

CONTACT INFORMATION  
Mining Records Curator  
Arizona Geological Survey  
416 W. Congress St., Suite 100  
Tucson, Arizona 85701  
602-771-1601  
<http://www.azgs.az.gov>  
[inquiries@azgs.az.gov](mailto:inquiries@azgs.az.gov)

The following file is part of the Arimetco, Inc. Mining Collection

#### **ACCESS STATEMENT**

These digitized collections are accessible for purposes of education and research. We have indicated what we know about copyright and rights of privacy, publicity, or trademark. Due to the nature of archival collections, we are not always able to identify this information. We are eager to hear from any rights owners, so that we may obtain accurate information. Upon request, we will remove material from public view while we address a rights issue.

#### **CONSTRAINTS STATEMENT**

The Arizona Geological Survey does not claim to control all rights for all materials in its collection. These rights include, but are not limited to: copyright, privacy rights, and cultural protection rights. The User hereby assumes all responsibility for obtaining any rights to use the material in excess of "fair use."

The Survey makes no intellectual property claims to the products created by individual authors in the manuscript collections, except when the author deeded those rights to the Survey or when those authors were employed by the State of Arizona and created intellectual products as a function of their official duties. The Survey does maintain property rights to the physical and digital representations of the works.

#### **QUALITY STATEMENT**

The Arizona Geological Survey is not responsible for the accuracy of the records, information, or opinions that may be contained in the files. The Survey collects, catalogs, and archives data on mineral properties regardless of its views of the veracity or accuracy of those data.

SAN JUAN BX-EW PROJECT southwestern U. S. A.		
JDS	01-Apr-91	
Acid consumption	7.00	7.00
	5.00	6.50
<b>RESERVES</b>		
grade % Cu	0.450%	0.520%
tonnage	16,000,000	16,000,000
per day moved	7,855	8,281
mine days/yr.	250	250
strip ratio	1.00	1.00
mine life years	8.15	10.22
	0.2250%	0.2600%
	0.1375%	0.1725%
recoveries	61.11%	66.35%
	0.2750%	0.3450%
tons/year copper	5400	5400
lbs Cu/day	29,589	29,589
<b>CAPITAL COSTS</b>	\$3,240,000	\$3,240,000
<b>PERMITTING</b>	\$500,000	\$500,000
<b>INFRASTRUCTURE</b>	\$2,000,000	\$2,000,000
<b>MINING EQUIPMENT</b>	\$1,200,000	\$1,200,000
<b>PROPERTY AQUIS</b>	\$1,500,000	\$1,500,000
<b>TOTAL PROJECT COSTS</b>	\$8,440,000	\$8,440,000
<b>ADMIN/OVERHEAD</b>	2.500	2.500
<b>MINING @ .79/ton</b>		
blasting	9.57	7.82
moving	19.15	15.26
	28.72	22.89
<b>CRUSHING</b>		
admin		
e power		
<b>LEACHING</b>		
admin	2.70	2.70
acid	6.25	8.13
e power	1.12	1.12
liner pad	2.50	2.50
	12.57	14.45
<b>SOLVENT EXTRACTION</b>		
admin	0.72	0.72
kerosene	0.80	0.80
lix	3.72	3.72
e power	0.47	0.47
	5.71	5.71
<b>ELECTROWINNING</b>		
admin	1.27	1.27
cobalt sulfate	0.30	0.30
e power	5.71	5.71
	7.28	7.28
<b>MISC</b>	0.00	0.00
<b>WATER</b>	1.00	1.00
<b>TOTAL OP COSTS</b>	\$0.5777	\$0.5382
	JDS	JDS
<b>PAYBACK IN YEARS</b>		
@ \$.85/lb	2.10	1.90
<b>\$/YEAR TON CAPACITY</b>	\$1,563	\$1,563
<b>% PAYBACK TO PROJECT LIFE</b>	26%	19%

OWNERSHIP

1. Chris Claridge Clan 51%
2. ANDERSON Clan 39%
3. BYU 10%

ACTUAL ownership split up between 16 parties. They generally go along with the advice of 2 individuals.

These are: ① Chris Claridge (602-485-2085)  
P.O. Box 235  
Fort Thomas, AZ 85536

Henry Met  
Chris Claridge  
on March 25<sup>th</sup> of  
the mine site

② Clyde Davis (801-374-5389)  
Provo, Utah

Clyde has a Ph.D from Arizona in geology and presently has a job advising BYU on its mineral interests/holdings. Both Claridge and Davis are very involved with the Mormon church and it is possible that some of the interests have been donated to the church over the years.

Clyde Davis is available the week of April 8-12 to have a meeting in Tucson. This might be an opportune time to get things moving.

In addition I've had two good talks with Grover Heinrichs concerning the ore reserves and quality of data. Grover was involved in the property back in the early 70s when Essex was working the property and has accumulated a database he considers far superior to the one furnished by Claridge. His rates are \$50/hr and \$5000 for a complete data set on the San Juan. He would be willing to set up a meeting and negotiate with the parties on our behalf, as he has known the individuals for over 20 years.

JIEL

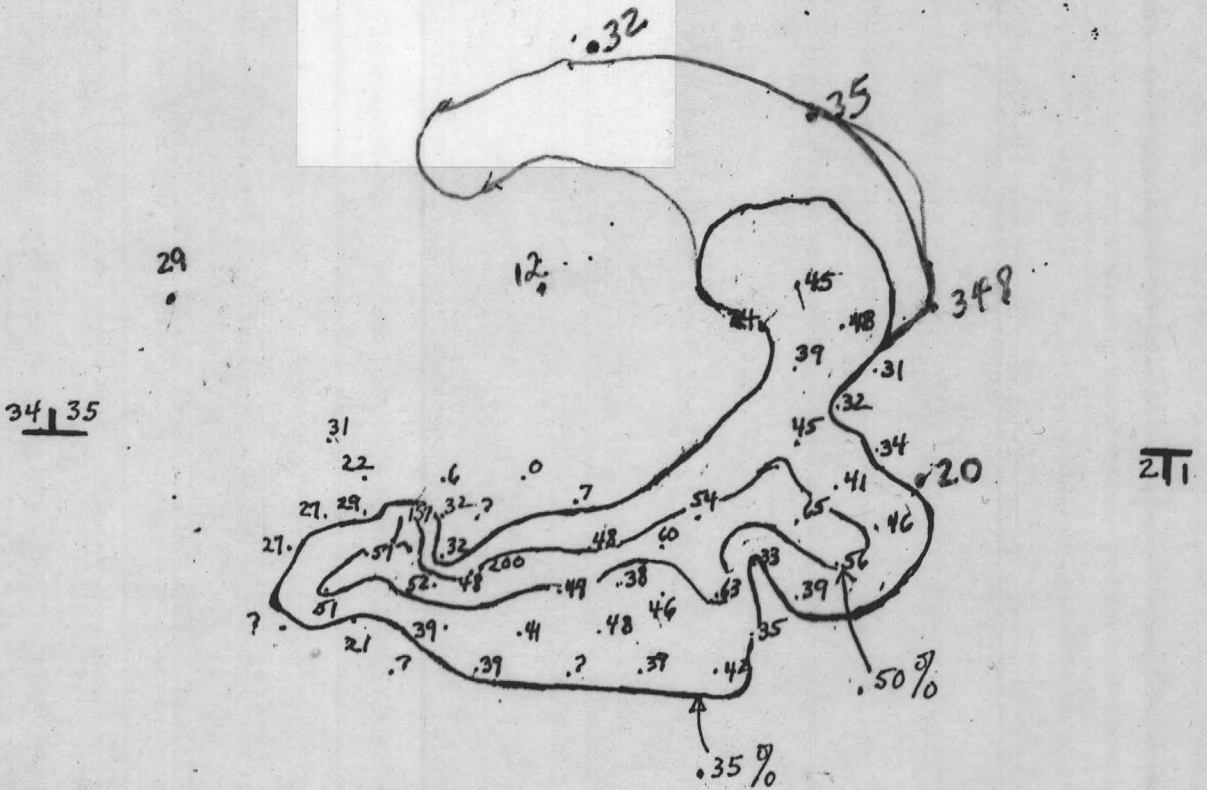
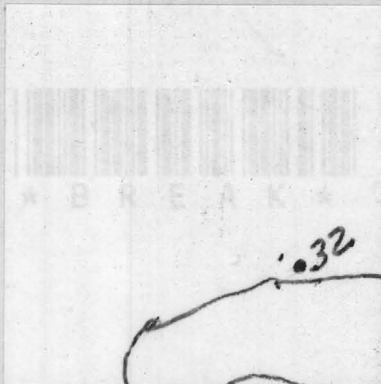

CONTOUR % MAP FOR  
1<sup>st</sup> 300' OF HOLE (AVERAGES)

FOR EXAMPLE A # OF .41 MEANS THAT OVER  
THE 1<sup>st</sup> 300' (FROM THE APPARANT DATA) THE  
AVERAGE GRADE IS .41% Cu.

34 | 35

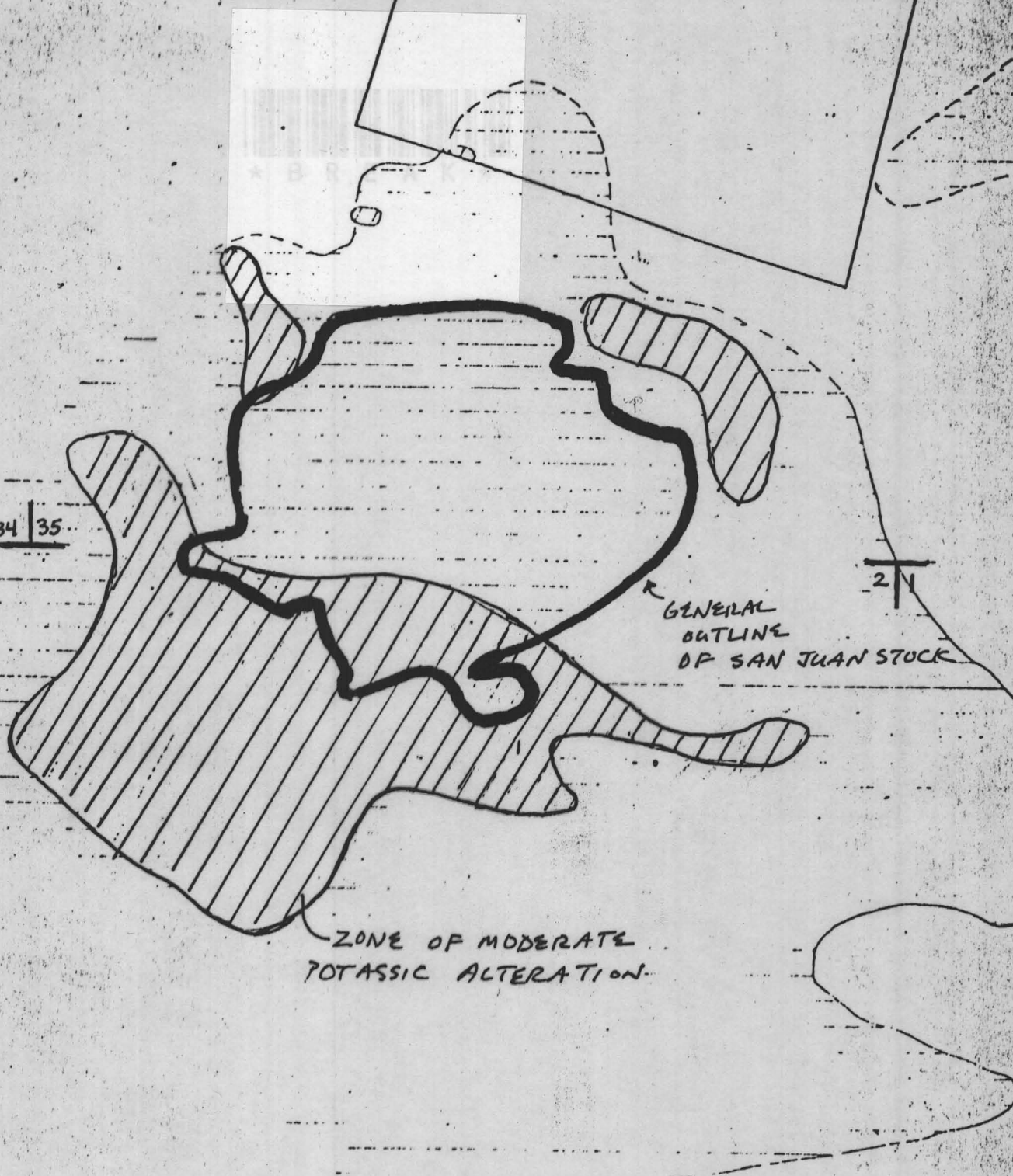

FROM M.S. THESIS OF  
D.W. BLAKE, 1971

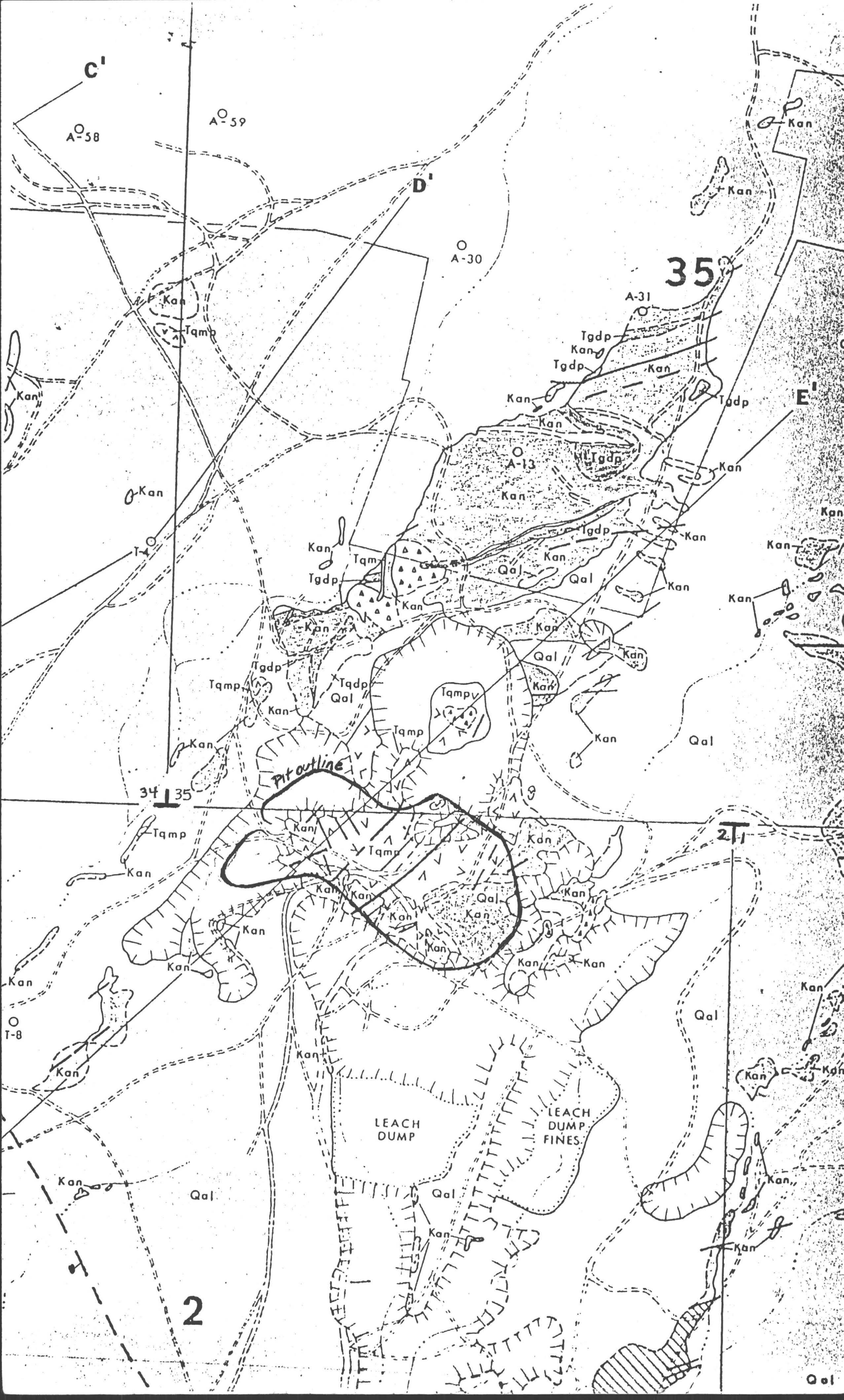

C'

A-58

A-59

D'

A-30

35

A-31

E'

Kan

Tgdp

Kan

Tgdp

Kan

Tgdp

Kan

Kan

Kan

A-13

Kan

Tgdp

Kan

Kan

Tamp

Tgdp

Kan

Qal

Qal

Kan

Kan

Kan

Tgdp

Kan

Qal

Kan

Tamp

Tgdp

Qal

Tamp

Kan

Qal

Kan

Qal

34

35

Pit outline

21

Tamp

Kan

Tamp

Kan

Kan

Kan

Kan

Kan

Kan

Kan

Qal

Kan

Kan

Kan

Kan

Qal

Kan

Kan

Kan

LEACH DUMP

LEACH DUMP FINES

Qal

Qal

Kan

Kan

Kan

2

Qal

34 | 35

2 | 1

GENERAL  
OUTLINE  
OF SAN JUAN STOCK

ZONE OF MODERATE  
POTASSIC ALTERATION

FROM M.S. THESIS OF  
D.W. BLAKE, 1971

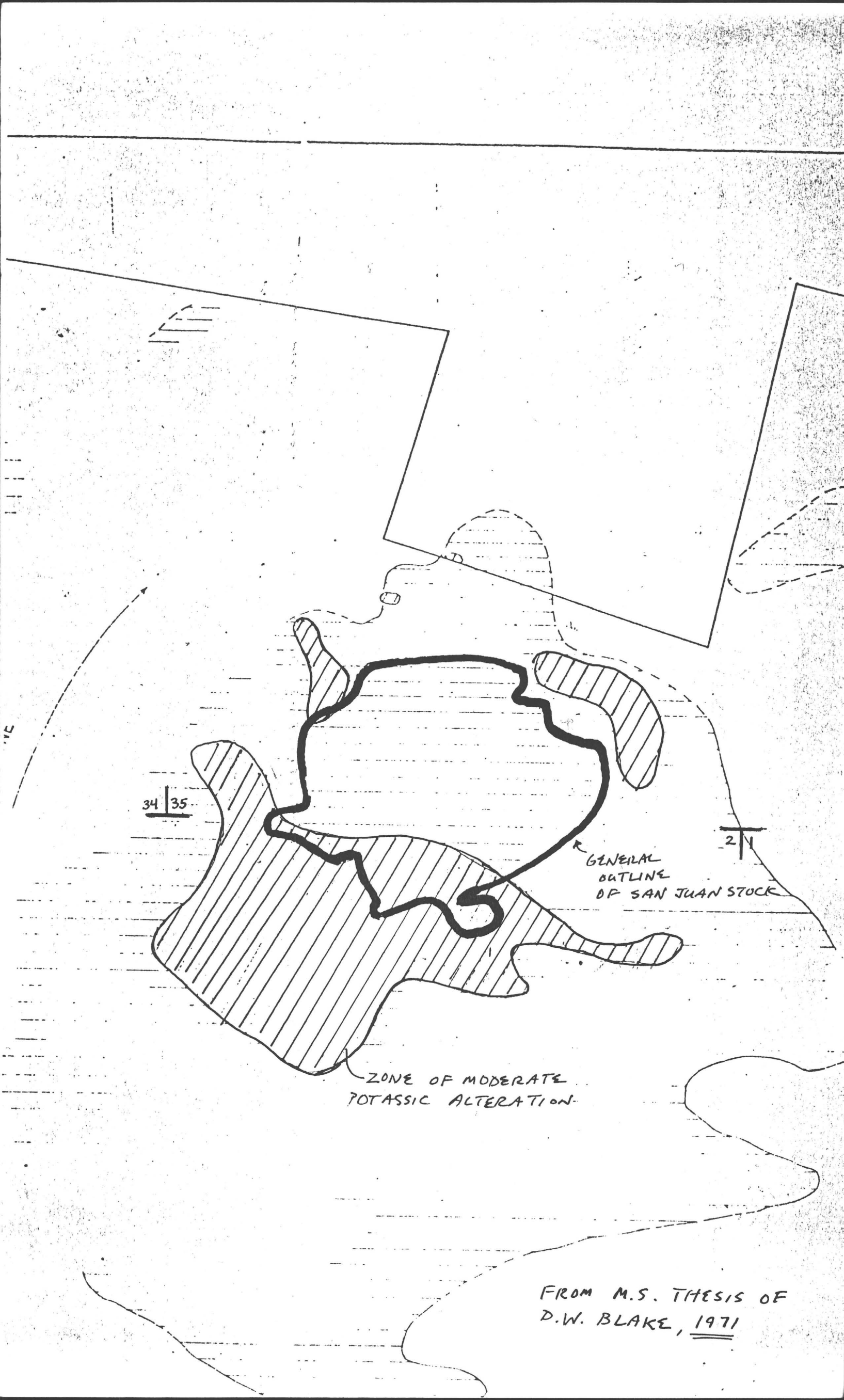

34 | 35

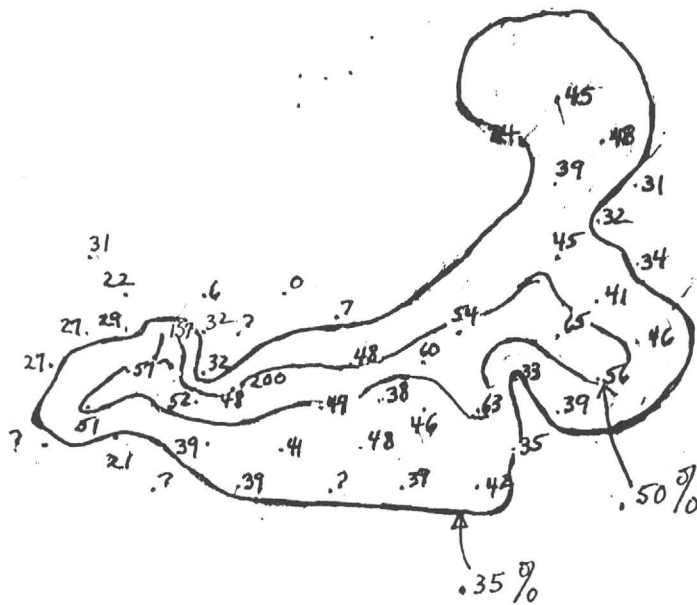

21

CONTOUR % MAP FOR  
1<sup>st</sup> 300' OF HOLE (AVERAGES)

FOR EXAMPLE A # OF .41 MEANS THAT OVER  
THE 1<sup>st</sup> 300' (FROM THE APPARENT DATA) THE  
AVERAGE GRADE IS .41% Cu.

ESSEX CROSS-SECTIONS AND WELL LOCATIONS

NOTE: WELLS NOT ON CROSS-SECTIONS NOT SHOWN FOR SIMPLICITY

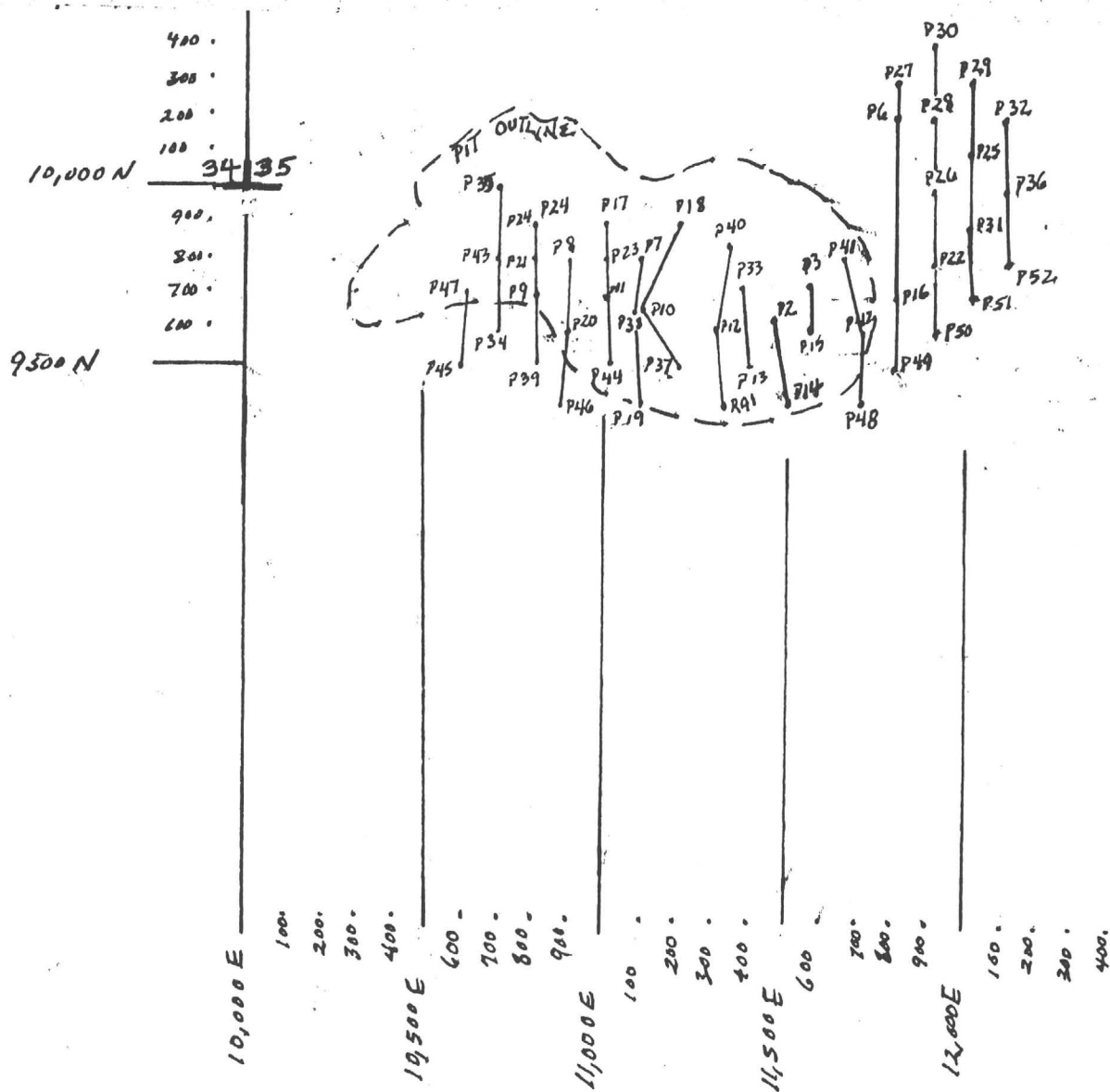



35

OA31

OA13

OT4  
No data

ORV.10

10,500 N

10,000 N

34 | 35

9,500 N

21.6

ORV5

Peak @

270-320

±0.37

○  
RV3  
No ore

OT6  
Nil

2

10,000 F

10,500 F

600

700

800

900

11,000 F

100

200

300

400

500

600

700

800

900

1000

12,000 F

12,500 F

H12

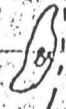
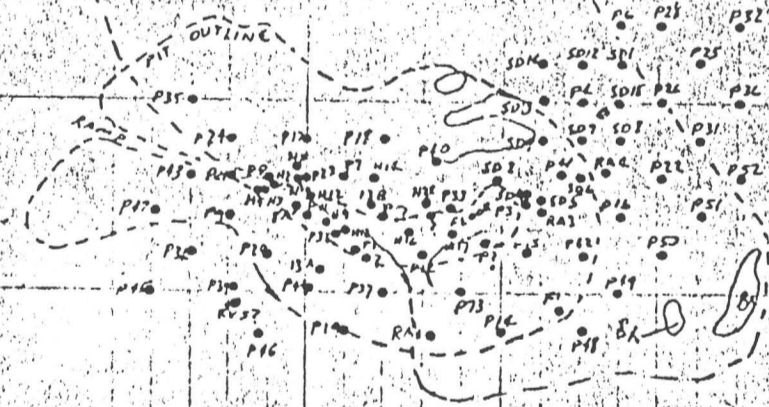
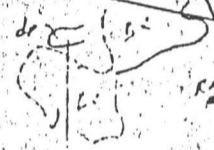

Henry Shipos  
Scott Birch