



CONTACT INFORMATION
Mining Records Curator
Arizona Geological Survey
3550 N. Central Ave, 2nd floor
Phoenix, AZ, 85012
602-771-1601
<http://www.azgs.az.gov>
inquiries@azgs.az.gov

The following file is part of the West Oatman Project mining collection

ACCESS STATEMENT

These digitized collections are accessible for purposes of education and research. We have indicated what we know about copyright and rights of privacy, publicity, or trademark. Due to the nature of archival collections, we are not always able to identify this information. We are eager to hear from any rights owners, so that we may obtain accurate information. Upon request, we will remove material from public view while we address a rights issue.

CONSTRAINTS STATEMENT

The Arizona Geological Survey does not claim to control all rights for all materials in its collection. These rights include, but are not limited to: copyright, privacy rights, and cultural protection rights. The User hereby assumes all responsibility for obtaining any rights to use the material in excess of "fair use."

The Survey makes no intellectual property claims to the products created by individual authors in the manuscript collections, except when the author deeded those rights to the Survey or when those authors were employed by the State of Arizona and created intellectual products as a function of their official duties. The Survey does maintain property rights to the physical and digital representations of the works.

QUALITY STATEMENT

The Arizona Geological Survey is not responsible for the accuracy of the records, information, or opinions that may be contained in the files. The Survey collects, catalogs, and archives data on mineral properties regardless of its views of the veracity or accuracy of those data.

RECEIVED MAY 15 1991



United States Department of the Interior

BUREAU OF LAND MANAGEMENT
KINGMAN RESOURCE AREA
2475 BEVERLY AVENUE
KINGMAN, ARIZONA 86401



IN REPLY REFER TO:
MN-91-K-05
3809 (025)
0865M

May 13, 1991

Mr. Michael Winston
Reynolds Metals Exploration, Inc.
5301 Longley Lane, Suite 157
Reno, Nevada 89511

Subject: Closure of Mining Notice MN-91-K-05

Dear Mr. Winston:

This letter is to notify you and the claimant of the West Oatman project that mining notice MN-91-K-05 was closed after a reclamation inspection was completed with you on May 9, 1991. We have found the area in excellent reclaimed condition and in compliance with Federal reclamation regulations with all drill access roads and drill pads in proper condition. This mining notice file having had all the exploration and required reclamation work completed, is being closed as of this date. Should you or your venture partners wish to continue mining or exploration activity in this area, a new mining notice or plan of operations will be required with subsequent reclamation bond as determined by the level of proposed mining related activity.

Thank you for your cooperation during the period of exploration activity and for assisting us in the management of our public lands.

Sincerely,

William K. Grissom
Acting Area Manager

cc: Compass Minerals, 5301 Longley Lane, Suite A-1, Reno, NV 89502



REYNOLDS METALS EXPLORATION, INC.

Reynolds Metals Company • 5301 Longley Lane • Suite 157 • Reno, Nevada 89511-1805
Telephone (702)829-8018 • Facsimile (702)829-8026

March 25, 1992

Arizona Department of Water Resources
15 South 15th Avenue
Phoenix, Arizona 85007

RE: Notice of Intention to Drill Exploration Wells
West Oatman Project, Mohave County, Arizona

To Whom It May Concern:

Attached, please find 3 completed Notice Of Intention To Drill Exploration Wells forms, for the West Oatman project, Mohave County, Arizona. I have also attached a money order for \$30.00 to cover the filing fees. If I can be of further assistance, please don't hesitate contacting me.

Sincerely,

Michael Winston
Contract Geologist for
Reynolds Metals Exploration, Inc.

THIS DOCUMENT CONTAINS AN ERASURE SENSITIVE FACE. ATTEMPTED ALTERATIONS WILL APPEAR WHITE.

AMERICAN EXPRESS® MONEY ORDER

82-40
1021

20	50	75	100	300
02	05	07	001	003

MONEY ORDER NOT GOOD FOR MORE THAN THE AMOUNT PUNCHED
MAXIMUM DOLLAR VALUE THREE HUNDRED DOLLARS (\$300)

21-236520788

VOID IF MORE THAN ONE AMOUNT IS PUNCHED

DATE 3/26 92 WAREHOUSE
MMTS. # 18

30 dol's 00 cts

TO THE ORDER OF Arizona Department of Water Resources *L. R. [Signature]* CHAIRMAN

SENDER'S NAME AND ADDRESS Reynolds Metals - 5301 Longley Ln, Ste. 157, Reno, NV 89511

Issued by American Express
Travel Related Services Company, Inc.
Englewood, Colorado

Payable at
United Bank of Grand Junction - Downtown
Grand Junction, Colorado

WS

⑆ 10 2 100400 ⑆ 21 ⑈ 2365207884 ⑈

NOTICE OF INTENTION TO DRILL EXPLORATION WELL(S)

Section §45-596, Arizona Revised Statutes, and Rule 12-15-817 provide: Prior to drilling one or more exploration wells, the well owner, or exploration firm shall file a Notice of Intention to Drill on a form provided by the Department.

WELL/LAND LOCATION

1. Township | Range | Section
20 N | 20 E | 32

In the case of a single well, list 10-acre subdivision.

10 ACRE | 40 ACRE | 160 ACRE

2. County Mohave

3. Applicant Name: Reynolds Metals Expl. Inc.
Address: 5301 Longley Lane, Ste #157
City: Reno Nevada 89511

4. Name of Contact Person: Michael Winston
Phone: (702) 829-8018

5. Owner of Well: Reynolds Metals Expl. Inc.
Address: 5301 Longley Lane #157
City: Reno Nevada 89511

6. Purpose of well(s) drilled pursuant to this Notice:

Mineral Exploration X
Geotechnical
Cathodic Protection
Grounding

7. Number of wells up to 20 (See Condition 4 on reverse side)

8. Owner of Land: U.S. Bureau of Land Management
Address: 2475 Beverly Avenue
City: Kingman AZ 86401

DO NOT WRITE IN THIS SPACE OFFICE RECORD
File No.
Filed By
Input By
DUPLICATE
Mailed By
Registration 55-
AMA/INA
W/S S/B

9. DESCRIPTION OF THE WELL
Diameter 5-6 inches
Depth Approx. 600 feet
Type of casing. If none, state: May use temporary steel casing, which if used would be removed from each well prior to abandonment

10. Construction will start April 22 1992
Month Day Year

11. Drilling Firm: Hackworth Drilling Inc
Name

5019 Manzanita Dr.
Address
City: Elko NV State Zip: 89801
391
D&R License Number: A-04
ROC License Category

12. Period well will remain in use: up to 2 months

13. Proposed method of abandonment of well(s) after project is completed: Fill each well with cuttings or bentonite to within 20' of surface. A cement cap will then be set to within 2' of surface. The upper 2' of hole will be backfilled with a mixture of cuttings and topsoil. All abandonment procedures will comply with Rules R12-15-816 and R12-15-817

14. Is the proposed wellsite within 100 feet of a septic tank system, sewage disposal area, landfill, hazardous waste facility or storage area of hazardous materials or a petroleum storage area and tanks?
Yes No X

GENERAL INSTRUCTIONS

- 1. Fill out this form in DUPLICATE and send WITH \$10.00 FEE to 15 South 15th Avenue, Phoenix, AZ 85007.
2. For specific instructions, limitations and conditions, see the reverse side of this form.

I state that Notice is filed in compliance with Rule R12-15-809 and is complete and correct to the best of my knowledge and belief and that I understand the conditions set forth on the reverse side of this form.

Date March 25, 1992

Signature of Applicant/Owner: Michael R. Winston

NOTICE OF INTENTION TO DRILL EXPLORATION WELL(S)

Section §45-596, Arizona Revised Statutes, and Rule 12-15-817 provide: Prior to drilling one or more exploration wells, the well owner, or exploration firm shall file a Notice of Intention to Drill on a form provided by the Department.

WELL/LAND LOCATION

1. Township 20 NYS | Range 20 EW | Section 31

In the case of a single well, list 10-acre subdivision.

10 ACRE 1 | 40 ACRE 1 | 160 ACRE 1

2. County Mohave

3. Applicant Name Reynolds Metals Expl. Inc.
Address 5301 Longley Lane, Ste. #157
Reno Nevada 89511
City State Zip

4. Michael Winston
Name of Contact Person
Phone (702) 829-8018

5. Owner of Well
Reynolds Metals Expl. Inc.
Name
5301 Longley Lane #157
Address
Reno Nevada 89511
City State Zip

6. Purpose of well(s) drilled pursuant to this Notice:

Mineral Exploration X
Geotechnical _____
Cathodic Protection _____
Grounding _____

7. Number of wells up to 20
(See Condition 4 on reverse side)

8. Owner of Land:
U.S. Bureau of Land Management
Name
2475 Beverly Avenue
Address
Kingman AZ 86401
City State Zip

9. DESCRIPTION OF THE WELL
Diameter 5-6 inches
Depth Approx. 600 feet
Type of casing. If none, state: May use temporary steel casing, which if used would be removed from each well prior to abandonment

10. Construction will start
April 22 1992
Month Day Year

11. Drilling Firm:
Hackworth Drilling Inc
Name

5019 Manzanita Dr.
Address
ELKO NV 89801
City State Zip
391
D&R License Number
A-04
ROC License Category

12. Period well will remain in use: up to 2 months

DO NOT WRITE IN THIS SPACE
OFFICE RECORD
File No. _____
Filed _____ By _____
Input _____ By _____
DUPLICATE
Mailed _____ By _____
Registration 55- _____
AMA/INA _____
W/S _____ S/B _____

13. Proposed method of abandonment of well(s) after project is completed: Fill each well with cuttings or bentonite to within 20' of surface. A cement cap will then be set to within 2' of surface. The upper 2' of hole will be backfilled with a mixture of cuttings and topsoil. All abandonment procedures will comply with Ruler R12-15-816 and R12-15-817

14. Is the proposed wellsite within 100 feet of a septic tank system, sewage disposal area, landfill, hazardous waste facility or storage area of hazardous materials or a petroleum storage area and tanks?
Yes _____ No X

GENERAL INSTRUCTIONS

- 1. Fill out this form in DUPLICATE and send WITH \$10.00 FEE to 15 South 15th Avenue, Phoenix, AZ 85007.
- 2. For specific instructions, limitations and conditions, see the reverse side of this form.

I state that Notice is filed in compliance with Rule R12-15-809 and is complete and correct to the best of my knowledge and belief and that I understand the conditions set forth on the reverse side of this form.

Date March 25, 1992

Michael R. Winston
Signature of Applicant/Owner

NOTICE OF INTENTION TO DRILL EXPLORATION WELL(S)

Section §45-596, Arizona Revised Statutes, and Rule 12-15-817 provide: Prior to drilling one or more exploration wells, the well owner, or exploration firm shall file a Notice of Intention to Drill on a form provided by the Department.

WELL/LAND LOCATION

1. Township | Range | Section
20 NYS | 20 EAD | 19

In the case of a single well, list 10-acre subdivision.

10 ACRE 40 ACRE 160 ACRE

2. County Mohave

3. Applicant Name Reynolds Metals Expl. Inc.
Address 5301 Longley Lane, Ste. #157
City Reno Nevada 89511 State Zip

4. Michael Winston
Name of Contact Person
Phone (702) 829-8018

5. Owner of Well Reynolds Metals Expl. Inc.
Name
Address 5301 Longley Lane #157
City Reno Nevada 89511 State Zip

6. Purpose of well(s) drilled pursuant to this Notice:

Mineral Exploration X
Geotechnical
Cathodic Protection
Grounding

7. Number of wells up to 10
(See Condition 4 on reverse side)

8. Owner of Land: U.S. Bureau of Land Management
Name
Address 2475 Beverly Avenue
City Kingman AZ 86401 State Zip

9. DESCRIPTION OF THE WELL
Diameter 5-6 inches
Depth Approx. 600 feet
Type of casing. If none, state: May use temporary steel casing, which if used would be removed from each well prior to abandonment

10. Construction will start April 22 1992
Month Day Year

11. Drilling Firm: Hackworth Drilling Inc
Name

5019 Manzanita Dr.
Address
City ELKO NV 89801 State Zip
391
D&R License Number A-04
ROC License Category

12. Period well will remain in use: up to 2 months

DO NOT WRITE IN THIS SPACE OFFICE RECORD
File No.
Filed By
Input By
DUPLICATE
Mailed By
Registration 55-
AMA/INA
W/S S/B

- 13. Proposed method of abandonment of well(s) after project is completed: Fill each well with cuttings or bentonite to within 20' of surface. A cement cap will then be set to within 2' of surface. The upper 2' of hole will be backfilled with a mixture of cuttings and topsoil. All abandonment procedures will comply with Rules R12-15-816 and R12-15-817
14. Is the proposed wellsite within 100 feet of a septic tank system, sewage disposal area, landfill, hazardous waste facility or storage area of hazardous materials or a petroleum storage area and tanks? Yes No X

GENERAL INSTRUCTIONS

- 1. Fill out this form in DUPLICATE and send WITH \$10.00 FEE to 15 South 15th Avenue, Phoenix, AZ 85007.
2. For specific instructions, limitations and conditions, see the reverse side of this form.

I state that Notice is filed in compliance with Rule R12-15-809 and is complete and correct to the best of my knowledge and belief and that I understand the conditions set forth on the reverse side of this form.

Date March 25 1992

Signature of Applicant/Owner Michael R. Winston



REYNOLDS METALS EXPLORATION, INC.

Reynolds Metals Company • 5301 Longley Lane • Suite 157 • Reno, Nevada 89511-1805
Telephone (702)829-8018 • Facsimile (702)829-8026

March 25, 1992

Mr. Dale Veden
Hackworth Drilling, Inc.
P.O. Box 850
5019 Manzanita Drive
Elko, NV 89801

Dear Dale:

I am glad to inform you, Reynolds has accepted your bid to drill our West Oatman project in Mohave County, Arizona. I spoke with Royce yesterday and asked for a drill contract for our lawyers to review.

We still plan to begin soon after Easter in late April. However, final permitting and road work may delay start-up till May 1st. I will keep you informed as we progress.

I will be in and out of the office, but you may also call Ray Irwin if you need further details. We look forward to working with you in sunny Arizona.

Best regards,

Michael R. Winston
Project Geologist

REYNOLDS METALS EXPLORATION, INC.

Drilling Specification

Project Name: West Oatman

Desired starting date: April 22, 1992 (Weds. after Easter)

Location and access from nearest town: About 8 miles east of Bullhead City, Arizona via the Silver Creek County road (dirt), towards Oatman, Arizona

Number of holes: Angle 19 Vertical 0

Total anticipated footage: 9600' max. - 5000' min.

Deepest hole anticipated: 600'

Thickness of overburden: 20' max.

Lithologies anticipated: Volcanic rocks with quartz veins and silicified breccias

Type of drill rig desired: Track preferred, truck acceptable (RCR)

Will drill holes encounter water and amount: All holes are anticipated to hit enough water as to require wet sampling procedures

Nearest source of water for drilling: Colorado River - Bullhead City (8-10 miles)

Sample interval: 5 feet

Special Requirements

- * 3 man crew consisting of driller, helper, and sampler.
- * Fire extinguishers required on all trucks.
- * Special Equipment: _____

- * Rig must plug drill holes prior to moving off of each site with bentonite and cement surface cap as required by current regulation.
- * Sample Collection System: Cyclone attached to 3 tier Jones splitter for dry samples and rotary splitter or equivalent for wet samples.
- * Drill crew is responsible for site clean-up.



April 2, 1992

Mr. Mike Winston
Reynolds Metals Exploration, Inc.
5301 Longley Lane #157
Reno, NV 89511-1805

Dear Mike,

I have enclosed two signed Drilling Contracts Number 710-RFTA, for your West Oatman Drilling Project, near Bullhead City, Arizona. Please look these contracts over and if everything is satisfactory please sign both copies and return one signed copy to us for our files. If you have any questions please call us at 702-738-9891.

We are looking forward to working with you.

Sincerely,

A handwritten signature in black ink, appearing to read 'Dale C. Veden', written in a cursive style.

Dale C. Veden
Drill Supervisor

DCV:gs

April 30, 1992

Hackworth Drilling, Inc.
5019 Manzanita
Elko, Nevada 89801

Gentlemen:

Find enclosed two executed originals of your drilling contract Number 710-RFTA with Reynolds Metals Exploration, Inc.

Please note that a change was made to Section 1.6 on page 1 by our attorneys. If this change is acceptable, initial in the margin and return one original to my attention in Richmond.

I apologize for the delay in returning the agreement and appreciate your patience.

Sincerely,

REYNOLDS METALS COMPANY

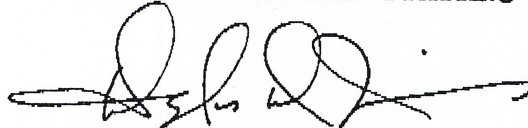

Douglas D. Jinks
Operations Manager
Precious Metals and Geology

DDJ:pj

Enclosures

cc: ✓ R. E. Irwin, REMX/Reno

Jodee,
Please file
under 1992
BLACKWONDER
DRILLING CONTRACT

**DRILLING SERVICES CONTRACT
NUMBER 710-RFTA**

from

**HACKWORTH DRILLING, INC
P. O. BOX 850
ELKO, NEVADA 89801**

(Hereinafter referred to as Contractor)

with

**REYNOLDS METALS EXPLORATION, INC.
5301 LONGLEY LANE #157
RENO, NV 89511-1805**

(Hereinafter referred to as Client)

HACKWORTH DRILLING, INC.
CONTRACT NO. 710-RFTA
DATE APRIL 2, 1992

IN CONSIDERATION OF THE MUTUAL PROMISES, CONDITIONS AND AGREEMENTS HEREIN CONTAINED AND THE SPECIFICATIONS, SPECIAL PROVISIONS SET FORTH IN SCHEDULES "A" THROUGH "D" ATTACHED HERETO AND MADE A PART HEREOF, CONTRACTOR OFFERS TO UNDERTAKE THE WORK ON A CONTRACT BASIS:

1. THE CONTRACTOR PROMISES AND AGREES:

- 1.1 To furnish equipment as per Schedule "C" attached.
- 1.2 To furnish personnel as per Schedule "D" attached.
- 1.3 To provide parts, supplies, materials, fuels, lubricants, etc. pertinent to the efficient performance of this undertaking, excepting casing, cement, drilling mud, additives, rotary, diamond and down-the-hole hammer bits.
- 1.4 To procure, at the request of the client and/or client's representative, casing, cement, drilling mud, additives, rotary diamond, down-the-hole hammer bits and such other additional supplies, materials, personnel and equipment as may be necessary for the efficient operation and completion of the drilling assignment. Compensation for the procurement of such additional supplies, materials, personnel and equipment shall be at the rates set forth in Schedule "D" attached.
- 1.5 To leave the drill site free of all debris resulting from the work performed by the contractor excepting drill cuttings.
- 1.6 To conduct all operations hereunder in full compliance of all rules and regulations adopted by any legal government ordinance whether Federal, State, Municipal or City.
- 1.7 To prepare a daily drill log (Schedule "A") summarizing in detail the day's activities including consumable and chargeable items. One copy of the daily drill log will be provided the client and/or the client's representative on a daily basis.
- 1.8 To provide and maintain insurance coverage with an insurance company or companies authorized to do business in the State where the work is to be performed and satisfactory to the client, insurance coverages of the kind and in the amount set forth in Schedule "B". Contractor will, if requested to do so by the client,

procure from the company or companies writing said insurance a certificate or certificates satisfactory to the client that said insurance is in full force and effective and that the same shall not be cancelled or materially changed without ten (10) days prior written notice to the client.

- 1.9 To operate the contractor's equipment on a single shift basis up to 10 hours per day 5 to 6 days per week and/or at some other schedule mutually agreeable to contractor and client.
- 1.10 To commence drilling operations within 14 days after receipt of award or as scheduling permits to diligently continue the work until it is completed or until the assignment is terminated as is hereinafter provided.
- 1.11 To render an invoice for services performed within five (5) days after the 15th and the end of the month or alternately within five (5) days of the conclusion or termination of the assignment if such assignment is commenced and concluded within a calendar month.
- 1.12 To conduct drilling and sampling operations in accordance with the procedures detailed on Schedule "C".

2. THE CLIENT PROMISES AND AGREES:

- 2.1 It is recognized that the client has superior knowledge of the location of the work, the access routes to the location of the work, surface and sub-surface conditions, weather patterns, etc. and client is obligated to advise contractor of all or any of the conditions that may affect contractor's performance of this undertaking. Additionally, prior to the commencement of drilling at the drilling location named herein, the client shall have determined and marked the locations of the bore holes and shall have made provisions for right-of-way, reasonably maintained access roads, sound locations, adequate in size and capable of properly supporting the drill unit. The client shall procure all entry permits and hold harmless the contractor for claims of trespass or damage to property required in carrying out the work contemplated by the client hereunder, except where contractor is negligent or has violated the client's specific written instructions. The client will provide a bulldozer and/or some other suitable machine and/or vehicle to provide towing and other assistance as may be required for the satisfactory performance of the undertaking.
- 2.2 The client shall be responsible for all underground

utilities, the plugging of bore holes and the refurbishing of the ground surface as may be required.

- 2.3 That should it direct, in writing, the contractor to furnish supplies, materials, personnel and equipment other than those items specifically furnished by contractor in Schedule "C" and "D" of this contract, the client will reimburse contractor for those items as detailed in Schedule "D" attached.
- 2.4 Client agrees to pay contractor for the mobilization and demobilization of personnel and equipment, for services provided and for materials supplied at the rates as detailed in Schedule "D" herein within 30 days after the receipt of the contractor's invoice.
- 2.5 The client shall be responsible for the handling, transporting, and safekeeping of the geological samples and will provide all sample bags and/or containers for the storage of the samples.

3. OTHER SPECIAL CONSIDERATIONS:

- 3.1 Contractor's invoices for services provided are net, due and payable upon receipt. Invoices unpaid thirty (30) days after date of invoice will be subject to a delinquency charge of 1.5 percent per month (18 percent per annum). Payable by check in U.S. funds, drawn on a U.S. bank or wired to our bank in U.S. funds. A \$15,000.00 advance has been received and noted for this project.
- 3.2 All the information and data obtained by reason of, or in connection with, the work shall be the exclusive property of the client. The contractor will keep all such information and data strictly confidential and will not divulge or use, or permit its employees to divulge or use any information or data so obtained.
- 3.3 All risk and damage to contractor's tools, machinery, appliances, or equipment shall be at all times borne and assumed by the contractor unless client expressly agrees to reimburse contractor for such loss or damage.

Loss of tools due to driller's error shall be paid for by the Contractor. The on-site contractor's personnel shall notify the Client's on-site representative in the event that loose and caving material are encountered that may prevent the successful completion of any hole. Under such notification, the client will assume responsibility for all in-hole tools, if the client elects to continue drilling on the hole; compensation will be paid to the

contractor as provided in Section 3.4 of this contract.

- 3.4 Hours consumed in the recovery and/or attempted recovery of drill pipe and/or drill tools, etc. on any one bore hole would be chargeable at an hourly rate of \$215.00. The maximum chargeable on any one bore hole would be 32 hours. At the end of that period should recovery not be achieved, the drill pipe and/or drill tools would be considered lost and/or abandoned and contractor would be entitled to receive payment according to the following:
- | | |
|--|-------------------|
| - Drill pipe 20 ft. lengths | <u>\$1,150.00</u> |
| - Mission SD5-HD Hammer Drill (Complete) | <u>\$5,870.00</u> |
| - Interchange (Crossover) Sub | <u>\$ 799.00</u> |
| - Regular Bit Sub | <u>\$ 484.00</u> |
- 3.5 It is specifically understood that the contractor is not the agent of the client and is not authorized to act for or on behalf of the client or to bind the client in any manner whatsoever, and that this agreement shall never be construed as creating a joint venture or other relationship whereby either party hereto shall be held for the acts either of omission or commission of the other party hereunder. Contractor agrees that the services provided herein will be performed as an independent contractor. The exclusive direction, management and control of the employees of contractor and of the work to be done under the provisions of this contract shall always reside in contractor.
- 3.6 That neither party to this agreement shall be liable for any loss or damage caused by reason of strikes, accidents, acts of God, action of the elements, or of any other causes beyond its control.
- 3.7 That this assignment is based upon contractor performing this assignment with his regular drill crew and under a non-union operation. Should local unions require contractor or its employees to join their local union against contractor's will, this agreement shall terminate and shall be open for renegotiation.
- 3.8 It is fully understood and agreed that none of the requirements of this contract shall be considered as waived and/or modified unless the same is done in writing, and then only by the persons executing this contract, or other duly authorized agent or representative of the party.
- 3.9 Contractor may employ other contractors to perform the work detailed in Schedule "D" provided that the contractor obtains written consent from the client.

3.10 This agreement shall continue in force until the drilling assignment is completed or until cancelled by either party hereto, such cancellation to be effective by giving written notice (by mail or telegram) to the other party at the address given herein not less than 3 calendar days prior to date of termination; PROVIDED HOWEVER, upon the breach of any substantial provision of this agreement, the party not guilty of such breach may if it elects, cancel this agreement without the written notice provided for above. In the event of termination under this provision, the client shall compensate contractor in accordance with the schedule of compensation as detailed in Schedule "D" herein.

3.11 ATTORNEYS FEES AND COURT COSTS: The Client agrees that upon demand by Hackworth Drilling, Inc., Client shall reimburse Hackworth Drilling, Inc. for all expenses, collection charges, court costs and attorney fees incurred in enforcing any of its rights and remedies against the Client for failure to make payments as required or otherwise perform the terms and conditions of this agreement.

3.12 This agreement will be governed by and construed in accordance with the laws of the State of Nevada.

3.13 This contract for drilling services is valid through December 31, 1992. After this date, the honoring of this contract would be subject to the availability of personnel and equipment and any extension of this contract would be entirely discretionary by the contractor.

The foregoing contract for drilling services is made by:

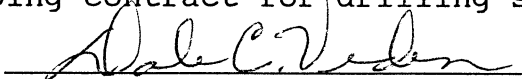
By: 

Title: Drill Supervisor

Date: APRIL 2, 1992

The foregoing contract for drilling services is accepted by:

By: _____

Title: _____

Date: _____

SCHEDULE "A"
HACKWORTH DRILLING COMPANY
 P.O. Box 850 Elko, Nevada 89801 (702) 738-8335

DAILY DRILLERS REPORT

Date _____
 Drill No. _____
 Hole No. _____
 Hours Drilled _____
 Hours Standby _____

Shift _____
 Location _____
 Footage End Shift _____
 Footage Start Shift _____
 Footage Drilled _____

FORMATION LOG		
From	To	Formation

Water Used _____ Gallons
 Water Truck No. _____
 Hours Casing _____
 Hours Equip. Rep. _____
 Hours Cementing _____
 Hours Travel _____
 Hours Other _____
 Total Hours _____

C A S I N G	Size	Type	Footage

MATERIALS USED						
B I T S	Size	Type	Footage	Serial No.	Name	

L O S T M T L	Description	No. Sacks	Size Sacks

REMARKS _____

Helper _____ Helper _____
 Driller _____ Approved _____

ACORD CERTIFICATE OF INSURANCE

ISSUE DATE 04/02/92

PRODUCER
SMITH - GREGORY INSURANCE
P.O. BOX 2108
790 COMMERCIAL STREET
ELKO, NEVADA 89801

THIS CERTIFICATE IS ISSUED AS A MATTER OF INFORMATION ONLY AND CONFERS NO RIGHTS UPON THE CERTIFICATE HOLDER, THIS CERTIFICATE DOES NOT AMEND, EXTEND OR ALTER THE COVERAGE AFFORDED BY THE POLICIES BELOW

CODE SUB-CODE

COMPANIES AFFORDING COVERAGE
LETTER A RELIANCE INSURANCE CO.

INSURED
Hackworth Drilling, Inc.
P.O. Box 850
Elko, NV
89801

COMPANY
LETTER B
COMPANY
LETTER C
COMPANY
LETTER D
COMPANY
LETTER E

=== COVERAGES ===
THIS IS TO CERTIFY THAT THE POLICIES OF INSURANCE LISTED BELOW HAVE BEEN ISSUED TO THE INSURED NAMED ABOVE FOR THE POLICY PERIOD INDICATED, NOTWITHSTANDING ANY REQUIREMENT, TERM OR CONDITION OF ANY CONTRACT OR OTHER DOCUMENT WITH RESPECT TO WHICH THIS CERTIFICATE MAY BE ISSUED OR MAY PERTAIN, THE INSURANCE AFFORDED BY THE POLICIES DESCRIBED HEREIN IS SUBJECT TO ALL THE TERMS, EXCLUSIONS AND CONDITIONS OF SUCH POLICIES. LIMITS SHOWN MAY HAVE BEEN REDUCED BY PAID CLAIMS.

CD	TYPE OF INSURANCE	POLICY NUMBER	POLICY EFF. DATE	POLICY EXP. DATE	ALL LIMITS IN THOUSANDS
	GENERAL LIABILITY				GENERAL AGGREGATE \$ 2,000
	[X] Commercial General Liability				PRODUCTS-COMP/OPS AGGREGATE \$ 2,000
A	[] Claims Made [X] Occur.	OB 1224412	01/01/92	01/01/93	PERSONAL & ADVERTISING INJURY \$ 1,000
	[X] Owner's & Contractor's Prot.				EACH OCCURRENCE \$ 1,000
	[]				FIRE DAMAGE (Any one fire) \$ 50
	[]				MEDICAL EXPENSE (Any one person) \$ 5
	AUTOMOBILE LIABILITY				COMBINED \$ 1,000
	[X] Any Auto				SINGLE LIMIT
	[] All Owned Autos				BODILY INJURY \$
A	[] Scheduled Autos	OB 1224412	01/01/92	01/01/93	(Per person)
	[X] Hired Autos				BODILY INJURY \$
	[X] Non-Owned Autos				(Per accident)
	[] Garage Liability				PROPERTY DAMAGE \$
	[]				
	EXCESS LIABILITY				EACH OCCURRENCE
A	[X]	OU 1224412	01/01/92	01/01/93	\$ 5,000
	[] Other Than Umbrella Form				\$ 5,000
	WORKER'S COMPENSATION AND EMPLOYERS' LIABILITY				STATUTORY
					\$ (EACH ACCIDENT)
					\$ (DISEASES-POLICY LIMIT)
					\$ (DISEASES-EACH EMPLOYEE)
	OTHER				

DESCRIPTION OF OPERATIONS/LOCATIONS/VEHICLES/SPECIAL ITEMS

=== CERTIFICATE HOLDER === CANCELLATION ===

REYNOLDS METALS COMPANY
5301 LONGLEY LANE
SUITE 157
RENO, NEVADA 89511 1805

SHOULD ANY OF THE ABOVE DESCRIBED POLICIES BE CANCELLED BEFORE THE EXPIRATION DATE THEREOF, THE ISSUING COMPANY WILL ENDEAVOR TO MAIL 10 DAYS WRITTEN NOTICE TO THE CERTIFICATE HOLDER NAMED TO THE LEFT, BUT FAILURE TO MAIL SUCH NOTICE SHALL IMPOSE NO OBLIGATION OR LIABILITY OF ANY KIND UPON THE COMPANY, ITS AGENTS OR REPRESENTATIVES.

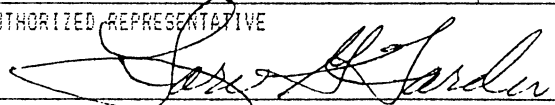
AUTHORIZED REPRESENTATIVE

SCHEDULE "C"

DESCRIPTION OF EQUIPMENT

- 1 1986 Schramm C-560 Track-mounted drill rig. The drill unit is equipped with a GHH 600 cfm at 350 psi air compressor. This unit is capable of drilling angle holes to 45° off of vertical to a depth of 800 feet.
- 800 Feet of 4-1/2" O.D. Matrix 20' joints of dual tube drill pipe.
- 1 4x4 service truck
- 1 Cyclone assembly c/w discharge hose
- Drill bit subs and adapters for tricone and/or down-the-hole hammer drilling up to a hole diameter of 5-1/2".
- 1 SD-5 Hammer Drill with interchange sub for use with dual wall drill pipe.
- 1 Track-mounted support vehicle with 1,000 gallon water capacity.
- 1 Gilson Splitter (1/2" V-bars, 1 cu. ft. capacity). Also available at client's request, a Jones 3-tier splitter, and a rotary cone wet splitter.

METHOD OF DRILLING & SAMPLING

The reverse circulation rotary method (RCR) will be employed utilizing double wall drill pipe, full bore tricone and/or button bits and reverse circulation air flow to drill and sample the formation. Should it be necessary and/or desirable to drill the hard formations with a down-the-hole hammer drill, the double wall drill pipe, interchange sub and down-the-hole hammer drill would be utilized. With either method, the reverse circulation system would be employed to recover the geological sample up through the center of the double wall pipe and the sample will be discharged at the surface via a cyclone directly onto a contractor supplied Gilson, Jones 3-tier, or rotary cone wet splitter. Should the sample be in a completely dry state and/or in a sticky condition, water may be injected into the air flow, on an intermittent or continuous basis, to assist in the recovery of the sample. Surface casing may be employed as required to stabilize any alluvial fill that may be present at the top of the hole.

HACKWORTH DRILLING, INC.
QUOTATION/CONTRACT NO.

#710-RFTA
DATE: March 10, 1992

FOOTAGE COMPENSATION SCHEDULE
(Track-Mounted Drill Rig)

I. INFORMATION RELATIVE TO JOB:

Location of Job: West Oatman Project near Bullhead City, Arizona

Starting Date: Late April, 1992

Minimum Guaranteed Footage: About 7,000 ft.

Maximum Depth: 600 ft.

No. and Type of Drill Rig: One Schramm C-560

Drill Crew Provided: One driller and two helpers

Access to Jobsite: Fair No. of Holes: 19

Angle (degree at top of casing): Vertical to 45°

II. SCHEDULE OF RATES:

- A. Mobilization and demobilization: Lump Sum \$2,500.00
- B. Travel time in excess of one (1) hour per day from the nearest available source of accomodation and fuel supply is chargeable at: No charge.
- C. Footage rate calculated from the surface of the bore hole to the depth penetrated by the drill bit would be: 0 ft. to 600 ft. at \$6.00.
The footage rate includes, on a per hole basis, the first one (1) hour of time that may be consumed in setting the surface casing, moving between holes, reaming, hole stabilization, etc. Time in excess of one (1) hour for each hole would be chargeable at the hourly rate of: \$215.00.
- D. Plugging of holes in accordance with Arizona laws, commencing with the first one (1) hour will be chargeable at the hourly rate of: \$175.00.
- E. No charges for down time would apply for the time consumed servicing and/or repairing contractor supplied equipment. Breakdown is defined as that breakage occurring above the ground.

- F. Standby time at the request of the client (limited to eight (8) hours per day): \$175.00 per hour with crew; \$125.00 per hour without crew.
- G. Drilling supplies (i.e. bits, additives, mud, etc.): No charge.
- H. Hole plugging supplies (i.e. hole plugs, cement, etc.): At cost plus 15%.
- I. Water supply to be furnished by client.
- J. Water truck rental: The water truck with this track rig is also a track support vehicle. It will be used to transport fuel and personnel as well as water from the "end of road" to drill site. Rate for this will be \$100.00 per hour from "start up" in the morning until it arrives at the drill rig. While the drill rig is running there will be no charge for the support vehicle. At the end of the day when the drill rig shuts down there will again be the \$100.00 charge per hour to run back out to "end of road".
- K. Per Diem for personnel listed under "I" above: \$35.00 per man per day.
- L. Miscellaneous: Casing lost or left in hole at client's request is cost plus 15%.

In the event that this Quotation is accepted, this sheet will become part of our Drilling Services Contract, as Schedule "D".



HACKWORTH DRILLING, INC.

RECEIVED MAR 12 1992

March 10, 1992

Mr. Michael R. Winston
Reynolds Metals Exploration, Inc.
5301 Longley Lane #157
Reno, NV 89511-1805

Dear Mike,

I enjoyed talking with you and Ray last week when I was in Reno. I appreciate the opportunity of bidding on your upcoming drilling project near Bullhead City, Arizona.

I have enclosed a Footage bid for a tire mounted TH-60 drill rig with a sliding angle mast for drilling angle holes and a Footage bid for a track rig.

Both of the rigs use a three-man crew consisting of one driller and two helpers. The helpers will be happy to split and bag the sample as per your instructions. With the track rig we have both track and tire mounted water vehicles available.

If you have any questions please give me a call at 702-738-9891.

Sincerely,

Dale C. Veden
Drill Supervisor

DCV:gs

*AZ Dale Veden
Permit # 391 well driller l.z.
Contractors l.z. # 082012-008
A-DA*

Track

HACKWORTH DRILLING, INC.
QUOTATION/CONTRACT NO.

#710-RFTA

DATE: March 10, 1992

FOOTAGE COMPENSATION SCHEDULE
(Track-Mounted Drill Rig)

I. INFORMATION RELATIVE TO JOB:

Location of Job: West Oatman Project near Bullhead City. Arizona

Starting Date: Late April, 1992

Minimum Guaranteed Footage: About 7,000 ft.

Maximum Depth: 600 ft.

No. and Type of Drill Rig: One Schramm C-560

Drill Crew Provided: One driller and two helpers

Access to Jobsite: Fair No. of Holes: 19

Angle (degree at top of casing): Vertical to 45°

II. SCHEDULE OF RATES:

A. Mobilization and demobilization: Lump Sum \$2,500.00

B. Travel time in excess of one (1) hour per day from the nearest available source of accomodation and fuel supply is chargeable at: No charge.

C. Footage rate calculated from the surface of the bore hole to the depth penetrated by the drill bit would be: 0 ft. to 600 ft. at \$6.00.

The footage rate includes, on a per hole basis, the first one (1) hour of time that may be consumed in setting the surface casing, moving between holes, reaming, hole stabilization, etc. Time in excess of one (1) hour for each hole would be chargeable at the hourly rate of: \$215.00.

D. Plugging of holes in accordance with Arizona laws, commencing with the first one (1) hour will be chargeable at the hourly rate of: \$175.00.

E. No charges for down time would apply for the time consumed servicing and/or repairing contractor supplied equipment. Breakdown is defined as that breakage occurring above the ground.

- F. Standby time at the request of the client (limited to eight (8) hours per day): \$175.00 per hour with crew; \$125.00 per hour without crew.
- G. Drilling supplies (i.e. bits, additives, mud, etc.): No charge.
- H. Hole plugging supplies (i.e. hole plugs, cement, etc.): At cost plus 15%.
- I. Water supply to be furnished by client.
- J. Water truck rental: The water truck with this track rig is also a track support vehicle. It will be used to transport fuel and personnel as well as water from the "end of road" to drill site. Rate for this will be \$100.00 per hour from "start up" in the morning until it arrives at the drill rig. While the drill rig is running there will be no charge for the support vehicle. At the end of the day when the drill rig shuts down there will again be the \$100.00 charge per hour to run back out to "end of road".
- K. Per Diem for personnel listed under "I" above: \$35.00 per man per day.
- L. Miscellaneous: Casing lost or left in hole at client's request is cost plus 15%.

In the event that this Quotation is accepted, this sheet will become part of our Drilling Services Contract, as Schedule "D".

Track

HACKWORTH DRILLING, INC.
QUOTATION/CONTRACT NO.

#710-RFA

DATE March 10, 1992

FOOTAGE COMPENSATION SCHEDULE

I. INFORMATION RELATIVE TO JOB:

Location of Job: Near Bullhead City, Arizona (West Oatman Project)

Starting Date: Late April, 1992

Minimum Guaranteed Footage: About 7,000 ft.

Maximum Depth: 600 ft. No. of Holes: 19

No. and Type of Drill Rig(s): 1 Ingersoll-Rand TH-60 reverse circulation
Drill Crew Provided: One driller and two helpers (with angle capabilities)

Access to Jobsite: Fair

Angle (degree at top of casing): Vertical to 45°

II. SCHEDULE OF RATES:

A. Mobilization and demobilization: \$500.00 Lump Sum

B. Travel time in excess of one (1) hour per day from the nearest available source of accomodation and fuel supply is chargeable at: No charge

C. Footage rate calculated from the surface of the bore hole to the depth penetrated by the drill bit would be charged at: 0 ft. - 600 ft. at \$5.00

The footage rate includes, on a per hole basis, the first one (1) hour of time that may be consumed in setting the surface casing, moving between holes, reaming, hole stabilization, etc. Time in excess of one (1) hour for each hole would be charegeable at the hourly rate of: \$190.00

D. Plugging of holes in accordance with Arizona laws, commencing with the first one (1) hour will be chargeable at the hourly rate of: \$150.00

E. No charges for down time would apply for the time consumed servicing and/or repairing contractor supplied equipment. Breakdown is defined as that breakage occurring above the ground.

- F. Standby time at the request of the client (limited to eight (8) hours per day): \$150.00 per hour with crew; \$100.00 per hour without crew.
- G. Drilling supplies (i.e. bits, additives, dust rubbers, etc.): No charge.
- H. Hole plugging supplies (i.e. hole plugs, cement, etc.): At cost plus 15%.
- I. Water supply to be furnished by client; if water haul is required, water truck rental will be charged at: No charge.
- J. Per Diem for personnel listed under "I" above: \$35.00 per man per day.
- K. Miscellaneous: Casing lost or left in hole at clients request is at cost plus 15%.

In the event that this Quotation is accepted, this sheet will become part of our Drilling Services Contract, as Schedule "D".

RECEIVED FEB 3 1992

BROWN DRILLING, INC.
4559 N. CASTLEROCK
KINGMAN, ARIZONA 86401
EUGENE BROWN (602) 753-6933
DAVE BROWN (602) 753-7687
(800) 448-8759

Attention Project Manager:

We appreciate the opportunity to bid your drilling projects, either conventional, reverse circulation and angle drilling. We have experience in all types of drilling. Enclosed are some specific project references. These references are only those related to your project drilling needs.

There are three officers in our company who each have at least fifteen years experience. We feel that being a small company, we can maintain better control of the on-site work.

We take pride in our work and would appreciate the opportunity to be of service.

Thank you for considering our company.

Sincerely,



Eugene Brown
President

Encls:

800-900 \$ for Asarco
rated at 1000'

REFERENCES

FISCHER WATT GOLD
BUD HILLEMAYER
114 TUCKER #7
KINGMAN, AZ. 86401
(602) 753-1622

WESTERN STATES MINERALS
TOM VEHR
4975 VAN GORDON
WHEATRIDGE, CO 80033
(303) 425-7042

AMERICAN COPPER AND NICKEL
MEL LAHR
#24 GLEN CARRAN CIRCLE
SPARKS, NV 89431
(702) 331-7331

ASARCO
ED JOHN
P.O. BOX 8
HAYDEN, AZ 85235
(602) 363-5531

ALMA AMERICAN MINING CORP.
CHARLIE SPEILMAN
P.O. BOX 479
FAIRPLAY, CO 80440
(719) 836-2242

ECHO BAY EXPLORATION
CASEY DANIELSON
370 17TH ST. SUITE 4050
DENVER, CO 80202
(303) 592-5450

TOLTEC RESOURCES
R. J. MCNEIL
650 W. GEORGIA SUITE 480
VANCOUVER B.C. V6B-4N9

AMERICAN GOLD RESOURCES
MAC McELDOWNNEY
134 UNION BLVD. STE 600
LAKEWOOD, CO 80228

GLAMIS (CHEM GOLD)
ROGER STEINEGER
715 GREGG ST.
RENO, NEVADA 89502
(702) 356-1030

BATTLE MOUNTAIN GOLD
BOB METZ
2700 E. EXECUTIVE DR.
SUITE 150
TUCSON, AZ 85106
(602) 741-2807

GEXA GOLD CORP.
1015 TELEGRAPH
RENO, NV 89510-0877
(702) 786-7667

ATLAS PRECIOUS METALS
JIM NEWMAN
395 FREEPORT BLVD.
STE 12
SPARKS, NV 89431

NERCO EXPLORATION
PAUL HARTLY
8100 N.E. PARKWAY DR.
VANCOUVER, WA 98688
(206) 892-1148

PRIME EQUITY
PETER LOUGHEED
10TH FLOOR
808 W. HASTINGS
VANCOUVER B.C.
V6C-2X4
(604) 687-7463

WESTLAND MINERALS
RANDY MARTIN
410 17TH ST. STE 2450
DENVER, CO 80202

BUTTES RESOURCES
BOB NORMAN
P.O. BOX 1300
MOAB, UT 84532

LIST OF EQUIPMENT

FIVE DRILL RIGS SET UP FOR REVERSE CIRCULATION AND ANGLE CAPABILITY

- (2) 650 CHICAGO PNEUMATIC'S
- (2) 670 CHICAGO PNEUMATIC'S
- W-650 CHICAGO PNEUMATIC

- (2) ALL WHEEL DRIVE WATER TRUCKS
- (1) THREE THOUSAND GALLON WATER TRUCK
- (2) FLATBED WATER TRUCKS

COLLECTORS AND GILSON SPLITTERS ON EACH RIG
SILVER-DRILL HAMMER OR TRI-CONE DRILLING

The rates vary depending on the amount of work and if it is the busy part of the year. We would also be glad to bid on a footage basis. The following are general hourly rates:

- \$ 150.00/HR ... CONVENTIONAL
- \$ 200.00/HR ... REVERSE CIRCULATION
- \$ 220.00/HR ... ANGLE REVERSE CIRCULATION

RECEIVED MAR 9 1992

BROWN DRILLING
4559 N. CASTLEROCK
KINGMAN, ARIZONA 86401
(602) 757-1920
(800) 448-8759

MARCH 4, 1992

CUSTOMER:
REYNOLDS METALS EXPLORATION, INC.
5301 LONGLEY LANE SUITE 157
RENO, NV 89511-1805

ATTN: MICHAEL R. WINSTON

BID PROPOSAL FOR DRILLING NEAR WEST OATMAN, ARIZONA

EQUIPMENT TO BE USED:

- 1.) 670 or 650 Chicago Pnuematic Drill Rig
- 2.) 500 of Reverse Circulation Pipe
- 3.) Water Truck (If needed)
- 4.) Collector and Gilson Splitter
- 5.) Revolving Wet Splitter

FOOTAGE RATES:

Vertical Footage Rate:	\$.00 Per Foot
Angle Footage Rate:	\$ 6.50 Per Foot
Standby Rate:	\$ 150.00 Per Hour
Casing and Conditioning Hole:	\$ 200.00 Per Hour
Long moves after one hour:	\$ 150.00 Per Hour
Mobilization:	\$ NO CHARGE
Materials:	\$ Cost Plus 10%
Plug Drill Holes	\$ 150.00 Per Hour

Thank you,
Gene Brown
Gene Brown



MODERN INTERNATIONAL INC.
EXPLORATION DRILLING

BUS. (702) 738-4300
RES. (702) 738-6121
FAX (702) 753-7010

March 2, 1992

Reynolds Metals Exploration, Inc.
5301 Longley Lane, Suite 157
Reno, NV. 89511-1805

ATTN: Michael R. Winston

Project Bid: West Oatman

I would like to thank you for giving us the opportunity to quote the following footage prices. All bids dependant on rig availability.

FOOTAGE RATE:

Drill: Drill Systems MPD 1000 track rig.
750/350 Air Compressor.
Reverse circulation.
Ability to carry 750 feet of pipe on drill.
Hammer or rock bit drilling.

Depth & Cost: Vertical holes 0-500ft \$7.25/ft.
Angle holes 45 degree maximum. 0-500ft \$7.50/ft.
Holes deeper than 500ft the hourly contract will apply until all drill steel is out of the ground.

Angle: Holes from eight degrees to forty-four degrees will be by the hour. The hourly contract will apply.
Standard hole size is 4 3/4 inch.

Sampling Equipment: A 3 foot diameter cyclone attached with a swing arm to drill.
Dry samples- A Gilson splitter and pans.
Wet samples- A Rotating splitter with adjustable intake and "Y" separation on outlet. Specially designed to set up on any terrain or slope. Contractor will collect and bag samples to your specifications.

Support Equipment: A four wheel drive water truck with 1,100 gallon capacity.
A four wheel drive service truck for crew and fuel transportation.
A four wheel drive articulating water truck if needed for those sensitive and hard to get to areas. This is at no extra cost except for mobilization and demobilization.
(If available.)

FOOTAGE:

Crew: Experienced three man crew- Driller, Helper, and Sampler.

Standby: \$175.00 per hour if drill is shut down at your request. Weather can not be controlled, therefore no standby will be charged unless crews are shut down after driving to job.

Per Diem: A charge of \$35 per day per man for each night the men are required to be away from home.

Trucking: Mobilization and demobilization for drill or support equipment will be per trucking company invoice. You may chose company to be used.

Booster Compressor: If needed will be at \$65.00 per hour during use.

Cost: Rock bit drilling- the hourly contract will apply until all steel is out of the hole. Water hauls exceeding more than one hour will be charged by the hour. Moving between holes exceeding one half hour will be charged by the hour. If more than 6ft of casing is used the time spent will be by the hour. Casing lost or damaged will be billed at cost. Plugging holes or stopping water flows will be charged by the hour. Walking drill from lowboy to first hole and from last hole to lowboy will be charged by the hour.

Damaged or lost drill steel: Contractor will bear the cost of lost tools except when in the opinion of the driller, the hole conditions are extremely dangerous. If the driller notifies your representative of the danger of losing drill pipe and tools and your representative directs the driller to continue, then the drill pipe and tools lost will be billed to you at replacement cost.

Lost circulation: In the event of lost circulation or hole conditioning, the contractor will attempt to recover circulation for the first two hours at contractors expense. If circulation is not recovered and you desire to continue the hole, then an hourly rate of \$230 per hour plus materials will be charged until completion of hole and steel is out of the hole.

Hole Abandonment: Done in accordance with state regulations by the hour plus materials.

FOOTAGE:

Access: Site Selection, preparation, right of way to water and drill will be your responsibility.

Damaged or lost pipe: Due to bad formations will be billed to you at replacement cost.

Insurance: Contractor will submit all certificate requirements.

Down time: No charge for servicing and /or repairing equipment.

Invoices are due and payable within (30) Thirty days upon receipt.

Thank You,

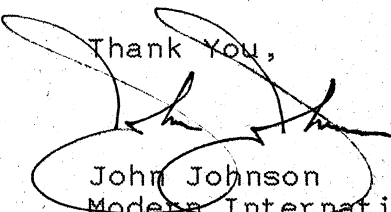

John Johnson
Modern International Inc.

JJ/tp



MODERN INTERNATIONAL INC.
EXPLORATION DRILLING

BUS. (702) 738-4300
RES. (702) 738-6121
FAX (702) 753-7010

March 2, 1992

Reynolds Metals Explorations, Inc.
5301 Longley Lane Suite 157
Reno, NV. 89511-1805

ATTN: Michael R. Winston

Projects Bid: West Oatman

I would like to thank you for giving us the opportunity to quote the following hourly prices. All bids dependant on rig availability.

HOURLY RATE:

Drill: Drill Systems MPD 1000 track rig.
750/350 Air Compressor.
Reverse circulation.
Ability to carry 750 feet of pipe on drill.
Hammer or rock bit drilling.

Depth: We have drilled to 1,300 feet, at 10,000 foot elevation.
(Dependant on formations.) Standard hole size is 4 3/4 inch.

Angle: Holes to any depth and any angle eight degrees to ninty degrees.

Sampling Equipment: A 3 foot diameter cyclone attached with a swing arm to drill.
Dry samples- A Gilson splitter with pans.
Wet samples- A Rotating splitter with adjustable intake and "Y" separation on outlet.
Specially designed to set up on any terrain or slope. Contractor will collect and bag samples to your specifications.

Support Equipment: A four wheel drive water truck with 1,100 gallon capacity.
A four wheel drive service truck for crew and fuel transportation.
A four wheel drive articulating water truck if needed for those sensitive and hard to get to areas. This is at no extra cost except for mobilization and demobilization. (If available)

Crew: Experienced three man crew- Driller, Helper, and Sampler.

HOURLY:

Standby: \$175.00 if drill is shut down at your request. Weather can not be controlled, therefor no standby will be charged unless crews are shut down after driving to drill.

Per Diem: A charge of \$35 per day per man for each night the men are required to be away from home.

Trucking: Mobilization and demobilization for drill or support equipment will be per trucking company invoice. You may chose company to be used.

Booster Compressor: If needed will be at \$65.00 per hour during use.

Cost: \$230.00 per hour for any time spent pertaining to completion of drill holes and project. Materials and supplies used in the hole will be billed to you at my cost. This includes bits, casing, cement, drilling mud and additives, deflector rubbers, detergents, and any other materials used.

Hole Abandonment: Done in accordance with state regulations by the hour plus materials.

Access: Site Selection, preparation, right of way to water and drill sites will be your responsibility.

Damaged or lost pipe: Due to bad formations will be billed to you at replacement cost.

Insurance: Contractor will submit all certificates and requirements.

Other Charges:	Drilling supplies.....	At cost
	Casing hole.....	230/hr. + materials
	Plugging.....	230/hr. + materials
	Reaming.....	230/hr. + materials
	Hole conditioning.....	230/hr. + materials
	Cementing.....	230/hr. + materials
	Moving between holes.....	230/hr.
	Down hole equipment retrival..	230/hr.

Down time: No charge for servicing and /or repairing equipment.

Invoices are due and payable within (30) Thirty days upon receipt.

Thank You,

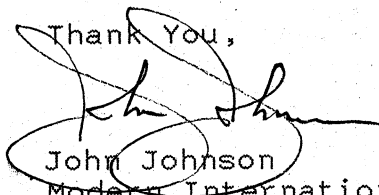

John Johnson
Modern International Inc.

JJ/tp

RECEIVED MAR 12 1992

LANG EXPLORATORY DRILLING

A DIVISION OF **Longyear**

2286 WEST 1500 SOUTH • SALT LAKE CITY, UTAH 84104-4126 • 801-973-6667
FAX 801-972-2994

DUAL TUBE DRILLING QUOTATION

BETWEEN

Lang Exploratory Drilling
a Division of Longyear Company
and

Reynolds Metals Exploration, Inc.

5301 Longley Lane, Suite 157

Reno, Nevada, 89511-1805

Office (702)829-8018 Fax (702)829-8026

This QUOTATION made and entered into this 9th day of March, 1992, by and between Lang Exploratory Drilling and Reynolds Metals Exploration, Inc. Attention: Michael R. Winston, hereinafter called Lang and Client.

WITNESSETH: That

I. In consideration of certain payments hereby agreed to be made by Client to Lang: Lang agrees to drill with drilling equipment for the West Oatman Project, in the State of Arizona, approximately 20 holes, 500 feet each, 10,000 feet total. Hole depth will not exceed 600 feet. Estimated project start up date to be arranged and agreed on by both parties.

PROPERTY LOCATION: 8 miles East of Bullhead City, Arizona, (Mohave County).

MOBILIZATION AND DEMOBILIZATION:

Mobilization - \$2,000.00

Demobilization - \$2,000.00

DRILL RIG TO BE PROVIDED FOR PROJECT:

Driltech D40 K: 62,000 lbs. gross weight, mast height 35 feet, 50,000 lbs. pullback, 850 cfm at 350 psi, rig length 18 feet 6 inches. Angle capabilities 45 to 90 degrees. Maximum depth 1,500 feet. Drill steel diameter 4-1/2 inches.

Crane Truck: Lang crane support truck is tandem axle, flat bed mounted on a crane carrier chassis. This unit is equipped with a 2,000 gallon vertical water tank, drill rod storage and 15,000 lb. hydraulic crane.

Crew Support: One ton GMC 4x4 with 200 gallon diesel capabilities.

Lang "Dog House": Hoses, fittings, everything needed for equipment consistency (approximately \$75,000).

DRILL CREW: Three man crew; driller, two helpers.

SUBSISTENCE: \$25.00 per man per day.

FOOTAGE RATES:

0 - 500 feet at \$7.50 per foot.

501 - 800 feet at \$8.75 per foot.

Above rates include angle and vertical drilling. Hammer bits included.

HOURLY RATE:

\$185.00 per hour. All activities involved in setting and pulling of casing, conditioning holes, rigging up and rigging down, moving between holes, hole abandonment, etc.) except breakdown time of Lang equipment.

The previously listed prices are based on Lang having the option to work 12 rig hours per day. Any schedule changes must be approved by the Lang office and Client or will be charged at the "standby with crew" rate.

JOY BOOSTER:

Lang will provide a 1000 psi booster at \$65.00 operating and \$30.00 standby, plus mobilization.

SULLAIR COMPRESSOR:

Lang will provide a 900 cfm - 350 psi compressor at \$65.00 operating and \$30.00 standby, plus mobilization.

STANDBY:

Standby rate \$225.00 per hour with or without crew for the benefit of the Client during the drill shift.

TRAVEL:

Travel time to and from job site: No charge first one (1) hour. Any additional travel time after the first one hour will be charged at: No charge.

SAMPLES:

Lang will collect and bag samples upon Client's request at N/C. (This does not include transportation of samples, nor sample containers. A third man will be supplied to assist with sample collection and rig work at N/C.)

Client must notify Lang at least one week prior to project mobilization as to their decision regarding the collection and bagging of samples.

DRILLING MATERIALS:

Drilling Materials: Cost + 15% - charged for swabs, tricone bits, casing, cement, drilling fluids and additives, detergents, plugging material and any other material used in the drill hole.

Water Hauls: First 60 minutes no charge, thereafter at \$65.00 per hour.

Splitters Supplied: Rotating Wet Splitter, Gilson Dry Splitter, Jones Three Tier. We will provide upon your request what is needed.

LIABILITY:

Lang shall drill at the locations and to the depths specified by the representative of Client and shall be held harmless for all liability which may arise from normal activity related to this contract, including pollution of ground water or surrounding land from discharge of drill water and wastes. Lang agrees to accept responsibility for the irresponsible acts of its employees and for the liability which may result from these acts.

LOSS OF TOOLS:

Loss of tools due to driller's error shall be paid for by Lang. However, loss of tools due to bad formation shall be paid for by Client. Repair of equipment damaged directly by insufficient road work will be paid for by Client.

INVOICES:

Lang will invoice at the end of each calendar week for the work done during such period and the terms will be NET due within 30 days of receipt.

LICENSES & PERMITS:

Lang certifies it has a license to do contract work in the State of Arizona. All other licenses, land and water use permits, environmental reports, state reports relating to hole plugging, etc. shall be the responsibility of Client. Lang shall cooperate with and give technical assistance for Client's compliance with these regulations.

III. Client will furnish a competent representative to advise Lang as to the desired locations and depths of the different holes.

IV. Lang shall maintain such insurance as will protect it from claims under workmen's compensation acts and from any other claims for damages for personal injury, including death, which may arise from operations under this contract, whether such operations are by Lang or any subcontractor or anyone directly or indirectly employed by either of them.

Prior to commencement of this work, Lang shall file with Client complete certificates of insurance in the form of an insurance certificate for Lang and each subcontractor. Lang and each subcontractor shall provide insurance coverage in satisfactory amounts.

V. Lang shall fully save harmless and indemnify Client against any expense, loss or damage on account of any claim, demand, or suit made by any person

whomsoever, including any employee of Client, which is in any way connected with, grows out of or has anything to do with the execution and performance of this contract on the part of Lang or any subcontractor and agrees that Client shall not be liable for any injury, or other loss or damage of any nature, that might be sustained by Lang itself or its employees in the execution and performance of this contract, unless such injury, loss or damage is caused solely by willful fault or negligence on the part of Client or its employees. Lang accepts all responsibility for any claims for damages whatsoever resulting from the use, misuse or failure of any hoist, rigging, locking, scaffolding, or other equipment used by Lang or any of its subcontractors.

VI. The drilling operations shall be carried out in a good and workmanlike manner, and Lang will make every reasonable effort to execute the drilling in the best interest of Client.

Lang will take necessary precautions to prevent gas and oil spillage which might create a pollution problem.

VII. This proposal is contingent on availability of rigs at the time of contract award.

VIII. Either party may terminate performance of work under this Contract if it is in their best interest. Any termination must be in writing giving not less than 10 days notice.

IN WITNESS WHEREOF, the parties hereto have set their hands and seals.

REYNOLDS METALS
EXPLORATION, INC.

BY _____

LANG EXPLORATORY DRILLING
a Division of Longyear Company

BY _____

JEFF GREEN

Contract Representative

Mr.

Pat Harris

Harris Exploration Drilling and Associates Inc.

P.O. Box 1573

Escondido, CA 92033

(619) 741-8890

Randy Mayer

Mr. ~~Jeff Green~~

Lang Exploratory Drilling

2286 West 1500 South

Salt Lake City, UT 84104

(801) 973-6667

Mr. John Johnson

Modern International Inc. ~~Exploration Drilling~~

P.O. Box 1828

ELKO, NV 89801

(702) 738-4300

Mr. Eugene Brown

Brown Drilling

~~3595 E. Gordon Drive~~ 4559 N. Castle Rock

Kingman, AZ 86401

(602) ~~152~~ - ~~1920~~ 753-6933

(800) 448-8759

Mr. Dale Veden

Hackworth Drilling Inc.

5019 Manzanita Dr.

P.O. Box 850

ELKO NV 89801

(702) 738-9891

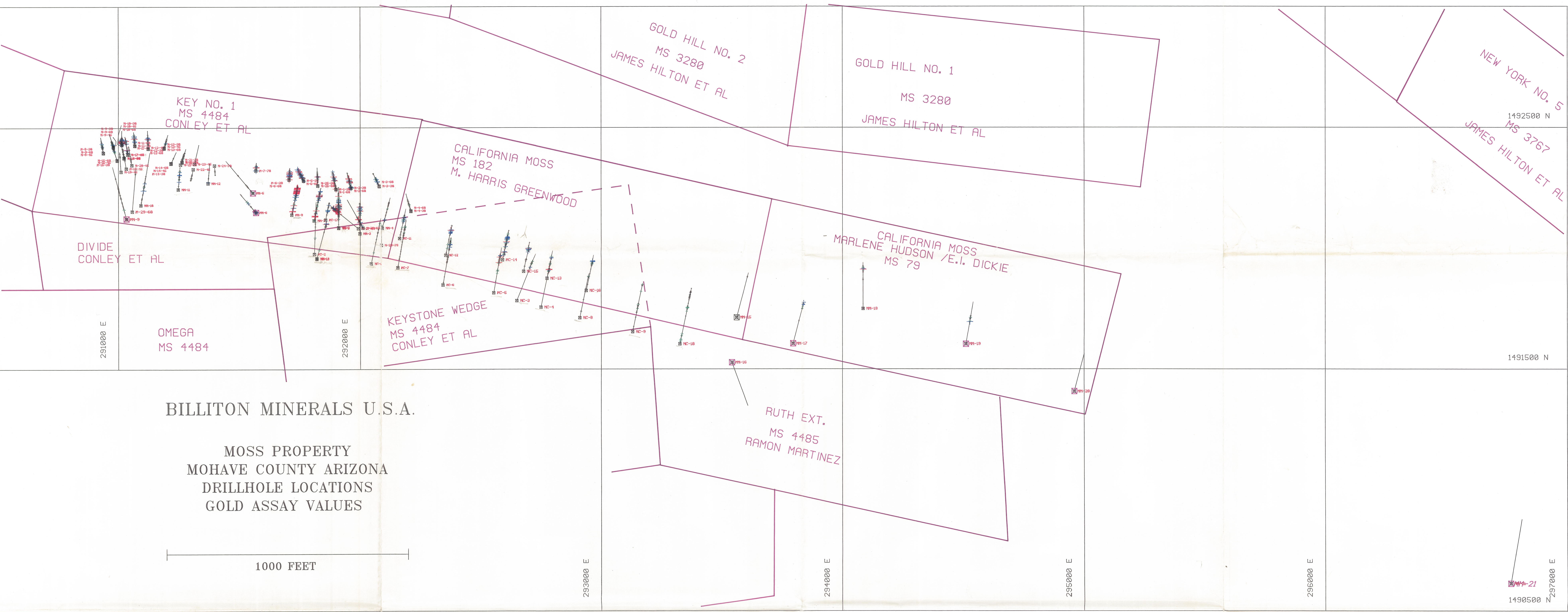

BILLITON MINERALS U.S.A.

MOSS PROPERTY
 MOHAVE COUNTY ARIZONA
 DRILLHOLE LOCATIONS
 GOLD ASSAY VALUES

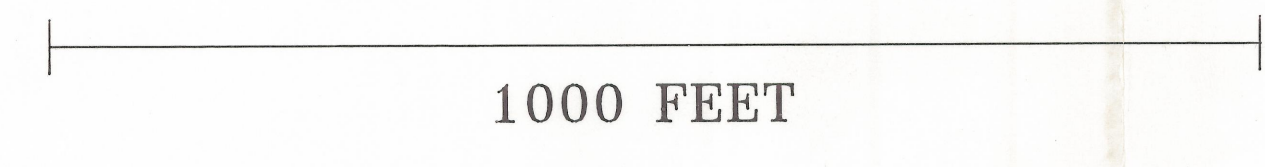

1490500 N
 297000 E
 21