

CONTACT INFORMATION
Mining Records Curator
Arizona Geological Survey
416 W. Congress St., Suite 100
Tucson, Arizona 85701
520-770-3500
<http://www.azgs.az.gov>
inquiries@azgs.az.gov

The following file is part of the
James Doyle Sell Mining Collection

ACCESS STATEMENT

These digitized collections are accessible for purposes of education and research. We have indicated what we know about copyright and rights of privacy, publicity, or trademark. Due to the nature of archival collections, we are not always able to identify this information. We are eager to hear from any rights owners, so that we may obtain accurate information. Upon request, we will remove material from public view while we address a rights issue.

CONSTRAINTS STATEMENT

The Arizona Geological Survey does not claim to control all rights for all materials in its collection. These rights include, but are not limited to: copyright, privacy rights, and cultural protection rights. The User hereby assumes all responsibility for obtaining any rights to use the material in excess of "fair use."

The Survey makes no intellectual property claims to the products created by individual authors in the manuscript collections, except when the author deeded those rights to the Survey or when those authors were employed by the State of Arizona and created intellectual products as a function of their official duties. The Survey does maintain property rights to the physical and digital representations of the works.

QUALITY STATEMENT

The Arizona Geological Survey is not responsible for the accuracy of the records, information, or opinions that may be contained in the files. The Survey collects, catalogs, and archives data on mineral properties regardless of its views of the veracity or accuracy of those data.

SCAN SEPARATOR



0048

↕ Compass Minerals, Ltd.

Mical N. Slater, President • 5301 Longley Lane, Suite A-1 • Reno, Nevada 89502 • Telephone (702) 825-1135 Telecopy (702) 825-3005

September 9, 1992

JDS

Mr. James D. Sell
Manager-Southwest Division
P.O. Box 5747
Tucson, AZ 85703

Dear Jim:

I tried to call you yesterday, but I guess you were out pounding on rocks in the hot sun.

Our company has put together a large land package (+300 claims) in the Oatman district. With the recent demise of our JV partners—Reynolds Metals, we need some help in evaluating these claims. Reynolds left the project (and the western states) immediately after drilling 45' @ 0.075 opt gold. We feel that the property warrants follow-up. If you would like to see the data package, please sign the enclosed Confidentiality Agreement and return a copy to the above address. I'll send that package off to you.

Thank you for your attention to this matter.

Kind regards,

Mical
Mical N. Slater

Enclosure:

file

Moss Mine Area, Oatman Dist

We decided not to pursue - after Billston's work

ASARCO Incorporated

SEP 11 1992

SW Exploration

CONFIDENTIALITY AGREEMENT

In consideration for receiving certain maps, reports and data pertaining to the Oatman Property, which is shown on attached Exhibit A, for evaluation to determine our interest in acquiring the Property from Compass Minerals Ltd. (CML), located at 5301 Longley Lane, Suite A-1, Reno, Nevada 89511, we, _____ located at _____ agree to the following:

1. All Information provided by CML that is not otherwise available in our files or in the public domain, will be held confidential for one year from the date of this agreement. This Information will be released only to those individuals responsible for evaluating the merits of the Property.

2. No claims will be located, nor any mineral interests otherwise obtained, within a one mile boundary of the Property for a one year period from the date of this agreement without the written permission of CML. Mineral interests that have already been acquired or that are being acquired by current negotiations, are excluded from this provision.

3. All information provided to our company in connection with our evaluation of the Property will be returned to CML within 30 days of our decision not to acquire the Property or of written notification from CML that the Property is no longer available.

4. Copies of all factual data, including sample locations and analytical results, we generate during our evaluation of the property will be provided at no charge to CML within 30 days of our decision not to acquire the Property.

5. Our company shall release and hold CML harmless from any claims arising from any incompleteness of and inaccuracies in the Information and from any interpretation of the Information, and CML shall have no responsibility for our reliance on such Information.

Presented by:

Compass Minerals Ltd.
5301 Longley Lane #A-1
Reno, Nevada 89511

Mical N. Slater, President

Accepted and signed on behalf of:

By: _____

Title: _____

Date: _____

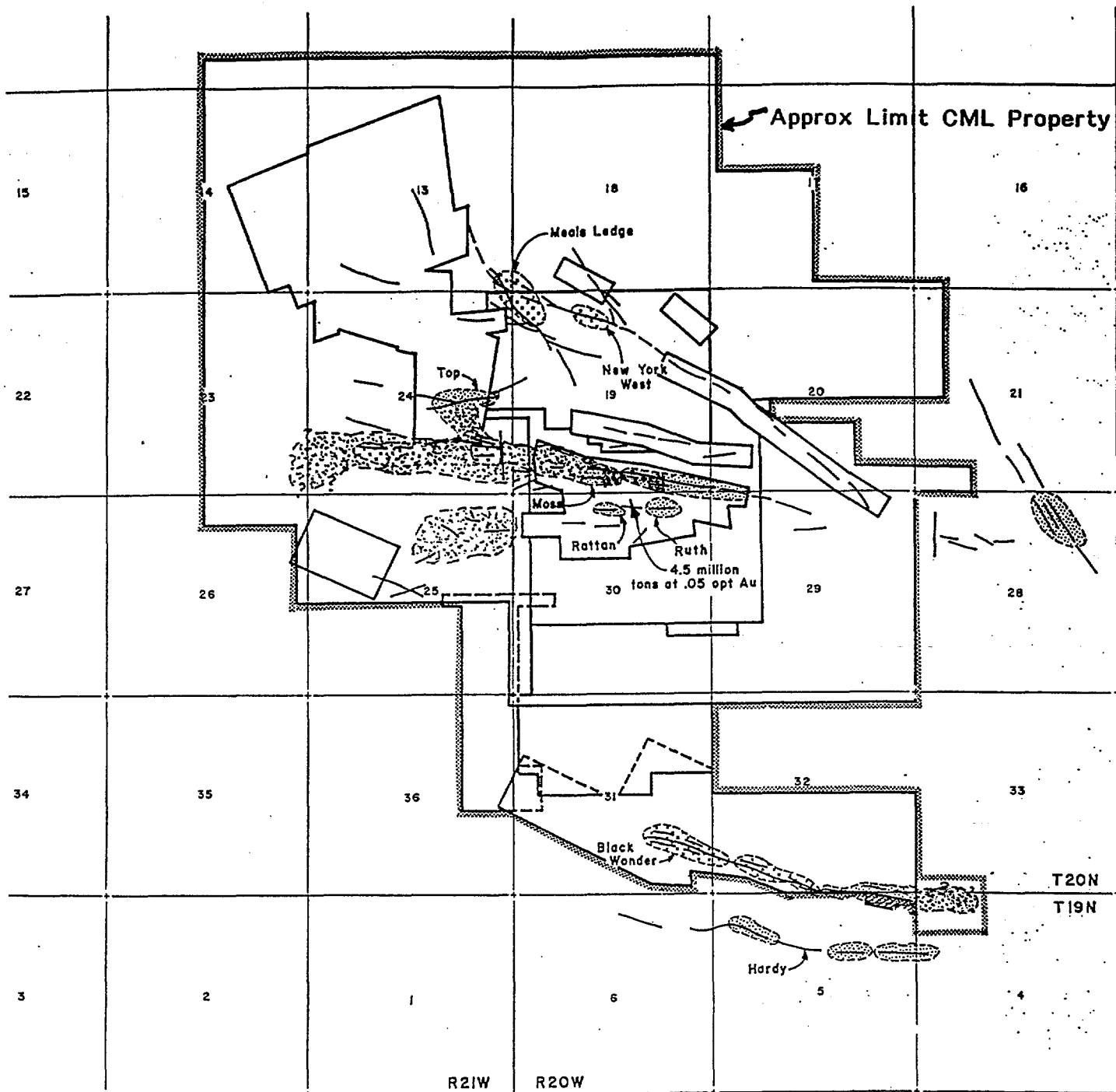

EXHIBIT A

- ☐ AL and ALX Claims, formerly held by Reynolds.
- ☐ FB Claims, leased by Reynolds.
- ☐ Gregory Gintoff
- ☐ RAL, PEN, and SNOW Claims controlled by Reynolds.
- ☐ Black Wonder.
- ☐ Third party claims (hatched indicates under negotiation).



Potential target areas
where tested

----- Quartz vein - stockwork zone

REYNOLDS METALS EXPLORATION, INC. 5301 Longley Lane - Suite 157 • Reno, Nevada 89511 A Consolidated Subsidiary - Reynolds Metals Co.			
T. 19, 20 N., R. 20, 21 W. WEST OATMAN MOHAVE COUNTY, ARIZONA			
LAND STATUS & TARGET MAP			
AUTHOR: REI	DRAFTED BY: BW	DATE: 1/17/92	SCALE: 1" = 4000'
REVISIONS: 7/26/92		DRAWING NO.	

Oatman Dist FILE
Mohave Co AZ
Return to Sender

↕ Compass Minerals, Ltd.

Mical N. Slater, President • 5301 Longley Lane, Suite A-1 • Reno, Nevada 89502 • Telephone (702) 825-1135 Telecopy (702) 825-3005

September 14, 1992

Mr. James D. Sell
ASARCO Inc.
P.O. Box 5747
Tucson, AZ 85703

Packet returned
9/16/92
mek

JDS

Dear Jim:

Following is the data package relevant to the Confidentiality Agreement sent to you last week. Should ASARCO elect not to sign the C.A., please return this package at your convenience.

Thank you for your attention to this matter.

ASARCO Incorporated

SEP 16 1992

OATMAN PROJECT SUMMARY

SW Exploration

Compass Minerals Ltd. (CML) has assembled a large land block (+300 claims) in the Oatman District of Mohave County, Arizona. Most of this ground was held by a joint venture with Reynolds Metals Exploration, Inc. (RMEI) until August, 1992, when RMEI elected to terminate exploration in the western states. CML will regain total control of these claims by October, 1992, and we are seeking an aggressive mining company to collaborate with us in our efforts to detect and define a world class, bulk mineable gold deposit in this significant, yet under-explored gold district.

Past production at Oatman has totalled over 2.2 million ounces of gold from 3.8 million tons of ore. The principal producers of this gold were the Gold Road and Tom Reed veins.

Several areas within the CML land blocks reveal strong potential for lower grade, bulk mineable deposits. These are displayed schematically in figure 2 of the accompanying report. The most obvious target is the eastern extension of the Black Wonder vein system where that vein complex intersects the projections of the Gold Road and Tom Reed veins (Fig. 4--accompanying report) near the border the Township line between Townships 19 and 20 North (sections 4 and 33). Ore grade intercepts can be documented along the Black Wonder vein system, from the west, up to this large covered target area from CML/RMEI's most recent drilling campaign, completed in June, 1992.

Although the above target is the most obvious for follow-up, other areas to the north also have merit. These areas are characterized by auriferous quartz-stockwork veining along the western extension of, and south of the Moss vein system, where 4.5 million tons of

0.05 opt gold is known. LAC Minerals (USA) Inc., in a previous JV with CML, and more recently, RMEI, have conducted limited drilling along the Moss structure, with some ore grade intercepts, but this encouragement was not adequate to hold their interest. CML feels that these ore grade intercepts should be followed-up and that the large, intervening areas of completely untested stockwork veining, should be drilled.

Finally, a block of 50 claims was located by CML about seven miles south of our main block. These claims were staked over another showing of auriferous quartz-stockwork veining detected in float. Very little is known regarding this particular occurrence, except we feel confident that the float is near subcrop and that it is proximal to the detachment zone underlying the Oatman volcanic series, which should provide for ideal host rock preparation.

Should you wish to examine additional information, or more detailed maps of any of the areas summarized above, after reviewing the attached report, please contact me.

Kind regards,



Mical N. Slater

Enclosure:

WEST OATMAN PROJECT

1992 Summary Report

by

Michael R. Winston

Contract Geologist

for

Reynolds Metals Exploration, Inc.

August 14, 1992

March 14, 1987
MOHAVE COUNTY GOLD "RESERVES" - RESOURCES

****Mossback** (Crown Res./Sutton) 259 + 5 pat. claims (Ex-1200 HIMCO claims)
Brad Peek (Geol)

1-5 m.t. @ 0.07 opt Au (Ex-potential-disproved) Meridian (1982)

8 1982 RDH 3735' - Calc. \pm Qtz HW stockwork of Mossback vein

a few 5-10' intercepts of .X-1 ppm Au hit.

20 1984 RDH 5000', Sec. 16 hot spring (jar + alunite), NY +N vein

a few 0.0X ppm Au zones hit in v. strong dissem. py zones \pm "shales"

Have data maps-data-worth low priority recon. Moss Porphyry margin.

****Secret Pass/Tincup Mine** (Santa Fe/Pacific Mining) Fred Jenkins, Mgr. ABQ
Martin Steinpress, Geol. (\pm WSA)

90 DH, 6 areas, about \$1 million spent

74,000T @ 0.11 .02 c/o 5.6/1 w/o Tincup (op)

108,000T @ 0.053 .02 c/o 3/1 w/o FM area (op)

400,000T @ 0.07 .01 c/o NW Tincup UG "Geologic Resource"

including 92,000T @ 0.20 .10 c/o NW Tincup UG "Geologic Resource"

\pm 45,000 oz. total, \pm fair potential for additional UG Geol. Res. \pm op
mineral in vicinity, complex land situation (State + RR checkerboard,
Pat + Unpat. claims). Stockwork (not vein) mineraliz. in pE Gr + T

and - not detachment. Have data packet for detailed field review; SF
wants \pm \$200,000 buy out.

***Moss Mine** (Moss and Ruth veins) Production: 64T @ 280! opt Au (1864)

Total: 25-30,000 oz. Au to 1930's

200,000T @ 0.11 opt Au, 0.6 opt Ag to 300' level:

vn 40-60' wide

1940 Tonapah

Belmont

+

19,000T @ 0.29 Au + 1.4 Ag UG (300' level)

F.M. Stevens

400,000T @ 0.1 opt Potential

(Asarco)

90,000T @ 0.13 opt Au (op) Bill Faulstich drill data (F-W/WLK notes)

500,000T @ 0.06 opt includes above. Peter Drobeck 3/87. Harrison

Resources pouring shaft collar for retimbering main shaft 3/11/87.

****Gold Road:**

395,000T @ .245 opt Au diluted to 5'+15% = Mineable SAA/JRS

or 556,000T @ .24 opt Au +0.28 Ag 1942 USSR&M

plus 560,000T @ .21 opt Au inferred (Gold Road-Red Top) Sharon Steel

Tails: 20,000T @ .08 opt Au Drilled 1930's (80,000T remilled 1930's-'42)

\pm 1,000,000T @ .02-.03 opt Au - production records.

1,691,000T @ 0.34 opt Au - production

Sharon Steel (1987) feasibility study; maybe looking for partner--
turned down Echo Bay (1986).

***Oatman:** United Western \pm 200,000T @ 0.2 opt Au (vn) Fischer-Watt (Sun
River Au)

Tom Reed Tails 1.5 m.t. @ 0.025 opt Au

Vivian Area: \pm 100,000T @ 0.2-0.3 opt Au Sun River Gold Potential (UG)

or \pm 125,000T @ 0.25 opt Au Sun River Gold calc. from GCNL 2/12/87

Oro Fino Vn pot: 20,000T @ 0.3 opt Au Pete Drobeck 1987 Drilling (BX)

February 15, 1991

W.L. Kurtz

Moss Mine
Oatman District
Mohave County, AZ

As you have requested, I now put down in this memo why I was not "hot" on the Moss Mine, as was Fleetwood Koutz in his January 1991 Monthly Report.

Mr. Koutz stated:

"Res: 1.7 m.t. @ 0.06 opt Au (4/1 w/o) + 2-5 m.t. @ 0.02-0.03 of drill intercepts. Data analyzed and sent to SWED. Worth a generous bid soon!"

SWED received a packet from Fleet around 1/15/91 (the date P.G. Vikre wrote a memo to R.L. Brown concerning the Billiton Minerals review which includes the Moss Mine review by Fleet which was also dated 1/15/91).

At the time, I essentially agreed with Fleet that some 2 million tons of 0.06 opt gold with a 4/1 w/o ratio probably was outlined, and that lower grade material (± 0.02 opt gold) was widespread. As drill holes of zip to 0.02 opt gold flanked the "mineralized holes" along strike, I was not excited about the potential to increase the tonnage up to 5-10 million tons at an acceptable grade with the relatively high stripping ratio.

On 1/18/91, I passed the info to M.A. Miller with a request to "review the data carefully." Mr. Miller was pulled off for the Mexican file review and the Kelvin area sampling, and as a result, had not gotten to the material as of 2/15/91.

I have taken several days and reviewed the data, and hereby present another scenario.

As Koutz had included numerous 0.02-0.04 values, I broke out the assay values to exclude low-grade intervals which by themselves would not support mining to get down to the next interval of ore grade mineralization.

A case in point is drill hole MM-1.

<u>Fleet</u>	<u>Sell</u>
215': 135'-350' at 0.057 opt.	135'-200' at 0.028 opt
with: 135'-200' at 0.028 opt	200'-225' at 0.015 opt
and: 225'-350' at 0.080 opt	225'-290' at 0.132 opt
	290'-350' at 0.023 opt

With this breakdown, I did not consider Fleet's upper 135'-200' at 0.028 as being part of a mining scheme, nor the bottom part of his 0.080 intercept to make up the nice 215 foot intercept (at a 0.59/1 w/o ratio). My breakdown would be 225'-290' (65') at 0.132 opt gold at a 3.4/1 w/o ratio.

The remaining holes were also reviewed in this light.

Figure 1, Plan of drill holes with JDS intercept values.

Attachment A, Work Sections by F.R. Koutz.

Attachment B, Work Sections by J.D. Sell.

Table 1 is a tabulation of the sections and compares the results of FRK-JDS.

The bottom line is:

FRK: 1,694,760 tons at 0.058 opt gold, or 99,050 contained ounces of gold with a 4/1 w/o ratio.

JDS: 716,300 tons at 0.105 opt gold or 75,540 contained ounces of gold with a rough calculation of 11/1 w/o ratio.

Based on Fleet's reserve-grade-ounces and the potential of expanding at depth and only at the cost of a higher than 4/1 w/o ratio, only meager returns could be secured from the zone.

Thus, I would not take on the project except under very favorable land position (plus \$1 million due one landowner in 18 months), based on the optimistic contained ounces (100,000, FRK) and the high stripping to secure the thicker-better grade (0.1+) at depth.

As suggested in Figure 1, several unanswerable question remain.

- 1) Hole M-26 cut the zone near MM-3 (Section 1), but contained no values, though MM-3 had 50' - 0.069 opt.
- 2) Hole M-27 drilled between MM-3 and MM-1 & 2, returned a good intercept, as did MM-3 and 4.
- 3) Hole M-25 between M-1 and M-5 failed to intercept any values.
- 4) The holes M-10, -11, -12 suggest an ore shoot but the holes below failed to intercept such values except for the core hole (from site M-29) which cut much deeper and had 23.5 ft. of 0.283 opt. Holes M-29, MM-9 and MM-10, adjacent to the core hole, failed to cut any values.

Thus with limited tonnage (1 million), limited expansion (at depth), limited ounces (100,000) of contained gold, the property is not worth a generous bid in my opinion.

All file data from Godbe, Billiton, Homestake, etc. sent by F.R. Koutz is in the Moss Mine File, Tucson.

JDS:mek
Atts.

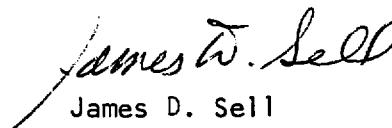
James D. Sell

cc: R.L. Brown, F.R. Koutz

MOSS MINE
Oatman District
Mohave County, AZ

Table 1. Sections/Block Evaluation

Section	Hole	F.R. Koutz		J.D. Sell	
		Tons	Grade	Tons	Grade
E.		outlined, no figures		zip, 2-5' bands of ± 0.05	
F.	M-5	71,040	@ 0.068	58,400	@ 0.079
	MM-8 upper	156,720	@ 0.062	42,500	@ 0.123
	MM-8 lower	262,800	@ 0.094	184,200	@ 0.117
G.	M-25 upper	35,720	@ 0.026	None	
	M-25 lower	50,160	@ 0.038	12,500	@ 0.070
	MM-7 upper)	380,000	@ 0.048	75,000	@ 0.110
	MM-7 lower)			70,000	@ 0.104
H.	M-1 upper	72,540	@ 0.052	27,500	@ 0.094
	MM-2 upper	82,260	@ 0.049	30,000	@ 0.092
	MM-1	223,020	@ 0.057	102,900	@ 0.132
I.	M-2	161,250	@ 0.049	38,300	@ 0.095
	MM-3	199,250	@ 0.052	75,000	@ 0.069
J.	MM-4	outlined, no figures		zip, 5' - 0.056	

		1,694,760 (@ 0.058)		716,300 (@ 0.105)	
		with 99,050 oz. Au		with 75,540 oz. Au	

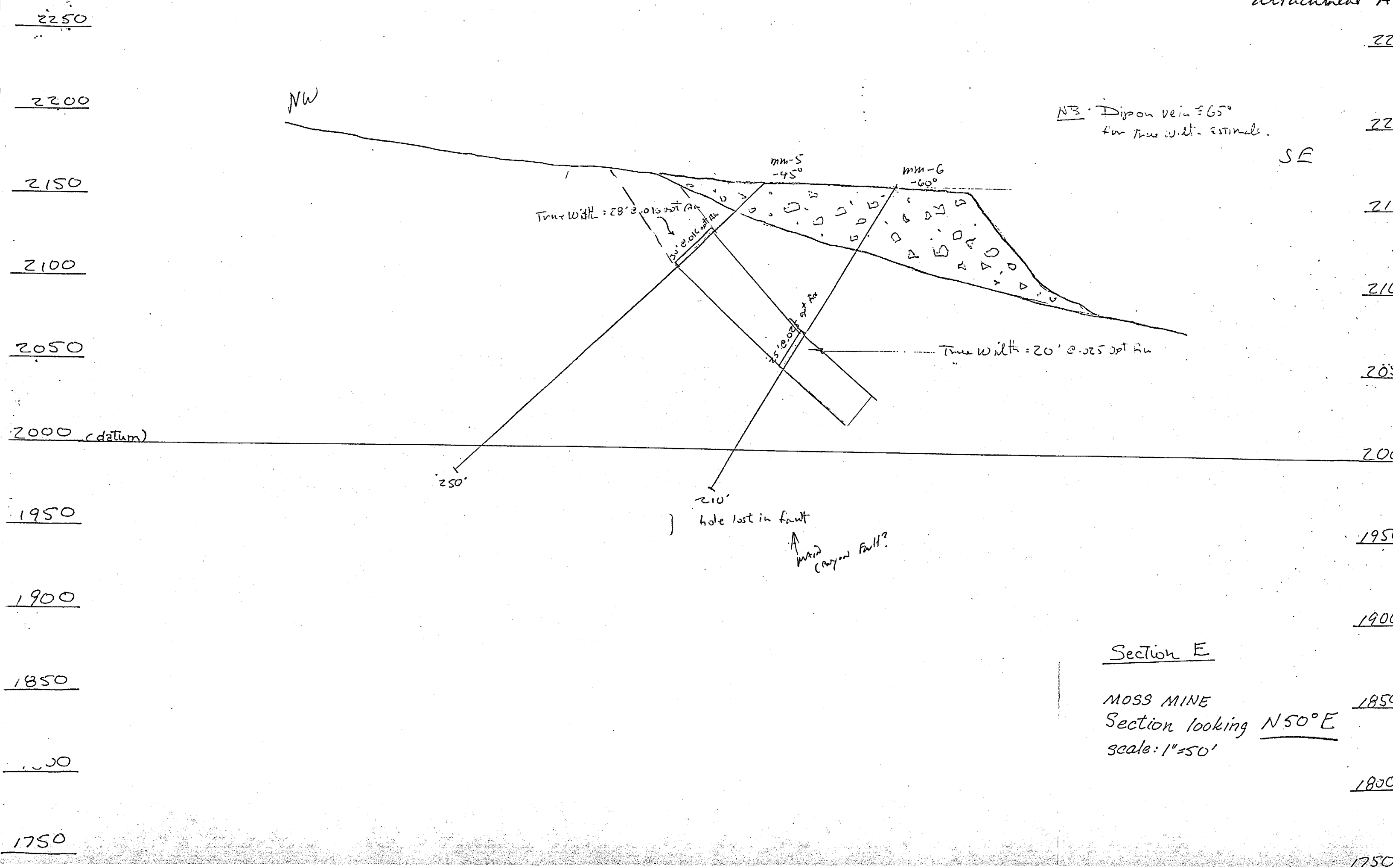

2250
2200
2150
2100
2050
2000 (datum)
1950
900
850
800

2252
2200
2150
2100
2050
2000
1950
1900
1850
1800

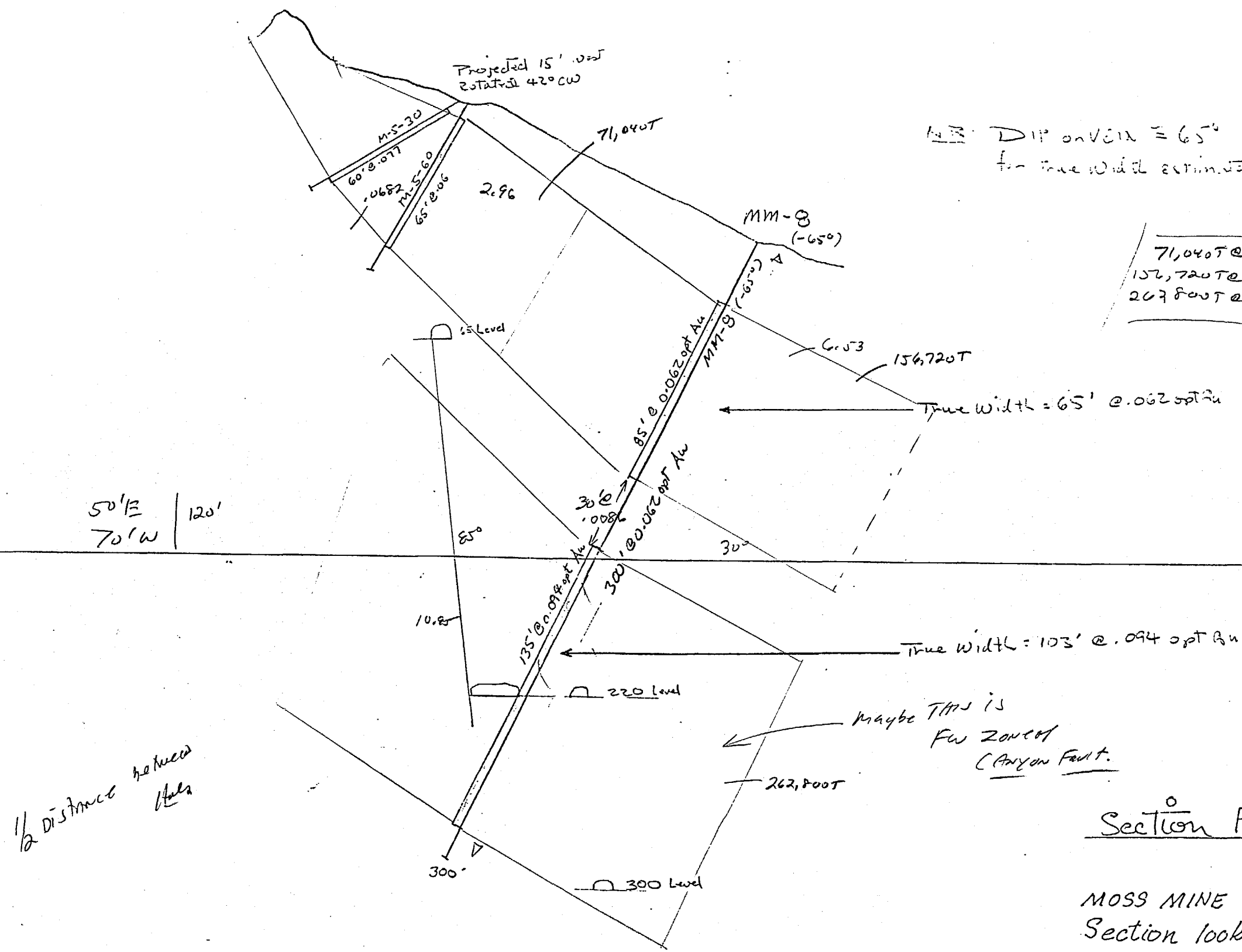

71,040T @ .0682
156,720T @ .062
262,800T @ .094

Section F

MOSS MINE
Section looking E 12° S
scale: 1" = 50'

1/2 distance between
Auls

2250
2200
2150
2100
2050
2000 (datum)
1950
1900
1850
1800

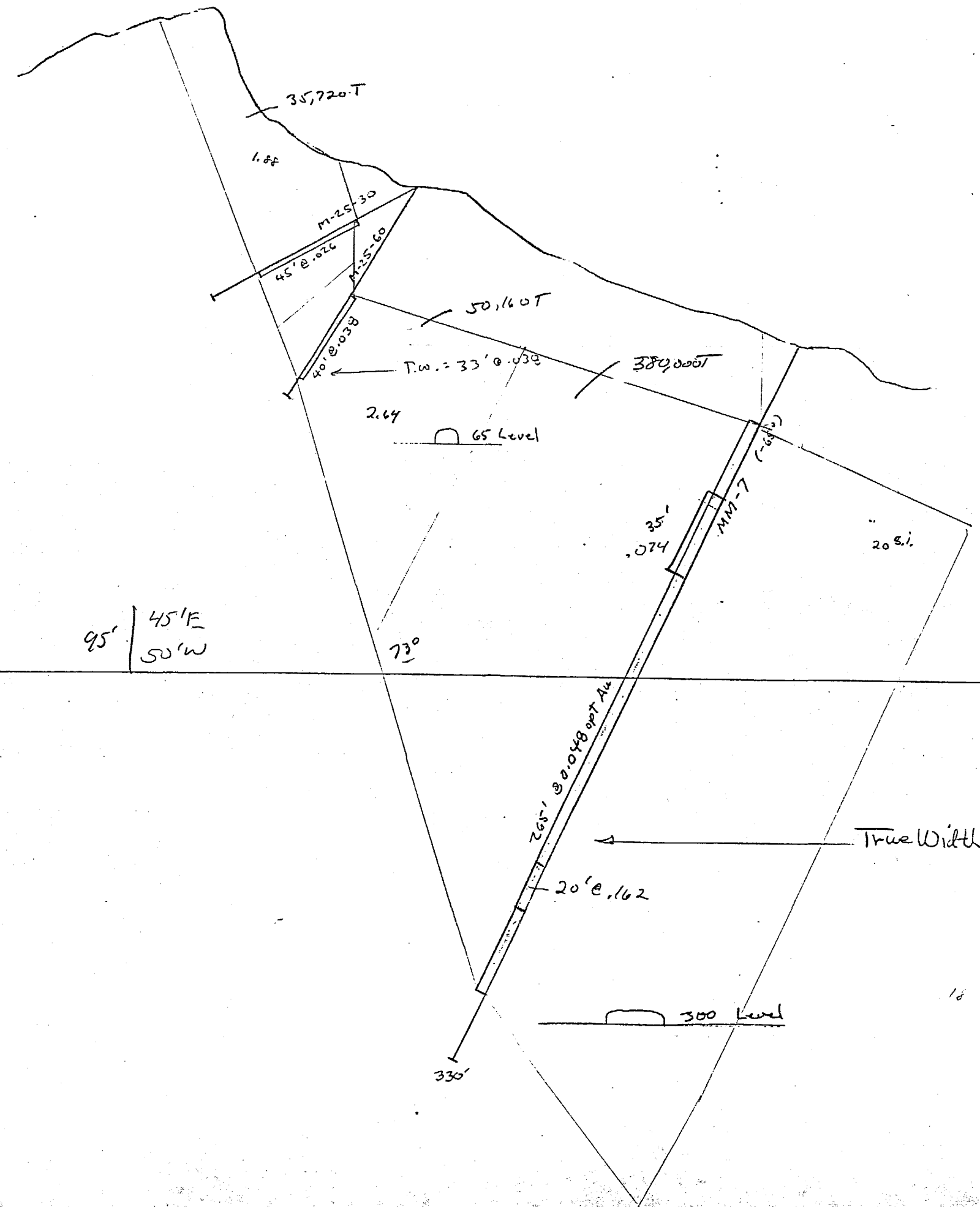

NT: width of vein $\approx 65'$ for
True Wilt. estimate.

35,720 T @ .026
50,160 T @ .038
380,000 T @ .048

Section G

MOSS MINE
Section looking E 12° S
scale: 1" = 50'

2250
2200
2150
2100
2050
2000
1950
1900
1850
1800

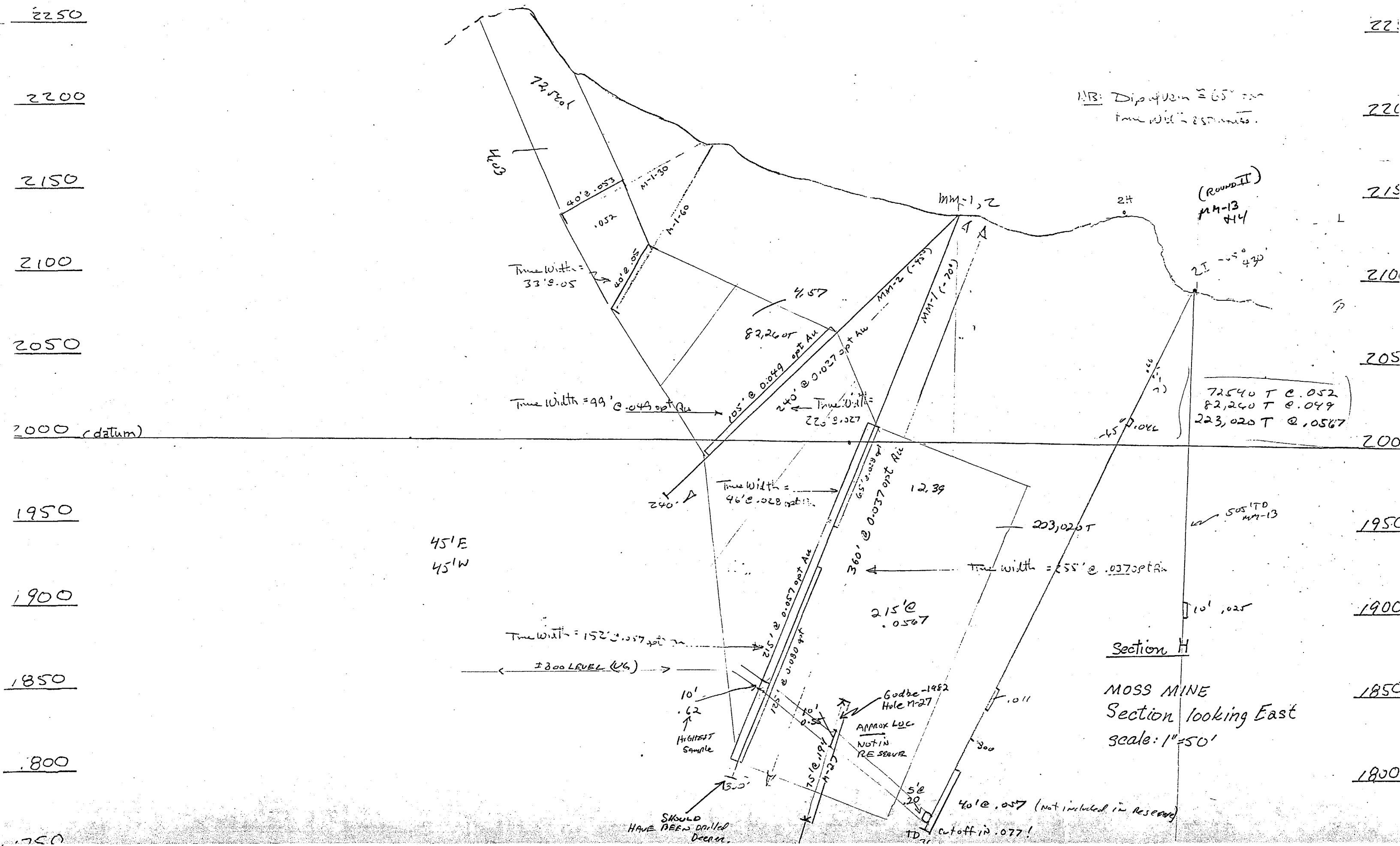

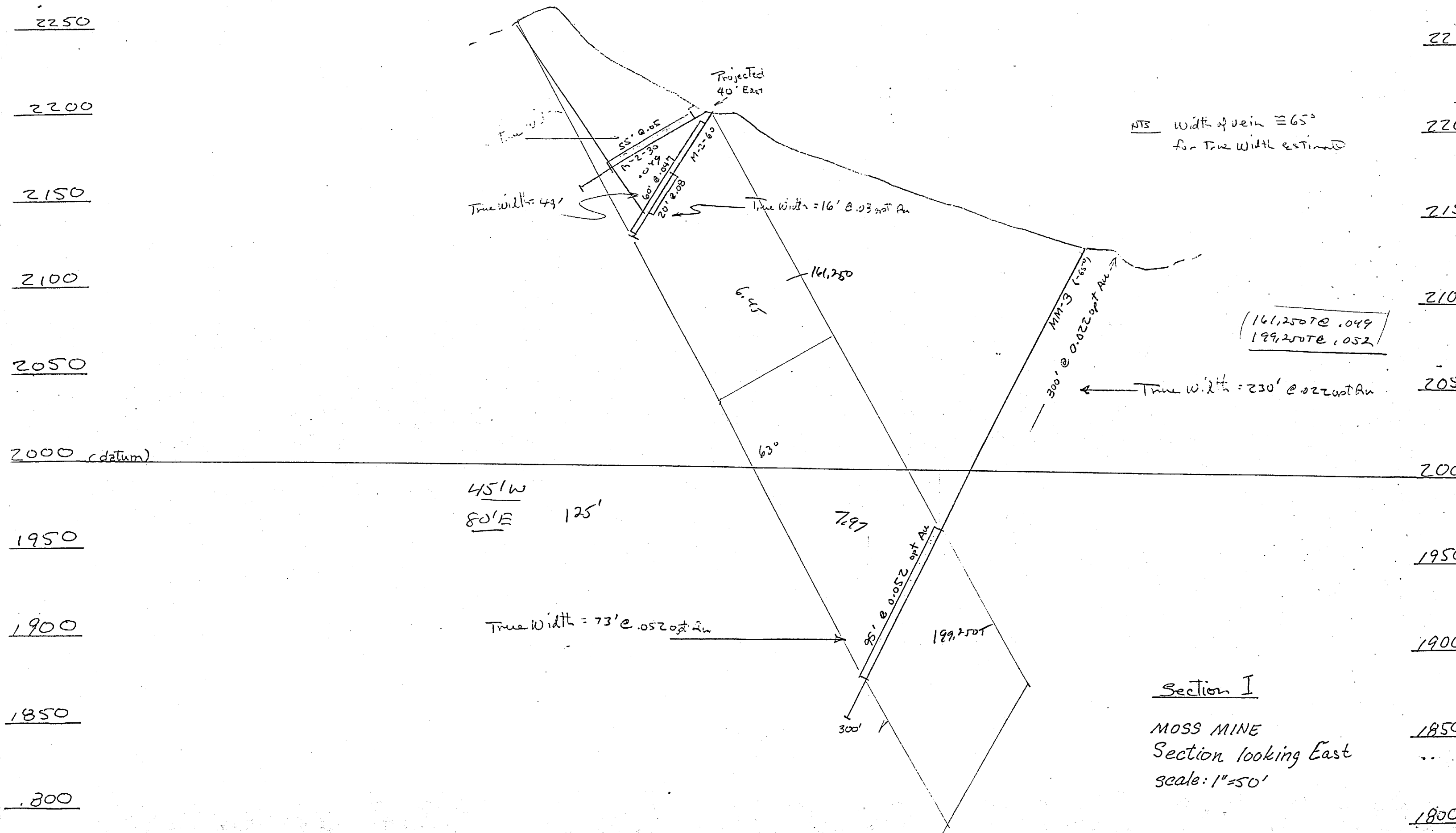

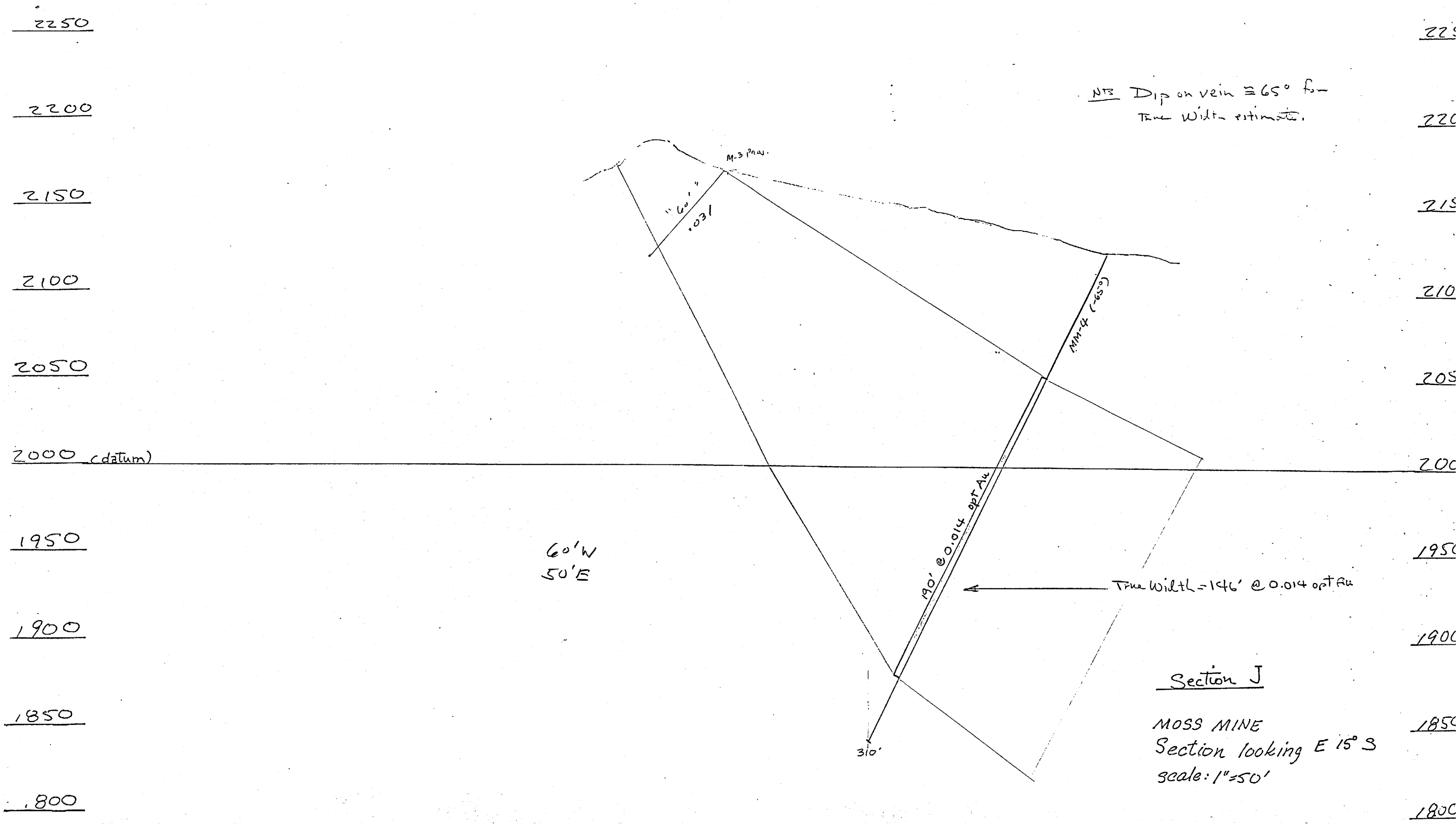

2250
2200
2150
2100
2050
2000 (datum)
1950
1900
1850
1800
1750

2250
2200
2150
2100
2050
2000
1950
1900
1850
1800

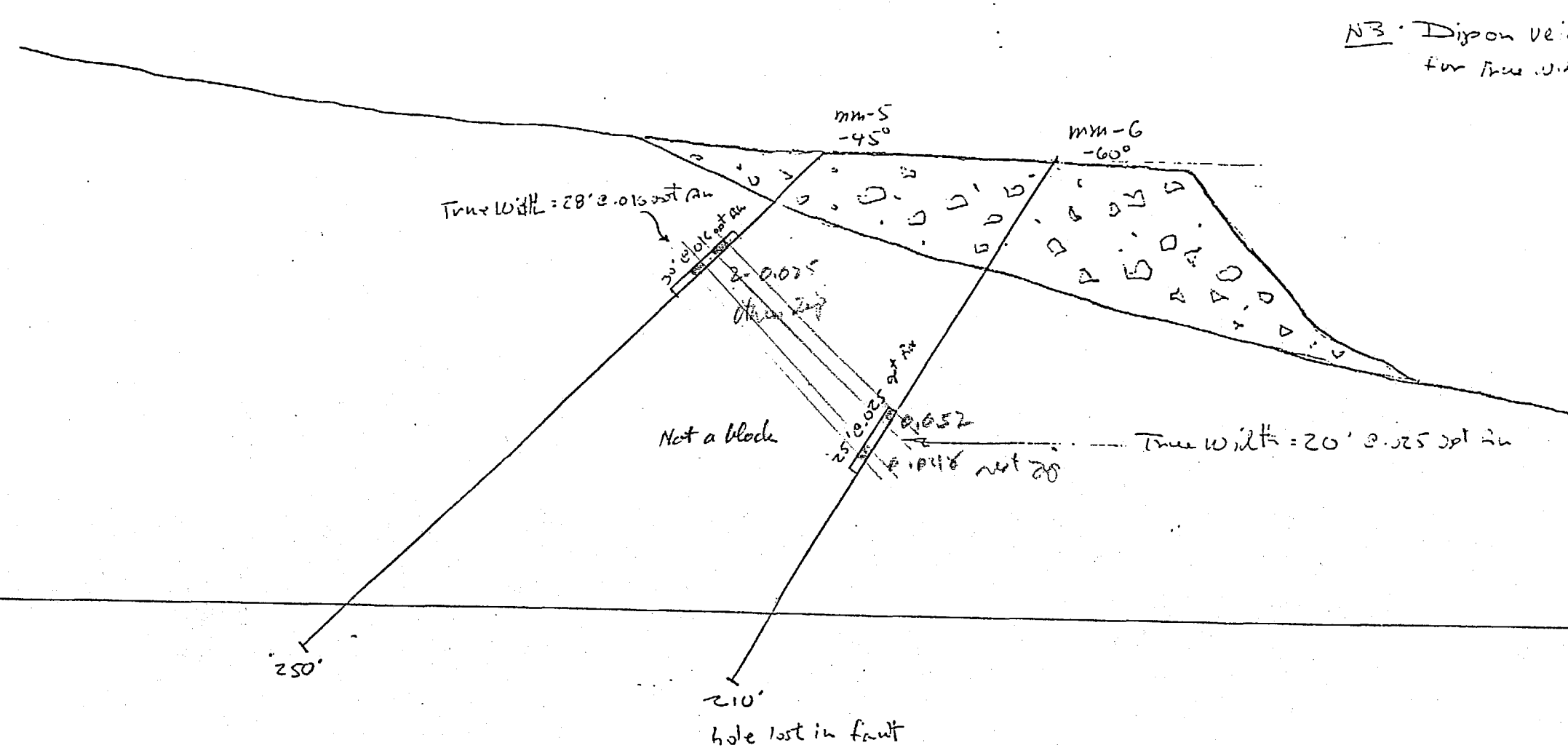

NB. Dip on vein $\approx 65^\circ$
for true width estimate.

Section E

MOSS MINE
Section looking N50°E
scale: 1"=50'

2250

2200

2150

2100

2050

2000 (datum)

1950

1900

1850

1800

2250

2200

2150

2100

2050

2000

1950

1900

1850

1800

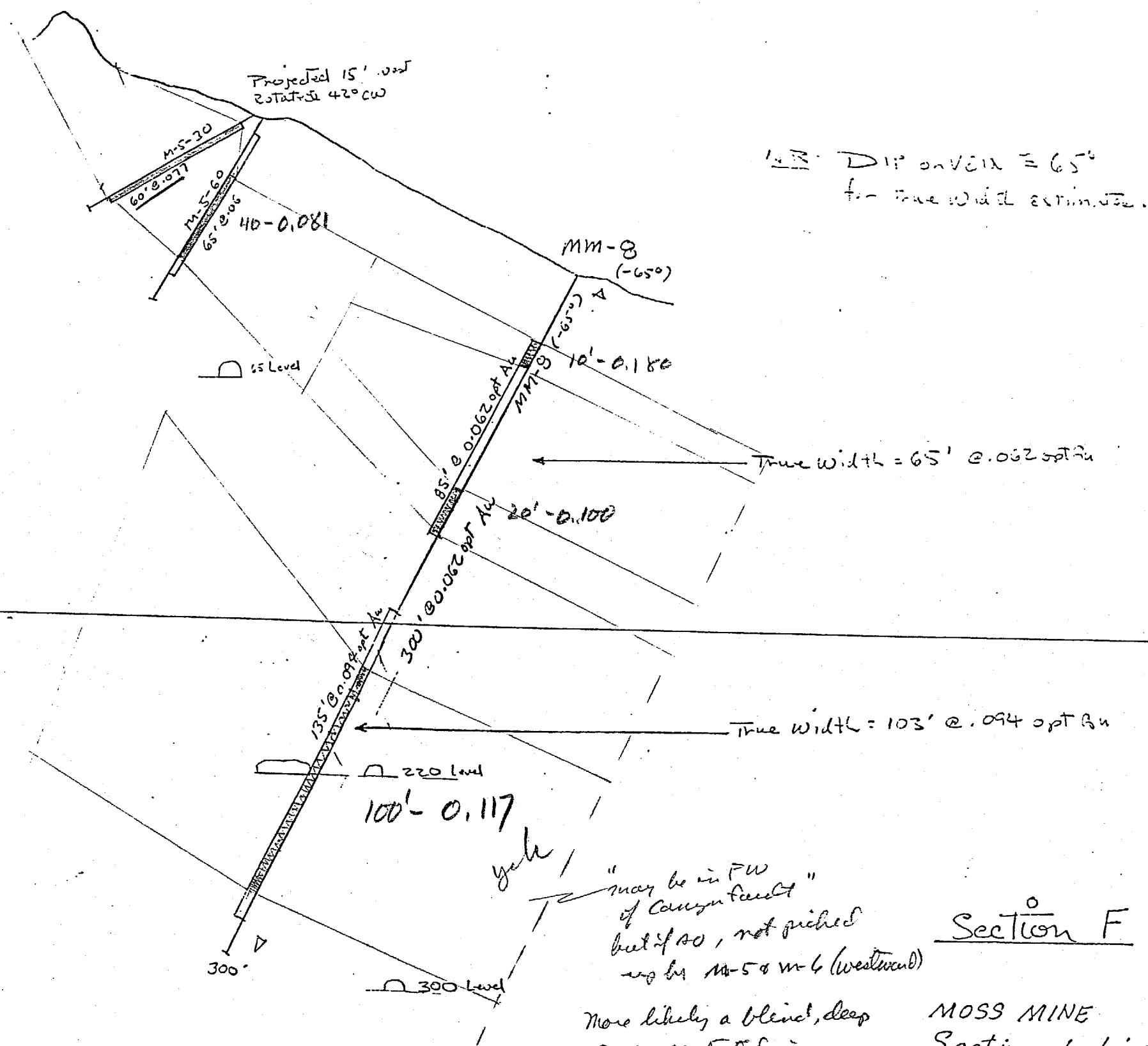

Section F

"may be in FW of conglomerate" but if so, not picked up by M-5 & M-6 (westward)
More likely a blind, deep zone as tested in Secs G, H, I

MOSS MINE
Section looking E 12° S
scale: 1" = 50'

2250
2200
2150
2100
2050
2000 (datum)
1950
1900
1850
1800

2250
2200
2150
2100
2050
2000
1950
1900
1850
1800

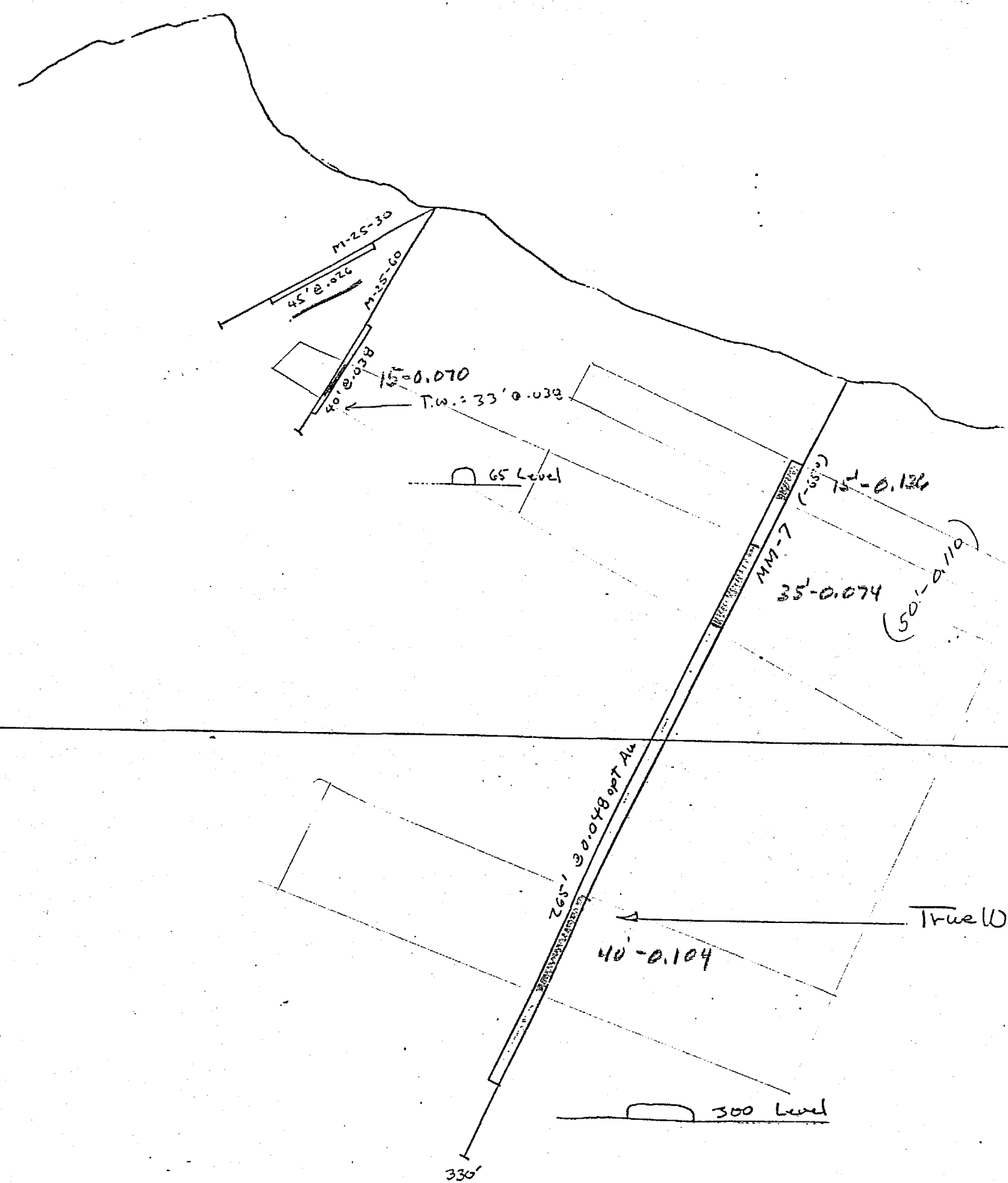

NTB: width of join $\approx 65^\circ$ for
True Wilt. estimated.

Section G
MOSS MINE
Section looking E 12° S
scale: 1" = 50'

2250
2200
2150
2100
2050
2000 (datum)
1950
1900
1850
1800

2250
2200
2150
2100
2050
2000
1950
1900
1850
1800

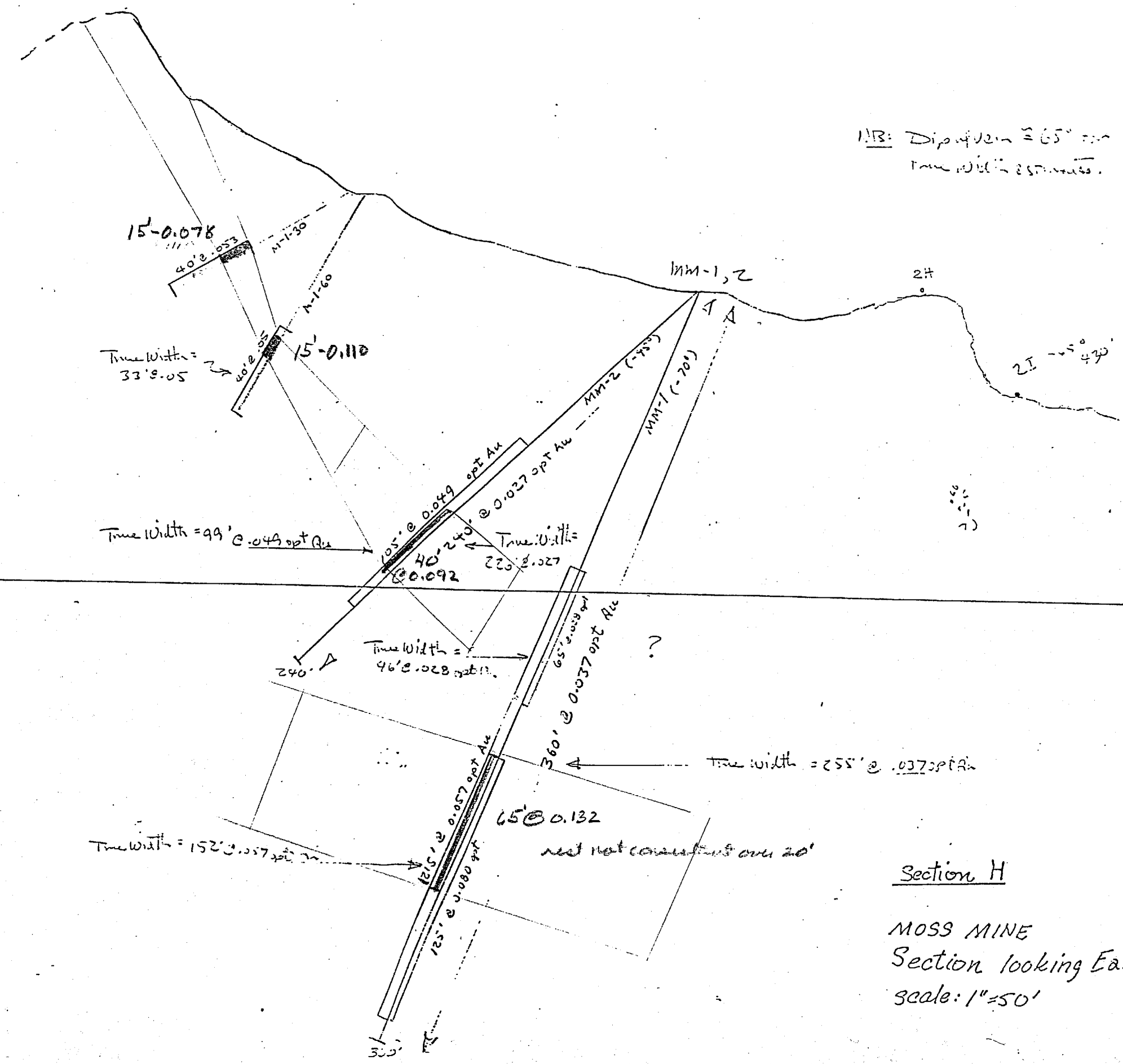

1/B: Dip of vein = 65°
True width estimates.

Section H

MOSS MINE
Section looking East
scale: 1" = 50'

2250
2200
2150
2100
2050
2000 (datum)
1950
1900
1850
1800

NB Dip on vein $\approx 65^\circ$ for
True Width estimate.

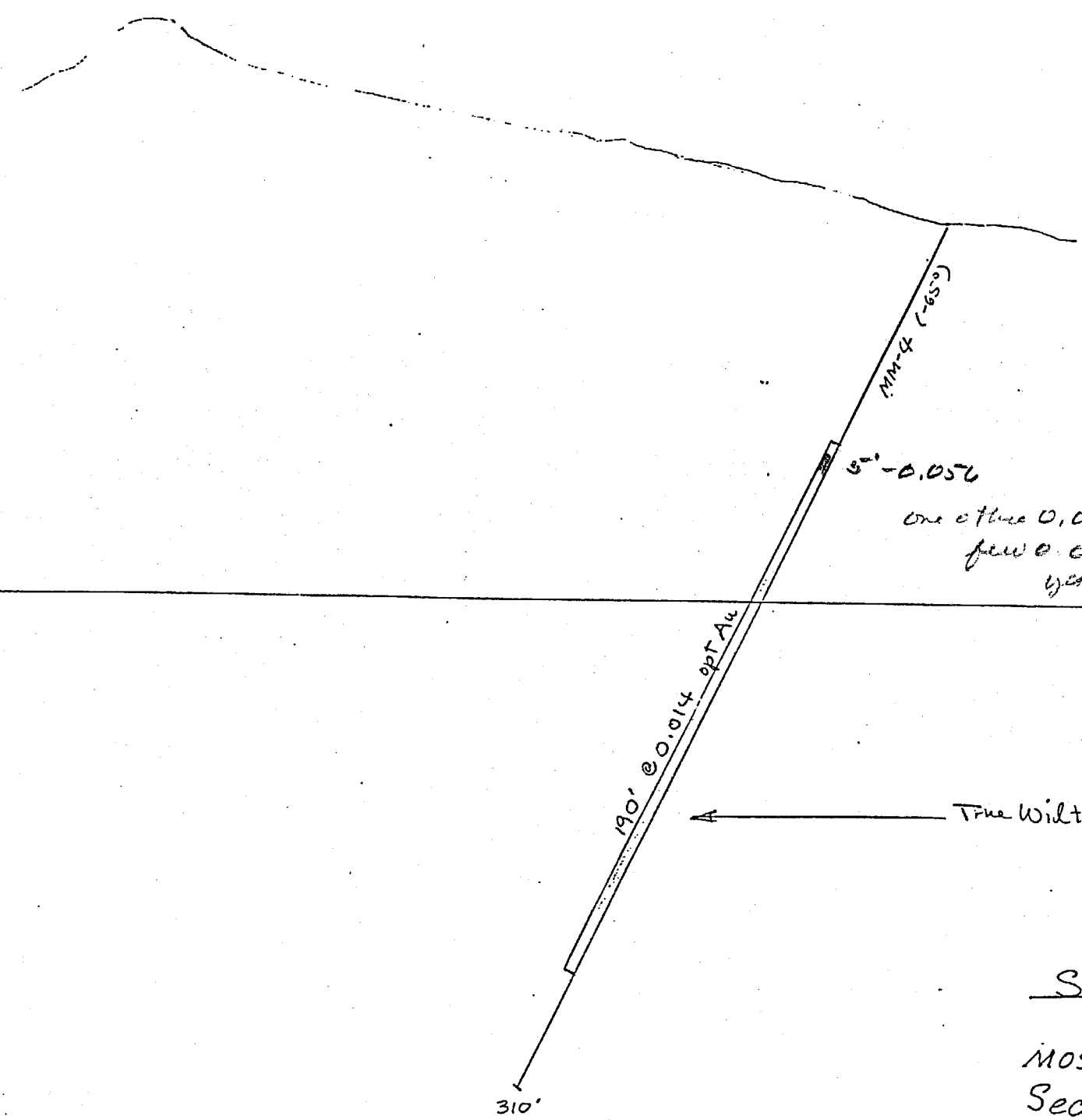

Section J

MOSS MINE
Section looking E 15° S
scale: 1" = 50'

ASARCO*JDS*
see last
*Section**Moss mine***RECEIVED****FEB 19 1991****EXPLORATION DEPARTMENT**

Exploration Department

R. L. Brown
Vice President

February 14, 1991

Mr. W.L. Kurtz
Tucson OfficeBilliton Minerals, USA

Dear Mr. Kurtz:

As you may know, Billiton Minerals, USA is selling out and I asked Mr. Vikre to examine data regarding all the properties in all districts, make evaluations of each property regardless of location, and to alert us to properties which in his view should be acquired by Asarco. Vikre studied Billiton data in its Reno office on January 9th and 14th, and sent his report on this work to me under cover of a letter dated January 15. I have only just now caught up with this correspondence but note in it that the Moss Mine project, in the Oatman district could be of some interest. You have a copy of Vikre's report with which there was included Koutz's notes on this project. All that I could glean for Koutz's notes was that he is enthusiastic about the property. Reading between the line of Koutz's memo might lead one to the idea that the Moss Creek is a one vein property with a number of shoots within the vein. Further perusal of the document does unearth the Billiton summary, to which is attached a cross-section which one assumes shows some of their better drill results. Those grades would not support a 7 - 1 waste - ore ratio, let alone an underground mining operation.

All of the above aside it could be possible in light of the enthusiastic Koutz memo that Moss Creek might be better than the Gold Road proposal, which did not prosper here because of the possibility of a very difficult and expensive underground exploration, uncertainty as to the grade in the target, and uncertainty also as I recall of the amount of previous mining. perhaps the Moss Creek is a cleaner proposition and I will be interested in seeing Mr. Sell's evaluation of it.

*Will you write
a cover letter not
to my memo or
send to Brown?*

Yours very truly,

R. L. Brown

R.L. Brown

RLB:lj

Sharon Steel → SAA

1/17/91

JDS

Moss Mine
Calmwood
Mohave Co
AZ

WHILE DIGGING THRU my OATman File, the following folder of Sharon Steel - Goldward materials turned up in a packet of data that S.A.A. had borrowed from me in 1986-87 and returned to me before I packed up & left in 1988. Would you please give it back to him? This stuff may better belong in the SWED Mohave County files but I think SAI & MBD & other 3rd floor types keep their own files on these projects. I will let you Tucsonites determine where to file this.

Good luck with Moss - I think the chance of increasing the Av oz to ASARCO size is very good.

Note for SAA: I have a copy of Bob Chorney's M.S. Thesis on Creta ss - Flowerpot sh. Cu-Ag in OKLA for you after I read it. Maybe should be passed along to R. Dingers on RMEP??

Thanks

Fleet

ASARCO

Southwestern Exploration Division

February 20, 1991

R.L. Brown
New York Office

Billiton Minerals, USA
Moss Mine
Oatman District
Mohave County, AZ

Prior to your letter of February 14th, Mr. Sell, at my request, had re-reviewed in detail the Moss Mine data supplied by Koutz. Sell came to the same negative conclusion that he had a month earlier. You have received his memo of February 15th and the important part is the next to last sentence. I have very briefly reviewed the data and agree with Sell that the chances for finding important tonnage and ounces of gold are extremely slim and I would spend my time and exploration dollars elsewhere.

As an aside, your comments on Gold Road are incorrect.

WLK:mek

W.L. Kurtz

cc: J.D. Sell

ASARCO

Exploration Department
Great Basin Division

Date: FEB 4, 1991

TELECOPIER COVER SHEET

ASARCO Incorporated

FEB 4 1991

SW Exploration

PLEASE DELIVER THE FOLLOWING PAGES TO:

NAME: J. D. Sell / W. L. Kutz
FROM: F. R. Kutz, RENO OFFICE

You will receive 2 pages of copy including this cover sheet.

If you do not receive all pages, please call the Reno Office as soon as possible.

Telephone Number: (702) 826-7007.

Thank you.

*PHU Asked me to send THIS Billiton notice
TO YOU, IF YOU ARE interested in visiting Moss Mine
OR any other Billiton Projects OR making a Bid
YOU NEED TO GET AROUND THE MILLION BAIT PEOPLE
SOON.*

FRK

BILLITON MINERALS U.S.A.**JANUARY 29, 1991****UPDATE FOR PROSPECTIVE PURCHASERS****DATA ROOM AVAILABILITY**

The Billiton Minerals U.S.A. ("BMUSA") Data Room, located in Reno, NV, will now be open through Friday, February 8, 1991. The Data Room is being made available for prospective purchasers to review information on the BMUSA assets. Initial or follow-up visits may be scheduled by calling Gary Kearns at (215) 553-2199 or Karr McCurdy at (412) 234-7939.

DEADLINE FOR WRITTEN PROPOSALS

Written proposals for the purchase of the BMUSA assets are due by the close of business on Friday, February 15, 1991. Prospective purchasers are reminded that their proposals must include the following:

- o If the prospective purchaser's proposal does not include the entire BMUSA asset portfolio, then the specific assets/projects to be acquired should be clearly identified;
- o The composition of the purchase price (cash, other forms of consideration, if any);
- o Specifics as to due diligence requirements, conditions precedent to closing, and time required to complete the acquisition;
- o The prospective buyer's statement of intent with respect to acquiring any staff of BMUSA;
- o If the prospective purchaser is not a publicly traded company, please include a recent financial statement.

ADDRESS FOR SUBMISSION OF PROPOSALS

Written proposals should be sent to the undersigned:

Gary P. Kearns
Vice President
Mellon Bank, N.A.
1735 Market Street, 7th Floor
Philadelphia, PA 19103
(215) 553-2199
(215) 553-3399 (fax)

ASARCO Incorporated

FEB 4 1991

SW Exploration

FROM: W. L. KURTZ

TO: J. Sell

2/13/41
Moss Mine

Please write FBI memo on
memo to me with copy to
Rebsaen on your
disposition of the Moss
Mine — Kurtz has a
recommendation to acquire in his
monthly report (may have copy)

ASARCO

Great Basin Exploration Division

RECEIVED

FEB 13 1991

EXPLORATION DEPARTMENT

February 11, 1991

TO: R. L. Brown
New York Office

FROM: F. R. Koutz
Reno Office

Monthly Report
Walker Lane Region, NV-CA
January, 1991

	<u>Field Days</u>	<u>Office Days</u>	<u>Samples</u>
Program to date	557	489	14,332
Year to date	1	21	0

*Moss Mine
S 1/2 Sec. 19, N 1/2 Sec 30
T20N, R 20W
Oatman Dist.
Mohave Co., AZ*

Most of the month was spent on review and analysis of various submittals and farm-out solicitations. Several pages with recommendations were written on most of these propositions which are briefly summarized below.

Drafted well-depth "Walker Lane Depth-to-bedrock" maps were finally received during the month and were colored and assembled with recently obtained USGS Nevada Basin depth estimates from isostatic gravity calculations. Except for a few very specific instances, these combined data are insufficient to predict shallow pediment drill targets, but do provide a synoptic view of the basin depths where drill targets would be hopelessly deep. Several maps for slides were prepared for the New York Office showing various Nevada gold belts, contained viable Au-Ag deposits and thin pediment cover percentages. Much of February will be spent writing up 1989-90 Walker Lane reconnaissance and planning 1990-1991 AEM evaluations.

Submittals - Farm-outs examined:

<u>Property</u>	<u>Location</u>	<u>Verdict</u>
WestGold Properties (all or part farmed-out as of 1 Feb?)		
Coyote Hole	E. Ellendale District T2N, R47E Nye County, Nevada	CaCO ₃ -CaF ₂ -SiO ₂ + MnOX (±Au-Ag-As) Tufa along range front. Previously drilled by St. Joe. No interest.
Hidden Hill	Golden Arrow District Kawich Range, T2N, R48E Nye County, Nevada	Resources: 1.9 m.t. @ 0.047 opt Au (.02 c/o). From 6.4 m.t. @ 0.026 opt Au (.01 c/o) under shallow pediment. Not for sale at this time. <u>Keep track of this resource.</u>
Beatty	Bullfrog District Sec. 13, T11S, R46E Nye County, Nevada	Very weak anomaly in structure in tuffs. Potential target very deep - 5 mi. N of Bullfrog Mine. No interest.

R.L. Brown
February 11, 1991
Page 2

Boss JV	Gilbert District T2-3N, R38½-39E Esmeralda County, NV	All shallow targets tested by Mintek-Westly, WestGold. Hopeless deal. 0.6 m.t. @ 0.023 resource. Data including geophysics will aid GBE-AEM interpretation.
Lucky 89	Gilbert District Sec. 7-8, T4N, R39E Esmeralda County, Nevada	2 mi. N. of ASARCO 1990 GBN-AEM claims. Local anomalous Au-Ag-As-Hg-SiO ₂ adjacent to intrusive dome into epiclastic volcanics. No tonnage potential. Interesting occurrence.
Masonic JV	Masonic District Mono County, CA	(W/CoCa Mines). Data also examined 1 yr. ago. No significant additional work; scattered, small marginal zones of Au-Ag mineralization. Fractured holdings and escalated deal. Some AEM potential on NW flank.

Billiton Properties (Mellon Bank) Bids due 15 Feb.

Moss Mine	Oatman District Mohave County, Arizona	Res: 1.7 m.t. @ 0.06 opt Au (4/1 w/o) + 2-5 m.t. @ 0.02-0.03 of drill intercepts. Data analyzed and sent to SWED. <u>Worth a generous bid soon!</u>
Garrison	S. Va City District Madison County, Nevada	"Mother Lode" veins/shear zones. DH to date unsuccessful. High rent and BLM-FS problems. Nebulous targets - not attractive.
Borealis JV	Borealis District Mineral County, Nevada	(w/Echo Bay) Extensively drilled, all identified viable targets tested. High rent. Maps and GP data obtained for reference.
Midnite ATM	SE OR + NC NV Regional Compilation	Airborne predawn thermal imagery. Interesting method. Huge non-useful, partially evaluated prospect - target file. No 1990 work. Not worth their \$ spent.

Pahroc	T6S, R62E Lincoln County, Nevada	Dec. 89 visit. Jasperoid PZ Ls window is Tv. High As, Sb, Hg, But very minor Au-Ag. No potential.
Easter Mine	Sec. 18, T5S, R66E E. Delamar District Lincoln County, Nevada	Dec. 89 visit. ±2 m.t. @ 0.1 opt Au (milling ore). Epithermal Qtz. vein outcrop. FMC is dropping. Full data available after 15 Feb and <u>worth a look.</u>
7-mile Creek	T9N, R73-74W Lamimer County, Colorado	Independence Mining Farm-out after Molycorp drilled best soil/oc target and dropped. Other good soil Au anomalies untested. Sent to RMED (Bartos).

R.L. Brown
February 11, 1991
Page 3

SFS-NY Canyon Gabbs Valley Range
Mineral County, Nevada

Kookaburra-Wombat Gold (CoCA Mines) pediment sulfide +
CO₃ = hosted oxide op Cu resources. No direct interest.

F.R. Koutz

FRK:ks
cc: WLK
PGV

ASARCO

Southwestern Exploration Division

February 14, 1991

M.A. Miller

Moss Mine Data

I had passed on the Moss Mine data to you on 1/18/91. I have not received any feed back as of this date. I have removed the file packet from your room and returned it to the file, as I needed to review the material and write a summary.

JDS:mek

James D. Sell

cc: W.L. Kurtz

Review of assays: 2/14/91

a) etc glass entry

Fleet

MM-1 ~~360' @ 0.037~~ ^{215' @ 0.057} qst (135-350)

a) on 45' @ 0.028 (top) (135-200) ~~entirely~~ ^{entirely} 200-225 = 25' @ 0.015
b) plus 125' @ 0.080 (bottom) (225-350)

a) one 0.102, one 0.032, all rest lower down to 0.010

b) ~~125~~, 225-290 = 65' = $1.718/13 = 0.132$, remainder ^{exp 408'} 0.025 ^{0.042}

MM-2 105' @ 0.049 (100-205) rest of interval < 0.025

a) 150-190 = 40' = $0.737/8 = 0.092$ held up by 0.359 but also 0.038

MM-3 95' @ 0.052 (180-275) rest not constant.

a) 220-270 = 50' @ $0.691/10 = 0.069$ w/ 2 do 0.10 ^{actual}

MM-4 190' @ 0.014 (80-270)

a) best is 5' - 0.054 no go - No good.

MM-5 30' @ 0.016 (40-70')

a) best is 2 @ 0.025 other < 0.012

MM-6 25 @ 0.025 (100-125)

a) best is 0.052 & 0.048 rest ~~0.012~~

MM-7 245' @ 0.048 (35-300)

a) top 35-50 = 15' @ $0.408/3 = 0.134$

b) mid 70-105 = 35' @ $0.514/7 = 0.074$

c) lower 220-260 = 40' @ $0.831/8 = 0.104$

35-105 = 70' = $0.956/14 = 0.068$

held up by 0.292 off 0.03

MM-8

~~300' @ 0.062~~

85' @ 0.062 (30' - 115')

135' @ 0.094 (140' - 275')

a) $30-40 = 10' = 0.360/2 = 0.180$

b) $95-115 = 20' = 0.398/4 = 0.0995$ but, ^{held up by} 0.292, 0.045, 0.019!

c) $175-275 = 100 = 2.335/20 = 0.117$ yeh!

MM-9

75' @ 0.03

MM-10

75' @ 0.024 w/ 1-0.087

MM-11

115' @ 0.024 (75' - 190')

@) $140-150 = 10' = 0.138/2 = 0.069$

MM-12 20' - 0.024 at surface.

~~Godby Holes~~
~~Sec H~~
~~M-1-30~~
~~40' @ 0.053 (55' - 95')~~
~~@) 75-85 = 10' @ 0.22/2 = 0.110~~

Godby Holes (upper part of zone)

~~M-1-30~~

Fleet

M-1-30

50'-90' = 40' @ 0.053

a) $50-65 = 15' = 0.234/3 = 0.078$

M-1-60

40' @ 0.05 (70' - 110')

a) $75-85 = 10' = 0.22/2 = 0.110$

I

$$M-2-30 \quad 55' - 0.05 \quad (5-60')$$

$$30-50 = 20' = 0.40/4 = 0.100$$

$$M-2-60 \quad 60' - 0.047 \quad (5-65')$$

$$a) \quad 40-60 = 20' = 0.36/4 = 0.09$$

I

$$M-5-30 \quad 60' - 0.077 \quad (5-65')$$

$$a) \quad 5-65 = 60' = 0.930/12 = 0.0775$$

$$M-5-60 \quad 65' @ 0.06 \quad (5-70')$$

$$25-65 = 40' = 0.65/8 = 0.081$$

could have
been in F

$$M-6-30 \quad 20-45 = 25' = 0.41/5 = 0.082$$

$$M-6-60 \quad 20-65 = 45' = 0.82/9 = 0.091$$

overly diff
w of F
E of E

$$M-7-70 \quad 35-55 = 20' = 0.31/4 = 0.0775$$

$$M-10-45 \quad 5-35 = 30' = 0.62/6 = 0.103$$

~~$$M-10-40 \quad 15-50 = 35' = 1.62/7 = 0.231$$~~

$$M-10-60 \quad 15-50 = 35' = 0.85/7 = 0.121$$

$$M-11-45 \quad 20-55 = 35' = 0.47/7 = 0.067$$

G

$$M-25-30 \quad 45' - 0.026$$

$$M-25-60 \quad 40' - 0.038$$

$$a) \quad 70-85 = 15' = 0.21/3 = 0.070$$

M-27-68

$$290-365 = 75 \quad 2.75/15 = 0.183$$

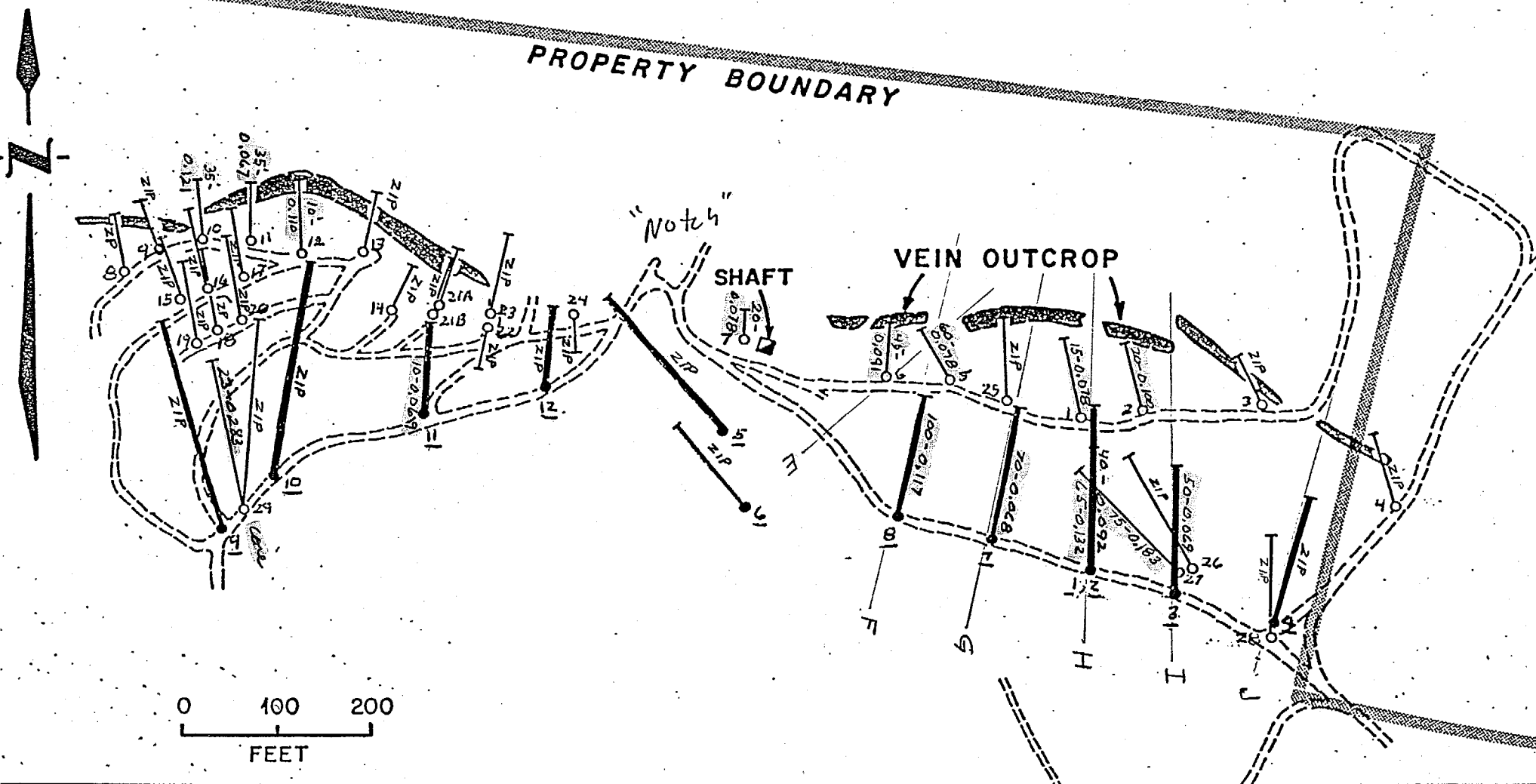

MOSS MINE DRILLING MOSS MINE PROJECT MOHAVE COUNTY, ARIZONA

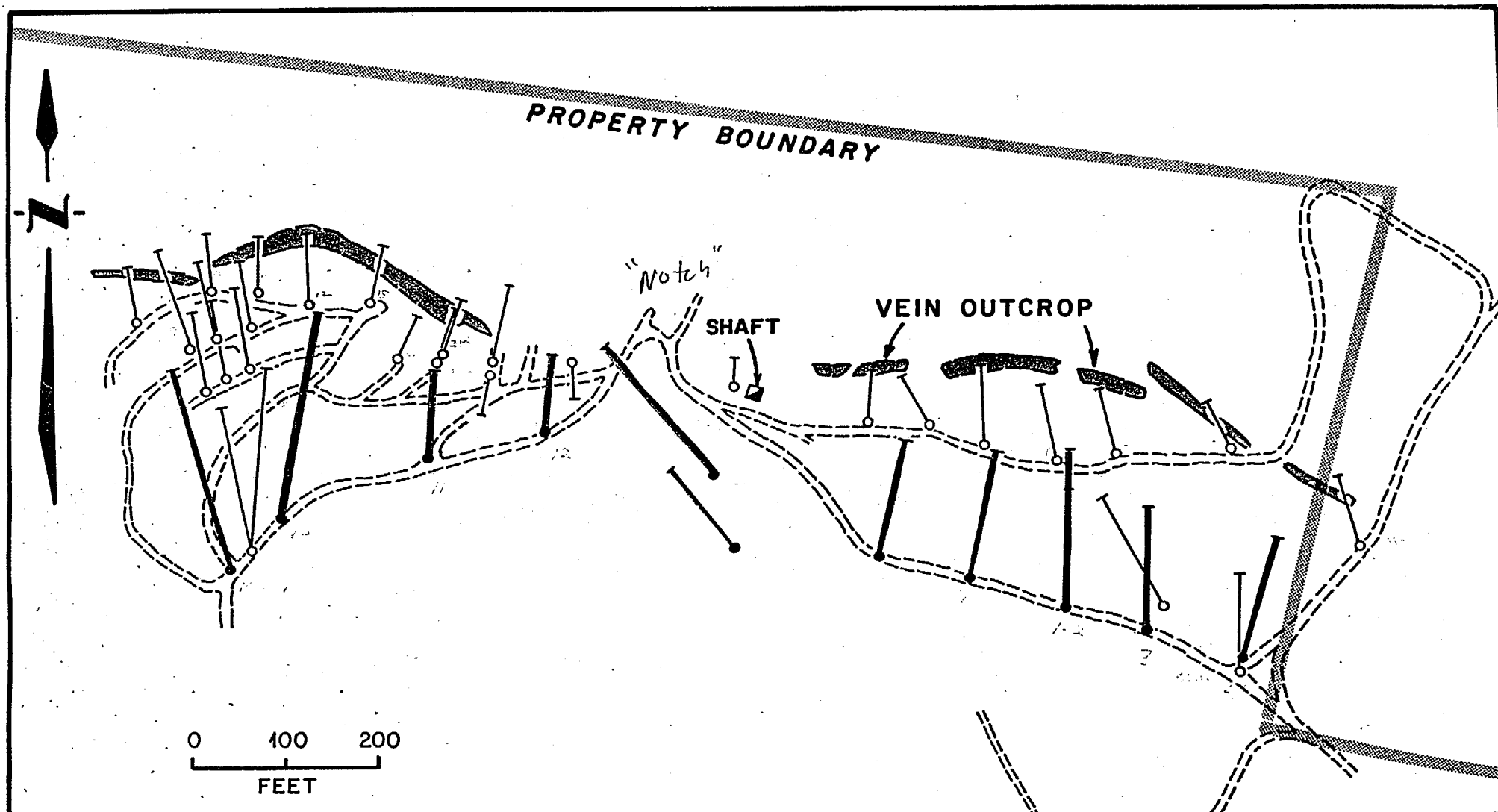

MOSS MINE DRILLING **MOSS MINE PROJECT** **MOHAVE COUNTY, ARIZONA**

MM-  Reverse circulation drill hole, Billiton 1990

M-  Air-Trac drill hole, BF Minerals 1982

 Outcrop exposure of vein system

1-18-91

FROM: J. D. SELL

To: M. A. Miller

On a day you are resting
from the Mexican dungeon,
Review the Moss Mine
area data carefully
for possible ASARCO
participation aka Fleetwood

Need definition of ore
shoots etc., target, expansion
etc. Note that 0.02-0.03
is not too interesting for ASARCO
J.D. Sell

FROM: J. D. SELL

1-18-91

To: M A Miller

On a day you are resting
from the Mexican Surgeon,
Review the Moss Mine
Area data carefully
for possible ASARCO
participation aka Fleetwood

Need definition of ore
shoots etc, target, expansion
etc. Ndr. that 0.02-0.03
is not to interesting for ASARCO
J.D. Sell

The Northern Miner Nov 22, 1993, p. 3