



CONTACT INFORMATION
Mining Records Curator
Arizona Geological Survey
416 W. Congress St., Suite 100
Tucson, Arizona 85701
520-770-3500
<http://www.azgs.az.gov>
inquiries@azgs.az.gov

The following file is part of the
James Doyle Sell Mining Collection

ACCESS STATEMENT

These digitized collections are accessible for purposes of education and research. We have indicated what we know about copyright and rights of privacy, publicity, or trademark. Due to the nature of archival collections, we are not always able to identify this information. We are eager to hear from any rights owners, so that we may obtain accurate information. Upon request, we will remove material from public view while we address a rights issue.

CONSTRAINTS STATEMENT

The Arizona Geological Survey does not claim to control all rights for all materials in its collection. These rights include, but are not limited to: copyright, privacy rights, and cultural protection rights. The User hereby assumes all responsibility for obtaining any rights to use the material in excess of "fair use."

The Survey makes no intellectual property claims to the products created by individual authors in the manuscript collections, except when the author deeded those rights to the Survey or when those authors were employed by the State of Arizona and created intellectual products as a function of their official duties. The Survey does maintain property rights to the physical and digital representations of the works.

QUALITY STATEMENT

The Arizona Geological Survey is not responsible for the accuracy of the records, information, or opinions that may be contained in the files. The Survey collects, catalogs, and archives data on mineral properties regardless of its views of the veracity or accuracy of those data.

ASARCO

JDS

Exploration Department
Southwestern United States Division
James D. Sell
Manager

June 12, 1986

Mr. S. John Downs, Agent
2027 S. La Rosa Drive
Tempe, AZ 85282

Honey Dew Patented Claim
Dos Cabezos District
Cochise County, AZ

Dear Sir:

Your letter of May 30th, concerning the Honey Dew patented claim, has been received.

At the present time all of my staff is out of the state and I am not sure when we can field review the claim area.

Thank you for bringing the property to our attention.

Do you have any further information such as township-range-section location and the production and maps of the workings?

Sincerely,

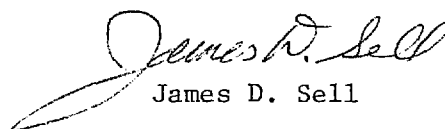
James D. Sell

JDS:mek

1-128
May 30, 1986

Mr. J. D. Sell, Mgr.
ASARCO INCORPORATED
1150 North 7th Avenue
P.o. Box 5747
Tucson, Arizona, 85703

Dear Sir:

Your company was recommended to me by my friend,
John Jett, Director, Arizona Mineral Resources, as
one that might be interested in seeing a mining property.

I represent the owners of HONEY DEW, a small mining
property located in the Dos Cabezas mining district in
southeastern Arizona in Cochise County. It was once an
active gold mine in the early 1900's, and I have been
told that the single owner-operator made a good living
from its ores until he died of an accident.

Its tunnel and shaft lie in the same extensive quartzsite
that the recently mined GOLD PRINCE (Phelps Dodge Copper
Corporation) is located. In fact, these two properties
are less than a mile apart.

The HONEY DEW, a patented mining claim, is about twenty
miles southeast of Wilcox and is easily accessible by
truck or four-wheeled vehicle.

If you would care to examine this property, I am available
at 2027 S. La Rosa Drive, Tempe, Arizona, 85282, Tel. 967-5827.

Sincerely,

S. John Downs

S. John Downs
Agent

ASARCO Incorporated

JUN 2 1986

SW Exploration

The Northern Virginia Mercury 7, 1988 p. A 3



DOS CABEZAS PROJECT

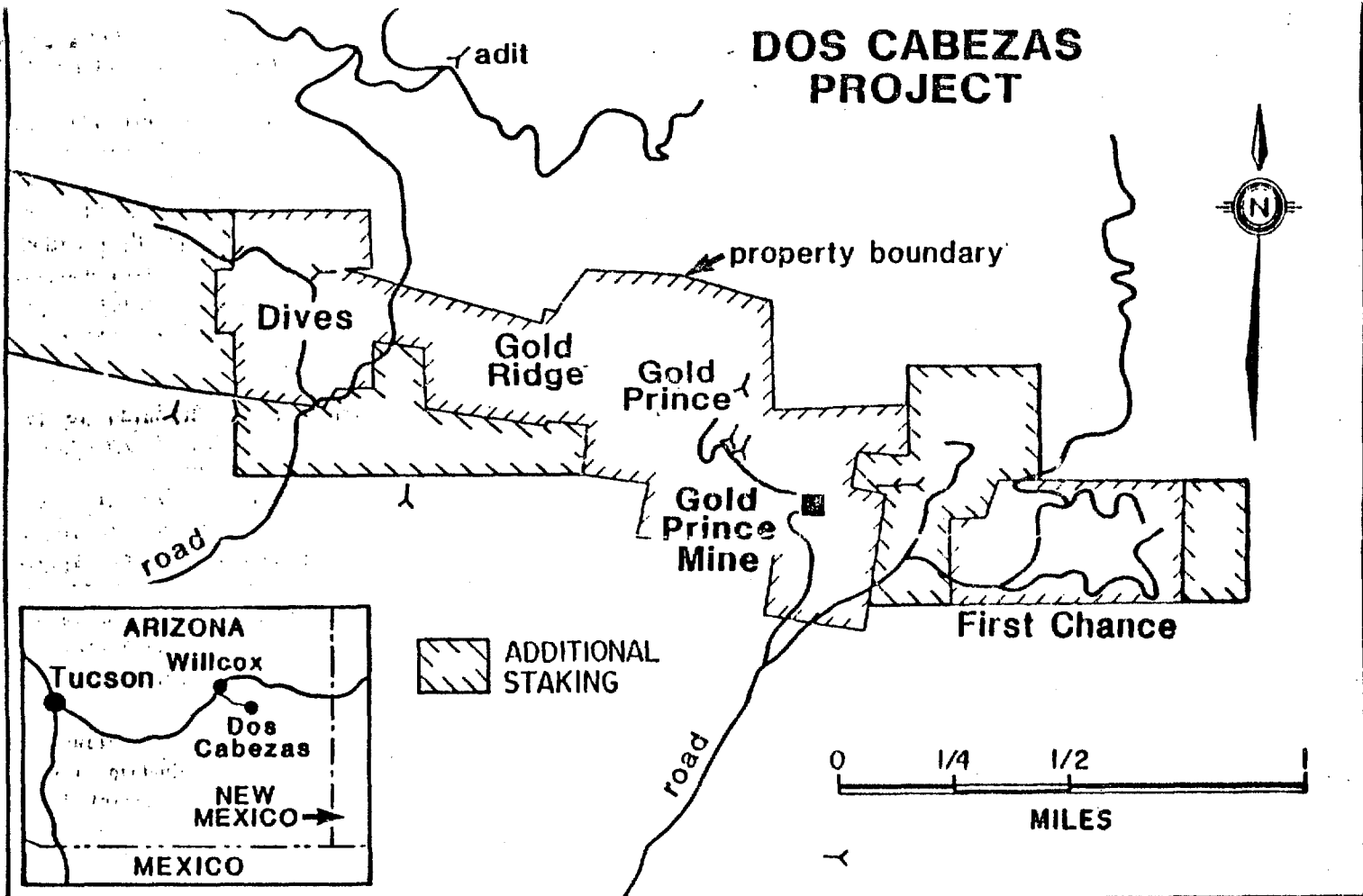

1988 PHASE ONE DRILL PROGRAM

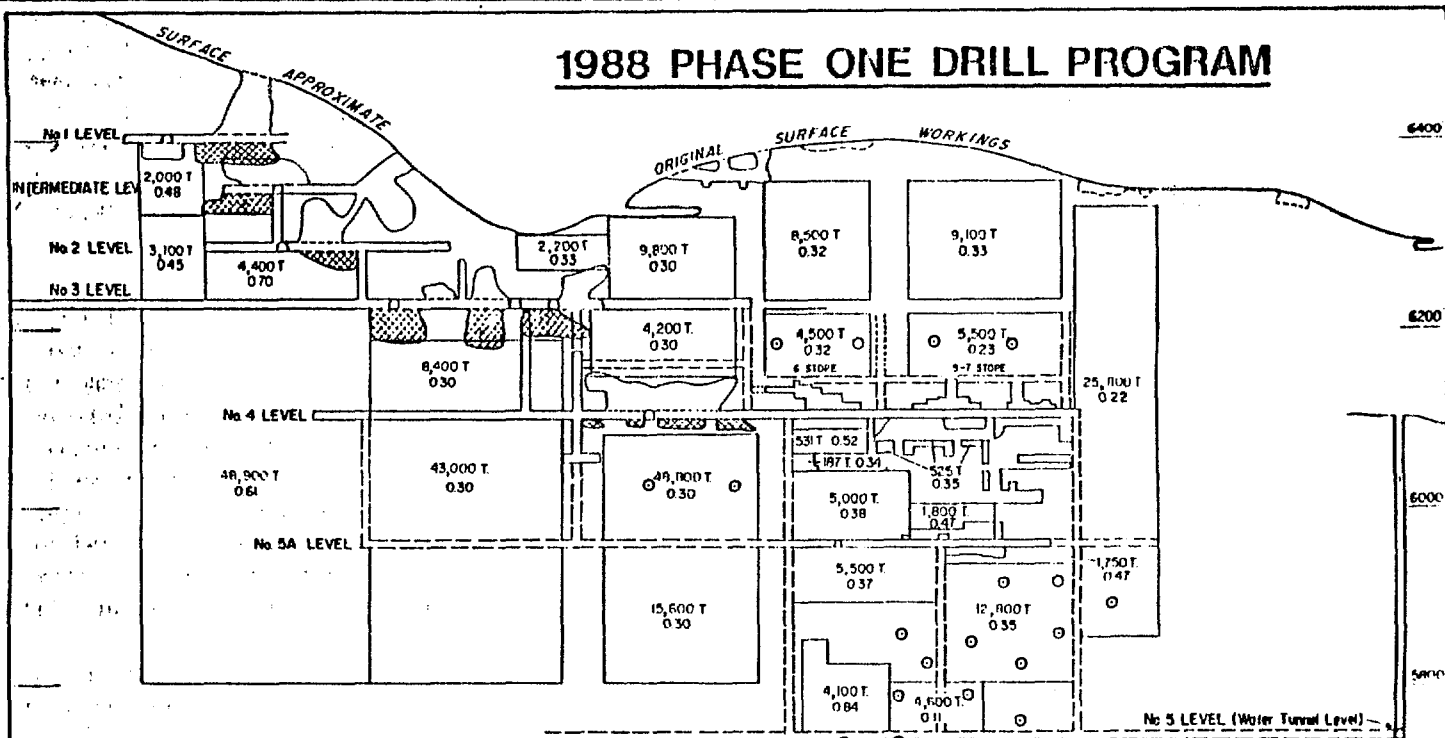

LEGEND

--- FUTURE DEVELOPMENT

○ 1988 PHASE ONE DIAMOND DRILL HOLE

□ RESERVES-ALL CATEGORIES 236,768 TONS.
AVERAGE GRADE OF 0.384 oz/T. GOLD

■ FILLED STOPES

QUEENSTAKE RESOURCES

DOS CABEZAS PROJECT
GOLD PRINCE MINE

PROPOSED DEVELOPMENT PLAN

February 14, 1989

Mark Miller

Queenstake's
Dos Cabezas Project
Cochise County, AZ

Mr. Al Voirin, phone: 384-4337, called on 2/14 to say that they are now in a crunch and may have the area open for joint venture.

They have drilled about 50% of the surface and underground holes and are looking for help.

Some stockwork - dissemination has been found by the drilling which may be put together as a small open-pit potential. The best potential is the underground.

Please contact Al or Tim Pearson to look at data.

JDS:mek

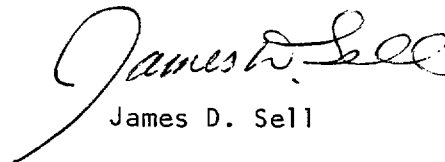

James D. Sell

cc: W.L. Kurtz

MAR 16 '89 04:35

P.116

QUEENSTAKE RESOURCES (USA) INC.
Dos Cabezas Project
P. O. Box 217
Willcox, AZ 85644
(602) 384-4337

ASARCO Incorporated

MAR 15 1989

SW Exploration

FACSIMILE TRANSMISSION COVER SHEET

DATE: March 15, 1989

TO: Mr. Jim Sell
ASARCO
P. O. Box 5746
Tucson, AZ 85703

FAX NUMBER: (602) 792-3934

FROM: Timothy J. Pearson, Project Geologist

NUMBER OF PAGES: 6 (Including Cover Sheet)

COMMENTS: Original Agreement to follow in the mail for signature.

FAX OPERATOR:

Courtesy of The Copper Penny
P. O. Box 788
902 W. Rex Allen Drive
Willcox, AZ 85644
FAX #: (602) 384-4608 Ext. 16

If you do not receive all the pages or if they are not legible, please contact the operator as soon as possible.

The original transmission ☒ will ☐ will not be ☒ mailed ☐ couriered to you office.

cc M.A. MILLER 3/15/89

CONFIDENTIALITY AGREEMENT

This Confidentiality Agreement is made and entered into
this _____ day of _____, 19____, by and between
_____ having offices at _____

(hereinafter called the "Discloser") and _____
_____ having offices at _____
_____ (hereinafter called the
"Recipient").

WHEREAS Discloser has an interest in the _____
_____ area located in _____ County,
State of _____, (hereinafter called the "Area") which
is delineated in the slashed area on the plan attached as
"Exhibit A" hereto and all land within one (1) mile distance away
from the outside boundary of said area; and

WHEREAS Discloser has developed and obtained certain
confidential information, including maps and geological data,
(hereinafter together called the "Information") with respect to
the Area; and

WHEREAS Recipient desires to examine, review and use the
information for the purpose of determining whether to negotiate
with Discloser for a possible business arrangement regarding the
Area; and

WHEREAS both Discloser and Recipient are desirous of
preserving the confidentiality of the Information.

NOW, THEREFORE, in consideration of Discloser furnishing
the Information to Recipient and the mutual agreement set out,

the parties hereto hereby agree as follows:

1. All Information disclosed by Discloser to Recipient shall be made available solely for the purpose of enabling Recipient to determine whether to negotiate with Discloser for a possible business arrangement regarding the Area.

2. All Information disclosed by Discloser to Recipient shall be clearly marked to indicate its confidential nature.

3. Subject to Paragraph 4 hereof, Recipient agrees:

a. to treat Information as confidential and to use reasonable care not to divulge Information to any third party, such care to be commensurate with the care exercised by Recipient with respect to preservation of its own confidential information;

b. to restrict the use of Information to matters related to the parties' relationship with each other under this Agreement; and

c. to restrict access to Information to officers, directors, employees and professional advisors of Recipient whose access is reasonably necessary in the implementation of the relationship between the parties hereto, and to require all such persons to have knowledge of and be bound by and to Recipient's obligations hereunder.

4. The restriction in Paragraph 3 will not apply and Recipient shall not be liable for disclosure of Information which:

a. is in the possession of Recipient prior to receipt from Discloser;

b. is independently developed by Recipient after

the date of this Agreement with

Information:

c. is disclosed to Recipient without any restriction or disclosure by Recipient; or
right to make such disclosure;

d. is furnished to others by Recipient without restrictions similar to those herein on the right to use or disclose it;

e. is inadvertently disclosed by Recipient where reasonable care has been taken consistent with the effort it exercises as to the preservation of its own confidential information to prevent such disclosure;

f. is or becomes available to the general public through no fault of Recipient; or

g. is approved in writing by Discloser for disclosure to a third party by Recipient.

5. All information furnished by Discloser to Recipient is to be returned by Recipient to Discloser upon its request, together with all copies, elaborations, modifications, and adaptations which Recipient has made thereof and thereto.

6. Nothing contained in this Agreement shall be construed as granting by implication, estoppel or otherwise, any license or rights of Discloser.

7. The obligations of Recipient under this Agreement shall terminate on _____, 19____.

8. Recipient agrees that it shall not acquire any property interest (which expression shall include mineral rights)

P. 676

MAR 16 '89 04:38

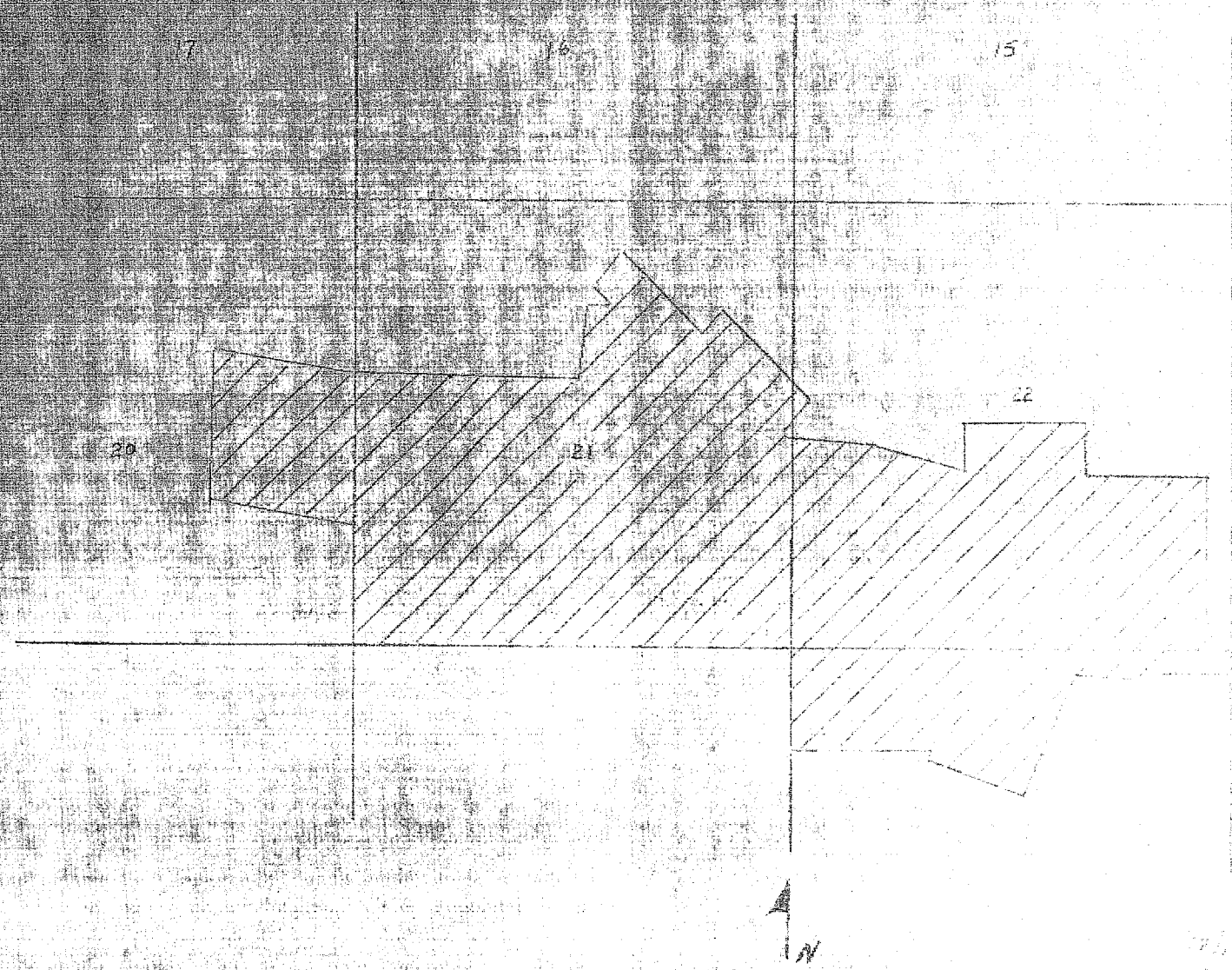

Map of
Surveyed area of the
land portion of the
Cochise Co., AZ. 1880-1885
GSRB + M
Scale 1"=2000'

GEORGE CROSS NEWS LETTER LTD.NO.57(1991)

PAGE TWO

MARCH 21, 1991



ASARCO

Exploration Department
Western USA

W. L. Kurtz
Manager

August 27, 1992

Ms. Annette Mowinckle
101 First Street, Suite 521
Los Altos, CA 94022-2706

Dear Ms. Mowinckle:

Mr. Sell is on assignment out of the country so I am answering your letter submitting your Dos Cabezas gold property for Asarco's consideration, on his behalf.

We are aware of your properties and, in fact, followed the work of Queenstake rather closely. We do not feel these properties are what we want to explore and/or mine at the present time.

Thank you for bringing the properties to our attention once again.

Very truly yours,

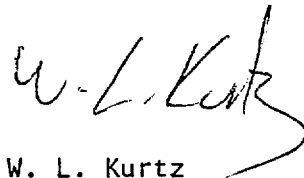

W. L. Kurtz

WLK:mek

cc: J.D. Sell

2v.

Mr. Sell is on assignment out of the country so I am answering your letter submitting your ~~the~~ Las Cabeza gold property for Asarco's consideration, on his behalf.

We are aware of your properties and ^{in fact} followed the work of Cuenotake rather closely. We do not feel

These properties are ~~the~~ what we want ASARCO Incorporated to explore and/or mine at the present time.

August 24, 1992

AUG 27 1992

Mr. James D. Sell
S.W. Exploration Manager
ASARCO Inc.
Box 5747
Tucson, AZ 85703

Thank you for bringing the properties to our attention once again.

SW Exploration

VTT

Dear Mr. Sell:

cc JDSell

We are interested in selling or leasing our gold property in Arizona that has produced more than 4,177 ounces of gold during the last four years, and 4,483 ounces for the three year period from 1984 to 1986.

Small underground mining has produced the 4,177 ounces as 11,974 tons at .33/.44 average grade; and the 4,483 ounces as 14,238 tons at .31 average grade. The ore has been shipped as flux ore to Phelps Dodge smelters.

Enclosed is a 1989 report on the property, which includes 322 acres of twenty contiguous patented claims, 780 acres of 39 unpatented lode claims, and 70 acres of deeded surface land (including town lots).

Dr. William C. Peters, geologist, recommended that we provide you with this information, as he thought you might be interested. If you would like more information, or to arrange a trip to the property, which currently has a small mining crew, please contact me.

I look forward to hearing from you.

Yours truly,

Annette Mowinckle

Annette Mowinckle
101 First Street, Suite 521
Los Altos, CA 94022-2706
Phone:
work (415) 854-9700, ext. 232
home (415) 967-4877