



CONTACT INFORMATION
Mining Records Curator
Arizona Geological Survey
3550 N. Central Ave, 2nd floor
Phoenix, AZ, 85012
602-771-1601
<http://www.azgs.az.gov>
inquiries@azgs.az.gov

The following file is part of the Grover Heinrichs Mining Collection

ACCESS STATEMENT

These digitized collections are accessible for purposes of education and research. We have indicated what we know about copyright and rights of privacy, publicity, or trademark. Due to the nature of archival collections, we are not always able to identify this information. We are eager to hear from any rights owners, so that we may obtain accurate information. Upon request, we will remove material from public view while we address a rights issue.

CONSTRAINTS STATEMENT

The Arizona Geological Survey does not claim to control all rights for all materials in its collection. These rights include, but are not limited to: copyright, privacy rights, and cultural protection rights. The User hereby assumes all responsibility for obtaining any rights to use the material in excess of "fair use."

The Survey makes no intellectual property claims to the products created by individual authors in the manuscript collections, except when the author deeded those rights to the Survey or when those authors were employed by the State of Arizona and created intellectual products as a function of their official duties. The Survey does maintain property rights to the physical and digital representations of the works.

QUALITY STATEMENT

The Arizona Geological Survey is not responsible for the accuracy of the records, information, or opinions that may be contained in the files. The Survey collects, catalogs, and archives data on mineral properties regardless of its views of the veracity or accuracy of those data.

Grove - This is a list of Squaw Peak material that Pangea has in their possession.

Borrowed Orig. Mylers & Segins

2-6-75

MAPS &c.

- 1 CLAIM MAP 1" = 1000'
- 10 PHILLIP'S TOPOG. SHEET 1-9 (extra of #5) 1" = 200'
- 2 ESSEX AMEND. OF SHEET 5 1" = 200'
- 1 SECTIONS - ALT. & MIN. 1" = 200'
- 1 GEO. MAP 1" = 12000'
- 1 GEO. SEC. A-A' 1" = 200'
- 1 8" x 11 SKETCH SECTION - X-Verde fault
- 1 larger " "
- 1 GEOL. SECTIONS Plate 3 1:12000
- 3 Surface geodetic contours

22

Pangea

Jerry

Squaw Peak maps to Town.

A. SECTIONS N. Squaw Peak Borrowed 1-29-75
(7) Series of w/mq-data Jerry

7600 -

7800

8000 -

8200 -

8400 -

8600 -

8800 -

B. Final agreement, unexecuted

Jerry



SCALE: 1" = 650' APPROX.

SECTIONS 29, 30, 31, 32; T13N, R5E

12-73

ESSEX
SQUAW PEAK PROJECT
YAVAPI COUNTY, ARIZONA

W. W. DENNIS

908 - 330 Bay Street

Toronto, Ontario M5H 2S8

Evan Koblanski

Suite 2602 - The Royal Centre

P. O. Box 11122

Vancouver, British Columbia M5H 2S8

Canadian Barranca Mining Ltd

If Dennis is negative try

J. A. Harquail

~~908~~ - 330 Bay Street

~~915~~ Toronto, Ontario M5H 2S8

604/926 2758 h
604/685 1251 o

416/362 6424

*Two Toronto Exchange
Companies*

700' - \$64 above

\$25

\$100

Amoco - 2 Ave

ESSEX

SQUAW PEAK PROJECT
YAVAPAI COUNTY, ARIZONA

12-73

SCALE: 1" = 650' APPROX.

SECTIONS 29, 30, 31, 32; T13N, R5E

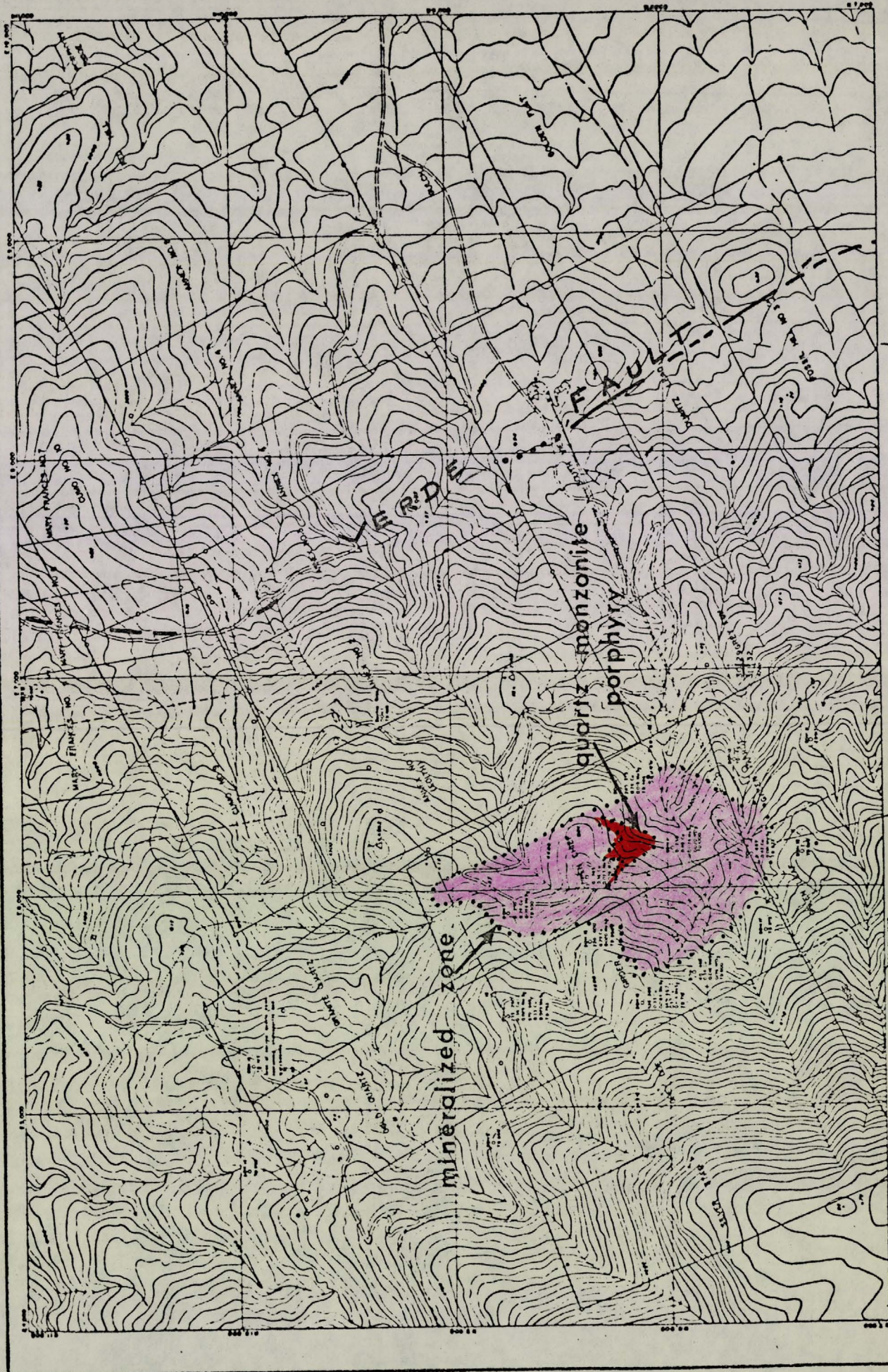

From
Rio - Cerro

PROPERTY AGREEMENT SUMMARY

Jan. 8, 1975

Squaw Peak Project
Squaw Peak Mining District
Yavapai County, Arizona
Portions of:
Sec. 23, 24, 25 T.13N., R.4E.
Sec. 19, 20, 21, 28, 29, 30, 31, 32, 33 -
T.13N., R.5E

Claims:

138 unpatented claims including 6 millsite claims.

Owner: Squaw Peak Copper Mining Co., P.O. Box 6, Camp Verde, Ariz.

Principals: Gale Wingfield, President; W. (Bill) Bowler, Sec. Treas.

Effective date of Agreement: Aug. 20, 1973.

Payments - Not deductible from purchase price

\$ 2,000.00	Down (Paid)		
10,000.00	Feb. 20, 1974 (Paid)	\$10,000.00	Feb. 20, 1978
10,000.00	" " 1975	10,000.00	" " 1979
10,000.00	" " 1976	10,000.00	" " 1980
10,000.00	" " 1977	10,000.00	" " 1981

Purchase price: \$1,000,000.00 at rate of
\$ 250,000.00 down at no interest
\$ 250,000.00 1st yr. thereafter @ 5½%
interest per annum and \$250,000.00
each year thereafter @ 5½% int/yr.
or can be apid lump sum.

Term of agreement: 8½ years

<u>Work Commitment</u>	<u>&</u>	<u>Minimum Expenditures Required</u>
\$10,000.00 Sept. 20, 1973		thru Feb. 19, 1974
10,000.00 Feb. " 1974		thru " " 1975
10,000.00 " " 1975		thru " " 1976
10,000.00 " " 1976		thru " " 1977
20,000.00 " " 1977		thru " " 1978
20,000.00 " " 1978		thru " " 1979
20,000.00 " " 1979		thru " " 1980
20,000.00 " " 1980		thru " " 1981
20,000.00 " " 1981		thru " " 1982

Minimum annual exploration payments are \$10,000.00 cash
plus \$10,000.00 work.

Upon decision to mine the purchase cost will be \$1,000,000.00 or
\$250,000.00 @ 5½% interest per year for 4 yrs: Yr 1 - \$291,250.00
Yr 2 - \$277,500.00
Yr 3 - \$263,750.00
Yr 4 - \$250,000.00

Total - - - - - \$1,082,500

a v o

TO Howard Lanier LOCATION Ft. Wayne, Ind.
 FROM Don P. Bellum LOCATION Tucson, Ariz.
 SUBJ. Squaw Peak Ore Reserves DATE March 1, 1974

COPY TO
 P. Eimon ✓
 L. Lichty

As part of the evaluation of Squaw Peak a preliminary mining plan has been developed and mining ore reserves have been calculated. These reserves are developed on the basis of a 0.30% Cu cut-off and include all the sample data on drilling completed to date. The cut-off grade is based on the expected production costs which will be verified during the evaluation. The configuration of the orebody makes it possible to mine a higher grade ore in the initial years of production and the mining has been planned in two phases.

Squaw Peak Ore Reserves

<u>Phase</u>	<u>Ore Tons</u>	<u>% Cu</u>	<u>% Mo</u>	<u>Waste Tons</u>	<u>Strip Ratio</u>
1	8,486,000	0.44	0.21	5,013,000	0.59/1
2	3,172,000	0.36	0.21	4,001,000	1.26/1
Total	11,658,000	0.42	0.21	9,014,000	0.77/1

The molybdenum content is the average of drill holes SP-1, SP-2, SP-4, and SP-6 only. The gold and silver content of 0.002 oz. per ton and 0.026 oz. per ton, respectively, will have little affect on the value of the ore. The laboratory test work has been completed on 20 samples comprising the above drill holes and it is estimated that average recovery of 82% for copper, 55% for molybdenum, and 50% for the gold and silver can be expected.

DPB:td

DPB

AN AFFILIATE OF

Rio Algom

Rio Tinto

February 10, 1975.

Mr. Grover Heinrichs,
Manager,
Essex International Inc.,
1704 W. Grant,
Tucson, Arizona 85705
U.S.A.

Dear Mr. Heinrichs:

We have been advised by Pangea Resources that they are presently examining your Squaw Peak property data on our behalf.

This is to confirm that we are interested in having Pangea continue their examination particularly to ascertain if there is evidence that a so-far undiscovered ore body might exist on the property. This will, I presume, involve an examination of the drill core and outcrops on site.

We wish to thank you for allowing Pangea access to your data and for your assistance in the on-going examination.

Yours truly,

RIOAMEX, A DIVISION OF ATLAS ALLOYS INC.,

H.W. Marsh,
General Manager.

HWM:ad

cc: A. Wandke
T. Mitcham
M.B. Mehrtens

Rio Algom
Rio Tinto

March 19, 1975.

Mr. Grover Heinrichs,
Exploration Manager,
Essex International Inc.,
1704 West Grant Road,
Tucson, Arizona 85705
U.S.A.

Dear Mr. Heinrichs:

We have received your letter of March 14 explaining your views on the status of our examination of your Squaw Peak property.

As I understand our arrangement the following steps should be taken:

1. Pangea may examine the Squaw Peak property during a period not to exceed 60 days from February 17, 1975.
2. Upon or before the expiration of the 60 day period Rioamex shall advise Essex whether or not we wish to enter into an agreement to acquire the Squaw Peak property.
3. If Rioamex does elect to acquire the property it shall then prepare a letter outlining the proposed terms of acquisition. It is understood that these terms will include but not be limited to the assumption by Rioamex of the present underlying leases and the payment to Essex of \$10,000.

If the terms as outlined are mutually satisfactory then Rioamex would prepare a complete formal agreement.

It would appear that the only step that differs from the outline in your letter is that of the timing of the preparation of an agreement. It has not been our practice to prepare a definitive document before the completion of an examination and before

./2

the decision has been made to acquire a property, as the Company believes that such a document can only be prepared after discussions between the parties and a review by its Legal Counsel of any pertinent documents.

I do hope that this small difference in approach is acceptable to you and I can assure you that if and when the decision is made to enter into agreement with Essex that our proposal will be in your hands at an early date.

Yours very truly,

RIO TINTO CANADIAN EXPLORATION LIMITED

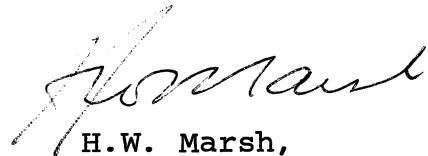
A handwritten signature in cursive script, appearing to read 'H. W. Marsh', is written over the typed name.

H.W. Marsh,
Exploration Manager.

HWM;ad

cc: M.B. Mehrtens
T.W. Mitcham

PANGEA RESOURCES, INC.

EXPLORATION MANAGERS, GEOLOGIC & MINING CONSULTANTS

2002 N. FORBES BLVD., SUITE 101
TUCSON, ARIZONA 85705
(602) 623-6316

April 4, 1975

Mr. E. Grover Heinrichs
Exploration Manager
Essex International, Inc.
1704 W. Grant Road
Tucson, AZ 85705

Dear Grover:

I regret to inform you that we have no further interest in the Squaw Peak property. However, we very much appreciate the opportunity, which you provided, for us to examine it.

Considering the above, we relinquish any rights, specific or implied, written or verbal, in the Squaw Peak property.

Sincerely,

Thomas W. Mitcham
Exploration Manager

TWM/mk

ESSEX

ESSEX INTERNATIONAL, INC.

METALLURGICAL & MINING DIVISION

1704 WEST GRANT RD., TUCSON, ARIZONA 85705 • PHONE (602) 624-7421

March 14, 1975

Rioamex, A Division of
Atlas Alloys, Inc.
120 Adelaide Street, West
Toronto, Canada

Re: Squaw Peak Project
Yavapai County, Arizona

Dear Mr. Marsh:

Your letter of March 7, 1975, has been received, and I wish to clear up your statement that there are no commitments on the part of either party at this time.

On the contrary, we mutually, Essex and Rioamex, are committed as follows:

1. Pangea may examine the Squaw Peak property for 60 days at no expense. The 60 day period commenced Feb. 17, 1975.
2. During this examination period an agreement will be prepared by Rioamex for review by and approval of Essex.
3. If Rioamex wishes to continue with its exploration effort on Squaw Peak, following the expiration of the 60 day period, two things must occur as below:
 1. An agreement must be executed or significant progress being made towards execution.
 2. A sum of \$10,000.00 must be paid by Rioamex. This logically can be a condition of the agreement.

Ridamex
March 14, 1975
Page 2

I assume that your attorneys are proceeding with a rough draft of an agreement that will be forthcoming shortly.

Our feeling here is that of a certain amount of foot dragging on your part relative to the \$10,000.00 payment and the drafting of the agreement. I can understand some of the reasoning involved, and I know the mail strike in Canada has amplified our communication problems. It is hoped this will aid in mutually resolving how I interpret where we stand at the moment.

Very truly yours,

ESSEX INTERNATIONAL, INC.

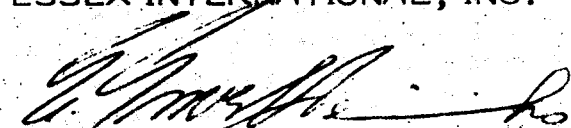

E. Grover Heinrichs
Exploration Manager

EGH/mah

cc: Pangea Resources, Inc.
Dr. Tom Mitchum
Rioamex
M. B. Mehrtens
Essex International
D. Letizia

ESSEX

ESSEX INTERNATIONAL, INC.

METALLURGICAL & MINING DIVISION

1704 WEST GRANT RD., TUCSON, ARIZONA 85705 • PHONE (602) 624-7421

William D. Boler, Jr.
P.O. Box 6
Camp Verde, Arizona 86322

Re: Squaw Peak Project

September 12, 1975

Dear Bill,

Under separate cover this date, via Greyhound Bus, I have sent data which you were so kind to loan to Essex. The data is itemized as per the attached three sheets. In addition, I have enclosed some aerial photos which you may find useful.

Sorry for the delay in getting this data to you, however, it was my understanding that Gale was planning to come through Tucson to look it over.

In accordance to the terms of the Essex-Squaw Peak agreement, you are welcome to see all the data we have and to copy any items which you may want to retain for your files.

I am sure that any company interested in your property would want to see this data.

PLEASE ACKNOWLEDGE RECEIPT
OF THE ABOVE DESCRIBED DATA
BY SIGNING, DATING AND RETURNING
THE ATTACHED COPY.

SIGNED: _____

DATE: _____

Very truly yours,
Essex International, Inc.

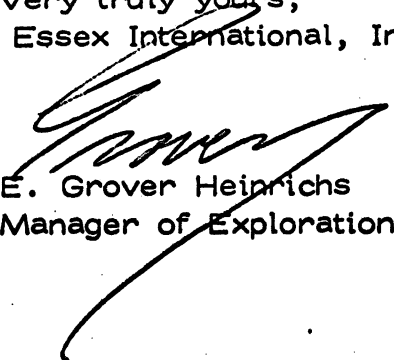
E. Grover Heinrichs
Manager of Exploration

Inventory of Property of Squaw Peak Mining Company, data on loan to ESSEX
Dated: September 12, 1975.

1. Drill Log Cross-sections - Phillips
2. Induced Polarization - Geoex Report - November 1968
3. Phillips Map Squaw Peak District - sheet 5 of 9 sheets
4. Phillips Map Squaw Peak Mine - Section 3
5. Phillips Map Squaw Peak District - sheet 5 of 9 sheets
6. Squaw Peak Mine - Section B-B' - August 1969 report
7. Squaw Peak Mine - Section A-A' - August 1969 report
8. Minerals Division - Squaw Peak District - June 11, 1971
9. Squaw Peak Project - Claim Map - Bartlesville, Okla.
10. Squaw Peak Mine - Section 5 - Minerals Division
11. Squaw Peak Mine - Section 6 - Minerals Division
12. Squaw Peak Mine - Section 7 - Minerals Division
13. Squaw Peak Mine - Section 8 - Minerals Division
14. Squaw Peak District - Sheet 9 of 9 sheets
15. Squaw Peak District - Sheet 8 of 9 sheets
16. Squaw Peak District - Sheet 7 of 9 sheets
17. Squaw Peak District - Sheet 6 of 9 sheets
18. Squaw Peak District - Sheet 5 of 9 sheets
19. Squaw Peak District - Sheet 4 of 9 sheets
20. Squaw Peak District - Sheet 3 of 9 sheets
21. Squaw Peak District - Sheet 2 of 9 sheets
22. Squaw Peak District - Sheet 1 of 9 sheets
23. Squaw Peak Mine - Section 5
24. Squaw Peak District - Sheet 2 of 9 sheets - Drill Hole Location
25. Horner Mountain - 1967 - N3422.5 W11145/7.5
26. Squaw Peak Mine - Section 4
27. Squaw Peak Mine - Section 7- Minerals Division
28. Squaw Peak Mine - Section 6 - Minerals Division
29. Squaw Peak District - Sheet 5 of 9 sheets
30. Squaw Peak District - Sheet 5 of 9 sheets
31. Squaw Peak Mine - Section 3
32. Squaw Peak Mine - Section 8 - Phillips 8-19-71 DWA #0002
33. Squaw Peak District - Geologic Map - Sheet 5 of 9 sheets - Jan. 1969
34. Geologic Log - Phillips - Hole #1 - Date Completed 3/28/68
Page 1-9, Assay info page 1-3.
35. Geologic Log - Phillips - Hole DDH #2 Date Completed 5-28-68
two copies - Page 1-8 Assay info (1pg.)
36. Geologic Log Phillips Hole DDH#3 pg. 1-5 Assay info pg. 1-2.
37. Geologic Log - Phillips Hole DDH#4 page 1-7 Assay Info -1-3
38. Geologic Log - Phillips Hole DDH#5 page 1-6 Assay info pg. 1-2
39. Geologic Log - Phillips Hole DDH#6 page 1-8 Assay info pg. 1-3
40. Geologic Log - Phillips Hole DDH#7 page 1-5 Assay info pg. 1-2
41. Geologic Log - Phillips Hole DDH#8 page 1-5 Assay info pg. 1-2
42. Geologic Log - Phillips Hole DDH#9 page 1-7 Assay info pg. 1-3
43. Geologic Log - Phillips Hole DDH#10page 1-6 Assay info pg. 1-2
44. Geologic Log - Phillips Hole DDH#11 page1-8 NONE

Inventory of Property of Squaw Peak Mining Company, data on loan to
ESSEX Dated: September 12, 1975 (CONTINUED)

45. Geologic Log Phillips Hole DDH#12 pages 1-10 Assay Info 1-4
46. Geologic Log Phillips Hole DDH#13 pages 1-10 Assay Info 1-4
47. Geologic Log Phillips Hole DDH#14 pages 1-8 Assay Info 1-4
48. Geologic Log Phillips Hole DDH#15 pages 1 only NONE
49. Geologic Log Phillips Hole DDH#16 pages 1-8 Assay Info 1-4
50. Geologic Log Phillips Hole DDH#17 pages 1-9 Assay Info 1-4
51. Geologic Log Phillips Hole DDH#18 pages 1-6 Assay Info 1-3
52. Geologic Log Phillips Hole DDH#19 pages 1-5 Assay Info 1-14
53. Geologic Log Phillips Hole DDH#20 pages 1-13 Assay Info 1-4
54. Geologic Logs for Holes: DDH#1, DDH#4, DDH#5, DDH#6, DDH#7, DDH#8, DDH#9, DDH#10, DDH#12.
55. Map, Main Leuel, Squaw Peak Mine Map 1967.
56. Molybdenum Geochemical Contour Map Jan-Feb 1969
57. Mercury Geochem Contour Map - Jan. & Feb. 1969
58. Linc - Jan & Feb. 1969
59. Copper - Jan. & Feb. 1969
60. Copper Molybdenum Histogram Diamond Drill Hole #1
61. Copper Molybdenum Histogram Diamond Drill Hole #3
62. Copper Molybdenum Histogram Diamond Drill DDH#4
63. Copper Molybdenum Histogram DDH#6
64. Copper Molybdenum Histogram DDH#7
65. Copper Molybdenum Histogram DDH#8
66. Copper Molybdenum Histogram DDH#9
67. Copper Molybdenum Histogram DDH#16
68. Copper Molybdenum Histogram DDH#18
69. Map Main Tunnel Workings - Squaw Peak Mine - Camp Verde, Arizona
70. Squaw Peak Mine Composite Leuel Map
71. Report on Squaw Peak Copper Mine by JM Hill - 10-19-49
72. Reflection of Seismic Investigation of Subsurface Geology and of Squaw Peak District, for Phillips,, by JW Cooksley, Jr. Oct. 1971.
73. Hanna Mining Company - Results of Geologic investigation to Phillips Jan. 8, 1972.
74. McPhar Polarization and resistivity survey for Phillips - Maps same July 15, 16, 1970.
75. 1972 Final Report Squaw Peak Mine Job no. MD-1064 M R Sauvola May 26, 1972.
76. Aerial Photos dated Oct. 17, 1967:

1-04	2-03	3-01	6-11
1-05	2-04	4-11	1-06 (2)
2-06 (2)	5-12	1-07	2-07
6-01	2-02	2-08	6-10
77. Progress Report I Million 8-2-68
78. Progress Report MR Sauvola Jan 1971.
79. Report on Cu Mo Deposit RT Forest and SB Gardner Jan 1969.
Job no. MD-1064

Inventory of Property of Squaw Peak Mining Company, data on loan to ESSEX
Dated: September 12, 1975 (CONTINUED)

80. Progress report SP Cu. Mo. Deposit Forest and Sauvola - Aug. 1969
Job no. MD 1064
81. Claim Map March 1969.
82. Letter to Forest from Sauvola re Proposed Exp. Project. 1-21-72.
83. Progress Reports from May 1967 to April 1972.
84. Geologic Log Phillips RDH#1 7-12-68
85. Progress report #3 Horacio Franco Oct. 8, 1971.
86. Map of Squaw Peak Mine Main level.
87. Geology Map, Phillips sheet 6 of 9.
88. Section A-A - Squaw Peak Mine, Aug. 69 report
89. Geology Map - Squaw Peak District from October 67 photos.
90. Geologic Map of Squaw Peak Area 1967.
91. Claim Map Squaw Peak Mine traced from print March 9, 1956.
92. Claim map Squaw Peak Mine traced from print Mar. 9, 1956.
93. Mo. Geochem Contour Map, Jan. & Feb. 1969.
94. Section 4 - Squaw Peak Mine 4-29-71.
95. Topo Map Squaw Peak District - sheet 5 of 9 sheets.
96. Topo Map Squaw Peak District - sheet 5 of 9 sheets.
97. Statement for rent of D7 and Grader, McDonald Bros. Const. 5-1-73.
98. Topo Map Squaw Peak District - sheet 5 of 9 sheets.
99. Topo Map Squaw Peak District - sheet 5 of 9 sheets.
100. Letter Phillips to Squaw Peak Copper Mining Co. releasing option.
101. Verde Valley Chamber of Commerce Historical Map.

(1)

Inventory of Property of Squaw P. Mng. Co.
Date on loan to Essex.

- 1) DRILL Logs - Phillips Petroleum Co.
- 2) Induced Polarization - Geopex Report -
Nov. 1968.
- 3) Phillips Petroleum Company - ~~Minerals Division~~
~~Reno, Nev. office - Squaw Peak District -~~
~~Sheet 5 of 9 sheets.~~
- 4) Phillips Petro. Company - ~~Bartlesville, Okla.~~
~~Exploration & Production Dept. - Minerals Div.~~
~~Section 3 - Squaw Peak Mine - Yavapai County~~
- 5) ~~Minerals Division, Reno, Nev. office, Job~~
~~number MD 1064-1065 - Squaw Peak Dist.~~
~~Yavapai County, Ariz. Sheet 5 of 9 sheets.~~
- X6) Squaw Peak Mine - Section B-B'; Yavapai
County; August 1969 Report.
- X7) Squaw Peak Mine - Section A-A'; Yavapai
County; August 1969 Report.
- X8) Minerals Division - Reno, Nev. office;
Job no. MD 1064-1065; Squaw Peak Dist.
Dated 6-11-71.
- X9) Bartlesville, Okla. Exploration & Production
Map; Claim Map; Squaw Peak Project;
- X10) Squaw Peak Mine - Section 5; Minerals
Division.
- X11) Squaw Peak Mine - Section 6; Minerals
Division.
- X12) Squaw Peak Mine - Section 7; Minerals Div.
- X13) Squaw Peak Mine - Section 8; Min. Div.
- X14) Squaw Peak District, Minerals Div.

(2)

S.L.C. Utah office; JOB No. MD 1064-1065;
Sheet 9 of 9 sheets.

X15) Squaw Peak District - S.L.C. Utah office;
Sheet 8 of 9 sheets; JOB No. MD 1064-1065.

X16) Squaw Peak District - S.L.C. Utah office;
JOB No. MD 1064-1065; Sheet 7 of 9 sheets

X17) Squaw Peak District - S.L.C. Utah office;
JOB No. MD 1064-1065; Sheet 6 of 9 sheets

X18) Squaw Peak District - Reno, Nev. office;
Sheet 5 of 9 sheets.

X19) Squaw Peak District - Reno, Nev. office;
Sheet 4 of 9 sheets.

X20) Squaw Peak District - S.L.C. Utah office;
Sheet 3 of 9 sheets;

X21) Squaw Peak District - S.L.C. Utah office;
Sheet 2 of 9 sheets;

X22) Squaw Peak District - S.L.C. Utah office;
Sheet 1 of 9 sheets;

X23) Squaw Peak Mine - Section 5 - Yavapai
County, Arizona.

X24) Squaw Peak District - Sheet 2 of 9 sheets
Drill Hole Location.

X25) Horner Mtn; Arizona; 1967;
N3422.5 - W11145/7.5

26) Squaw Peak Mine - Section 4, Yavapai
County, Arizona, Minerals Division.

27) Squaw Peak Mine - Section 7, Yavapai
County, Arizona; Minerals Division.

(3)

- X(28) Squaw Peak Mine - Section 6, Yavapai County, Mineral Division.
- X(29) Squaw Peak District - Sheet 5 of 9 sheets; Reno, Nevada office.
- X(30) Squaw Peak District - Sheet 5 of 9 sheets, Reno, Nevada office.
- X(31) Squaw Peak Mine - Section 3; ~~Bartlesville, Oklahoma.~~
- X(32) Squaw Peak Mine - Section 8; ~~Bartlesville, Oklahoma, Phillips~~ 8-19-71 Dwa #0002
- X(33) Squaw Peak District - Geologic Map, ~~Reno, Nevada office~~ - Sheet 5 of 9 sheets
Rev Jan 1969
- X(34) Geologic Log Phillips Hole #1, Date Completed 3/28/68
Pg 1-9, Assay info pg 1-3
- Two copies X(35) Geologic Log Phillips Hole DDH #2, Date Comp 5-28-68
pg 1-8 Assay info (1 pg) 2 copies
- X(36) Geologic Log Phillips Hole DDH #3 pg 1-5
Assay info pg 1-2
- X(37) Geologic Log Phillips Hole DDH #4 pg 1-7 Assay Info 1-3
- X(38) Geologic Log Phillips Hole DDH #5 pg 1-6
Assay info pg 1-2
- X(39) ditto Hole DDH #6 pg 1-8 Assay info, page 1-3
- X(40) ditto Hole DDH #7 pg 1-5 " pg 1-2
- X(41) ditto Hole DDH #8 pg 1-5 " pg 1-2
- X(42) ditto Hole DDH #9 pg 1-7 " pg 1-3
- X(43) ditto Hole DDH #10 pg 1-6 " pg 1-2
- X(44) ditto " DDH #11 pg 1-8 none

(4)

				Pages	Assay Info
45)	Geologic Log	Phillips	Hole DDH #12	1-10	1-4
46)	"	"	" #13	1-10	1-4
47)	"	"	" #14	1-8	1-4
48)	"	"	" #15	1 only	none
49)	"	"	" #16	1-8	1-4
50)	"	"	" #17	1-9	1-4
51)	"	"	" #18	1-6	1-3
52)	ditto		#19	1-5	1-14
53)	"		20	1-13	1-4

54) Geologic Log for Holes:

#1, DDH #4 DDH #5 DDH #6
DDH #7 DDH #8 DDH #9 DDH #10
DDH #12

X 55) map, main level, Square Rock mine
May 1967

X 56) Molybdenum Geochemical Contour
map Jan Feb 1969

X 57) Mercury Geochem. Contour map
Jan Feb 1969

X 58) Zinc ditto
Jan Feb 1969

X 59) Copper ditto
Jan Feb 1969

X 60) Copper Molybdenum Histogram
Diamond Drill Hole #1

X 61) ditto

X 62) ditto #3

X 62) ditto
DDH #4

(3)

- X (63) Copper Molybdenum Histogram
DDH #6
- X (64) ditto _____
DDH #7
- X (65) ditto _____
DDH #8
- X (66) ditto _____
DDH #9
- X (67) ditto _____
DDH #16
- X (68) ditto _____
DDH #18
- X (69) Map Main Tunnel Workings
Squaw Peak Mine
Camp Verde, Az
- X (70) Squaw Peak mine Composite Level
map
- X (71) Report on Squaw Peak Copper
mine by John Hill Oct 19 1949
- X (72) Reflection of Seismic Investigation
of Subsurface Geology E of Squaw
Peak District, for Phillips, by
J W Cooksey, Jr, Oct 1971
- X (73) Hanna Mining Company letter &
results of geologic investigation
to Phillips Jan. 8 1972
- X (74) McPhar Polarization &
resistivity survey for Phillips
Maps same July 15, 16, 1970

X 75) 1972 Final Report Lg Pk Mine
Job no MD-1064 M R Sauvola
May 26, 1972

X 76) Aerial Photos dtd Oct 17, 1967
1-04 1-05 1-06(2) 1-07 2-02
2-03 2-04 2-06(2) 2-07 2-08
3-01 4-11 5-12 6-01 6-10
6-11

X 77) Progress Report I Million 8-2-68

X 78) " " M R Sauvola Jan 71

X 79) Report on Cu rno Deposit
R T Forest + S B Gardner
Jan 69 Job no MD-1064

80) Prog rpt SP Cu rno Deposit
Forest + Sauvola Aug 1969
Job no MD 1064

81) Claim Map March 1969

82) Ltr to Forest from Sauvola
re Proposed Exp. Project
Jan 21, 1972

83) Progress Reports from May 1967
to April 72

84) Geologic Log Phillips RDH #1
7-12-68

85) Progress rpt #3 Horacio Frances,
Oct 8, 1971

86) ^{MAR} Lg Pk Mine Main level

87) Geology maps, Phillips sheet 6 of 9

- (88) Section A-A Lg Pk mine
Aug 69 Report
- (89) Geology Map Lg Pk District
from October 67 photos
- (90) Geologic Maps Lg Pk Area 1967
- (91) Claim Map Lg Pk Mine
traced from print dtd Mar 9, 1956
- (92) Claim map ditto
- (93) mo Geochron Contour Map
Jan Feb 1969
- (94) Section 4 Lg Pk mine 4-29-71
- (95) Topo map Lg Pk District
sheet 5 of 9 sheets
from photos Oct 67
- (96) same
- (97) Statement for rent of D7 +
Graders, McDonald Bros
Costr May 1 1973
- (98) same as 96 + 95
- (99) ditto
- (100) ltr Phillips to Lg Pk Copper
Mining Co releasing option
- (101) Verde Valley C of C.
Historical Map

AN AFFILIATE OF

Rio Algom
Rio Tinto

March 3, 1975

Mr. Grover Heinrichs
Manager of Exploration
Essex International Inc.
1704 W. Grant Road
Tucson, Arizona 85705

Dear Mr. Heinrichs:

I would confirm the substance of our telephone conversation of Friday, February 28th, 1975, in respect to the Squaw Peak Property, Yavapai County, Arizona.

It is my understanding that you have authorized Pangea Resources, Inc., on behalf of Atlas Alloys, Inc., to carry out an on-site examination of the Property. This examination will be on a free and non-exclusive basis for a period of 60 days, terminating April 19th, 1975.

On termination of the period referred to above, or shortly thereafter, Atlas Alloys, Inc., will present Essex International with an offer for the property, provided that the results of our examination are favorable.

Yours very truly,

RIOAMEX
A Division of Atlas Alloys, Inc.

M. B. Mehrtens

M. B. Mehrtens
Regional Manager

MBM/skk

cc: H. W. Marsh
T. W. Mitchum

3. Pangea will have the right to withdraw on 90 days notice after the initial 60 days if the \$10,000 is paid.
4. \$80,000 to be paid by Pangea for an 80% interest two years after the signing of the agreement.
5. If the option is exercised Essex will retain a 20% participating interest in the development.
6. If Pangea does not continue all data will revert to Essex International.

It is anticipated that Pangea will have the Letter of Intent and Agreement completed for Essex's review and signature the second or third week of February.

Since a \$10,000 payment is due on the Squaw Peak agreement on February 20, 1975, an RFA is being submitted to maintain the agreement for Essex. If Pangea does not continue with the terms of the agreement, it is felt that a similar agreement can be negotiated and signed with another company.

Geological and Engineering reports on the Squaw Peak property are in the Essex Tucson files.

PE:td

STATUS REPORT

SQUAW PEAK COPPER PROPERTY Yavapai County, Arizona

February 8, 1975

Paul Eimon

The Squaw Peak copper property was optioned by Essex International, Inc. in August of 1973 from the Squaw Peak Mining Company under extremely favorable option terms. Subsequently Essex International, Inc. has spent approximately \$75,000 in drilling, geological studies, engineering analysis and option payments to explore and evaluate the property.

This exploration and evaluation showed tentative mineable reserves of 11,658,000 tons averaging 0.42% copper with 0.076 ounces per ton of silver, and 0.002 ounces per ton of gold. The stripping ratio of this reserve is 1.02/1. In addition, exploration potential for further ore development does exist.

In line with Essex International's intention to "phase down" their mining exploration activities while protecting Essex International's investments and position, an option on Essex's rights at Squaw Peak is being negotiated with Dr. Thomas Mitcham, Vice President, Pangea Resources, Inc.

Pangea conducts mineral exploration in the Southwest for Rio Tinto Canadian Exploration. Rio Tinto Canadian is a subsidiary of Rio Tinto-Zinc Corporation, London, England.

Pangea Resources, Inc. is preparing a Letter of Intent and Agreement by which Pangea Resources, Inc. will option 80% of Essex's rights to Squaw Peak under the following terms.

1. \$10,000 to be paid to Essex 60 days after signing of the agreement to continue the agreement.
2. Pangea will assume all obligations of the Essex option until the option is exercised or dropped.

PROPERTY AGREEMENT SUMMARY

Feb. 11, 1974

Squaw Peak Project
Squaw Peak Mining District
Yavapai County, Arizona
Portions of:
Sec. 23, 24, 25 T.13N., R.4E.
Sec. 19, 20, 21, 28, 29, 30, 31, 32, 33 -
T.13N., R.5E.

Claims:

138 unpatented claims including 6 millsite claims.

Owner: Squaw Peak Mining Co., P.O. Box 6, Camp Verde, Ariz. *Copper*

Effective date of Agreement: Aug. 20, 1973.

Payments

\$ 2,000.00	Down	<i>pd.</i>		
10,000.00	Feb. 20, 1974	<i>pd.</i>	\$10,000.00	Feb. 20, 1978
10,000.00	" " 1975		10,000.00	" " 1979
10,000.00	" " 1976		10,000.00	" " 1980
10,000.00	" " 1977		10,000.00	" " 1981

*Not deductible
from purchase
price*

Purchase price: \$1,000,000.00 at rate of
\$ 250,000.00 down at no interest
\$ 250,000.00 1st yr. thereafter @ 5½%
interest per annum and \$250,000.00
each year thereafter @ 5½% int./yr.
OR CAN BE PD. LUMP SUM

Term of agreement: 8½ years

<u>Work Commitment</u>	<u>&</u>	<u>Minimum Expenditures Required</u>
\$10,000.00 Sept. 20, 1973		thru Feb. 19, 1974
10,000.00 Feb. 20, 1974		thru Feb. 19, 1975
10,000.00 " 20, 1975		Thru " 19 1976
10,000.00 " " 1976		Thru " " 1977
20,000.00 " " 1977		Thru " " 1978
20,000.00 " " 1978		Thru " " 1979
20,000.00 " " 1979		Thru " " 1980
20,000.00 " " 1980		Thru " " 1981
20,000.00 " " 1981		Thru " " 1982.

*Minimum Annual Exploration payments are \$10,000 cash
plus \$10,000 work,*

*Upon decision to mine the purchase cost will be \$1,000,000 or
\$250,000 @ 5½% interest per year for 4 yrs:*

Yr 1	- \$291,250	Total:
Yr 2	- \$277,500	\$1,082,500
Yr 3	- \$263,750	
Yr 4	- \$250,000	

PANGEA RESOURCES, INC.
2002 N. FORBES BLVD. #101
TUCSON, ARIZONA 85705

Dr. Thomas Mitcham, Vice President

Letter of intent and agreement
60 day ~~opt~~ \$10,000
assume all obligations of agreement
~~2~~ 90 days notice ~~to drop~~
2 years \$80,000 for 80%
interest

Essex to retain 20% interest.

All data to return.

19896

W

~~19896 - 129~~
~~1756 - 229~~
22000

Ernst International
Legal Registry

E. Hoover Heinrich,

~~18~~
358
19896

20247
104

20341

13
2

26
4

104

Squaw Peak File

8-25-75
1

Missing

2020640

2, 3, 4, 6

34

41 & 43

30
8
240
250

79 - 13 pages missing

84 - ~~3~~ maps
3

20771
35
20806

20719
52
20771

Recommendations

If current exploration indicates a tonnage and grade high enough to suggest the possibility of a profitable mining operation additional development work will be proposed. If proposed, this additional development work will cost \$150,000 to \$200,000 and will require 6 months to complete. Upon completion the data would be sufficient to undertake financial and engineering analysis that could indicate a capital investment requirement of \$20 to 35 million to bring the mine into production.

a v o

TO Howard Lanier LOCATION Ft. Wayne, Ind.
 FROM Don P. Bellum LOCATION Tucson, Ariz.
 SUBJ. Squaw Peak Ore Reserves DATE March 1, 1974

C
O P. Eimon
P
Y L. Lichty
T
O

As part of the evaluation of Squaw Peak a preliminary mining plan has been developed and mining ore reserves have been calculated. These reserves are developed on the basis of a 0.30% Cu cut-off and include all the sample data on drilling completed to date. The cut-off grade is based on the expected production costs which will be verified during the evaluation. The configuration of the orebody makes it possible to mine a higher grade ore in the initial years of production and the mining has been planned in two phases.

Squaw Peak Ore Reserves

<u>Phase</u>	<u>Ore Tons</u>	<u>% Cu</u>	<u>% Mo</u>	<u>Waste Tons</u>	<u>Strip Ratio</u>
1	8,486,000	0.44	0.21	5,013,000	0.59/1
2	3,172,000	0.36	0.21	4,001,000	1.26/1
Total	11,658,000	0.42	0.21	9,014,000	0.77/1

The molybdenum content is the average of drill holes SP-1, SP-2, SP-4, and SP-6 only. The gold and silver content of 0.002 oz. per ton and 0.026 oz. per ton, respectively, will have little affect on the value of the ore. The laboratory test work has been completed on 20 samples comprising the above drill holes and it is estimated that average recovery of 82% for copper, 55% for molybdenum, and 50% for the gold and silver can be expected.

DPB

DPB:td

Recommendations

If current exploration indicates a tonnage and grade high enough to suggest the possibility of a profitable mining operation additional development work will be proposed. If proposed, this additional development work will cost \$150,000 to \$200,000 and will require 6 months to complete. Upon completion the data would be sufficient to undertake financial and engineering analysis that could indicate a capital investment requirement of \$20 to 35 million to bring the mine into production.

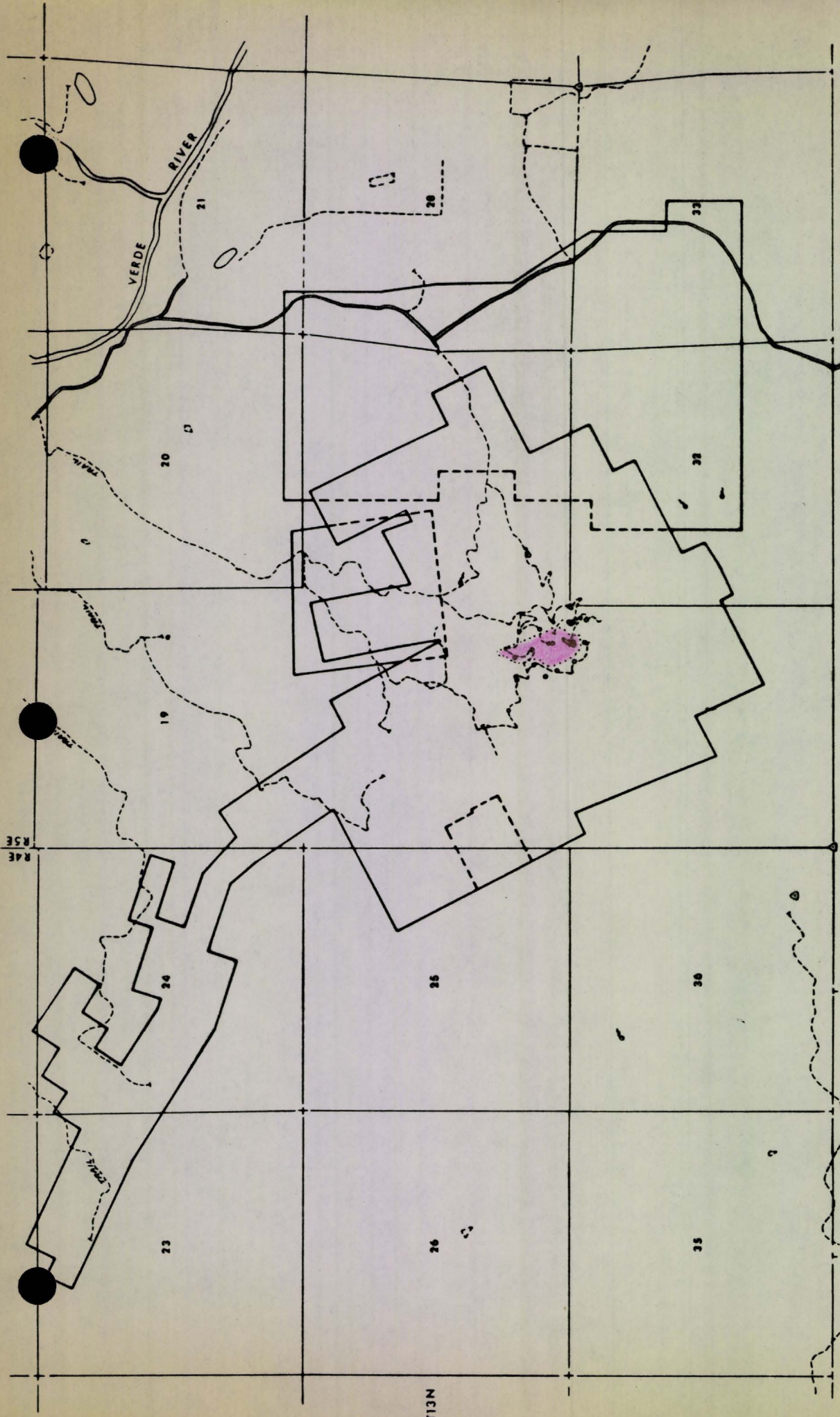

ESSEX

MINERAL INTERNATIONAL, INC.
THE WEST GARDEN RD. TULSON, ARIZONA 85701
PHONE 808-541-7401

PROJECT: SQUAW PEAK
PROSPECT NUMBER:
COUNTY, STATE: YAVAPAI, ARIZ.
T. R. & SECTION T13N: R4E, 3E
LATITUDE, LONGITUDE:

INDEX MAP

SCALE: 2" = 1 MI.
DATE: 9/19/73
DATA BY: PHILLIPS PET.
PREPARED BY: ATC

L E G E N D

ESSEX CLAIM BOUNDARY

UNPATENTED LODGE CLAIMS

MINERALIZED ZONE

MAIN ROADS

TRAIL ROADS



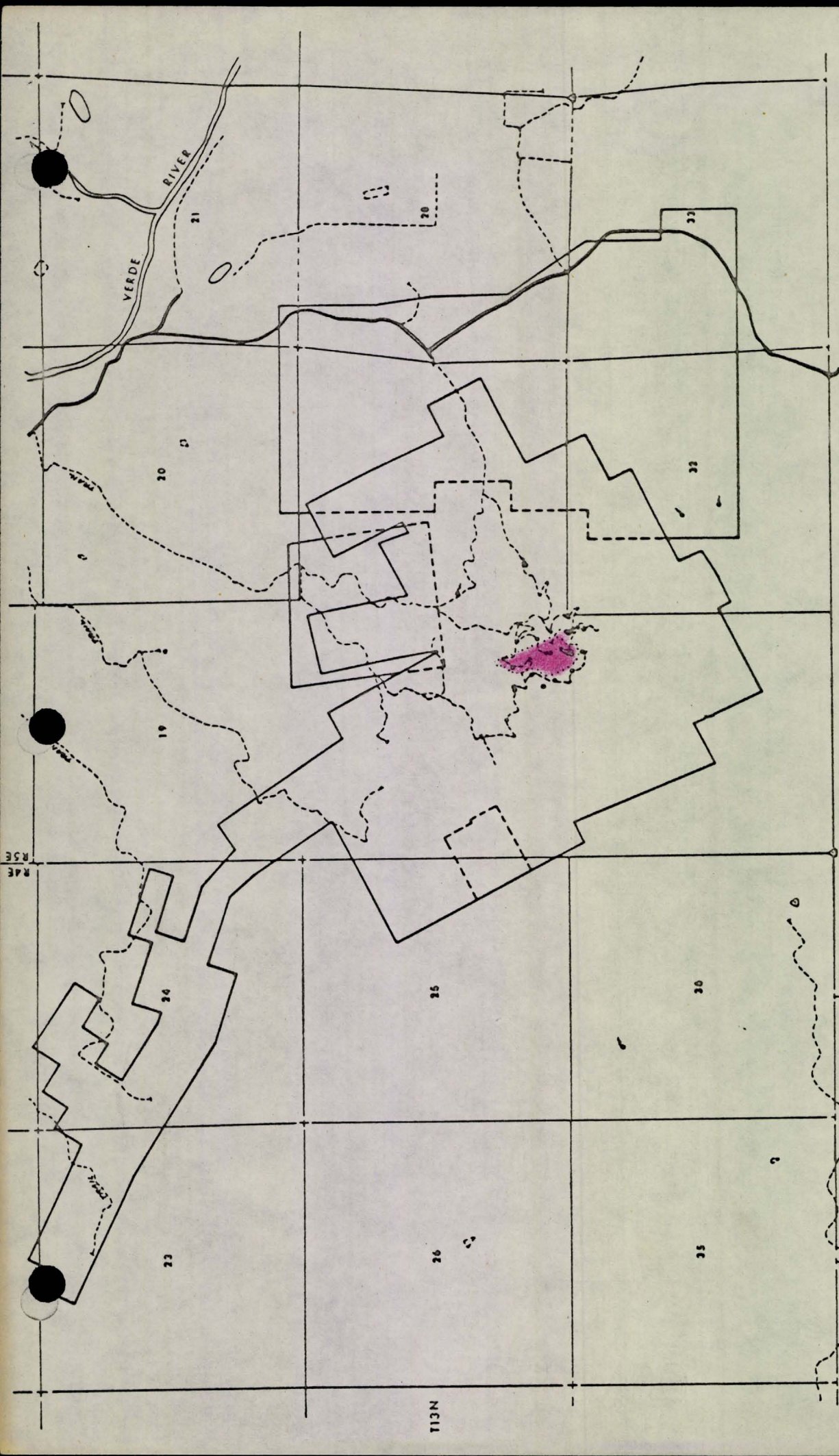

ESSEX

PROJECT SQUAW PEAK	
PROSPECT NUMBER	
COUNTY, STATE YAVAPAI, ARIZ.	T. 13 N. R. 4 E. S. 1 E
LATITUDE, LONGITUDE	
INDEX MAP	
SCALE 2" = 1 MI.	DATE 9/19/73
DATE BY PHILLIPS PET.	PREPARED BY ATC

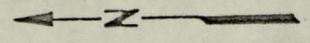

- L E G E N D**
- ESSEX CLAIM BOUNDARY
 - UNPATENTED LODGE CLAIMS
 - MINERALIZED ZONE
 - MAIN ROADS
 - TRAIL ROADS

Squaw Peak Project

Proposed Terms

1/8/75

\$30,000 down in 30 days

\$300,000.00

buyer will receive all data representing value of estimated
20,000 per year ^{rental} will not apply to purchase price.

10,000 per year work commitment for 75 & 76

20,000 " " " " " 77 thru 82

Purchase Price \$2,000,000.00

+ overriding royalty 5% N.S.R.

OR 1st call on copper produced at
less 1¢/lb. market price is established by EMS
at date of sale.

11,000,000 0.4 8th

\$8,000,000 # Cas

2

1/15/75

Paul -

Enclosed is a list
of the data on Squaw
Peak which I
removed from your office
for study on 1/14/75

Arthur R. Stettin

AKS - List of materials
Removed From Essex Office re
Squaw Peak - 1/14/75

Reports

- 1) Report by R. Roe of July 1974 - bound, 18pg - black cover
- 2) "Squaw Peak Evaluation Report" by DP Bellum - May 8, 1974
- 3) Pencil notes by DPB 3/15/74 "Estimate of Squaw Peak Production Costs" - 2pg
- 4) "A Potential Deep Exploration Target at Squaw Peak" - 1pg typed w/ sketch
- 5) "Squaw Peak Concentrator Design Criteria", by DP Bellum, 2pg plus floor sheet
- 6) "Squaw Peak Copper Property" a two page typed summary - no name or date

Maps:

- 1) "Composite" - 1" = 100' showing outline of +0.2% Cu + +0.2% composite hole intercepts.
- 2) "Squaw Peak" Pit Plan by DPB 2/22/74 (pencil on 1" = 100' plan format)
- 3) 1 set 8 1/2 x 11" Cu, Mn & Zn geochem maps,
- 4) 1 set " " level plan map of UG workings
- 5) 1 set " " "Cooksey" generalized geologic X Sec
- 6) 1 set of "Clean" Essex West X-Secs 7600, 7800, 8000, 8400, 8600 and 8800N (note 8200 missing)
- 7) 1 set same as above but w/ color grade code & "ore" outlines (including 8200N)

Taken by ARS - 1/14/75 - re Square Peak

pg 2

- 8) 1 ea 1:12000 "Merl Map of Square Peak Area" (clean)
- 9) 1 ea 1"=100' Square Peak mine (drill hole plan map)
- 10) 1 ea ~~Merl~~ Merl X sec's A-A', B-B' C-C' (1:12000)
- 11) 1 ea sec C-C' & D-D' (1"=200'?)
- 12) 1 ea " D-D' & E-E' (1"=200')
- 13) 1 ea "Map of Main Tunnel workings (1"=25') (reprint of ^{old} US map)
- 14) 1 ea colored copper geochron (1"=200' - sheet "5" of 9)
- 15) 1 ea 1"=200' sheets "5" of 9 (1 clean, the others all show something different)
- 16) 1 ea of 1"=200' sheets 1, 2, 3 & 4

Files (all in blue file folders):

- 1) 1 ea drill logs for holes SP-1 thru 19, incl.; DDH's 1, 3 thru 10, 12 thru 14, and 16-20.
- 2) Petrography
- 3) USFS
- 4) assay comparisons
- 5) Reports by others
- 6) Soil maps
- 7) Ore Res Calc

SQUAW PEAK COPPER PROPERTY

Yavapai County, Arizona

History, Development

In August 1973 Essex negotiated an 8½ year option on mining property of the Squaw Peak Copper Mining Company in Yavapai County, Arizona. Since August Essex has conducted geologic mapping and drilling as the initial portion of a program to evaluate the commercial potential. Intermittent exploration has been conducted by various parties since the late 1800's, but to date has not indicated great enough tonnage at a high enough grade to sustain a mining operation. Exploration by Phillips Petroleum immediately prior to Essex's entry indicated a reasonable possibility for 30 million tons of ore containing .36% copper and .013% molybdenum.

Geology

Mineralization occurs mostly in pre-Cambrian granodiorite intruded by a small quartz monzonite porphyry plug and cut by northwest trending dikes, faults, and breccia dikes. The mineral assemblage includes the alteration minerals clay, sericite, orthoclase, and biotite and the sulfide minerals chalcopryite, pyrite, and molybdenite, and resembles the assemblage that would occur in the deeper portion of a porphyry copper deposit. Persistent disseminated and fracture controlled mineralization is indicated in an area approximately 1600 feet long and 800 feet wide. More or less persistent sulfide mineralization occurs from a few feet below the surface to as deep as 850 feet in some drill holes.

Results to Date

Geologic mapping and assay results from the August-September drilling have confirmed an exploration target with a tonnage potential in the range of 10 to 30 million tons at a grade of .30 to .50% copper with significant molybdenum content. Drilling is underway at present under RFA 335-48 which provides for about 3200 feet of hammer drilling to obtain additional grade and tonnage data within the mineralized body. In addition to current work 6000 feet or more drilling will be necessary to confirm an ore reserve sufficient to support a 4000 to 10,000 ton per day mining operation. Assay returns from work in progress will be available in mid-January 1974.

Rio Algom
Rio Tinto

March 7, 1975.

Mr. Grover Heinrichs,
Exploration Manager,
Essex International Inc.,
1704 West Grant Road,
Tucson, Arizona 85705,
U.S.A.

Dear Mr. Heinrichs:

Your letter of February 17 was received today. Unfortunately we are having some labour strike problems that have disrupted our mail service and thus the long delay.

In the meantime, however I understand that both Pangea and our Denver office have replied to your letter and that all is in hand. Particularly, I understand that Mike Mehrtens has explained that we wish to examine the Squaw Peak prospect without commitment at this time on the part of either party.

Yours very truly,

RIO TINTO CANADIAN EXPLORATION LIMITED

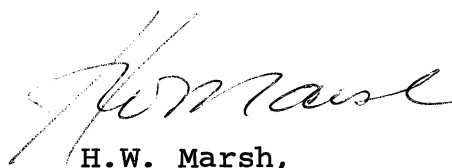
H.W. Marsh,
Exploration Manager.

HWM:ad

ESSEX

ESSEX INTERNATIONAL, INC.

METALLURGICAL & MINING DIVISION

1704 WEST GRANT RD., TUCSON, ARIZONA 85705 • PHONE (602) 624-7421

February 17, 1975

Mr. H. W. Marsh
General Manager
Rioamex
120 Adelaide Street West
Toronto 1, Ontario, Canada

Re: Squaw Peak Project
Yavapai County, Arizona

Dear Mr. Marsh,

I am in receipt of your letter dated February 10, 1975 in which you indicate that Pangea Resources, Inc. (under the direction of Mr. A. Wandke and Dr. Tom Mitcham) is planning to examine our Squaw Peak Property in behalf of Rioamex.

Permission by Essex is hereby granted Pangea Resources, Inc. to have complete access to our Squaw Peak Property provided the following conditions are met.

- 1) Pangea verify by document that it is a corporation authorized to do business in the state of Arizona.
- 2) Please indicate in writing (Rioamex or Pangea or both) which corporation accepts liability relative to any acts of its employees or agents while on the Squaw Peak Property.
- 3) Also I would like a "Save harmless" statement from the responsible corporation with a certificate of insurance coverage from your insurance agent.
- 4) A written confirmation that the free 60-day period will commence on February 17, 1975 (the date your personnel will start their field examination) and will terminate on April 19, 1975. On April 20, 1975 a \$10,000 payment to Essex and an agreement executed by all parties will be in hand.

Via a copy of this letter I am informing Pangea of the conditions required by Essex in order to proceed to a mutually acceptable agreement.

ESSEX

ESSEX INTERNATIONAL, INC.

METALLURGICAL & MINING DIVISION

1704 WEST GRANT RD., TUCSON, ARIZONA 85705 • PHONE (602) 624-7421

Page 2
Squaw Peak Property

If you have any questions or wish to discuss any of the foregoing,
please let me know.

Very truly yours,

ESSEX INTERNATIONAL, INC.

E. Grover Heinrichs
Exploration Manager

EGH/bn

cc: Paul W. O'Malley
Richard Kelly
D. Letizia
Tom Mitcham
Al Wandke

PANGEA RESOURCES, INC.

EXPLORATION MANAGERS, GEOLOGIC & MINING CONSULTANTS

2002 N. FORBES BLVD., SUITE 101
TUCSON, ARIZONA 85705
(602) 623-6316

February 20, 1975

Mr. Grover Heinrichs
Manager of Exploration
Essex International, Inc.
1704 W. Grant Road
Tucson, AZ 85705

Dear Mr. Heinrichs:

In reply to item 1 of your letter of February 17, 1975, we attach a copy of Pangea's registration to do business in Arizona. With regard to items 2 and 3, Pangea fully accepts liability for any acts of its employees or agents while on the Squaw Peak property and agrees to hold Essex International, Inc. harmless from any lawsuits resulting from the actions of its employees. Our certificate of insurance will be forwarded to you directly by our insurance agent, Jacob C. Fruchthendler & Company.

Item 4 of your letter will have to be answered by Atlas Alloys, Inc., and I am sure you will receive their reply in the near future.

Very truly yours,

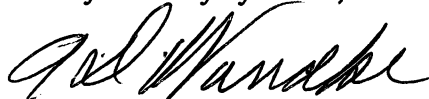
A. D. Wandke
President

ADW:mk

Attach.

cc: J. A. Sadler
M. B. Mehrtens
A. D. Wandke, CT

STATE OF ARIZONA

Corporation Commission



To all to Whom these Presents shall Come, Greeting:

THIS IS TO CERTIFY THAT PANGEA RESOURCES, INC.

A CORPORATION, ORGANIZED AND EXISTING UNDER AND BY VIRTUE OF THE LAWS OF THE
STATE OF NEVADA HAVING COMPLIED WITH THE LAWS OF THE
STATE OF ARIZONA GOVERNING THE ADMISSION OF FOREIGN CORPORATIONS, IS, BY
VIRTUE OF THE POWERS VESTED IN THE ARIZONA CORPORATION COMMISSION BY THE
CONSTITUTION AND THE LAWS OF THE STATE OF ARIZONA, HEREBY GRANTED THIS

LICENSE

TO TRANSACT BUSINESS IN THE STATE OF ARIZONA, AS PROVIDED BY LAW.

BY ORDER OF THE ARIZONA CORPORATION COMMISSION

IN WITNESS WHEREOF, I, AL FARON,

THE CHAIRMAN, HAVE HEREUNTO SET MY HAND
AND CAUSED THE OFFICIAL SEAL OF THE ARIZONA
CORPORATION COMMISSION TO BE AFFIXED AT THE
CAPITOL, IN THE CITY OF PHOENIX, THIS 13th
DAY OF JANUARY A. D. 1975.

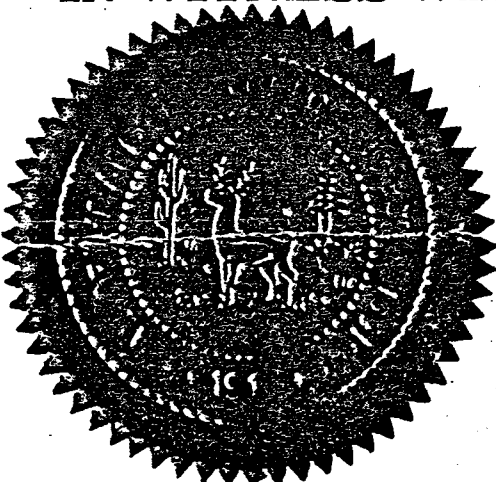

Al Faron
CHAIRMAN.

ATTEST:

George W. Hempery
SECRETARY

BY

ASSISTANT SECRETARY

No. F-18777

April 23, 1975

Mr. Evan Koblanski
Suite 7602 The Royal Centre
P.O. Box 11122
Vancouver, B.C.
Canada

Dear Mr. Koblanski:

Enclosed is a brief summary of the Essex Squaw Peak property. If the property sounds like something you might be interested in please let me know.

Very truly yours,

E. Grover Heinrichs
Exploration Manager

EGH:td
enclosure

April 23, 1975

**Mr. J A. Harquail
915 330 Bay Street
Toronto, Ontario
Canada**

Dear Mr. Harquail:

Enclosed is a brief summary of the Essex Squaw Peak property. If the property sounds like something you might be interested in please let me know.

Very truly yours,

**E. Grover Heinrichs
Exploration Manager**

**EGH:td
enclosure**

*Copy
sent to Koblanski
Hargrave*

SQUAW PEAK COPPER PROPERTY

Yavapai County, Arizona

History, Development

In August 1973 Essex negotiated an 8½ year option on mining property of the Squaw Peak Copper Mining Company in Yavapai County, Arizona. Since August Essex has conducted geologic mapping and drilling as the initial portion of a program to evaluate the commercial potential. Intermittent exploration has been conducted by various parties since the late 1800's, but to date has not indicated great enough tonnage at a high enough grade to sustain a mining operation. Exploration by Phillips Petroleum immediately prior to Essex's entry indicated a reasonable possibility for 30 million tons of ore containing .36% copper and .013% molybdenum.

Geology

Mineralization occurs mostly in pre-Cambrian granodiorite intruded by a small quartz monzonite porphyry plug and cut by northwest trending dikes, faults, and breccia dikes. The mineral assemblage includes the alteration minerals clay, sericite, orthoclase, and biotite and the sulfide minerals chalcopryite, pyrite, and molybdenite, and resembles the assemblage that would occur in the deeper portion of a porphyry copper deposit. Persistent disseminated and fracture controlled mineralization is indicated in an area approximately 1600 feet long and 800 feet wide. More or less persistent sulfide mineralization occurs from a few feet below the surface to as deep as 850 feet in some drill holes.

Results to Date

Geologic mapping and assay results from the August-September drilling have confirmed an exploration target with a tonnage potential in the range of 10 to 30 million tons at a grade of .30 to .50% copper with significant molybdenum content. Drilling is underway at present under RFA 335-48 which provides for about 3200 feet of hammer drilling to obtain additional grade and tonnage data within the mineralized body. In addition to current work 6000 feet or more drilling will be necessary to confirm an ore reserve sufficient to support a 4000 to 10,000 ton per day mining operation. Assay returns from work in progress will be available in mid-January 1974.

ESSEX

COOPER BEAR PL. EC
HARPA COUNTY, ARIZONA

12-73

SCALE: 1" = 650' APPROX.

SECTIONS 29, 30, 31, 32, T13N, R5E

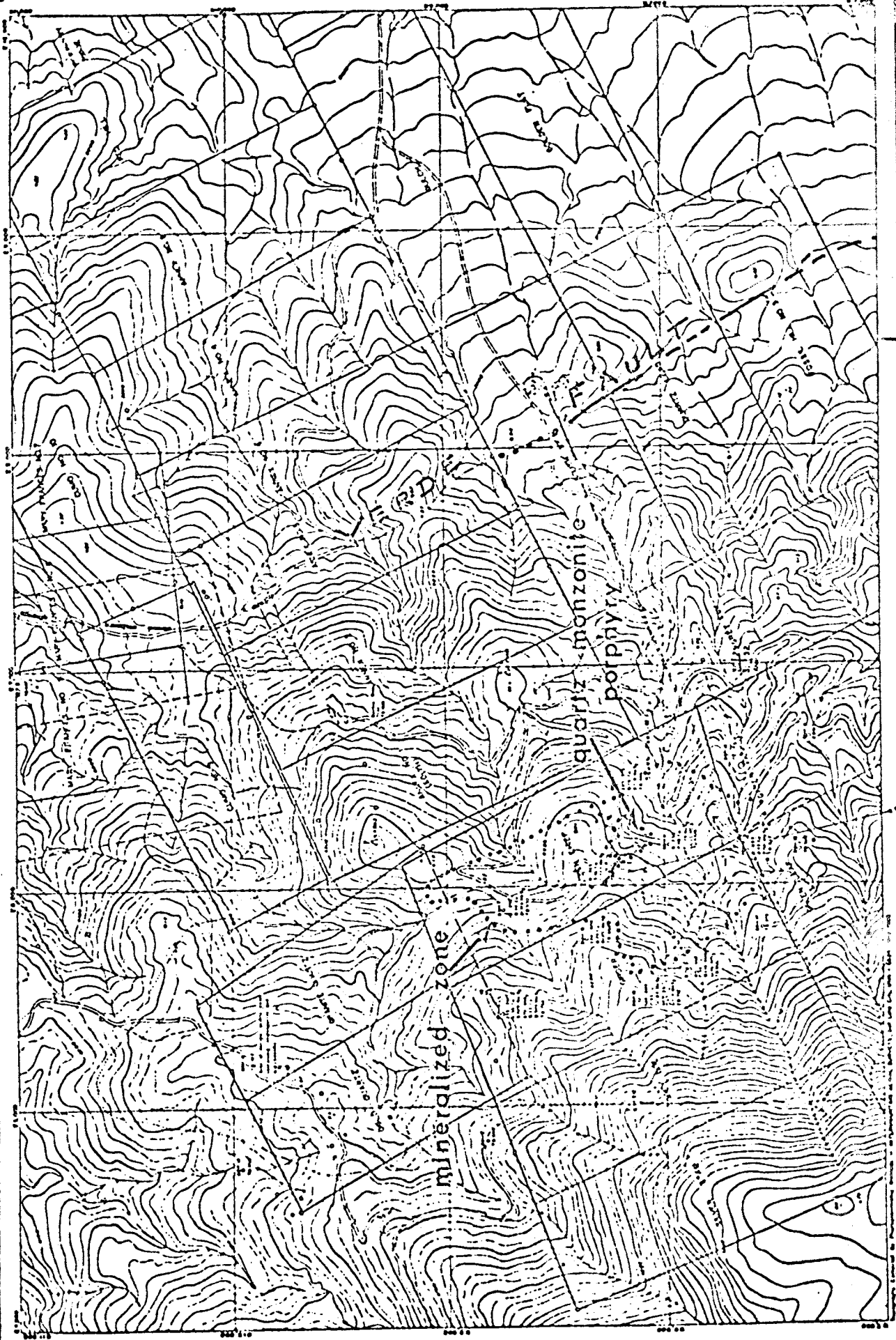

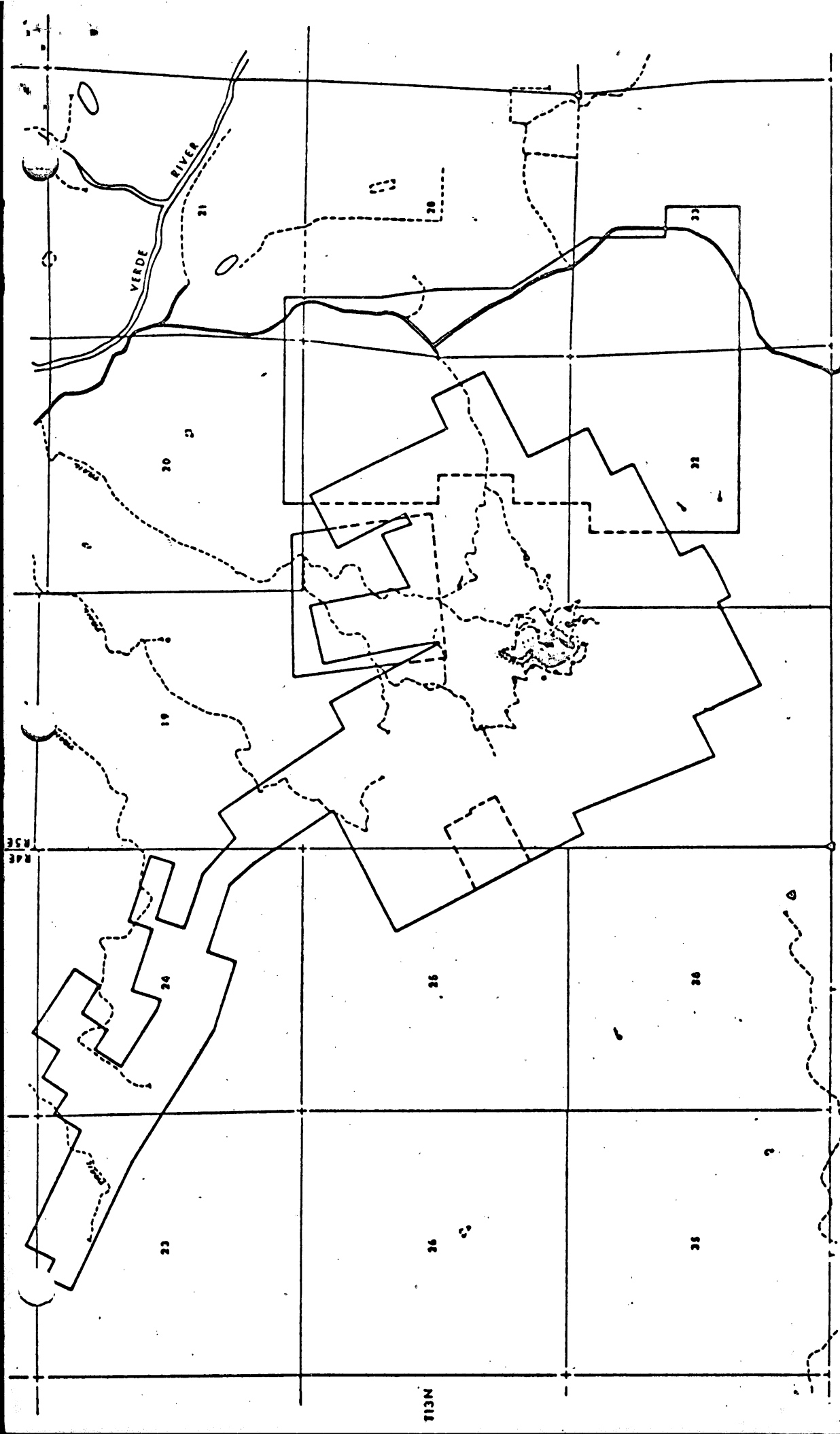

ESSEX

PROJECT		SQUAB PEAK	
NUMBER		YAVAPAI, ARIZ.	
COUNTY, STATE		T. 8 S. R. 4 E. S. 6 E.	
T. 8 S. R. 4 E. S. 6 E.		LATITUDE	
DATE		9/10/73	
DRAWN BY		PHILLIPS PET.	
PROJECTED BY		ATC	

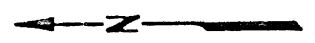

L E G E N D
 ESSEX CLAIM BOUNDARY
 UNPATENTED LOSE CLAIMS
 MINERALIZED ZONE
 MAIN ROADS
 TRAIL ROADS

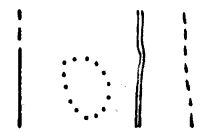

SQUAW PEAK COPPER DEPOSIT

Yavapai County, Arizona

The Squaw Peak copper-molybdenum deposit is located 8 miles south of Camp Verde, Yavapai County, Arizona, and is approximately 50 airline miles east of Prescott, the county seat.

Mining claims were located on this prospect as early as 1883, but first extensive work on the property was during World War II when a small amount of copper and molybdenum was produced and more than 4000 feet of underground workings were driven with help of a government loan. Although some fair grade copper was encountered, the average grade of samples from the underground workings was 0.35% copper, much too low grade to be considered economic at that time. In May 1967 Phillips Petroleum Company optioned the property from Squaw Peak Mining Company and undertook geological and geophysical investigations and drilling. In May 1973 Phillips terminated their option on the property after an exploration expenditure of \$269,736.

Phillips information indicates that 29,701,000 tons at a grade of 0.36% copper and 0.022% molybdenum were developed. Included in this total is 10,170,000 tons at 0.44% copper. Copper and molybdenum values occur almost entirely as sulphides, with chalcopyrite and molybdenite being the most common ore minerals.

Copper mineralization occurs in intrusive rocks ranging in composition from granite to quartz diorite. An age determination by

the potassium-argon method showed mineralized quartz diorite to be 1,643 million years old or pre-Cambrian age. Alteration and mineralization features at Squaw Peak resemble the root zone of a porphyry copper deposit. The age date is difficult to accept as all other known porphyry copper deposits in Arizona are younger than 163 million years. If the age date is an accurate representation of the age of mineralization this deposit would be geologically unique in the Southwest. Phillips' geologists clearly recognized the possibility of prospecting potential in the hanging wall of the Verde fault, a major structure that passes near the mineralization, as they conducted geophysical work in an attempt to determine depth of cover on the down-dropped side of the fault. However, they did not make any drill hole tests of the down faulted area. Additional geologic work will be necessary to evaluate prospecting potential in the area.

The Squaw Peak property contains a moderate tonnage of low grade copper-molybdenum mineralization. Some additional drilling is needed to confirm and block out mineralization, and geological work should be conducted to evaluate exploration potential. Although the copper grade indicated by prior development work is relatively low, some 214,000,000 pounds of copper are contained in the deposit.

Squaw

A POTENTIAL ^{Deep} EXPLORATION TARGETS AT SQUAW PEAK

1. DEEP TARGET DIRECTLY BELOW KNOWN OREBODY?

- current drilling information suggests that the ore zone "bottoms" at 250' to 400'
- "deep" orebody is untested (i.e. >1000')

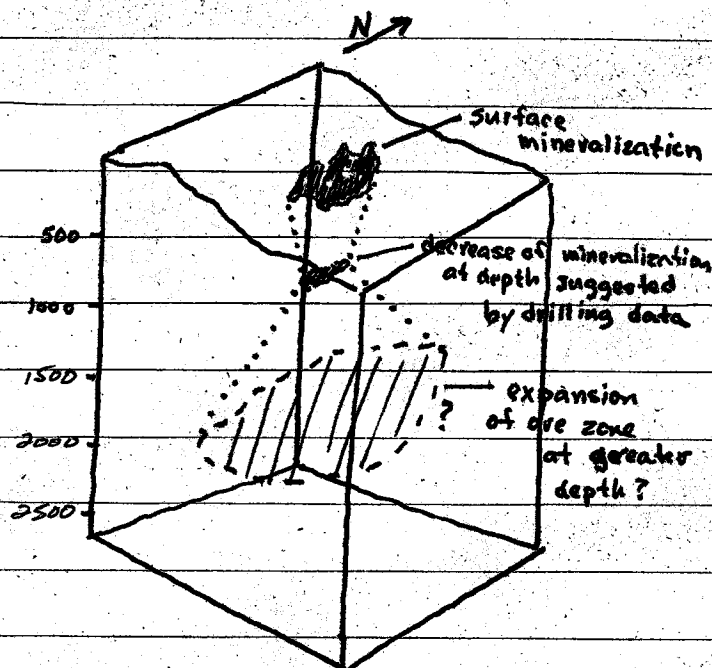

2. BRECCIA ZONE NNE from SQUAW PEAK MINE

- contains traces of Cu-mineralization at surface
- virtually untested
- surface examinations indicate that the zone is probably discontinuous
- untested

3. BRECCIA ZONE APPROX. 1 MI. NW from SQUAW PK. MINE

- PRESENCE OF Qtz Monz py dikes suggest same age as known mineralization
- Scattered Cu-mineralization in Qtz vns at surface
- also discontinuous
- untested

4. HANGINGWALL OF VERDE FAULT

- steepness of fault suggests that no significant portion of the orebody has been preserved; however, no drilling east of the fault has gone below Tertiary rocks.

SQUAW PEAK COPPER DEPOSIT

Yavapai County, Arizona

The Squaw Peak copper-molybdenum deposit is located 8 miles south of Camp Verde, Yavapai County, Arizona, and is approximately 50 airline miles east of Prescott, the county seat.

Mining claims were located on this prospect as early as 1883, but first extensive work on the property was during World War II when a small amount of copper and molybdenum was produced and more than 4000 feet of underground workings were driven with help of a government loan. Although some fair grade copper was encountered, the average grade of samples from the underground workings was 0.35% copper, much too low grade to be considered economic at that time. In May 1967 Phillips Petroleum Company optioned the property from Squaw Peak Mining Company and undertook geological and geophysical investigations and drilling. In May 1973 Phillips terminated their option on the property after an exploration expenditure of \$269,736.

Phillips information indicates that 29,701,000 tons at a grade of 0.36% copper and 0.022% molybdenum were developed. Included in this total is 10,170,000 tons at 0.44% copper. Copper and molybdenum values occur almost entirely as sulphides, with chalcopyrite and molybdenite being the most common ore minerals.

Copper mineralization occurs in intrusive rocks ranging in composition from granite to quartz diorite. An age determination by

the potassium-argon method showed mineralized quartz diorite to be 1,643 million years old or pre-Cambrian age. Alteration and mineralization features at Squaw Peak resemble the root zone of a porphyry copper deposit. The age date is difficult to accept as all other known porphyry copper deposits in Arizona are younger than 163 million years. If the age date is an accurate representation of the age of mineralization this deposit would be geologically unique in the Southwest. Phillips' geologists clearly recognized the possibility of prospecting potential in the hanging wall of the Verde fault, a major structure that passes near the mineralization, as they conducted geophysical work in an attempt to determine depth of cover on the down-dropped side of the fault. However, they did not make any drill hole tests of the down faulted area. Additional geologic work will be necessary to evaluate prospecting potential in the area.

The Squaw Peak property contains a moderate tonnage of low grade copper-molybdenum mineralization. Some additional drilling is needed to confirm and block out mineralization, and geological work should be conducted to evaluate exploration potential. Although the copper grade indicated by prior development work is relatively low, some 214,000,000 pounds of copper are contained in the deposit.

SQUAW PEAK COPPER DEPOSIT

Yavapai County, Arizona

The Squaw Peak copper-molybdenum deposit is located 8 miles south of Camp Verde, Yavapai County, Arizona, and is approximately 50 airline miles east of Prescott, the county seat.

Mining claims were located on this prospect as early as 1883, but first extensive work on the property was during World War II when a small amount of copper and molybdenum was produced and more than 4000 feet of underground workings were driven with help of a government loan. Although some fair grade copper was encountered, the average grade of samples from the underground workings was 0.35% copper, much too low grade to be considered economic at that time. In May 1967 Phillips Petroleum Company optioned the property from Squaw Peak Mining Company and undertook geological and geophysical investigations and drilling. In May 1973 Phillips terminated their option on the property after an exploration expenditure of \$269,736.

Phillips information indicates that 29,701,000 tons at a grade of 0.36% copper and 0.022% molybdenum were developed. Included in this total is 10,170,000 tons at 0.44% copper. Copper and molybdenum values occur almost entirely as sulphides, with chalcopyrite and molybdenite being the most common ore minerals.

Copper mineralization occurs in intrusive rocks ranging in composition from granite to quartz diorite. An age determination by

the potassium-argon method showed mineralized quartz diorite to be 1,643 million years old or pre-Cambrian age. Alteration and mineralization features at Squaw Peak resemble the root zone of a porphyry copper deposit. The age date is difficult to accept as all other known porphyry copper deposits in Arizona are younger than 163 million years. If the age date is an accurate representation of the age of mineralization this deposit would be geologically unique in the Southwest. Phillips' geologists clearly recognized the possibility of prospecting potential in the hanging wall of the Verde fault, a major structure that passes near the mineralization, as they conducted geophysical work in an attempt to determine depth of cover on the down-dropped side of the fault. However, they did not make any drill hole tests of the down faulted area. Additional geologic work will be necessary to evaluate prospecting potential in the area.

The Squaw Peak property contains a moderate tonnage of low grade copper-molybdenum mineralization. Some additional drilling is needed to confirm and block out mineralization, and geological work should be conducted to evaluate exploration potential. Although the copper grade indicated by prior development work is relatively low, some 214,000,000 pounds of copper are contained in the deposit.

7. SPI (x10) subhed. plag al, rel. fresh (1,2,4)
in microgran. text of
g, bt, Kspar, chlor

10. 12-5-B granitic text. (15/30/60)
Kspar, g, plag
(stud)

11. HB ~~subhed~~ twinned olivene x1 2,4,8
plag laths
magnetite

12. 19-204 calc vn offsets carb-g vn (1,2,4)
in P_{ear} - sub-par chlor grns
in micro base of ~~new~~ g series(?)

13. 3-570 bt → chlor ± 20 (1,2,B)

14. SPI (10x) alb rim on plag (1,2,4)

15. 1-452 ser repl. bt
(10x) " alt felds (1,2,4)

16. 1-591

frag.
sulf. in bt mass
in q + Kspar grm.

(1, 2 ~~3~~)

17. 1-993
(pl lt)

Znd. bt w/ sulf. (60, 125, 250)

18 1-993

alb. of plag xl
alt asso w/ q-ser-sul unit. (8, 15, 30)

19 6-254

sheared frag w/ chlor-zois (30, 30, 1, 2)
-sulf. alt (~~2, 3, 4~~)

20 19-204

Plag

(1, 2, +)

21 AP-2a

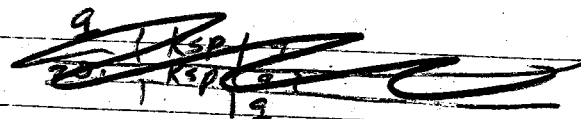

(1, 2 ~~3~~)

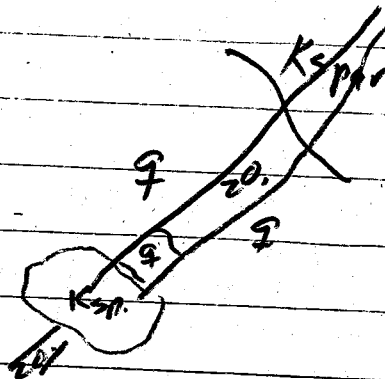

zois. vlt
w/ ~~cont~~
chem. controls

- ① 1-447 Kspar flooding (4,8,15)
2nd? bt
sul. un-x-nich
- ② 1-618 (10x) shreddy green bt (4,8,15)
w/ Kspar un-x-nich
- ③ 1-993 ep-chlor alt w/ py? xl (2,4,8)
seric.
- ④ 7-186 seric. surr. q grn w/ sulf min'l (1,2,4)
(10x) bt part. repl. by ser.
- ⑤ ~~9~~-441 ~~ser~~ zois^{tr} repl bt xl (1,2,4)
chlor " " "
ser alt of plag
ser-sulf. unit.
- ⑥ 14-955 amph. xl repl. by chlor-carb-ep-g (1,2,4)
mont.
- ⑦ 18-102 epid-Kspar flooding (2,4,8)
- ⑧ ~~SEI~~ 9-5-A seric. + clay alt'd plag phenos.
v.f.g. matrix of q, Kspar (8,15/30)
(stained Kspar)

- 22 16-510 (10x) Mos_2 rosette 1, 2
- 23 10-460 (10x) cpy + py 1, 2
- 24 16-936 (10x) sheared spec w/ int. seric. (1, 2, ~~3~~)
- 25 ~~18-107-1318~~ (1, 2, 4)
~~7-486~~ 7-486 bimodal bt
(pl. lt) surr by plag (w/ky, cdt)
+g
- 26 1-447 2nd bt - Kspar (2, 4, 8)
(pl. lt)
- 27 7-280 apatite rd. to sul. (1 ~~2, 3, 4~~)
(10x) (pl. lt)

PECHINEY UGINE KUHLMANN DEVELOPMENT, INC.

730 SAN MATEO, S.E.
ALBUQUERQUE, NEW MEXICO 87108
505-266-7897

April 29, 1975

Mr. E. Grover Heinrichs
Essex International
1704 W. Grant Road
Tucson, Arizona 85705

Dear Mr. Heinrichs:

I am returning you, registered, the documentation concerning your Squaw Peak property as our management has decided not to take any action on it.

I would like to thank you for contacting us and I hope that other opportunities will occur in the future that will come to a happier conclusion.

Yours truly,

J.P. Guelpa

JPG/AJS/796

A
B
C
D
E
F
G
H
I
J
K
L
M
N
O
P
Q
R
S
T
U
V
W
Y
Z

ITEM #

DESCRIPTION

1	16 p.	Squad P.	Mine Drill H. Log	
2		Picture	DDH No. 1 # 3	
3		Mine Picture		
4		"	"	
5		Letter	Lease Release	
6		Lease Agreement	(Phillips)	
7		Map	section 7	
8		Map	sec. 6	
9		"	Sheet 5	
10		"	" "	
11		"	sec. 3	
12		"	sec. 8	
13		"	Sheet 5	
14		Drill Hole Log	# 1	
15		" "	# 2	
16		" "	# 3	
17		" "	# 4	
18		" "	# 5	
19		" "	# 6	
20		" "	# 7	
21		" "	# 8	
22		" "	# 9	
23		" "	# 10	
24		" "	# 11	
25		" "	# 12	
26		" "	# 13	
27		" "	# 14	
28		" "	# 15	
29		" "	# 16	
30		" "	# 17	
31		" "	# 18	
32		" "	#	
33		" "	# 2	
34		Map	# She	
35		"	# Sec.	
36		"	# Ore	

37	Map	Sheet 5	
38	"	Aug 1969 Report	sec. B-B
39	"	sec. A-A	
40	"	Sheet 5	F
41	"	sec. A-A	G
42	Claim		H
43	"	sec. 4	I
44	"	" 5	J
45	"	" 6	K
46	"	" 7	L
47	"	sec. 8	M
48	"	Sheet 9	ME
49.	"	Sheet 8	N
50.	"	Sheet 7	O
51.	"	" 6	P
52	"	" 5	Q
53	"	" 4	R
54	"	" 3	S
55	"	" 2	T
56	"	" 1	U
57	MAP	sec. 5	V
58	"	Sheet 2	W
59	"	Contour	X
60	"	Howe Mount.	Y
61		sec. 4	Z
62	Elec. Geophysical Survey Report		
63	Geo. Log of Holes		
64	Map "Main Level"		
65	Moly. Geochemical Contour Map		
66	Mercury	"	"
67	Zinc	"	"
68	Copper	"	"
69	"	# Moly	Histogram #1
70	"	"	#3
71.	"	"	#4
	"	"	#6

72	Copper & Moly Histogram Hole #7	
73	" " " " " #8	
74	" " " " " #9	
75	" " " " " #14	
76	" " " " " #18	
77	Map "Main Tunnel Workings"	
78	Map "Deposit Level"	
79	"38 p." General Report	I
80	Reflection Seismic Investigation	J
81	"14 p." HAMA Mining Report	K
82	Polarization Report	L
83	Final Report	M
84	"21 p." of Maps & Plates ect.	
85	"41 p." Progress Report 8-2-68	
86	"25 p." " " JAN. 1971	
87	Report by Bob Forest & S.B. Gardner	Mc
88	Report by Bob Forest & Mike Sauval	N
89	CLAIM MAP	
90	Progress Report 1972 April 1972	O
91	"102 p." " " April 1972	P
92		Q
93		R
94		S
95		T
		U
		V
		W
		Y
		Z