

CONTACT INFORMATION
Mining Records Curator
Arizona Geological Survey
416 W. Congress St., Suite 100
Tucson, Arizona 85701
520-770-3500
<http://www.azgs.az.gov>
inquiries@azgs.az.gov

The following file is part of the

Richard Mieritz Mining Collection

ACCESS STATEMENT

These digitized collections are accessible for purposes of education and research. We have indicated what we know about copyright and rights of privacy, publicity, or trademark. Due to the nature of archival collections, we are not always able to identify this information. We are eager to hear from any rights owners, so that we may obtain accurate information. Upon request, we will remove material from public view while we address a rights issue.

CONSTRAINTS STATEMENT

The Arizona Geological Survey does not claim to control all rights for all materials in its collection. These rights include, but are not limited to: copyright, privacy rights, and cultural protection rights. The User hereby assumes all responsibility for obtaining any rights to use the material in excess of "fair use."

The Survey makes no intellectual property claims to the products created by individual authors in the manuscript collections, except when the author deeded those rights to the Survey or when those authors were employed by the State of Arizona and created intellectual products as a function of their official duties. The Survey does maintain property rights to the physical and digital representations of the works.

QUALITY STATEMENT

The Arizona Geological Survey is not responsible for the accuracy of the records, information, or opinions that may be contained in the files. The Survey collects, catalogs, and archives data on mineral properties regardless of its views of the veracity or accuracy of those data.

AN ESTATE APPRAISAL

of

CERTAIN MINING PROPERTIES

in which

CLIFFORD J. RUSSELL (DECEASED)

held

AN INTEREST

by

Richard E. Mieritz
Mining Consultant
Phoenix, Arizona

November 13, 1979

REPLY TO:

2940 N. CASA TOMAS
PHOENIX, ARIZONA 85016
TELEPHONE (602) 277-6053

Richard E. Mieritz

MINING CONSULTANT

ARIZONA REGISTERED
MINING ENGINEER AND GEOLOGIST

GEOLGICAL
EXPLORATION
EVALUATION
FEASIBILITY
OPERATION

Laurence H. Whitlow, P.C.
524 East Dunlap Avenue
Phoenix, Arizona 85020

RE: ESTATE of CLIFFORD J. RUSSELL, DECEASED
PROBATE #: P-120445

Dear Mr. Whitlow:

At your request and authorization, verbally and with your letter of October 30, 1979, the writer proceeded with an appraisal of certain mining properties in which Clifford J. Russell, Deceased, held an interest and as such is a part of the Estate of the deceased.

Your office also provided a copy of Exhibit A - Inventory - which, in part itemizes many mining claims by name and/or number, book and page recording of the Location Notices for the listed claims and Bureau of Land Management (Phoenix Office) file numbers for many of the claims. As you are aware, mining claims located after October 1, 1976 and prior to July 24, 1979, should have been filed within 90 days of location with the Bureau of Land Management. Claimants staking claims after July 24, 1979, have 90 days to file with the B.L.M. - to be legal claims in the eyes of the B.L.M. (Government). Claims located prior to October 21, 1976, had to be filed with the B.L.M. by October 22, 1979.

Some of the listed (Inventory) claims have not been filed with the B.L.M. as of October 22, 1979. One claim, Manzanita Mill Site #2 was located in September 1976 and seventeen (17) other claims were located in years 1977 and 1978. These should have been filed with the B.L.M. within 90 days of the location dates to maintain legality.

Under these conditions, the 18 claims mentioned above cannot be considered "legal" claims. However, this is not for me to make judgement, but available information indicates that the referred to claims were dropped by the owners.

The value of a mining claim is based on one and only one factor - measured ore in place. Measured, in this case, means all four sides and the vein width are visible and can be sampled to determine the value by assay. Any "mineralized potential" is an educated hypothesis, thus an intangible factor. Geologic evidence projection is also an intangible factor. These considerations are the foundation and/or base of the writer's appraisal for the inventoried mining claims in which the deceased had an interest.

In the opinion of the writer, all claims of reference are "prospects" - no "measurable" ore in place. Some claims are "antique" - meaning worked by the early prospectors but abandoned.

Laurence H. Whitlow, P.C.

RE: ESTATE of CLIFFORD J. RUSSELL, DECEASED

Page Two

The inventoried claims are in three separate areas and are grouped as follows:

Area I: Near Wagoner, Yavapai County, Arizona

| | |
|----------------------------------|----------------|
| Manzanita claims 1 thru 30 | (30) |
| North Manzanita claims 1 thru 11 | (11) |
| Manzanita Ext. 1 thru 4 | (4) |
| Silver Dollar 1 thru 7 | (7) |
| Rhodium 1 thru 8 | (8) |
| Silver Dollar 8 thru 20 | (13) abandoned |
| Manzanita Mill Site #1 | (1) |
| Manzanita Mill Site #2 | (1) abandoned |
| Spring Mine #1 & #2 | (2) abandoned |

Area II: Rich Hill, Stanton, Yavapai County, Arizona

| | |
|--------------------------|-------------------------------------|
| Russell Mines #1 thru 4 | (4) |
| Russell Mill Site #1 & 2 | (2) abandoned (included in Area I) |

Area III: South of Aguila, Maricopa County, Arizona

| | |
|------------------------|------|
| Gold Basin #1 thru 8 | (8) |
| Crown Prince #1 thru 3 | (3) |

These claims which are identified as being "abandoned" have not been filed with the Bureau of Land Management as of October 22, 1979 - thus considered "non-legal." However, the writer submits an appraisal value to fulfill the inventory list.

The writer had occasion to examine the claims in Area I in September 1975 and the claims in Area II in September 1974. The writer visited the claims in Area I and II, accompanied by Mr. Frank Russell, brother of the deceased, on November 5, 1979. The writer visited the Area III claims on November 12, 1979, again accompanied by Mr. Frank Russell.

The following pages contain the writer's appraisal by claim groups and Maps which show the locations of the claims. This arrangement will provide flexibility for heir distribution.

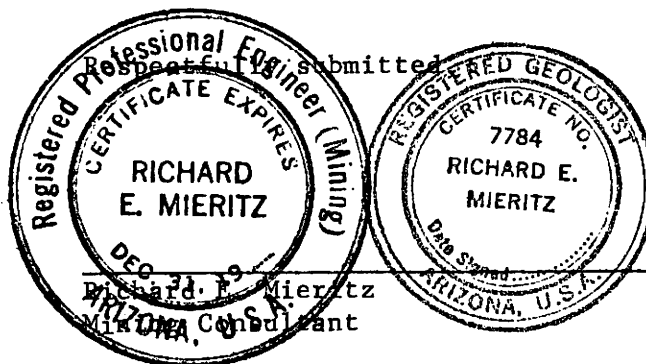

November 13, 1979

Laurence H. Whitlow, P.C.
RE: ESTATE of CLIFFORD J. RUSSELL, DECEASED
Page Three

AREA I
Wagoner Area, Yavapai County, Arizona

Manzanita Claims (30)

All claims except numbers 10, 11, 23 & 24 appraised
@ \$500.00/claim. Considered prospects.

Numbers 10, 11, 23 & 24 appraised @ \$650.00/claim.

Prospects but some showing of mineralization.

TOTAL

\$15,600.00

North Manzanita Claims (11)

All claims appraised @ \$400.00/claim. Considered
prospects.

TOTAL

4,400.00

Manzanita Extension Claims (4)

Considered prospects and appraised @ \$400.00/claim.

TOTAL

1,600.00

Silver Dollar Claims (7)

All claims except number 2 appraised @ \$500.00/claim.
Considered prospects.

Claim number 2 appraised @ \$900.00/claim. Prospect
but some showing of mineralization.

TOTAL

3,900.00

Rhodium Claims (8)

Appraised @ \$400.00/claim. Considered prospects.

TOTAL

3,200.00

Silver Dollar Claims 8 thru 20 (13) (abandoned)

All claims considered prospects and appraised
@ \$350.00/claim.

TOTAL

4,550.00

Manzanita Mill Site #1 (1)

This claim appraised @ \$800.00 because of land use
purpose and location.

TOTAL

800.00

Manzanita Mill Site #2 (1) (abandoned)

This claim appraised @ \$600.00 because of land use
purpose and location.

TOTAL

600.00

Spring Mine (2) (abandoned)

These claims appraised @ \$500.00/claim because of
possible water source.

TOTAL

1,000.00

Laurence H. Whitlow, P.C.

RE: ESTATE of CLIFFORD J. RUSSELL, DECEASED

Page Four

Russell Mill Sites (2) (abandoned)

These claims appraised @ \$500.00/claim because
of land use purpose and location.

TOTAL

1,000.00

Reason for the above abandonments and their respective dates thereof are not known to the writer. These abandonments were not on file with the Bureau of Land Management on November 6, 1979 when the writer checked that office.

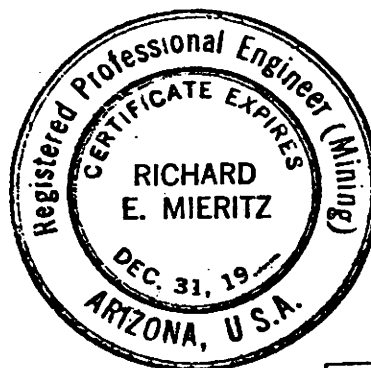
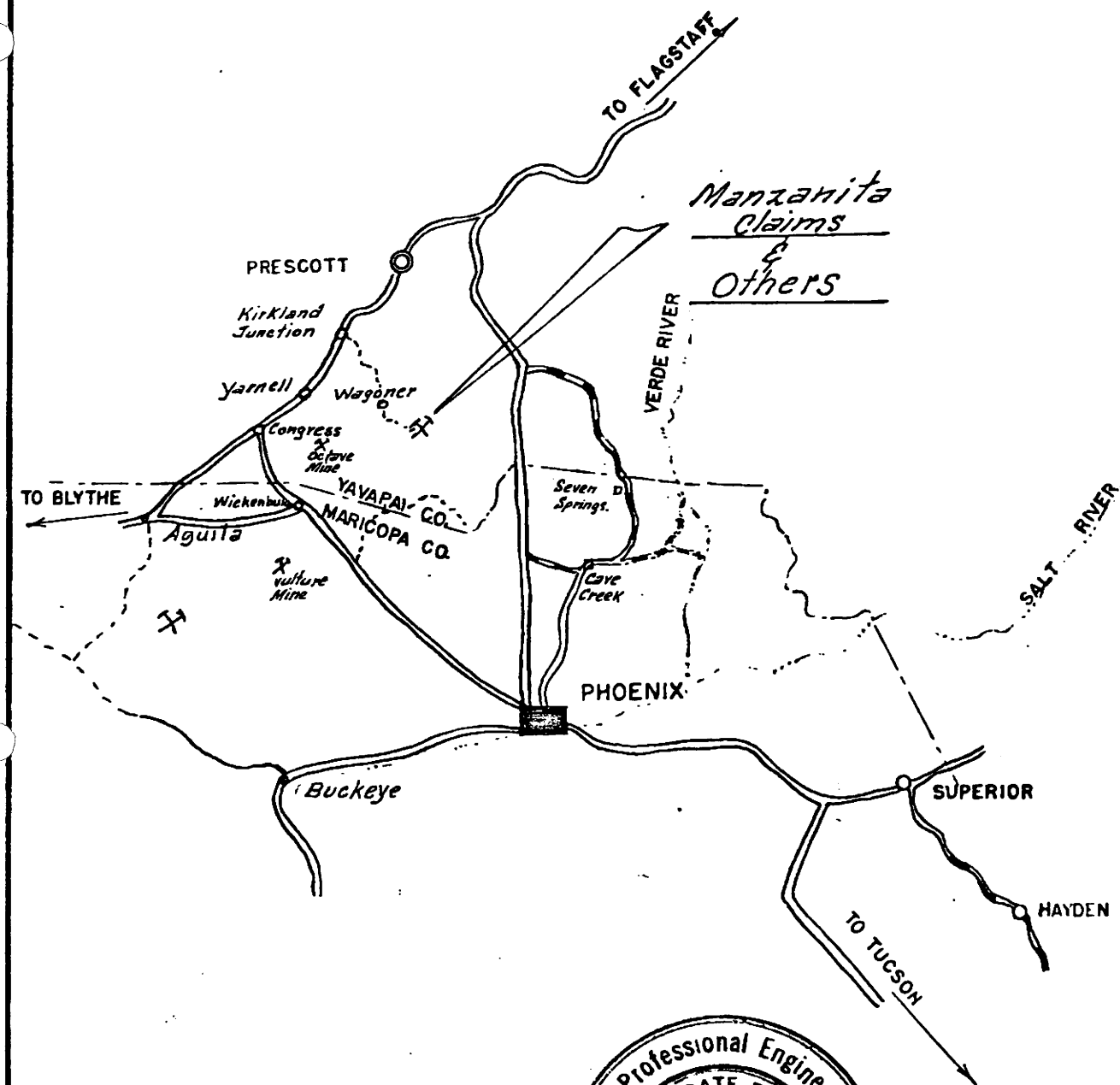

Manzanita

Not to be reproduced or altered
without permission,
R.E.M.

INDEX MAP CENTRAL ARIZ.

SCALE: 1" = 27 MI

R.E. MIERITZ, P.E.

MAR., 1962

MAP No 1

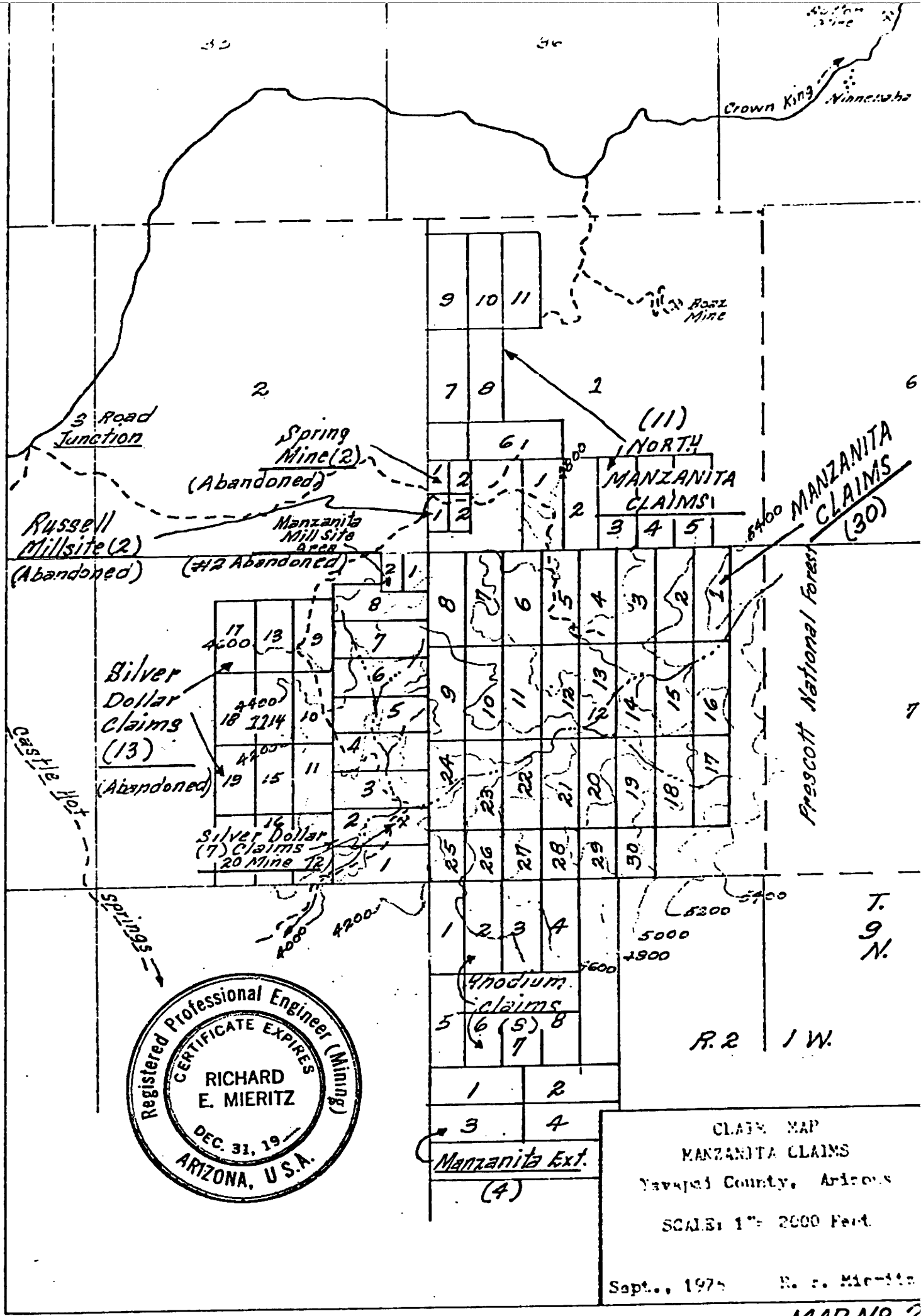

MAP No 2

Laurence H. Whitlow, P.C.

RE: ESTATE of CLIFFORD J. RUSSELL, DECEASED

Page Five

AREA II

Weaver Creek, Stanton, Yavapai County, Arizona

Russell Mines 1 thru 4 (4)

All claims except number 2 appraised @
\$500.00/claim. Considered prospects.

Claim number 2 appraised @ \$800.00. A
prospect but location of claim indicates
some mineralization.

TOTAL

\$2,300.00

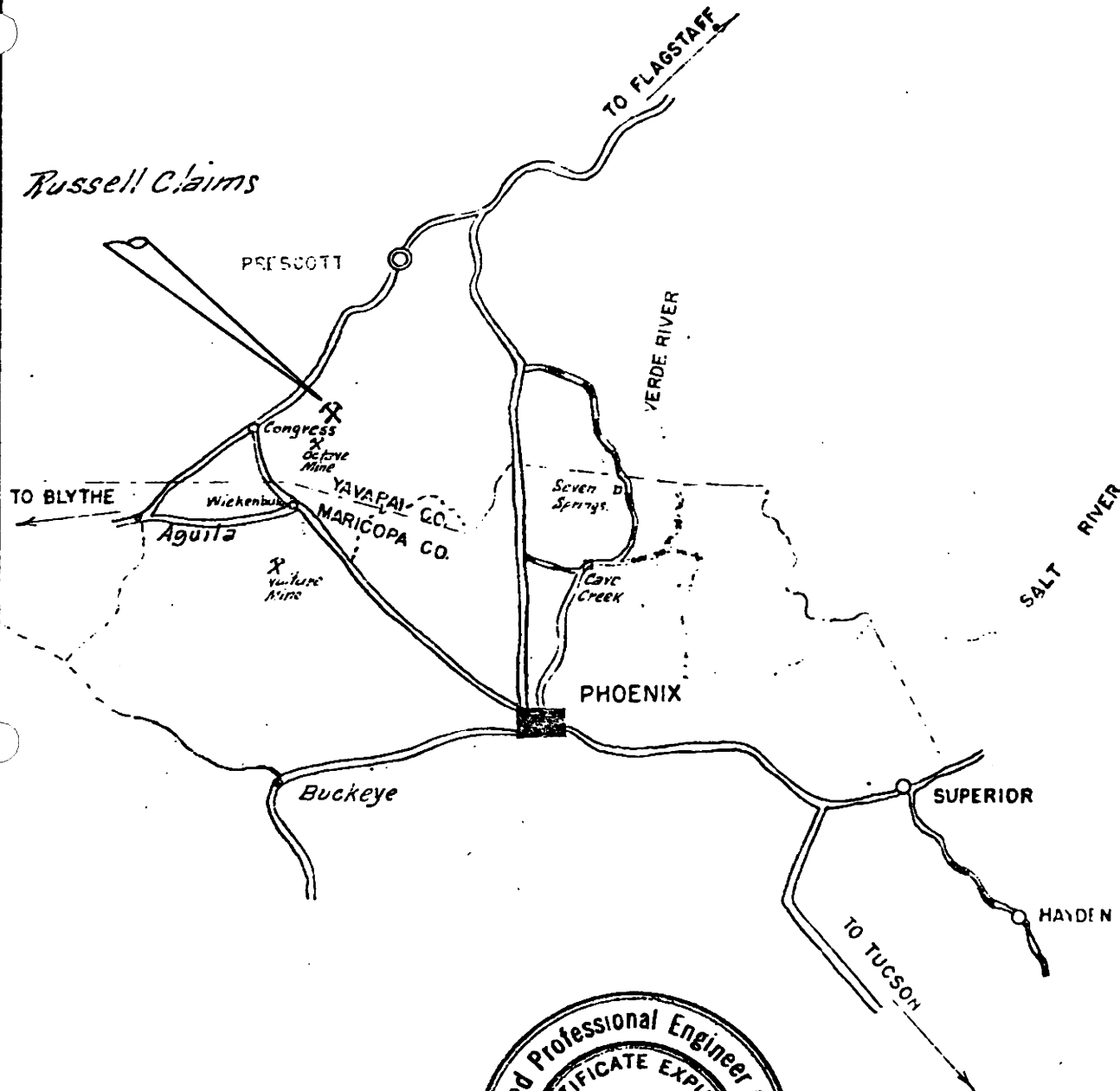

66

*Not to be reproduced or altered
without permission
R.E.M.*

INDEX MAP CENTRAL ARIZ.

SCALE: 1" = 27 MI

R.E. MIERITZ, P.E.

MAR., 1962

MAP No. 3

R. 5 - 4 W

24

19

20

Russell
Mines Am'd
(4)

25

30
Rich
Hill
Katherine
Patented

No 4
Johnson
Patented
No 3
No 2
No 1

T.
10.
N.



CLAIM MAP
RUSSELL CLAIMS
Weaver Mining District
Yavapai County, Arizona

Scale: 1" = 2000 Ft.

Sept., 1974 R. E. Mieritz

MAD No 4

Laurence H. Whitlow, P.C.

RE: ESTATE of CLIFFORD J. RUSSELL, DECEASED

Page Six

AREA III

South of Aguila, Maricopa County, Arizona

Gold Basin Claims 1 thru 8 (8)

All claims appraised @ \$650.00/claim.

Considered prospects but with mineralization
exposures.

TOTAL

\$5,200.00

Crown Prince Claims 1 thru 3 (3)

All claims appraised @ \$400.00/claim.

Considered prospects.

TOTAL

1,200.00

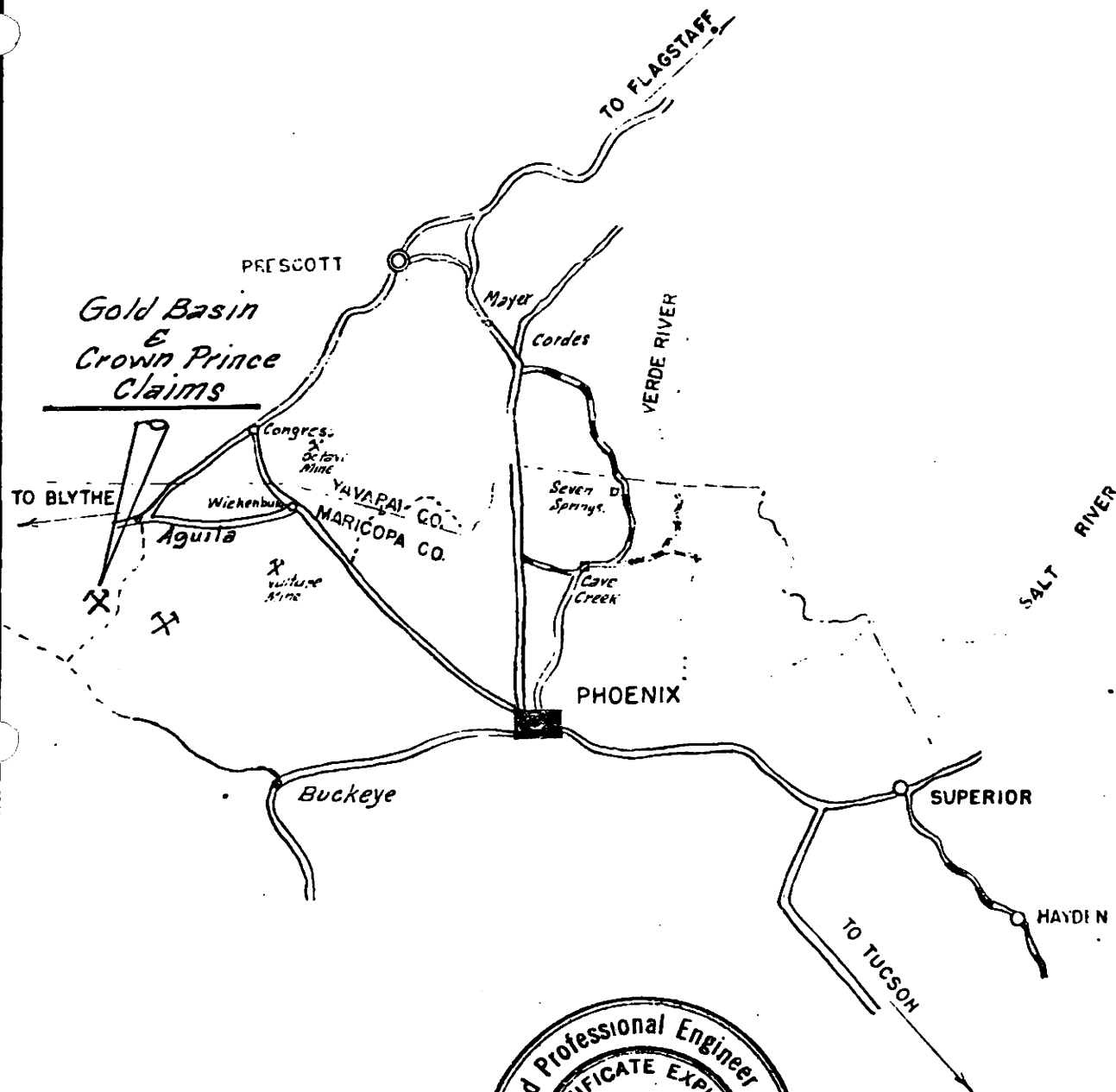

1977 Mieritz

*Not to be reproduced or altered
without permission.
R.E.M.*

66

INDEX MAP CENTRAL ARIZ.

SCALE: 1"=27 MI

R.E. MIERITZ, P.E.

MAR., 1962

MAP No 5

Russell Claims

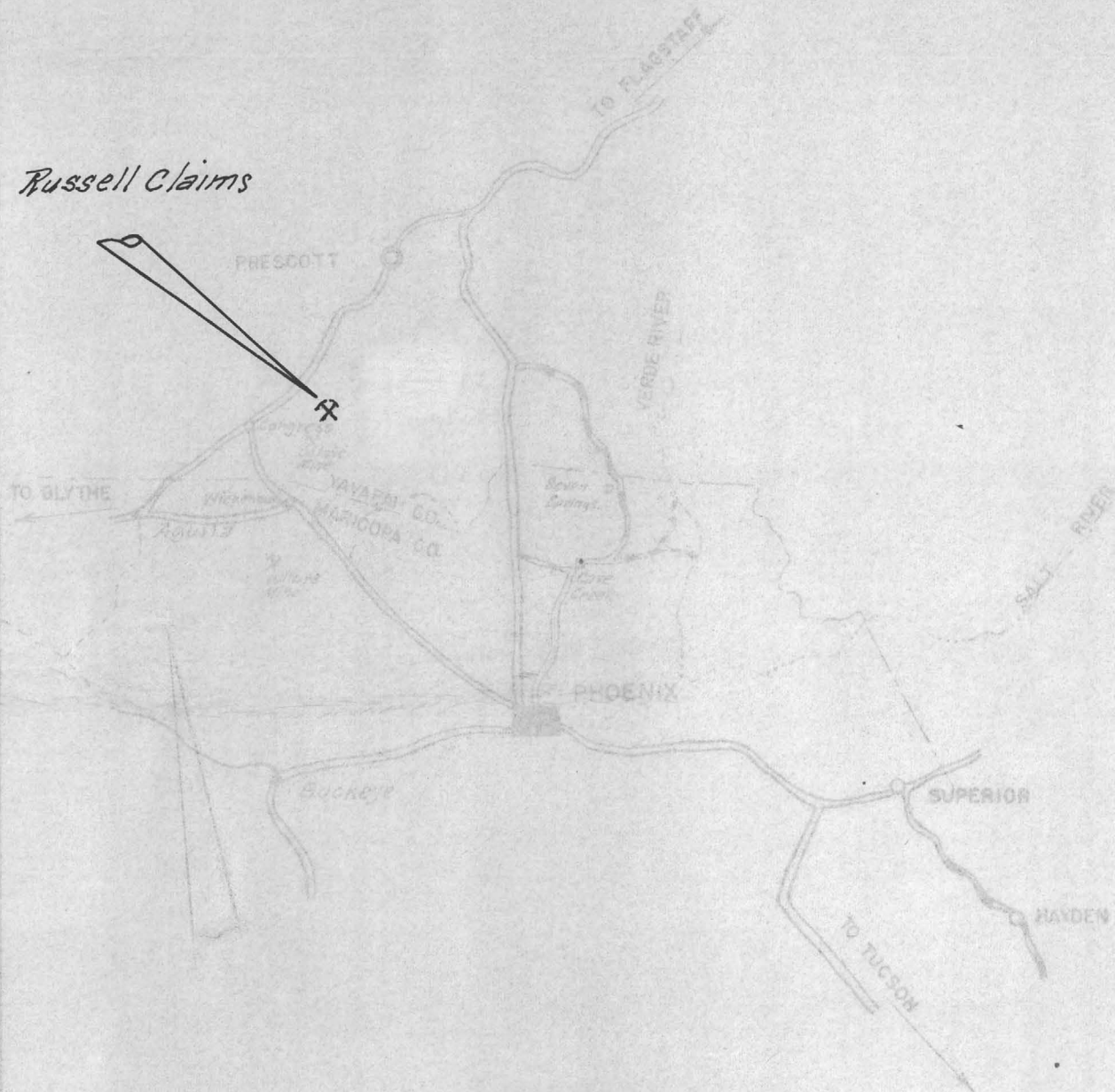

*Not to be reproduced or altered
without permission
R.E.M.*

INDEX MAP
CENTRAL ARIZ.

SCALE - 1" = 27 MI.

R.E. MIERITZ, P.E.

MAR. 1902

MAP N^o 1

CENTRAL ARIZ. INDEX MAP

SCALE: 1"=25 MI.

R.E. MIERITZ, P.E.

MAR., 1963

MAP No. 1

Not to be reproduced or altered
without permission.
R.E.M.

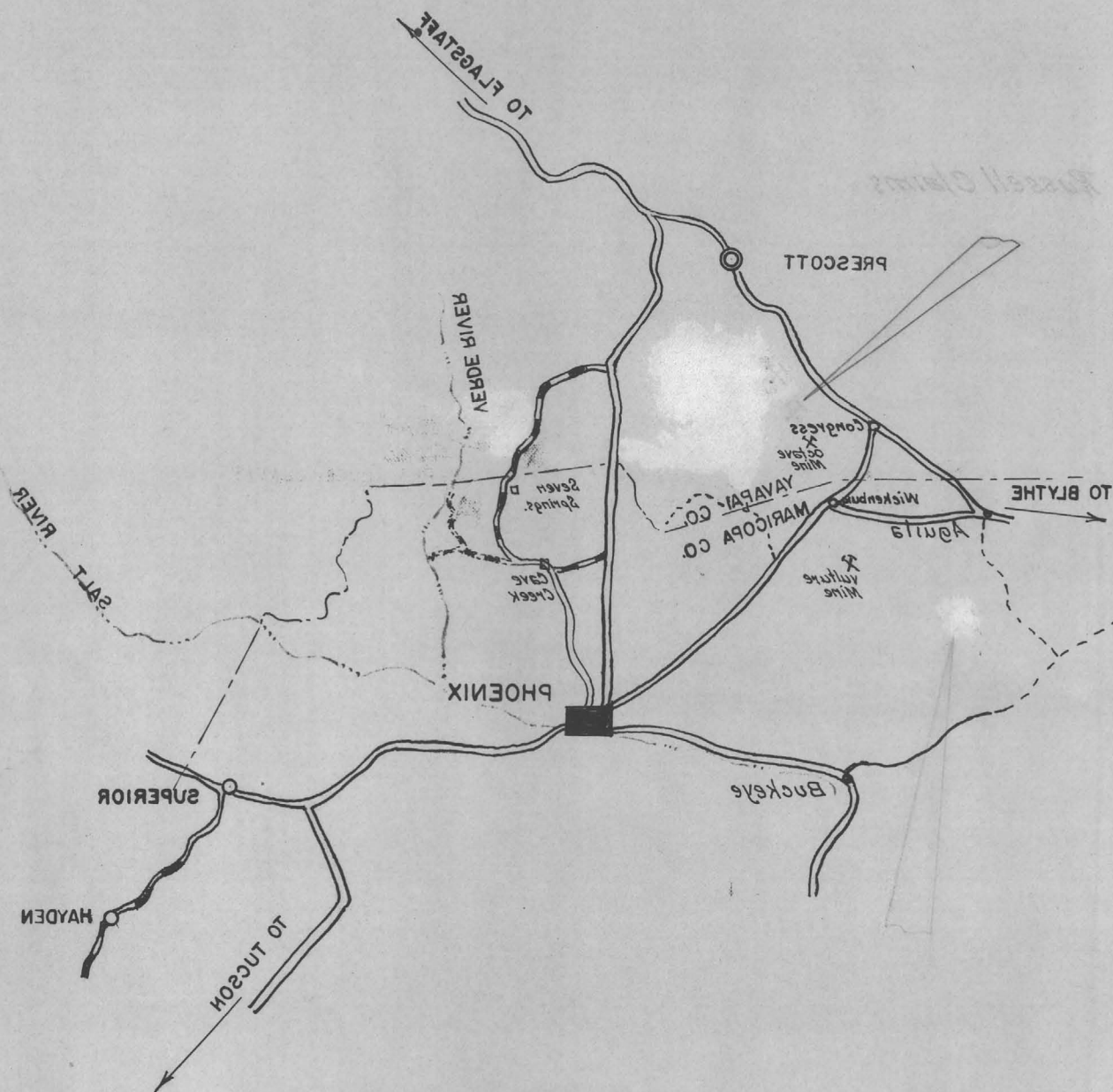

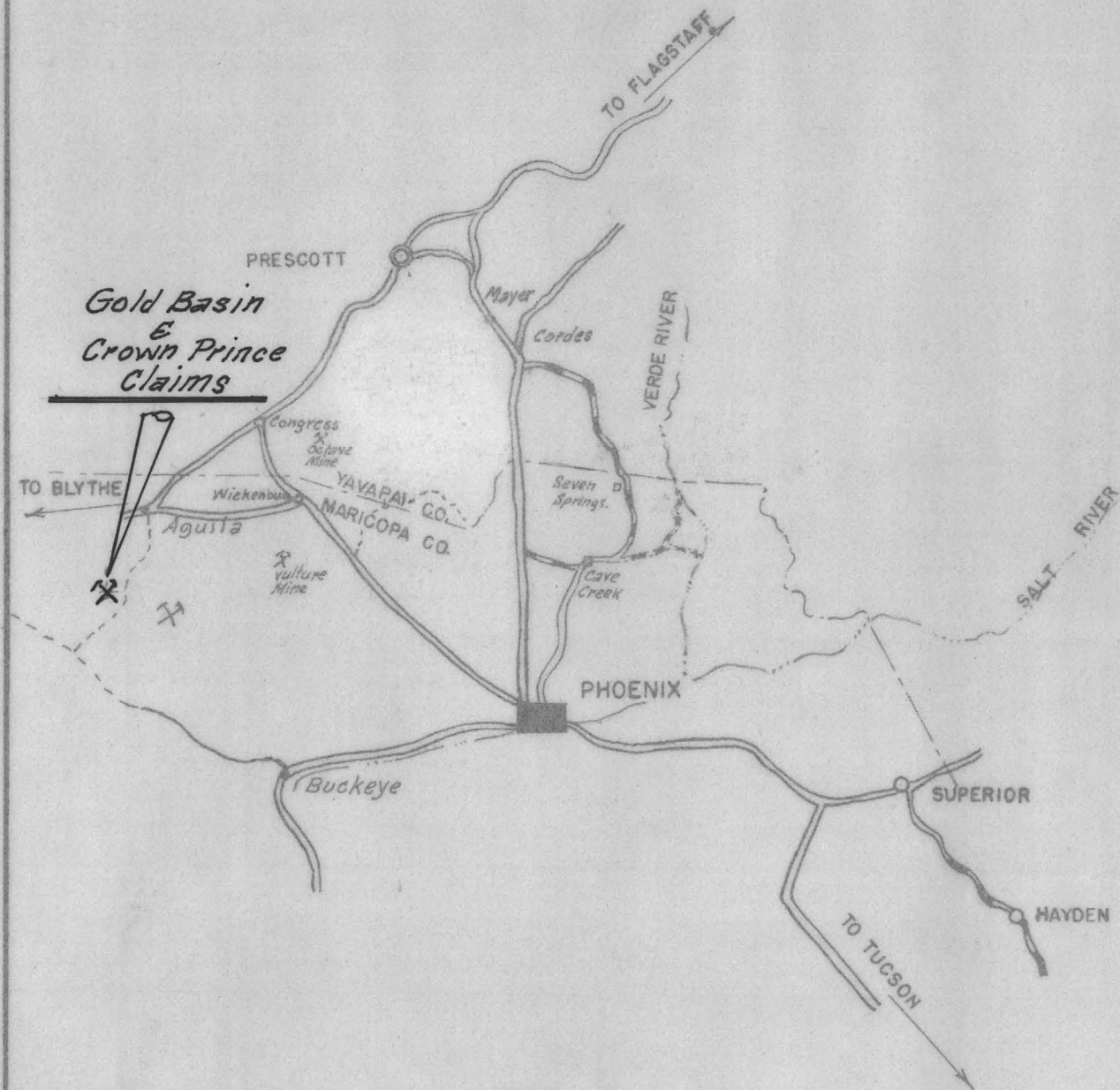

R. E. Mieritz

Not to be reproduced or altered
without permission.
R.E.M.

INDEX MAP CENTRAL ARIZ.

SCALE: 1"=27 MI.

R.E. MIERITZ, P.E.

MAR., 1962

MAP N^o 1

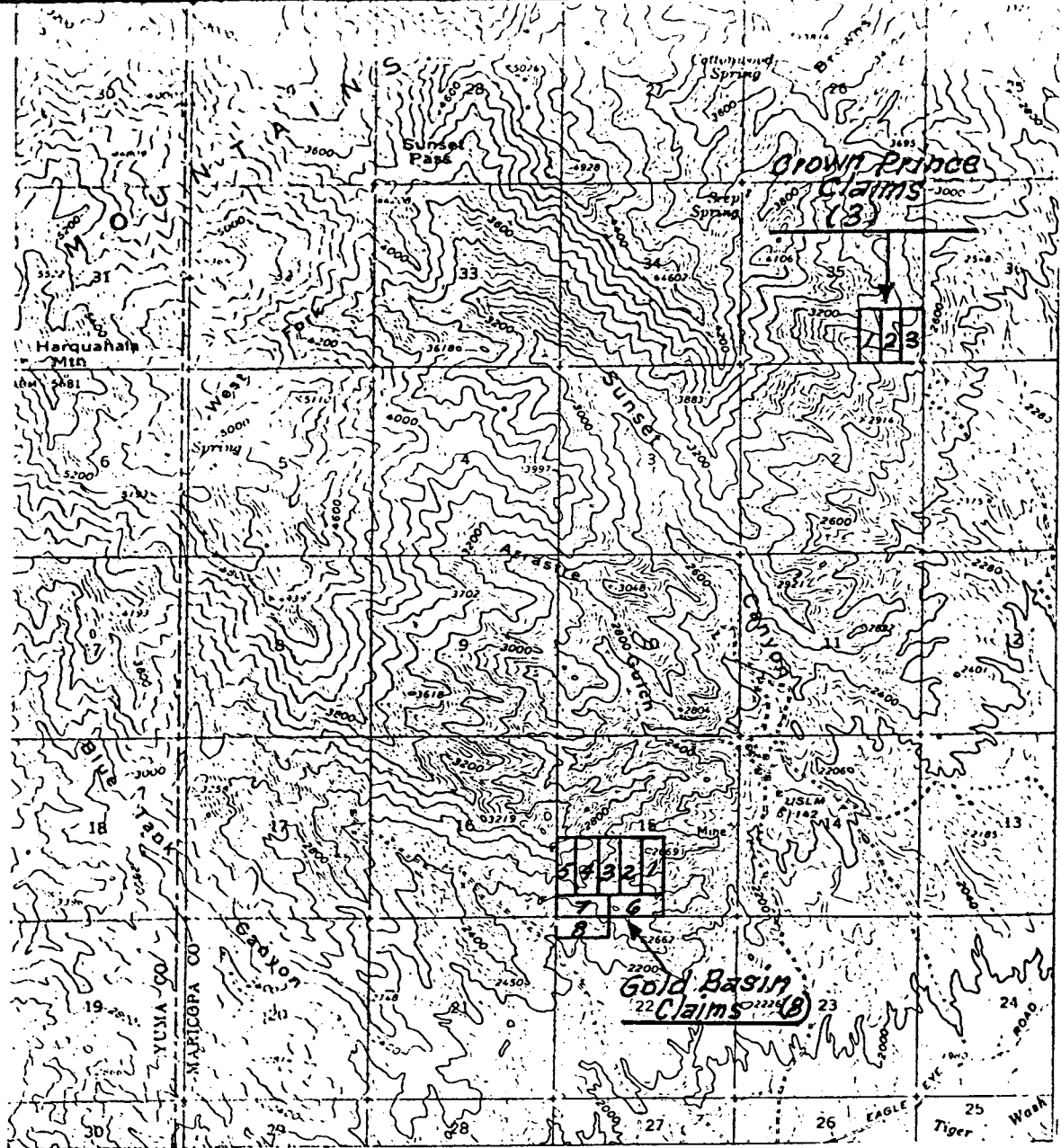

R. 10 W.



CLAIM MAP
CROWN PRINCE CLAIMS
and
GOLD BASIN CLAIMS
Maricopa County, Arizona
SCALE: 1" = 5000 Ft.
Nov., 1979 R. E. Mieritz

MAP No 6

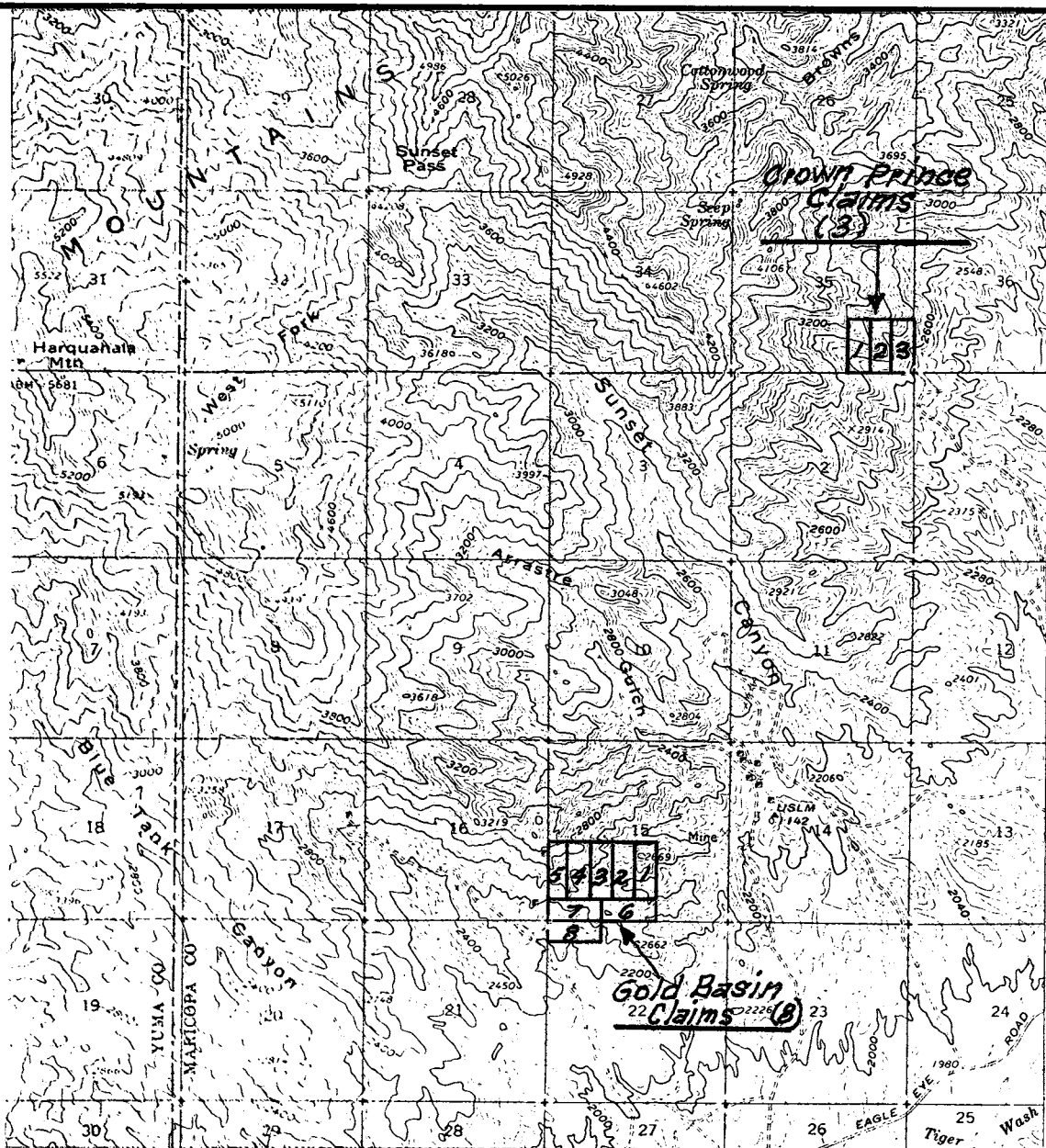

T.
6
S.
N.

R. 10 W.

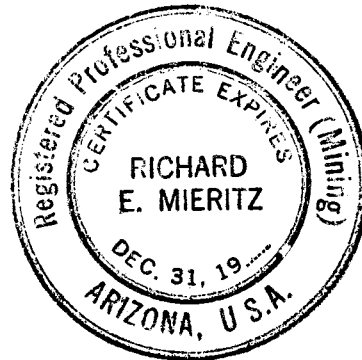

CLAIM MAP
CROWN PRINCE CLAIMS
and
GOLD BASIN CLAIMS
Maricopa County, Arizona

SCALE: 1" = 5000 Ft.

Nov., 1979

R. E. Mieritz

MAP No 6

R. 5 - 4 W

24

19

20

Russell
Mines Am'd
(4)

T.
10.
N.

25

30

Rich
Hill
Katherine
Patented

No 3

No 2

No 1

No 4

Johnson
Patented

29

Weaver Creek

CLAIM MAP
RUSSELL CLAIMS
Weaver Mining District
Yavapai County, Arizona

Scale: 1" = 2000 Ft.

Sept., 1974 R. E. Mieritz

MAP No. —

REPLY TO:

2940 N. CASA TOMAS
PHOENIX, ARIZONA 85016
TELEPHONE (602) 277-6053

Richard E. Mieritz

MINING CONSULTANT

ARIZONA REGISTERED
MINING ENGINEER AND GEOLOGIST

GEOLOGY
EXPLORATION
EVALUATION
FEASIBILITY
OPERATION

January 19, 1982

Mr. Owen Speck
15801 North 29th Street
Phoenix, Arizona 85032

Dear Mr. Speck:

Pursuant to our office conversation on January 17, 1982, please be advised of the following.

My daily consulting fee (whether travel, field or office time) is three hundred (\$300.00) dollars per day and/or forty (\$40.00) dollars per hour if the time spent is less than a normal working day. If retained on a minimum three month basis, the monthly consulting fee is five thousand five hundred (\$5,500.00) dollars per month (22 working days during the period.) Days in excess of 22, when required by urgency, carry a consulting fee of two hundred fifty (\$250.00) dollars per day - on a full day charge. No partial day or hours considered.

All Out-of-Pocket expenses are for your account which would include but not be limited to: transportation, (air fares, ground transportation of any kind, etc.), lodging, meals, sampling and surveying supplies, assay charges, map printing, copying, etc.

You indicated an escrow type drawing account would be established at a local (Phoenix) bank with authority of an escrow official to write payment checks for presented monthly invoices. Payments should be made within five working days of receipt of Invoice. An Out-of-Pocket expense monthly advance - to be accounted for by Expense Account - would be required but limited to one thousand (\$1,000.00) dollars per month - within an 800 mile radius of Phoenix. Same would only be requested when the coming month's work program calls for Out-of-Pocket expenses. Work programs beyond the 800 mile radius of Phoenix, for extended time periods or above normal transportation charges would require a larger advance payment. Your approval for same - to the bank - is requested.

For any work program - domestic or foreign - the writer applies his full knowledge and experience capabilities to accomplish whatever may be required in the field of geology and mining of mineral (metallic and non-metallic) deposits. The attached Professional Resume provides a general insight of the writer's range of capability and experience.

Mr. Owen Speck
January 19, 1982
Page 2

Time-wise, as regards the oncoming project - the Russell Claims, Weaver Mining District, Yavapai County, Arizona, might require two to three weeks of work (fifteen days) field and office time. My time spent would be determined by the amount of current information you can provide, how much field work may be required and the objective of the program.

A time factor is extremely vulnerable to change; however, permit me to state that the writer works to the advantage of the client but at his own pace - forward without repetition.

Sincerely,

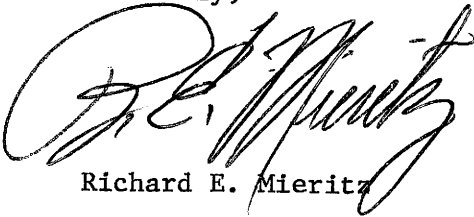
A handwritten signature in cursive script, appearing to read "R.E. Mieritz". The signature is written in dark ink and is positioned above the printed name.

Richard E. Mieritz

REM/cm

REPLY TO:

PHOENIX, ARIZONA 85016 16
TELEPHONE (602) 277-6053
2940 N. Casa Tomas

Richard E. Mieritz

MINING CONSULTANT

ARIZONA REGISTERED
MINING ENGINEER AND GEOLOGISTGEOLOGY
EXPLORATION
EVALUATION
FEASIBILITY
OPERATION

PROFESSIONAL RESUME

CONSULTANT, 1956 to Present:

Practicing in the fields of exploration, geology, evaluation, mining, feasibility and metallurgy of ferrous, non-ferrous and non-metallic mineral deposits completing many examinations and evaluations of mining properties of base metals, diamonds, uranium, manganese, etc., in Arizona, the Western States, Mexico, Panama, Brazil, Australia, Canada, Turkey, Cyprus Isle, and Iran for individuals and corporations. Since 1974 some thirty odd mining property examinations were made and reports written on Arizona properties for several Canadian Corporations for submittal to and approval by the Vancouver Securities Exchange. Have appeared as expert witness on several mining cases. The following are some of the long term retainments by corporations.

IMCO Services (Division of Halliburton Inc.) Seven months in Iran at barite Project 150 miles south of Tehran as a Consultant to Doreen-IMCO Co. (Iranian Co.) to initiate and establish mine method and procedure and train Iranian technical and labor personnel to carry forward. 1978.

CYPRUS MINES: eighteen months in Turkey in charge of and completing a geological reconnaissance using helicopter for an area 250 miles along the Black Sea and 100 miles inland. 1967 and 1968.

ANVIL MINING Co.: Field Development and Administrative Engineer of the Faro lead-zinc-silver deposit, White Horse, Yukon Territory, Canada in charge of diamond drill exploration and evaluation and administration of the field operation. 1966

MT. GOLDSWORTHY MINING PTY: Three years as Chief Mining Engineer designate, Exploration and Field Project Manager of the Mt. Goldsworthy Iron deposit, Port Hedland, Western Australia. Mt. Goldsworthy is a consortium of Utah Construction Co., Consolidated Goldfields of London and Cyprus Mines, Los Angeles. Supervised exploration drilling, geological staff and feasibility investigations as to mine operation and planning, townsite planning, railroad route, harbor and dock loading facilities, etc. 1962 to 1965.

AMSTUTZ & YATES:

As a field engineer for this firm of Consulting Petroleum Geologists and Engineers of Wichita, Kansas, engineering work was completed in the petroleum fields of Kansas and Oklahoma. Completed geological work, oil and gas reservoir reserve and potential evaluations, secondary oil recovery by gas and water repressuring, design of such plants and methods. 1953-56.

AMERICAN SMELTING & REFINING CO.;

Field Superintendent of exploration and evaluation Projects of base metals in Utah, Idaho, Colorado, Nevada and Arizona, particularly Silver Bell copper deposit for 2½ years in charge of churn drill and diamond drill exploration and evaluation of the low grade deposits. Field Superintendent for 3 years at the Toquepala-Quellaveco low grade copper deposit exploration using churn drills and diamond drills in Southern Peru. Supervised geological and engineering staff, accounting department, etc., and some 400 other personnel. The latter was for Northern Peru Mining and Smelting Co., a subsidiary of ASARCO in Peru. 1945-53

U. S. BUREAU OF MINES:

Project Engineer supervising iron and aluminum exploration and evaluation Projects in Utah. In 1944 became Ass't to Chief of the Iron and Steel Division in Washington D. C. This office controlled all exploration and mining Projects of raw materials for steel making in the U. S. and Alaska. After Bureau re-organization, became Chief of the Nevada-California and Alaska Divisions controlling exploration and evaluation Projects of all minerals in the industry. Had budgetary and Congress contact responsibilities. 1942-45.

EARLY EXPERIENCE:

U. S. Smelting & Refining Co., Lark, Utah, Ass't Mine Engineer.
Utah Copper Co., Bingham Canyon, Utah, Trackhand, Sampler, Assayer.
Shell Oil Co., Hobbs, New Mexico and Big Spring, Texas, Roustabout.
Pickands-Mather Iron Mining Co., Wakefield, Michigan, Mine Engineers helper. Summer work, 1938. 1938 to 1942.

Received B. S. Degree, Mining Engineering, Univ. of Wisconsin, June, 1939
Received Petroleum Geology Certificate, Kansas Geological Society, University of Kansas, April, 1954.
Received Mining Engineers License 3191, State of Kansas, July, 1955.
Not in force at this time.
Received Mining Engineers License 2745, State of Arizona, March, 1956.
Valid and current.
Received Geologist License 7784, State of Arizona, December, 1970.
Valid and current.

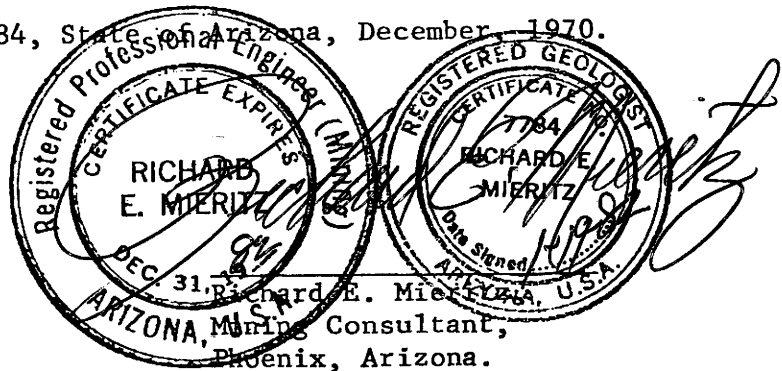

REPLY TO:

2940 N. CASA TOMAS
PHOENIX, ARIZONA 85018
TELEPHONE (602) 277-6053

Richard E. Mieritz

MINING CONSULTANT

ARIZONA REGISTERED
MINING ENGINEER AND GEOLOGIST

GEOLOGY
EXPLORATION
EVALUATION
FEASIBILITY
OPERATION

January 19, 1982

Mr. Owen Speck
15801 North 29th Street
Phoenix, Arizona 85032

Dear Mr. Speck:

Pursuant to our office conversation on January 17, 1982, please be advised of the following.

My daily consulting fee (whether travel, field or office time) is three hundred (\$300.00) dollars per day and/or forty (\$40.00) dollars per hour if the time spent is less than a normal working day. If retained on a minimum three month basis, the monthly consulting fee is five thousand five hundred (\$5,500.00) dollars per month (22 working days during the period.) Days in excess of 22, when required by urgency, carry a consulting fee of two hundred fifty (\$250.00) dollars per day - on a full day charge. No partial day or hours considered.

All Out-of-Pocket expenses are for your account which would include but not be limited to: transportation, (air fares, ground transportation of any kind, etc.), lodging, meals, sampling and surveying supplies, assay charges, map printing, copying, etc.

You indicated an escrow type drawing account would be established at a local (Phoenix) bank with authority of an escrow official to write payment checks for presented monthly invoices. Payments should be made within five working days of receipt of Invoice. An Out-of-Pocket expense monthly advance - to be accounted for by Expense Account - would be required but limited to one thousand (\$1,000.00) dollars per month - within an 800 mile radius of Phoenix. Same would only be requested when the coming month's work program calls for Out-of-Pocket expenses. Work programs beyond the 800 mile radius of Phoenix, for extended time periods or above normal transportation charges would require a larger advance payment. Your approval for same - to the bank - is requested.

For any work program - domestic or foreign - the writer applies his full knowledge and experience capabilities to accomplish whatever may be required in the field of geology and mining of mineral (metallic and non-metallic) deposits. The attached Professional Resume provides a general insight of the writer's range of capability and experience.

Mr. Owen Speck
January 19, 1982
Page 2

Time-wise, as regards the oncoming project - the Russell Claims, Weaver Mining District, Yavapai County, Arizona, might require two to three weeks of work (fifteen days) field and office time. My time spent would be determined by the amount of current information you can provide, how much field work may be required and the objective of the program.

A time factor is extremely vulnerable to change; however, permit me to state that the writer works to the advantage of the client but at his own pace - forward without repetition.

Sincerely,

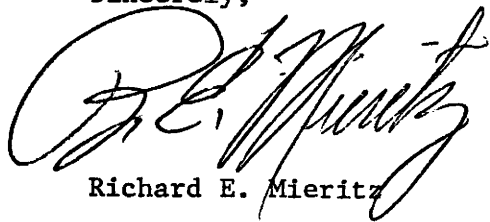
A handwritten signature in cursive script, appearing to read "R.E. Mieritz". The signature is written in dark ink and is positioned above the printed name.

Richard E. Mieritz

REM/cm

992-2912

REPLY TO:

2940 N. CASA TOMAS
PHOENIX, ARIZONA 85016
TELEPHONE (602) 277-6053

Richard E. Mieritz
MINING CONSULTANT

GEOLOGY
EXPLORATION
EVALUATION
FEASIBILITY
OPERATION

ARIZONA REGISTERED
MINING ENGINEER AND GEOLOGIST

January 19, 1982

Mr. Owen Speck
15801 North 29th Street
Phoenix, Arizona 85032

Dear Mr. Speck:

Pursuant to our office conversation on January 17, 1982, please be advised of the following.

My daily consulting fee (whether travel, field or office time) is three hundred (\$300.00) dollars per day and/or forty (\$40.00) dollars per hour if the time spent is less than a normal working day. If retained on a minimum three month basis, the monthly consulting fee is five thousand five hundred (\$5,500.00) dollars per month (22 working days during the period.) Days in excess of 22, when required by urgency, carry a consulting fee of two hundred fifty (\$250.00) dollars per day - on a full day charge. No partial day or hours considered.

All Out-of-Pocket expenses are for your account which would include but not be limited to: transportation, (air fares, ground transportation of any kind, etc.), lodging, meals, sampling and surveying supplies, assay charges, map printing, copying, etc.

You indicated an escrow type drawing account would be established at a local (Phoenix) bank with authority of an escrow official to write payment checks for presented monthly invoices. Payments should be made within five working days of receipt of Invoice. An Out-of-Pocket expense monthly advance - to be accounted for by Expense Account - would be required but limited to one thousand (\$1,000.00) dollars per month - within an 800 mile radius of Phoenix. Same would only be requested when the coming month's work program calls for Out-of-Pocket expenses. Work programs beyond the 800 mile radius of Phoenix, for extended time periods or above normal transportation charges would require a larger advance payment. Your approval for same - to the bank - is requested.

For any work program - domestic or foreign - the writer applies his full knowledge and experience capabilities to accomplish whatever may be required in the field of geology and mining of mineral (metallic and non-metallic) deposits. The attached Professional Resume provides a general insight of the writer's range of capability and experience.

Mr. Owen Speck
January 19, 1982
Page 2

Time-wise, as regards the oncoming project - the Russell Claims, Weaver Mining District, Yavapai County, Arizona, might require two to three weeks of work (fifteen days) field and office time. My time spent would be determined by the amount of current information you can provide, how much field work may be required and the objective of the program.

A time factor is extremely vulnerable to change; however, permit me to state that the writer works to the advantage of the client but at his own pace - forward without repetition.

Sincerely,

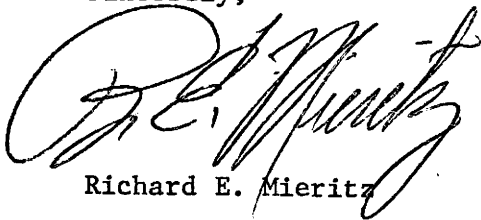
A handwritten signature in dark ink, appearing to read "R. E. Mieritz", with a large, stylized initial "R" and a long, sweeping underline.

Richard E. Mieritz

REM/cm

FORMERLY
WETZEL & WHITLOW

LAW OFFICE
LAURENCE H. WHITLOW, P. C.
524 EAST DUNLAP AVENUE
PHOENIX, ARIZONA 85020

TELEPHONE 943-3456
AREA CODE 602

November 15, 1979

Mr. Richard E. Mieritz
2940 North Casa Tomas
Phoenix, Arizona 85016

Re: Estate of Clifford J. Russell

Dear Mr. Mieritz:

Thank you for the prompt action on obtaining the appraisal of the mining claims in the Russell Estate. Needless to say, we were very pleased with it.

I am enclosing herewith a check from Mary Russell, the personal representative, for your services.

Once again, thank you.

Very truly yours,

LAURENCE H. WHITLOW, P. C.

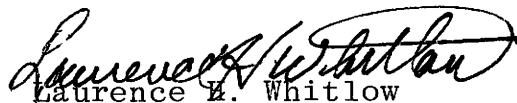
Laurence H. Whitlow

LHW:jsl

Enclosure - 1

P.S. Mrs. Russell has moved, so when you return her records, please return them to her at: 508 East Las Palmaritas, Phoenix, Arizona 85020. Her telephone number is now 943-0688. Thank you.

Sons Allan & Charles C. Russell - separate
(R.P.)
attorneys of Whitlow,
32821 + Armita Calito, San Juan, Calif.
714-493-1425

Sept 6, 1979

Nothing in well -
P-180445 - July 18th 1979

Don Cooper: San Pedro, Calif - Mergers with
Libra Dallas - 480,000

Gold #1 - 100' tunnel 1.76
Sewerage bath sides of wash

Crown Pipe
Barcraft Tunnel 480'

EXHIBIT A

INVENTORY

| Item No. | Real | Personal | Separate | Community | Description of Property | Fair Market Value | Encumbrance | Value Less Encumbrance |
|----------|------|----------|----------|-----------|---|-------------------|-------------|------------------------|
| 1 | | x | x | | 1st National Bank Time Cert. of Deposit #814191 | | | |
| 2 | | x | x | | 1967 Jeep Station Wagon, Id.# 8705F1612664 | | | |
| 3 | x | | x | | An undivided one-half (1/2) interest in all of the following mines known as the Silver Dollar Group located in the Crown King Mining District, County of Yavapai, State of Arizona, as more fully described in the notices of location thereof recorded in the Office of the Yavapai County Recorder in the Book and Page set forth below: <div style="text-align: right;">A MC</div> Silver Dollar #1 B.687,p. 71 37493 Silver Dollar #2 B.888,p. 68 37494 Silver Dollar #3 B.888,p. 69 37495 Silver Dollar #4 B.888,p. 70 37496 Silver Dollar #5 B.888,p. 71 37497 Silver Dollar #6 B.896,p.107 37498 Silver Dollar #7 B.896,p.379 37499 Rhodium #1 B.725,p.230 37485 Rhodium #2 B.725,p.231 37486 Rhodium #3 B.725,p.232 37487 Rhodium #4 B.725,p.233 37488 Rhodium #5 B.725,p.234 37489 Rhodium #6 B.725,p.235 37490 Rhodium #7 B.725,p.236 37491 Rhodium #8 B.725,p.237 37492 Manzanita Ext.#1 B.656,p.729 37500 Manzanita Ext.#2 B.656,p.730 37501 Manzanita Ext.#3 B.656,p.731 37502 Manzanita Ext.#4 B.656,p.732 37503 | | | |
| 4 | x | | x | | An undivided one-quarter (1/4) interest in those certain mining claims situated in Crown King Mining District, Yavapai County, Arizona, the names of which, together with the book and page of official records wherein their location notices are of record in the office of the County Recorder of Yavapai County are as follows: <div style="text-align: right;">A MC</div> Manzanita # 1 B.486,p.558 37558 Manzanita # 2 B.486,p.559 37559 Manzanita # 3 B.486,p.560 37560 Manzanita # 4 B.486,p.561 37561 (continued on page 2) | | | |

Totals _____

Probate No. 120445

EXHIBIT A

INVENTORY

| Item No. | Real | Personal | Separate | Community | Description of Property | Fair Market Value | Encumbrance | Value Less Encumbrance |
|---------------|------|----------|----------|-----------|--|-------------------|-------------|------------------------|
| 4 (continued) | | | | | Manzanita # 5 B.486,p.562 37562 Manzanita # 6 B.486,p.563 37563 Manzanita # 7 B.486,p.564 37564 Manzanita # 8 B.486,p.565 37565 Manzanita # 9 B.486,p.566 37566 Manzanita #10 B.486,p.567 37567 Manzanita #11 B.486,p.568 37568 Manzanita #12 B.486,p.569 37569 Manzanita #13 B.486,p.570 37570 Manzanita #14 B.486,p.571 37571 Manzanita #15 B.486,p.572 37572 Manzanita #16 B.489,p.561 37573 Manzanita #17 B.489,p.562 37574 Manzanita #18 B.489,p.563 37575 Manzanita #19 B.489,p.564 37576 Manzanita #20 B.489,p.565 37577 Manzanita #21 B.489,p.566 37578 Manzanita #22 B.489,p.567 37579 Manzanita #23 B.489,p.568 37580 Manzanita #24 B.489,p.569 37581 Manzanita #25 AmB.1010,p.85 37582 Manzanita #26 AmB.1010,p.86 37583 Manzanita #27 AmB.1010,p.87 37584 Manzanita #28 AmB.1010,p.88 37585 Manzanita #29 AmB.1010,p.89 37586 Manzanita #30 AmB.1010,p.90 37587 Manzanita Mill B.1034,p.881) Site #1) 37504 Manzanita Mill B.1034,p.880) Site #2) | | | |
| 5 | x | | x | | An undivided one-half (1/2) interest in all of the following mines known as the Crown Prince group: A MC Crown Prince #1 B.6438,p.218 34934 Crown Prince #2 B.6503,p.714 34935 Crown Prince #3 B.6945,p.627 34936 | | | |
| 6 | x | | x | | An undivided one-half (1/2) interest in the following mines known as the Spring Mine group (which controls the water supply for the Silver Dollar, Manzanita and North Manzanita Groups: Spring Mine #1 B.12221,p.218 Spring Mine #2 B.12221,p.220 | | | |
| 7 | x | | x | | An undivided one-half (1/2) interest in the following mines known as the Gold Basin Group: | | | |

(continued on page 3)

Totals

Probate No. P-120445

EXHIBIT A

INVENTORY

| Item No. | Real | Personal | Separate | Community | Description of Property | Fair Market Value | Encumbrance | Value Less Encumbrance |
|----------|-------------|----------|----------|-----------|---|---|---|------------------------|
| 7 | (continued) | | | | <p style="text-align: right;">A MC</p> Gold Basin #1 B.11533,p.536 37714 Gold Basin #2 B.11533,p.538 37715 Gold Basin #3 B.11533,p.540 37716 Gold Basin #4 B.11533,p.541 37717 Gold Basin #5 B.11533,p.542 37718 Gold Basin #6 B.11539,p.570 37719 Gold Basin #7 B.11539,p.572 37720 Gold Basin #8 B.11585,p.789 37721 | | | |
| 8 | x | | x | | <p>An undivided one-half (1/2) interest in the following mines known as the North Manzanita Mines Group:</p> <p style="text-align: right;">A MC</p> N. Manzanita # 1 B.982,p567 34937 N. Manzanita # 2 B.982,p568 34938 N. Manzanita # 3 B.982,p569 34939 N. Manzanita # 4 B.982,p570 34940 N. Manzanita # 5 B.982,p571 34941 N. Manzanita # 6 B.982,p572 34942 N. Manzanita # 7 B.982,p573 34943 N. Manzanita # 8 B.982,p574 34944 N. Manzanita # 9 B.982,p575 34945 N. Manzanita #10 B.982,p576 34946 N. Manzanita #11 B.986,p518 34947 | | | |
| 9 | x | | x | | <p>An undivided one-third (1/3) interest in the following mines known as the Russell Mines Group*:</p> <p style="text-align: right;">A MC</p> Russell Mines #1 B.1064,p469 34930 Russell Mines #2 B.1064,p470 34931 Russell Mines #3 B.1064,p471 34932 Russell Mines #4 B.1064,p472 34933 Russell Mill Site #1 B.1159,p403 Russell Mill Site #2 B.1159,p402 | <p>Full. Sec 29 - 10N 4W. 9-1-72 9/25-72 - 750' N E X 600' 29/30' TION 4W 9-25-72 1500' X 600' " " " 9-15-73 - 1500' X 600' AMCD. 8/14/78 - SW 1/4 Sec 1 8/14/78 - SW 1/4 Sec 1, T9N, 2W. 330' N E 330' S X 600'</p> | | |
| 10 | x | | x | | <p>*Documents list owners as Clifford J. Russell and Frank Russell, however there is an agreement which gives a one-third interest to Charles Clifford Russell.</p> <p>An undivided one-half (1/2) interest in the following mines which may be a part of the Silver Dollar Group:</p> <p>Silver Dollar # 8 B.1091,p.578 Silver Dollar # 9 B.1091,p.579 Silver Dollar #10 B.1091,p.580</p> <p>(continued on page 4)</p> | <p>8/5/77 - Sec 11 - T.9N R.2W 8/11/77 " " " " 8/11/77 " " " "</p> | <p>1140' E W X 600' N S " N S " E W " N S " E W</p> | |

Totals

Probate No. P-120445

EXHIBIT A

INVENTORY

| Item No. | Real | Personal | Separate | Community | Description of Property | Fair Market Value | Encumbrance | Value Less Encumbrance |
|----------|-----------|----------|----------|-----------|--------------------------------|-----------------------------|---------------------|------------------------|
| 10 | Continued | X | | | Silver Dollar #11 B.1091,p.581 | 8/1/77 - Dec 11 79 N R 2 W. | - 1/40 A 3 - 600 EA | 11 40 A 3 600 EA |
| | | | | | Silver Dollar #12 B.1091,p.582 | " | " | " |
| | | | | | Silver Dollar #13 B.1091,p.583 | " | " | " |
| | | | | | Silver Dollar #14 B.1091,p.584 | " | " | " |
| | | | | | Silver Dollar #15 B.1091,p.585 | " | " | " |
| | | | | | Silver Dollar #16 B.1091,p.586 | " | " | " |
| | | | | | Silver Dollar #17 B.1091,p.587 | " | " | " |
| | | | | | Silver Dollar #18 B.1091,p.588 | " | " | " |
| | | | | | Silver Dollar #19 B.1091,p.589 | " | " | " |
| | | | | | Silver Dollar #20 B.1901,p.590 | " | " | " |

Totals _____

Probate No. P-120445

Estate of
Clifford J. Russell
To Lawrence Whitlow.

| | | |
|--|--------|--------|
| 11-2 - Office - checking list | 3 hrs. | |
| 11-3 - To Mrs Russell - Office | 3 hrs. | |
| 11-5 - To Prescott - (County Recorder) | | 1 day |
| Margarita - Russell claims | | |
| 11-6 - Office - B.M. | 4 hrs. | |
| 11-7 - Office - | 3 hrs. | |
| 11-8 - Office - Report & Maps. | 4 hrs. | |
| 11-12 - Field - C.P. & C. Basin | | 1 day. |
| 11-13 - Office finish report | 4 hrs. | |

Total 4 days five hrs.

3 days at \$200.00/day 900.-

1 day at 250.- 250.-

5 hrs @ 31.25

156.25
~~\$796.25~~

1306.25

Cost of Packet

Map purchases, & Map Printing 4.31

Report xeroxing - 3.94

Meals 2 days (11-5, & 11-12) \$ 14.75

Transportation (2 trips) \$ 75.00

97.80

~~96.96~~

~~96.96~~

~~1404.31~~

1404.05

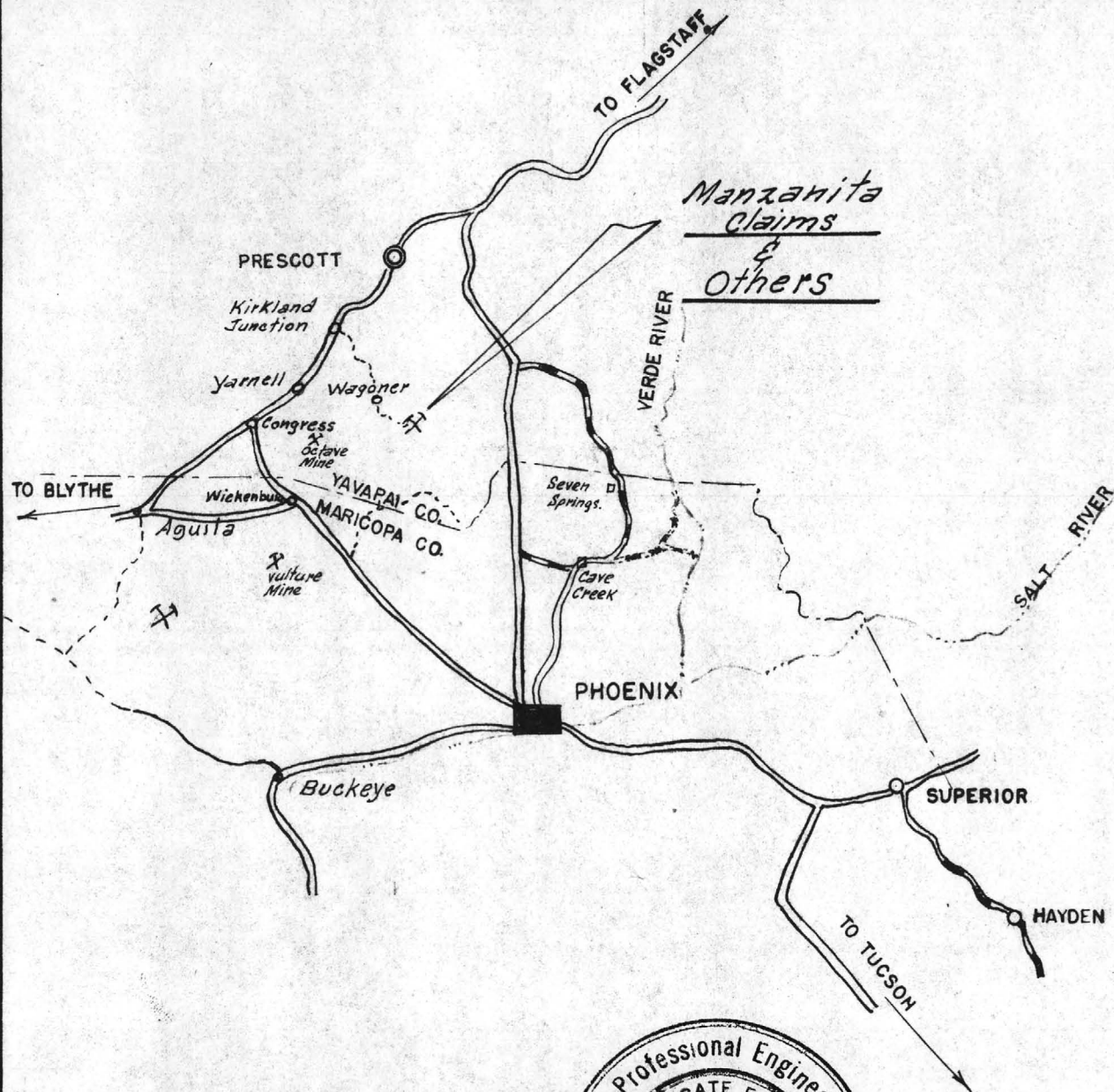

Not to be reproduced or altered
without permission.
R.E.M.

INDEX MAP CENTRAL ARIZ.

SCALE: 1" = 27 MI.

R.E. MIERITZ, P.E.

MAR., 1962

MAP No. 1

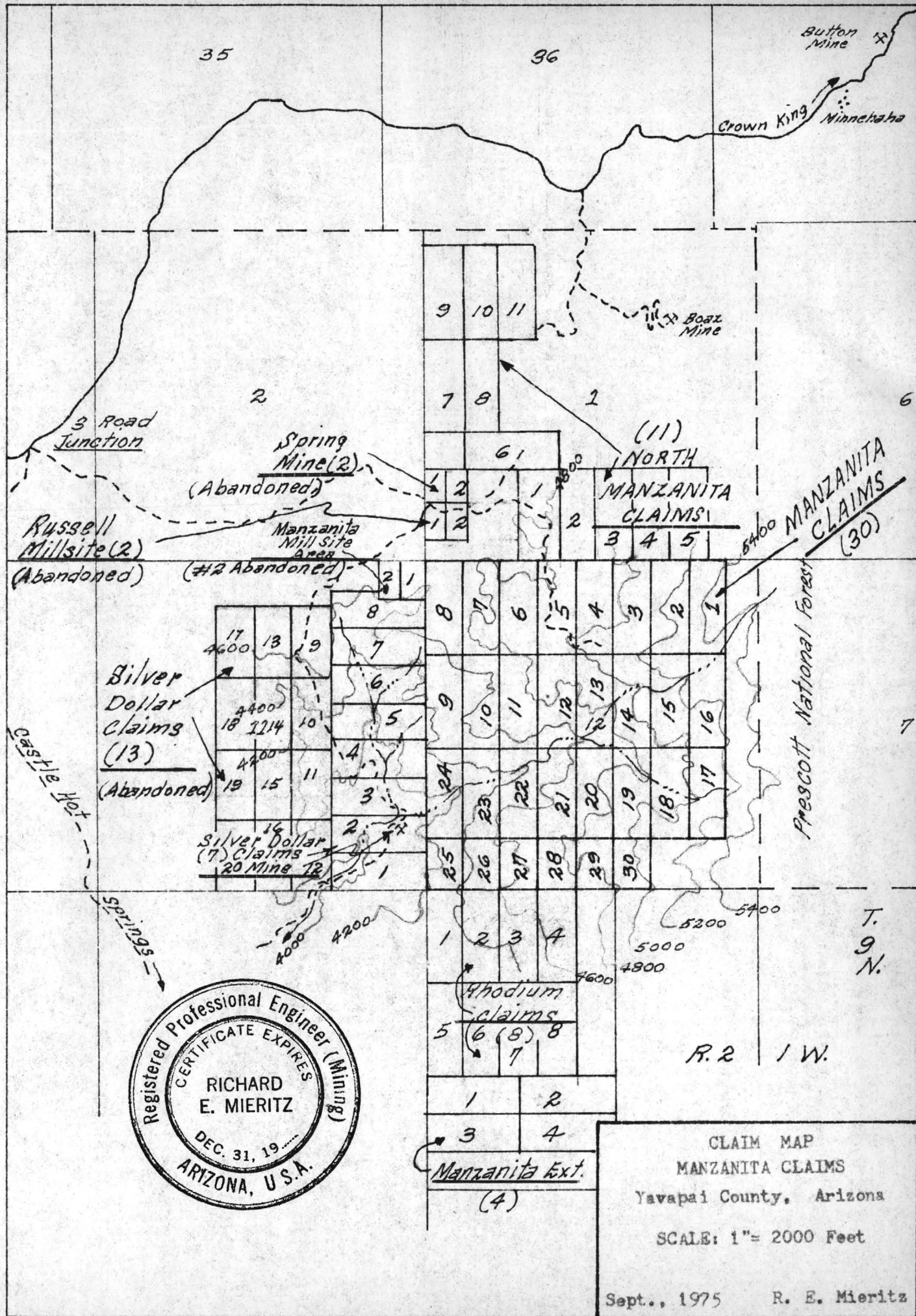

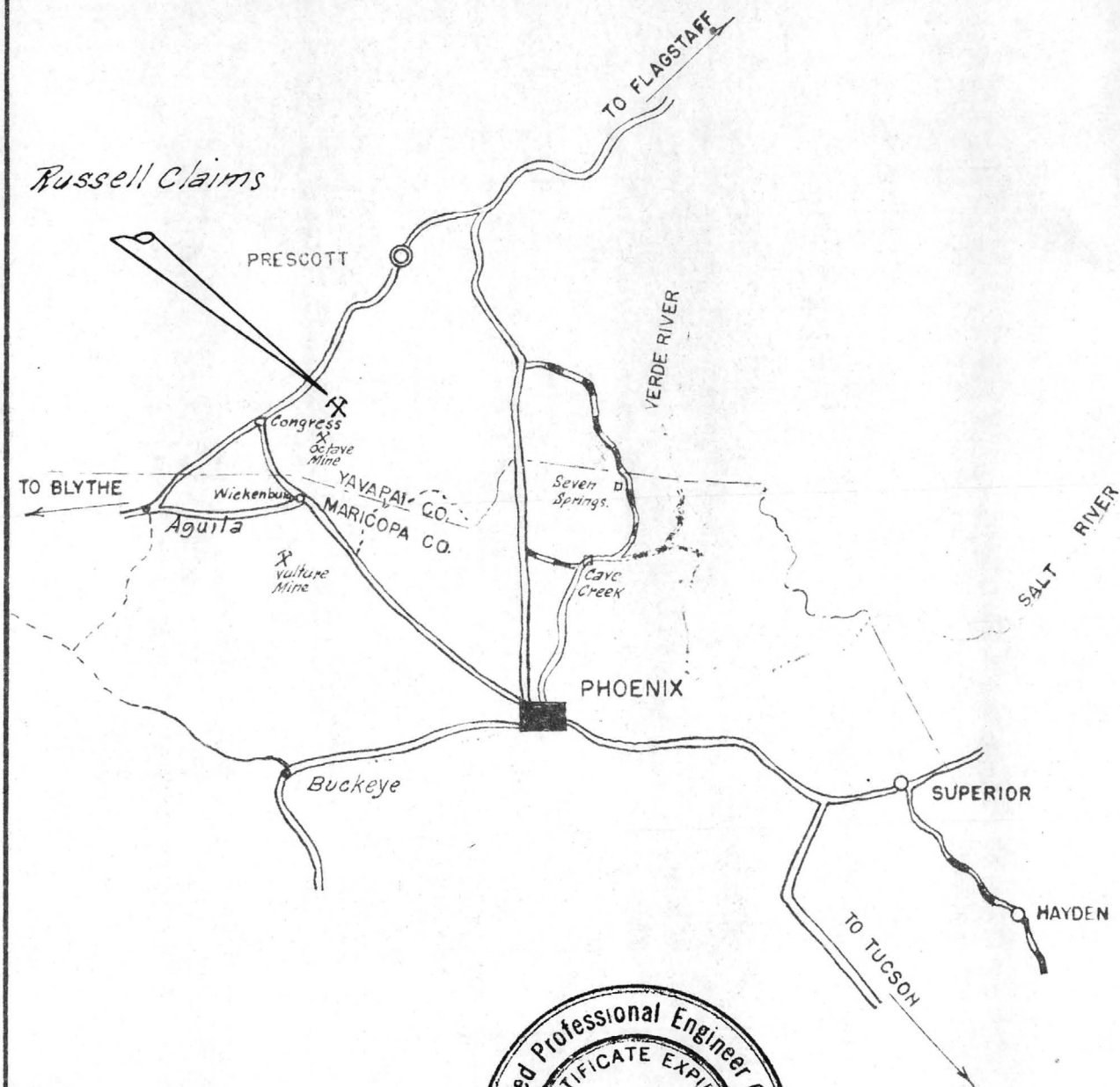

R. E. Mieritz

*Not to be reproduced or altered
without permission.
R.E.M.*

66

INDEX MAP CENTRAL ARIZ.

SCALE: 1" = 27 MI.

R.E. MIERITZ, P.E.

MAR., 1962

MAP No 3

R. 5 - 4 W

24

19

20

Russell
Mines Am'd
(4)

T.
10.
N.

25

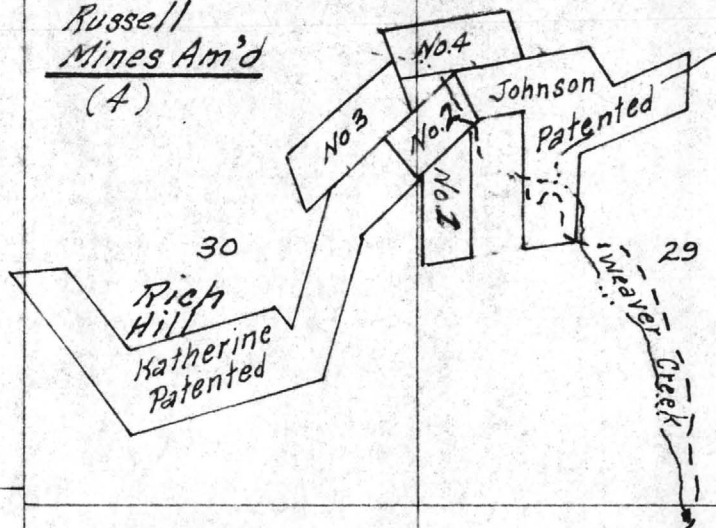

CLAIM MAP
RUSSELL CLAIMS
Weaver Mining District
Yavapai County, Arizona

Scale: 1" = 2000 Ft.

Sept., 1974 R. E. Mieritz

MAP No 4

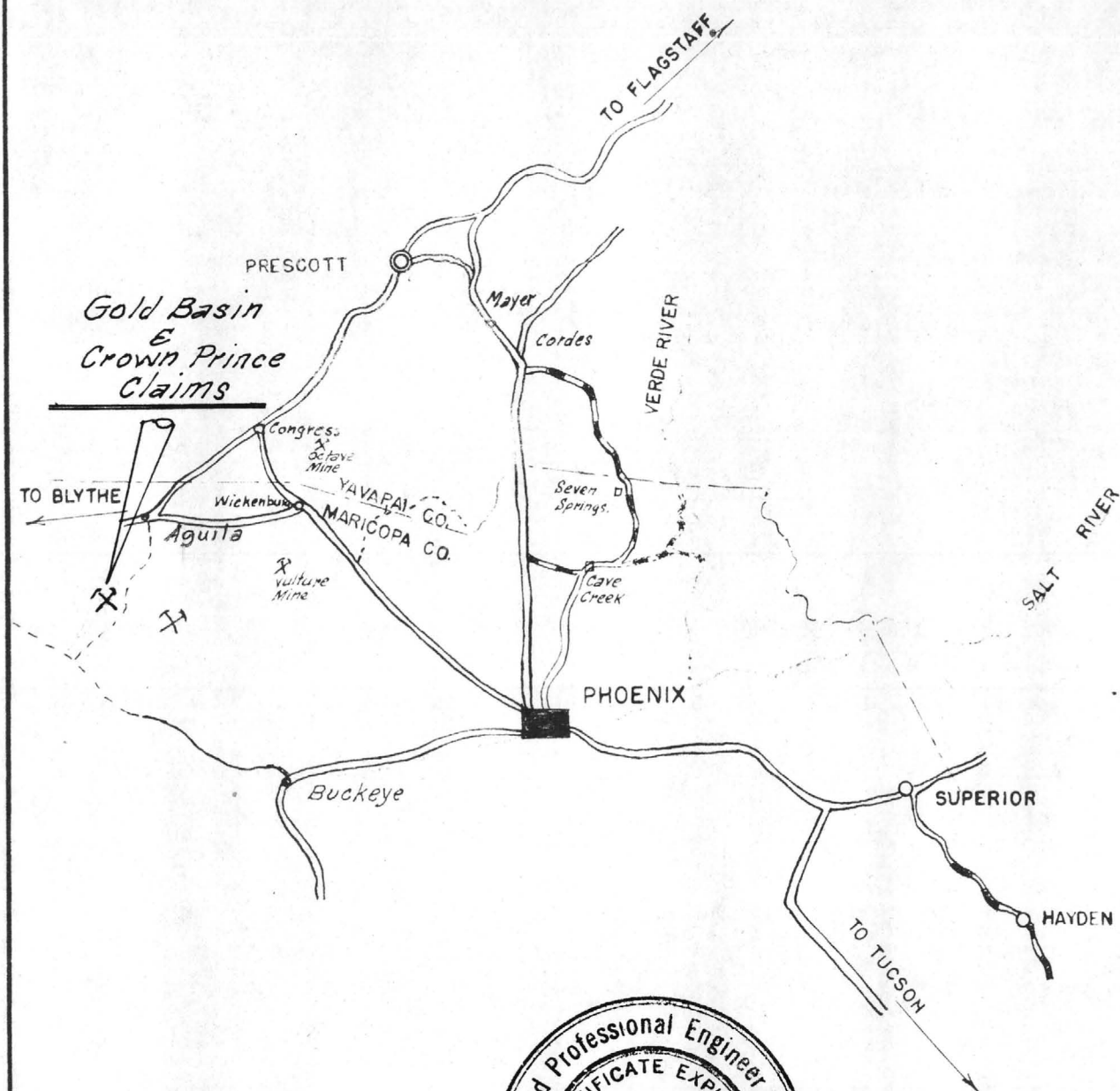

Continued

*Not to be reproduced or altered
without permission.
R.E.M.*

66

INDEX MAP CENTRAL ARIZ.

SCALE: 1" = 27 MI.

R.E. MIERITZ, P.E.

MAR., 1962

MAP No. 5

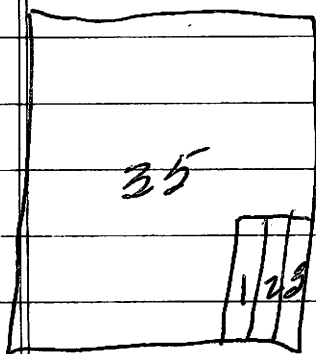

76N

10W.

Crown
Prince

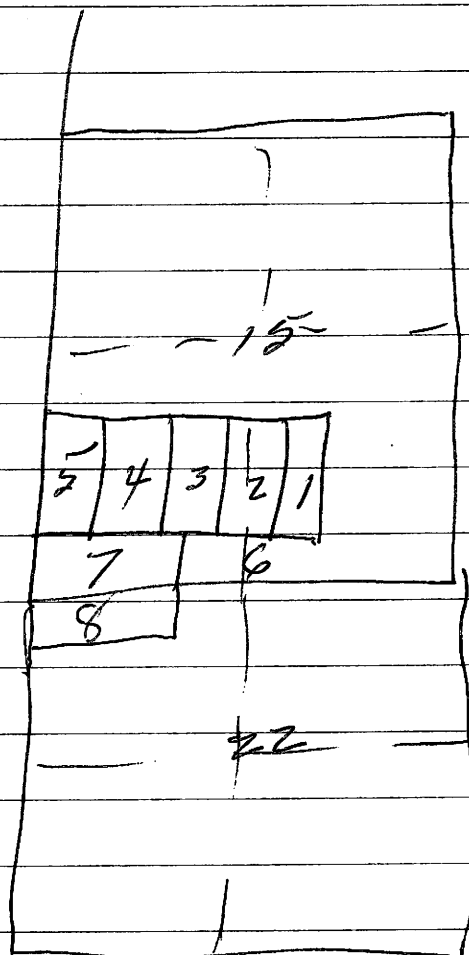

5N.

Sold Basin, 10W.

LAW OFFICE

LAURENCE H. WHITLOW, P. C.

FORMERLY
WETZEL & WHITLOW

524 EAST DUNLAP AVENUE
PHOENIX, ARIZONA 85020

TELEPHONE 943-3456
AREA CODE 602

October 30, 1979

Mr. Richard E. Mieritz
2940 N. Casa Tomas
Phoenix, AZ 85016

Re: Estate of Clifford J. Russell, Deceased

Dear Mr. Mieritz:

Pursuant to our telephone conversation this date, I am enclosing the copy of the inventory of the estate which shows all of the claims in which the estate has an interest and which must be appraised for tax purposes.

You will note that Frank Russell has a considerable interest in all of these claims. As you may or may not know, Frank Russell's address is:

P. O. Box 101
Yarnell, AZ 85362
Tel: 1 427-3342

You indicated that you have been on some of these claims, but I would imagine it would help if Frank assisted you in locating all of the claims.

If I can be of any further service, do not hesitate to call me.

Very truly yours,

LAURENCE H. WHITLOW, P.C.

Laurence H. Whitlow

LHW:mw

Enclosure

on the surface in a small pit some 400 feet along the strike of the vein southwest of the sampled shaft. The results of the samples are:

| Samp. Number | Discription | Ounces/ton | | Value/ton |
|--------------|---|------------|--------|-----------|
| | | Gold | Silver | |
| 1251 | 4 foot vertical across white bull quartz vein - some iron limonite, some copper sulphides, galena | 0.005 | 0.36 | \$ 2.30 |
| 1252 | Across 18" of two 6 inch bull quartz veins with 6 inches of andesite between quartz veins exposed in small pit 400 SW of shaft. | 0.005 | 0.44 | \$ 2.66 |

Value based on quoted prices in the Engineering & Mining Journal of August, 1974.

The "bull quartz" veins have a general northeast trend or strike and usually dip quite gently (10 to 20°) to the northwest. In most instances they are associated with highly altered andesite dikes, all cutting the Bradshaw granite, the host rock.

The mining history of the Weaver District, dating back to the early 1860's is one of "seek and find" with the end result that little profit, except in small ways, is realized even with its estimated one and a half million dollar production credit.

Any investment in this property should be done by an organization in the mining business and who is accustomed to long term investment, expenditures, not fearful of money loss and satisfied with small return of money percentage over a long period.

Respectfully yours,

R. E. Mieritz
Mining Consultant
Phoenix, Arizona

September 13, 1974

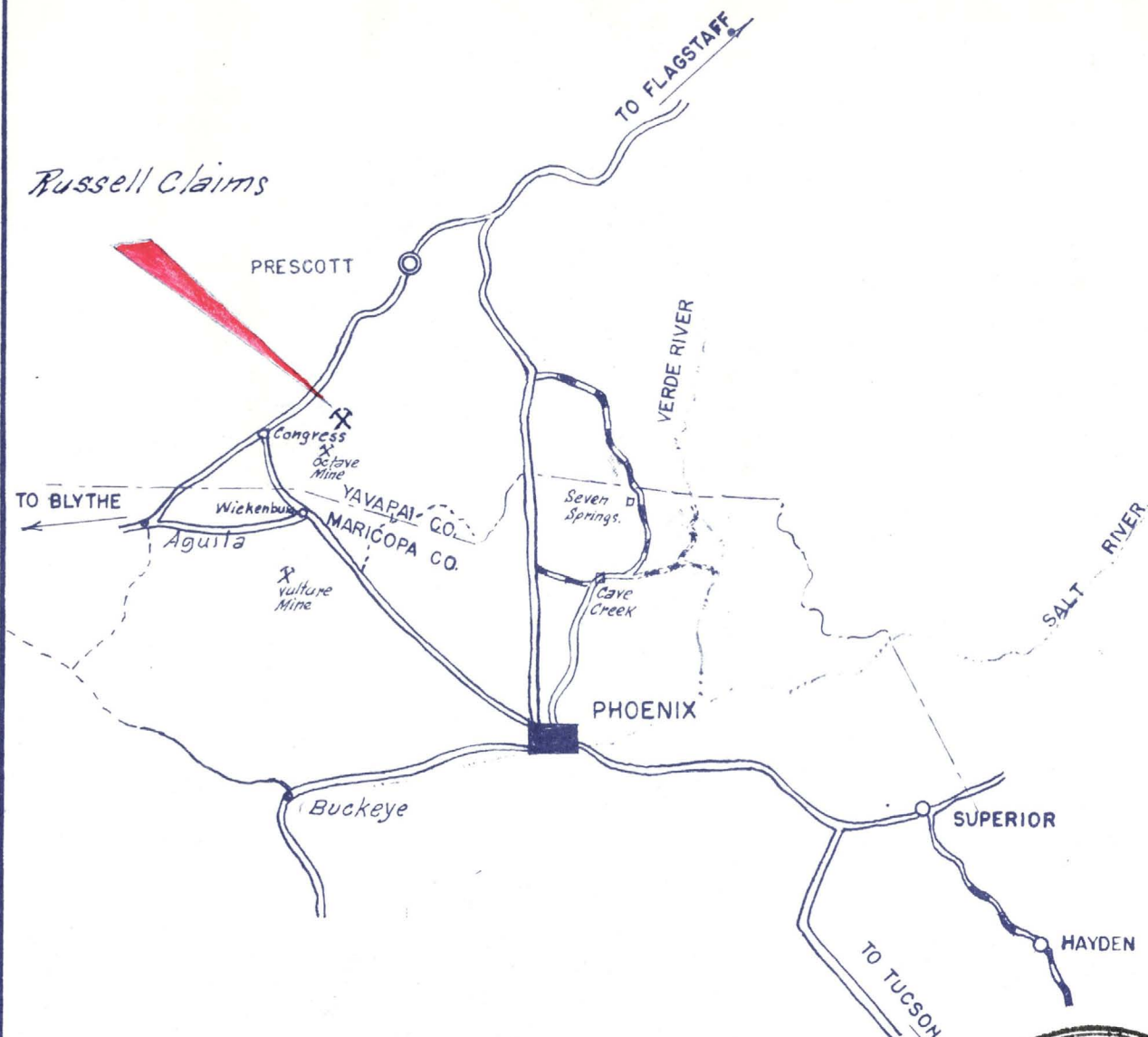

R. E. Mieritz

*Not to be reproduced or altered
without permission.
R.E.M.*

66

INDEX MAP CENTRAL ARIZ.

SCALE: 1" = 27 MI.

R.E. MIERITZ, P.E.

MAR., 1962

MAP No. 1

A-23

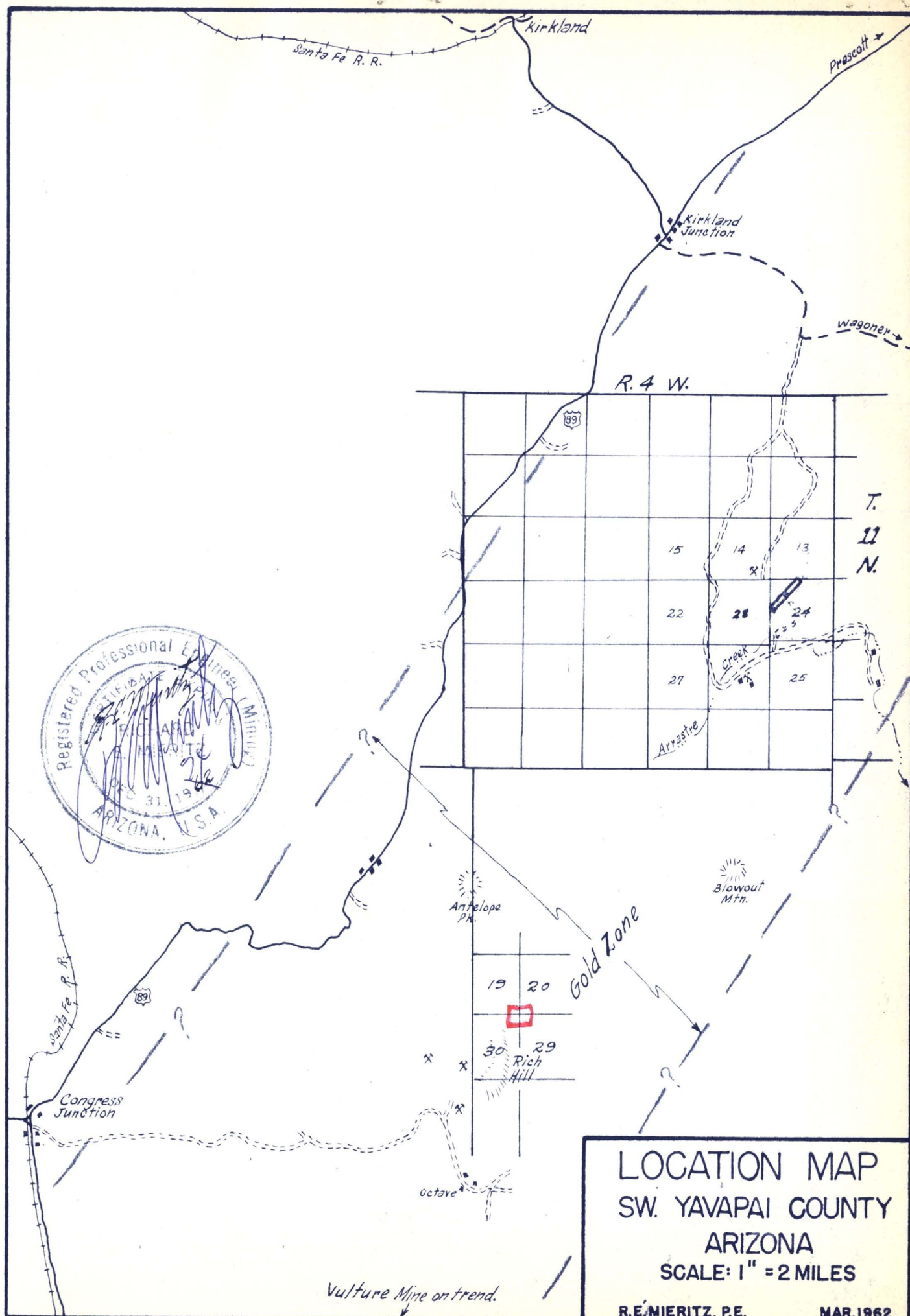

R. 5 - 4 W

24

19

20

25

30

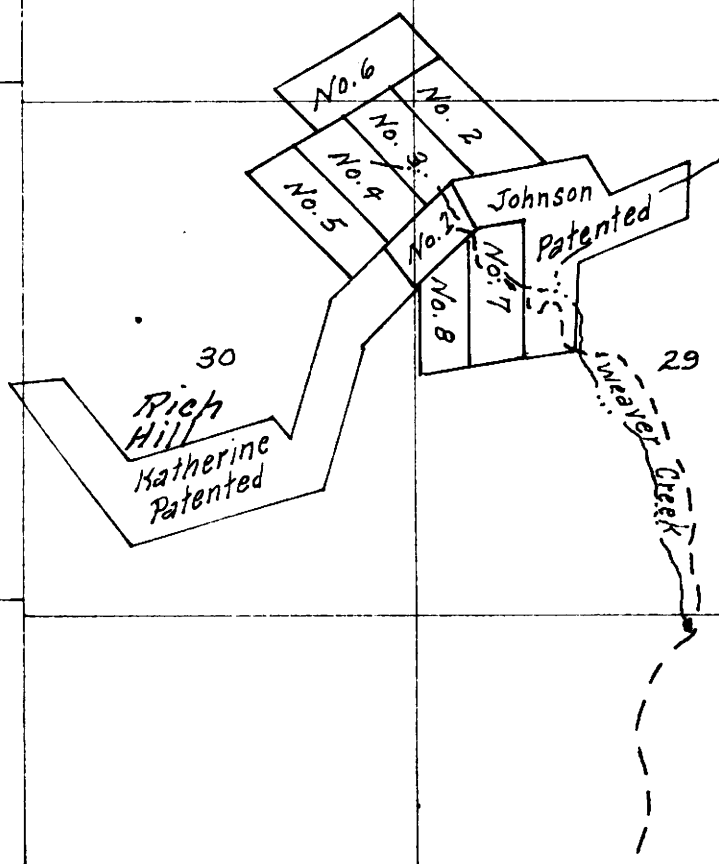

T.
10.
N.

CLAIM MAP
RUSSELL CLAIMS
Weaver Mining District
Yavapai County, Arizona

Scale: 1" = 2000 Ft.

Sept., 1974 R. E. Mieritz

MAP No 3

Grassell Husb - 977-7211 Ext 334
Home 2284, Missouri - 279-0197

Dr Donald Tobias - Edward Twitty, attorney

| <u>Sold claims</u> | <u>Bk</u> | <u>Page</u> | <u>Acct'd</u> |
|--------------------|-----------|-------------|---------------|
| Grassell No 1 | 772 - | 391 | |
| " No 2 | 784 - | 898 | |
| 3 | 784 | 899 | |
| 4 | 820 - | 285 | |
| 5 | 821 - | 604 | |
| 6 | 905 - | 848 | |
| 7 | | | |
| 8 | | | |

Sec 19, 20, 29, 30, T. 10 N. R. 4 W.

deane Mining Dist.

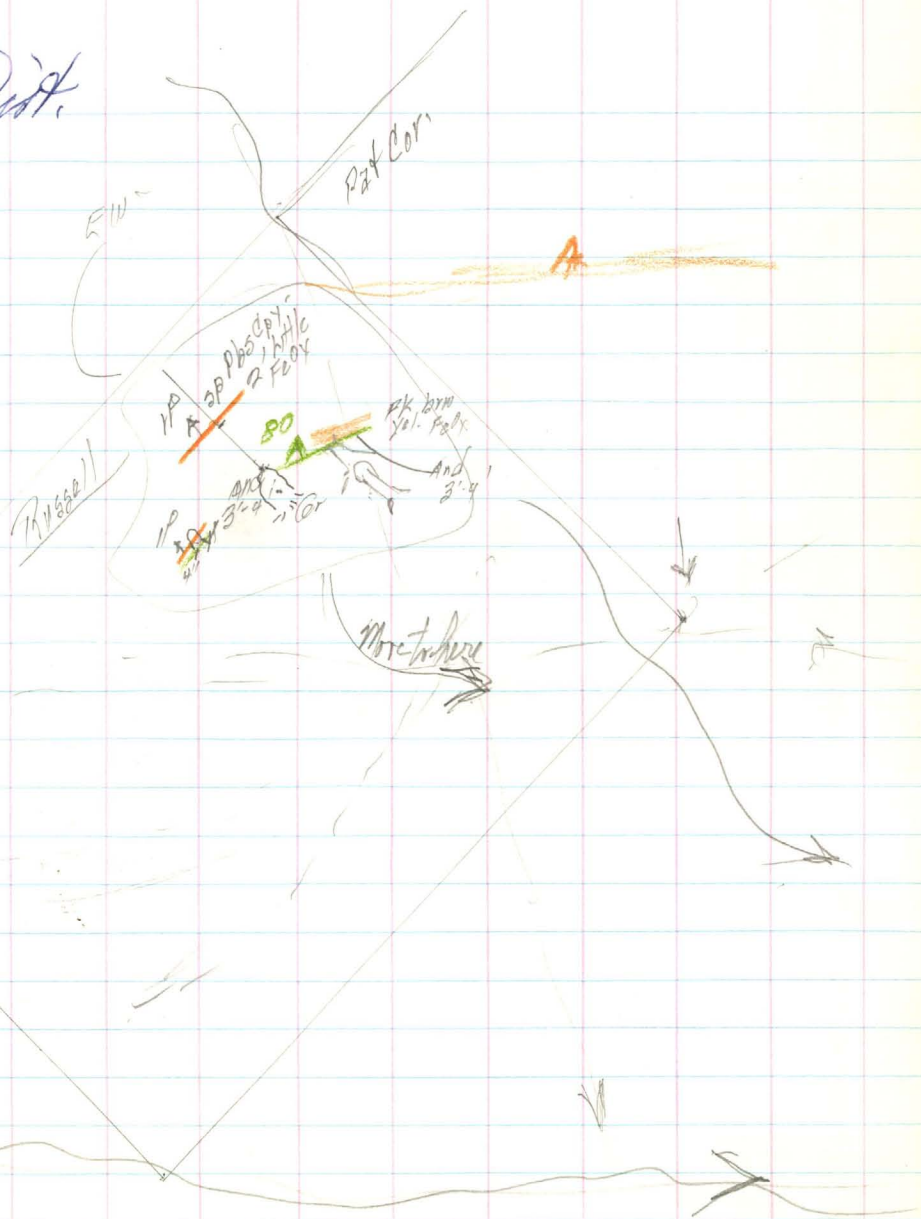

5amp.

Gr. B.W. Fresh - some Fox on
little Fox. NW 1 ft.
Footwall

85021

A Dean
~~John~~ ~~Madchak~~ - Madchak
522 W Northway
Dan Tobias - Paola, Kansas }

Don E.
Russell

\$100,000 - Exploration - development - 150,000 to 200,000 tons.

- (1) Enough Rd.
- (2) Drilling - 200'-400' -
- (3) Lifting - according to requirements.