



CONTACT INFORMATION  
Mining Records Curator  
Arizona Geological Survey  
416 W. Congress St., Suite 100  
Tucson, Arizona 85701  
520-770-3500  
<http://www.azgs.az.gov>  
[inquiries@azgs.az.gov](mailto:inquiries@azgs.az.gov)

The following file is part of the

Richard Mieritz Mining Collection

### **ACCESS STATEMENT**

These digitized collections are accessible for purposes of education and research. We have indicated what we know about copyright and rights of privacy, publicity, or trademark. Due to the nature of archival collections, we are not always able to identify this information. We are eager to hear from any rights owners, so that we may obtain accurate information. Upon request, we will remove material from public view while we address a rights issue.

### **CONSTRAINTS STATEMENT**

The Arizona Geological Survey does not claim to control all rights for all materials in its collection. These rights include, but are not limited to: copyright, privacy rights, and cultural protection rights. The User hereby assumes all responsibility for obtaining any rights to use the material in excess of "fair use."

The Survey makes no intellectual property claims to the products created by individual authors in the manuscript collections, except when the author deeded those rights to the Survey or when those authors were employed by the State of Arizona and created intellectual products as a function of their official duties. The Survey does maintain property rights to the physical and digital representations of the works.

### **QUALITY STATEMENT**

The Arizona Geological Survey is not responsible for the accuracy of the records, information, or opinions that may be contained in the files. The Survey collects, catalogs, and archives data on mineral properties regardless of its views of the veracity or accuracy of those data.

ARIZONA REG'D MINING ENGINEER  
1338 WEST THOMAS ROAD  
PHOENIX, ARIZONA 85013  
TELEPHONE 279-7354

REPLY TO:

22 NORTH 22ND PLACE  
PHOENIX, ARIZONA 85016  
TELEPHONE 955-7353

Richard E. Mieritz  
MINING CONSULTANT

GEOLOGY  
EXPLORATION  
EVALUATION  
FEASIBILITY  
OPERATION

January 18, 1967

Mr. Grat Wilson  
P. O. Box 1043  
Wikieup, Arizona

Dear Mr. Wilson:

Herewith my report based on the observations and physical measurements I made during the examination of the Adit Level on your Copper Head claims located about eight miles southwest of Wikieup, Arizona.

The examination was completed on January 14, 1967 and I was accompanied by Mr. A. H. Mackenzie, Mr. Royce Hardy and yourself. My thanks to Mr. Hardy for his help in the actual survey of the Adit Level.

My thanks also to Mrs. Wilson for her hospitality and coffee.

I enclose my statement which I understand from Mr. Mackenzie, you had provided him a retainer to get the work started. Mr. Mackenzie will advise you how much he has given me and if any balance remains you can forward same to me at the above address. Thank you again.

Very truly yours,

R. E. Mieritz, P. E.  
Mining Consultant



*Richard E. Mieritz*  
MINING CONSULTANT

REPLY TO:

22 NORTH 22ND PLACE  
PHOENIX, ARIZONA 85016  
TELEPHONE 955-7353

January 17, 1967

Mr. Grat Wilson  
P. O. Box 1043  
Wikieup, Arizona

Dear Mr. Wilson:

On January 14, 1967 the writer completed a brunton and tape survey of the Adit Level located on the Copper Head claims which are situated in part of Sections 19, 20, 29 and 30 of T. 15 N., R. 13 W., G. and S. R. B. and M. in Mohave County, Arizona.

Purpose of the survey was to obtain an accurate map in so far as cloth tape and brunton will permit, and to evaluate the amount of development and degree of workmanship that has been done by the lessee since November 4, 1965, the date of a "lease and option to buy" agreement between yourself, Grat Wilso, lessor and lessees Redd and Frost as noted in the legal instrument.

POINTS OF CONCERN:

You had indicated that the lessee had accomplished the following:

- (1) advanced the Adit level beyond a point marked on the wall of the drift and so indicated (station 4 plus 63 feet) on the attached map.
- (2) installed an 18" air vent line from the portal to the working faces as well as a 4" compressed air line.
- (3) removed sufficient rock in the upper left corner of the Adit from the portal to where the "face" existed on November 4, 1965, in order to install the 18" air vent and 4" compressed air line.
- (4) installed timbers as stulls, stulls with one post or complete timber sets (caps and posts)
- (5) removed much and caved material and timbered in an area when the forward progress of the Adit intersected an old shaft or stope.
- (6) mined 24 tons of ore from two areas or small stopes, and,
- (7) "graveled" the floor of the Adit Level with a "clay-like" material which becomes "mud" when wet.

During the course of the actual survey the writer kept the above points in mind as as to evaluate same from a monetary standpoint, quantity and quality standpoint (miner-like fashion) as well as a time standpoint.



### WORK ACCOMPLISHED

The writer has determined that the following work has been accomplished:

- (1) 125 lineal feet of drift or crosscut advance which averages 7 feet wide and a strong 7 feet high in cross-section, for the most part, untimbered.
- (2) installed (hung) approximately 340 feet of 18" air vent line and approximately 340 feet of 4" compressed air line.
- (3) removed approximately 300 lineal feet of rock from the upper left hand portion of the Adit (averaging 1 foot wide and 1½ feet high, as a triangle) to permit installation of the air vent and 4" compressed air line.
- (4) installed 8 sets of timber and at least 15 stulls or stulls with a post.
- (5) Removed muck and/or cave from the old shaft or stope area--quantity unknown.
- (6) mined 24 tons as evidenced by the two stopes closest to the "shaft area" and indicated on the attached map.
- (7) "graveled" approximately 240 lineal feet of Adit floor to create a hard, smooth surface to accomodate the rubber tired equipment used by the lessee.

### EVALUATION OF WORK DONE:

Mine work completed can usually be evaluated by using one or more of the following as a base:

- (1) manshifts, the most frequently used measure.
- (2) tons of rock or mineral and
- (3) a dollar value for some unit of measure.

The evaluation of work completed by the lessee is based herein on the writers many years experience with small and large mining and exploration projects. Many intangible conditions such as location, accessibility, nearest source of supplies and spare parts and climatic conditions are always reflected in any evaluation of mine project progress or advance, costs, etc. Such considerations are herein included in the writers evaluation of the work actually performed by the lessee, or said in another way, what work, costs, etc, the writer would consider as satisfactory if such work were being completed for him on a project of similar conditions.

The tabulation on the following page has been prepared to provide a condensed evaluation of the work completed by the lessee.

# TABULATION of WORK COMPLETED

<u>Item</u>	<u>Type Work</u>	<u>Number</u>	<u>Lineal Feet</u>	<u>Size</u>	<u>Tons</u>	<u>Value Per unit</u>	<u>Total Value</u>	<u>Man Shifts</u>	<u>Number Men</u>
1	Drifting, Xcutting.		125	7' x 7'	500	\$50.00	\$6250.00	75	3
2	Install air vent line.		340	4" air 18" Vent		\$ 1.00	\$ 340.00	12	2
3	Blast for airlines.		300	1' x 1½'	20	\$ 1.00	\$ 300.00	12	2
4	Timber, Sets,	8	25	8' x 8'		\$14.00	\$ 350.00	14	3
	Stulls,	15	22	8"x8" timber		\$ 6.80	\$ 150.00	6	2
5	Remove muck (old shaft)				?		\$ 375.00	15?	3
6	Mined ore (hand sort)		20	1½' x 8'	24		\$ 300.00	12	3
7	Graveled Adit floor		240	6' x ½'	40		\$ 200.00	8	2
	Equipment repair, about 10% of actual time (breakdowns)						\$ 375.00	15	
	Dead Work, install equipment, pump water, haul supplies into area, etc. about 12% actual time						\$ 275.00	18	
	Geologist-Engineer (assuming there was one)						\$ 400.00	8	
Totals							\$9315.00	195	



WORKMANSHIP by LESSEE:

With regard to grading the workmanship of the work completed by the lessee-- or as stated in the November 4, 1965 agreement, quote "workman-like manner and in accordance with sound engineering and geological practice to obtain economical return" unquote, the writer did not see or observe any major divergence from the afore mentioned requirement.

In an instant or two, the "stull" timbering was not sufficiently "hitched into the wall, but then too, the timber has now dried to some extent thus permitting wood wedges to loosen and perhaps give an impression of "un-miner-like" work.

It is the opinion of the writer that in some instances the "stull" installation was superfluous because the rock penetrated is quite competent. Some "barring down" would easily have corrected what might be termed a "limited" or confined risk area.

The vein portion is somewhat a lesser competent rock but does not exceed 18 inches in width and would soon "catch itself up", or natural arch itself.

On the whole the writer could approve the "miner-like" quality of this work, that is, drifting, timbering, stoping and including the installation of the 18" air vent line because of the diesel driven equipment that was used to perform this work.

With reference to the 264 work day stipulation of the agreement, it appears that this condition has not been met as indicated by the writers evaluation of only 195 man shifts but the human element of a "hard worker" as compared to an "easy worker" and the degree of supervision is an elusive factor controable only at the time the work was completed. The writers 195 man shift figure is realistic with reservations as indicated above.

Respectfully submitted,

---

R. E. Mieritz, P. E.  
Mining Consultant

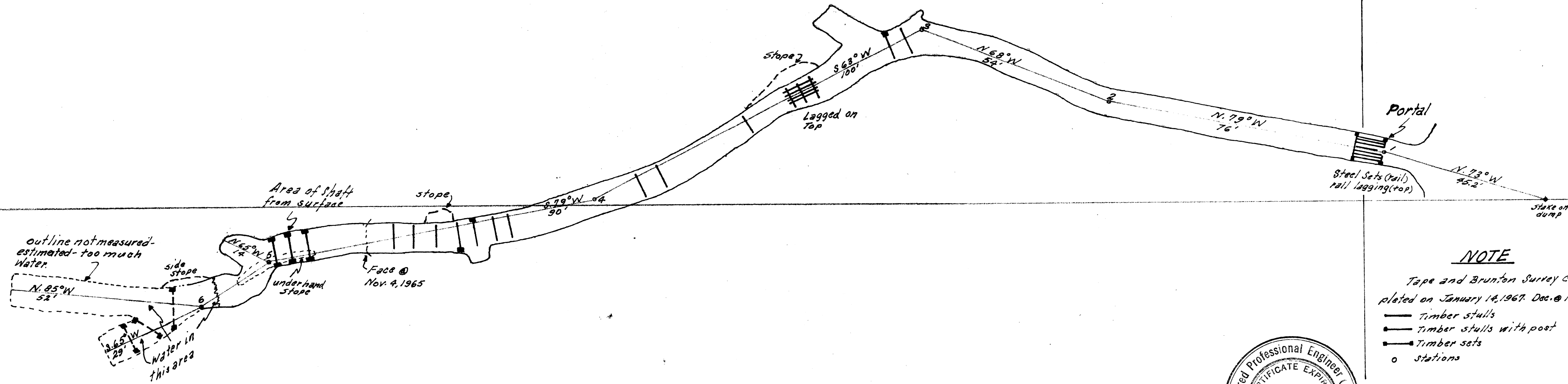

**NOTE**

Tape and Brunton Survey completed on January 14, 1967. Dec. @ 14° 30'

- Timber stulls
- Timber stulls with post
- Timber sets
- o Stations



**ADIT LEVEL**  
**COPPER HEAD MINE**  
AUBREY MINING DISTRICT  
MOHAVE CO., ARIZ.



R. E. Mieritz

Jan. 15, '67

ALBERT H. MACKENZIE  
DEAN SCOTT  
VERN E. GASSER  
DUANE W. BOLZE  
JULIAN F. WELTSCH  
WILLIAM T. MORONEY

LAW OFFICES  
MACKENZIE, SCOTT, GASSER, BOLZE & WELTSCH  
SUITE 1104, SECURITY CENTER  
222 NORTH CENTRAL AVENUE  
PHOENIX, ARIZONA 85004

TELEPHONE 254-6054

15 March 1967

Mr. Richard E. Mieritz  
5822 North 22nd Place  
Phoenix, Arizona 85016

Re: Mr. Grat Wilson

Dear Dick:

I have received a note from Mr. Grat Wilson dated March 13th, requesting the return of the map of claims of the Copperhead Mine, which he believes one of us has in his possession. A check of our files reveals that we do not have this, so am forwarding his request on to you.

Thank you.

Sincerely yours,



Albert H. Mackenzie

mm

cc: Mr. Grat Wilson  
P.O. Box 1043  
Wikieup, Arizona



March 25, 1967

Mr. Albert H. Mackenzie  
Suite 1104. Security Center  
222 North Central Avenue  
Phoenix, Arizona, 85004

Re: Mr. Grat Wilson

Dear Mac:

Reference is to your March 15th letter regarding the "where-abouts" of the Copperhead Claim Map which was borrowed from Mr. Grat Wilson.

As indicated in my telephone conversation of March 20th with your secretary, I do not have the map of the Copperhead Claims in my possession. I prepared the map of the Adit from my own survey notes and since that was the main purpose of the examination, I had no interest or need for the Claim Map which we had reviewed in Mr. Wilsons home prior to our departure from Wikieup on January 14, 1967.

It is hoped you can locate the map in question.

Thanking you,

Sincerely yours,

R. E. Mieritz, P. E.  
Mining Consultant

cc: Mr. Grat Wilson  
P. O. Box 1043  
Wikieup, Arizona

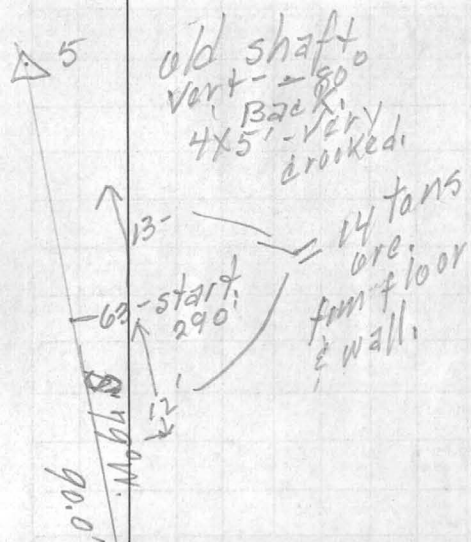

6.3 9.0 7.5 7.7 7.5  
 7.0 6.5 3.5 1.5 2.0 cor. 4.0  
 Δ4-18.0 40. 56 43(st) 77 88 Δ  
 1.2 1.8 4.5 6.0 7.0 7.0 6.5  
 31-37 Turnaround. 4' deep.

Stope open @ 39'-45' - 17.5 from floor-floor  
 to back (orig. average 4" wide).

Stalls @ 24, 28, 33.5, 38, 44, 50  
 P P  
 Posts loose - Blocking okay.

Sets @ 79, 83.5 88.0 these okay - blocks loose  
 8x8'

Back stopes - 30' to 53' - stalls @ 33.5 37  
 40 - Not lagged fully. 8x8'  
 stalls 54 - not too solid.  
 stalls 81 & 87'

Elev = 7.5 8.0 8.0 7.8 11.5' 11.5  
 8.0 5.8 4.5 4.0 10' 9.0' 6.8 9.5 10  
 5.0 5.5 3.5 6.0 4.0 4.5  
 Δ3 5.0 10 19 22 30 42 63 81 Δ4  
 4.5 3.8 4.5 17.4 6.0 3.6 3.5 1.7 1.5 4.5  
 cor. @ 15 = 7.1

@ 5' - Stall - 8x8'  
 Solid-wedge Block  
 loose.

small slope 18" wide up - 5' - loose.  
 @ 10 - Stall & post - 8x8 - solid, except cap - no  
 wedges.



A hand-drawn sketch of a plant stem with several leaves and a flower bud, drawn on graph paper. The stem is curved, and the leaves are small and pointed. A flower bud is at the end of the stem. The drawing is done in black ink.

Agreement Nov. 4 1965

2 leases on 2 prop.

16 claims - Trail, Copper Head And, Copper Head  
And #2 through 15. Book 6-A pages 165-179  
Trail Book 5V page 21 Mineral County - Idaho  
Mining Dist. unpatented

264 work days required - no time limit - work -  
man like manner and in accordance with  
sound engineering and geological practice - to  
obtain economic return

2 shipments - 1<sup>st</sup> 10 tons } To Inspiration  
2<sup>nd</sup> 14 tons }

Argonite - about 6" wide?  
ore

paid royalty on 1<sup>st</sup>  $\$858$  15%  $\pm 572.00$  / ton or 500 oz.  
2<sup>nd</sup>  $\$150 \pm$  15%  $\pm \$1000$  / ton or  $\$66$  / ton  
or 500 oz.  
 $\approx 1400.00$  or  $140.00$  / ton  $\pm 120$  oz / ton

June 66 - 4,572 oz - small piece from dump.

operators might not know ore?

316' wide for 140' - they wanted to put 18" air vent.

mining machine - 1x7 - 5' rounds - 45 min.

90 ft of drift rock - all on same level - 3-4

started on 2nd - couple of months

Energy Blowing 1st,



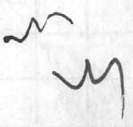

↑  
Many 10 tons Highgrade.  
one 18" wide.

○

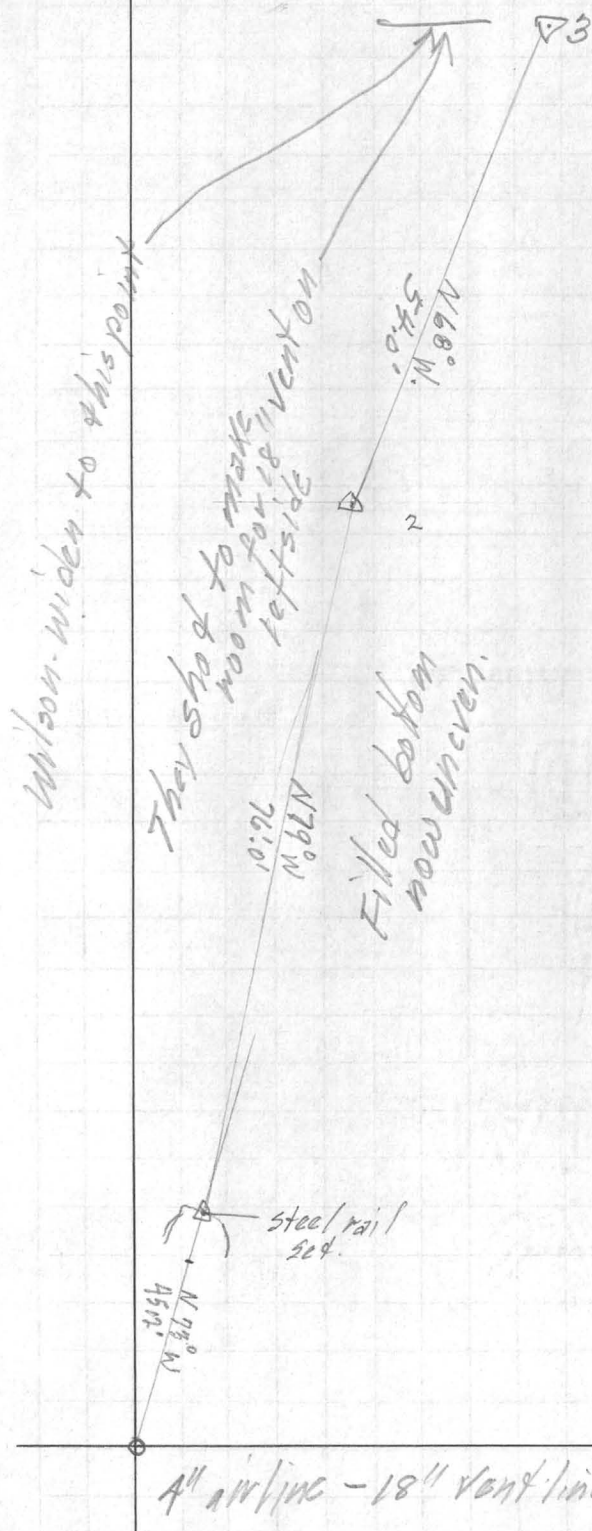

Elev. 6.7 7.2 7.0 7.0 6.7 7.5  
4.5 3.2 3.5 2.5 4.5 6.8  
2Δ 5.1 13 25 35 44 Δ3  
3.5 4.0 5.2 5.0 3.1 2.4

6.1R  
Elev. 7.0 6.8 6.3 6.6 7.5 7.0  
7.5  
↑ 4.0 4.0 4.5 4.0 4.0  
Δ 28 21 34 45 60 Δ  
45 3.6 3.5 3.8 3.2

2nd  
steel set  
left rib. Post. Top 81° - evidence of  
sliding on rock at top - not now blocked

2.8R  
3' 3.8  
0+ 39 Δ1  
4' 3.8  
3.0R.



January 15, 1967

Mr. Grat Wilson  
P. O. Box 1043  
Wikieup, Arizona.

Dear Mr. Wilson:

During my tape and brunton survey of the Adit level we encountered water in the floor of the last 50 to 60 feet of development which prevented true measurements of the width of the development.

The presence of the water limits accessibility and can make an operation somewhat miserable. The floor in the area of the water is somewhat uneven and in the lowest spot, about a foot of water exists. It is suggested that you pump this water out occasionally so as to keep the development as dry as possible to facilitate the use of the mobile equipment that is used for mucking, drilling and haulage equipment. It is further suggested that the water be pumped to the outside through use of pipe so as not to get the clay like material wet which has been used to "gravel the floor" of the adit to obtain a hard smooth surface for the mobile equipment.

Dewatering of this area should be done as soon as possible, as I feel sure your attorney would give you permission from the legal standpoint.

Very truly yours,

R. E. MIERITZ

---

R. E. Mieritz, P. E.  
Mining Consultant.