



CONTACT INFORMATION
Mining Records Curator
Arizona Geological Survey
3550 N. Central Ave, 2nd floor
Phoenix, AZ, 85012
602-771-1601
<http://www.azgs.az.gov>
inquiries@azgs.az.gov

The following file is part of the G. M. Colvocoresses Mining Collection

ACCESS STATEMENT

These digitized collections are accessible for purposes of education and research. We have indicated what we know about copyright and rights of privacy, publicity, or trademark. Due to the nature of archival collections, we are not always able to identify this information. We are eager to hear from any rights owners, so that we may obtain accurate information. Upon request, we will remove material from public view while we address a rights issue.

CONSTRAINTS STATEMENT

The Arizona Geological Survey does not claim to control all rights for all materials in its collection. These rights include, but are not limited to: copyright, privacy rights, and cultural protection rights. The User hereby assumes all responsibility for obtaining any rights to use the material in excess of "fair use."

The Survey makes no intellectual property claims to the products created by individual authors in the manuscript collections, except when the author deeded those rights to the Survey or when those authors were employed by the State of Arizona and created intellectual products as a function of their official duties. The Survey does maintain property rights to the physical and digital representations of the works.

QUALITY STATEMENT

The Arizona Geological Survey is not responsible for the accuracy of the records, information, or opinions that may be contained in the files. The Survey collects, catalogs, and archives data on mineral properties regardless of its views of the veracity or accuracy of those data.

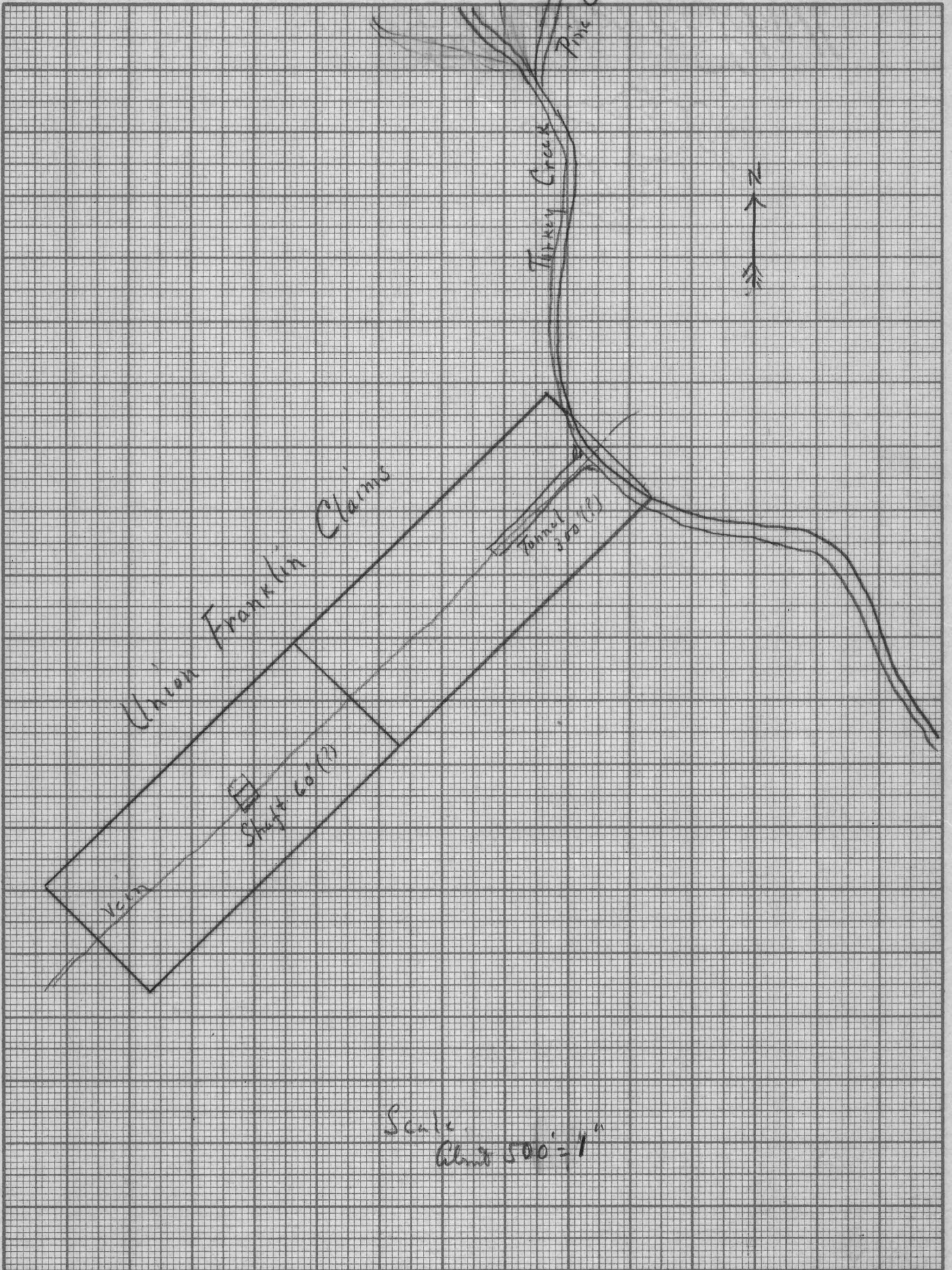

COPY

GIROUX ASSAY OFFICE

MAYER, ARIZONA

ASSAY CERTIFICATE

Mr. Bert Roby

Mayer Arizona

July 10, 1935

Union Franklin Silver Mine

Gold #35 oz.
Silver --.77¢ oz.

No.	Sample	Gold oz.	Silver oz.	Total value
#1.	From tunnel (cobbed)	.03	288.	\$222.81
#2.	After cobbing #1	.01	12.6	10.05
#3	From Shaft (cobbed)	.04	224.	173.83
#4	After cobbing #3	.015	16.2	12.99
#10	Average of vein	.012	66.	55.02

GIROUX****ASSAYER

9/19/35

THE UNION FRANKLIN SILVER MINE is located about two miles from the Keystone Group, visited by White, and it is best reached by driving to Pine Flat from Mayer and then turning on a side road to the west at the old buildings and to the Dondrio Ranch and then keeping on the west side of the creek past the old mills and through a gate and then down along the creek by a burro trail two and one-half miles past the Trinity Mine and below this about one mile along Turkey Creek where the dumps on the Union Franklin Claims are located close to the creek and cannot be missed. (see map)

The tunnel on the Franklins Claim is 300' long and about 120' is now open and can be sampled. The shaft on the Union Claim is 120' deep but timbers are rotted with no ladders and it cannot be descended, although there is no water in it.

The work was done in 1882-1886. The quartz vein is strong and has a width of 8-10' and the high grade stringer is continuous and represents a width of from 2" to 24" along the foot wall. The silver and small gold values are associated with galena and gray copper.

The samples quoted were taken from the dumps which altogether contain some 200 tons of material and the sorted ore which was cobbled out might represent 20 to 25% of the total,--perhaps 40 tons which Robie thinks will have a value of about \$200 per ton say a total gross value of \$8000 and a net value of close to \$7000.

Assume cost of cobbing to be \$5.00 per ton of sorted ore

Freight by pack burros to Pine Flat	\$2.00 per ton.
Truck to Clarkdale	3.00 " "
Smelter charges, penalties and deductions.	15.00 " "
TOTAL	<u>\$25.00 per ton.</u>

(The figures for sorting, burro truck freight seem much too low and total costs might run to \$40.00 per ton, which would make it necessary to sort out a very high grade of ore.)

Robie has an option on this property until about January 1st by which date he must have men working there and must have put in at least 50 shifts and he is to pay 10% royalty on shipments until complete purchase price of \$5000 is paid which must be within three years.

Four other parties, Garner, Murphy and another are now interested with Robie and they would give a 1/6 interest to anyone who will advance \$400.00 (which is to be paid back from the first proceeds from shipments) which Robie thinks will be sufficient to ship the ore on the dumps and to put the property on a self supporting basis.

Robie and associates would also consider a sale of a controlling interest to parties who would put in a road and the necessary mine equipment which might cost some \$10,000.

(In view of the very high grade of ore reported this should be worth investigating and sampling, although it is to be feared that the rich streaks and pockets may prove to be very small.)

*Replied by attention of Lube Henderson.
Samuel J. J. is 137 N. Kansas, phone 33754*

10/9/35

NOTES ON UNION FRANKLIN MINING CLAIMS

Copied

J S. M. C.

Two patented claims first worked apparently in the 1880's and later sold for taxes. Now controlled by Bert Roby and associates in Phoenix, including Mr. Garner and Ralph Murphy.

Visited this property October 5th. Driving down south on Pine Flat, three miles to a ranch, which is now being used as headquarters by Lewis Dandrio, who is developing the Trinity Mine some distance southwest.

Walked down from ranch along Pine Creek to Turkey Creek, somewhat less than a mile and then a little over half a mile down Turkey Creek to the Union Franklin Tunnel dump, which is directly above the right hand bank of the creek and in a big horseshoe bend.

The country is mainly granite-porphyry and the tunnel is about 20' above the level of Turkey Creek and above that the hill rises steeply for about 100' or more.--Then rises gradually along the strike of the vein (south 20 west.) and the outcrop can be followed at intervals for a distance of approximately 2000' to the old shaft which is over 150' above the level of the tunnel. The shaft is in fair condition, but timbers and ladders are too rotten to make it possible to descend. The dip of the vein is about 75 degrees to the northwest. The strike of the vein appears to vary between North 20 East and North 30 East. There is some quartz-porphyry and the vein itself contains crushed wall rock and quartz with some iron and lead. Apparently the silver values follow the lead. On the shaft dump there is a small pile of picked ore, perhaps 700 pounds, from which my sample assayed .05 oz. gold and 28.1 oz. silver.--Value \$21.35. The main dump of the shaft is mostly waste and probably represents some 200 tons and my sample showed a trace of gold 1.7 oz. silver value \$1.30 per ton.

The tunnel is said to have been driven in for 300' but could not be entered until the pile of muck near the portal should be cleaned out. At this point the vein appears to have a width of about 3', but is mainly composed of crushed wall rock and it is evident that the pay streak is comparatively narrow, probably not more than a few inches.

2- Union Franklin

The dump at the portal of the tunnel represents probably 800 tons and there is a small pile (about 300 pounds) of sorted ore, which, according to my samples, carry gold .01 and silver 23 oz.,--value \$18.06 per ton, while the average value of the entire dump is gold .02, silver 1.5 equals \$1.85 per ton.

It appears to me quite evident that this property is not likely to have any value except for small operations by leasers, although there is a possibility that the vein might appear better in the bottom of the shaft and toward the face of the tunnel. Also there is a chance that better values might come in at greater depth, but the money which would have to be spent in exploration and development would be a pure gamble and not a very good one.

Under present conditions any ore that might be mined would have to be packed on burros for about one and one-half miles to the ranch and then trucked over a very rough road three miles to Pine Flat and some ten miles further to Mayer.

If enough low grade ore should be developed to justify the erection of a small mill it is probable that enough water for a 25 ton mill can be obtained from Turkey Creek, but no indications of any low grade ore body were observed.

S. M. C.

Upper Turkey Creek District

