



CONTACT INFORMATION  
Mining Records Curator  
Arizona Geological Survey  
3550 N. Central Ave, 2nd floor  
Phoenix, AZ, 85012  
602-771-1601  
<http://www.azgs.az.gov>  
[inquiries@azgs.az.gov](mailto:inquiries@azgs.az.gov)

The following file is part of the Edwin Noel Pennebaker Mining Collection

### **ACCESS STATEMENT**

These digitized collections are accessible for purposes of education and research. We have indicated what we know about copyright and rights of privacy, publicity, or trademark. Due to the nature of archival collections, we are not always able to identify this information. We are eager to hear from any rights owners, so that we may obtain accurate information. Upon request, we will remove material from public view while we address a rights issue.

### **CONSTRAINTS STATEMENT**

The Arizona Geological Survey does not claim to control all rights for all materials in its collection. These rights include, but are not limited to: copyright, privacy rights, and cultural protection rights. The User hereby assumes all responsibility for obtaining any rights to use the material in excess of "fair use."

The Survey makes no intellectual property claims to the products created by individual authors in the manuscript collections, except when the author deeded those rights to the Survey or when those authors were employed by the State of Arizona and created intellectual products as a function of their official duties. The Survey does maintain property rights to the physical and digital representations of the works.

### **QUALITY STATEMENT**

The Arizona Geological Survey is not responsible for the accuracy of the records, information, or opinions that may be contained in the files. The Survey collects, catalogs, and archives data on mineral properties regardless of its views of the veracity or accuracy of those data.

FROM J. F. Sharp, Exploration Superintendent  
A. J. O'Connor, General Manager  
TO  
SUBJECT

Safford, Arizona  
CITY  
April 12, 1952  
DATE  
FRANCO REQUEZA CLAIMS, SILVER LEAD GROUP, PIMA COUNTY, ARIZONA

Dear Art:

Your memo dated April 7 was waiting when I returned yesterday. This property has a peculiar history. When originally presented to the American Metals some time last fall, Penny and I arranged to examine it on January 4 of this year, but the owner, Mr. Adams, withdrew it from examination.

Tom wrote me the middle of March and we examined the property March 24 and 25. C. P. Jenney and myself re-examined the property on April 10. This would constitute a further investigation that I mentioned in my original memo addressed to Pennebaker on April 2. We are still no further ahead as to whether the property is worth optioning. It is one of those deals where you just can't say no and it's hard to say yes. So we are reserving our recommendations until further sample results.

In this particular case, I do not think we need worry about anyone optioning over us. Mr. Adams, from all indications, is inclined to deal only with American Metals.

Pennebaker did not specifically leave any procedure in the case we wanted to option a piece of ground, other than it had to clear with American Metals before we optioned it. The procedure that I am working on is to clear it with American Metals, to see if they think the property is worth optioning, then clear it with Mr. Tripp for our part before going ahead.

Sincerely,

Frank

JFS/to

CC: Mr. E. N. Pennebaker

FROM J. F. Sharp, Exploration Superintendent  
TO E. N. Pennebaker, Consulting Geologist  
SUBJECT

CITY Safford, Arizona

DATE April 12, 1952

Dear Penny:

Phil and I have just completed our tour. We spent two days in Deming with Beal and visited the American Mine. This mine is a teaser on the surface, but a very good report on the district by Lasky and the tonnages mined per vertical foot made us back off. This is one of those that has been looked at by most every company in the west. It lies right next to one of the monzonite areas mentioned in the last report. This is a very highly altered monzonite stock with considerable oxidation and occasionally some chalcopryrite boxwork. Probably be a low grade primary deposit. The same people have this located along with the American Mine and a deal on it would be very difficult to make without taking the American also, with a \$10,000 down payment.

We re-examined the Adams, Franco Requeza Group and are in doubt about it. I believe a fair tonnage of metallized material could be developed in the area in the diorite and quartz latite, but I am very doubtful about the grade.

As mentioned in the memorandum on the property, the lead, zinc, and copper is in these big globs in the fractures. After looking at it again, it is doubtful whether there would be enough to carry the whole thing. There is some fine disseminated lead, zinc, and copper in the rock and Phil and I tried to get a sample of this material. We are waiting on this assay.

Phil and I contacted Mulhern and Busch in Phoenix about this Dover property at Morenci. They have a lot of ground and some of it in the quartz porphyry area within four or five hundred feet of the west side of the pit. But if I remember rightly this is in the higher iron section. Phil wanted to clear this with New York before we go on the ground so I am writing Tripp and Moore today. No doubt we will go take a look anyway. Ray has a few more localities to scout from Kingman, so I think I will bring him down here for this and then send him to New Mexico until July 1st.

Kennecott has pulled away from the Mineral Park area.

Next week I plan to examine three mines near Socorro, so will see your friend, Mr. Long.

Best regards to you and Kate,

Frank

JFS/to



THE AMERICAN METAL COMPANY, LIMITED  
61 BROADWAY  
NEW YORK 6, N.Y.

TELEPHONE BOWLING GREEN 9-1800  
CABLE ADDRESS: EFFLUX, NEW YORK

PLEASE ADDRESS REPLY TO

SUBJECT:

TGM:ART

December 31, 1951

Mr. E. N. Pennebaker  
Box 817  
Scottsdale, Arizona

Dear Penny:

I am enclosing herewith copy of letter  
which I received from Adams regarding his Adams-Franco  
property together with copy of my reply.

Obviously Adams is getting big ideas about  
the property.

Best regards,

Sincerely,



Thomas G. Moore

Enc.

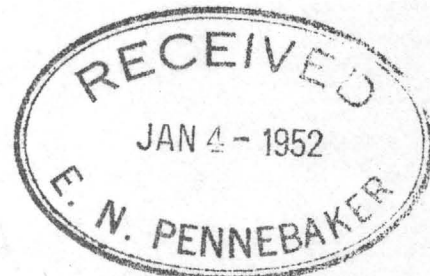



THE AMERICAN METAL COMPANY, LIMITED

61 BROADWAY  
NEW YORK 6, N. Y.

COPY

TGM:ART

December 31, 1951

Mr. Robert M. Adams  
Robert M. Adams Company  
Duluth, Minnesota

Dear Mr. Adams:

Thank you very much for your letter of the 26th. Please telephone me when you come to New York the latter part of January as I would enjoy seeing you and discussing further the Adams-Franco property.

Kindest regards and best wishes for the New Year,

Sincerely yours,

Thomas G. Moore

bcc- Mr. E. N. Pennebaker ✓

C  
O  
P  
Y

ROBERT M. ADAMS COMPANY  
Duluth, Minnesota

December 26, 1951

Mr. Thomas G. Moore  
Geological & Exploration Department  
The American Metal Company, Limited  
61 Broadway  
New York 6, N.Y.

Dear Mr. Moore:

Replying to your letter of December 19. I enclose a copy of letter that Mr. Verity wrote Mr. Pennebaker dated December 21. When Mr. Verity recently advised me that Mr. Pennebaker had been in to see him, had inquired about the Franco and was going to see Messrs. Dodge and Williams relative to going over the data and seeing the property, I advised Mr. Verity that I thought this should be deferred. I did so for the following reasons.

When I last saw you in New York last April I figured that we still had field work ahead of us; but as this work progressed, the picture began to grow in our minds. More area was geologized; more claims located. And now Mr. Williams is, I understand, working on a new map to show the entire area and his geology. Mr. Verity advises in a letter I have just received from him that Mr. Williams hopes to have this done in about a month. I would of course like to have our data complete and up to date before any examination.

I am going to be in the West I hope for a good part of the period February 15 to April 15 approximately and will be in Arizona in the latter part of March and early April.

Another thing that we are thinking about is Defense Minerals and drilling. It seems we have a sizable area of interesting surface indications and doubtless the next thing to do is some drilling. To date all we know of the underground comes from some old workings which showed sulphide at a shallow depth. It happened that we had been having quite a bit of contact with the Bureau of Mines Region 5 Head Office in Minneapolis, and the Bureau and the Defense Minerals had suggested drilling on an area containing manganese which we have on the Cuyuna Range. That gave me a thought in regard to the Franco.

I figure on being East and in New York for a few days toward the latter part of January. Incidentally, if you are to be there at that time, I would be glad to have a visit with you and we can touch on this matter further.

I reciprocate your season's greetings.

Sincerely yours,

(Signed) Robert M. Adams

cc- Mr. Victor H. Verity

C  
O  
P  
Y



THE AMERICAN METAL COMPANY, LIMITED

61 BROADWAY  
NEW YORK 6, N. Y.

COPY

TGM:MHD

July 24, 1951

MINING DEPARTMENT

FRANCO PROPERTY, ARIZONA

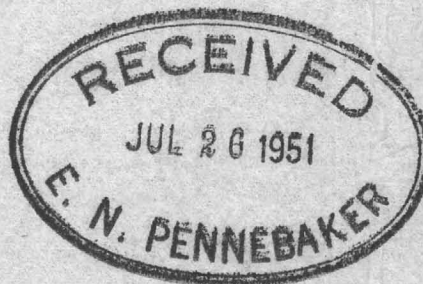

Mr. Robert M. Adams  
Robert M. Adams Company  
Duluth, Minnesota

Dear Mr. Adams:

Thank you very much indeed for your letter to me in Phoenix, Arizona. I see that you are not yet ready to present the property to us or to anyone else but that you would be very glad to have us take a preliminary look at it.

Mr. E. N. Pennebaker, who is associated with our company, makes his headquarters in Phoenix. Should he have the opportunity, he will get in touch with Mr. Verity in Tucson and, through him, with Mr. Dodge, to go over the preliminary information on the Franco property.

Thank you very much for continuing to keep us in touch with your developments on the Franco.

With kindest regards,

Sincerely yours,

cc Mr. E. N. Pennebaker

Thomas G. Moore



THE AMERICAN METAL COMPANY, LIMITED  
61 BROADWAY  
NEW YORK 6, N.Y.

TELEPHONE BOWLING GREEN 9-1800  
CABLE ADDRESS: EFFLUX, NEW YORK

TGM:MHD

PLEASE ADDRESS REPLY TO Geological & Exploration  
Department

December 26, 1951

SUBJECT:

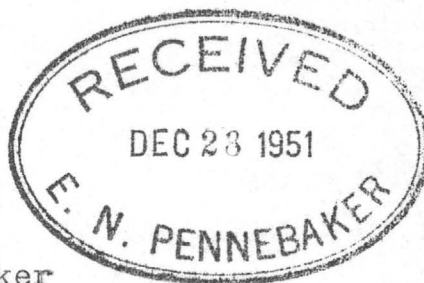

Mr. E. N. Pennebaker  
P. O. Box 817  
Scottsdale, Arizona

Dear Penny:

Thanks very much for your note regarding the Adams-Franco situation. I see that Adams is not yet ready to show the property. This has been the situation for approximately one year. I don't know what he has in mind, but I feel sure that he will give us an opportunity of looking at it when he does get in the mood to show it.

Best regards.

Sincerely yours,

A handwritten signature in cursive script, appearing to read "T. G. Moore".

Thomas G. Moore

December 23, 1951

Mr. Thomas G. Moore  
Manager, Geol. & Exp. Dept.  
The American Metal Co., Ltd.  
61 Broadway  
New York 6, N. Y.

Dear Tom:

I enclose a letter from Mr. Verity regarding the Adams-Franco property near Silver Bell and a copy of my reply.

Evidently our appetites are supposed to become more whetted.

Flying by at a distance, their hill doesn't appear too enticing; however, if I get a chance I'll go around it a few times in a charter plane and see if it improves under a close-up view.

Best wishes for a Happy New Year.

Yours sincerely,

ENP:mc  
encl.

December 23, 1951

Mr. Victor H. Verity  
613 Valley National Building  
Tucson, Arizona

Dear Mr. Verity:

This acknowledges receipt of your letter of December 21, 1951, in which you advise that the Adams-Franco property is not open for inspection. Consequently I have cancelled my plans to come to Tucson on January 3.

At such time as the property can be looked over, I shall be glad to hear from you again. After February 23, 1952, I shall be away on an extended trip overseas and communication should then be made directly to:

Mr. Thomas G. Moore, Manager  
Geological & Exploration Dept.  
The American Metal Co., Ltd.  
61 Broadway  
New York 6, N. Y.

Yours very truly,

ENP:mc

cc - Mr. Thomas G. Moore  
Mr. J. Frank Sharp



THE AMERICAN METAL COMPANY, LIMITED  
61 BROADWAY  
NEW YORK 6, N.Y.

TELEPHONE BOWLING GREEN 9-1800  
CABLE ADDRESS: EFFLUX, NEW YORK

TGM:MHD

December 19, 1951

PLEASE ADDRESS REPLY TO Geological & Exploration  
Department

SUBJECT:

Mr. E. N. Pennebaker  
P. O. Box 817  
Scottsdale, Arizona

Dear Penny:

Thanks a lot for your note advising that you have arranged to examine the Adams-Franco ground, northeast of the Silver Bell immediately after the first of the year. I am advising Mr. Adams of this arrangement.

Very best wishes for a Merry Christmas and a Happy New Year.

Sincerely yours,



Thomas G. Moore

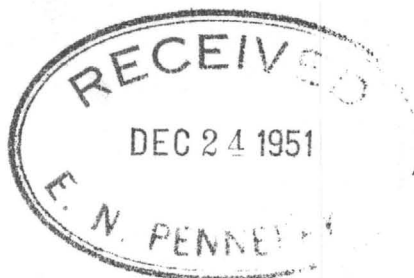

December 13, 1951

Mr. Thomas G. Moore  
Manager, G. & E. Dept.  
The American Metal Co., Ltd.  
61 Broadway  
New York 6, N. Y.

Dear Tom:

I finally made it over to Tucson and had a talk with Victor Verity and Seton Williams (Ted Dodge's associate) about the Franco property presented to your office by Robert M. Adams of Duluth some months ago.

The property is about 4 miles northeast of A. S. & R.'s Silver Bell. Additional claims have been staked out for Mr. Adams, and the Adams-Franco ground, as it is now known, comprises about 30 unpatented mining claims. It sounds like it is well worth having a look at, and I have arranged for Frank Sharp and me to visit the property with Seton Williams on January 4 and 5, 1952.

I thought that you might want to advise Mr. Adams that we are about to make a preliminary inspection.

With best Holiday wishes,

Yours sincerely,

ENP:mc

FROM J. Frank Sharp, Exploration Superintendent  
TO E. N. Pennebaker, Consulting Geologist  
SUBJECT FRANCO REQUEZA CLAIMS, SILVER LEAD GROUP, PIMA COUNTY, ARIZONA.

CITY Safford, Arizona  
DATE April 2, 1952

#### Conclusions:

On the Buena Vista and Mountain Side claims of the Franco Group there is evidence that a considerable ore body of low grade lead, zinc and copper ore could be developed. The development work on the Buena Vista was terminated in the ore deposit so the limits are unknown. The oxidized surface exposures over this underground development indicate an area of about 800 feet by 1000 feet of possible ore. This would be a zoned ore body as numerous dikes of fresh rock cut through this oxidized area. The tenure of the ore would probably not exceed the assay of the ore fines sampled, although there could be some higher grade spots. This area warrants further investigation.

On the area covered by the Requeza claims, on the north and east of Ragged Mountain, there is very little possibility of developing an ore body. The iron stained outcrops of granite, quartz and dikes exhibit no evidence of copper, lead, or zinc metallization.

#### Location:

The Franco Requeza Claims are located in the Silver Bell Mining District, Pima County Arizona in sections 22, 23, 24, 25 and 26 Township 11 South, Range 8 East, G. & S.R.B.4M, about 50 miles by road northwest of Tucson.

#### Property:

The Silver Lead Group is comprised of thirty four unpatented lode mining claims. Nine of the original Franco claims and twenty five Requeza claims. The Franco claims cover the west end of Ragged Mountain and are the Silver Lead, Addition, Josephine, Tinaja, Buena Vista, Mountain Side, Fortuna, Suerte and Esperanza claims. These claims were located in 1935. The Requeza group of twenty five claims consisting of Requeza Nos. 1 through 25 and are located on the north and the east of Ragged Mountain. These claims were located in 1951 and in 1952. Accompanying this report is a photostat of a partial claim map of the groups.

#### Relief:

Ragged Mountain is a rhyolite capped mountain about a mile long that sits by itself in low lying hills. It slopes rather steeply on all sides from the valley to the cliff like rhyolite cap.

The slopes are partially covered with detritus and are cut by numerous gullies exposing the underlying rock.

#### Development:

The only development on the property other than location holes is confined to two adits on the Buena Vista claim. The upper adit is about sixty feet



FROM J. Frank Sharp, Exploration Superintendent CITY Safford, Arizona  
TO E. N. Pennebaker, Consulting Geologist DATE April 2, 1952  
SUBJECT FRANCO REQUEZA CLAIMS, SILVER LEAD GROUP, PIMA COUNTY, ARIZONA.

Page 2

long and the lower adit has about five hundred feet of adit, crosscuts and raises.

Geology:

The basement rock in the area is a coarse grained granite which has been intruded by medium to coarse grained diorite, quartz latite porphyry, probably in that sequence. These in turn have been intruded by dikes of latite and trachyte and irregular rock masses of basic composition. The area is partially overlain with rhyolite porphyry which forms the cliffs and top of Ragged Mountain.

On the Franco claims the exposed outcrops are quartz latite and diorite which have been intruded with dikes of latite and trachyte. The lower adit on the Buena Vista claim was started in diorite (Dodge calls this trachyte) and driven into the quartz latite porphyry. About the last sixty feet of the quartz latite porphyry is mineralized with galena, sphalerite and chalcopryite. This mineralization is unusual as it occurs in globs or coarse clusters in the fractures as well as small veinlets in the rock. The quartz latite porphyry that is not mineralized with galena, sphalerite and chalcopryite has a fine dissemination of pyrite through it. The upper adit which is about sixty to seventy feet higher was started in the diorite and driven through the contact to the quartz latite porphyry which has the same mineralization as the lower adit. The sulphides are quite near the surface as the backs on the upper adit can not be more than thirty or forty feet. The surface over the quartz latite porphyry covers an exposed area of about eight hundred by a thousand feet and is oxidized and altered. Numerous dikes of fresh latite and trachyte cut through this oxidized and altered zone. The adits were not sampled as it would be very difficult to get a representative sample of the walls due to the erratic occurrence of the high grade globs. The most prominent minerals are galena and sphalerite with some chalcopryite.

Several samples were taken from the dump of the lower adit to try and determine the value of the various types of material cut in the adit. The quartz latite with disseminated pyrite averages trace gold, 0.30 oz. silver, 0.06% copper, 0.31% lead and 0.26% zinc. A sample of the fines taken from where the higher grade ore had been chuted down assayed 0.01 oz. gold, 2.30 oz. silver, 1.35% Cu., 4.10% lead and 3.55% zinc.

The area covered by the Requeza claims on the north and east sides of the mountain appears quite different from the Franco area. Here the granite has been intruded by dikes of latite, a basic rock probably diorite and contains large quartz veins and stringers, veinlets of calcite, hematite, and siderite (?). Most of the outcrops of granite, dikes and quartz veins have been stained with limonite to deep reds and browns. Some of this limonite was transported into the area and some of it may be attributed to alteration of ferromagnesium minerals in the basic dikes. Very little evidence of metallization was found in this granite area. An occasional

FROM J. Frank Sharp, Exploration Superintendent

CITY Safford, Arizona

TO E. N. Pennebaker, Consulting Geologist

DATE April 2, 1952

SUBJECT FRANCO REQUEZA CLAIMS, SILVER LEAD GROUP, PIMA COUNTY, ARIZONA. 5

Page 3

piece of float with a little copper staining can be found on the flats below the mountain. There is some metallization present as the location hole samples taken by Williams assayed a few tenths of an ounce silver and a few tenths of a % in lead, about the same as the pyritized quartz latite porphyry on the Franco Group.

## Summary:

The Franco Group in the quartz latite porphyry exhibits a possibility of a low grade lead, zinc, copper ore deposit. This deposit would be zoned due to the dikes of fresh latite and trachyte cutting through it.

The area covered by the Requeza Claims is quite unimpressive due to the lack of evidence of surface metallization.

JFS/ jmh

cc: Mr. Chester D. Tripp  
Mr. Thomas G. Moore  
Mr. A. J. O'Connor





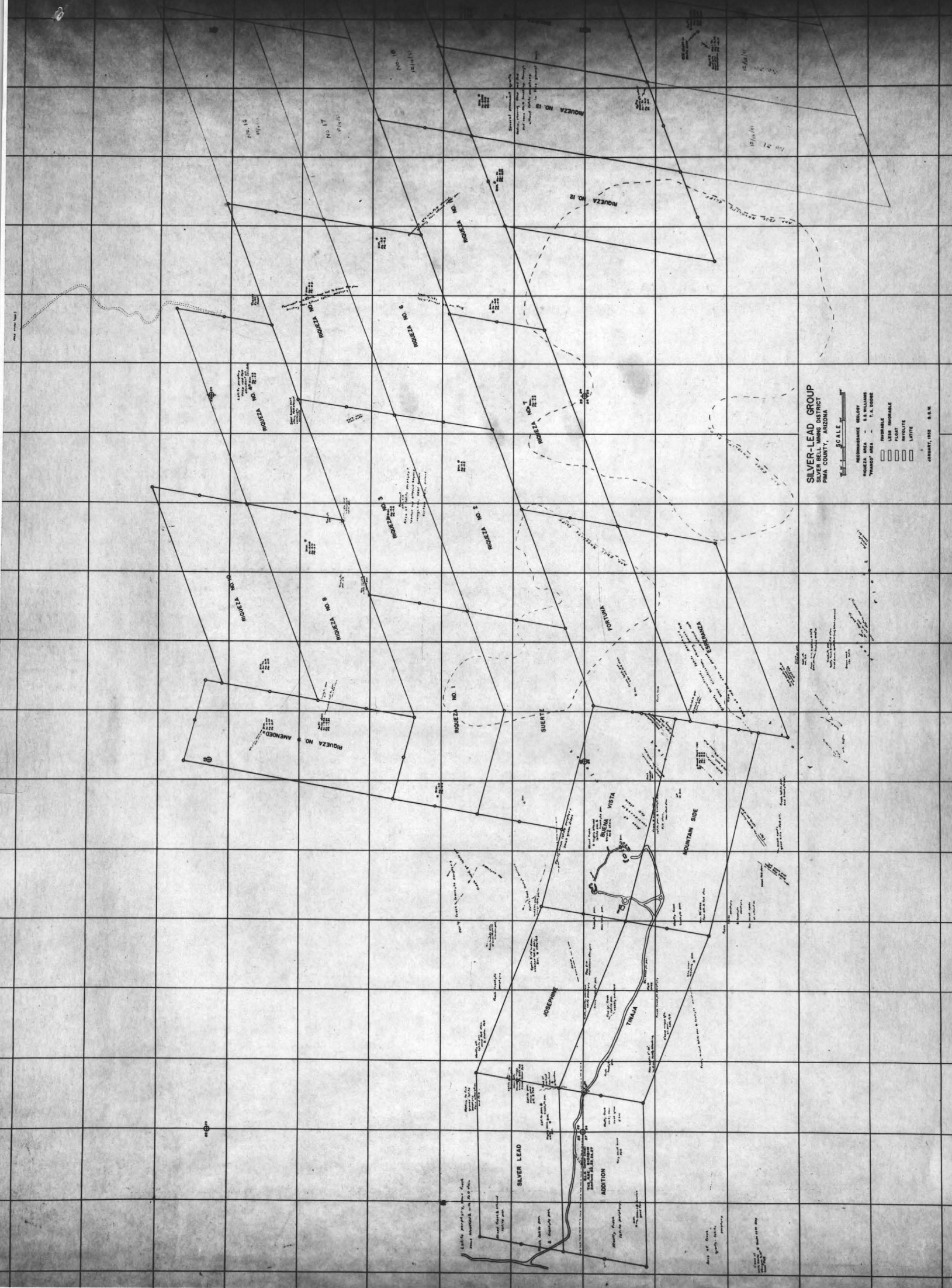



CPJ/ms  
April 28, 1952

Heath Steele

C. P. Jenney

Report on the Franco Requeza Claims, Pima County, Arizona

On April 10, 1952 Mr. Frank Sharp and I examined this property. The attached memo by Mr. Sharp and accompanying map gives the geologic and other details in connection with it.

The main mineral showing of interest occurs within the Buena Vista and Mountainside claims on the west side of Ragged Mountain, about 50 miles by road northwest of Tucson, Arizona. The showings are approximately 5 miles as the crow flies north of the Silver Bell copper property now being opened up by A.S. & R.

Mineralization, which consists of splashes and stringers of fine to coarse galena and sphalerite with some chalcopyrite, occurs within a coarse dioritic-like rock. This original intrusive may have two or three phases of slightly varying composition and is cut in a number of places by finer grained dikes and irregular masses of similar material. Mr. Sharp's original estimate of the surface oxidized which gave it an extent of 800 x 1000 ft. is conservative. Detailed mapping might indicate that this oxidized area extends for 1500 x 1000 ft. Within this area the mineralization is exposed underground in two small adits. The longest of these might have as much as 400 ft. of linear workings. Of this length, about 100 ft. is in the zone of mineralization. This area shows a high degree of hydro-thermal alteration with clay minerals and sericite and with irregular and erratically distributed splashes, veins, stringers and grains of sphalerite and galena. Due to the irregular nature of this mineralization no channel sampling would give a true picture of the probable grade. In my opinion it would be necessary to mine about 200 tons of ore to determine this. However, my guess, after carefully examining the walls and backs of these underground workings, is that the combined lead, zinc and copper grade would not exceed 1%.

This general and admittedly guess-like estimate is borne out by the assay returns of a grab sample taken by me at random from the ore pile on the dump at the mouth of the lower adit. This sample contained what appeared to be a good deal of finely disseminated galena and sphalerite but carried no coarse splashes of either mineral. It assayed as follows:

Memorandum: Heath Steele  
 Re: Report on the Franco Requeza Claims, Pima County, Arizona

Gold	trace
Silver	0.50 oz.
Copper	0.04%
Lead	0.15%
Zinc	0.35%

During the first examination Mr. Sharp took the following samples of which the first three check the results above and the last can be disregarded as a higher than average grade concentrate.

Location	Oz. Gold	Oz. Silver	%Pb	%Cu	%Zn
North dump, mineralized diorite	Trace	0.2	0.11	0.03	0.17
South dump, " "	"	0.3	0.15	0.06	0.28
Edge south dump possible ore section "	"	0.4	0.68	0.09	0.32
Fines from bottom ore chute	0.01	2.3	4.10	1.35	3.55

All of the mineralization seen was primary with no sign of secondary enrichment.

Two or three vertical churn drill holes should be put down by Mr. Adams within the zone of alteration to test the grade of the mineralized area. The same purpose could be accomplished by continuing the adit about 500 feet through the main zone of alteration, or by fanning a number of diamond drill holes from the present face. The chances that this exploration might indicate a tonnage and grade with mine-making possibilities are not sufficiently attractive to warrant further interest by either Amco or Coppermines.

In addition to the main mineral showing described above, Mr. Adams and his geologist Mr. Williams have staked a number of claims east of Ragged Mountain and covering numerous brown to red brown gossan areas in granite. These zones show no signs of original mineralization other than pyrite and are similar in that respect to hundreds of others remaining unstaked throughout the state of Arizona. I would not recommend work on any of these.

cc: Mr. Chester D. Tripp  
 E. N. Pennebaker  
 Frank Sharp  
 A. J. O'Connor

C. P. Jenney



THE AMERICAN METAL COMPANY, LIMITED

61 BROADWAY  
NEW YORK 6, N. Y.

TELEPHONE BOWLING GREEN 9-1800  
CABLE ADDRESS: EFFLUX NEW YORK

PLEASE ADDRESS REPLY TO

SUBJECT:

CPJ/ms  
June 3, 1952

Mr. E. N. Pennebaker  
c/o O. C. C.  
Nababeep, Cape Province  
South Africa

Dear Penny:

Many thanks for your letter of May 21 giving me your reaction regarding the Franco Riqueza claims near Tucson, Arizona. I note that you think it might be worthwhile to discuss a possible deal with Mr. Adams on this property.

I think it best to leave this until you return to Arizona when you may wish to make an examination of the property yourself. As far as I am concerned, I couldn't get interested even if Adams sold the property in Macy's bargain basement. However, I know Frank Sharp does not feel as definitely as I do about this and I am sure he would enjoy taking you out for a look around.

We have been following the recent results from your part of Africa with a good deal of interest and only wish you could transfer some of those exploration chances out to Arizona. You, no doubt, have had the same feeling.

Please give my best regards to Kate and I hope you are both enjoying your African safari.

With best regards.

Sincerely,



C. P. Jenney

*Rec'd June 11-1952*



THE AMERICAN METAL COMPANY, LIMITED

61 BROADWAY  
NEW YORK 6, N. Y.

TELEPHONE BOWLING GREEN 9-1800  
CABLE ADDRESS: EFFLUX NEW YORK

PLEASE ADDRESS REPLY TO

SUBJECT:

CPJ/ms  
April 25, 1952

Mr. E. N. Pennebaker  
O. C. C.  
Nababeep, Africa

Dear Penny:

Yes, I agree, your home coming should be very pleasant. John Hope was in the office yesterday but said nothing at all about repaying you the bottle of Scotch which P.D. is reported to owe you.

Frank, Larry and I visited the area mentioned in the third and fifth paragraphs of his March Report in connection with his examination of the American Mine. I was not surprised that you were intrigued by the description of the alteration in these areas as it is actually very interesting when seen on the ground. However, the altered areas are covered by claims and are held by the owners of the American Mine and other adjacent properties. We were not interested in the American Mine nor in optioning any other claim groups.

Frank and I examined the lead-zinc-copper showing on the Adams property and had the same general reaction you had that it might be worth a couple of churn drill holes. The altered area is rather impressive in size and on the surface, and also in intensity underground. However, the mineralization is so erratic and scattered that a visual estimate plus a few miscellaneous grab samples indicated that the best one could expect would be 1% combined lead-zinc and copper. Consequently we turned it down. Incidentally Adams is staking a large area east of the mountain covered by red oxidized zones in granite which he is going to throw into the same deal. If you are interested in this type of ground, Frank and I will contract to stake 1,000 similar claims for a very small consideration.

throw

I concur with your recommendations in the last paragraph of your letter and will do what I can about the matter.

With best regards to Kate and yourself.  
I trust you are both having a delightful time.

Sincerely,

A handwritten signature in cursive script, appearing to read "Phil", written in dark ink.

C. P. Jenney

cc: Frank Sharp



CONSOLIDATED COPPERMINES CORPORATION

~~KIMBERLY, NEVADA~~

Safford, Arizona

April 2, 1952

A. J. O'CONNOR  
GENERAL MANAGER

JOHN EABY  
CHIEF CLERK

Mr. E. N. Pennebaker  
% O'okiepe Copper Company  
Nababeep  
Cape Province  
Union, South Africa

Dear Penne:

Please find enclosed a copy of the report on the Franco Requeza Claims owned by Mr. Adams and located northwest of Tucson.

Mr. Adams apparently contacted Tom Moore personally some time in February and opened up this property for examination.

Ray Ludden and I examined the property on our way back from Yuma. We both were of the same opinion that there might be a chance to develop a small ore body of lead and zinc on the original Franco Group. The Requeza area located by Williams for Mr. Adams we did not think showed much possibility.

Tom Moore in his letter to Mr. Adams on March 17th. indicated that he would have one of their men examine the property also.

Best regards,

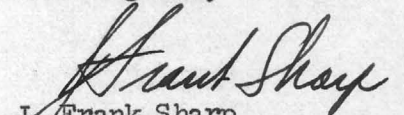

J. Frank Sharp  
Exploration Superintendent

JFS/ jmh  
Encl:



XXXXXXXXXXXXXXXXXXXX  
Safford, Ariz.

April 14, 1952

Mr. T. G. Moore  
American Metals Co. Ltd.  
61 Broadway  
New York 6, N. Y.

Dear Tom:

Phil has probably phoned you about the Franco-Requeza claims owned by Mr. Adams by now. On our recent visit to the property we picked a sample of the finely disseminated sulphides in the ore section for assay. The assay results of that are as follows: Gold trace, silver 0.50 oz., copper 0.04 %, lead 0.15% and zinc 0.35%.

I have some other assays of the samples taken on the first examination that were reported averaged in the memorandum to Mr. Pennebaker. Phil wanted a copy of these assays so I will include them in this letter:

Location	Oz. Gold	Oz. Silver	% Lead	% Cu.	% Zinc
North dump, mineralized diorite	Trace	0.2	0.11	0.03	0.17
South dump, mineralized diorite	Trace	0.3	0.15	0.06	0.28
Edge south dump possible ore section	Trace	0.4	0.68	0.09	0.32
Fines from bottom ore chute	0.01	2.3	4.10	1.35	3.55

I believe that a considerable tonnage of metallized material could be developed in this area, but from the assay results on the samples taken and the scattered high grade globs the grade of the material is going to be the deciding factor. I am not thoroughly convinced in my own mind that we should turn this down with out doing some sampling on it. I recommend that we sample the ore section by drilling some short holes into it or by channel samples to try and determine the grade of the ore exposed. I do not know what Phil has recommended or will recommend when he receives the above assay results but will await your decision.

Sincerely yours,

  
J. Frank Sharp

cc: E. N. Pennebaker  
A. J. O'Connor