



CONTACT INFORMATION

Mining Records Curator
Arizona Geological Survey
1520 West Adams St.
Phoenix, AZ 85007
602-771-1601
<http://www.azgs.az.gov>
inquiries@azgs.az.gov

The following file is part of the

Arizona Department of Mines and Mineral Resources Mining Collection

ACCESS STATEMENT

These digitized collections are accessible for purposes of education and research. We have indicated what we know about copyright and rights of privacy, publicity, or trademark. Due to the nature of archival collections, we are not always able to identify this information. We are eager to hear from any rights owners, so that we may obtain accurate information. Upon request, we will remove material from public view while we address a rights issue.

CONSTRAINTS STATEMENT

The Arizona Geological Survey does not claim to control all rights for all materials in its collection. These rights include, but are not limited to: copyright, privacy rights, and cultural protection rights. The User hereby assumes all responsibility for obtaining any rights to use the material in excess of "fair use."

The Survey makes no intellectual property claims to the products created by individual authors in the manuscript collections, except when the author deeded those rights to the Survey or when those authors were employed by the State of Arizona and created intellectual products as a function of their official duties. The Survey does maintain property rights to the physical and digital representations of the works.

QUALITY STATEMENT

The Arizona Geological Survey is not responsible for the accuracy of the records, information, or opinions that may be contained in the files. The Survey collects, catalogs, and archives data on mineral properties regardless of its views of the veracity or accuracy of those data.

PRINTED: 09/06/2002

ARIZONA DEPARTMENT OF MINES AND MINERAL RESOURCES AZMILS DATA

PRIMARY NAME: WELDON HILL

ALTERNATE NAMES:
COPPER PENNY

MARICOPA COUNTY MILS NUMBER: 116

LOCATION: TOWNSHIP 4 N RANGE 10 W SECTION 7 QUARTER N2
LATITUDE: N 33DEG 42MIN 35SEC LONGITUDE: W 113DEG 19MIN 31SEC
TOPO MAP NAME: LONE MOUNTAIN - 15 MIN

CURRENT STATUS: UNKNOWN

COMMODITY:
COPPER OXIDE
ALUMINUM ALUMINA
CALCIUM
CHROMIUM
IRON
SODIUM
STRONTIUM
TITANIUM

BIBLIOGRAPHY:
USGS LONE MTN QUAD
ADM MR WELDON HILL FILE

LONE MOUNTAIN QUADRANGLE
ARIZONA
15 MINUTE SERIES (TOPOGRAPHIC)

15'
3351' (AGUILA)

Gunsight?

11 ✓ Navajo

R. 11 W. R. 10 W. 283 285 286 640 000 FEET (WEST) 288 289 AGUILA 16 MI. 291 113° 15' 33° 45'

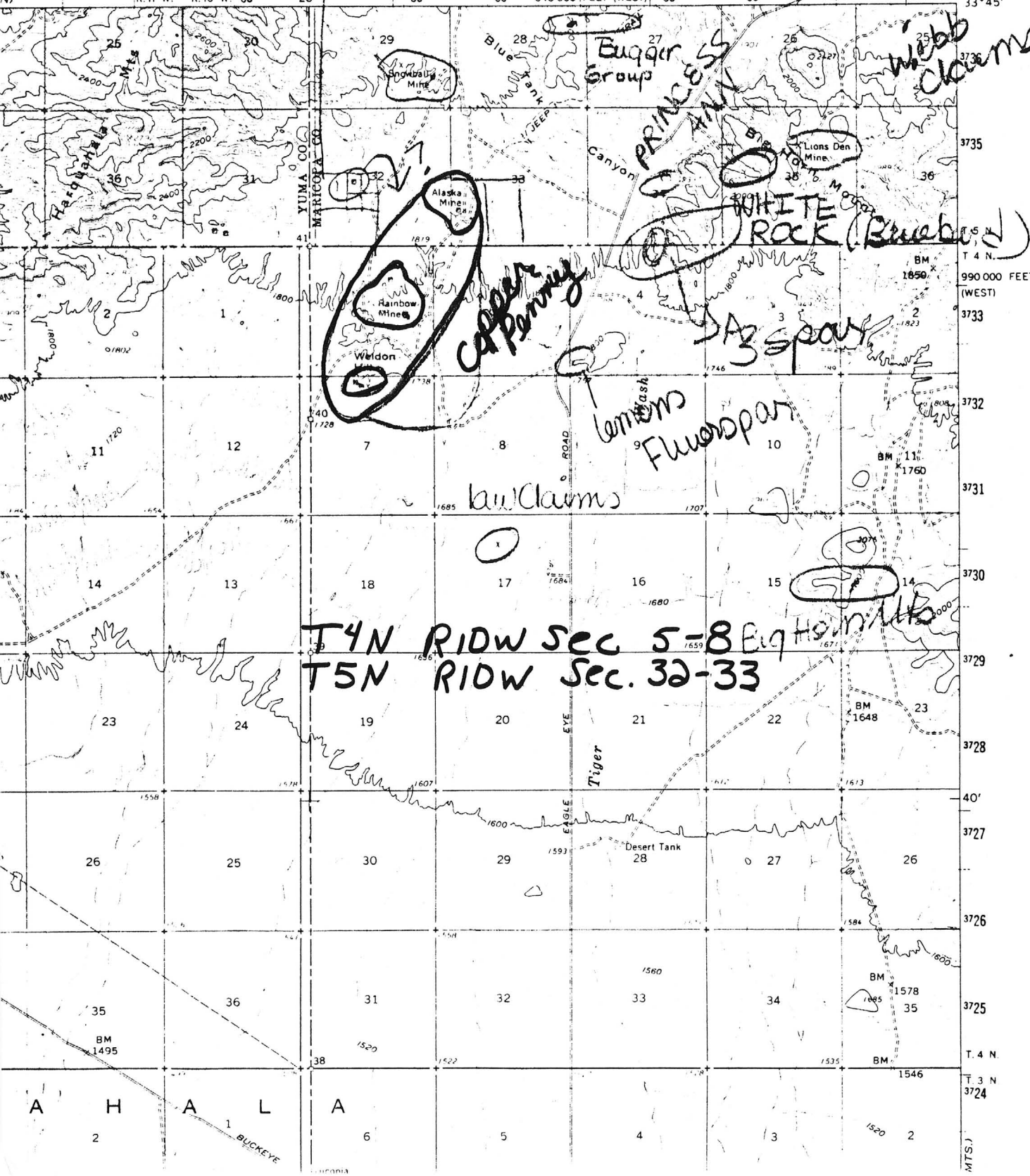

T4N RIDW Sec 5-8
T5N RIDW Sec. 32-33

A H A L A
2 1 BUCKEYE 6 5 4 3 2

T. 4 N
T. 3 N
3724
MTS.)

Copper Penny, Silver Thread, Two Sisters, and Old Gold Claims
sec. 5-8 T. 4N., R. 10W., sec. 32, 33 T. 5N., R. 10W.
Maricopa County

reference: Arizona Dept. of Mineral Resources
Copper Penny (file)

present owner: E. H. Chisholm
Mining Company
P.O. Box 1351
Glendale, AZ 85311

minerals: copper, gold, silver, fluorspar, dolomite,
limestone, concrete aggregate

former name of mine: Alaska, Rainbow, and Weldon Hill

history of the area:

The old Alaska Mine produced several hundred thousand dollars in gold in the 1920's and 1930's as the Rainbow Claims. The property was mined by the Alaskan Mining Corp. until the shut down on gold in 1933. There was a 50 ton stamp mill working at the Old Alaska Mine for quite awhile.

geology of the area:

area has igneous and sedimentary. Some of the rocks contain fluorspar, copper, and high contents of silica. A fissure vein runs from NE to SW one mile long and approx. 100' wide at the southwest end. At the northeast end the vein is approx. 50' wide. At the center of this fissure the body is exposed by deep wash 650' wide and one-half a mile long.

ore body: estimates over 100 million tons of copper deposit

COPPER PENNY

MARICOPA COUNTY

KAP WR 6/27/86: Rick Lawrence of Santa Fe Mining Company's exploration office in Prescott reported that they drilled the Alaska Mine (Copper Penny Mine - file) in SW, Sec 33, T5N R10W, Maricopa County. He said the project was "a fast get in-get out effort" and they no longer have any position on the property.

Mr. Butterfield of Mesa called regarding Gene Chisholm's Cu prospect SW of Aguila. This was the 3rd time he has asked advice as to an investment in the property. According to Butterfield, Chisholm has sold 1% interests or shares for upwards of \$100,000. Butterfield says no more shares are available as 49% have been sold; he has the opportunity of purchasing a previous buyers share. GW WR 9/10/74

Went out to Gene Chisholm's Copper Penny claims about 21 miles SW of Aguila where two young fellows were sitting at a BX wire line core rig waiting on repairs. They said they had been drilling there since February and that this was their 4th hole. Two were 100 feet deep and one was 600 feet. The present hole is 72 feet and is projected for 1200 feet. Some core (the last 10 feet) was seen; no appreciable mineralization was observed in the schist. These holes are being drilled along a westerly line from the old Alaska mine. The last hole is about $\frac{1}{2}$ mile west. GW WR 9/12/74

Bill Platt, an attorney in Coolidge, called regarding a client who was considering the purchase of a 1% interest in Gene Chisholm's property. He was given what little information we have in our file. He commented that he felt the sale of an undivided property interest constituted the sale of a security which should be regulated by the SEC and that an owner of such an undivided interest could be held liable for debts incurred by the property. KAP WR 9/26/74

Mr. Sundeen, Phoenix attorney, called regarding the Chisholm Cu prospect SW of Aguila. He represents Mr. Chisholm's sister who as a 20% interest in the claims. She claims he has sold a 5% interest to various individuals for several thousand dollars but she hasn't received a cent. Although I had no knowledge of the amount received for interests sold, but whatever it was it was probably in excess of the mineral potential of the property. GW WR 2/11/75

ABM Bull. 137, p. 133
" " 140, p. 104

Tony Lane, Tucson consulting geologist, called regarding Copper Penny claims of Chisholm 20 miles SW of Aguila. He said his client had been approached to buy $\frac{1}{2}$ of 1% interest for \$5000.00. He was told of the Cu and fluorspar occurrences. GW WR 5/4/76

Accompanied Wm. Laughlin on a cursory examination of 48 unpatented claims of Gene Chisholm, 22 miles SW of Aguila. His two structures containing oxide copper and fluorite mineralization in schist & quartzite trend toward the old Alaska mine & ore about $\frac{1}{2}$ mile SW of it. Neither of these veins are of commercial width where noted in a 150 foot long surface cut and in a 125 foot inclined shaft (-30°). Mr. Chisholm said he had drilled a core hole 286 feet which had 0.80% Cu from 214 feet to the total depth. This hole, which was dry is about $\frac{1}{2}$ the distance from the Alaska, inclined to the 150 foot long open-cut. A dozer arrived on the property as Mr. Laughlin and I were leaving. GW WR 10/13/71

Chas. Balch brought in a good piece of oxide Cu rock from the new dozing on the Chisholm claims 22 miles SW of Aguila. GW WR 10/22/71

Charles Balch phoned to say he had the trail to Chisholm's fluorspar claims opened and that they are ready for examination; which will be made November 17. This property is about 22 miles southwest of Aguila. GW WR 11/2/71

Went to see Gene Chisholm's fluorspar deposit 23 miles SW of Aguila. Here the vein structure trends N 65-70 W dips $60-70^{\circ}$ N and is discontinuously traceable for at least 2500 feet. However, the most promising CaF_2 mineralization is near the eastern most exposure which is in the W bank of a wash. The solid CaF_2 here is slightly over 2 feet in thickness and occurs along a diabase dike of unknown width. The hanging wall is schist which strikes N 40 dips similar to the spar. Both the Schist and diabase are well altered (soft). This exposure is perhaps $\frac{1}{2}$ mile N 65 W of the Old Alaska mine. To the NW stringers of spar crop out intermittently in altered diabase or schist to the extremity of the claims. The boulders seen previously in a photograph proved to be diabase with a $\frac{1}{2}$ " thick streak of CaF_2 on one side; they are within 400 feet of the west claim boundary. GW WR 11/17/71

Charles Balch phoned wanting help in contacting companies interested in the Chisholm copper claims 20 miles SW of Aguila. He was questioned regarding their CaF_2 deposits in the same area, but said they had done no additional work on it. Therefore, it was suggested they concentrate their efforts on it rather than the copper prospects. GW WR 7/5/72

A Mr. Butterfield, Phoenix, called regarding Gene Chisholm's copper prospect about 20 miles SW of Aguila. He said Chisholm has been selling 1% shares in the claims for \$100,000 and that he had been approached by a man who had bought some shares now trying to sell them. He was told what I had noted when last on the property which was more than a year ago. Mr. Butterfield said either 4 or 6 core holes have been drilled since my visit. GW WR 8/22/74

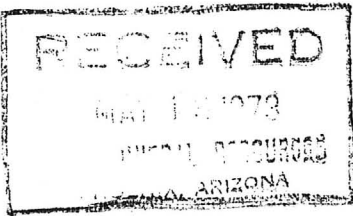

DEPARTMENT OF MINERAL RESOURCES

State of Arizona

MINE OWNER'S REPORT

Date May 14, 1973

1. Mine: Copper Penny, Silver Thread, Two Sisters & Old Gold Claims
2. Location: Sec. ~~32-33~~⁵⁻⁶⁻⁷⁻⁸ Twp ~~5N~~^{4N} Range 10W Nearest Town Aguilá Distance 18 $\frac{1}{2}$ miles
 Direction ~~mine~~^{northeast from} Nearest R.R. Aguilá Distance 18 $\frac{1}{2}$ miles
 Road Conditions Well maintained county road
3. Mining District and County: Ellsworth - Maricopa
4. Former Name of Mine: Alaska, Rainbow & Waldon Hill
5. Owner: Gene E. Chisholm and co-owners
 Address: P.O. Box 1351 Glendale, Arizona 85311
6. Operator: Gene E. Chisholm
 Address: Same
7. Principal Minerals: Copper, Gold, Silver, Fluorspar, Dolomite, Limestone, Concrete Aggregate
8. Number of Claims: Lode 98 Patented Unpatented
 Placer Patented Unpatented
9. Type of Surrounding Terrain: Igneous & sedimentary rocks, disseminated through sediments
10. Geology and Mineralization: Fluorspar, copper, high contents of silica
 Fissure vein from northeast to southwest one mile long approximately 100' wide at the southwest end 50' wide at the northeast end, at the center of this fissure body exposed by deep wash 650' wide and one half mile long. Recent tests of samples by ATL- Copper 0.24 of 1% from surface cuts up to 11.9%.
11. Dimension and Value of Ore Body: Engineer's estimate of copper deposit of one hundred million ton and that did not include the outlying area.

Please give as complete information as possible and attach copies of engineer's reports, shipment returns, maps, etc. if you wish to have them available in this Department's files for inspection by prospective lessors or buyers.

12. Ore "Blocked Out" or "light": Fissure ore body one-half mile long 650' wide
 One drill hole indicates depth of ore to 600' This one deposit consists of
 60 million ton

Ore Probable: My personal opinion same as Engineer's-- possible-- over 100
 million ton

13. Mine Workings—Amount and Condition:

No.	Feet	Condition
Shafts 4	120, 110, 30, 40	old
Raises		
Tunnels 2	120, 110, 40	Old
Crosscuts 5		new
Stopes 2		last ten years

14. Water Supply: Windmill supplying water for cattle rancher now and has been
 for last 45 years

15. Brief History: The old Alaska mine produced several hundred thousand dollars in
 gold in the 1920 and 1930 as the Rainbow Claims, mined by the Alaskan Mining
 Corp. until the shut down on gold in 1933. A fifty ton stamp mill worked at the
 old Alaska Mine for some time.

16. Remarks: This property should be drilled and blocked. The one drill hole that
 I put down is just a start even with the large amount of copper ore exposed
 by my exploration work each year, it still should be drilled. That is why I
 am offering to sell some interest in this property.

17. If Property for Sale, List Approximate Price and Terms: I have 23,000,000 ton of rock
 that has been tested for specification for use on C.A.P. Water Project. that
 will be excluded from property. If responsible company wants to drill and
 block ore body of copper I will take \$1.00 per ton of all copper drilled and
 blocked.

18. Signature

Leue H. Chisholm PH-939-8315

Reed Engineering

1140 N. Lemon Street, Orange, California 92667

SPECTROGRAPHIC ANALYSIS

For:

*Elements not detectable below .005%

+

Date: JUL 3 - 1973

+

Sample No. #22

Mr. E.H. Chisholm
PO Box 1351
Glendale, AZ 85311

Film No. 02

+

Tests Recommended:

Approximate Values

QUALITATIVE

Approximate Values

	Lbs. per ton	Value per ton	Percent
Aluminum	90	.90	4.5
Antimony			
Barium			
Beryllium			
Bismuth			
Cadmium			
Calcium	52	.52	2.6
Cesium			
Chromium	4	.52	.2
Cobalt			
Columbium			
Copper			
Fluorine			
Gallium			
Gold*			
Hafnium			
Indium			
Iridium*			
Iron	34	.42	1.7
Lead			
Lithium	.04	---	.002
Magnesium	40	.20	2.0
Manganese	.02	---	.001
Mercury			
Molybdenum	---	---	trace
Nickel			
Osmium*			
Palladium*			
Platinum*			
Potassium	16	.32	.8
Rhodium*			
Rubidium*			
Ruthenium*			
Silver			
Sodium	28	.28	1.4

	Lbs. per ton	Value per ton	Percent
Strontium	4	.12	.2
Tantalum			
Thallium			
Thorium			
Tin			
Titanium	.8	---	.04
Tungsten			
Vanadium			
Zinc			
Zirconium			

RARE EARTHS : none

	Lbs. per ton	Value per ton	Percent
Cerium			
Dysprosium			
Erbium			
Europium			
Gadolinium			
Holmium			
Lanthanum			
Lutetium			
Neodymium			
Praseodymium			
Samarium			
Terbium			
Thulium			
Ytterbium			
Yttrium			

Silicon, Water, Gases----- 86.5 Percent

RADIOMETRIC ASSAY

(e) Uranium Oxide 0.0 Percent

Reed Engineering

1140 N. Lemon Street, Orange, California 92667

SPECTROGRAPHIC ANALYSIS

For:

*Elements not detectable below .005%

+

Date: JUL 3 - 1973

+

Sample No. #5

R. F. G. Chisholm
10 Box 1501
Monticello, AL 35311

Film No. 04

+

Tests Recommended:

+

Approximate Values

QUALITATIVE

Approximate Values

	Lbs. per ton	Value per ton	Percent
Aluminum	48	.48	2.4
Antimony			
Barium	.4	---	.02
Beryllium			
Bismuth			
Cadmium			
Calcium	66	.66	3.3
Cesium			
Chromium	30	\$3.90	1.5
Cobalt			
Columbium			
Copper	---	---	trace
Fluorine			
Gallium			
Gold*			
Hafnium			
Indium			
Iridium*			
Iron	16	.18	.8
Lead	---	---	trace
Lithium	---	---	trace
Magnesium	40	.20	2.0
Manganese	.2	---	.01
Mercury			
Molybdenum			
Nickel			
Osmium*			
Palladium*			
Platinum*			
Potassium	90	\$1.80	4.5
Rhodium*			
Rubidium*			
Ruthenium*			
Silver			
Sodium	32	.32	1.6

	Lbs. per ton	Value per ton	Percent
Strontium	.1	---	.005
Tantalum			
Thallium			
Thorium			
Tin			
Titanium	---	---	trace
Tungsten			
Vanadium			
Zinc			
Zirconium			

RARE EARTHS : none

	Lbs. per ton	Value per ton	Percent
Cerium			
Dysprosium			
Erbium			
Europium			
Gadolinium			
Holmium			
Lanthanum			
Lutetium			
Neodymium			
Praseodymium			
Samarium			
Terbium			
Thulium			
Ytterbium			
Yttrium			

Silicon, Water, Gases----- 83.8 Percent

RADIOMETRIC ASSAY

(e) Uranium Oxide 0.0 Percent

Reed Engineering

1140 N. Lemon Street, Orange, California 92667

SPECTROGRAPHIC ANALYSIS

For:

*Elements not detectable below .005%

+

Date: JUL 3 - 1973

+

Sample No. #6

Mr. R. S. Chisholm
 20 Box 1351
 Mendota, CA 95211

Film No. 05

+

Tests Recommended:

Approximate Values

QUALITATIVE

Approximate Values

	Lbs. per ton	Value per ton	Percent
Aluminum	52	.52	2.6
Antimony			
Barium			
Beryllium			
Bismuth			
Cadmium			
Calcium	86	.86	4.3
Cesium			
Chromium	10	\$1.30	.5
Cobalt			
Columbium			
Copper			
Fluorine			
Gallium			
Gold*			
Hafnium			
Indium			
Iridium*			
Iron	156	\$1.84	7.8
Lead			
Lithium	.02	---	.001
Magnesium	12	.06	.6
Manganese	2	.20	.1
Mercury			
Molybdenum	---	---	trace
Nickel			
Osmium*			
Palladium*			
Platinum*			
Potassium	60	\$1.20	3.0
Rhodium*			
Rubidium*			
Ruthenium*			
Silver			
Sodium	8	.08	.4

	Lbs. per ton	Value per ton	Percent
Strontium	4	.12	.2
Tantalum			
Thallium			
Thorium			
Tin			
Titanium	2	.20	.1
Tungsten			
Vanadium			
Zinc			
Zirconium			

RARE EARTHS : none

	Lbs. per ton	Value per ton	Percent
Cerium			
Dysprosium			
Erbium			
Europium			
Gadolinium			
Holmium			
Lanthanum			
Lutetium			
Neodymium			
Praseodymium			
Samarium			
Terbium			
Thulium			
Ytterbium			
Yttrium			

Silicon, Water, Gases----- 80.3 Percent

RADIOMETRIC ASSAY

(e) Uranium Oxide 0.0 Percent

Reed Engineering

1140 N. Lemon Street, Orange, California 92667

SPECTROGRAPHIC ANALYSIS

For:

*Elements not detectable below .005%

+

+

Date: JUL 3 - 1973

Sample No. #7

Dr. F. H. Whishole
 P.O. Box 1351
 Monticello, AL 35311

Film No. 06

Tests Recommended:

+

+

Approximate Values

QUALITATIVE

Approximate Values

	Lbs. per ton	Value per ton	Percent
Aluminum	190	\$1.90	9.5
Antimony			
Barium			
Beryllium			
Bismuth			
Cadmium			
Calcium	160	\$1.60	8.0
Cesium			
Chromium	6	.78	.3
Cobalt			
Columbium			
Copper			
Fluorine			
Gallium			
Gold*			
Hafnium			
Indium			
Iridium*			
Iron	210	\$1.72	10.5
Lead	4	.60	.2
Lithium	---	---	trace
Magnesium	34	.17	1.7
Manganese	4	.40	.2
Mercury			
Molybdenum	.06	---	.003
Nickel			
Osmium*			
Palladium*			
Platinum*			
Potassium	88	\$1.76	4.4
Rhodium*			
Rubidium*			
Ruthenium*			
Silver			
Sodium	68	.68	3.4

	Lbs. per ton	Value per ton	Percent
Strontium	4	.12	.2
Tantalum			
Thallium			
Thorium			
Tin			
Titanium	20	\$2.00	1.0
Tungsten			
Vanadium			
Zinc			
Zirconium			

RARE EARTHS : none

	Lbs. per ton	Value per ton	Percent
Cerium			
Dysprosium			
Erbium			
Europium			
Gadolinium			
Holmium			
Lanthanum			
Lutetium			
Neodymium			
Praseodymium			
Samarium			
Terbium			
Thulium			
Ytterbium			
Yttrium			

Silicon, Water, Gases----- 60.5 Percent

RADIOMETRIC ASSAY

(e) Uranium Oxide 0.0 Percent

Reed Engineering

1140 N. Lemon Street, Orange, California 92667

SPECTROGRAPHIC ANALYSIS

For:

*Elements not detectable below .005%

+ +

Date: JUL 3 - 1973

Mr. E.H. Chisholm
PO Box 1351
Glendale, AZ 85311

Sample No. #11

Film No. 01

Tests Recommended:

+ +

Approximate Values

QUALITATIVE

Approximate Values

	Lbs. per ton	Value per ton	Percent
Aluminum	134	\$1.34	6.7
Antimony			
Barium	62	\$1.24	3.1
Beryllium			
Bismuth			
Cadmium			
Calcium	200	\$2.00	10.0
Cesium			
Chromium	.6	---	.03
Cobalt			
Columbium			
Copper			
Fluorine			
Gallium			
Gold*			
Hafnium			
Indium			
Iridium*			
Iron	72	.86	3.6
Lead	---	---	trace
Lithium	.02	---	.001
Magnesium	170	.85	8.5
Manganese	4	.40	.2
Mercury			
Molybdenum			
Nickel			
Osmium*			
Palladium*			
Platinum*			
Potassium	160	\$3.20	8.0
Rhodium*			
Rubidium*			
Ruthenium*			
Silver			
Sodium	24	.24	1.2

	Lbs. per ton	Value per ton	Percent
Strontium	20	.60	1.0
Tantalum			
Thallium			
Thorium			
Tin			
Titanium	18	\$1.80	.9
Tungsten			
Vanadium	---	---	trace
Zinc			
Zirconium			

RARE EARTHS : none

	Lbs. per ton	Value per ton	Percent
Cerium			
Dysprosium			
Erbium			
Europium			
Gadolinium			
Holmium			
Lanthanum			
Lutetium			
Neodymium			
Praseodymium			
Samarium			
Terbium			
Thulium			
Ytterbium			
Yttrium			

Silicon, Water, Gases----- 56.7 Percent

RADIOMETRIC ASSAY

(e) Uranium Oxide 0.0 Percent

Reed Engineering

1140 N. Lemon Street, Orange, California 92667

SPECTROGRAPHIC ANALYSIS

For:

*Elements not detectable below .005%

+

Date: JUL 28 1973

+

E. H. Chisholm
PO Box 1351
Glendale, AZ 85311

Sample No. 101

Film No. 09

+

Tests Recommended:

Approximate Values

Lbs. per ton Value per ton Percent

Aluminum	32	.32	1.6
Antimony			
Barium	72	\$1.44	3.6
Beryllium			
Bismuth			
Cadmium			
Calcium			
Cesium	80	.80	4.0
Chromium			
Cobalt			
Columbium			
Copper			
Fluorine	60	\$4.20	3.0
Gallium			
Gold*			
Hafnium			
Indium			
Iridium*			
Iron	88	\$1.04	4.4
Lead			
Lithium			
Magnesium	18	.09	.9
Manganese	14	\$1.40	.7
Mercury			
Molybdenum			
Nickel			
Osmium*			
Palladium*			
Platinum*			
Potassium	4	.08	.2
Rhodium*			
Rubidium*			
Ruthenium*			
Silver			
Sodium	6	.06	.3

QUALITATIVE

Approximate Values

Lbs. per ton Value per ton Percent

Strontium	10	.30	.5
Tantalum			
Thallium			
Thorium			
Tin			
Titanium	.04	---	.002
Tungsten			
Vanadium			
Zinc			
Zirconium			

RARE EARTHS : none

Lbs. per ton Value per ton Percent

Cerium			
Dysprosium			
Erbium			
Europium			
Gadolinium			
Holmium			
Lanthanum			
Lutetium			
Neodymium			
Praseodymium			
Samarium			
Terbium			
Thulium			
Ytterbium			
Yttrium			

Silicon, Water, Gases----- 80.7 Percent

RADIOMETRIC ASSAY

(e) Uranium Oxide 0.0 Percent

Reed Engineering

1140 N. Lemon Street, Orange, California 92667

SPECTROGRAPHIC ANALYSIS

For:

*Elements not detectable below .005%

+

+

Date:

JUL 28 1973

Sample No. unmarked rocks

Mr. E.H. Chisholm

Film No. 11

Tests Recommended: ****see Fluorine

+

+

Approximate Values

QUALITATIVE

Approximate Values

	Lbs. per ton	Value per ton	Percent
Aluminum	113	\$1.18	5.9
Antimony			
Barium			
Beryllium			
Bismuth			
Cadmium			
Calcium	560	*****	28.0
Cesium			
Chromium			
Cobalt			
Columbium			
Copper			
Fluorine	400	\$60.00	29.0
Gallium			
Gold*			
Hafnium			
Indium			
Iridium*			
Iron	84	\$1.01	4.2
Lead			
Lithium	---	---	trace
Magnesium	16	.08	.8
Manganese	8	.80	.4
Mercury			
Molybdenum	---	---	trace
Nickel			
Osmium*			
Palladium*			
Platinum*			
Potassium	150	\$3.00	7.5
Rhodium*			
Rubidium*			
Ruthenium*			
Silver			
Sodium	10	.10	.5

	Lbs. per ton	Value per ton	Percent
Strontium	22	.66	1.1
Tantalum			
Thallium			
Thorium			
Tin			
Titanium	6	.60	.3
Tungsten			
Vanadium			
Zinc			
Zirconium			

RARE EARTHS: none

	Lbs. per ton	Value per ton	Percent
Cerium			
Dysprosium			
Erbium			
Europium			
Gadolinium			
Holmium			
Lanthanum			
Lutetium			
Neodymium			
Praseodymium			
Samarium			
Terbium			
Thulium			
Ytterbium			
Yttrium			

Silicon, Water, Gases-----31.2 Percent

RADIOMETRIC ASSAY

(e) Uranium Oxide 0.0 Percent

Reed Engineering

1140 N. Lemon Street, Orange, California 92667

SPECTROGRAPHIC ANALYSIS

For:

*Elements not detectable below .005%

+

Date: JUL 28 1973

Mr. E.N. Chisholm

Sample No. 102

Film No. 10

+

Tests Recommended: ***see Fluorine

Approximate Values

QUALITATIVE

Approximate Values

	Lbs. per ton	Value per ton	Percent
Aluminum	32	.32	1.6
Antimony			
Barium			
Beryllium			
Bismuth			
Cadmium			
Calcium	670	670000	33.5
Cesium			
Chromium			
Cobalt			
Columbium			
Copper			
Fluorine	430	\$70.00	21.5
Gallium			
Gold*			
Hafnium			
Indium			
Iridium*			
Iron	.2	---	.01
Lead			
Lithium			
Magnesium	10	.05	.5
Manganese			
Mercury			
Molybdenum			
Nickel			
Osmium*			
Palladium*			
Platinum*			
Potassium	8	.16	.4
Rhodium*			
Rubidium*			
Ruthenium*			
Silver			
Sodium	6	.06	.3

Strontium
Tantalum
Thallium
Thorium
Tin
Titanium
Tungsten
Vanadium
Zinc
Zirconium

	Lbs. per ton	Value per ton	Percent
Strontium			
Tantalum			
Thallium			
Thorium			
Tin			
Titanium			
Tungsten			
Vanadium			
Zinc			
Zirconium			

RARE EARTHS : none

	Lbs. per ton	Value per ton	Percent
Cerium			
Dysprosium			
Erbium			
Europium			
Gadolinium			
Holmium			
Lanthanium			
Lutetium			
Neodymium			
Praseodymium			
Samarium			
Terbium			
Thulium			
Ytterbium			
Yttrium			

Silicon, Water, Gases-----42.1 Percent

RADIOMETRIC ASSAY

(e) Uranium Oxide 0.0 Percent

ARIZONA TESTING LABORATORIES

A DIVISION OF CLAUDE E. McLEAN & SON LABORATORIES, INC.
817 WEST MADISON ST. PHOENIX, ARIZONA 85007

PHONE 254-6181

For: Mr. Gene Chisholm
Post Office Box 1351
Glendale, Arizona 85311

Date: May 14, 1974

Lab. No.: 6842

Received: -----

Marked: No Mark

Submitted by: Same

REPORT OF QUALITATIVE SPECTROGRAPHIC EXAMINATION

<u>ELEMENT</u>	<u>APPROXIMATE PERCENT</u>
Boron	0.01
Silicon	5.0
Aluminum	2.0
Manganese	0.04
Magnesium	0.2
Lead	1.0
Chromium	0.1
Copper	9.0
Iron	Major Constituent
Molybdenum	0.2
Calcium	1.0
Vanadium	0.005
Sodium	5.0
Zinc	6.0
Titanium	0.04
Silver	0.05
Nickel	1.0

Respectfully submitted,

ARIZONA TESTING LABORATORIES



Claude E. McLean, Jr.

Reed Engineering

1140 N. Lemon Street, Orange, California 92667

SPECTROGRAPHIC ANALYSIS

For:

*Elements not detectable below .005%

+ +

Date: JUL 3 - 1973

Mr. E.H. Chisholm
P.O. Box 1851
Glendale, AZ 85311

Sample No. #Wall

Film No. 03

Tests Recommended:

+ +

Approximate Values

QUALITATIVE

Approximate Values

	Lbs. per ton	Value per ton	Percent
Aluminum	110	\$1.10	5.5
Antimony			
Barium			
Beryllium			
Bismuth			
Cadmium			
Calcium	42	.42	2.1
Cesium			
Chromium	6	.78	.3
Cobalt			
Columbium			
Copper			
Fluorine			
Gallium			
Gold*			
Hafnium			
Indium			
Iridium*			
Iron	28	.33	1.4
Lead			
Lithium	---	---	trace
Magnesium	24	.12	1.2
Manganese			
Mercury			
Molybdenum			
Nickel			
Osmium*			
Palladium*			
Platinum*			
Potassium	18	.36	.9
Rhodium*			
Rubidium*			
Ruthenium*			
Silver			
Sodium	72	.72	3.6

	Lbs. per ton	Value per ton	Percent
Strontium	2	.06	.1
Tantalum			
Thallium			
Thorium			
Tin			
Titanium	.1	---	.005
Tungsten			
Vanadium			
Zinc			
Zirconium			

RARE EARTHS : none

	Lbs. per ton	Value per ton	Percent
Cerium			
Dysprosium			
Erbium			
Europium			
Gadolinium			
Holmium			
Lanthanum			
Lutetium			
Neodymium			
Praseodymium			
Samarium			
Terbium			
Thulium			
Ytterbium			
Yttrium			

Silicon, Water, Gases-----84.9 Percent

RADIOMETRIC ASSAY

(e) Uranium Oxide 0.0 Percent

ARIZONA TESTING LABORATORIES

A DIVISION OF CLAUDE E. McLEAN & SON LABORATORIES, INC.
817 WEST MADISON ST. PHOENIX, ARIZONA 85007

PHONE 254-6181

For Gene Chisholm

Date June 6, 1973

Sample of Ore

Received:

Submitted by: same

ASSAY CERTIFICATE

Gold figured at \$ 80.00 per ounce

Silver figured at \$ 2.00 per ounce

LAB. NO.	IDENTIFICATION	GOLD		SILVER		PERCENTAGES	
		OZ. PERTON	VALUE	OZ. PERTON	VALUE	Copper	
4558	H-Wall, 650	0.01	0.80	2.25	4.50	0.02	
	#22, 650	0.01	0.80	0.15	0.30	0.01	
	#5, 650					0.01	
	#6, 650					0.02	
	#7, 650					0.01	
	#11, 650					0.03	
	Fissure 650' wide 4000'					1.80	

Respectfully submitted,

ARIZONA TESTING LABORATORIES

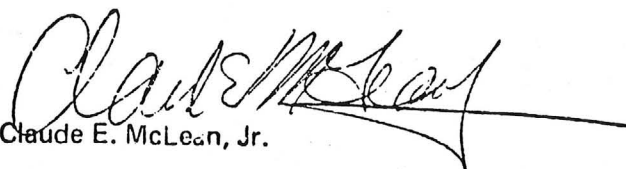
 Claude E. McLean, Jr.

STATE OF ARIZONA
DEPARTMENT OF MINERAL RESOURCES
MINERAL BUILDING, FAIRGROUNDS
PHOENIX, ARIZONA 85007

April 27, 1973

Mr. Gene Chisholm
Aguila, Arizona 85320

Dear Mr. Chisholm:

It has come to our attention that you own a large number of mining claims in the Harquahala Mt. area and wish to obtain investors and/or financing for these properties.

We would very much appreciate any information you could supply on your mining property. I have enclosed a mine owners report for your convenience. Whatever amount of information you would be willing to supply would be helpful for our files. Our mine files are open to the public and are often consulted by the large mining and exploration companies and individuals wishing to purchase or finance mining ventures.

Data and reports on your property on file in this office may be helpful in your gaining financing.

Thank you very much.

Sincerely,

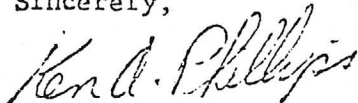

Ken A. Phillips,
Mineral Resource Specialist

KAP/GCS

Enclosures

DEPARTMENT OF MINERAL RESOURCES
State of Arizona
MINE OWNER'S REPORT

Date 5-14-73

- Mine: Copper Peak - Silver Thread - Two Sisters and old Gold Claims
- Location: Sec ⁵⁻⁶⁻⁷⁻⁸ 32-33 Twp ^{4N} 5N Range ^{12W} 12W Nearest Town: AGUILA Distance 1.8 1/2 mi
Direction ^{North east} From mine Nearest R.R. AGUILA Distance 1.8 1/2 mi
Road Conditions: Well maintained COUNTY ROAD
- Mining District and County: Ellsworth - MARICOPA
- Former Name of Mine: ALASKA - RAINBOW - WALDON HILL
- Owner: Gene H. Chisholm
Address: P.O. Box 1351 Glendale, ARIZONA 85311
- Operator: Gene Chisholm Phone 602-939-8315
Address: SAME
- Principal Minerals: Copper - Gold - Silver - Fluorspar - Dolomite - Limestone - Carbonate - Aberrant
- Number of Claims: Lode 98 Patented Unpatented ✓
Placer Patented Unpatented
- Type of Surrounding Terrain: IGNEOUS AND SEDIMENTARY rocks, disseminated through sediments.
- Geology and Mineralization: FLUORSPAR, Copper, high contents of Silica
Fissure vein from Northeast to southwest one mile long approximately 100' wide at the southwest end, 50' wide at the northeast end, at the center of this fissure body exposed by deep wash, 650' wide and one-half mile long. Recent tests of samples by A.T.L. - Copper = 0.24 of 1% from surface up to 11.9'.
- Dimension and Value of Ore Body: Engineer's estimate of copper deposit of one hundred million tons and that did not include the outlying areas.

Please give as complete information as possible and attach copies of engineer's reports, shipment returns, maps, etc. if you wish to have them available in this Department's files for inspection by prospective lesors or buyers.

12. Ore "Blocked Out" or "Sight": Fissure Ore Body one-half mile long, 650' wide and drill hole indicates depth of ore to 600'. This ore deposit consists of 60 million Tons.

Ore Probable: My personal opinion same as Engineer's possible over 100 million tons high grade copper has been shipped from this property several different times.

13. Mine Workings—Amount and Condition:

No.	Feet	Condition
Shafts <u>14</u>	<u>120-110-30-40</u>	<u>old</u>
Raises		
Tunnels <u>2</u>	<u>120-110-40</u>	<u>old</u>
Crosscuts <u>15</u>		<u>New</u>
Stopes <u>2</u>		<u>last 10 years</u>

14. Water Supply: windmill supply water for cattle ranches now and has been for last 45 years

15. Brief History: The old Alaska mine produced several hundred thousand dollars in gold in the 1920+30 as the Rainbow Claims, mined by the Alaska Mining Corp. until they shut down on gold in 1933 a fifty ton stamp mill worked at the old Alaska mine for some time.

16. Remarks: this property should be drilled and blocked the one drill hole that I put down is just a start even with the large amount of copper ore exposed by my exploration work each year, it still should be drilled that is why I am offering to sell some interest in this property.

17. If Property for Sale, List Approximate Price and Terms: I have 2,300,000 tons of rock that has been tested for specification for use on C.A.P. Water Project that will be excluded from property if responsible company

18. Signature: wants to drill and block ore body of copper, I will take \$100 per ton of all copper drilled & blocked on cash sale.
Signed: Gene Chickholm P.O. Box 1351 Grand Lake Ariz 85511
Ph. 939-8315

NOTICE:

June 24, 1976

Stolen Quit Claim Deeds
on Mining Property!!

A. H. Chisholm
Mining Company
P.O. Box 1351
Glendale, Arizona
85311

To Whom It May Concern:

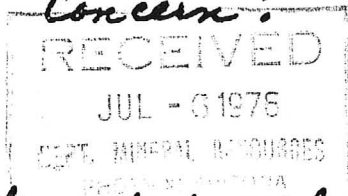

Dear Sir:

I am trying to catch thieves before they make any other sales or trades of Quit Claim Deeds stolen from me by the following persons: Arlen H. Larson - last known address, 1305 East Fremont Dr. Tempe, Arizona - Dennis O. Larson - last known address, 1902 West Eugie - Phoenix, Arizona - Beverly Ann Judson - 1902 West Eugie, Phoenix, Arizona.

These people are friends and associates of Del Schultz of Sea-Ecc Construction, Inc. He purchased an interest in said property in 1974 + 1975, is falsely claiming that I have no interest left in this property.

Description + location of mining property as follows: Copper Penny, Silver Thread, Two Sisters, and Old Gold - T55N: R.10W: SEC. 32-33; T54N: R10W: SEC. 5-6-7-8, located in the Ellsworth Mining District, Yuma and Maricopa Counties, State of Arizona.

If by chance any of the above persons should contact you in regards to the selling of said mining property, please notify the Sheriff's office. Fraud case file no. 76-16053 or contact the F.B.I. - 279-5511 and ask for the agent that I filed the theft report with.

Signed: A. H. Chisholm

REED ENGINEERING
1140 NO. LEMON ST., SUITE C
ORANGE, CALIF. 92667

Assay Certificate

Date: JUL 3 - 1973

The samples received from E.H. Chisholm assayed as follows:

Sample Identification	Gold		Silver	
	oz. per ton	value per ton	oz. per ton	value per ton
#11	none	---	none	---
#22	none	---	none	---
#Wall	none	---	none	---
#5	none	---	none	---
#6	none	---	none	---
#7	none	---	6.344	\$16.20

Silver \$2.60 per oz. Gold \$110 per oz.

Assayer

P. Reed

ARIZONA TESTING LABORATORIES

A DIVISION OF CLAUDE E. McLEAN & SON LABORATORIES, INC.
817 WEST MADISON ST. PHOENIX, ARIZONA 85007

PHONE 254-6181

For Mr. Gene Chisholm
Post Office Box 1351
Glendale, Arizona 85311

Date May 15, 1974

Sample of Pulp

Received: ----

Submitted by: same

ASSAY CERTIFICATE

Gold figured at \$ 200.00 per ounce

Silver figured at \$ 5.00 per ounce

LAB. NO.	IDENTIFICATION	GOLD		SILVER		PERCENTAGES	
		OZ. PER TON	VALUE	OZ. PER TON	VALUE		
6842	No Mark			82.	\$410.00		
				Note: This corresponds to 0.28% silver			

Respectfully submitted,

ARIZONA TESTING LABORATORIES

Claude E. McLean, Jr.
Claude E. McLean, Jr.