



CONTACT INFORMATION

Mining Records Curator
Arizona Geological Survey
1520 West Adams St.
Phoenix, AZ 85007
602-771-1601
<http://www.azgs.az.gov>
inquiries@azgs.az.gov

The following file is part of the

Arizona Department of Mines and Mineral Resources Mining Collection

ACCESS STATEMENT

These digitized collections are accessible for purposes of education and research. We have indicated what we know about copyright and rights of privacy, publicity, or trademark. Due to the nature of archival collections, we are not always able to identify this information. We are eager to hear from any rights owners, so that we may obtain accurate information. Upon request, we will remove material from public view while we address a rights issue.

CONSTRAINTS STATEMENT

The Arizona Geological Survey does not claim to control all rights for all materials in its collection. These rights include, but are not limited to: copyright, privacy rights, and cultural protection rights. The User hereby assumes all responsibility for obtaining any rights to use the material in excess of "fair use."

The Survey makes no intellectual property claims to the products created by individual authors in the manuscript collections, except when the author deeded those rights to the Survey or when those authors were employed by the State of Arizona and created intellectual products as a function of their official duties. The Survey does maintain property rights to the physical and digital representations of the works.

QUALITY STATEMENT

The Arizona Geological Survey is not responsible for the accuracy of the records, information, or opinions that may be contained in the files. The Survey collects, catalogs, and archives data on mineral properties regardless of its views of the veracity or accuracy of those data.

PRINTED: 07-27-2012

ARIZONA DEPARTMENT OF MINES AND MINERAL RESOURCES AZMILS DATA

PRIMARY NAME: WAR HORSE

ALTERNATE NAMES:

MANILA
HOMER

COCHISE COUNTY MILS NUMBER: 653

LOCATION: TOWNSHIP 20 S RANGE 21 E SECTION 36 QUARTER NE
LATITUDE: N 31DEG 38MIN 39SEC LONGITUDE: W 110DEG 08MIN 55SEC
TOPO MAP NAME: FAIRBANK - 7.5 MIN

CURRENT STATUS: PAST PRODUCER

COMMODITY:

LEAD
GOLD LODE
SILVER
COPPER OXIDE
VANADIUM
MOLYBDENUM

BIBLIOGRAPHY:

USBM REPORT FILE NO. 463.2/19009 BY
THOMAS L. CHAPMAN
AZBM BULL 158, PART II, P 39
ADMMR WAR HORSE FILE
SEE BOOK V-III A.L.FLAGG VANADIUM REPORTS

WAR HORSE COPPER MINING COMPANY.

The claims of the War Horse Copper Mining Company (defunct) lie southwest of the Gallagher property. The present ownership is not known. Within very recent times a re-survey of the Boquillas Land Grant boundary puts the shaft, which is known generally as the Manilla Shaft, within the Land Grant. This is open to question.

Between the War Horse ground and the Gallagher claims are claims owned by Etlinger heirs. (Ettlinger long a resident of Bisbee)

In 1942 Percy Ryder, the last operating Superintendent on the War Horse properties told A.L. Flagg that when the property was closed down in 1907(?) copper ore showed in the face of the southwest drift on the 400-ft level. His recollection as to the copper content was not too clear but it was of the order of 2% perhaps.

A mine plan was prepared by Motz Engineering Company, Bisbee, dated September 4th, 1924.

Copy of prospectus and
above notes furnished
by A.L. Flagg, 11-20-52.

WAR HORSE
COPPER MINING
COMPANY

Later known as Gallagher Copper Co.

PROSPECTUS OF THE WAR HORSE COPPER MINING COMPANY

Tombstone Mining District Cochise County, Arizona

- - - -

The above Company owns fifteen mines, as follows: War Horse, War Horse No. 2, War Horse No. 3 and 4, War Eagle, War Eagle No. 2, Bald Eagle, Bald Eagle No. 2, 3, 4 and 5, Osker, Bessie, Orin and Homer. About six miles southwesterly from Tombstone and about twenty miles northwesterly from Bisbee, three-fourths mile from Charleston, on Main Line of El Paso & Southwestern Railroad. County road from Tombstone to Fort Huachuca runs within two hundred feet of Shaft No. 1 on War Horse mine.

DEVELOPMENT WORK ON WAR HORSE MINE

Double compartment shaft five hundred and eight feet deep, timbered to bottom. Cross cut on two hundred level with some drifting both East and West, with shipping ore in both drifts. Large sump with station pump.

On four hundred foot level cross cut with large sump and station pump. At two hundred and sixty-five feet in shaft ledge of copper ore five and one-half feet thick was cut. Average assay copper 8 per cent, silver 16 oz. gold \$1.00.

At 286 feet in shaft low grade ledge was cut and lasted to 315 feet in shaft, when it dipped out same as copper ledge. Cross cut on 400 level cut through this ledge on 400 level for 27 feet, but was not extended far enough to cut the copper ledge or the ledge cut on 200 level.

At 450 feet in shaft high grade ledge was cut through but no cross-cutting has been done at bottom of shaft to cut this ledge, or any other.

On War Eagle mine, double compartment shaft timbered 100 feet deep no cross-cutting done for the ledge. War Horse No. 2, one shaft 85 feet, one 60 feet. On balance of group numerous shafts have been started ranging in depth from 10 to 50 feet, some of which show high grade ore with a showing of ore in every one.

The 27 foot ledge can be traced on the surface through War Horse, War Horse No. 2, 3, and 4, War Eagle and War Eagle No. 2, a distance of 9,000 feet. The big ledge assays on 400 foot level from \$1 to \$4.50 gold and 2 per cent copper at 30 cents for copper would average \$13 per ton in copper and gold.

MACHINERY ON PROPERTY

One Double cylinder hoisting engine, 25 horse power.

One single cylinder hoisting engine, 10 horse power.

Two 70 horse power boilers.

One 20 horse power boiler.

Two Duplex Station pumps, 4 in. discharge.

Two Cameron Sinkers, No. 5 and No. 9.

Cage in shaft, six ore cars, hoist building, blacksmith shop, oil house, tool house, etc.

The Company has placed in the Treasury 300 thousand shares of stock. The price of the first 50 thousand shares to be sold for 25 cents per share, 50 thousand to be sold for 35 cents per share, and 100 thousand shares at 50 cents per share, for the purpose of purchasing air compressor, air drills, cross-cutting further on 200, 400 and 500 foot levels. Sinking shaft 200 feet deeper and putting in lift pumps to drain the

mine; sinking air shaft to connect with 200 foot level, to comply with the laws of the state.

Stock is fully paid and non-assessable, and we expect to commence shipping ore in a short time after mine is unwatered. The water has only increased 20 thousand gallons in 24 hours in sinking shaft from 200 to 500 foot levels and is only making about 70 thousand gallons per day.

We are only offering 200 thousand shares of the stock for sale, as we expect the stock to advance when we get the mine unwatered and start shipping.

There are no debts on the property.

These mines are in the Tombstone District, which has produced about 40 million dollars in gold silver and lead, and were worked in the early days to water, which was struck at about 400 feet, and the President of this Company was the first man to go below water and strike copper.

Our officers are business men, and the President has had over 35 years experience in mining.

- - - -

mine; sinking air shaft to connect with 200 foot level, to comply with the laws of the state.

Stock is fully paid and non-assessable, and we expect to commence shipping ore in a short time after mine is unwatered. The water has only increased 20 thousand gallons in 24 hours in sinking shaft from 200 to 500 foot levels and is only making about 70 thousand gallons per day.

We are only offering 200 thousand shares of the stock for sale, as we expect the stock to advance when we get the mine unwatered and start shipping.

There are no debts on the property.

These mines are in the Tombstone District, which has produced about 10 million dollars in gold silver and lead, and were worked in the early days to water, which was struck at about 400 feet, and the President of this Company was the first man to go below water and strike copper.

Our officers are business men, and the President has had over 35 years experience in mining.

PROSPECTUS OF THE

WAR HESS

COPPER

MINEING CO.

Tombstone Mining District

Cochise County, Arizona

OFFICERS

H. F. Fisher - - - - - President

John Rock - - - - - Vice President

F. J. Abell - - - - - Sec. - Treas.

Douglas Gray - - - - - Director

J. L. Smythe - - - - - Director

L. K. Fisher - - - - - Director

"Reported as ore
by our engineers"

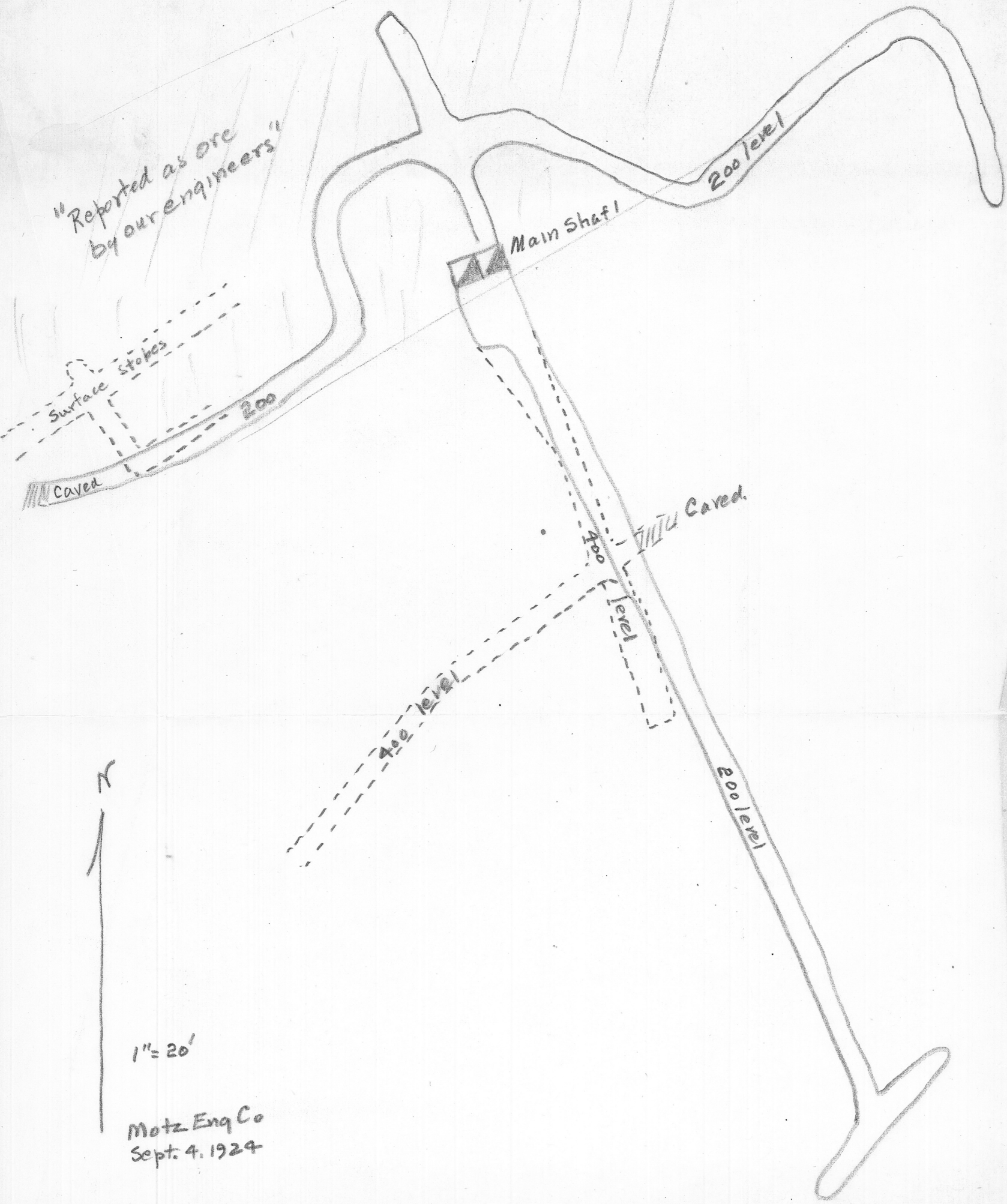

1" = 20'

Motz Eng Co
Sept. 4, 1924