



CONTACT INFORMATION

Mining Records Curator
Arizona Geological Survey
1520 West Adams St.
Phoenix, AZ 85007
602-771-1601
<http://www.azgs.az.gov>
inquiries@azgs.az.gov

The following file is part of the

Arizona Department of Mines and Mineral Resources Mining Collection

ACCESS STATEMENT

These digitized collections are accessible for purposes of education and research. We have indicated what we know about copyright and rights of privacy, publicity, or trademark. Due to the nature of archival collections, we are not always able to identify this information. We are eager to hear from any rights owners, so that we may obtain accurate information. Upon request, we will remove material from public view while we address a rights issue.

CONSTRAINTS STATEMENT

The Arizona Geological Survey does not claim to control all rights for all materials in its collection. These rights include, but are not limited to: copyright, privacy rights, and cultural protection rights. The User hereby assumes all responsibility for obtaining any rights to use the material in excess of "fair use."

The Survey makes no intellectual property claims to the products created by individual authors in the manuscript collections, except when the author deeded those rights to the Survey or when those authors were employed by the State of Arizona and created intellectual products as a function of their official duties. The Survey does maintain property rights to the physical and digital representations of the works.

QUALITY STATEMENT

The Arizona Geological Survey is not responsible for the accuracy of the records, information, or opinions that may be contained in the files. The Survey collects, catalogs, and archives data on mineral properties regardless of its views of the veracity or accuracy of those data.

PRINTED: 09/05/2002

ARIZONA DEPARTMENT OF MINES AND MINERAL RESOURCES AZMILS DATA

PRIMARY NAME: TWIN SAGUARO PROSPECT

ALTERNATE NAMES:

MARICOPA COUNTY MILS NUMBER: 680

LOCATION: TOWNSHIP 2 S RANGE 6 W SECTION 17 QUARTER S2
LATITUDE: N 33DEG 15MIN 10SEC LONGITUDE: W 112DEG 53MIN 48SEC
TOPO MAP NAME: ARLINGTON - 15 MIN

CURRENT STATUS: UNKNOWN

COMMODITY:
COPPER
GOLD

BIBLIOGRAPHY:
ADMMR TWIN SAGUARO PROSPECT FILE

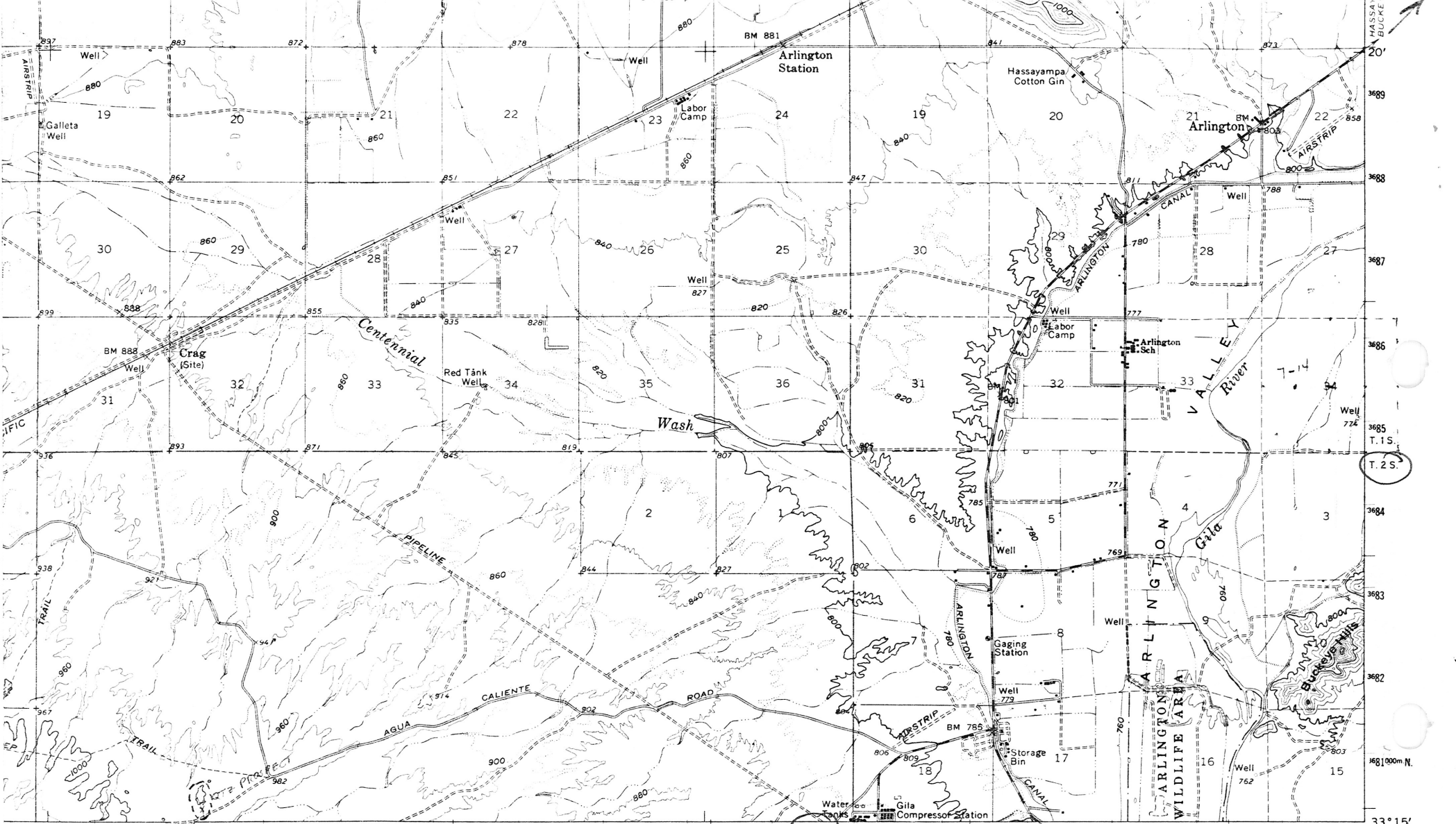

TWIN SAGUARO PROSPECT
 SCALE 1:62500

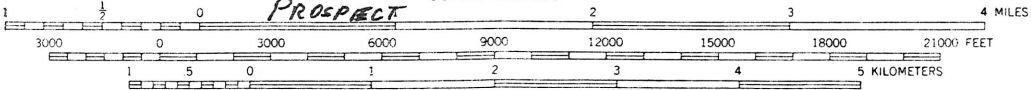

CONTOUR INTERVAL 40 FEET
 DOTTED LINES REPRESENT 20-FOOT CONTOURS
 DATUM IS MEAN SEA LEVEL



QUADRANGLE LOCATION

ROAD CLASSIFICATION
 Medium-duty ——— Light-duty ———
 Unimproved dirt - - - - -

ARLINGTON, ARIZ.
 N3315—W11245/15

1962

AMS 3450 IV—SERIES V798

THIS MAP COMPLIES WITH NATIONAL MAP ACCURACY STANDARDS
 FOR SALE BY U. S. GEOLOGICAL SURVEY, DENVER 25, COLORADO OR WASHINGTON 25, D. C.
 A FOLDER DESCRIBING TOPOGRAPHIC MAPS AND SYMBOLS IS AVAILABLE ON REQUEST

MINE AND PROSPECT FIELD VISIT DATA SUMMARY

Sheet 1 of 2

COMMODITIES Copper Gold(?) Silver (?)

MILS ID No. New MILS 680 Date May 13, 1982

ENGINEER Ken A. Phillips and Nyal Niemuth

INFORMATION FROM: above

PROPERTY SUMMARY

I. MINE NAME Twin Saguaro Prospect OTHER POSSIBLE NAMES INCLUDING ANY CLAIM NAMES NOTED

II. LOCATION: T 2S R 6W SEC(S) S $\frac{1}{2}$ 17 unsurveyed MINE DISTRICT
 ELEV. 1000' COUNTY Maricopa TOPO QUAD. Arlington 15'
 DIRECTIONS As on Topo

MAP ATTACHED

III. OWNERSHIP: NAME unknown PHONE
 ADDRESS:
 COMPANY NAME IF ANY:
 PERTINENT PEOPLE

IV. PROPERTY AND HOLDINGS: unknown

V. PAST PRODUCTION - NOTED, KNOWN, PROBABLE, UNKNOWN, NONE None

IV. CURRENT STATUS:

IV. WORKINGS: Prospect pits - one ten feet deep

IV. GEOLOGY AND MINERALOGY: DEPOSIT TYPE: Quartz Vein in green schist
 LENGTH: Variable but ^{tracable for up to 200'} WIDTH: 2 - 3" VEIN STRIKE N30W Dip 70°NE
 HOST ROCK: (Meta Volcanic) Schist
 ECONOMIC MINERALS: Malachite, possible Au in quartz vein

COMMENTS: Series of narrow quartz veins showing copper oxides. May contain precious metals.

IX. EQUIPMENT ON SIGHT: None

X. SAMPLING: NOTE TYPE IF ANY, DRILLING? None taken.

XI. REFERENCES AND REMARKS

Twin Lagoons Prospect

7/22/82

Ln 17 (appears open)

IPA 6-8 (289380)

Beverly Hill

1990
(No 1991)?