



CONTACT INFORMATION

Mining Records Curator
Arizona Geological Survey
1520 West Adams St.
Phoenix, AZ 85007
602-771-1601
<http://www.azgs.az.gov>
inquiries@azgs.az.gov

The following file is part of the

Arizona Department of Mines and Mineral Resources Mining Collection

ACCESS STATEMENT

These digitized collections are accessible for purposes of education and research. We have indicated what we know about copyright and rights of privacy, publicity, or trademark. Due to the nature of archival collections, we are not always able to identify this information. We are eager to hear from any rights owners, so that we may obtain accurate information. Upon request, we will remove material from public view while we address a rights issue.

CONSTRAINTS STATEMENT

The Arizona Geological Survey does not claim to control all rights for all materials in its collection. These rights include, but are not limited to: copyright, privacy rights, and cultural protection rights. The User hereby assumes all responsibility for obtaining any rights to use the material in excess of "fair use."

The Survey makes no intellectual property claims to the products created by individual authors in the manuscript collections, except when the author deeded those rights to the Survey or when those authors were employed by the State of Arizona and created intellectual products as a function of their official duties. The Survey does maintain property rights to the physical and digital representations of the works.

QUALITY STATEMENT

The Arizona Geological Survey is not responsible for the accuracy of the records, information, or opinions that may be contained in the files. The Survey collects, catalogs, and archives data on mineral properties regardless of its views of the veracity or accuracy of those data.

09/18/86

1

ARIZONA DEPARTMENT OF MINES AND MINERAL RESOURCES FILE DATA

PRIMARY NAME: TOP HAT GROUP

ALTERNATE NAMES:

GILA COUNTY MILS NUMBER: 403B

LOCATION: TOWNSHIP 8 N RANGE 12 E SECTION 31 QUARTER E2
LATITUDE: N 33DEG 59MIN 30SEC LONGITUDE: W 111DEG 09MIN 38SEC
TOPO MAP NAME: PICTURE MTN - 7.5 MIN

CURRENT STATUS: PRODUCER

COMMODITY:
BARIUM BARITE

BIBLIOGRAPHY:

ADMR TOP HAT MINE FILE
STEWART L A & A J PFISTER BARITE DEPTS AZ
USBM IC 5651 1960 P 12
AZBM BULL 180 MIN & WATER RES AZ 1969 P 314

ARIZONA DEPARTMENT OF MINES AND MINERAL RESOURCES

INFORMATION FROM MINE CARDS IN MUSEUM

ARIZONA

MM-9729 Barité

Gila.Co.

So. of Payson

A & B Mine - Mils # 403 B

1-AKA
Top Hat Mine (File)

ARIZONA DEPARTMENT OF MINES AND MINERAL RESOURCES

INFORMATION FROM MINE CARDS IN MUSEUM

ARIZONA

GILA COUNTY

3

A & B CLAIMS
near Chalk Mtn.

MM-8635 Barite

"

MM-9139 Barite concentrate

MILS #4038

AKA

Top Hat Mine (File)

Date Printed: 11/13/97

ARIZONA DEPARTMENT OF MINES AND MINERAL RESOURCES

INFORMATION SUMMARY

Information from: Allen Matovich and Bob Languth

Company: Northwest Mining Industries, Ltd.

Address: P.O. Box 829

City, State ZIP: Northport, Washington 99157

Phone: 250-367-9555

MINE: Top Hat Barite

ADMMR Mine File: Top Hat Mine

County: Gila

AzMILS Number: 403B

SUMMARY

Bob Languth initially made the contact with me and later brought in Mr. Matovich to the Department as a result of discussing filler-extender grades of barite. I had suggested that the Top Hat property in Gila County was a good first occurrence to look at in Arizona.

Allen Matovich, President of both Northwest Mining Industries and Matovich Mining Industries Ltd., PO Box 829, Northport, Washington 99157 and PO Box 110, Montrose, British Columbia V0G 1P0, phone (250) 367-9555, Fax (250) 367-6122 was in and interested in barite deposits that might produce white ground barite for filler uses.

He was especially interested in my suggestion of the Top Hat, a.k.a. A & B property in Gila County [Gila AZMILS 403B] previously operated by South Coast Texas Aggregates. It is believed that the property is reclaimed, but that only two of the four known pods of barite were mined. Specimens of barite in the Museum's collection were shown. He was impressed by the "dings" on the specimens that show how white a ground product would be in spite of the rose color of the massive specimen.

The Roosevelt Ranger District of the Tonto National Forest should have had copies of the plan of operations for South Coast Texas Aggregates' operation. Bob Languth reported that the Forest Service could not find a copy.

Ken A. Phillips, Chief Engineer

Date: November 10, 1996

DEPARTMENT OF MINERAL RESOURCES
STATE OF ARIZONA
FIELD ENGINEERS REPORT

Mine *Top Hat* BARITE MINE Date August 13, 1957
District UPPER GUN CREEK, GILA CO. Engineer Lewis A. Smith
Subject: Information from Owner - Office Call.

Location: ^{8N 12E 31+32} (T9N R11E, Secs. 27-28) In the North end of the Sierra Anchas,
Gila County, Arizona.

Owners: ✓ E. W. Grimes, Tonto Basin
✓ C. E. and Flora Massingill (2063 West 1st St., Mesa, Arizona
✓ Gale Passey, Mesa, Arizona

Geology: A Barite vein, 6000 feet long and 3-8 feet wide, cuts what is apparently diorite and greenstone. The barite is of excellent grade.

Development work: 6 cuts, 8 to 10' deep, have been made, by bulldozer, at intervals along the strike of the vein.

Access: Nearest railhead at Mesa, by means of the Bush, or Beeline, Highway.

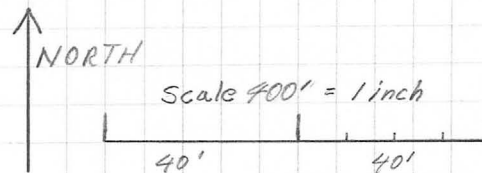

#1 Pit: Good BARITE MINED OUT OVER A STRIKE LENGTH OF 350'
TO A DEPTH OF 85', NOW RECLAIMED

#2 Section: DRILLED BUT NOT MINED. LOW
QUALITY BARITE - TOO MUCH QUARTZ

#3 Section: DRILLED BUT NOT MINED. THREE NARROW
VEINS OF BARITE OVER THE WIDTH OF 80' ZONE.
GOOD QUALITY BARITE, BUT NARROW VEINS.

#4 PIT: SIMILAR TO #1. MINED OUT AND
RECLAIMED

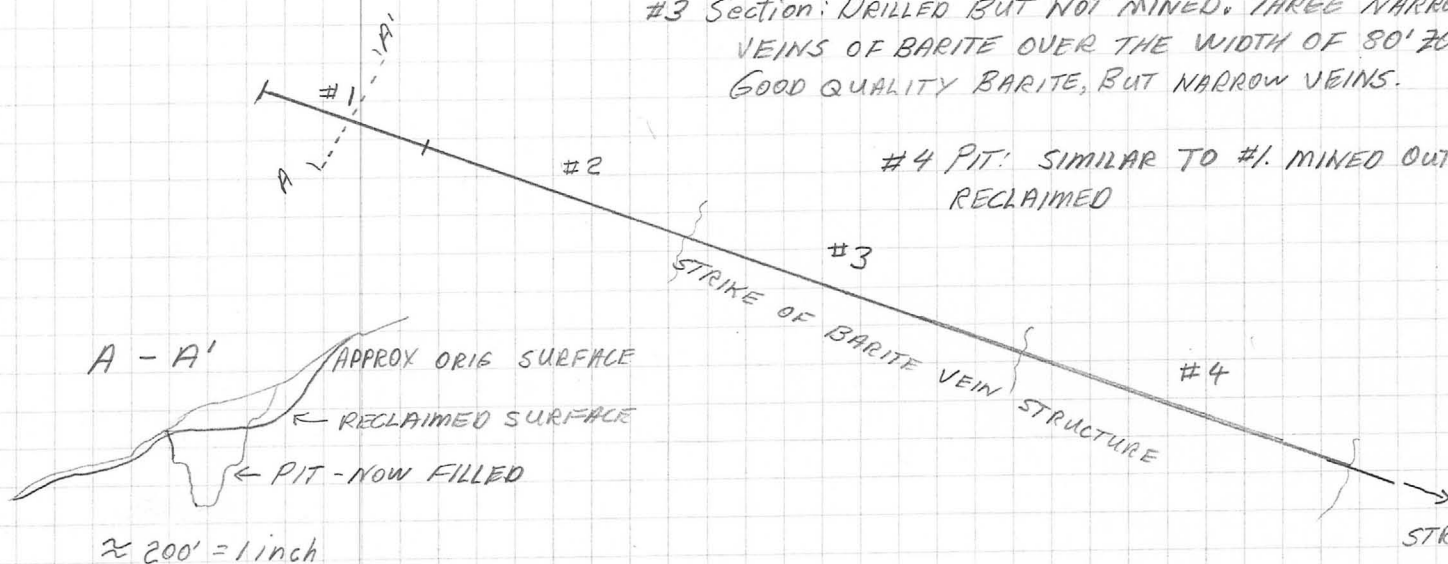

STRUCTURE AND APPARENT LENSE
OF BARITE CONTINUE FOR 3/4 MILE
NO DRILLING HAS BEEN DONE

A+B MINE, GILA COUNTY, ARIZONA
AZ DEPT MINE + MINERAL RESOURCES
TOP HAT MINE FILE, GILA COUNTY
INFORMATION FROM HERB NORDMEYER
COASTAL + WESTERN MINERALS
KNIPPA TEXAS
1982

BARITE MINE

August 13, 1957

UPPER GUN CREEK, GILA CO.

Lewis A. Smith

Information from Owner - Office Call.

- Location: ^{8N 12E 31+32} (T9N R11E, Secs. 27-28) In the North end of the Sierra Anchas, Gila County, Arizona.
- Owners: E. W. Grimes, Tonto Basin
C. E. and Flora Massingill (2063 West 1st St., Mesa, Arizona)
Gale Passey, Mesa, Arizona
- Geology: A Barite vein, 6000 feet long and 3-8 feet wide, cuts what is apparently diorite and greenstone. The barite is of excellent grade.
- Development work: 6 cuts, 8 to 10' deep, have been made, by bulldozer, at intervals along the strike of the vein.
- Access: Nearest railhead at Mesa, by means of the Bush, or Beeline, Highway.

✓
TOP HAT MINE

GILA COUNTY
UPPER GUN CREEK

Flora Massingill reported that a group of Kansas oil people were drilling the Massingill barite deposits. 150 foot holes (3) have disclosed that at 100 feet of depth below the outcrop, there was 6-8 feet of fine barite. Further drilling is in progress. She stated that they have optioned the deposits on a 10% royalty basis. The new company plans to market the barite for oil well mud and for chemical purposes.

L. A. SMITH
November 18, 1958
Weekly report.

ARIZONA DEPARTMENT OF MINERAL RESOURCES

Mineral Building, Fairgrounds

Phoenix, Arizona

1. Information from: D. Herbert "Herb" Nordmeyer
Address: 634 Favel Circle, Uvalde, Texas 78801, Ph- 512-278-4357
2. Mine: A&B (Top Hat mine file) 3. No. of Claims - Patented _____
Unpatented 11
4. Location: _____
Possibly also Sec 4,5 T7
5. Sec 31, 32 Tp 8N Range 12E 6. Mining District _____
7. Owner: Don Packard and Alice Holiday, 664 S. 2nd, Globe, Az. 85501
8. Address: 3785 Butler Ave., Kingman 86401
9. Operating Co.: Coastal and Western Minerals
10. Address: Knippa, Texas, Ph-512-934-2616
11. President: _____ 12. Gen. Mgr.: Herb Nordmeyer
13. Principal Metals: Barite 14. No. Employed: _____
15. Mill, Type & Capacity: Jig
16. Present Operations: (a) Down ☒ (b) Assessment work ☐ (c) Exploration ☐
(d) Production ☐ (e) Rate _____ tpd.
17. New Work Planned: None- deposit is now for sale
18. Misc. Notes: Herb Nordmeyer explained that Coastal & Western was suspending operations at the A & B mine. Although the barite they were producing was of excellent quality they could obtain imported material delivered to their Texas plant from Morrocco cheaper than the cost of just the trucking from Payson. The operation had involved open cut mining of lenses of barite in a vein system to a depth of about 85 feet. Two cuts or pits were mined, both have been backfilled and the land reclaimed. Additional details of the deposit are included on the attached sheet.

Date: October, 1982

(Signature)

Kend Phillips

(Field Engineer)

TOP HAT MINE (file)

DO NOT REPRODUCE THIS PAGE

GILA CO.
Fluorine Dist.

KP WR 1/12/79 - Supplied information to property's owner John Livengood, Nuclear Resources, Inc., 164 Mason St., Greenwich, Conn. 06830, Phone: (203) 661-8363. They have the property located as the A & B Group of Eleven Claims, they hope to develop the potential fluorspar of the property. 2/8/79 a.p.

RRB WR 7/18/80: Hoyt Burckhalter, P.O. Box 167, Deming, New Mexico 88030, reported that he has bought the Top Hat Claims in Tonto Basin, Gila County, from Don Packard and Alice & David Holliday of Globe. Says he has been mining in New Mexico and wanted to know who he had to notify before starting operations in Arizona. I gave him "Pertinent Data". It is a barite property and he intends to extract a few tons for testing before proceeding with development.

RRB WR 10/24/80: Hoyt Burckhalter of South Texas Aggregates reports that they have shipped 600 tons of barite from the Top Hat claims to date. Their projected production is 250 tons per day. Raw ore is shipped to their plant in Knippa, Texas where it is processed for sale to the oil well drilling industry. The company address is Jink Coteman, President, South Texas Aggregates, P.O. Box 217, Knippa, Texas 78870.

KAP WR 11/14/80: Alice and David Holliday, 664 S. Second Street, Globe, Arizona 85501, reported that they have the A & B Group (Lead AMC #72599 in Sections 32 & 33, T7N R11E, Mazatal Mountains District, Tila County). The property is a barite deposit which they have leased to South Texas Aggregate, Houston, Texas. Don Snodgrass of El Paso is apparently the contact for South Texas Aggregate. Actual work on the property is being done by Hoyt O. Burkhalter of Albuquerque.

RRB WR 4/3/81: Verge Ostler of Rocky Mountain Refractories called to find out if there was any barite being mined in the Payson area. I referred him to South Texas Aggregates who are reportedly operating the Tip Top Property.

Phone Call 5/1/81 JHJ: Mr. Ed Heissman of Empire Machinery Company reported that a Herb Nordmeyer of Western Costal Mining was operating the barite mine out of Punkin Center.

RRB WR 6/12/81: Hoyt Burkhalter, formerly with South Texas Aggregates reports that South Texas Aggregates has merged with Western Costal Mining. They are producing barite from the Top Hat property in Gila County.

Top Hat Mine

Gila County

RRG WR 2/5/82: Steve Sikich, Thompson, Weinman and Company, P.O. Box 130, Cartersville, Ga. 30120, phone (404) 382-5353 "A Cyprus Company", was in to get information on the Top Hat Barite property in Gila County. He is looking for pure white barite for filters, fillers, extenders, etc. He would like for us to refer possible suppliers to him.

KAP WR 2/5/82: Herb Nordmeyer, Coastal and Western reported they are mining barite from the A & B Mine (I think) southeast of Payson and hauling the material to Payson. There it is crushed to minus 3", washed, crushed at 3/4" and screen to minus 1/4" and jigged. The jig concentrate ~~as~~ shipped to Texas for further treatment. In Texas the product is divided into a high grade fraction for the paint industry and a low grade fraction for drilling mud.

NJN WR 12/31/82: Tommy Robins of CSC Oilfield Service, Bakersfield, California, phone 805-393-3445 visited. He has need for a supplemental barite supply. To fill that need he would like to acquire a developed or at least a blocked out barite deposit of drilling mud grade. He was provided with the name of the owners of the A & B Claims, Gila County and Coastal and Western Mining.

KAP WR 10/82: Herb Nordmeyer of Coastal and Western Minerals reported they have shut down their barite mining operation at the A & B mine (Top Hat Mine file) Gila County and mineral jig beneficiation plant at Payson. Information was provided for a separate report and sketch. He feels that under different world economic conditions, more barite could be mined from additional lenses on the vein system. They want to sell their interest in the deposit.

KAP WR 7/25/86: Don Packard, 3785 Butler Avenue, Kingman, Arizona 86401, phone 757-2445, requested information on barite markets. He owns the Top Hat or A & B Mine, Gila County and is considering operating it himself.

TOP HAT GROUP

GILA COUNTY

KAP WR 9/19/86: Don Packard, Kingman called about using barite from his A & B Group (Top Hat - file) Gila County for ship ballast. Call was prompted by a newspaper story mentioning the use of copper smelter slag for ship ballast.

KAP WR 11/7/86: Don Packard, (c) owner of the A & B Claims (Top Hat - file) Gila County was in and explained that he had to relocate the claim group on his barite occurrence. He went on to say that the only activity on the claims since Southwestern Texas Aggregate pulled out has been assessment work. Provided him with the most current list of possible barite buyers from EMJ's International Directory of Mining.

DEPARTMENT OF MINERAL RESOURCES

STATE OF ARIZONA

FIELD ENGINEERS REPORT

Mine Top Hat Mine

Date February 3, 1960

District Spring Valley Dist., Gila County

Engineer Lewis A. Smith

Subject:

Bob Grimes, a part owner along with the Massingills, stated that work on the Top Hat (barite) would possibly be resumed as soon as Tonto Creek gets down so as to allow crossing. At present the creek is high. This ^{interested} party is affiliated with the A.T.L. Oil Co., Kansas, who had previously drilled the lode and it is not yet known whether he is going alone or in behalf of the company. Bob Grimes stated that the road up Gun Creek would have to be improved before a large tonnage can be extracted. The haul to Mesa via Tonto Basin is about 95 miles from Chalk Mountain, 26 of which is dirt road. The Tonto Creek crossings are generally poor, and sometimes during high water, are inaccessible.

