



CONTACT INFORMATION

Mining Records Curator
Arizona Geological Survey
1520 West Adams St.
Phoenix, AZ 85007
602-771-1601
<http://www.azgs.az.gov>
inquiries@azgs.az.gov

The following file is part of the

Arizona Department of Mines and Mineral Resources Mining Collection

ACCESS STATEMENT

These digitized collections are accessible for purposes of education and research. We have indicated what we know about copyright and rights of privacy, publicity, or trademark. Due to the nature of archival collections, we are not always able to identify this information. We are eager to hear from any rights owners, so that we may obtain accurate information. Upon request, we will remove material from public view while we address a rights issue.

CONSTRAINTS STATEMENT

The Arizona Geological Survey does not claim to control all rights for all materials in its collection. These rights include, but are not limited to: copyright, privacy rights, and cultural protection rights. The User hereby assumes all responsibility for obtaining any rights to use the material in excess of "fair use."

The Survey makes no intellectual property claims to the products created by individual authors in the manuscript collections, except when the author deeded those rights to the Survey or when those authors were employed by the State of Arizona and created intellectual products as a function of their official duties. The Survey does maintain property rights to the physical and digital representations of the works.

QUALITY STATEMENT

The Arizona Geological Survey is not responsible for the accuracy of the records, information, or opinions that may be contained in the files. The Survey collects, catalogs, and archives data on mineral properties regardless of its views of the veracity or accuracy of those data.

PRINTED: 08/16/2002

ARIZONA DEPARTMENT OF MINES AND MINERAL RESOURCES AZMILS DATA

PRIMARY NAME: SUE MINE

ALTERNATE NAMES:

GILA COUNTY MILS NUMBER: 172C

LOCATION: TOWNSHIP 1 N RANGE 15.5E SECTION 14 QUARTER NW
LATITUDE: N 33DEG 26MIN 00SEC LONGITUDE: W 110DEG 45MIN 10SEC
TOPO MAP NAME: GLOBE - 7.5 MIN

CURRENT STATUS: PAST PRODUCER

COMMODITY:
MANGANESE
LEAD
ZINC
COPPER

BIBLIOGRAPHY:
ADMMR SUE MINE FILE

06/13/86

ARIZONA DEPARTMENT OF MINES AND MINERAL RESOURCES FILE DATA

PRIMARY NAME: SUE MINE

ALTERNATE NAMES:

GILA COUNTY MILS NUMBER: 172C

LOCATION: TOWNSHIP 1 N RANGE 15.5E SECTION 14 QUARTER NW
LATITUDE: N 33DEG 26MIN 00SEC LONGITUDE: W 110DEG 45MIN 10SEC
TOPO MAP NAME: GLOBE - 7.5 MIN

CURRENT STATUS: PAST PRODUCER

COMMODITY:

MANGANESE
LEAD
ZINC
STONE DIMENSION

BIBLIOGRAPHY:

ADMMR SUE MINE FILE

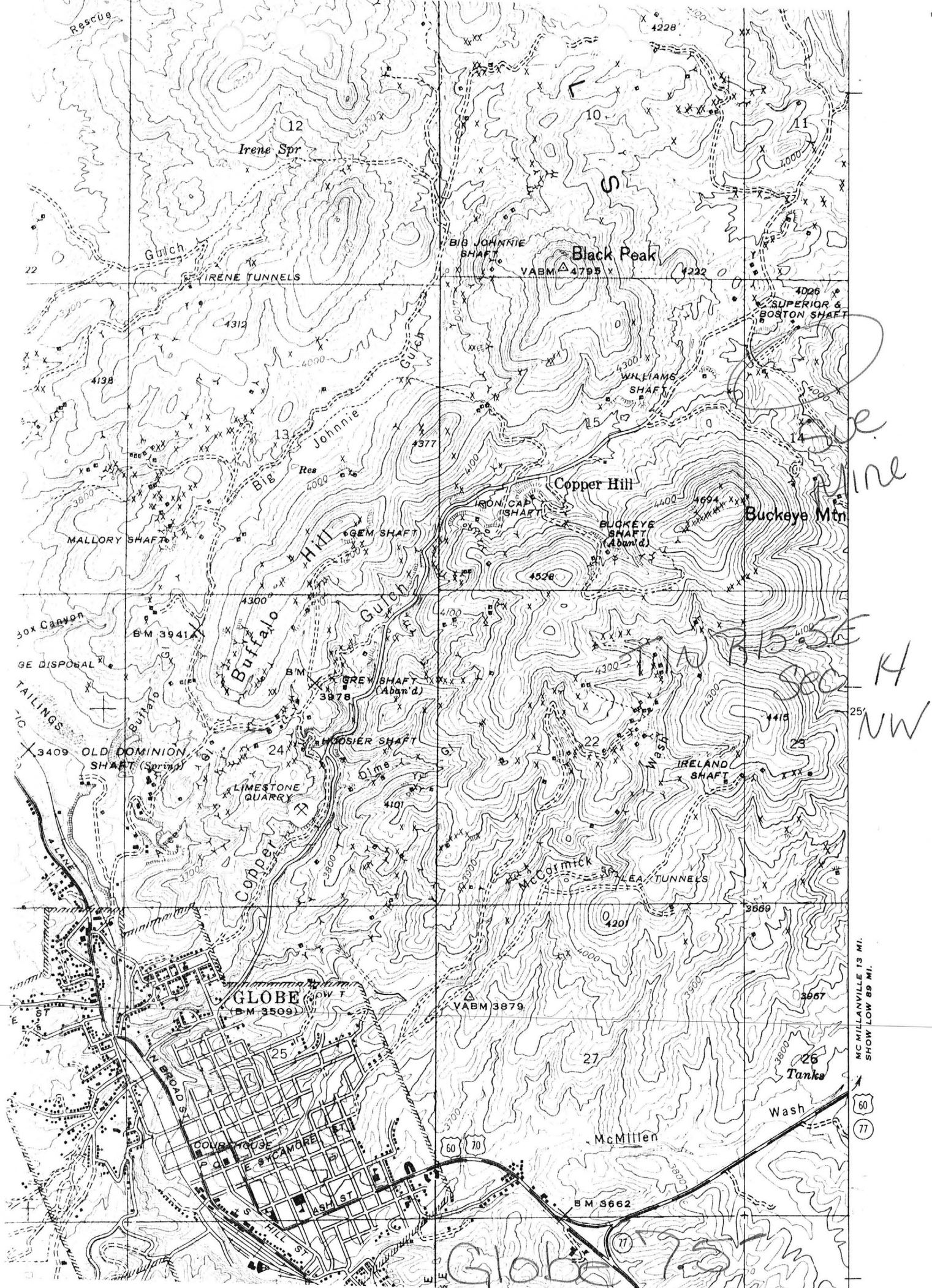

McMILLANVILLE 13 MI.
SHOW LOW 89 MI.

60
77

DEPARTMENT OF MINERAL RESOURCES
STATE OF ARIZONA
FIELD ENGINEERS REPORT

Mine Sue Mine (on old Superior-Boston property) Date April 28, 1954

District Globe Mining District--- Gila Co. Engineer Axel L. Johnson

Subject: Field Engineers Report --- -Personal Visit & Information from H. C. Smith.

Location About 4 miles NE of Globe. On old Superior-Boston property.

Number of Claims 8 patented claims

Owners Copper Hill Mining Co. ----L. O. Goodman, Globe, Ariz.

Lessee and Operator H. C. Smith, Box 347, Globe, Ariz., and
R. A. Wright, 614 Heard Bldg., Phoenix, Ariz.
d.b.a. Smith-Wright Manganese

Principal Minerals Manganese ore.

Number of Men Employed 2 to 4 men

Production Rate Very variable, depending on conditions.
Shipped first shipment of 50 tons to Deming yesterday, after having operated the property for 6 weeks (since March 15). Have also done considerable exploration and development during this time.

Geology Manganese veins in limestone on ~~at~~ dip of 45 to 60 degrees. Width of veins from 2 to 4 ft.

Ore Values Average assay values reported by Mr. Smith, viz: Manganese ---26 %; Iron ----8 %; Copper ---- 0.08 %; Pb & Zn 2 to 3 % (2 combined). Some concern was expressed by Mr. Smith in regard to the high Copper, Lead, and Zinc values. He believed, however, that he will be able to keep those contents down enough to make the ore acceptable to the Deming depot.

Ore in Sight Ore in sight is confined to ore showings in the 3 workings opened up to date. Total length 40 ft.----width 3 ft. ----depth unknown.

Marketing Facilities Ore will be hauled in trucks to railroad at Globe, then shipped by rail to Deming depot.

Present Mine Workings

- (1) 1 open cut -----20 ft. long, 6 ft. wide and 8 ft. deep in side of hill following ore vein. Cut is on a 45 degree dip. Ore vein about 4 ft. thick.
- (2) 1 adit -----8 ft. long driven into the hill in the ore vein. (5' x 6')
- (3) 1 open cut ----- 12 ft. in length, 4 ft. wide and 8 ft. deep. Cut made in the ore vein, dipping about 60 degrees.

Present Operations Stopping ore in open cut ~~(2)~~ (1) described above. Intend to resume operations in open cut (3) described above. Plan also to continue adit (2) described above. Ore is now transported to place where it can be loaded on a truck by means of wheelbarrows and a tin slide on the slope of the steep hill. Operators plan on installing mine track, ore cars, and an ore bin as soon as practicable.

Terms of Lease 10 % straight royalty on ore receipts from the Deming depot.

COPPER HILL MINING COMPANY (OWNER)

4-28-54

L. O. GOODMAN,
Globe, Arizona

MINE- SUE MINE, Globe Mining Dist., Gila County - about 4 Mi. NE
of Globe.

Lessee and Operator - H. C. Smith, Box 347, Globe, Ariz. and
R. A. Wright, 614 Heard Bldg., Phoenix, Ariz.
d/b/a SMITH-WRIGHT MANGANESE