



CONTACT INFORMATION

Mining Records Curator
Arizona Geological Survey
1520 West Adams St.
Phoenix, AZ 85007
602-771-1601
<http://www.azgs.az.gov>
inquiries@azgs.az.gov

The following file is part of the

Arizona Department of Mines and Mineral Resources Mining Collection

ACCESS STATEMENT

These digitized collections are accessible for purposes of education and research. We have indicated what we know about copyright and rights of privacy, publicity, or trademark. Due to the nature of archival collections, we are not always able to identify this information. We are eager to hear from any rights owners, so that we may obtain accurate information. Upon request, we will remove material from public view while we address a rights issue.

CONSTRAINTS STATEMENT

The Arizona Geological Survey does not claim to control all rights for all materials in its collection. These rights include, but are not limited to: copyright, privacy rights, and cultural protection rights. The User hereby assumes all responsibility for obtaining any rights to use the material in excess of "fair use."

The Survey makes no intellectual property claims to the products created by individual authors in the manuscript collections, except when the author deeded those rights to the Survey or when those authors were employed by the State of Arizona and created intellectual products as a function of their official duties. The Survey does maintain property rights to the physical and digital representations of the works.

QUALITY STATEMENT

The Arizona Geological Survey is not responsible for the accuracy of the records, information, or opinions that may be contained in the files. The Survey collects, catalogs, and archives data on mineral properties regardless of its views of the veracity or accuracy of those data.

PRINTED: 08/16/2002

ARIZONA DEPARTMENT OF MINES AND MINERAL RESOURCES AZMILS DATA

PRIMARY NAME: STANDARD TUNGSTEN MINE

ALTERNATE NAMES:

HEAD CENTER
BLACK PRINCE
JOHNNY BOY

COCHISE COUNTY MILS NUMBER: 106

LOCATION: TOWNSHIP 18 S RANGE 23 E SECTION 24 QUARTER NW
LATITUDE: N 31DEG 51MIN 46SEC LONGITUDE: W 109DEG 57MIN 22SEC
TOPO MAP NAME: BLACK DIAMOND PEAK - 7.5 MIN

CURRENT STATUS: PAST PRODUCER

COMMODITY:

TUNGSTEN
LEAD SULFIDE
SILVER
COPPER SULFIDE
BARIUM BARITE

BIBLIOGRAPHY:

KEITH, S.B., 1973, AZBM BULL. 187, P. 69
ADMMR STANDARD TUNGSTEN FILE
USBM RI 5650, P. 57-59
USBM RI 5651, P. 10 & 11
AZBM BULL. 180, P. 314

STANDARD TUNGSTEN

REFERENCES

COCHISE COUNTY

USBM RI 5650, p. 57 - 59

USBM RI 5651, p. 10 and 11

ABM Bul. 187, p. 69

MILS Sheet sequence number 0040030217

ABM Bul 180 p. 314

AKA: Black Prince
HEAD Center
Johnny Box

T185 R 23E Sec 24 NW

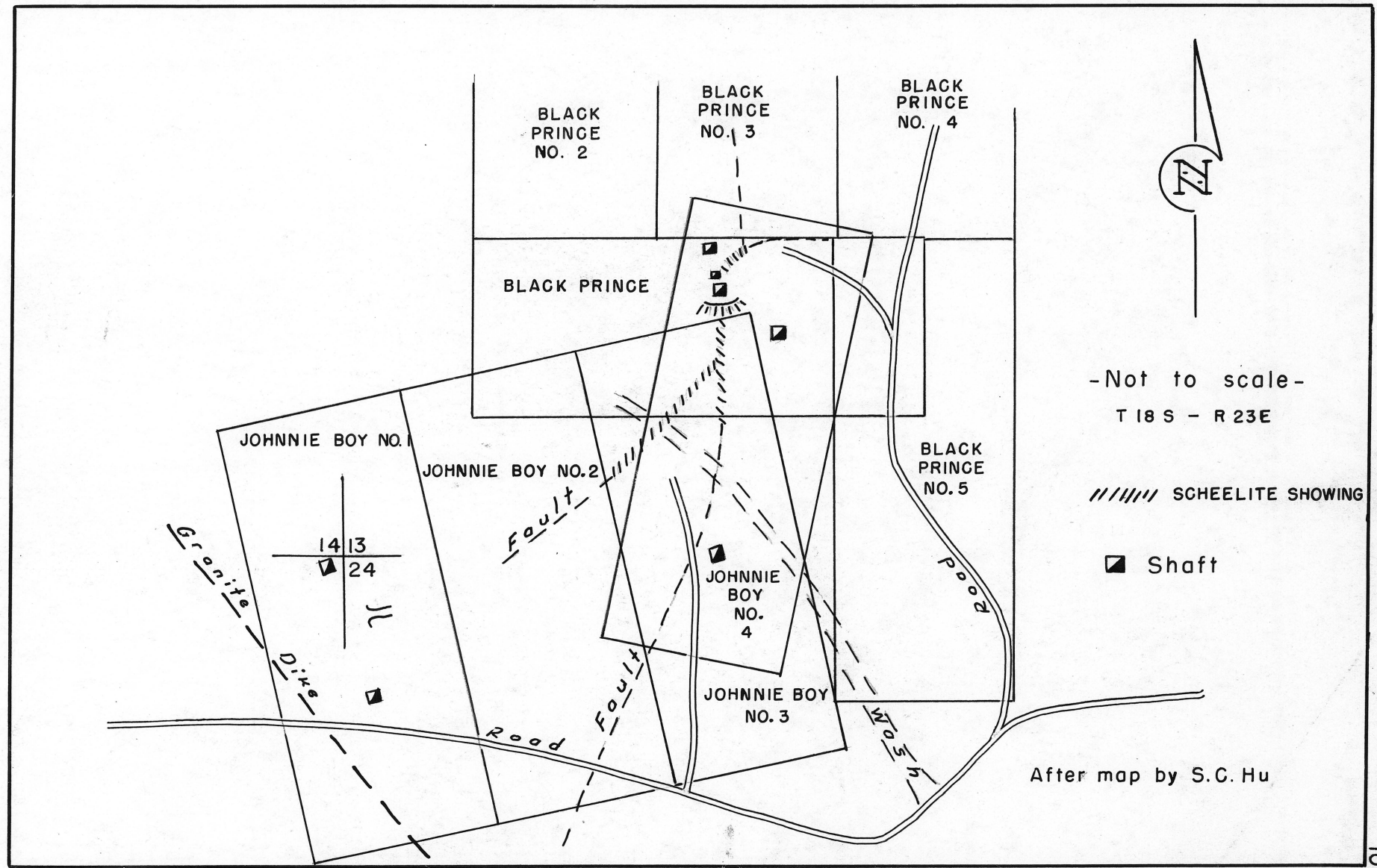

Fig. 21- Sketch of Black Prince and Johnnie Boy Claims, Dragoon Mts. Ariz.

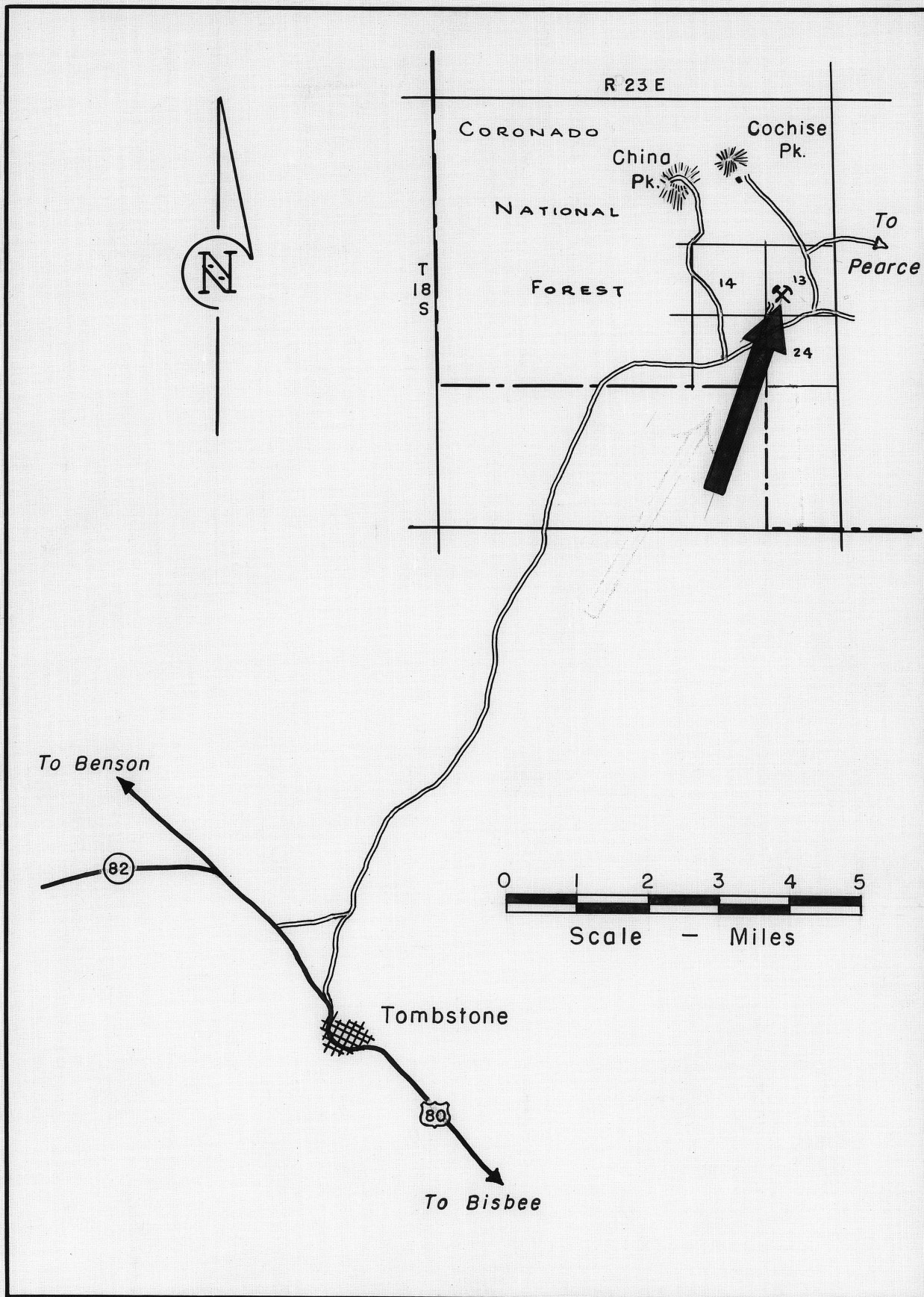

Fig.20-Location map of Black Prince and Johnny Boy Claims
Cochise County, Arizona

STANDARD TUNGSTEN

COCHISE COUNTY

MG WR 5/6/84: Drove through the Middle Pass Mining District, Cochise County and visited the Chirstmas, Festerling, Middlemarch and Standard Tungsten mines. There was no sign of activity at any of these mines.

TUCSON, T. RSDAY, MAY 15, 1980



ts
n

The Arizona Daily Star

RE
M
DEPT. N

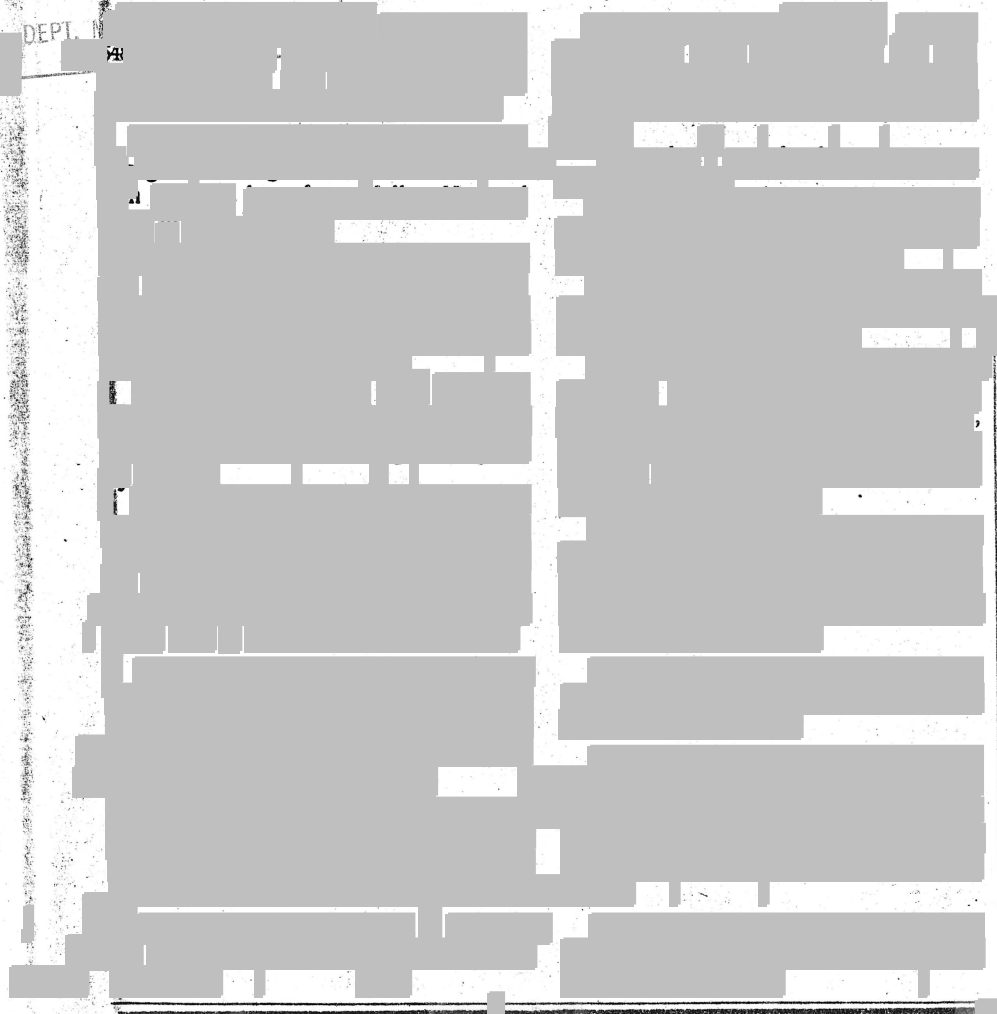

ARIZONA DEPARTMENT OF MINERAL RESOURCES
Mineral Building, Fairgrounds
Phoenix, Arizona

1. Information from: Personal visit
Address: _____
2. Mine: Standard Tungsten (Known as) 3. No. of Claims - Patented _____
Unpatented several
4. Location: SW of Middlemarch pass, Dragoon Mts.
5. Sec 13 Tp 18S Range 23E 6. Mining District Dragoon
7. Owner: Great Western Associates
8. Address: 3200 East Linden Tucson 85716--Box 570 Grant Central Station NY 10017
9. Operating Co.: Same
10. Address: _____
11. President: _____ 12. Gen. Mgr. J. Brooks Davis
13. Principal Metals: Tungsten 14. No. Employed: 0
15. Mill, Type & Capacity: _____
16. Present Operations: (a) Down (b) Assessment work (c) Exploration
(d) Production (e) Rate _____tpd.
17. New Work Planned: Not informed. Found evidence that locations had been made
and some bull dozer work done.
18. Miscl. Notes: _____

Date: 5-6-70

[Signature]
(Signature)

(Field Engineer)