



CONTACT INFORMATION

Mining Records Curator
Arizona Geological Survey
1520 West Adams St.
Phoenix, AZ 85007
602-771-1601
<http://www.azgs.az.gov>
inquiries@azgs.az.gov

The following file is part of the

Arizona Department of Mines and Mineral Resources Mining Collection

ACCESS STATEMENT

These digitized collections are accessible for purposes of education and research. We have indicated what we know about copyright and rights of privacy, publicity, or trademark. Due to the nature of archival collections, we are not always able to identify this information. We are eager to hear from any rights owners, so that we may obtain accurate information. Upon request, we will remove material from public view while we address a rights issue.

CONSTRAINTS STATEMENT

The Arizona Geological Survey does not claim to control all rights for all materials in its collection. These rights include, but are not limited to: copyright, privacy rights, and cultural protection rights. The User hereby assumes all responsibility for obtaining any rights to use the material in excess of "fair use."

The Survey makes no intellectual property claims to the products created by individual authors in the manuscript collections, except when the author deeded those rights to the Survey or when those authors were employed by the State of Arizona and created intellectual products as a function of their official duties. The Survey does maintain property rights to the physical and digital representations of the works.

QUALITY STATEMENT

The Arizona Geological Survey is not responsible for the accuracy of the records, information, or opinions that may be contained in the files. The Survey collects, catalogs, and archives data on mineral properties regardless of its views of the veracity or accuracy of those data.

07/01/97

ARIZONA DEPARTMENT OF MINES AND MINERAL RESOURCES FILE DATA

PRIMARY NAME: SONOMA

ALTERNATE NAMES:

SANTA CRUZ COUNTY MILS NUMBER: 237

LOCATION: TOWNSHIP 23 S RANGE 11 E SECTION 20 QUARTER NE
LATITUDE: N 31DEG 24MIN 53SEC LONGITUDE: W 111DEG 14MIN 12SEC
TOPO MAP NAME: RUBY - 15 MIN

CURRENT STATUS: UNKNOWN

COMMODITY:

SILVER
LEAD
ZINC
COPPER SEE BIBLIO

BIBLIOGRAPHY:

ADMMR SONOMA FILE

SONOMA

SANTA CRUZ COUNTY
ORO BLANCO DISTRICT
T23S R11E Sec 20 NE

MG WR 11/26/79: Mr. Ralph Griffin, P.O. Box 66, Arivaca, Arizona 85601, owns the Sonoma patented claim in Santa Cruz County.

GWI WR 11/13/80: Ralph Griffin, owner of Sonoma Mine, called for information on shipping ore.

KAP WR 12/23/83: Ralph Griffen, Ph: 883-4799 reported he is continuing to work and live on his Sonoma patented mine. He is concerned about being able to produce marketable ores or concentrates from his complex silver=lead-zinc-copper prospect. A number of possible processing methods were discussed. However, the necessity of proving an adequate quantity of ore in the deposit was the first priority followed by determining the metallurgical mineralogy. Maps of the location of the property have been provided.

Sec. 21

of T.235, R.11E.
ORO BLANCO DIST
SANTA CRUZ COUNTY

SONOMA
756 PAT

Sec. 20

CALIFORNIA
754 PAT

LAURA
3048 PAT

U.S.M.M.
5

EXTENSION
3042

OLD ORO BLANCO
3042

PARALLEL
3042

JENNIE C.
3936

MONSTER
3042

TWO REPUBLIC
3047 PAT

MONARCH
3053

OLD CASE
4198

CANADA
3042

TRES AMIGOS
3042

SAN JUAN
3042

SORREL TOP
3042

LOUISE
347PAT.

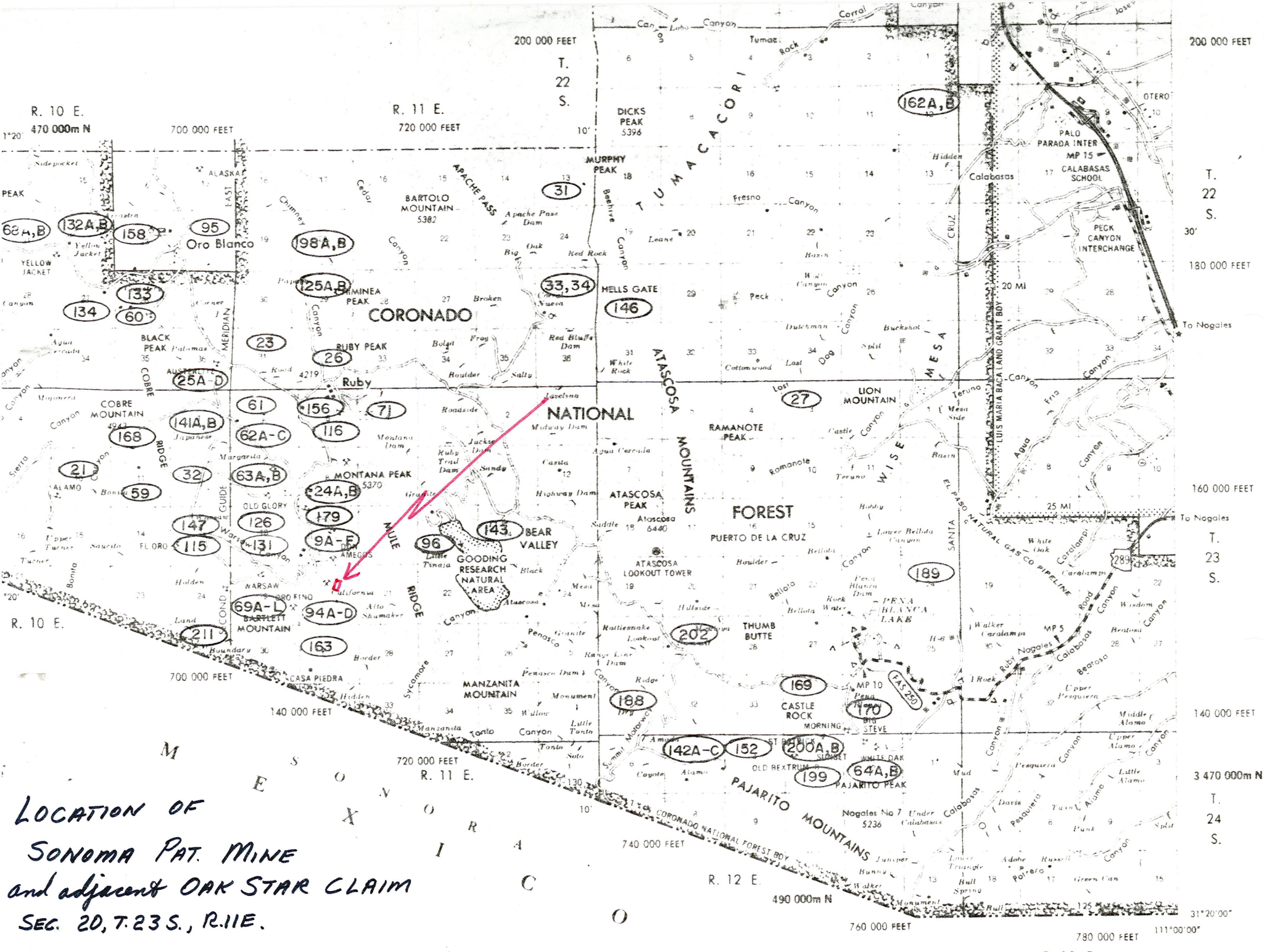

LOCATION OF
 SONOMA PAT. MINE
 and adjacent OAK STAR CLAIM
 SEC. 20, T. 23 S., R. 11 E.

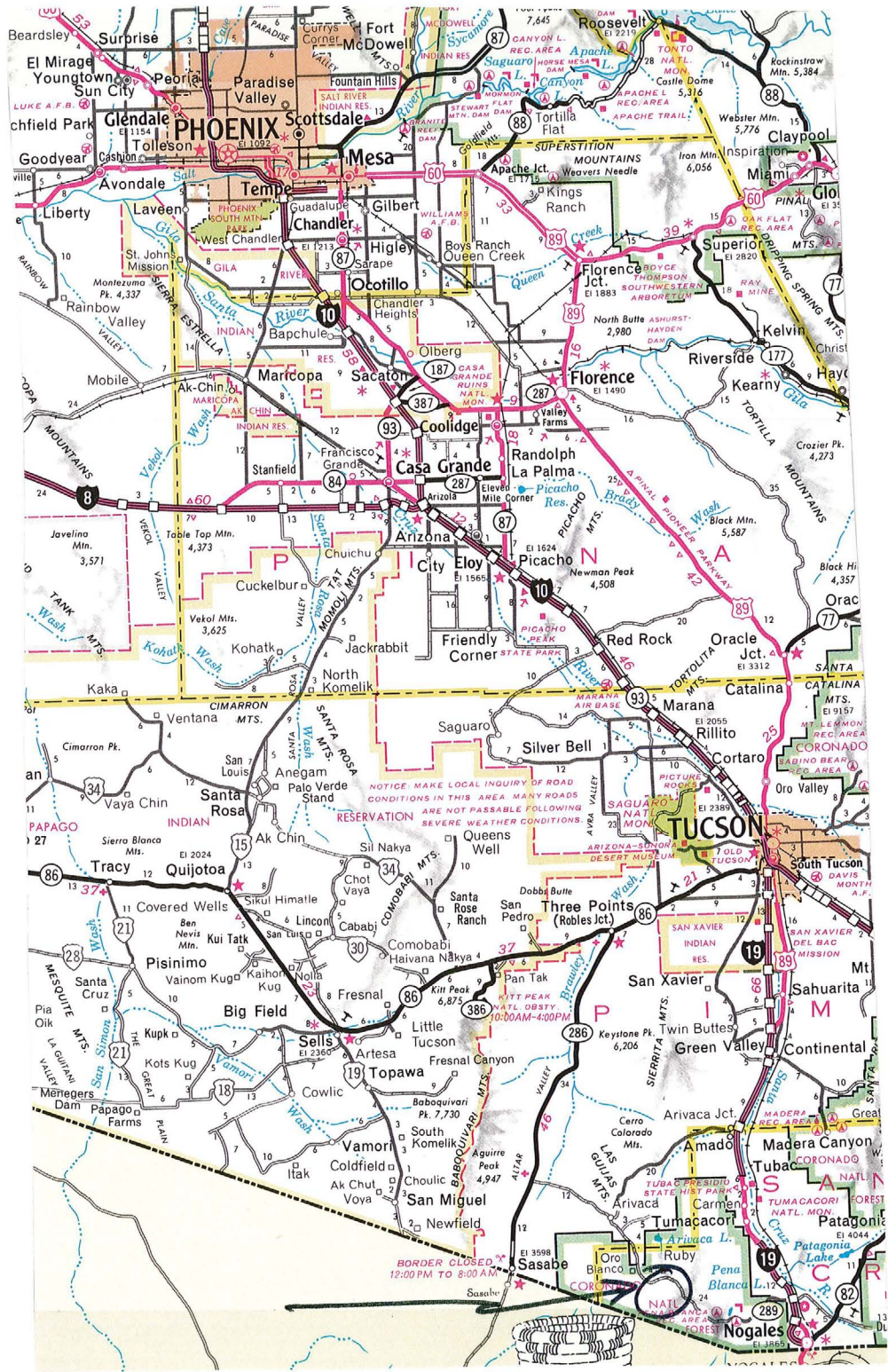

Regional Location of the SONOMA Patented Mine, Santa Cruz County, Ariz.