



CONTACT INFORMATION

Mining Records Curator
Arizona Geological Survey
1520 West Adams St.
Phoenix, AZ 85007
602-771-1601
<http://www.azgs.az.gov>
inquiries@azgs.az.gov

The following file is part of the

Arizona Department of Mines and Mineral Resources Mining Collection

ACCESS STATEMENT

These digitized collections are accessible for purposes of education and research. We have indicated what we know about copyright and rights of privacy, publicity, or trademark. Due to the nature of archival collections, we are not always able to identify this information. We are eager to hear from any rights owners, so that we may obtain accurate information. Upon request, we will remove material from public view while we address a rights issue.

CONSTRAINTS STATEMENT

The Arizona Geological Survey does not claim to control all rights for all materials in its collection. These rights include, but are not limited to: copyright, privacy rights, and cultural protection rights. The User hereby assumes all responsibility for obtaining any rights to use the material in excess of "fair use."

The Survey makes no intellectual property claims to the products created by individual authors in the manuscript collections, except when the author deeded those rights to the Survey or when those authors were employed by the State of Arizona and created intellectual products as a function of their official duties. The Survey does maintain property rights to the physical and digital representations of the works.

QUALITY STATEMENT

The Arizona Geological Survey is not responsible for the accuracy of the records, information, or opinions that may be contained in the files. The Survey collects, catalogs, and archives data on mineral properties regardless of its views of the veracity or accuracy of those data.

08/14/91

ARIZONA DEPARTMENT OF MINES AND MINERAL RESOURCES FILE DATA

PRIMARY NAME: SENATE

ALTERNATE NAMES:

MOUNTAIN VIEW
HOMESTAKE
CONGRESS EXTENSION

YAVAPAI COUNTY MILS NUMBER: 436B

LOCATION: TOWNSHIP 10 N RANGE 6 W SECTION 15 QUARTER S2
LATITUDE: N 34DEG 12MIN 13SEC LONGITUDE: W 112DEG 51MIN 46SEC
TOPO MAP NAME: CONGRESS - 7.5 MIN

CURRENT STATUS: PAST PRODUCER

COMMODITY:

COPPER
SILVER
GOLD

BIBLIOGRAPHY:

USGS CONGRESS QUAD
BLM MINING DISTRICT SHEET 310
ADMMR SENATE FILE
BLM AMC FILE 27414
CLAIMS EXTEND INTO N2N2 SEC. 22

Mrs. Belle Dick wanted me to look over her Au property about $\frac{1}{2}$ mile SW of the old Congress mine; it is known as the Congress Extension. Here the vein about 3 ft. of quartz, strikes N80W & dips 37° N in granite. The collar of a 950 ft. inclined shaft is caved somewhat. About 250 ft. NW of the incline are a couple of shallow digs, now caved, from which it is reported a couple of 2-3 oz. Au samples were taken from a 14" vein striking at an acute angle to the main vein. 200ft. N77^oW of the old incline is an 80 ft. vertical shaft from which it is reported several tons of +40% Cu ore were dug, the vein here strikes E-W and dips $\pm 30^{\circ}$ N. It may be a portion of the main vein, however, it is only about $\frac{1}{2}$ as thick. GW WR 6/2/76

CONGRESS EXTENSION MINE

The Congress Extension mine, about $\frac{1}{2}$ mile west of the Congress mine, is reported to have been operated for about three years during the nineties by T. Carrigan and associates who sank a 950-foot inclined shaft and opened nine levels, each of which extends for approximately 100 feet east and west of the shaft. The Herskowitz family obtained the property in 1910 and, since about 1923, has made yearly shipments of 35 to 80 tons of ore that contained from \$8.50 to \$17.50 worth of gold per ton.

When visited in May 1934, the shaft contained water to the 140-ft. level. Where seen in the upper workings, the vein strikes westward, dips 35 to 40 N., and occurs in granite. A stope on the first level east of the shaft indicates that the ore there occurred as a flat lens about 3 feet thick. The vein material consists mainly of massive, locally shattered white quartz. Specimens of this quartz seen on the dump contain irregular bunches and disseminations of pyrite and a little chalcopyrite. The oxidized vein material contains abundant limonite and some copper stain.

As the surface exposures are terminated on the east by alluvium the relations of this vein to the Congress and Niagara veins are unknown.

(Arizona Bureau of Mines Bulletin No. 137), p 73)

CHAPTER III--MOHAVE COUNTY

GENERAL GEOGRAPHY

Mohave County, as shown on Figure 3, comprises an irregular area about 190 miles long from north to south by 85 miles wide. Its north-northeastern portion is within the deeply dissected Plateau Province and rises to an altitude of more than 6,000 feet. The rest of the county consists of north-northwestward-trending fault-block mountain ranges and valleys. The largest of these ranges is the Black Mountains, near the Colorado River. This range is nearly 100 miles long by a maximum of 20 miles wide and attains an altitude of more than 5,000 feet.

The region is drained by the Colorado River, as indicated on Figure 3.

Oral communication from H. Herskowitz

DEPARTMENT OF MINERAL RESOURCES
STATE OF ARIZONA
FIELD ENGINEERS REPORT

Mine Senate Group

Date December 14, 1944

District Martinez

Engineer A. C. Nebeker

Subject: Examination of Senate Mine

This mine is located 3 miles northwest of Congress Junction, and about 1/2 mile west of the old Congress mine, in the district known as the Martinez Mining District.

The old name of this property was known as the Congress Extension Mining Company and the owner is Harry Herskowitz of Congress Junction.

The property consists of seven mining claims.

This property has been developed by an incline shaft several hundred feet deep with drifts and crosscuts out from different levels for several hundred feet. The water now stands at about the 85 foot level, and on this level and above old stopes can be seen from which considerable gold ore has been mined from a rather flat quartz vein having thickness up to 6 feet. The ore was reported to have netted at the smelter \$21.00 per ton.

The new work being done now is through an incline shaft which is about 45 feet deep and a drift run out from the bottom on the vein for about 40 feet. The vein is in a fractured zone with a width of one foot to four feet between quart-granite walls. The vein consists of bunches of copper ore, some very high grade, in a gangue of mica-hornblende decomposed green stone.

Assay returns shown me of samples taken from the vein ran: Copper 9.16%, silver 3.0 ozs., gold .05 ozs., insol. 48.4%, S. 1.45.

The vein is steeper than the general run of veins in this district, it having a dip of 70 degrees N.W. and strike of N 20 E.

The equipment on the property is a very small mining plant capable of handling one small drill and the hoist is good for about 100 feet depth with a 600 lbs. bucket.

The property is ideally located as to transportation, markets and climate.

The property is not apt to produce a fair tonnage of copper ores, although the present showing justifies more development ahead on the strike and I would also recommend sinking another 50 feet to feel it out on the dip.

If and when gold is given the Green Light, and a better price is paid for gold, I would recommend that the quartz vein in the old shaft be given serious attention, as it is possible to open up more gold stopes which will then be profitable.

/S/ A. C. Nebeker

DEPARTMENT OF MINERAL RESOURCES
STATE OF ARIZONA
FIELD ENGINEERS REPORT

MS-25

Mine SENATE

Date October 10, 1939

District Martinez

Engineer Carl G. Barth, Jr.

Subject:

Location: At old Congress.

Owner: Herschkowitz and Sons, Congress, Arizona.

Operator: Chloriding by the sons.

Principal Metals: Gold

Men Employed: 3 to 4 work together.

Production Rate: One carload monthly (approx.).

Power - Amt. & Type: Gasoline Hoist and Portable Compressor.

Number Claims, Title, Etc.: Four (4).

Mine Workings - Amt. & Condition: 900 foot shaft filled with water to 200 level.
Amount of lateral work unknown.

Geology & Mineralization: Quartz vein in Granite. Galena and Pyrite in primary zone.
Strikes E-W Dip 35° - 40° N.

Road Conditions, Route: 4 miles well kept county road to railroad.

Brief History: Operations during day of Old Congress Mine. Known as Congress Extension when operated in early nineties by T. Carrigan & associates.

If property for sale, price, terms and address to negotiate: Property for sale with reasonable terms to substantial parties.

(Signed) Carl G. Barth, Jr.

DEPARTMENT OF MINERAL RESOURCES

**REPORT TO OPA ON
ACTIVE MINING PROJECT**

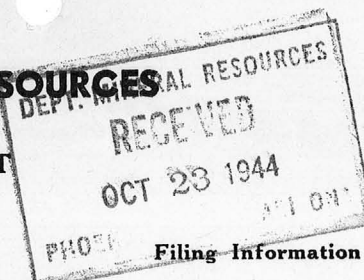

CPM

Date Oct 5 - 1944

Name of Mine Senate

Owner or Operator Oscar Deck

Address Box 113 Congress Ariz

Mine Location Congress

File System Sumberland

File No. nd

This chart to be used for gallons of gasoline required per month.

PRESENT OPERATIONS: (check X)

Production.....; Development ; Financing.....; Sale of mine.....;

Experimental (sampling).....; Owner's occasional trip.....;

Other (specify).....

PRODUCTION: Past and Future.

Tons

Approx. tons last 3 months

Approx. present rate per 3 months

Anticipated rate next 3 months

If in distant future check (X) here

EQUIPMENT OPERATED:

Type	Quantity or Horse Power	Miles or Hours Per Month	Gallons Required Per Month
Personal Cars
Light or Service Trucks
Ore Hauling Trucks
Compressors	<u>20</u>	<u>90</u>	<u>90</u>
Other Mine or Mill Eqpt.

PRODUCT PRODUCED OR CONTEMPLATED: Name metals or minerals.

Copper

REMARKS:

Applicant is asking for one month's supply for compressor used on property. I approve request.

ARIZONA DEPARTMENT OF MINERAL RESOURCES

By Altheber
Field Eng

DEPARTMENT OF MINERAL RESOURCES
STATE OF ARIZONA
OWNERS MINE REPORT

Date October 10, 1939

1. Mine **SENATE**
2. Mining District & County **Martinez**
3. Former name **Same**
4. Location **At old Congress**
5. Owner **Herschkowitz and Sons**
6. Address (Owner) **Congress, Arizona**
7. Operator **Chloriding by the Sons**
8. Address (Operator)
9. President
10. Gen. Mgr.
11. Mine Supt.
12. Mill Supt.
13. Principal Metals **Gold**
14. Men Employed **3 to 4 work together**
15. Production Rate **One carload monthly (Approx.)**
16. Mill: Type & Cap.
17. Power: Amt. & Type **Gasoline hoist and portable compressor**
18. Operations: Present

19. Operations Planned

SENATE

Au

Yavapai

13 - 7

T 10 N, R 6 W

Herschkowitz & Sons, Congress

'39

20. Number Claims, Title, etc. **Four (4)**

21. Description: Topography & Geography

22. Mine Workings: Amt. & Condition **900 foot shaft filled with water to 200 level. Amount of lateral work unknown**

23. Geology & Mineralization Quartz vein in Granite, Galena and Pyrite in primary zone.

Strikes E-W Dip 35°-40° N

24. Ore: Positive & Probable, Ore Dumps, Tailings

24-A Vein Width, Length, Value, etc.

25. Mine, Mill Equipment & Flow Sheet

26. Road Conditions, Route 4 miles well kept county road to railroad

27. Water Supply

28. Brief History Operations during day of Old Congress Mine.
Known as Congress Extension when operated in early nineties by
T. Carrigan & Associates.

29. Special Problems, Reports Filed

30. Remarks

31. If property for sale: Price, terms and address to negotiate.

Property for sale with reasonable terms to substantial parties.

32. Signed.....CARL G. BARTH, JR.

33. Use additional sheets if necessary.

DEPARTMENT OF MINERAL RESOURCES
STATE OF ARIZONA
OWNERS MINE REPORT

Date October 10, 1939

1. Mine SENATE
2. Mining District & County Martinez
3. Former name Same
4. Location At old Congress
5. Owner Herschkowitz and Sons
6. Address (Owner) Congress, Arizona
7. Operator Chloriding by the Sons
8. Address (Operator)
9. President
10. Gen. Mgr.
11. Mine Supt.
12. Mill Supt.
13. Principal Metals Gold
14. Men Employed 3 to 4 work together
15. Production Rate One carload monthly (Approx.)
16. Mill: Type & Cap.
17. Power: Amt. & Type Gasoline hoist and portable compressor
18. Operations: Present
19. Operations Planned
20. Number Claims, Title, etc. Four (4)
21. Description: Topography & Geography
22. Mine Workings: Amt. & Condition 900 foot shaft filled with water to 200 level. Amount of lareral work unknown

23. Geology & Mineralization Quartz vein in Granite, Galena and Pyrite in primary zone.

Strikes E-W Dip 35°-40° N

24. Ore: Positive & Probable, Ore Dumps, Tailings

24-A Vein Width, Length, Value, etc.

25. Mine, Mill Equipment & Flow Sheet

26. Road Conditions, Route 4 miles well kept county road to railroad

27. Water Supply

28. Brief History Operations during day of Old Congress Mine.
Known as Congress Extension when operated in early nineties by
T. Carrigan & Associates.

29. Special Problems, Reports Filed

30. Remarks

31. If property for sale: Price, terms and address to negotiate.

Property for sale with reasonable terms to substantial parties.

32. Signed.....CARL G. BARTH, JR.

33. Use additional sheets if necessary.

CUSTOM ASSAY OFFICE

Prescott, Arizona.
10-13-32

TO, Mr. Chas. Berg,
Wickenburg, Arizona.

	<u>Gold Value</u>	<u>Silver</u>	<u>Total Value</u>
Sample No 1.	.025 .50	Trace	Coloration caused by iron 0.
" " 2.	.67 13.40	1.5 .45	13.85

H. C. Smoot,
Assayer,

9-15-32

TO, Mr. Chas. Berg,
Wickenburg, Arizona.

Sample No 1.	.30	6.00	0.8	.24	6.24
" " 2.	.29	5.80	0.7	.21	6.01

H. C. Smoot,
Assayer.

AMERICAN SMELTER AND REFINING COMPANY

Messrs. Connery, Woods, & McNelly
Congress, Arizona.

10-14-32

Dear Sirs:

Please find attached an assay certificate giving results on hand sample which you recently sent us. This class of material would return you approximately \$9.00 after freight to El Paso and treatment charges.

yours very truly,

E. R. Marble.

LOT NUMBER	GOLD	SILVER
1668	0.64	21.8

The samples were taken from top to bottom in 2 places in working at about 5 feet apart.

In conclusion i would sat that the Buckie O'neal claim and Ledge shows a lime foot wall and a schist hanging wall. The veins all bein very prominent for a distance of 2000 feet. The average width being from 14 inches to 7 feet. Mary L leads crop very prominent for a distance of 2500 feet showing granite schist hanging wall. Ledge cropings varying in width from 10 inches to $2\frac{1}{2}$ feet. The dip on both ledges showing about 24 degrees with a strike of 80 NE.

Senator vein has a shaft 120 feet in depth. Ledge at surface about 10 inches to about 8' feet at 120'. The hanging wall shows andesite and granite foot wall. 12 inch gouge in porphery foot where vein shows granite hanging and schist foot. Width 6 feet, cropping 400 feet ore shoot on number 4 claim of Senator group crops a distance of 600 feet, the width 7 to 14 ft with a granite hanging porphery foot 12 inch a gough.

Valley view vein crops 3000 feet shows a width of 2 feet to 5 feet. Lime stone hanging wall, and granite foot wall. In my opinion this property has all the earmarks of one of the biggest mines in the prospective stage and with from \$2,500 to \$3,000 expenditure would make a mine bigger than the Congress and many times better than could be done with portable compressor and drills.

Lee F. Holland,

SAMPLE NUMBER 1.

Taken on Buckie Number 1, on open cut. Corner marking the vein on ore shoot. The vein is in a shist hanging wall and a lime foot wall. The vein shows 6' wide, Pitch 22, Strike 80 NE.

Across the creek is a tunnel driven in 250'. One can only go into this tunnel about 100' on account of a bad cave. No samples were taken at this place, however there is good ore showing and it has been told me that the breast is 4' wide and cut sample shows \$12,00. There is another ore shoot. There is three distinct ore shoots showing at this end. The pitch 22, Strike 80 NE.

Sample Number 2.

Taken on upper parallel vein about 30 feet above sample Number 1. This vein is 14" in a shist hanging wall and a Lime foot wall. The ore shoot can be traced or walked on over 1 mile.

Sample Number 3.

Taken on the Mary G. Cropping 14" just doing assessment work. Not completed; excellent showing.

Sample Number 4.

Taken on the lower shaft. This is a 120' inclined shaft. These samples were taken along the two sides at intervals of 5 feet, also in the breast or face with ledge matter in it.

Sample Number 5.

Sample number 5 is about 25 feet above the lower shaft at this place. There is a horse showing and the vein cuts it as clean as a razor blade would. This ore shoot is 6 feet wide and good showing. The Shaft is incline and 50' deep. Excellent showing down about 22 feet. The vein dips 24, strike 80 NE. These ore shoots can be traced and walked on over a mile in good ore.

Sample Number 6.

This was taken on Senator Number 4, average 8' deep showing heavy sulphides. Can be traced and walked on over $\frac{1}{2}$ mile showing good ore. This work is assessment work. The pitch of the vein is 24 and the strike is 80 NE.

ATKINS & MCRAE, ASSAYERS,
CHEMISTS & METALLURGISTS.

Suite 518-19 Jewelers Exchange Bldg.,
747 South Hill Street,
Los Angeles, Calif.

November 13, 1931

Office Number	OWNERS MARK	GOLD PER TON		SILVER
62607	# 1 Condor 4 feet X 3,000 feet on dyke	0.10	2.00	
62608	" 1 Bird Eye 2 ft. Hanging wall, 3 ft. Foot wall	.16	3.20	
62609	" 2 Bird Eye Crossing 4 feet	.60	12.00	1.8
62610	" 3 Bird Eye 3½ feet	3.14	62.80	
62611	" 4 Bird Eye 6" in High Grade	2.00	40.00	6.6

W. S. McRae,
Assayer

CUSTOM ASSAY OFFICE

PRESCOTT, ARIZONA
8-25-32

TO, Mr. John Connery,
Congress, Arizona.

SAMPLE	gold	value	silver	total value
	1.18	23.60	2.2	.66 24.26

H. C. Smoot,
Assayer.

10-1-32

TO, Mr. Chas Berg,
Wickenburg, Arizona.

.44	8.80	2.8	.84	9.64
-----	------	-----	-----	------

H. C. Smoot,
Assayer.

9-15-32

TO, Mr. Chas Berg,
Wickenburg, Arizona.

.50	6.00	0.8	.24	6.24
.29	5.80	0.7	.21	6.01

H. C. Smoot,
Assayer.

The samples were taken from top to bottom in 3 places in working at about 5 feet apart.

In conclusion I would say that the Buckie O'neal claim and Ledge shows a lime foot wall and a schist hanging wall. The veins all bein very prominent for a distance of 2000 feet. The average width being from 14 inches to 7 feet. Mary L leads crop very prominent for a distance of 2500 feet showing granite schist hanging wall. Ledge cropings varying in width from 10 inches to 2½ feet. The dip on both ledges showing about 34 degrees with a strike of 80 NE.

Senator vein has a shaft 120 feet in depth. Ledge at surface about 10 inches to about 8 feet at 120'. The hanging wall shows andesite and granite foot wall. 12 inch gouge in porphery foot where vein shows granite hanging and schist foot. Width 6 feet, cropping 400 feet ore shoot on number 4 claim of Senator group crops a distance of 600 feet, the width 7 to 14 ft with a granite hanging porphery foot 12 inch gouge.

Valley vein crops 5000 feet shows a width of 2 feet to 5 feet. Lime stone hanging wall, and granite foot wall. In my opinion this property has all the earmarks of one of the biggest mines in the prospective stage and with from \$2,500 to \$3,000 expenditure would make a mine bigger than the Congress and many times better than could be done with portable compressor and drills.

-COPY-

CUSTOM ASSAY OFFICE
ASSAY CERTIFICATE

For Operators and Developers,

Prescott Arizona, 8-28-34

Gold per ton
ounces troy value 1.06Oz. \$ 37.10 silver 2.5 Oz. 1.48 Total \$ 39.58

(Signed) H.C. Smoot



A-180-20

SENHTE

C-1950

Robert Rae

710 North Central Avenue
May 15th.1945

Dr. Thomas B. Chapman, Director,
Arizona Bureau of Mines,
University of Arizona,
Tucson, Arizona.

RECEIVED
MAY 16 1945
ARIZONA

Dear Doctor Chapman,

I have a copper property -or prospect- in an accepted gold country. The Department of Mineral Resources was impressed with the showing and suggested an examination, at their expense, by a prominent geologist.

Unfortunately three of the men they had in mind could not be secured and that threw the matter right back in my lap.

Chuck Dunning, the director of the Department, suggests that I write to you and ask that Eldred Wilson be sent to make an examination for if anything is developed through Mr. Wilson's examination, it will rebound to the benefit of the State.

The examination can be made in a short time, the prospect is in the Congress area of the Martinez Mining District and if Mr. Wilson would notify me when he would be here and pick me up I will be glad to make the trip with him.

Appreciating greatly your co-operation in the matter,

Yours sincerely,

Robert Rae

c/o to Chuck Dunning Director,
Dept. Of Mineral Resources,
Phoenix, Arizona.

WARD ADMISSION RECORD

No.

WARD Date Hour

Name Address

Sex Age Height, ft. in. Weight

Color Temp. Pulse Vaccinated

General Nutrition Cleanliness

Homicidal Suicidal Excited Depressed Epileptic

Injuries and Physical Defects

Clothing, articles and condition:

Personal effects:

.....

.....

.....

.....

.....

.....

.....

.....

.....

.....

.....

.....

.....

.....

.....

.....

.....

.....

.....

.....

.....

Money \$

Signed, Att.

Comments:

.....

Approved:, M. D.

U.S. GOVERNMENT PRINTING OFFICE: 1964 O 348-000

Senate
File
Book
Rea
May 19, 1945

Mr. Robt. Rea
710 N. Central Ave.
Phoenix, Arizona

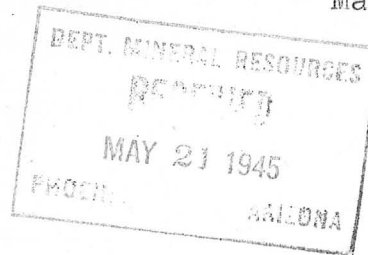

Dear Mr. Rea:

This will acknowledge receipt of your letter of May 15 relating to a copper prospect with your request that our Mr. E. D. Wilson make an examination of the property.

In normal times we are not permitted to make such an examination except when such examination can be coordinated into a long range research geological problem. The reason for this is that the Arizona Bureau of Mines functions are limited to extension work, research and education.

During the war we have interpreted our functions broadly and have at times made such examinations to assist the war effort, but the time is approaching when we must confine ourselves to our normal functions.

I have discussed your letter with Mr. J. H. Hedges of the U. S. Bureau of Mines and find that Mr. Hedges is in a position to send one of his engineers to your property to make a preliminary examination. If the findings of this engineer are sufficiently encouraging I will be glad to have our Mr. Wilson visit the property and look it over from the geological standpoint. This plan may seem to delay Mr. Wilson's examination, but we cannot possibly send him at this time because he has other commitments and it is my thought that Mr. Hedges' engineer might make a preliminary examination and therefore have some information for Mr. Wilson before arrangements are made for Mr. Wilson's visit.

Mr. Hedges is out of town today and I do not know when it will be convenient for him to send a U. S. Bureau of Mines engineer but I believe the best procedure would be for you to make a direct request to Mr. J. H. Hedges, U. S. Bureau of Mines, University of Arizona, Tucson, for a preliminary examination of this property by one of his engineers and I will send him a copy of this letter.

I trust these arrangements will be satisfactory.

Yours sincerely,

T. G. Chapman
Director, Arizona Bureau of Mines

Senita

May 16, 1945

Dr. T. G. Chapman
Arizona Bureau of Mines
University Station
Tucson, Arizona

Dear Tom:

Mr. Robert Rae has been exploring and developing a prospect near Congress that he thinks shows the earmarks of a copper mine.

We had our field engineer in that district, Mr. A. C. Nebeker, look this over and his report showed possibilities, but with many factors that could be better determined by a trained geologist.

I therefore suggested to Mr. Rae that he ask you to have Mr. Wilson look this over at his first opportunity.

From the reports we have had it seems at least different from the ordinary prospect and we would all appreciate Mr. Wilson's opinions.

I trust you will be able to have Mr. Wilson include this in his field work in the near future and he can get in touch with Mr. Rae at 710 North Central Avenue, Phoenix.

Yours very truly,

Chas. H. Dunning
Director

CHD:LP

CC: Mr. Robert Rae

ROBERT RAE
PHOENIX, ARIZONA

*Senate
mine
(Congress Ext)*

710 N. Central Avenue
Phoenix, Arizona
May 5, 1945

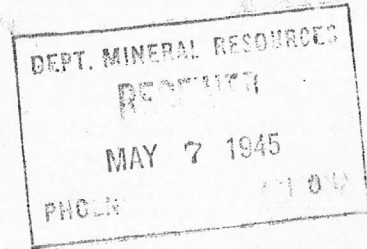

Chuck Dunning, Director
Dept. of Mineral Resources
Home Builders Building
Phoenix, Arizona.

Dear Chuck:

I wonder if there is anything definite regarding the examination of the prospect at Congress Junction. We are rather short of money and do not want to spend a lot in doing something that is entirely futile. So any acceleration on your part to get the examination made will be much appreciated.

Regards and sincerely,

Robert Rae.

Sample No 1

taken on Buckle No 1
on open cut. Cover markings
the vein is Ore Shute Fr
in a shirt hanging and a
lime foot wall this vein shows
6 ft wide Pitch 22 - Strike 80 N E.
across the creek in a
tunnel driven in 250 feet
a person can only go in
about 100 feet on account of
being badly caved. No sampler
was taken at this place.

There is good ore showing
and it has been told me
that the best is 4 ft wide
and cut sampler showed \$1200
this is another Ore Shute
There is three distinct ore
shuts showing at this end.
The Pitch 22 - Strike 80 N E.

Sample No 2 taken on upper
parallel vein about 30 ft above
No 1 sample parallel vein
this vein is 14 in in a shirt
hanging wall and lime foot
this Ore shut can be traced
or walked on over 1 mile

Sample No 3 on the Mary.
Coping 14 in just
doing cement work. Not
Completed Excellent showing

no 4

Sample no 4 - these samples were taken along the foot side of interval 6 5 feet also at Breast or face with Pre Edge motor in it

Sample no 5 - in shaft 2 5 feet from the lower shaft at this place - there is a fine showing and the vein cuts it clean on a regular side and good showing this shaft is incline 50 ft excellent showings down shaft 22 feet the vein dips 24 - Strike 80 - N. E. these Ore shutes can be traced and walked on over a mile on good Ore.

Sample no 6. This was taken on Senator no 4. average 8 ft deep showing heavy sulphides can be walked on over 1/2 mile showing good Ore in all adjacent rock.

The Pitch 24 - Strike 80 - N. E. samples taken from top to bottom in 2 places in working it shaft 5 ft apart.

of several groups of
a distance of 600 ft
width 7 to 14 ft with
a Granite hanging shaly
foot 12 in. high.

Valley view near Cape.
3000 ft show, a width
of 2 ft to 5 ft. Fine blue
hanging Granite foot wall.
In my opinion the prospects
for all the work
of one of the biggest
mines in the Prospective
Stage in the state in
the Prospective stage
and with from 25,000 to
30,000 expenditure would
make a mine bigger
than the Congress
and many times better
than could be done
with Portable Compressor

... was say in conclusion

That the Buckle Oneal Claims
and Ledger Show a Lime foot
roll and a schist hanging
the vein being very prominent
for a distance of 2000 ft.
Average width being from
14 in to 7 ft many of Lead. Crap.
very prominent for a distance
of 2500 ft showing Granite
Schist hanging roll and
Porphyry. foot roll & edge cropping
being in width from
10 in to 2 1/2 ft the dip on
both Ledger showing
about 24 degrees with a strike
of 80 north east

Senator vein has a sheet
120 ft ledge at surface.
about 10 in at 120 ft a

width of 8 ft hanging
roll show andesite and
Granite foot roll 12 in
Gang and Porphyry foot
show vein show Granite
~~Craps~~ hanging and
Granite foot width
... ..

H. C. SMOOT
CHEMIST AND ASSAYER
REGISTRATION NO. 460

CUSTOM ASSAY OFFICE

Assay Certificate



For Conroy ~~Arizona~~, Prescott, Arizona, 11-2-34

Sheet # 2

DESCRIPTION	GOLD PER TON		SILVER PER TON		GOLD AND SILVER VALUE	OTHER METALS	
	OZS. TROY	VALUE	OZS. TROY	VALUE		PER CENT	VALUE
Conroy Special X	1.14	\$ 39.90	1.7	\$ 1.10	\$ 41.00		\$

MARKET VALUES

GOLD PER OZ. 35.00	SILVER PER OZ. 64 1/2	COPPER PER LB.	LEAD PER LB.	ZINC PER LB.
-----------------------	--------------------------	----------------	--------------	--------------

Charges \$ 10.00

H.C. Smoot

H. C. SMOOT
CHEMIST AND ASSAYER
REGISTRATION NO. 460

CUSTOM ASSAY OFFICE

Assay Certificate



For Operators & Developers, Prescott, Arizona, 8-28-34

DESCRIPTION	GOLD PER TON		SILVER PER TON		GOLD AND SILVER VALUE	OTHER METALS	
	OZS. TROY	VALUE	OZS. TROY	VALUE		PER CENT	VALUE
Sample	1.06	\$ 37.10	2.3	\$ 1.48	\$ 38.58		\$
<p><u>NOTE</u> The above assay was taken as a grab sample from the shaft dump (120 feet deep) on the John Conroy property known as the Senate Group</p>							

MARKET VALUES

GOLD PER OZ.	SILVER PER OZ.	COPPER PER LB.	LEAD PER LB.	ZINC PER LB.
--------------	----------------	----------------	--------------	--------------

Charges \$ Paid

H.C. Smoot

CUSTOM ASSAY OFFICE

Assay Certificate



For Conroy
Dynamite

Prescott, Arizona, 11-3-34

Sheet # 2

DESCRIPTION	GOLD PER TON		SILVER PER TON		GOLD AND SILVER VALUE	OTHER METALS	
	OZS. TROY	VALUE	OZS. TROY	VALUE		PER CENT	VALUE
Conroy Special X	1.14	\$ 39.90	1.7	1.10	\$ 41.00		\$

MARKET VALUES

GOLD PER OZ.	SILVER PER OZ.	COPPER PER LB.	LEAD PER LB.	ZINC PER LB.	Charges \$
35.00	64.00				10.00

H. C. Smoot

CUSTOM ASSAY OFFICE

Assay Certificate



For Arizona Machinery Co.

Prescott, Arizona, 11-21-32

Wade

DESCRIPTION	GOLD PER TON		SILVER PER TON		GOLD AND SILVER VALUE	OTHER METALS	
	OZS. TROY	VALUE	OZS. TROY	VALUE		PER CENT	VALUE
Ducky # 1	.03	\$.60	trace	\$	\$		\$
4 Claims # 8	.08	1.60	0.1				
Mary L # 2	.09	1.80	0.3				
Chase # 6	.16	3.20	0.2				
Ore Shoot 8'	.05	1.00	trace				
Sultan	27.30	546.00	3.5	1.05	547.05		
Senator	.36	7.20	0.4				

N. Y. MARKET VALUES

GOLD PER OZ.	SILVER PER OZ.	COPPER PER LB.	LEAD PER LB.	ZINC PER LB.	Charges \$
\$20.67					Paid

H. C. Smoot

Hulland
now trucking
Aug 1940

was

Gr

23 2 1/2 - 3 1/2
6' 6" quantity
with shelter
covered

Gr

Gr

upper woods

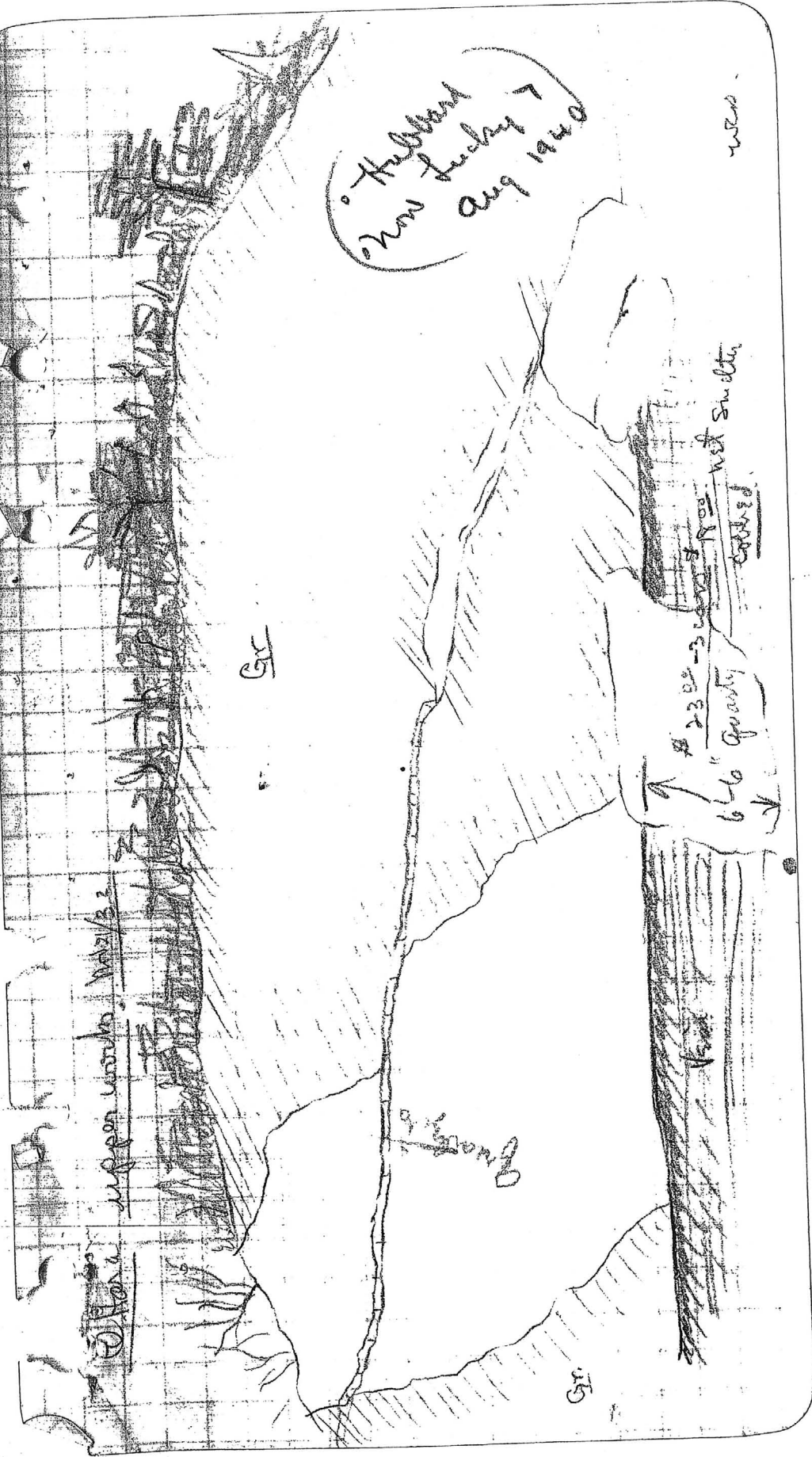

CONGRESS EXTENSION MINE

The Congress Extension mine, about $\frac{1}{2}$ mile west of the Congress mine, is reported to have been operated for about three years during the nineties by T. Carrigan and associates who sank a 950-foot inclined shaft and opened nine levels, each of which extends for approximately 100 feet east and west of the shaft. The Herskowitz family obtained the property in 1910 and, since about 1923, has made yearly shipments of 35 to 80 tons of ore that contained from \$8.50 to \$17.50 worth of gold per ton.⁶

When visited in May 1934, the shaft contained water to the 140-ft. level. Where seen in the upper workings, the vein strikes westward, dips 35 to 40 N., and occurs in granite. A stope on the first level east of the shaft indicates that the ore there occurred as a flat lens about 3 feet thick. The vein material consists mainly of massive, locally shattered white quartz. Specimens of this quartz seen on the dump contain irregular bunches and disseminations of pyrite and a little chalcopyrite. The oxidized vein material contains abundant limonite and some copper stain.

As the surface exposures are terminated on the east by alluvium the relations of this vein to the Congress and Niagara veins are unknown.

(Arizona Bureau of Mines Bulletin No. 137), p 73)

CHAPTER III—MOHAVE COUNTY

GENERAL GEOGRAPHY

Mohave County, as shown on Figure 3, comprises an irregular area about 190 miles long from north to south by 85 miles wide. Its north-northeastern portion is within the deeply dissected Plateau Province and rises to an altitude of more than 6,000 feet. The rest of the county consists of north-northwestward-trending fault-block mountain ranges and valleys. The largest of these ranges is the Black Mountains, near the Colorado River. This range is nearly 100 miles long by a maximum of 20 miles wide and attains an altitude of more than 5,000 feet.

The region is drained by the Colorado River, as indicated on Figure 3.

⁶ Oral communication from H. Herskowitz.

DEPARTMENT OF MINES & RESOURCES

News Items

Date

9/18/39

Mine

Senate

Location

Old Congress

Owner

Herstikowitz & Sons

Address

Congress

Operating Co.

Sales

Address

Pres.

Genl. Mgr.

Mine Supt.

Mill Supt.

Principal Metals

Gold

Men Employed

4

Production Rate

Mill, Type & Capacity

Power, Amt. & Type

Portable

Compressor

Signed

Burth

(Over)

Present Operations

Chaulding
1 car each
30 days

New Work Planned

Miscl. Notes

900' incline shaft
Water at 750' level

Work done during
activity of
Old Congress
Mine

DEPARTMENT OF MINERAL RESOURCES

REPORT TO OPA ON ACTIVE MINING PROJECT

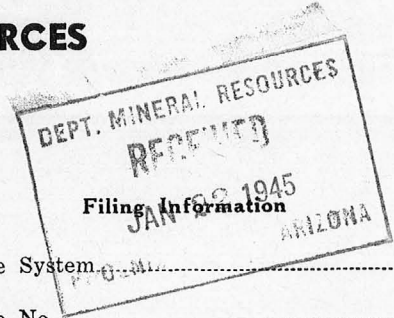

Date Jan 20 1945
 Name of Mine Senate
 Owner or Operator Oscar Deak
 Address Congress Ave
 Mine Location 3 mi north Congress

File System
 File No.
 This chart to be used for gallons of gasoline required per month.

PRESENT OPERATIONS: (check X)

Production ; Development ; Financing.....; Sale of mine.....;
 Experimental (sampling).....; Owner's occasional trip.....;
 Other (specify).....

PRODUCTION: Past and Future.

Tons

Approx. tons last 3 months
 Approx. present rate per 3 months
 Anticipated rate next 3 months
 If in distant future check (X) here

EQUIPMENT OPERATED:

Type	Quantity or Horse Power	Miles or Hours Per Month	Gallons Required Per Month
Personal Cars
Light or Service Trucks
Ore Hauling Trucks
Compressors	<u>15</u>	<u>28</u>	<u>234</u>
Other Mine or Mill Eqpt.	<u>10</u>	<u>104</u>	<u>156</u>

PRODUCT PRODUCED OR CONTEMPLATED: Name metals or minerals.

Copper & Silver

REMARKS:

.....
.....
.....
.....

By
.....

DEPARTMENT OF MINERAL RESOURCES
STATE OF ARIZONA
FIELD ENGINEERS REPORT

Mine SENATE

Date JAN 18th, 1945.

District Martinez

Engineer A. C. Nebeker

Subject: Check up on development.

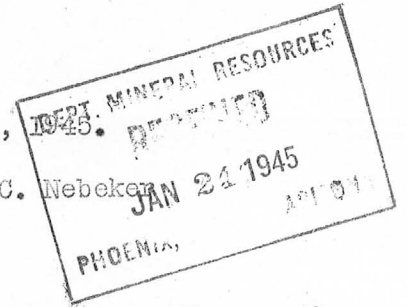

As stated in my report of Dec. 14th 1944 , this property is located 3 miles north of Congress Junction and about $\frac{1}{2}$ mile west of old Congress mine.

Since my last visit to the property, the shaft has been sunk another 25 feet. This work followed ore to the bottom.

From the bottom of the shaft a drift is now being driven north on the fissure and in ore. This drift was in about 12 feet from the shaft, and the face shows 18 inches of good copper ore. From this work about 5 tons of good ore has been sorted, which I would guess would assay 10 % copper.

The fault-fissure in which the ore is making is still strong and has all the ear marks of continuing down, and I would suggest that the shaft be carried on down. From the present indications, one is justified in assuming more ore will be developed below.

Date 12-15-44

TO MINING DIVISION
LOS ANGELES COUNTY CHAMBER OF COMMERCE
LOS ANGELES - 15 CALIFORNIA

1. Name of Mine Senate
2. Owner's Name and Address Harry Hershgorwitz
3. Operator's Name and Address Congress. Ruiz
4. Location of Mine 3 Northwest Congress Jct
(Number of Miles N.E.S. or W. of Nearest Town)
5. District Martinez P.O. Address _____
6. Ore Produced Copper-gold-silver
7. How Developed Incline shaft and drift on vein
8. Power used gasoline
9. Equipment 1 drill compressor - 5 H. wheel
10. Number of Men Employed 2
11. Plans for Future Operations will continue drifting on vein to end of ore, then sink shaft another 100 ft
12. Remarks Vein in fractured zone in granite walls

Signed _____

(Please state title)

DEPARTMENT OF MINERAL RESOURCES
STATE OF ARIZONA
FIELD ENGINEERS REPORT

MS-25

Mine SENATE

Date October 10, 1939

District Martinez

Engineer Carl G. Barth, Jr.

Subject:

Location: At old Congress.

Owner: Herschkowitz and Sons, Congress, Arizona.

Operator: Chloriding by the sons.

Principal Metals: Gold

Men Employed: 3 to 4 work together.

Production Rate: One carload monthly (approx.).

Power - Amt. & Type: Gasoline Hoist and Portable Compressor.

Number Claims, Title, Etc.: Four (4).

Mine Workings - Amt. & Condition: 900 foot shaft filled with water to 200 level.
Amount of lateral work unknown.

Geology & Mineralization: Quartz vein in Granite. Galena and Pyrite in primary zone.
Strikes E-W Dip 35° - 40° N.

Road Conditions, Route: 4 miles well kept county road to railroad.

Brief History: Operations during day of Old Congress Mine. Known as Congress Extension
when operated in early nineties by T. Carrigan & associates.

If property for sale, price, terms and address to negotiate: Property for sale with
reasonable terms to substantial parties.

(Signed) Carl G. Barth, Jr.

M-5-25-

DEPARTMENT OF MINERAL RESOURCES

STATE OF ARIZONA

FIELD ENGINEERS REPORT

Date October 10, 1939

Mine SENATE

Engineer

District Martinez

Location at Old Congress

Former name Same

Owner Herschkowitz and Sons

Address Congress, Arizona

Operator Chloriding by the Sons

Address

President

Gen. Mgr.

Mine Supt.

Mill Supt.

Principal Metals Gold

Men Employed 3 to 4 work together

Production Rate One carload monthly (approx.)

Mill: Type & Cap.

Power: Amt. & Type Gasoline Hoist and Portable Compressor.

Operations: Present

Operations Planned

Number Claims, Title, etc. Four (4)

Description: Topog. & Geog.

Mine Workings: Amt. & Condition 900 foot shaft filled with water to 200 level. Amount of lateral work unknown

Geology & Mineralization Quartz vein in Granite, Galena and Pyrite in primary zone.

Strikes E-W Dip 35° - 40° N

Date October 10, 1939

Ore: Positive & Probable, Ore Dumps, Tailings

Mine STATE

Location at Old Congress

District Martins

Former name same

Mine, Mill Equipment & Flow Sheet

Owner Herschowitz and Sons

Address

Operator Chloriding by the Sons

Gen. Mgr.

President

Road Conditions, Route 4 miles well kept county road to railroad

Mine Supr.

Men Employed 3 to 4 work together

Principal Metals Gold

Mill: Type & Cap.

Production Rate One carload monthly (approx.)

Water Supply

Power: Amt & Type Gasoline Motor and Portable Compressor.

Operations: Present

Brief History Operations during day of Old Congress Mine.

Known as Congress Extension when operated in early nineties by

T. Carrigan & associates.

Operations Planned

Special Problems, Reports Filed

Number Claims, Title etc. Four (4)

Remarks

Description: Topog. & Geog.

If property for sale: Price, terms and address to negotiate.

Property for sale with reasonable terms to substantial parties.

Mine Working: Amt & Condition 200 foot shaft filled with water to 200 level. Amount of lateral work unknown

Signed..... CARL G. BARTH, Jr.

Use additional sheets if necessary. Separate sheets on each problem.

DEPARTMENT OF MINERAL RESOURCES
STATE OF ARIZONA

FIELD ENGINEERS REPORT

Date October 10, 1939

Mine SENATE

Engineer ~~Carl G. Barth, Jr.~~

District Martinez

Location at Old Congress

Former name Same.

Owner Herschkowitz and Sons

Address Congress, Arizona.

Operator Chloriding by the Sons.

Address

President

Gen. Mgr.

Mine Supt.

Mill Supt.

Principal Metals Gold

Men Employed 3 to 4 work together

Production Rate One Carload monthly (approx.)

Mill: Type & Cap.

Power: Amt. & Type

Gasoline Hoist and Portable Compressor.

Operations: Present

Operations Planned

Number Claims, Title, etc.

Four (4)

Description: Topog. & Geog.

Mine Workings: Amt. & Condition

900 foot shaft filled with water to 200 level. Amount of lateral work unknown.

Geology & Mineralization

DEPARTMENT OF MINERAL RESOURCES
STATE OF ARIZONA

Quartz vein in Granite. Galena and Pyrite in Primary Zone.

Strikes E-W Dip 35°-40' N

Date October 10, 1933

Ore: Positive & Probable, Ore Dumps, Tailings

Mine, Mill Equipment & Flow Sheet

Road Conditions, Route

4 miles well kept county road to Railroad

Water Supply

Brief History

Operations during days of Old Congress Mine.

Known as Congress Extension when operated
in early nineties by T. Carrigan & Associates

Special Problems, Reports Filed

Remarks

If property for sale: Price, terms and address to negotiate.

Property for Sale with Reasonable Terms to substantial parties.

Carl G. Barth, Jr .

Signed.....

Use additional sheets if necessary. Separate sheets on each problem.

cc mailed
Robt. Roe

DEPARTMENT OF MINERAL RESOURCES
STATE OF ARIZONA
FIELD ENGINEERS REPORT

DEPT. MINERAL RESOURCES
RECEIVED
DEC 27 1944
PHOENIX, ARIZONA

Mine Senate Group

Date Dec. 14th, 1944

District Martinez

Engineer A. C. Nebeker

Subject: Examination of Senate Mine.

This mine is located 3 miles N. W. of Congress Junction, and about 3/8 mile west of the old Congress Mine, in the district known as the Martinez Mining District.

The old name of this property was known as, was the Congress Extension Mining Company, and the owner is Harry Herskozwitz of Congress Junction.

The property consists of seven mining claims.

This property has been developed by an incline shaft several hundred feet deep with drifts and cross cuts out from different levels for several hundred feet. The water now stands at about the 85 foot level, and on this level and above, old stopes can be seen from which considerable gold ore has been mined, from a rather flat quartz vein having thickness up to 6 feet. The ore was reported to have netted at the smelter \$21.00 per ton.

The new work being done now is through a incline shaft which is about 45 feet deep, and a drift run out from the bottom on the vein for about 40 feet. The vein is in a fractured zone with a width of one foot to four feet between quartz-granite walls. The vein consists of bunches of copper ore, some very highgrade, in a gangue of mica-hornblende decomposed green stone.

Assay returns, shown me of samples taken from the vein ran, copper 9.16%, Silver 3.0 Ozs, Gold .05 Ozs, Insol. 48.4%, S. I.45.

The vein is steeper than the general run of veins in this district. It having a dip of 70 degrees N.W. and strike of N 20 E.

The equipment on the property is a very small mining plant capable of handling on small drill and the hoist is good for about 100 feet depth with a 600 lbs bucket.

The property is ideally located as to transportation and markets; and climate.

The property is not apt to produce a fair tonnage of copper ores, all though the present showing justifies more development ahead on the strike and I would all so recommend sinking another 50 feet, to feel it out, on the dip.

If and when, gold is given the Green Light, and a better price is paid for gold, I would recommend that the quartz vein in the old shaft be given serious attention, as it is possible to open up more gold stopes which will then be profitable.

A. C. Nebeker

DEPARTMENT OF MINERAL RESOURCES
STATE OF ARIZONA
FIELD ENGINEERS REPORT

Mine Senate Group

Date December 14, 1944

District Martinez

Engineer A. C. Nebeker

Subject: Examination of Senate Mine

This mine is located 3 miles northwest of Congress Junction, and about 1/2 mile west of the old Congress mine, in the district known as the Martinez Mining District.

The old name of this property was known as the Congress Extension Mining Company and the owner is Harry Herskowitz of Congress Junction.

The property consists of seven mining claims.

This property has been developed by an incline shaft several hundred feet deep with drifts and crosscuts out from different levels for several hundred feet. The water now stands at about the 85 foot level, and on this level and above old stopes can be seen from which considerable gold ore has been mined from a rather flat quartz vein having thickness up to 6 feet. The ore was reported to have netted at the smelter \$21.00 per ton.

The new work being done now is through an incline shaft which is about 45 feet deep and a drift run out from the bottom on the vein for about 40 feet. The vein is in a fractured zone with a width of one foot to four feet between quart-granite walls. The vein consists of bunches of copper ore, some very high grade, in a gangue of mica-hornblende decomposed green stone.

Assay returns shown me of samples taken from the vein ran: Copper 9.16%, silver 3.0 ozs., gold .05 ozs., insol. 48.4%, S. 1.45.

The vein is steeper than the general run of veins in this district, it having a dip of 70 degrees N.W. and strike of N 20 E.

The equipment on the property is a very small mining plant capable of handling one small drill and the hoist is good for about 100 feet depth with a 600 lbs. bucket.

The property is ideally located as to transportation, markets and climate.

The property is not apt to produce a fair tonnage of copper ores, although the present showing justifies more development ahead on the strike and I would also recommend sinking another 50 feet to feel it out on the dip.

If and when gold is given the Green Light, and a better price is paid for gold, I would recommend that the quartz vein in the old shaft be given serious attention, as it is possible to open up more gold stopes which will then be profitable.

/S/ A. C. Nebeker

DEPARTMENT OF MINERAL RESOURCES
STATE OF ARIZONA
OWNERS MINE REPORT

Date October 10, 1939

1. Mine **SENATE**
2. Mining District & County **Martinez**
3. Former name **Same**
4. Location **At old Congress**
5. Owner **Herschkowitz and Sons**
6. Address (Owner) **Congress, Arizona**
7. Operator **Chloriding by the Sons**
8. Address (Operator)
9. President
10. Gen. Mgr.
11. Mine Supt.
12. Mill Supt.
13. Principal Metals **Gold**
14. Men Employed **3 to 4 work together**
15. Production Rate **One carload monthly (Approx.)**
16. Mill: Type & Cap.
17. Power: Amt. & Type **Gasoline hoist and portable compressor**
18. Operations: Present
19. Operations Planned
20. Number Claims, Title, etc. **Four (4)**
21. Description: Topography & Geography
22. Mine Workings: Amt. & Condition **900 foot shaft filled with water to 200 level. Amount of lareral work unknown**

23. Geology & Mineralization

Quartz vein in Granite, Galena and Pyrite in primary zone.
Strikes E-W Dip 95°-40' N

24. Ore: Positive & Probable, Ore Dumps, Tailings

24-A Vein Width, Length, Value, etc.

25. Mine, Mill Equipment & Flow Sheet

26. Road Conditions, Route

4 miles well kept county road to railroad

27. Water Supply

28. Brief History

Operations during day of Old Congress Mine.
Known as Congress Extension when operated in early nineties by
T. Carrigan & Associates.

29. Special Problems, Reports Filed

30. Remarks

31. If property for sale: Price, terms and address to negotiate.

Property for sale with reasonable terms to substantial parties.

32. Signed CARL G. BARTH, JR.

33. Use additional sheets if necessary.

DEPARTMENT OF MINERAL RESOURCES
STATE OF ARIZONA
OWNERS MINE REPORT

Date October 10, 1939

1. Mine **SENATE**
2. Mining District & County **Martinez**
3. Former name **Same**
4. Location **At old Congress**
5. Owner **Herschkowitz and Sons**
6. Address (Owner) **Congress, Arizona**
7. Operator **Chloriding by the Sons**
8. Address (Operator)
9. President
10. Gen. Mgr.
11. Mine Supt.
12. Mill Supt.
13. Principal Metals **Gold**
14. Men Employed **3 to 4 work together**
15. Production Rate **One carload monthly (Approx.)**
16. Mill: Type & Cap.
17. Power: Amt. & Type **Gasoline hoist and portable compressor**
18. Operations: Present
19. Operations Planned
20. Number Claims, Title, etc. **Four (4)**
21. Description: Topography & Geography
22. Mine Workings: Amt. & Condition **900 foot shaft filled with water to 200 level. Amount of lateral work unknown**

23. Geology & Mineralization **Quartz vein in Granite, Galena and Pyrite in primary zone.**

Strikes E-W Dip 35°-40° N

24. Ore: Positive & Probable, Ore Dumps, Tailings

24-A Vein Width, Length, Value, etc.

25. Mine, Mill Equipment & Flow Sheet

26. Road Conditions, Route **4 miles well kept county road to railroad**

27. Water Supply

28. Brief History **Operations during day of Old Congress Mine.
Known as Congress Extension when operated in early nineties by
T. Carrigan & Associates.**

29. Special Problems, Reports Filed

30. Remarks

31. If property for sale: Price, terms and address to negotiate.

Property for sale with reasonable terms to substantial parties.

32. Signed CARL G. BARTH, JR.

33. Use additional sheets if necessary.

-COPY*

CUSTOM ASSAY OFFICE
ASSAY CERTIFICATE

For Operators and Developers,

Prescott Arizona, 8-28-54

Gold per ton
ounces troy value 1.060z. \$ 37.10 silver 2.3 Oz. 1.48 Total \$ 38.58

(Signed) H.C. Smoot

DEPARTMENT OF MINERAL RESOURCES

News Items

Date 9/18/39

Mine Sengate

Location Old Congress

Owner Hershkovitz & Sons

Address Congress

Operating Co. Sales

Address

Pres.

Genl. Mgr.

Mine Supt.

Mill Supt.

Principal Metals Gold

Men Employed 4

Production Rate

Mill, Type & Capacity

Power, Amt. & Type Portable

Compressor

Signed

Barth

(Over)

Present Operations

News Items
 Chloriding
 1 Car each
 Date 30 days
 Mine
 Location
 Owner

New Work Planned

Address
 Operating Co.
 Address

Misc. Notes

900' incline shaft
 level at 250' level
 Mine Supt.
 Work done during
 activity of
 Men Employed
 Old Congress
 Production Rate
 Mill Type & Capacity
 Power Amt & Type
 (Over)

Sample No 1
taken on Buckle No 1
on open cut. Lower workings
the vein is Ore Shute. It
is a Shute hanging and a
Lime foot wall this vein shows
6 ft wide Pitch 22 - Strike 80 N.E.
across the creek is a
tunnel driven in 250 feet
a person can only go in
about 100 feet on account of
being badly caved. No sampler
went there at this place.

There is Good ore showing
and it has been told me
that the best is 4 ft wide
and cut sampler showed \$1200
this is another Ore Shute
There is three distinct ore
shutes showing at this end.
The Pitch 22 - Strike 80 N.E.

Sample No 2 taken on upper
parallel vein about 30 ft apart
No 1 sample parallel vein
this vein is 14 in in a Shute
hanging wall and Lime foot
this Ore Shute can be traced
or walked on over 1 mile
on the way.

Sample No 3
Cropping 14 in just
doing assessment work. not
Completed Excellent showing

Sample No 4. taken on
Lower Shute this Shute
is 120 ft Encline

no 4

Sample no 4 - these samples
 were taken along the foot
 side of intervale 5 feet
 also at Breast or face
 with the ledge matter in it
 Sample no 5 - in front of 5 feet
 from the lower shaft at
 this place - there is a
 hole showing and the rim
 cuts it clean or a rough blade
 would. This ore shaft is 6 to
 side and good showing
 This shaft is incline 50 ft
 Excellent showings down about
 22 feet the vein dips 24 - Strike
 80 - N. E. there Ore shaft
 can be traced and walked
 on over a mile on good
 Ore.

Sample no 6. This was
 taken on Senator no 4.
 average 8 ft deep showing
 heavy sulphides can be walked
 on over 1/2 mile showing
 good Ore in all excellent
 work.
 The Pitch 24 - Strike
 80 - N. E. samples taken
 from top to bottom in
 2 places in working it about
 5 ft apart.

of Senator Grumble Craps,
to distance of 600 to
width 7 to 14 ft with
a Granite hanging Arkley
foot 12 in Gage.

Roller view near Craps.
3000 ft show, a width
of 2 ft to 5 ft. Fine Stone
Hanging Granite foot wall.
In my opinion the Prospects
for the all the 2-3 months
of one of the bigger
mines in the Prospective
Stage in the State in
the Prospective stage
and with from 25,000 to
30,000 expenditure would
make a mine bigger
than the Congress
and many times better
this could be done
with Portable Compressor
and small drill.

... was say in conclusion

That the Buckle Oneal Claims
and Ledger Show a Fine foot
wall and a schist hanging
the vein being very prominent
for a distance of 2500 ft.
Average width varying from
14 in to 7 ft near the Lead. Craps.
very prominent for a distance
of 2500 ft showing Granite
Schist hanging wall and
Porphyry foot wall ledge crossings
varying in width from
10 in to 2 1/2 ft the dip on
both ledges showing
about 24 degrees with a strike
of 80 north east

Senter vein has a shaft
120 ft ledge at surface
about 10 in at 120 ft a

width of 8 ft hanging
wall show andesite and
Granite foot wall 12 in
Gang and Porphyry foot
wall vein show Granite
~~Craps~~ hanging and
Granite foot wall
8 ft Craps 400 ft
are shown on map claim

H. C. SMOOT
 CHEMIST AND ASSAYER
 REGISTRATION NO. 460

CUSTOM ASSAY OFFICE

Assay Certificate



For Operators & Developers,

Prescott, Arizona, 8-28-34

DESCRIPTION	GOLD PER TON		SILVER PER TON		GOLD AND SILVER VALUE	OTHER METALS	
	OZS. TROY	VALUE	OZS. TROY	VALUE		PER CENT	VALUE
Sample	1.06	\$ 37.10	2.3	\$ 1.48	\$ 38.58		\$
<p><u>NOTE</u> The above assay was taken as a grab sample from the shaft dump (120 feet deep) on the John Conry property known as the Senate Group</p>							

MARKET VALUES

GOLD PER OZ.	SILVER PER OZ.	COPPER PER LB.	LEAD PER LB.	ZINC PER LB.
-----------------	-------------------	-------------------	-----------------	-----------------

Charges \$

Paid

H. C. Smoot

H. C. SHOOT
 CHEMIST AND ASSAYER
 REGISTRATION NO. 460

CUSTOM ASSAY OFFICE

Assay Certificate



For Conroy
Byron Partridge,

Prescott, Arizona, 11-3-34

Sheet # 2

DESCRIPTION	GOLD PER TON		SILVER PER TON		GOLD AND SILVER VALUE	OTHER METALS	
	OZS. TROY	VALUE	OZS. TROY	VALUE		PER CENT	VALUE
Conroy Special X	1.14	\$ 39.90	1.7	\$ 1.10	\$ 41.00		\$

MARKET VALUES

GOLD PER OZ. 35.00	SILVER PER OZ. 64½	COPPER PER LB.	LEAD PER LB.	ZINC PER LB.
--------------------------	--------------------------	-------------------	-----------------	-----------------

Charges \$ 10.00

H. C. Shoot

H. C. SMOOT
 CHEMIST AND ASSAYER
 REGISTRATION NO. 460

CUSTOM ASSAY OFFICE

Assay Certificate



Woods property

For Arizona Machinery Co.,

Prescott, Arizona, 11-21-32

DESCRIPTION	GOLD PER TON		SILVER PER TON		GOLD AND SILVER VALUE	OTHER METALS	
	OZS. TROY	VALUE	OZS. TROY	VALUE		PER CENT	VALUE
Lucky # 1	.03	\$.60	Trace	\$	\$		\$.
4 Claims # 8	.08	1.60	0.1				
Mary L # 2	.09	1.80	0.3				
Chase # 6	.16	3.20	0.2				
Ore Shoot 8'	.05	1.00	Trace				
Sultan	27.30	546.00	3.5	1.05	547.05		
Senator	.36	7.20	0.4				

N. Y. MARKET VALUES

GOLD PER OZ. \$20.67	SILVER PER OZ.	COPPER PER LB.	LEAD PER LB.	ZINC PER LB.
----------------------------	-------------------	-------------------	-----------------	-----------------

Charges \$ Paid

H. C. Smoot

H. C. SMOOT
 CHEMIST AND ASSAYER
 REGISTRATION NO. 460

CUSTOM ASSAY OFFICE

Assay Certificate



For Conroy
~~Byron Partridge,~~ Prescott, Arizona, 11-3-34

Sheet # 2

DESCRIPTION	GOLD PER TON OZS. TROY VALUE		SILVER PER TON OZS. TROY VALUE		GOLD AND SILVER VALUE	OTHER METALS PER CENT VALUE	
		\$		\$			\$
Conroy Special X	1.14	39.90	1.7	1.10	41.00		

MARKET VALUES

GOLD PER OZ.	SILVER PER OZ.	COPPER PER LB.	LEAD PER LB.	ZINC PER LB.
35.00	64½			

Charges \$ 10.00

H. C. Smoot

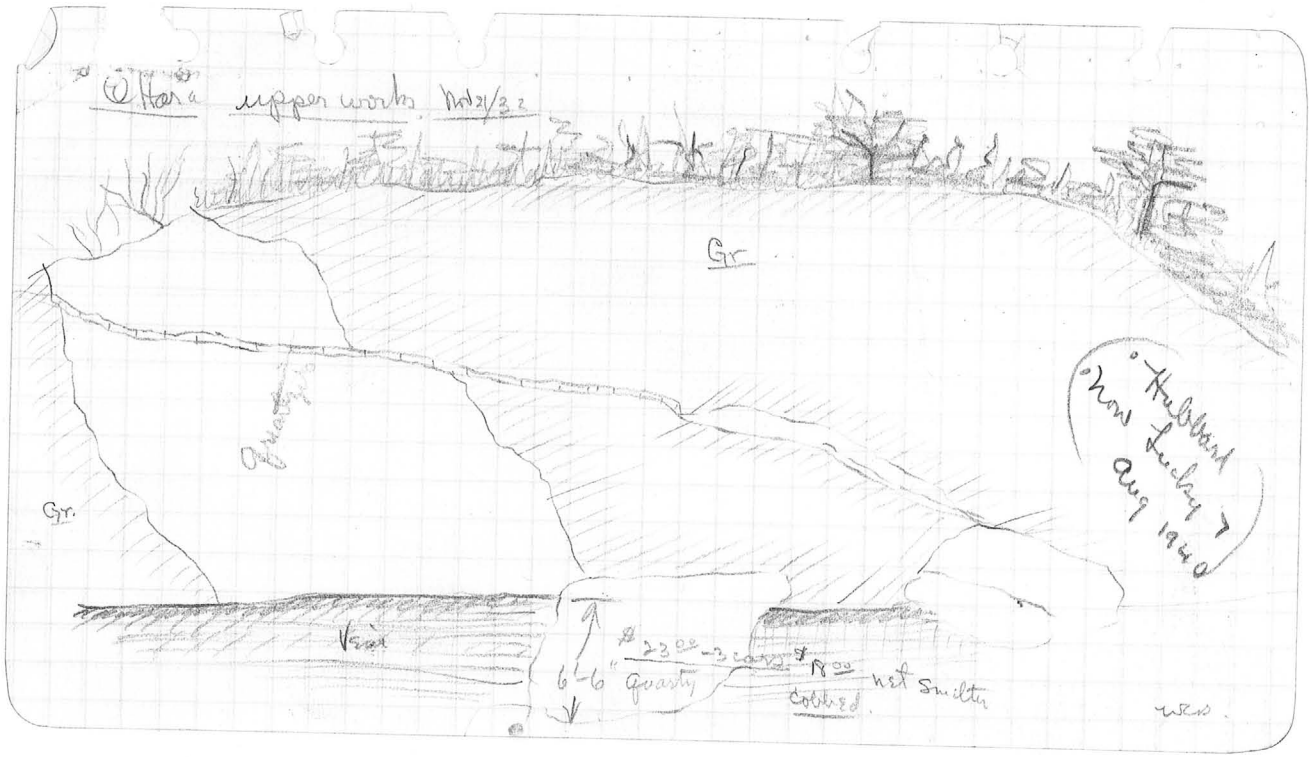

East

North

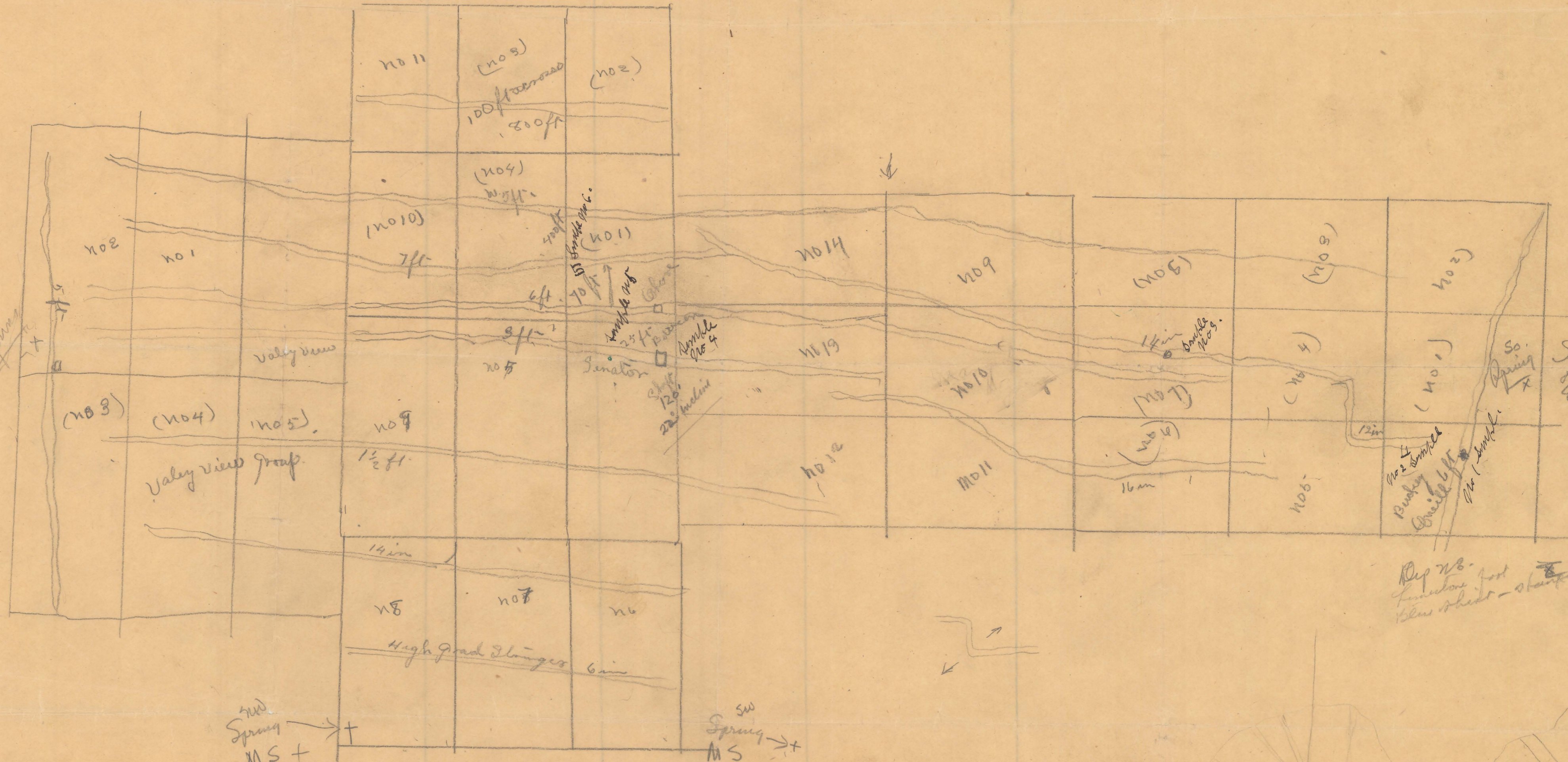

SW Spring MS +

SW Spring MS +

West

compass

Meatry Fault

Dep 23. Features just below sheet - sharp