



CONTACT INFORMATION

Mining Records Curator
Arizona Geological Survey
1520 West Adams St.
Phoenix, AZ 85007
602-771-1601
<http://www.azgs.az.gov>
inquiries@azgs.az.gov

The following file is part of the

Arizona Department of Mines and Mineral Resources Mining Collection

ACCESS STATEMENT

These digitized collections are accessible for purposes of education and research. We have indicated what we know about copyright and rights of privacy, publicity, or trademark. Due to the nature of archival collections, we are not always able to identify this information. We are eager to hear from any rights owners, so that we may obtain accurate information. Upon request, we will remove material from public view while we address a rights issue.

CONSTRAINTS STATEMENT

The Arizona Geological Survey does not claim to control all rights for all materials in its collection. These rights include, but are not limited to: copyright, privacy rights, and cultural protection rights. The User hereby assumes all responsibility for obtaining any rights to use the material in excess of "fair use."

The Survey makes no intellectual property claims to the products created by individual authors in the manuscript collections, except when the author deeded those rights to the Survey or when those authors were employed by the State of Arizona and created intellectual products as a function of their official duties. The Survey does maintain property rights to the physical and digital representations of the works.

QUALITY STATEMENT

The Arizona Geological Survey is not responsible for the accuracy of the records, information, or opinions that may be contained in the files. The Survey collects, catalogs, and archives data on mineral properties regardless of its views of the veracity or accuracy of those data.

PRINTED: 06/24/2002

ARIZONA DEPARTMENT OF MINES AND MINERAL RESOURCES AZMILS DATA

PRIMARY NAME: SANTA CLAUS PROSPECT

ALTERNATE NAMES:

MOHAVE COUNTY MILS NUMBER: 131C

LOCATION: TOWNSHIP 23 N RANGE 18 W SECTION 26 QUARTER NW
LATITUDE: N 35DEG 21MIN 12SEC LONGITUDE: W 114DEG 10MIN 38SEC
TOPO MAP NAME: CERBAT - 7.5 MIN

CURRENT STATUS: EXP PROSPECT

COMMODITY:
COPPER
MOLYBDENUM

BIBLIOGRAPHY:
ADMMR SANTA CLAUS PROSPECT
ADDITIONAL WORKINGS SEC. 27-NE
THERE MAY BE ADDITIONAL DATA IN THE ARKLA
1-7 FILES

755

3154 1 NW
(CHLORIDE)

756

757

10'

758

380 000 FEET

R.118

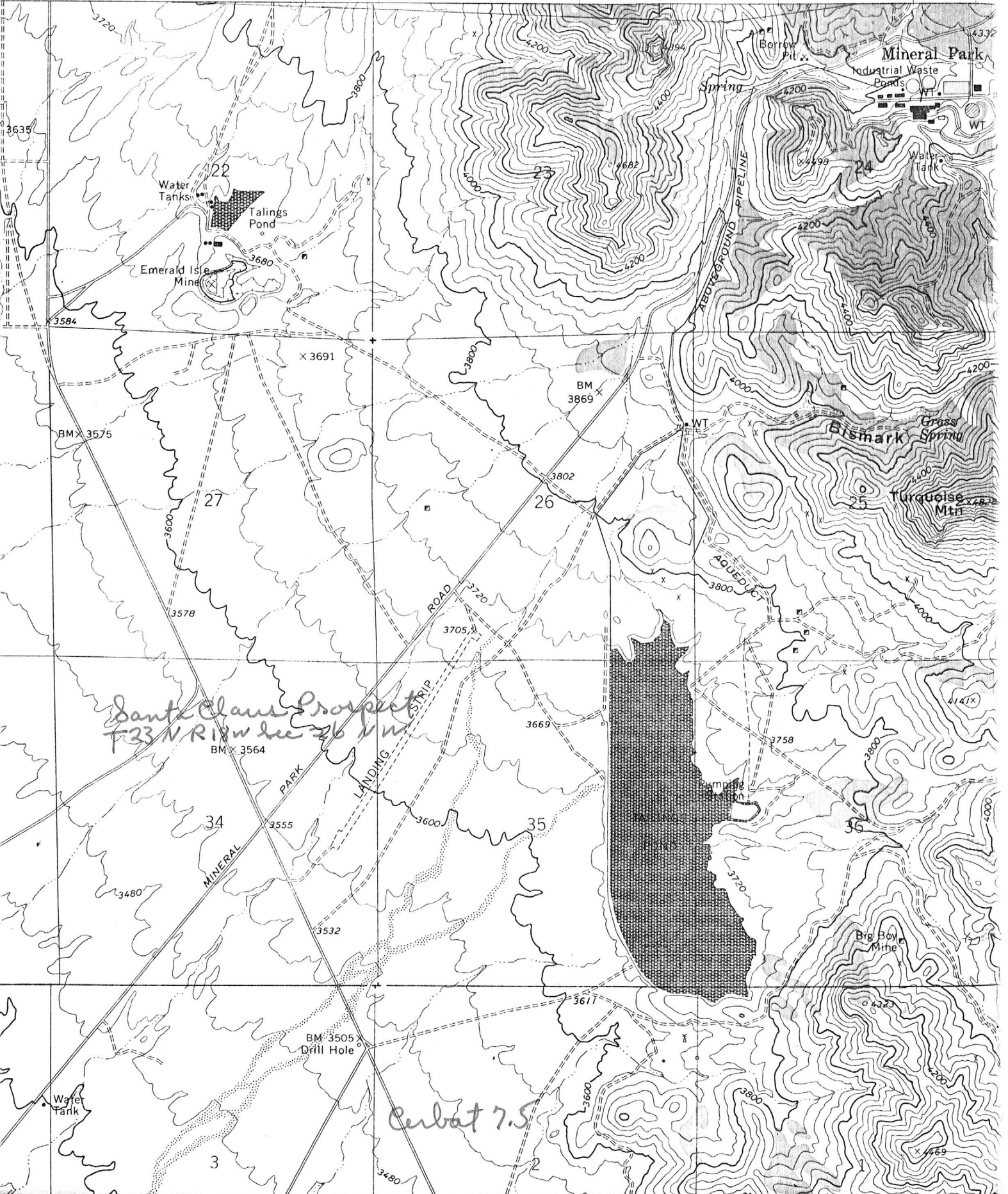

Santa Claus Prospect

ARKLA FILE
1977

Mohave County

- #1 AEC - Assays
- #2 AEC Tom (Old Pete #2 DPND) - Assays
- #3 AEC Pete - Assays
- #1 Hagey - Assays
- #2 Ray - Assays
- #6 Tom - Assays
- #12 - Tom - Assays



ARKLA EXPLORATION

C O M P A N Y

P. O. BOX 1734 SHREVEPORT, LOUISIANA 71102

April 30, 1965

Mr. E. L. Gorsuch
New Mexico Arizona Land Company
808 Bank of New Mexico Bldg.
Albuquerque, New Mexico

Chemical Assays on (1) Holbrook Area
(2) Santa Claus Area *copy*

Dear Lee:

Attached is a zerox copy of a chemical assay received today on A.E.C. #25 Pete in the Santa Claus Area and A.E.C. #14 State in the Holbrook Area.

I will keep you informed on any phone calls I receive.

Very truly yours,

ARKLA EXPLORATION COMPANY



R. L. Breedlove
Chief Geologist

RLB:aw

cc: Mr. W. H. Thomas
Mr. W. C. Bradford



O I L • G A S • M I N E R A L S

693-700

Shop No. 105-112

File No. 1789 AR

Date 27 APRIL 1965 CHAS. A. DIEHL

(Registered)

815 North First Street

Phoenix, Arizona

P. O. Box 1148

VALUES Latest Quotation

Arizona Assay Office

1 oz. Gold.....
1 oz. Silver.....
1 lb. Copper.....
1 lb. Lead.....
1 lb. Zinc.....

Phone ALpine 3-4001

ARKLA EXPLORATION CO
P.O. BOX 1047
KINGMAN ARIZONA

RECEIVED
APR 30 1965
GEOLOGICAL DEPT.

Short Ton 2000 Lbs.
Short Ton Unit 20 Lbs.
Long Ton 2240 Lbs.
Long Ton Unit 22.4 Lbs.

THIS CERTIFIES
Samples submitted for assay
contain as follows:

AFC # 25

P.O.# 014

MARKS	SILVER PER TON		VALUE PER TON	GOLD PER TON		VALUE PER TON	TOTAL VALUE PER TON of Gold & Silver	PERCENTAGE	REMARKS
	Ozs.	Tenths		Ozs.	100ths				
693		.3		TRACE				COPPER 0.025	VIA PHONE OF = cu - highest MOST = .03 to .05
694		.3		TRACE				0.035	
695		.3		TRACE				0.035	
696		.3		NIL				0.06	
697		.3		NIL				0.03	
698		.1		NIL				0.04	
699		.2		NIL				0.03	
700		.4		TRACE				0.03	
#105		.4		TRACE				0.015	
# 106		.3		TRACE				0.02	
# 107	TRACE			NIL				0.055	
# 108		.4		TRACE				0.02	
#109		.4		TRACE				0.015	
# 110		.3		NIL				0.02	
# 111		.3		NIL				0.015	
# 112		.2		TRACW				0.02	

Charges \$ 89.00

Assayer.....

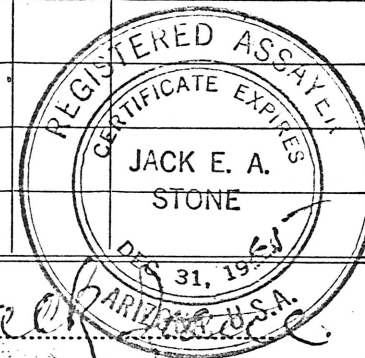

Shop No. 806-820
 File No. 1787 AR

Date 21 APRIL 1965 CHAS. A. DIEHL
 (Registered)

815 North First Street
 Phoenix, Arizona
 P. O. Box 1148

Arizona Assay Office

Phone ALpine 3-4001

ARKLA EXPLORATION CO
 BOX 1047
 KINGMAN ARIZONA

Santa Clause

Short Ton 2000 Lbs.
 Short Ton Unit 20 Lbs.
 Long Ton 2240 Lbs.
 Long Ton Unit 22.4 Lbs.

VALUES
 Latest Quotation

1 oz. Gold.....
 1 oz. Silver.....
 1 lb. Copper.....
 1 lb. Lead.....
 1 lb. Zinc.....

THIS CERTIFIES
 Samples submitted for assay
 contain as follows:

P.O.# 014

MARKS	SILVER PER TON		VALUE PER TON	GOLD PER TON		VALUE PER TON	TOTAL VALUE PER TON of Gold & Silver	PERCENTAGE		REMARKS
	Ozs.	Tenths		Ozs.	100ths			Copper	Mo	
P7 178-78 ⁵ #806		TRACE			TRACE			0.06		
18-188 # 807		.2			NIL			0.02		
65-67 # 808		.4			NIL			0.035		
75-77 # 809		.2			NIL			0.015		
83-85 # 810		.2			TRACE			0.03		
90-92 # 811		.1			TRACE			0.015		
103-104 # 812		.1			NIL			0.02		
113-114 # 813		.1			NIL			0.015		
12-122 # 814		.1			NIL			0.02		
123-129 # 815		.1			NIL			0.03		
132-134 # 816		.1			NIL			0.035		
143-151 # 817		TRACE			TRACE			0.03		
152-161 # 818		TRACE			NIL			0.025		
165-167 # 819		TRACE			NIL			0.015		
172-174 # 820		TRACE			NIL			0.025		

*1 - 3K. to
 L. Gov such
 w/ N.M. A*

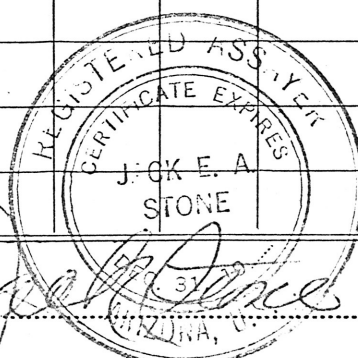

Charges \$ 202.50

Assayer.....

Ship No. 821-831

Date 23 APRIL 1965

CHAS. A. DIEHL
(Registered)

815 North First Street

File No. 1788 AR

Phoenix, Arizona

VALUES
Latest Quotation

Arizona Assay Office

P. O. Box 1148

1 oz. Gold.....
1 oz. Silver.....
1 lb. Copper.....
1 lb. Lead.....
1 lb. Zinc.....

Phone ALpine 3-4001

ARKLA EXPLORATION CO
P.O. BOX 1047
KINGMAN ARIZONA

Short Ton 2000 Lbs.
Short Ton Unit 20 Lbs.
Long Ton 2240 Lbs.
Long Ton Unit 22.4 Lbs.

THIS CERTIFIES
Samples submitted for assay
contain as follows:

P.O.# 014

MARKS	SILVER PER TON		VALUE PER TON	GOLD PER TON		VALUE PER TON	TOTAL VALUE PER TON of Gold & Silver	PERCENTAGE		REMARKS
	Ozs.	Tenths		Ozs.	100ths			COPPER	Mo.	
P4 180-186 # 821		.2			NIL			0.03		13k to L. Gorsuch WPKM-A
189-196 # 822		.2			NIL			0.045		
201-203 # 823		.2			TRACE			0.025		
210-212 # 824		.1			NIL			0.025		
220-222 # 825		.2			NIL			0.055		
230-232 # 826		.2			NIL			0.075		
243-245 # 827		.2			NIL			0.04		
250-252 # 828		.2			NIL			0.02		
260-262 # 829		TRACE			NIL			0.025		
269-271 # 830		TRACE			NIL			0.02		
P4 278-280 # 831		TRACE			NIL			0.05		



Charges \$ 148.50

Assayer.....

ARKANSAS LOUISIANA GAS CO.
 SHREVEPORT, LOUISIANA
 RECEIVED
 MAY 25 1965
 GEOLOGICAL
 DEPT.

ARKLA EXPLORATION CO.
 COMPANY

INTERNAL CORRESPONDENCE

KINGMAN, ARIZONA

DATED AT May 23, 1965

TO: Mr. R. L. Breedlove

FROM: D. P. McCarthy

**SUBJECT: Your request for summary of Drill Holes in Santa Clause Project
 Secs. 34, 26, and 27 T. 23 N. - R. 18 W. Mohave County, Ariz.**

Drill Hole-Rotary or Core TD Location Type Rock @ TD Discovery or Not*

Ray #1	Diamond Core	1709'	2800' N S/L	Hornblende-	Au Assays: 857-865 =.220z/T
			800' W E/L	Biotite-Magnetite	865-867 =.240z/T
			Sec. 34	Schist	
Ray #2	Rotary	682'	3800 N S/L	Sec34 Poss Granite	BR @ TD ----
			1600 W E/L		
Ray #3	Rotary	1272'	3800 N S/L	Sec34 " " " " "	----
			3200 W E/L		
Ray #4	Rot & Dia	519'	2200 N S/L	Sec34 Biotite Granite	Limonite Stained Core
			3300 W E/L		
Pete #1	Rot	85'	200 N S/L, 1550 E W/L	Sec26 Granite	Limonite Stained Ctg.
Pete #2	"	60'	1650 NS/L, 700 E W/L	Sec26 "	Fe & Mn Oxide Stained "
Pete #3	" & Dia	40'	125 S N/L, 100 E W/L	"	Fe & Mn " " Core
Pete #4	Dia	280'	300 S N/L, 150 W E/L	Sec 27 Biotite Granite	Scattered pyrite encountered, specifically noted at 111'
Pete #5	Rot	15'	4740 N S/L, 25 W E/L	Sec 27 Alluvial Sd & Gravel	-----
Pete #6	Rot	12'	4100 N S/L, 25 W E/L	Sec 27 " " "	-----
Pete #7	Rot	20'	3450 N S/L, 25 W E/L	" " Biotite Granite	Geo-Chem anal. of cuttings show over 1000 ppm of Zn & Cu
Pete #8	Rot	10'	2940 N S/L, 25 W E/L	" " Alluv. Sd & Gravel	-----
Pete #9	Rot	14'	5100 N S/L, 1475 E W/L	Sec26 " " " "	-----
Pete #10	Rot	15'	5100 N S/L, 1525 E W/L	" " " "	-----
Pete #11	Rot	10'	4500 N S/L, 1475 E W/L	" " Granite	-----
Pete #12	Rot	10'	4500 N S/L, 1525 E W/L	" " Granite	-----
Pete #13	Rot	11'	3900 N S/L, 1475 E W/L	" " Granite	-----
Pete #14	Rot	15'	3900 N S/L, 1525 E W/L	" " Alluv. Sd & Gravel	-----
Pete #15	Rot	10'	3300 N S/L, 1475 E W/L	" " " "	-----
Pete #16	Rot	10'	3300 N S/L, 1525 E W/L	" " " "	-----
Pete #17	Rot	10'	2700 N S/L, 1475 E W/L	" " " "	-----
Pete #18	Rot	15'	2700 N S/L, 1525 E W/L	" " " "	-----
Pete #19	Rot	10'	2100 N S/L, 1475 E W/L	" " " "	-----
Pete #20	Rot	10'	2100 N S/L, 1525 E W/L	" " " "	-----
Pete #21	Rot	10'	1500 N S/L, 1525 E W/L	" " " "	-----
Pete #22	Rot	10'	900 N S/L, 1475 E W/L	" " " "	-----
Pete #23	Rot	10'	900 N S/L, 1525 E W/L	" " " "	-----
Pete #24	Rot	10'	300 N S/L, 1475 E W/L	" " " "	-----
Pete #25	Dia.	695'	4680 N S/L, 1220 W E/L	" 27 Qtz-Biotite Granite	Traces Native Cu in interval 143 to 308
Pete #26	Dia.	613'	4100 N S/L, 1250 W E/L	" " Biotite Granite	Altered granite, highly silicified, w/pyrite, in interval 500 to 583'
Pete #27	Dia	536'	3750 N S/L, 100 W E/L	Sec.27 Biotite Granite	Tr. Native Cu at 368.

3X. to L. Coorsuch W/ NM-A

New Mexico and Arizona Land Company

808 Bank of New Mexico Building
ALBUQUERQUE, NEW MEXICO

Telephone 242-4044

H. L. Gastler, President
New Mexico and Arizona Land Company
3253 East Mill Street
Springfield, Missouri

RE: WEEKLY CONSOLIDATION REPORT - MOHAVE COUNTY - SANTA CLAUS PROSPECT - COPPER

Pete Claims

Hole #1 Validation

Location: Sec. 26, T. 23N, R. 18W

Remarks: T.D. 85'

Hole #2 Validation

Location: Sec. 26, T. 23N, R. 18W

Remarks: T. D. 60'

Hole #3 Validation

Location: Sec. 26, T. 23N, R. 18W

Remarks: T.D. 40'

Ray Claims

Hole #1 Validation & Core Hole

Location: Sec. 34, T. 23N, R. 18W

Remarks: First T.D. 436', Now Coring. Bottomed in Reworked Granite

Hole #2 Validation & Core Hole

Location: Sec. 34, T. 23N, R. 18W

Remarks: T.D. 665'. Bottomed in Reworked Granite

#1 Core Hole & Validation - Ray Claims

Location: Section 34, Twp. 23N, Rge. 18W

Remarks: Coring 595'

#3 Core Hole & Validation - Ray Claims

Location: Section 34, Twp. 23N, Rge, 18W

Remarks: Coring 315'

#4 Core Hole & Validation - Ray Claims

Location: Section 34, Twp. 23N, Rge. 18W

Remarks: Coring 360'

#4 Validation - Pete Claims

Location: Section 26, T.23N, R18W

Remarks: T.D. 53'-10" D&A Limonite in fractures

#25 Core Hole & Validation - Pete Claims

Location: Section 26. T.23N, R18W

Spud Date: 4/20/65

Remarks: This date at 421' and coring 118' of native copper. Additional assays being run. At the present time very encouraging

#1 Core Hole & Validation - Ray Claims

Location: Section 34, T.23N, R18W

Remarks: T.D. 1383' (3/25/65)

#2 Core Hole & Validation - Ray Claims

Location: Section 34, T23N, R18W

Remarks: T.D. 1272' D&A

#4 Core Hole & Validation - Ray Claims

Location: Section 34, T23N, R18W

Remarks: T.D. 519' D&A

#5 Core Hole & Validation - Pete Claim

Location: Section 26, T.23N, R.18W

Remarks: Drilling at 58'.

#26 Core Hole & Validation - Pete Claim

Location: Section 26, T.23N, R.18W

Spud Date: 5/3/65

Remarks: Core Analysis not available

#25 Core Hole & Validation - Pete Claim

Location: Section 26, T.23N, R.18W

Spud Date:

Remarks: Assays not yet available. Operation in this project will be suspended for the time being until geological interpretations can be completed.

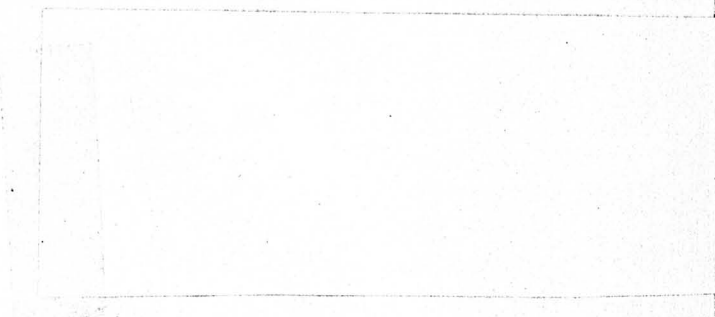

New Mexico and Arizona Land Company

808 Bank of New Mexico Building
ALBUQUERQUE, NEW MEXICO

Telephone 242-4044

H. L. Gastler, President
New Mexico and Arizona Land Company
3253 East Mill Street
Springfield, Missouri

RE: WEEKLY CONSOLIDATION REPORT - MOHAVE COUNTY - SANTA CLAUS PROSPECT - COPPER

Pete Claims

Hole #1 Validation

Location: Sec. 26, T. 23N, R. 18W

Remarks: T.D. 85'

Hole #2 Validation

Location: Sec. 26, T. 23N, R. 18W

Remarks: T. D. 60'

Hole #3 Validation

Location: Sec. 26, T. 23N, R. 18W

Remarks: T.D. 40'

Ray Claims

Hole #1 Validation & Core Hole

Location: Sec. 34, T. 23N, R. 18W

Remarks: First T.D. 436', Now Coring. Bottomed in Reworked Granite

Hole #2 Validation & Core Hole

Location: Sec. 34, T. 23N, R. 18W

Remarks: T.D. 665'. Bottomed in Reworked Granite

#1 Core Hole & Validation - Ray Claims

Location: Section 34, Twp. 23N, Rge. 18W

Remarks: Coring 595'

#3 Core Hole & Validation - Ray Claims

Location: Section 34, Twp. 23N, Rge. 18W

Remarks: Coring 315'

#4 Core Hole & Validation - Ray Claims

Location: Section 34, Twp. 23N, Rge. 18W

Remarks: Coring 360'

#4 Validation - Pete Claims

Location: Section 26, T.23N, R18W

Remarks: T.D. 53'-10" D&A Limonite in fractures

#25 Core Hole & Validation - Pete Claims

Location: Section 26, T.23N, R18W

Spud Date: 4/20/65

Remarks: This date at 421' and coring 118' of native copper. Additional assays being run. At the present time very encouraging

#1 Core Hole & Validation - Ray Claims

Location: Section 34, T.23N, R18W

Remarks: T.D. 1383' (3/25/65)

#2 Core Hole & Validation - Ray Claims

Location: Section 34, T23N, R18W

Remarks: T.D. 1272' D&A

#4 Core Hole & Validation - Ray Claims

Location: Section 34, T23N, R18W

Remarks: T.D. 519' D&A

#5 Core Hole & Validation - Pete Claim

Location: Section 26, T.23N, R.18W

Remarks: Drilling at 58'.

#26 Core Hole & Validation - Pete Claim

Location: Section 26, T.23N, R.18W

Spud Date: 5/3/65

Remarks: Core Analysis not available

#25 Core Hole & Validation - Pete Claim

Location: Section 26, T.23N, R.18W

Spud Date:

Remarks: Assays not yet available. Operation in this project will be suspended for the time being until geological interpretations can be completed.

New Mexico and Arizona Land Company

808 Bank of New Mexico Building
ALBUQUERQUE, NEW MEXICO

Telephone 242-4044

H. L. Gastler, President
New Mexico and Arizona Land Company
3253 East Mill Street
Springfield, Missouri

RE: WEEKLY CONSOLIDATION REPORT - MOHAVE COUNTY - SANTA CLAUS PROSPECT - COPPER

Pete Claims

Hole #1 Validation

Location: Sec. 26, T. 23N, R. 18W

Remarks: T.D. 85'

Hole #2 Validation

Location: Sec. 26, T. 23N, R. 18W

Remarks: T. D. 60'

Hole #3 Validation

Location: Sec. 26, T. 23N, R. 18W

Remarks: T.D. 40'

Ray Claims

Hole #1 Validation & Core Hole

Location: Sec. 34, T. 23N, R. 18W

Remarks: First T.D. 436', Now Coring. Bottomed in Reworked Granite

Hole #2 Validation & Core Hole

Location: Sec. 34, T. 23N, R. 18W

Remarks: T.D. 665'. Bottomed in Reworked Granite

#1 Core Hole & Validation - Ray Claims

Location: Section 34, Twp. 23N, Rge. 18W

Remarks: Coring 595'

#3 Core Hole & Validation - Ray Claims

Location: Section 34, Twp. 23N, Rge. 18W

Remarks: Coring 315'

#4 Core Hole & Validation - Ray Claims

Location: Section 34, Twp. 23N, Rge. 18W

Remarks: Coring 360'

#4 Validation - Pete Claims

Location: Section 26, T.23N, R18W

Remarks: T.D. 53'-10" D&A Limonite in fractures

#25 Core Hole & Validation - Pete Claims

Location: Section 26, T.23N, R18W

Spud Date: 4/20/65

Remarks: This date at 421' and coring 118' of native copper. Additional assays being run. At the present time very encouraging

#1 Core Hole & Validation - Ray Claims

Location: Section 34, T.23N, R18W

Remarks: T.D. 1383' (3/25/65)

#2 Core Hole & Validation - Ray Claims

Location: Section 34, T23N, R18W

Remarks: T.D. 1272' D&A

#4 Core Hole & Validation - Ray Claims

Location: Section 34, T23N, R18W

Remarks: T.D. 519' D&A

#5 Core Hole & Validation - Pete Claim

Location: Section 26, T.23N, R.18W

Remarks: Drilling at 58'.

#26 Core Hole & Validation - Pete Claim

Location: Section 26, T.23N, R.18W

Spud Date: 5/3/65

Remarks: Core Analysis not available

#25 Core Hole & Validation - Pete Claim

Location: Section 26, T.23N, R.18W

Spud Date:

Remarks: Assays not yet available. Operation in this project will be suspended for the time being until geological interpretations can be completed.

#5 Core Hole & Validation - Pete Claim

Location: Section 26, T.23N, R18W

Remarks: Drilling at 58'.

#26 Core Hole & Validation - Pete Claim

Location; Section 26, T.23N, R18W

Spud Date: 5/3/65

Remarks: Core analysis not available

#25 Core Hole & Validation - Pete Claim

Location: Section 26, T23N, R18W

Spud Date:

Remarks: Assays not yet available. Operation in this project will be suspended for the time being until geological interpretations can be completed.

#32 Core Hole & Validation - Pete Claim

Location: Section 26, T.23N, R18W

Spud Date: 5/5/65

Remarks: Total Depth 1253'. Composite percentage of 32-A, B & C equal 24.2% as per radiometric measurements of the Colorado School of Mines Research Foundation

#17 Core Hole & Validation - Pete Claim

Location:

Remarks: Preparing to spud.

ARKLA EXPLORATION CO.

COMPANY

INTERNAL CORRESPONDENCE

KINGMAN, ARIZONA

DATED AT May 23, 1965

TO: Mr. R. L. Broedlove

FROM: D. P. McCarthy

SUBJECT: Your request for summary of Drill Holes in Santa Clause Project
Secs. 34, 26, and 27 T. 23 N. - R. 18 W. Mohave County, Ariz.

Drill Hole-Rotary or Core TD Location Type Rock @ TD Discovery or Not*

Ray #1	Diamond Core	1709'	2800' N S/L 800' W E/L Sec. 34	Hornblende- Biotite-Magnetite Schist	Au Assays: 857-865 =.220z/T 865-867 =.240z/T
Ray #2	Rotary	682'	3800 N S/L 1600 W E/L Sec34	Poss Granite	ER @ TD
Ray #3	Rotary	1272'	3800 N S/L 3200 W E/L Sec34	" " " "	" " " "
Ray #4	Rot & Dia	519'	2200 N S/L 3300 W E/L Sec34	Biotite Granite	Limonite Stained Core
Pete #1	Rot	85'	200 N S/L, 1550 E W/L Sec26	Granite	Limonite Stained Cigs.
Pete #2	"	60'	1650 NS/L, 700 E W/L Sec26	"	Fe & Mn Oxide Stained "
Pete #3	" & Dia	40'	125 S N/L, 100 E W/L "	"	Fe & Mn " " Core
Pete #4	Dia	280'	300 S N/L, 150 W E/L Sec 27	Biotite Granite	Scattered pyrite encountered, specifically noted at 111'
Pete #5	Rot	15'	4740 N S/L, 25 W E/L Sec 27	Alluvial Sd & Gravel	-----
Pete #6	Rot	12'	4100 N S/L, 25 W E/L Sec 27	" " "	-----
Pete #7	Rot	20'	3450 N S/L, 25 W E/L "	Biotite Granite	Geo-Chem anal. of cuttings show over 1000 ppm of Zn & Cu
Pete #8	Rot	10'	2940 N S/L, 25 W E/L "	Alluv. Sd & Gravel	-----
Pete #9	Rot	14'	5100 N S/L, 1475 E W/L Sec26	" " " "	-----
Pete #10	Rot	15'	5100 N S/L, 1525 E W/L "	" " " "	-----
Pete #11	Rot	10'	4500 N S/L, 1475 E W/L "	Granite	-----
Pete #12	Rot	10'	4500 N S/L, 1525 E W/L "	Granite	-----
Pete #13	Rot	11'	3900 N S/L, 1475 E W/L "	Granite	-----
Pete #14	Rot	15'	3900 N S/L, 1525 E W/L "	Alluv. Sd & Gravel	-----
Pete #15	Rot	10'	3300 N S/L, 1475 E W/L "	" " " "	-----
Pete #16	Rot	10'	3300 N S/L, 1525 E W/L "	" " " "	-----
Pete #17	Rot	10'	2700 N S/L, 1475 E W/L "	" " " "	-----
Pete #18	Rot	15'	2700 N S/L, 1525 E W/L "	" " " "	-----
Pete #19	Rot	10'	2100 N S/L, 1475 E W/L "	" " " "	-----
Pete #20	Rot	10'	2100 N S/L, 1523 E W/L "	" " " "	-----
Pete #21	Rot	10'	1500 N S/L, 1525 E W/L "	" " " "	-----
Pete #22	Rot	10'	900 N S/L, 1475 E W/L "	" " " "	-----
Pete #23	Rot	10'	900 N S/L, 1525 E W/L "	" " " "	-----
Pete #24	Rot	10'	300 N S/L, 1475 E W/L "	" " " "	-----
Pete #25	Dia.	695'	4680 N S/L, 1220 W E/L "	27 Qtz-Biotite Granite	Traces Native Cu in interval 143 to 308
Pete #26	Dia.	613'	4100 N S/L, 1250 W E/L "	Biotite Granite	Altered granite, highly silicified, w/pyrite, in interval 500 to 583'
Pete #27	Dia	536'	3750 N S/L, 100 W E/L Sec.27	Biotite Granite	Tr. Native Cu at 368.

A.E.C. #27 PETE
Will spd Mon 5-10-65
T.D. 535' Compl. 5-15-65

CLAIMS HAVE BEEN VALIDATED AS FOLLOWS:
 PETE CLAIM #26 by PETE TEST #5
 " " #24 " " #6
 " " #22 " " #7
 " " #20 " " #8
 " " #17 " " #9
 " " #15 " " #10
 " " #14 " " #11
 " " #13 " " #12
 " " #12 " " #13
 " " #11 " " #14
 " " #10 " " #15
 " " #9 " " #16
 " " #8 " " #17
 " " #7 " " #18
 " " #6 " " #19
 " " #5 " " #20
 " " #4 " " #21
 " " #3 " " #22
 " " #2 " " #23
 " " #1 " " #24

A.E.C. #25
Spd AM 5-3-65 & d-1g 50' @ 4:00 PM
Drig 130' midnight 5-3-65
Coring 413' @ 11:20 AM 5-6-65
T.D. 613' Compl. 5-8-65 @ 5:30 P.M.
 A.E.C.
PETE #25
Spd 4:30 AM in mid afternoon
Drig 100' @ 10:00 PM 4-21-65
T.D. 695' Completed 5-1-65

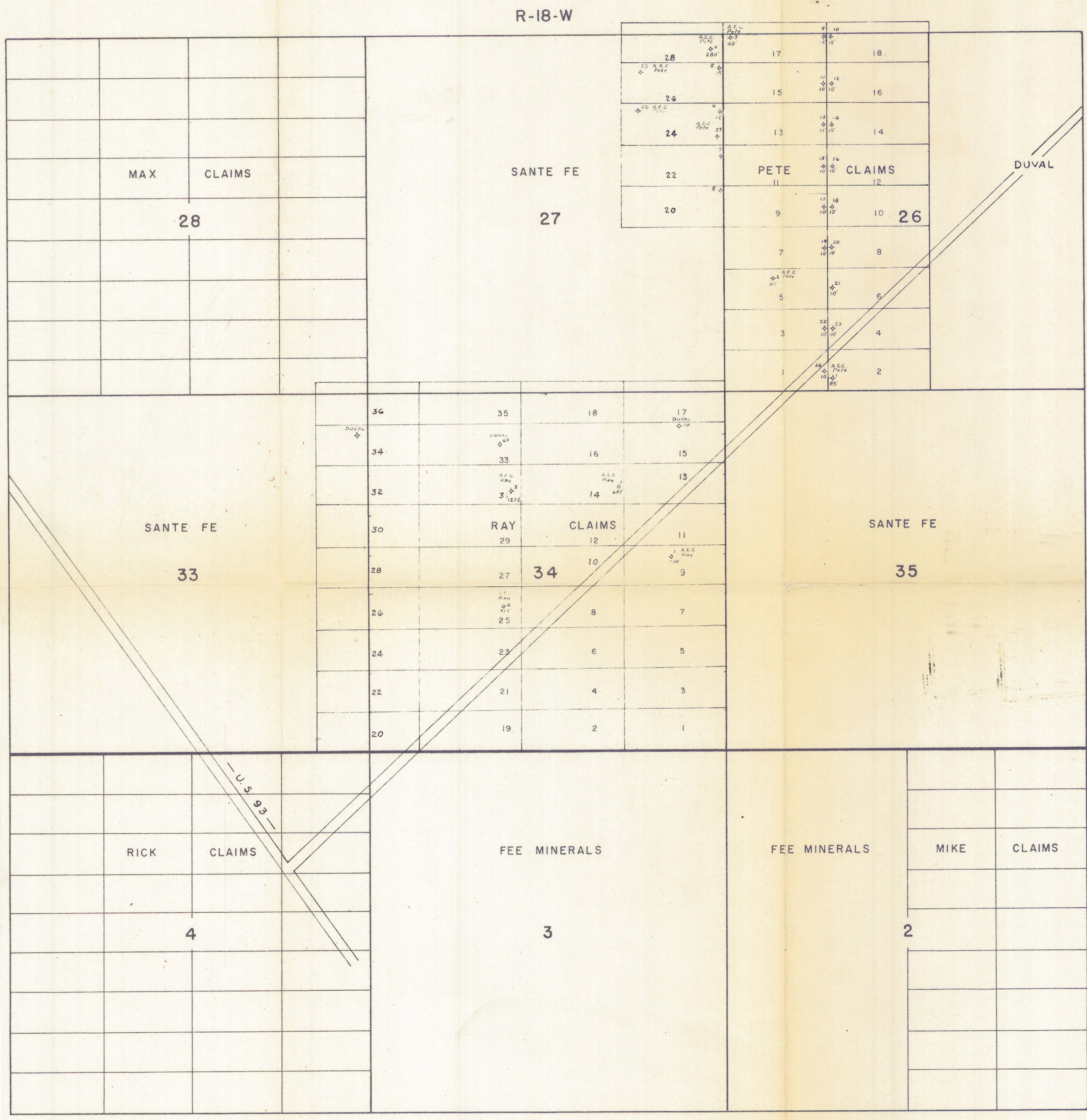

A.E.C. #1
Drig 31' gty, silica & orthoclase. 2-22-65
T.D. 85' D&A

A.E.C. #2
T.D. 60' D&A 2-23-65

A.E.C. #3
T.D. 40'

A.E.C. #4
T.D. 53'-10" D&A Limonite in fractures
Drig 100' @ 10:00 PM 4-15-65
Spd 12:00 PM 4-15-65

A.E.C. #1 RAY
Drig 205' sand & gravel at 5:00 PM. 2-18-65
Drig 430' on 2-21-65
RU to core at 436' on 2-24-65, 1:00 PM.
Coring 2-27-65
Coring 3-1-65
Coring 805' at 3:00 PM. 3-7-65
Coring 834' at 10:00 AM. 3-10-65
892' 3-14-65 at 10:30 AM.
923' A.M. of 3-17-65
1383' 3-25-65
1518' 4-1-65
1614' 4-8-65
1714' 4-15-65

T 23 N
A.E.C. #2 RAY
Drig 14' 07' 2-20-65
Drig 260' at 11:00 AM. 3-50' at 8:30 PM. 2-22-65
Drig 535' at 8:00 PM. 2-23-65
Drig 605' gravel 1:00 PM. 2-24-65
T.D. 602' 5:00 AM 2-25-65
T.D. 662' D&A

A.E.C. #3 RAY
Drig 1-23-65
Spd 2-26-65
Drig 310' on 3-1-65
Drig 850' gravel 3-4-65
Drig 1770' at 8:19 AM 3-7-65
Drig 915' at 8:00 PM 3-10-65
Drig 1105' at 10:00 AM 3-14-65
1215' AM at 4:17 PM
T.D. 1276' D&A

T 22 N
A.E.C. #4 RAY
Spd 2-24-65
Drig 335' 11 PM 3-1-65
Drig 840'
T.D. 517' D&A

DUVAL #49
T.D. at least 500' no water

DUVAL #118
T.D. at least 250' no water

COPIES TO
 W.H.T. ___ J.C.T. ___
 W.C.B. ___
 W.C. ___
 M.L.P. ___
 E.L.G. ___
 H.L.G. ___

DATE: 6-29-65
 By: R.E.B.

(PRELIMINARY MAP)
 ARKLA EXPLORATION COMPANY
 SANTA CLAUS AREA
 MINERAL CLAIMS WITH CORE TESTS
 MOHAVE CO. ARIZONA
 SCALE 1"=1000'

REMARKS: 1. Duval's claims in sec. 34 are "Placer" and A.E.C. are "Lode".
 2. Claims are approx. 1500' X 600' square

Rocky Mountain Geochemical Corporation

P. O. BOX 2217
SALT LAKE CITY, UTAH 84110

Phone 322-2356
Area Code: 801

CERTIFICATE OF ANALYSES

Date June 7, 1968

Page 1

Client Arkla Exploration Co.,
% Gerald Weathers
P.O. Box 971
Wikieup, Arizona

YB-13

Report on: 25 pulp samples

Submitted by: G. Weathers

Date Received: June 5, 1968

Analysis: Copper and Molybdenum.

Remarks: Analysis of Molybdenum determined colorimetrically. Copper determined by atomic absorption. 8 assays reported. Purchase Order No. L 58098. Job. No. 68-14-2 SL.

cc: Enc.
File (2)

LRR:dc

*Arkla
Exploration
#13 Yellow
Basin*

*Scan set
- B -
X - M - A*

All values are reported in parts per million unless specified otherwise. A minus sign (-) is to be read "less than" and a plus sign (+) "greater than." Values in parenthesis are estimates. This analytical report is the confidential property of the above mentioned client and for the protection of this client and ourselves we reserve the right to forbid publication or reproduction of this report or any part thereof without written permission.

ND = None Detected

1 ppm = 0.0001%

1 Troy oz./ton = 34.28 ppm

% Mo x 1.6683 = %MoS₂

Ark' Exploration #13 Yellow Basin

<u>DEPTH</u>	<u>Sample No.</u>	<u>ppm Copper</u>	<u>ppm Molybdenum</u>	<u>AG</u>
YB 13 20'-25'	4001	240	4	(P) END
45'-50'	4002	185	7	
55-60	4003	200	9	
70-75	4004	190	5	
95-100	4005	300	4	
120-125	4006	220	11	(P)
145-150	4007	230	6	
170-175	4008	230	1	
195-200	4009	155	3	
208-211	4010	120	-1	
220-225 →	4011	325	13	(P)
245-250	4012	400	18	
270-275	4013	+1000=0.15%	21	
295-300	4014	570	5	
300-305	4015	520	6	
315-320	4016	670	20	(P)
320-325	4017	370	20	
340-345	4018	710	17	
345-350	4019	360	3	
360-365	4020	+1000=0.12%	23	
365-370	4021	+1000=0.10%	2	(P)
375-380	4022	+1000=0.19%	9	:
380-385	4023	+1000=0.74%	+300=.252%	
385-390	4024	+1000=0.37%	+300=.34%	COPPER W VEIN
420-425	4025	390	18	

Rocky Mountain Geochemical Corporation
Salt Lake City, Utah June 7, 1968

By Lawrence R. Reid
Lawrence R. Reid

J.R. N.W.A.

Property 5-23 1968
YB-13
Location _____
County Mohave
S _____ T _____ R _____
NX Core wea Granite
ARKLA No 4001 20-25
Sample Data: 1-Union
2-RKyMtn

Au, Ag, Pb, Zn, Fe, Mn, Cu, Mo²

240 ppm 4
Sampler _____

Property 5-23 1968
YB-13
Location _____
County Mohave
S _____ T _____ R _____
NX Core wea Granite
ARKLA No 4002 45-50
Sample Data: 2-RKyMtn

Au, Ag, Pb, Zn, Fe, Mn, Cu, Mo⁷²

2 1 185
Sampler _____

Property 5-23 1968
YB-13
Location _____
County Mohave
S _____ T _____ R _____
NX Core wea Granite
ARKLA No 4003 55-60
Sample Data: 2-RKyMtn

Au, Ag, Pb, Zn, Fe, Mn, Cu, Mo²

Sampler _____

Property 5-23 1968
YB-13
Location _____
County Mohave
S _____ T _____ R _____
NX Core wea Granite
ARKLA No 4004 70-75
Sample Data: 2-RKyMtn

Au, Ag, Pb, Zn, Fe, Mn, Cu, Mo²

Sampler _____

Property 5-23 1968
YB-13
Location _____
County Mohave
S _____ T _____ R _____

ARKLA No: 4006 NX Core
wea Granite
120-125
Sample Data:
1-Union
2-RKy Mtn

Au, Ag¹, Pb, Zn, Fe, Mn, Cu, Mo²

Sampler _____

Property 5-23 1968
YB-13
Location _____
County Mohave
S _____ T _____ R _____

ARKLA No: 4005 NX Core
wea Granite
95-100
Sample Data:
2-RKy Mtn

Au, Ag, Pb, Zn, Fe, Mn, Cu, Mo²

Sampler _____

Property 5-23 1968
YB-13
Location _____
County Mohave
S _____ T _____ R _____

ARKLA No: 4008 NX Core wea Granite
120-175
Sample Data:
2-RKy Mtn

Au, Ag, Pb, Zn, Fe, Mn, Cu, Mo²

Sampler _____

Property 5-23 1968
YB-13
Location _____
County Mohave
S _____ T _____ R _____

ARKLA No: 4007 NX Core wea Granite
145-150
Sample Data:
2-RKy Mtn

Au, Ag, Pb, Zn, Fe, Mn, Cu, Mo²

Sampler _____

Property 5-73 1968
YB-3
Location _____
County Mohave
S _____ T _____ R _____

ARKLA No: 4010 NX Core
Wea Granite
208-211
Sample Data: 2-RKy MTH

Au, Ag, Pb, Zn, Fe, Mn, Cu, Mo²

Sampler _____

Property 5-28 1968
YB-13
Location _____
County Mohave
S _____ T _____ R _____

ARKLA No: 4009 NX Core
Wea Granite
195-200
Sample Data: 2-RKy MTH

Au, Ag, Pb, Zn, Fe, Mn, Cu, Mo²

Sampler _____

Property 5-79 1968
YB-13
Location _____
County Mohave
S _____ T _____ R _____

ARKLA No: 4012 NX Core
Wea Granite
245-250
Sample Data: 2-RKy MTH

Au, Ag, Pb, Zn, Fe, Mn, Cu, Mo²

Sampler _____

Property 5-29 1968
YB-13
Location _____
County Mohave
S _____ T _____ R _____

ARKLA No: 4011 NX Core
Wea Granite
220-225
Sample Data: 1-Union
2-RKy MTH

Au, Ag¹, Pb, Zn, Fe, Mn, Cu, Mo²

Sampler _____

Property 5-29 1968
-13
Location _____
County Mohave
S _____ T _____ R _____
NX Core wea Granite
ARKLA No: 4013 270-275-
Sample Data: 2-RKy Mtn

Au, Ag, Pb, Zn, Fe, Mn, Cu, Mo

Sampler _____

Property 5-29 1968
YB-13
Location _____
County Mohave
S _____ T _____ R _____
NX Core wea Granite
ARKLA No: 4014 295-300
Sample Data: 2-RKy Mtn

Au, Ag, Pb, Zn, Fe, Mn, Cu, Mo

Sampler _____

Property 5-29 1968
YB-13
Location _____
County Mohave
S _____ T _____ R _____
NX Core wea Granite
ARKLA No: 4015 300-~~305~~
305-
Sample Data: 2-RKy Mtn

Au, Ag, Pb, Zn, Fe, Mn, Cu, Mo

Sampler _____

Property 5-29 1968
YB-13
Location _____
County Mohave
S _____ T _____ R _____
NX Core wea Granite
ARKLA No: 4016 315-320
Sample Data: 1-Union
2-RKy Mtn

Au, Ag, Pb, Zn, Fe, Mn, Cu, Mo

Sampler _____

5-20 1968
Property _____
Location _____
County Mohave
S _____ T _____ R _____

NX Core
ARKLA No 4017 wea Granite
Sample Data: 320-325
2-RKYMTn

Au, Ag, Pb, Zn, Fe, Mn, Cu, Mo

Sampler _____

5-29 1968
Property YB-13
Location _____
County Mohave
S _____ T _____ R _____

NX Core wea Granite
ARKLA No 4018 340-345
Sample Data: 2-RKYMTn

Au, Ag, Pb, Zn, Fe, Mn, Cu, Mo

Sampler _____

5-29 1968
Property YB-13
Location _____
County Mohave
S _____ T _____ R _____

NX Core wea Granite
ARKLA No 4019 345-350
Sample Data: 2-RKYMTn

Au, Ag, Pb, Zn, Fe, Mn, Cu, Mo

Sampler _____

5-29 1968
Property YB-13
Location _____
County Mohave
S _____ T _____ R _____

NX Core wea Granite
ARKLA No 4020 360-365
Sample Data: 2-RKYMTn

Au, Ag, Pb, Zn, Fe, Mn, Cu, Mo

Sampler _____

Property S-20 1968
YB-1
Location _____
County Mohave
S _____ T _____ R _____

ARKLA No: 4021 NX Core
Wea Granite
Sample Data: 365-370
1-Union
2-RKy Mtn

Au, Ag¹, Pb, Zn, Fe, Mn, Cu, Mo²

Sampler _____

Property S-31 1968
YB-13
Location _____
County Mohave
S _____ T _____ R _____

ARKLA No: 4022 NX Core
Wea Granite
Sample Data: 375-380
2-RKy Mtn

Au, Ag, Pb, Zn, Fe, Mn, Cu, Mo²

Sampler _____

Property S-31 1968
YB-13
Location _____
County Mohave
S _____ T _____ R _____

ARKLA No: 4023 NX Core
Wea Granite
Sample Data: 380-385
2-RKy Mtn

Au, Ag, Pb, Zn, Fe, Mn, Cu, Mo²

Sampler _____

Property S-31 1968
YB-13
Location _____
County Mohave
S _____ T _____ R _____

ARKLA No: 4024 NX Core
Wea Granite
Sample Data: 385-390
2-RKy Mtn

Au, Ag, Pb, Zn, Fe, Mn, Cu, Mo²

Sampler _____

5-31 1968
Property YB-13
Location _____
County Mohave
S _____ T _____ R _____

ARKLA No: 4025 NX Core
Sample Data: Wea Granite
420-425
2-RKY MTH

Au, Ag, Pb, Zn, Fe, Mn, Cu, Mo

Sampler _____

#1 Core Hole & Validation - Ray Claims

Location: Section 34, Twp. 23N, Rge. 18W

Remarks: Coring 595'

#3 Core Hole & Validation - Ray Claims

Location: Section 34, Twp. 23N, Rge. 18W

Remarks: Coring 315'

#4 Core Hole & Validation - Ray Claims

Location: Section 34, Twp. 23N, Rge. 18W

Remarks: Coring 360'

May 26, 1967

Mr. H. B. Parker, Auditor
New Mexico and Arizona Land Company
3253 East Trafficway
Springfield, Missouri

Dear Mr. Parker:

Reference your letter of May 25, 1967, Santa Claus Project, referenced project is status quo as of this date.

The only activity is trying to defend claims that have been State or Government land which is adjoining that which was the old Santa Claus Project originally. It is questionable whether any additional expenditures will be made this year in this area.

Very truly yours,

E. L. Gorsuch

ELG:ko

cc: Mr. George Bailey, St. Louis
Mr. G. M. Rayburn, St. Louis

NEW MEXICO AND ARIZONA LAND COMPANY

~~806 OLIVE STREET, ST. LOUIS, MISSOURI 63101~~

H. B. PARKER
AUDITOR

3253 East Trafficway
Springfield, Missouri 65802
May 25, 1967

AIR MAIL

Mr. E. L. Gorsuch, Vice President
New Mexico & Arizona Land Company
1130 Bank of New Mexico Building
222 4th Street, N.W.
Albuquerque, New Mexico 87101

Dear Mr. Gorsuch:

Please furnish, by return air mail,
status of Santa Claus project under Arkla contract.

Yours very truly,

H. B. Parker
HBP

cc: Messrs. G. M. Rayburn
G. E. Bailey

January 31, 1967

Mr. G. M. Rayburn, President
New Mexico and Arizona Land Company
906 Olive Street
St. Louis, Missouri

Re: Santa Clause Area
Sections 26 and 27
T. 23N, R. 18W

Dear Mr. Rayburn:

Pursuant to our discussion as of this date referencing Santa Clause Project, Mohave County, Arizona, herewith you will find executed copy of Agreement to validate claims to Santa Clause Project, Sections 26 and 27, Township 23 North, Range 18 West.

You will note that "which we are sure we will find" is underlined and that means we must find mineral of economic value to extend these claims within a period of time.

Very truly yours,

E. L. Gorsuch

ELG:ko
Enc.



ARKLA EXPLORATION COMPANY (a wholly owned subsidiary of)
ARKANSAS LOUISIANA GAS COMPANY
and the NEW MEXICO AND ARIZONA LAND COMPANY
OKLAHOMA CITY, OKLAHOMA

P. O. Box 1439

February 15, 1965

Request for Prospecting Permits

Mr. T. H. Rodgers
Land Commissioner
Santa Fe Pacific Railroad Company
4549 Produce Plaza
Los Angeles, California 90058

Dear Mr. Rodgers:

This letter is a request for prospecting permits covering Sections 27, 33 and 35, in Township 23 North, Range 18 West, Mohave County, Arizona, subject to the following terms and conditions:

The rental of \$2 per acre with the acreage being held equal to the amount of \$10 per acre spent at the end of the first year. Royalty terms will be negotiated similar to those of the State of Arizona when a commercial discovery has been made.

The Arkla Exploration Company and the New Mexico and Arizona Land Company are currently engaged in an extensive exploratory program for numerous minerals in the State of Arizona, and have been for the last two years. Currently, we have approximately 35 engineers and geologists, plus the following consulting firms working in our behalf:

Dames and Moore, Los Angeles; Research Institute of Colorado at Colorado School of Mines, Golden, Colorado; Walter and Heinerich of Tucson; Western Knapp of San Francisco; and A. I. Levenson, as advisors.

Should a commercial deposit of ore be found, we are prepared to handle all of the operations with the assistance of the above staffs.

Very truly yours,

W. C. Bradford

W. C. Bradford, Exploration Coordinator
ARKLA EXPLORATION COMPANY

E. L. Gorsuch

E. L. Gorsuch, Vice President
NEW MEXICO AND ARIZONA LAND COMPANY

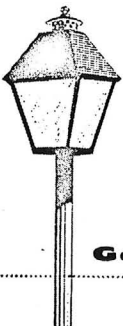

ARKLA EXPLORATION CO.

COMPANY

INTERNAL CORRESPONDENCE

DATED AT KINGMAN, ARIZONA
12/5/65

TO: Mr. R. L. Breadlove

FROM: D. P. McCarthy

SUBJECT: Your request for list of drill holes on Mohave Project and locations.

Following is the list of Drill Holes completed during 1964 on the Mohave Tract:

DRILL HOLE	CLAIM	TD	DATES		LOCATION				
			START	COMPL.	N/S line	E/W line	Sec.	Tsp	Rn
1 Northside #1	Northside #3	351	7/15/64	7/30/64	30'	1670'	14	17N	19W
2 Paycheck #1	Paycheck #3	230	7/30/64	8/4/64	3940'	5240'	22	17N	19W
3 Badger #1	Badger #1	122	8/6/64	9/3/64	3550'	3280'	18	18N	18W
4 Finger #1	Finger #8	185.5	8/4/64	8/10/64	1330'	4510'	9	17N	19W
5 Chuck #1	Stan #5	119	8/7/64		2370'	4500'	1	18N	19W
6 Don #1	Don #4	180	8/10/64	8/13/64	1000'	5180'	8	17N	19W
7 4-Buttes #1	4-Buttes #1	77			5160'	2120'	1	18N	19W
8 Stan #1	Stan #10	162	8/13/64	8/17/64	5240'	2350'	1	18N	19W
9 Clint #1	Clint #3	135	8/13/64	8/15/64	3680'	5080'	17	17N	19W
10 Badger #2	Badger #7	77	8/18/64	8/19/64	3650'	2680'	18	18N	18W
11 Northside #2	Northside #3	684	8/17/64	9/11/64	200'	1440'	14	17N	19W
12 Nosam #1	Nosam #4	111	8/18/64	8/21/64	4080'	4180'	15	19N	19W
13 Lil #1	Lil #2	100	8/25/64	8/27/64	850'	1660'	10	17N	19W
14 Matilda #1	Matilda #3	396	8/27/64	9/11/64	1270'	820'	9	17N	19W
15 Ted #1	Ted #2	120	9/12/64	9/14/64	5160'	1820'	15	17N	19W
16 Extension #1	Extension #2	102	9/14/64	9/15/64	3640'	770'	14	17N	19W
17 West End #1	West End #4	130	9/14/64	9/16/64	1160'	1800'	35	17N	19W
18 Matilda #2	Matilda #8	603	9/ /64	10/ /64	1420'	2100'	9	17N	19W

ARKANSAS LOUISIANA GAS CO.
SHREVEPORT, LOUISIANA
RECEIVED
DEC 7 1965
GEOLOGICAL
DEPT.

D. P. McCarthy

Shop No. 1025-1028
 File No. 1810 A R

Date 28 JUNE 1965

Phoenix, Arizona 85
 P. O. BOX 1148

Arizona Assay Office

815 NORTH FIRST STREET

Phone: 253-4001

ARKLA EXPLORATION CO

P.O. BOX 1047

KINGMAN ARIZONA

P.O.# 014

VALUES
 Latest Quotation

- 1 oz. Gold.....
- 1 oz. Silver.....
- 1 lb. Copper.....
- 1 lb. Lead.....
- 1 lb. Zinc.....

THIS CERTIFIES
 Samples submitted for assay
 contain as follows:

Short Ton
 Short Ton Unit
 Long Ton
 Long Ton Unit

MARKS	SILVER PER TON		VALUE PER TON	GOLD PER TON		VALUE PER TON	TOTAL VALUE PER TON of Gold & Silver	PERCENTAGE				REI
	Ozs.	Tenths		Ozs.	100ths			COPPER				
1025		.6		.02		\$.70		1.55				
1026		.6		TRACE								
1027		TRACE		TRACE								
1028		TRACE		NIL				0.025				

*3 K. to
 L. 90
 W. N. M. A*

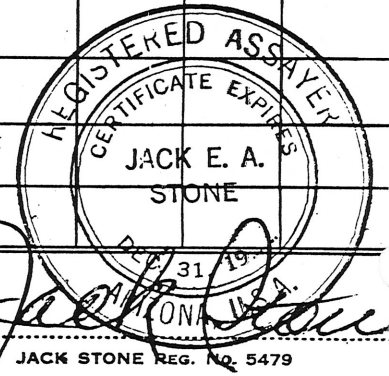

Charges \$ \$19.00
~~17.50~~

Assayer Jack Stone
 JACK STONE REG. No. 5479

ANDY CHUKA, PRINT

Shop No. 1118-1120

Date: 28 JUNE 1965

File No. 1811 A R

VALUES
Latest Quotation

- 1 oz. Gold.....
- 1 oz. Silver.....
- 1 lb. Copper.....
- 1 lb. Lead.....
- 1 lb. Zinc.....

THIS CERTIFIES
Samples submitted for assay
contain as follows:

Arizona Assay Office

815 NORTH FIRST STREET

Phone: 253-4001

ARKLA EXPLORATION CO

P.O. BOX 1047

KINGMAN ARIZONA P.O.# 014

Phoenix, Arizona 85

P. O. BOX 1148

Short Ton

Short Ton Unit

Long Ton

Long Ton Unit

MARKS	SILVER PER TON		VALUE PER TON	GOLD PER TON		VALUE PER TON	TOTAL VALUE PER TON of Gold & Silver	PERCENTAGE				RE	
	Ozs.	Tenths		Ozs.	100ths			COPPER					
1118		.2		.02		\$.70		0.02					
1119		.1		TRACE				0.045					
1120		.1		TRACE				0.025					

*3X to each
L. M. A
WJ*

Charges \$ 16.50

ANDY CHUKA, PRINT

Assayer *Jack Stone*

JACK STONE REG. NO. 5479

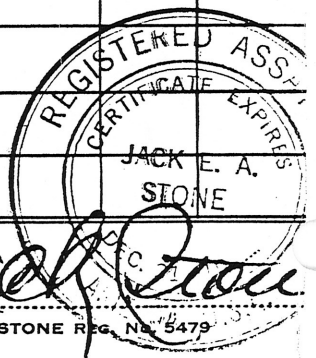

Shop No. 1020-1024

Date... 8th JI 1965

File No. 1808 A R

VALUES
Latest Quotation

- 1 oz. Gold.....
- 1 oz. Silver.....
- 1 lb. Copper.....
- 1 lb. Lead.....
- 1 lb. Zinc.....

THIS CERTIFIES
Samples submitted for assay
contain as follows:

Arizona Assay Office

815 NORTH FIRST STREET

Phone: 253-4001

ARKLA EXPLORATION CO
BOX 1047
KINGMAN ARIZONA

Phoenix, Arizona 8500

P. O. BOX 1148

Short Ton 20
Short Ton Unit
Long Ton 22
Long Ton Unit 22

MARKS	SILVER PER TON		VALUE PER TON	GOLD PER TON		VALUE PER TON	TOTAL VALUE PER TON of Gold & Silver	PERCENTAGE				REMA
	Ozs.	Tenths		Ozs.	100ths			Copper	LEAD	ZINC	Mo.	
1020	8	.8		.20		\$ 7.00		0.17	5.40	2.80		
1021	1	.3		.04		\$ 1.40		0.09	TRACE	1.00	0.002	
1022		.8		.02		\$.70		0.08	TRACE	0.80	0.002	
1023	2	.8		0.03		\$ 1.05		0.11	0.20	2.80	0.002	
1024	4	.4		0.04		\$ 1.40		0.43	TRACE	0.30	0.001	

3K-to:
Lee Gorsuch
WVA

Charges \$ 82.00

ANDY CHUKA, PRINT

Assayer.....
Jack Stone
JACK STONE REG. No. 5379
ARIZONA

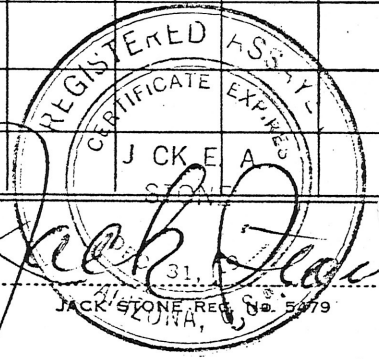

Shop No. 1108-1117
 File No. 1809 A R
VALUES
 Latest Quotation

1 oz. Gold.....
 1 oz. Silver.....
 1 lb. Copper.....
 1 lb. Lead.....
 1 lb. Zinc.....

THIS CERTIFIES
 Samples submitted for assay
 contain as follows:

Date 23 JUN 19

CHAS. A. DIEHL
 (Registered)

815 North First Street
 Phoenix, Arizona
 P. O. Box 1148

Arizona Assay Office

Phone ALpine 3-4001

ARKLA EXPLORATION CO
 BOX 1047
 KINGMAN ARIZONA

Short Ton 2000 Lbs.
 Short Ton Unit 20 Lbs.
 Long Ton 2240 Lbs.
 Long Ton Unit 22.4 Lbs.

MARKS	SILVER PER TON		VALUE PER TON	GOLD PER TON		VALUE PER TON	TOTAL VALUE PER TON of Gold & Silver	PERCENTAGE				REMARKS
	Ozs.	Tenths		Ozs.	100ths			Copper	LEAD	ZINC	MO.	
1108	.6			Nil				0.04	Trace	1.00	0.001	
1109	.6			NIL				0.03	Trace	0.80	0.002	
1110	.4			NIL				0.045	Trace	1.80	0.001	
1111	.8			0.01		\$.35		0.03	Trace	0.80	0.001	
1112	.4			Nil				0.035	Trace	1.00	0.002	
1113	.4			NIL				0.05	Trace	1.80	0.003	
1114	.4			Nil				0.18	Trace	1.30	0.002	
1115	.8			.01		\$.35		0.07	Trace	1.60	0.001	
1116	.4			Nil				0.045	Trace	0.90	0.001	
1117	.4			Nil				0.02	Trace	0.70	0.001	

3x to
 Lee Gorsuch
 NM-A

Charges \$ 180.00

Assayer.....

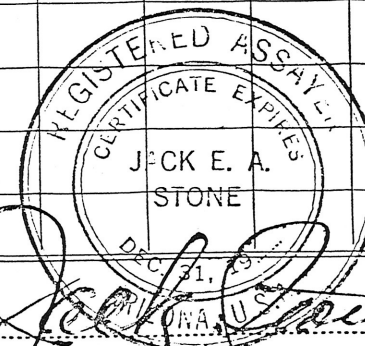

Shop No. 1019

Date 7 JUNE 1965

File No. 1807 A.R.

VALUES
Latest Quotation

- 1 oz. Gold.....
- 1 oz. Silver.....
- 1 lb. Copper.....
- 1 lb. Lead.....
- 1 lb. Zinc.....

THIS CERTIFIES
Samples submitted for assay
contain as follows:

Arizona Assay Office

815 NORTH FIRST STREET

Phone: 253-4001

Phoenix, Arizona 85001

P. O. BOX 1148

ARKLA EXPLORATION CO
BOX 1047
KINGMAN ARIZONA

P.O. 014

Short Ton 2000 Lb
Short Ton Unit 20 Lb
Long Ton 2240 Lb
Long Ton Unit 22.4 Lt

MARKS	SILVER PER TON		VALUE PER TON	GOLD PER TON		VALUE PER TON	TOTAL VALUE PER TON of Gold & Silver	PERCENTAGE				REMARKS
	Ozs.	Tenths		Ozs.	100ths							
1019		.5			TRACE							

*3X
Le P Gorsuch
w/ A. M. - A.*

Charges \$ 4.00

ANDY CHUKA, PRINT

Assayer.....

Jack Stone
JACK STONE REG. NO. 3479

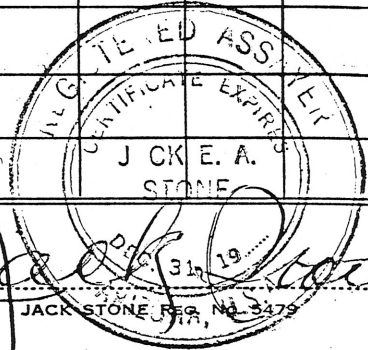

Shop No. 1101-07
 File No. 1906 A.R.

Date 4 1965

Phoenix, Arizona 85001
 P. O. BOX 1148

Arizona Assay Office

815 NORTH FIRST STREET

Phone: 253-4001

ARELA EXPLORATION CO

P.O. BOX 1047
 KINGMAN ARIZONA

P.O. # 014

Short Ton 2000
 Short Ton Unit 20
 Long Ton 2240
 Long Ton Unit 22.4

VALUES
 Latest Quotation

- 1 oz. Gold.....
- 1 oz. Silver.....
- 1 lb. Copper.....
- 1 lb. Lead.....
- 1 lb. Zinc.....

THIS CERTIFIES
 Samples submitted for assay
 contain as follows:

MARKS	SILVER PER TON		VALUE PER TON	GOLD PER TON		VALUE PER TON	TOTAL VALUE PER TON of Gold & Silver	PERCENTAGE			REMARK
	Ozs.	Tenths		Ozs.	100ths			COPPER	Mo.		
SEC 12 T22N R12W APEX ADIT #3		.5		.01		\$.35		0.28			5 1/2' CH.
1101		.5		TRACE				0.51			2 1/2' CH.
APEX PIT #2		.4		TRACE				0.83			2 1/2' CH.
1102				.01		\$.35					1' CH.
APEX ADIT #1								0.46	X		REP OF
1103								1.03	X		1' CH.
SEC 22 T26N R21W WILLIAMSON				.02		\$.70		0.52			SAMPLE A PERIMERY
1104		.5									
WILLIAMSON											
1105											
WILLIAMSON											
1106											
WILLIAMSON											
1107											
WILLIAMSON											

Charges \$ 53.50

Lee Gorsuch
W7 N M - A

Assayer *Jack Stone*



ANDY CHUKA, PRINT

ARKLA EXPLORATION

COMPANY

INTERNAL CORRESPONDENCE

DATED AT KINGHAM
6-7-65

TO: R. L. B.

FROM: G. W.

SUBJECT: ASSAYS

ENCLOSED ARE ASSAYS OF SAMPLES TAKEN FROM CLAIMS
IN THE BLACK MOUNTAINS IMMEDIATELY WEST OF THE
CERBAT RANGE, SHOWING THAT COPPER MINERALIZATION
PERSISTS IN THIS RANGE AND COULD BE PRESENT
UNDER THE ALLUVIAL COVER BETWEEN THE TWO RANGES.
A FIELD PROPERTY EXAMINATION FORM AND SKETCHES
HAVE BEEN PREPARED FOR THE PROPERTIES.

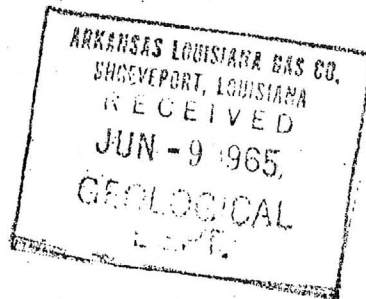

3X
E G
W N M - A

Shop No. 154-164
 File No. 1804 A.R.

Date 20 MAY 1965

CHAS. A. DIEHL
 (Registered)

815 North First Street
 Phoenix, Arizona
 P. O. Box 1148

VALUES
 Latest Quotation

1 oz. Gold
 1 oz. Silver
 1 lb. Copper
 1 lb. Lead
 1 lb. Zinc

Arizona Assay Office

Phone ALpine 3-4001

ARKLA EXPLORATION CO
 BOX 1047
 KINGMAN ARIZONA

P.O. # 014

Short Ton 20
 Short Ton Unit 2
 Long Ton 224
 Long Ton Unit 22

THIS CERTIFIES
 Samples submitted for assay
 contain as follows:

MARKS	SILVER PER TON		VALUE PER TON	GOLD PER TON		VALUE PER TON	TOTAL VALUE PER TON of Gold & Silver	PERCENTAGE		REMAI
	Ozs.	Tenths		Ozs.	100ths			Copper	Mo.	
# 154		.4		NIL				0.02	0.001	
# 155		.4		TRACE				0.015	0.001	
# 156		.4		NIL				0.045	0.002	
# 157		.4		NIL				0.04	0.001	
# 158		.4		TRACE				0.035	0.001	
# 159		.4		NIL				0.05	0.001	
# 160		.3		NIL				0.045	0.001	
# 161		.3		NIL				0.045	0.001	
# 162		.6		TRACE				0.015	0.001	
# 163		.6		NIL				0.02	0.002	
# 164		.6		NIL				0.11	0.001	

3X. to:
 Lee Gorsuch
 of A.M. - A. Co.

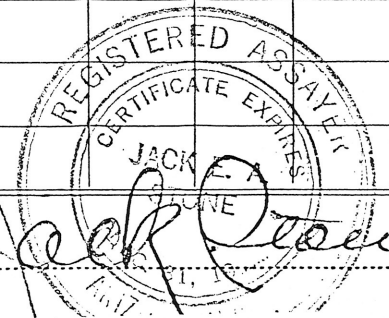

Charges \$ 148.50

Assayer.....

LABORATORY NUMBER	MARK	P.O. #014	<u>Molybdenum</u>
1105-07 1806 A.R	<u>Arkla</u>		0.001
	# 1105		0.001
	# 1106		0.002
	# 1107		

3X to:
L. G. Gossuch
W. N. M. A.



ARKLA Expl. Co.

COMPANY

INTERNAL CORRESPONDENCE

DATED AT KINGMAN, ARIZ
5/27/65

TO: R. L. B

FROM: D.P.M.

SUBJECT: Identification of Assays Nos: 154 - 164 INCL.

- 154 Pete #27 440-443 $\frac{1}{2}$: white & gray gouge zone, clay and fine frags. of granite.
- 155 " " 443 $\frac{1}{2}$ -445 $\frac{1}{2}$: Same
- 156 " " 457-459 : Crs. ex. peg. granite w/ some frags stained w/ limonite
- 157 " " 466-468 : white granite w/ minor amt. of biotite
Fracs. vert and at 30° to core. Seams lined w/ green waxy clay. Occ. limonite.
- 158 " " 475-477 : Gray biotite granite, limonite on occ. frags. and in adjacent core.
- 159 " " 485-487 : wh. biotite granite, thin vert. frac w/ pyrite
- 160 " " 495-497 : " " "
- 161 " " 507-509 : Lt gray biotite granite
- 162 " " 515-517 : " " hard, dense, f. textured granite.
- 163 " " 523-524 $\frac{1}{2}$: Gray, f.-textured, hard, granite
- 164 " " 532-534 : Hard, gray, granite.

3X. to:
Lee Gorsuch
w/ N.M.A.

[Signature]

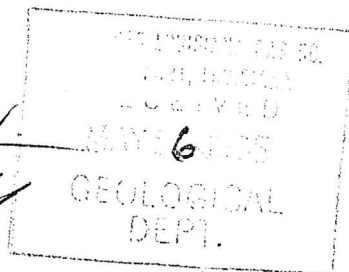

Shop No. 943-954 Date..... May 1965

File No. 1803 A.R.

CHAS. A. DIEHL
(Registered)

815 North First S

Phoenix, Arizo

P. O. Box 114

VALUES
Latest Quotation

Arizona Assay Office

Phone Alpine 3-4001

ARKLA EXPLORATION CO
BOX 1047
KINGMAN ARIZONA

- 1 oz. Gold.....
- 1 oz. Silver.....
- 1 lb. Copper.....
- 1 lb. Lead.....
- 1 lb. Zinc.....

- Short Ton
- Short Ton Unit
- Long Ton
- Long Ton Unit

THIS CERTIFIES
Samples submitted for assay
contain as follows:

P.O. # 014

MARKS	SILVER PER TON		VALUE PER TON	GOLD PER TON		VALUE PER TON	TOTAL VALUE PER TON of Gold & Silver	PERCENTAGE	
	Ozs.	Tenths		Ozs.	100ths			COPPER	
<u>P-27</u>									
<u>304-306</u> 943		<u>.1</u>		<u>NIL</u>				<u>0.025</u>	
<u>315-317</u> 944		<u>.1</u>		<u>TRACE</u>				<u>0.025</u>	
<u>325-327</u> 945		<u>.4</u>		<u>TRACE</u>				<u>0.035</u>	
<u>335-337</u> 946		<u>.1</u>		<u>NIL</u>				<u>0.03</u>	
<u>345-347</u> 947		<u>.1</u>		<u>NIL</u>				<u>0.025</u>	
<u>351-353</u> 948		<u>.3</u>		<u>NIL</u>				<u>0.01</u>	
<u>367-369</u> 949		<u>.2</u>		<u>NIL</u>				<u>0.03</u>	
<u>371-376</u> 950		<u>.2</u>		<u>TRACE</u>				<u>0.035</u>	
<u>383-385</u> 951		<u>.2</u>		<u>NIL</u>				<u>0.04</u>	
<u>392-394</u> 952		<u>.2</u>		<u>TRACE</u>				<u>0.035</u>	
<u>406-408</u> 953		<u>.2</u>		<u>TRACE</u>				<u>0.035</u>	
<u>416-418</u> 954		<u>.2</u>		<u>NIL</u>				<u>0.03</u>	
<u>P-27 - A</u>									

3x. to Lee Co. w/N

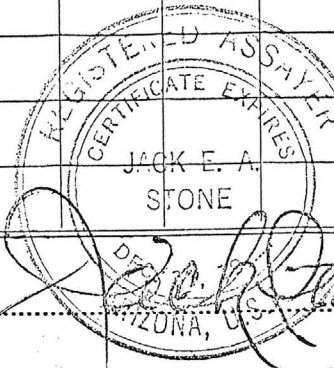

Charges \$.....66.00.....

Assayer.....

ANDY CHUKA, PRINT

Shop No.

Date.....

CHAS. A. DIEHL
(Registered)

815 North First St

File No.

Phoenix, Arizona

P. O. Box 1148

VALUES
Latest Quotation

Arizona Assay Office

Phone ALpine 3-4001

- 1 oz. Gold.....
- 1 oz. Silver.....
- 1 lb. Copper.....
- 1 lb. Lead.....
- 1 lb. Zinc.....

ARKLA EXPLORATION CO
BOX 1047
KINGMAN ARIZONA

Short Ton

Short Ton Unit

Long Ton

Long Ton Unit

THIS CERTIFIES
Samples submitted for assay
contain as follows:

P.O. # 014

MARKS	SILVER PER TON		VALUE PER TON	GOLD PER TON		VALUE PER TON	TOTAL VALUE PER TON of Gold & Silver	PERCENTAGE	
	Ozs.	Tenths		Ozs.	100ths			COPPER	
187-186 931		.4		TRACE				0.03	
192-194 932		.4		TRACE				0.02	
202-204 933		.5		.01	\$.35			0.03	
215 ^s -217 ^s 934		.5		NIL				0.04	
222 ^s -224 ^s 935		.5		TRACE				0.045	
240-242 936		.2		NIL				0.025	
247-249 937		.2		NIL				0.07	
256-258 938		.2		TRACE				0.055	
267-269 939		.2		NIL				0.055	
278-280 940		.2		NIL				0.015	
286-288 941		.2		NIL				0.02	
296-298 942		.2		NIL				0.025	

3x. fo. Lee Co w/ N/A

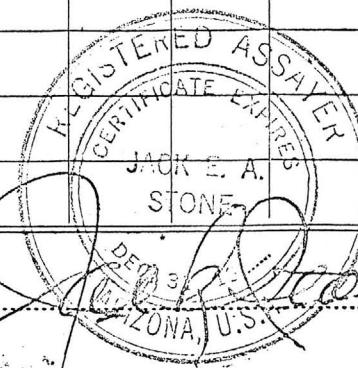

Charges \$..... 66.00.....

Assayer.....

ANDY CHUKA, PRINT

Shop No. 916-930

File No. 1801 A R

VALUES
Latest Quotation

Date.....

MAY 1965

CHAS. A. DIEHL
(Registered)

815 North First S

Phoenix, Arizona

P. O. Box 114

Arizona Assay Office

Phone ALpine 3-4001

ARKLA EXPLORATION CO
BOX 1047
KINGMAN ARIZONA

Short Ton

Short Ton Unit

Long Ton

Long Ton Unit

- 1 oz. Gold.....
- 1 oz. Silver.....
- 1 lb. Copper.....
- 1 lb. Lead.....
- 1 lb. Zinc.....

THIS CERTIFIES
Samples submitted for assay
contain as follows:

P.O. # 014

MARKS	SILVER PER TON		VALUE PER TON	GOLD PER TON		VALUE PER TON	TOTAL VALUE PER TON of Gold & Silver	PERCENTAGE	
	Ozs.	Tenths		Ozs.	100ths			COPPER	
P-27 43-45 916		.2			NIL			0.01	
51-53 917		.2			NIL			0.03	
60-62 918		.2			TRACE			0.01	
72-74 910		.2			NIL			0.015	
81-83 920		.2			NIL			0.025	
92 ^S -94 ^S 921		.2			NIL			0.035	
94-96 922		.2			NIL			0.03	
106-108 923		.2			NIL			TRACE	
118-120 924		.3			NIL			0.01	
120-122 925		.3			NIL			0.01	
132-134 926		.3			NIL			0.015	
144-146 927		.3			TRACE			0.02	
155-157 928		.4			TRACE			0.05	
160-162 929		.4			.01	\$.35		0.02	
174-176 930		.4			TRACE			0.025	

3X-t
Lee Cor
w/8.11

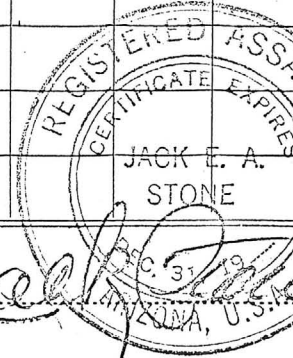

P-27
Charges \$..... 82.50.....

Assayer.....

ANDY CHUKA, PRINT

LABORATORY NO.
140-150
1800AR

MARK
140
141
142
143
144
145
146
147
148
149
150

15 May 1965

PERCENTAGES
KINGMAN ARIZONA
EXPLORATION CO
Molybdenum

0.007
0.002
0.001
0.005
0.002
0.005
0.004
0.005
0.003
0.001
0.001

3X. to:
Lee Gorsuch
WY N.M. - A.

XXXXB



Shop No. 154-164

Date 20 M 1965

CHAS. A. DIEHL
(Registered)

815 North First Street

File No. 1804 A R.

VALUES
Latest Quotation

Arizona Assay Office

Phoenix, Arizona

P. O. Box 1148

1 oz. Gold.....

1 oz. Silver.....

1 lb. Copper.....

1 lb. Lead.....

1 lb. Zinc.....

Phone ALpine 3-4001

ARKLA EXPLORATION CO
BOX 1047
KINGMAN
ARIZONA

Short Ton 2000 Lbs.

Short Ton Unit 20 Lbs.

Long Ton 2240 Lbs.

Long Ton Unit 22.4 Lbs.

THIS CERTIFIES
Samples submitted for assay
contain as follows:

P.O. # 014

MARKS	SILVER PER TON		VALUE PER TON	GOLD PER TON		VALUE PER TON	TOTAL VALUE PER TON of Gold & Silver	PERCENTAGE		REMARKS
	Ozs.	Tenths		Ozs.	100ths			COPPER	Mo.	
154		.4			NIL			0.02	X	<i>3x fo: Lee Gorsuch W N.A.A.</i>
155		.4			TRACE			0.015	X	
156		.4			NIL			0.045	X	
157		.4			NIL			0.04	X	
158		.4			TRACE			0.035	X	
159		.4			NIL			0.05	X	
160		.3			NIL			0.045	X	
161		.3			NIL			0.045	X	
162		.6			TRACE			0.015	X	
163		.6			NIL			0.02	X	
164		.6			NIL			0.11	X	

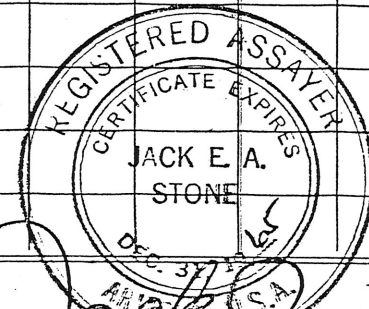

Charges \$ 148.50

Assayer *Jack E. A. Stone*

890-899
 Shop No.
 File No. 1798 A R
VALUES
 Latest Quotation

Date: MAY 1965

Arizona Assay Office

815 NORTH FIRST STREET

ARKLA EXPLORATION CO Phone: 253-4001
 BOX 1047
 KINGMAN ARIZONA

Phoenix, Arizona 85001
 P. O. BOX 1148

- 1 oz. Gold.....
- 1 oz. Silver.....
- 1 lb. Copper.....
- 1 lb. Lead.....
- 1 lb. Zinc.....

THIS CERTIFIES
 Samples submitted for assay
 contain as follows:

Short Ton 2000 Lbs.
 Short Ton Unit 20 Lbs.
 Long Ton 2240 Lbs.
 Long Ton Unit 22.4 Lbs.

P. O. # 014

MARKS	SILVER PER TON		VALUE PER TON	GOLD PER TON		VALUE PER TON	TOTAL VALUE PER TON of Gold & Silver	PERCENTAGE				REMARKS	
	Ozs.	Tenths		Ozs.	100ths			COPPER					
890		.3			NIL			0.02					
891		.3			NIL			0.025					
892		.2			NIL			0.03					
893		.4			NIL			0.01					
894		.4			NIL			0.02					
895		.4			NIL			0.03					
896		.3			NIL			0.025					
897		.2			NIL			0.015					
898		.2			NIL			0.03					
899		.3			NIL			0.03					

3x to Lee Gorsach WNM-A.

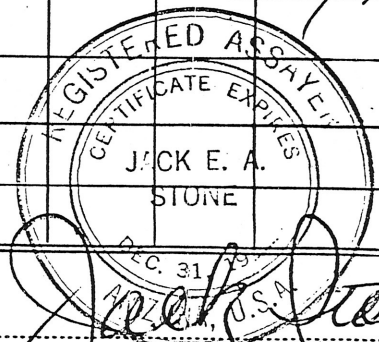

Charges \$ 55.00

Assayer.....

ANDY CHUKA, PRINT

JACK STONE REG. NO. 5479

10. TIC

PERCENTAGES

7 May 1965

MARK

LABORATORY NO.

900-915
17994 AR

P-266

Retention Time	Percentage
427-429	0.002
429-451	0.001
447-449	0.003
453 ⁵ -455 ⁵	0.002
461-463	0.002
470 ⁵ -472 ⁵	Trace
478 ⁵ -480 ⁵	Trace
488-490	Trace
496-498	Trace

P-266

3X
Lee Gorsuch
WV NM-A

XXXX



Shop No. 151-153
 File No. 1799 A R.

Date MAY 1965

Phoenix, Arizona 85001
 P. O. BOX 1148

Arizona Assay Office

815 NORTH FIRST STREET
 Phone: 253-4001

VALUES
 Latest Quotation

1 oz. Gold.....
 1 oz. Silver.....
 1 lb. Copper.....
 1 lb. Lead.....
 1 lb. Zinc.....

ARKLA EXPLORATION CO
 KINGMAN ARIZONA

Short Ton 2000 Lbs.
 Short Ton Unit 20 Lbs.
 Long Ton 2240 Lbs.
 Long Ton Unit 22.4 Lbs.

THIS CERTIFIES
 Samples submitted for assay
 contain as follows:

MARKS	SILVER PER TON		VALUE PER TON		GOLD PER TON		VALUE PER TON	TOTAL VALUE PER TON of Gold & Silver	PERCENTAGE			REMARKS	
	Ozs.	Tenths			Ozs.	100ths			NO.				
# 151												TRACE	
#152												TRACE	
#153												0.02	

*3/11/65
 Lee Garsach
 W/M-A*

Assayer.....

Jack Stone
 JACK STONE REG. NO. 5479
 PHOENIX, ARIZONA, U.S.A.

Charges \$ XXXX

ANDY CHUKA, PRINT

Shop No. 890-899

Date 11 Y 1965

File No.

V A U S A R
Latest Quotation

1 oz. Gold.....

1 oz. Silver.....

1 lb. Copper.....

1 lb. Lead.....

1 lb. Zinc.....

THIS CERTIFIES
Samples submitted for assay
contain as follows:

Arizona Assay Office

815 NORTH FIRST STREET

Phone: 253-4001

ARKLA EXPLORATION CO
BOX 1047
KIIDMAN ARIZONA

Phoenix, Arizona 85001

P. O. BOX 1148

Short Ton 2000 Lbs.

Short Ton Unit 20 Lbs.

Long Ton 2240 Lbs.

Long Ton Unit 22.4 Lbs.

P.L.C.	MARKS	SILVER PER TON		VALUE PER TON	GOLD PER TON		VALUE PER TON	TOTAL VALUE PER TON of Gold & Silver	PERCENTAGE			REMARKS
		Ozs.	Tenths		Ozs.	100ths						
295-297	890		.3			NIL			0.03			
300-309	891		.3			NIL			0.035			
317-319	892		.2			NIL			0.03			
320-322	893		.4			NIL			0.01			
330-390	894		.4			NIL			0.03			
344-396	895		.4			NIL			0.03			
350-358	896		.3			NIL			0.035			
364-366	897		.2			NIL			0.015			
371-376	898		.2			NIL			0.03			
4286	899		.3			NIL			0.03			

Charges \$ 55.00

ANDY CHUKA, PRINT

Assayer.....

REGISTERED
CERTIFICATE
USA PAT.
OFFICE
JACK E. STONE
31
JACK STONE REG. NO. 5479

W. Lee Gorsuch
W. H. M. T.

Shop No. 151-153

File No. 1799 A R

VALUES
Latest Quotation

- 1 oz. Gold.....
- 1 oz. Silver.....
- 1 lb. Copper.....
- 1 lb. Lead.....
- 1 lb. Zinc.....

THIS CERTIFIES
Samples submitted for assay
contain as follows:

MAY 1965

Arizona Assay Office

815 NORTH FIRST STREET

Phone: 253-4001

ARKLA EXPLORATION CO
BOX 1047
KINGMAN ARIZONA

P.O.# 014

Phoenix, Arizona 85001

P. O. BOX 1148

Short Ton 2000 Lbs.
Short Ton Unit 20 Lbs.
Long Ton 2240 Lbs.
Long Ton Unit 22.4 Lbs.

MARKS	SILVER PER TON		VALUE PER TON	GOLD PER TON		VALUE PER TON	TOTAL VALUE PER TON of Gold & Silver	PERCENTAGE		REMARKS
	Ozs.	Tenths		Ozs.	100ths			Copper	No.	
151		.5			TRACE			0.02	X	
152		.5			TRACE			0.04	X	
153		1.0			.01	\$.35		0.045	X	

Charges \$ 40.50

ANDY CHUKA, PRINT

B. C. Lee
ARKLA

Assayer

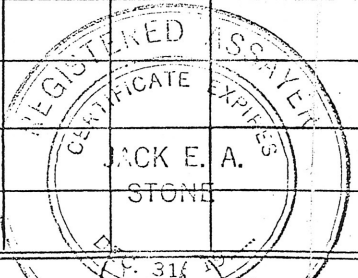

JACK STONE REG. No. 5479

Shop No. 140-150
 File No. 1800 A-R
 VALUES
 Latest Quotation

Date 15 Nov 1965 CHAS. A. DIEHI
 (Registered)

815 North First Street
 Phoenix, Arizona
 P. O. Box 1148

Arizona Assay Office

Phone Alpine 3-4001

- 1 oz. Gold.....
- 1 oz. Silver.....
- 1 lb. Copper.....
- 1 lb. Lead.....
- 1 lb. Zinc.....

ARKLA EXPLORATION CO
 BOX 1047
 KINGMAN ARIZONA

Short Ton 2000 Lbs.
 Short Ton Unit 20 Lbs.
 Long Ton 2240 Lbs.
 Long Ton Unit 22.4 Lbs.

THIS CERTIFIES
 Samples submitted for assay
 contain as follows:

P.O. # 014

MARKS	SILVER PER TON		VALUE PER TON	GOLD PER TON		VALUE PER TON	TOTAL VALUE PER TON of Gold & Silver	PERCENTAGE		REMARKS
	Ozs.	Tenths		Ozs.	100ths			COPPER	Mo.	
#140		.3			TRACE			0.015	X	
#141		.3			TRACE			0.02	X	
#142		.3			TRACE			0.015	X	
#143		.3			NIL			0.025	X	
#144		.4			NIL			0.055	X	
#145		.4			NIL			0.025	X	
#146		.3			NIL			0.02	X	
#147		.3			NIL			0.02	X	
#148		.3			NIL			0.01	X	
#149		.3			NIL			0.015	X	
#150		.4			NIL			0.045	X	

\$ 148.50

*3X - See Enclsure
 W/ NMA*

Assayer

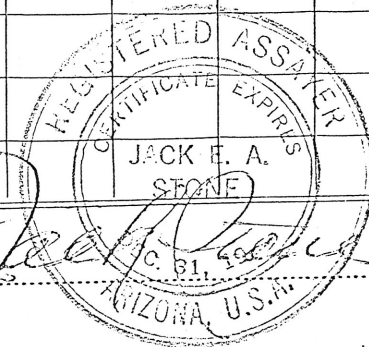

Shop No. 943-954
 File No. 1803 A R.

Date 17 MAY 1965

CHAS. A. DUFFL
 (Registered)

815 North First Street
 Phoenix, Arizona
 P. O. Box 1148

VALUES
 Latest Quotation

1 oz. Gold.....
 1 oz. Silver.....
 1 lb. Copper.....
 1 lb. Lead.....
 1 lb. Zinc.....

Arizona Assay Office

Phone ALpine 3-4001

ARKIA EXPLORATION CO
 BOX 1047
 KINGMAN ARIZONA

P.O. # 014

THIS CERTIFIES
 Samples submitted for assay
 contain as follows:

Short Ton 2000 Lbs.
 Short Ton Unit 20 Lbs.
 Long Ton 2240 Lbs.
 Long Ton Unit 22.4 Lbs.

MARKS	SILVER PER TON		VALUE PER TON	GOLD PER TON		VALUE PER TON	TOTAL VALUE PER TON of Gold & Silver	PERCENTAGE			REMARKS
	Ozs.	Tenths		Ozs.	100ths			COPPER			
943		.1			NIL			0.025			
944		.1			TRACE			0.025			
945		.4			TRACE			0.035			
946		.1			NIL			0.03			
947		.1			NIL			0.025			
948		.3			NIL			0.01			
949		.2			NIL			0.03			
950		.2			TRACE			0.035			
951		.2			NIL			0.04			
952		.2			TRACE			0.035			
953		.2			TRACE			0.035			
954		.2			NIL			0.03			

3X-izee Gorsuch
W.N.M.-A.

Charges \$ 66.00

Assayer.....

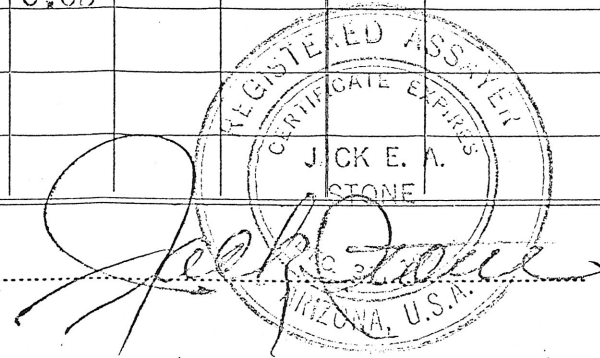

Shop No. 916-930

File No. 1801 A-R

VALUES
Latest Quotation

1 oz. Gold.....

1 oz. Silver.....

1 lb. Copper.....

1 lb. Lead.....

1 lb. Zinc.....

THIS CERTIFIES
Samples submitted for assay
contain as follows:

Date 16 MAR 1965

CHAS. A. DIEHL
(Registered)

Arizona Assay Office

Phone ALpine 3-4001

ARKIA EXPLORATION CO
BOX 1047
KINGMAN ARIZONA

815 North First Street

Phoenix, Arizona

P. O. Box 1148

Short Ton 2000 Lbs.

Short Ton Unit 20 Lbs.

Long Ton 2240 Lbs.

Long Ton Unit 22.4 Lbs.

) P.O. # 014

MARKS	SILVER PER TON		VALUE PER TON	GOLD PER TON		VALUE PER TON	TOTAL VALUE PER TON of Gold & Silver	PERCENTAGE			REMARKS
	Ozs.	Tenths		Ozs.	100ths			COPPER			
916		.2		NIL				0.01			
917		.2		NIL				0.03			
918		.2		TRACE				0.01			
919		.2		NIL				0.015			
920		.2		NIL				0.025			
921		.2		NIL				0.035			
922		.2		NIL				0.03			
923		.2		NIL				TRACE			
924		.3		NIL				0.01			
925		.3		NIL				0.01			
926		.3		NIL				0.015			
927		.3		TRACE				0.02			
928		.4		TRACE				0.05			
929		.4		.01		\$.35		0.02			
930		.4		TRACE				0.025			

Charges \$ 82.50

3X - Bee Carsack
w/ N.M.-A.
Assayer.....

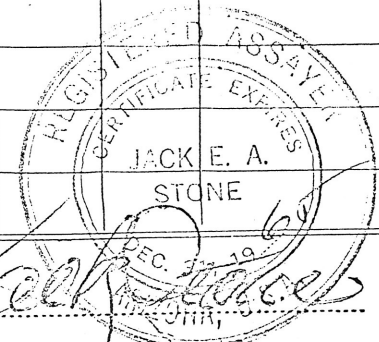

Shop No. 931, 942
 File No. 1802 A R
 VALUES
 Latest Quotation

Date 16 Y. 1965 CHAS. A. DIEHL
 (Registered)

815 North First Street
 Phoenix, Arizona
 P. O. Box 1148

Arizona Assay Office

Phone ALpine 3-4001

- 1 oz. Gold.....
- 1 oz. Silver.....
- 1 lb. Copper.....
- 1 lb. Lead.....
- 1 lb. Zinc.....

ARKLA EXPLORATION CO
 BOX 1047
 KINGMAN ARIZONA

P.O. # 014

Short Ton 2000 Lbs.
 Short Ton Unit 20 Lbs.
 Long Ton 2240 Lbs.
 Long Ton Unit 22.4 Lbs.

THIS CERTIFIES
 Samples submitted for assay
 contain as follows:

MARKS	SILVER PER TON		VALUE PER TON	GOLD PER TON		VALUE PER TON	TOTAL VALUE PER TON of Gold & Silver	PERCENTAGE				REMARKS	
	Ozs.	Tenths		Ozs.	100ths			COPPER					
931		.4			TRACE			0.03					
932		.4			TRACE			0.02					
933		.5			.01	\$.35		0.03					
934		.5			NIL			0.04					
935		.5			TRACE			0.045					
936		.2			NIL			0.025					
937		.2			NIL			0.07					
938		.2			TRACE			0.055					
939		.2			NIL			0.055					
940		.2			NIL			0.015					
941		.2			NIL			0.02					
942		.2			NIL			0.025					

Charges \$ 66.00

Chas. A. Diehl
 Assayer
w/ N.M.A.

Chas. A. Diehl
 ASSAYER
 STONE

ARKLA EXPLORATION CO.

COMPANY

INTERNAL CORRESPONDENCE

DATED AT Phoenix, Arizona
May 17, 1965

TO: R. L. Breedlove
FROM: Gerald Weathers
SUBJECT: Samples Submitted for Assay
May 15, 1965

Sample No.	Hole No.	Depth	Description
916	P-27	43-45	Weathered biotite gneissic granite
917	P-27	51-53	"
918	P-27	60-62	"
919	P-27	72-74	"
920	P-27	81-83	" Coarser texture
921	P-27	92.5-94.5	" "
922	P-27	94-96	Biotite gneissic granite
923	P-27	106-108	Pegmatitic
924	P-27	118-120	"
925	P-27	120-122	"
926	P-27	132-134	Biotite Gneissic Granite, weathered
927	P-27	144-146	" " " "
928	P-27	155-157	" abundant limonite staining
929	P-27	160-162	"
930	P-27	174-176	"
931	P-27	184-186	"
932	P-27	192-194	"
933	P-27	202-204	"
934	P-27	215.5-217.5	Diorite, altered
935	P-27	222.5-224.5	Clay gouge
936	P-27	240-242	Biotite Gneissic granite
937	P-27	247-249	"
938	P-27	256-258	"
939	P-27	267-269	"
940	P-27	278-280	Diorite
941	P-27	286-288	Biotite Gneissic granite
942	P-27	296-298	"
943	P-27	304-306	Diorite
944	P-27	315-317	"
945	P-27	325-327	"
946	P-27	335-337	"
947	P-27	345-347	Biotite gneissic granite, weathered - dendritic manganese along fracture planes

*3X. Lee Gorsuch
at N M-A*

Sample No.	Hole No.	Depth	Description
948	P-27	351-353	Biotite gneissic granite, weathered - dendritic manganese along fracture planes
949	P-27	367-369	Weathered gneissic resiliicified granite, native copper leafs disseminated throughout core
950	P-27	374-376	Weathered gneissic granite, oxidized, limonite stained
951	P-27	383-385	"
952	P-27	392-394	Same, soft green clay mineral
953	P-27	406-408	Weathered gneissic granite
954	P-27	416-418	Pegmatitic

3X - Lee Gorsuch
WYNN-A

Shop No. 859-870

Date 8 MAY 1965

CHAS. A. DIEHL
(Registered)

815 North First Street

File No. 1795 AR

Phoenix, Arizona

VALUES
Latest Quotation

Arizona Assay Office

P. O. Box 1148

Phone ALpine 3-4001

- 1 oz. Gold.....
- 1 oz. Silver.....
- 1 lb. Copper.....
- 1 lb. Lead.....
- 1 lb. Zinc.....

ARKIA EXPLORATION CO
BOX 1047
KINGMAN ARIZONA

- Short Ton 2000 Lbs.
- Short Ton Unit 20 Lbs.
- Long Ton 2240 Lbs.
- Long Ton Unit 22.4 Lbs.

THIS CERTIFIES
Samples submitted for assay
contain as follows:

P.O. # 014

MARKS	SILVER PER TON		VALUE PER TON	GOLD PER TON		VALUE PER TON	TOTAL VALUE PER TON of Gold & Silver	PERCENTAGE			REMARKS
	Ozs.	Tenths		Ozs.	100ths			COPPER			
859		.4			TRACE			0.015			
860		.3			TRACE			0.015			
861		.4			NIL			0.03			
862		.6			NIL			0.015			
863		.6			NIL			0.015			
864		.6			NIL			0.03			
865		.3			NIL			0.01			
866		.3			NIL			0.015			
867		.3			NIL			0.015			
868		.3			TRACE			0.015			
869		.3			NIL			0.025			
870		.3			NIL			0.035			

*177X to Garsuch
M.A.*

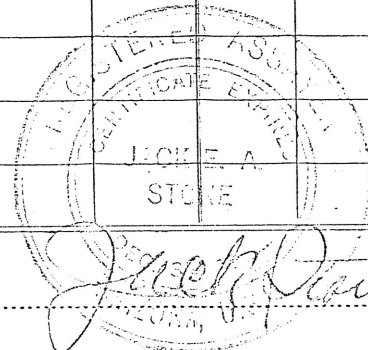

Charges \$.....66.00.....

Assayer.....*Chas. A. Diehl*.....

Shop No. 871-882
 File No. 1796 A R

Date 9 MAY 1965

CHAS. A. DIEHL
 (Registered)

815 North First Street
 Phoenix, Arizona
 P. O. Box 1148

Arizona Assay Office

Phone ALpine 3-4001

VALUES
 Latest Quotation

1 oz. Gold.....
 1 oz. Silver.....
 1 lb. Copper.....
 1 lb. Lead.....
 1 lb. Zinc.....

ARKLA EXPLORATION CO
 BOX 1047
 KINGMAN ARIZONA

Short Ton 2000 Lbs.
 Short Ton Unit 20 Lbs.
 Long Ton 2240 Lbs.
 Long Ton Unit 22.4 Lbs.

THIS CERTIFIES
 Samples submitted for assay
 contain as follows:

P. O. # 014

MARKS	SILVER PER TON		VALUE PER TON	GOLD PER TON		VALUE PER TON	TOTAL VALUE PER TON of Gold & Silver	PERCENTAGE			REMARKS
	Ozs.	Tenths		Ozs.	100ths			COPPER			
871		.2			NIL			0.01			
872		.3			NIL			0.02			
873		.1			NIL			0.01			
874		.2			NIL			0.01			
875		.2			NIL			0.02			
876		.1			NIL			0.01			
877		.2			NIL			0.025			
878		.2			NIL			0.035			
879		.1			NIL			0.065			
880		.2			NIL			0.025			
881		.3			NIL			0.04			
882		.4			NIL			0.045			

fo
mt
Goosuch
N/A
W

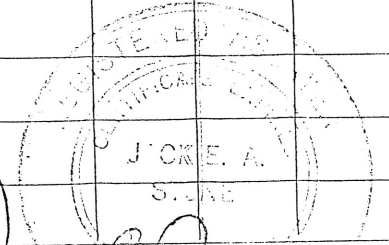

Charges \$ 66.00

Assayer *Jack Diehl*

Shop No. 883-889
 File No. 1797 A R

Date 20 MAY 1965

Phoenix, Arizona 85001
 P. O. BOX 1148

Arizona Assay Office

815 NORTH FIRST STREET

Phone: 253-4001

VALUES
 Latest Quotation

1 oz. Gold.....
 1 oz. Silver.....
 1 lb. Copper.....
 1 lb. Lead.....
 1 lb. Zinc.....

ARKLA EXPLORATION CO
 BOX 1047
 KINGMAN ARIZONA

P.O.# 014

Short Ton 2000 L
 Short Ton Unit 20 L
 Long Ton 2240 L
 Long Ton Unit 22.4 L

THIS CERTIFIES
 Samples submitted for assay
 contain as follows:

MARKS	SILVER PER TON		VALUE PER TON	GOLD PER TON		VALUE PER TON	TOTAL VALUE PER TON of Gold & Silver	PERCENTAGE				REMARKS
	Ozs.	Tenths		Ozs.	100ths			COPPER				
883		.1			NIL			0.025				
884		.1			TRACE			0.02				
885		.3			NIL			0.015				
886		.3			NIL			0.035				
887		.2			nil			0.015				to Gov
888		.3			NIL			0.015				W
889		.4			NIL			0.015				

APPROVED
 JACK E. A. STONE
 ASSAYER
 JACK STONE REG. No. 5479

Charges \$ 38.50

Assayer.....

ANDY CHUKA, PRINT



}

}

|

Shop No. 581
 File No. 1777-AR
VALUES
 Latest Quotation

1 oz. Gold.....
 1 oz. Silver.....
 1 lb. Copper.....
 1 lb. Lead.....
 1 lb. Zinc.....

THIS CERTIFIES
 Samples submitted for assay
 contain as follows:

Date 25 MARCH 1965 CHAS. A. DIEHL
 (Registered)

Arizona Assay Office

Phone ALpine 3-4001

ARKLA EXPLORATION CO
 P.O. BOX 1047
 KINGMAN ARIZONA

P.O.# 014

*1 3/4 to
 L. Borsuch
 W/NMA*

815 North First Street
 Phoenix, Arizona
 P. O. Box 1148

Short Ton 2000 Lbs.
 Short Ton Unit 20 Lbs.
 Long Ton 2240 Lbs.
 Long Ton Unit 22.4 Lbs.

MARKS	SILVER PER TON		VALUE PER TON	GOLD PER TON		VALUE PER TON	TOTAL VALUE PER TON of Gold & Silver	PERCENTAGE		REMARKS
	Ozs.	Tenths		Ozs.	100ths			Copper	LEAD	
581 <i>847-849</i>		TRACE			TRACE			0.03		Nil
582 <i>849-850</i>		TRACE			TRACE			0.03		Nil
583 <i>850-855</i>		TRACE			TRACE			0.03		Nil
584 <i>855-857</i>		TRACE			TRACE			0.01		Nil
585 <i>857-865</i>		.3			.22	\$ 7.70		0.03		Nil
586 <i>865-867</i>		.3			.24	\$ 8.40		0.02		Nil
587 <i>867-875</i>		.3			TRACE			0.02		Nil
588 <i>875-885</i>		.2			TRACE			0.02		Nil
589 <i>885-886</i>		.2			NIL			0.025		Nil
590 <i>886-887</i>		.2			NIL			0.03		Nil
591 <i>887-888</i>		.2			NIL			0.015		Nil
592 <i>888-889</i>		TRACE			TRACE			0.015		Nil
(SPEC) 593		4.0			.02	\$.70		0.175	0.20	***
<i>Spec not along for nothing check</i> 594		1.2			.44	\$ 15.40			TRACE	

Charges \$ 10.00 Spectrograph
 176.00
 \$ 186.00 TOTAL

ANDY CHUKA, PRINT

Assayer *Jack Stone*

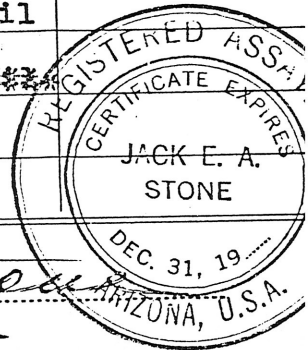

Shop No. 615
File No. 1780 AR

Date 28 MARCH 1965

CHAS. A. DIEHL
(Registered)

1/24 To Lee Hanson w/ NMA

815 North First Street
Phoenix, Arizona
P. O. Box 1148

Arizona Assay Office

Phone ALpine 3-4001

ARKLA EXPLORATION CO
P.O. BOX 1047
KINGMAN ARIZONA

VALUES
Latest Quotation

- 1 oz. Gold.....
- 1 oz. Silver.....
- 1 lb. Copper.....
- 1 lb. Lead.....
- 1 lb. Zinc.....

THIS CERTIFIES
Samples submitted for assay
contain as follows:

P.O.# 014

- Short Ton 2000 Lbs.
- Short Ton Unit 20 Lbs.
- Long Ton 2240 Lbs.
- Long Ton Unit 22.4 Lbs.

MARKS	SILVER PER TON	VALUE PER TON	GOLD PER TON	VALUE PER TON	TOTAL VALUE PER TON of Gold & Silver	PERCENTAGE		REMARKS
						Ozs.	Tenths	
615 1211-1213	.4		TRACE			0.02	8.80	
616 1218-1226	.2		TRACE			0.025	8.40	
617 1233-1235	.1		NIL			0.02		
618 1243 1/2 - 1245 1/2	TRACE		TRACE			0.02	8.00	
619 1256-1258	TRACE		TRACE			0.03		
620 1272-1274	TRACE		TRACE			0.025	7.40	
621 1282-1284	TRACE		.005	178		0.02	9.40	
622 1294-1297	TRACE		NIL			0.015	3.00	

Charges \$ 44.00

Assayer.....

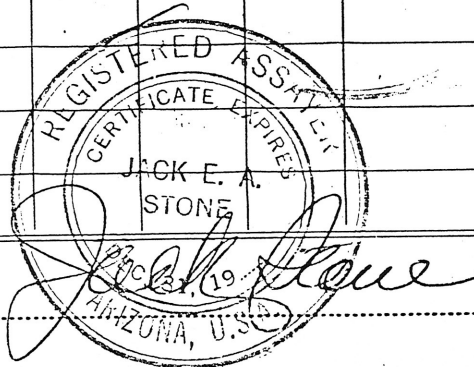

Shop No. 625-629
 File No. 1783 AR

Date April 1965

*1 yr
Lee Gosman
w/NMA*

Phoenix, Arizona 85001
 P. O. BOX 1148

Arizona Assay Office

815 NORTH FIRST STREET

Phone: 253-4001

ARKLA EXPLORATION CO

VALUES
 Latest Quotation

1 oz. Gold.....
 1 oz. Silver.....
 1 lb. Copper.....
 1 lb. Lead.....
 1 lb. Zinc.....

Short Ton 2000 Lbs.
 Short Ton Unit 20 Lbs.
 Long Ton 2240 Lbs.
 Long Ton Unit 22.4 Lbs.

THIS CERTIFIES
 Samples submitted for assay
 contain as follows:

MARKS	SILVER PER TON		VALUE PER TON	GOLD PER TON		VALUE PER TON	TOTAL VALUE PER TON of Gold & Silver	PERCENTAGE		REMARKS
	Ozs.	Tenths		Ozs.	100ths			COPPER	IRON	
	625 <i>KEY 1 1085-87</i>	.5			TRACE					
626 <i>1503 1/2 - 1506</i>	.4		TRACE				0.04	7.90		
627 <i>1526 1/2 - 1528</i>	.4		TRACE				0.035	8.30		
628 <i>1550 - 1552</i>	.4		TRACE				0.045	7.80		
629 <i>1567 1/2 - 1570 1/2</i>	.4		TRACE				0.025	10.40		

Charges \$ 42.50

ANDY CHUKA, PRINT

Assayer.....

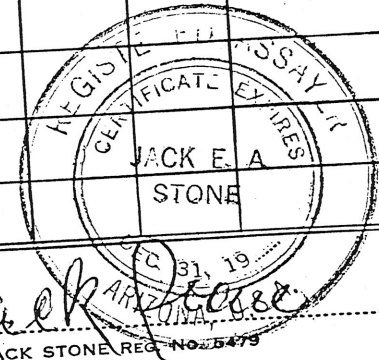



)

)

)

)

ARKLA EXPLORATION

COMPANY

INTERNAL CORRESPONDENCE

DATED AT KINGMAN, ARIZ

3-29-65

TO: P. L. BREED LOVE

FROM: G. WEATHERS

SUBJECT: GEOCHEM RETURNS FOR SAMPLES NUMBERED 757 THRU 777

ENCLOSED IS THE ROCKY MTN GEOCHEM LAB ANALYTICAL ~~REPORT~~
REPORT FOR SAMPLES 757-THRU-777. THE DRILL HOLE NOS.
AND DEPTH INTERVALS HAVE BEEN PLACED ADJACENT TO
THE CORRESPONDING SAM. NO. IT IS PLANNED TO PREPARE
A TABLE IN WHICH ASSAYS ARE COMPARED WITH GEOCHEM
RESULTS WHEN BOTH ARE RECEIVED.

1 copy to
Lee Starnach
W/NMA

ARKANSAS LOUISIANA GAS CO.
MONROE, LOUISIANA
RECEIVED
MAR 31 1965
GEOLOGICAL
DEPT.

ROCKY MOUNTAIN GEOCHEMICAL LABORATORIES

233 North Marina Street

Phone: 445-4393

PRESCOTT, ARIZONA

ANALYTICAL REPORT

Date March 27, 1965

Page 1 of 2

Client Mr. Gerald Weathers
Arkansas Louisiana Gas Co.
P.O. Box 1047
Kingman, Arizona

Report on 21 Rock samples

Sample Data Sheet of Inst. 3-23-65

Submitted by G. Weathers

Date 3-23-65

Analysis Copper, Zinc, Lead, Molybdenum, Silver

Remarks Colorimetric methods used. Pulps to be returned.

cc: encl.
file

*1 photo
Lee Shuman
w/INMA*

All values are reported in parts per million unless specified otherwise. A minus sign (-) is to be read "less than" and a plus sign (+) "greater than". Values in parenthesis are estimates. This analytical report is the confidential property of the above mentioned client and for the protection of this client and ourselves we reserve the right to forbid publication or reproduction of this report or any part thereof without written permission.

Field No.	Copper	Zinc	Lead	Molybdenum	Silver
517-518-3					
517-518-3 757	10	85	35	1	-1
R-1 758	45	40	-5	1	-1
20-222 759	60	55	-5	1	-1
231-233 760	45	40	-5	-1	1
248-250 761	45	65	10	-1	-1
252-261 762	40	65	15	1	-1
272-272 ⁵ 763	20	60	5	-1	-1
272-281 764	10	25	20	7	-1
293-225 765	50	80	-5	-1	-1
303-1005 766	40	75	5	-1	-1
314-1016 767	65	55	10	1	1
333-1035 768	60	45	15	1	1
344-1046 769	50	60	10	-1	-1
360-1062 770	40	25	10	1	-1
380-1082 771	25	40	-5	-1	-1
399-1101 772	45	65	10	1	-1
424-1126 773	45	35	-5	1	-1
444-1146 774	55	45	10	1	-1
456-1158 775	65	40	-5	-1	-1
483-1185 776	60	45	90	1	-1
491-1203 777	55	30	-5	1	-1

1 pkg to
Lee Stanch
W/NMA

E. A. Johnson
E. A. Johnson

ROCKY MOUNTAIN GEOCHEMICAL LABORATORIES

233 North Marina Street

Phone: 445-4393

PRESCOTT, ARIZONA

ANALYTICAL REPORT

Date March 12, 1965

Page 1 of 1

Client Mr. Gerald Weathers
Arkansas Louisiana Gas Co.
P.O. Box 1047
Kingman, Arizona

Report on 5 rock samples

Sample Data Sheet of Inst. 3-5-65

Submitted by G. Weathers

Date 3-5-65

Analysis Copper, Zinc, Lead, Molybdenum, Silver

Remarks Colorimetric methods used. Pulps to be returned.

cc: encl. ✓
file

Field No.	Copper	Zinc	Lead	Molybdenum	Silver
P-1 584-2- 584-4 744	50	105	220	1	1
P-1 585-595 745	20	95	280	3	1
P-2 55-60 746	110	65	90	3	-1
P-3 625-630 747	25	20	50	3	1
P-1 686-693 748	50	35	155	-1	1

COMPARISON CHART OF GEOCHEM RESULTS
TO ASSAYS TO BE PREPARED WHEN
BOTH ARE RECEIVED - G.W.

E. A. Johnson
E. A. Johnson

*1 yr to
Lee Branch
w/NMA*

All values are reported in parts per million unless specified otherwise. A minus sign (-) is to be read "less than" and a plus sign (+) "greater than". Values in parenthesis are estimates. This analytical report is the confidential property of the above mentioned client and for the protection of this client and ourselves we reserve the right to forbid publication or reproduction of this report or any part thereof without written permission.

ROCKY MOUNTAIN GEOCHEMICAL LABORATORIES

233 North Marina Street

Phone: 445-4393

PRESCOTT, ARIZONA

ANALYTICAL REPORT

Date March 24, 1965

Page 1 of 1

Client Mr. Gerald Weathers
Arkansas Louisiana Gas Co.
P.O. Box 1047
Kingman, Arizona

Report on 8 rock samples

Sample Data Sheet of (none)

Submitted by G. Weathers

Date 3-19-65

Analysis Copper, Zinc, Lead, Molybdenum, Silver

Remarks Colorimetric methods used. Pulps to be returned.

cc: encl.
file

R-1	Field No.		Copper	Zinc	Lead	Molybdenum	Silver
780-791	749	SCHIST, BIOTITE	15	30	30	3	-1
797-799	750	"	5	40	5	1	-1
803 ⁵ -805	751	"	30	35	15	2	1
712-724	752	SCHIST, QUARTZ	20	30	400	3	8
810-822	753	SCHIST, BIOTITE	45	45	10	3	-1
825-827	754	"	55	60	10	3	1
827-829	755	"	35	60	5	4	-1
832-834 ^{1/2}	756	GRANITE w/ SCHIST INCLUSIONS	10	35	15	3	-1

1 gpk to
Lee
W/NMA

E. A. Johnson

E. A. Johnson

All values are reported in parts per million unless specified otherwise. A minus sign (-) is to be read "less than" and a plus sign (+) "greater than". Values in parenthesis are estimates. This analytical report is the confidential property of the above mentioned client and for the protection of this client and ourselves we reserve the right to forbid publication or reproduction of this report or any part thereof without written permission.

Shop No. 757A-767A
 File No. 1778 AR

Date 26 1965 CHAS. A. DIEHL
 (Registered)

*1 3/4 to
 Lee Edwards
 W/NMA*

815 North First Street
 Phoenix, Arizona
 P. O. Box 1148

Arizona Assay Office

Phone Alpine 3-4001

VALUES
 Latest Quotation

1 oz. Gold.....
 1 oz. Silver.....
 1 lb. Copper.....
 1 lb. Lead.....
 1 lb. Zinc.....

ARKIA EXPLORATION CO
 P.O. BOX 1047
 KINGMAN ARIZONA

P.O.#014

Short Ton 2000 Lbs.
 Short Ton Unit 20 Lbs.
 Long Ton 2240 Lbs.
 Long Ton Unit 22.4 Lbs.

THIS CERTIFIES
 Samples submitted for assay
 contain as follows:

MARKS	SILVER PER TON		GOLD PER TON		VALUE PER TON	TOTAL VALUE PER TON of Gold & Silver	PERCENTAGE		REMARKS
	Ozs.	Tenths	Ozs.	100ths			COPPER	Fe	
<i>R-1</i>									
<i>517^L-518^S</i> 757A	1.0		TRACE				0.02	6.80	BIOTITE GR. <i>IF</i>
<i>R-1</i> <i>911-913</i> 758A	.2		NIL				0.03	10.00	BIOTITE SCHIST
<i>920-922</i> 759A	.2		NIL				0.03		" "
<i>931-933</i> 760A	.2		NIL				0.025	8.60	" "
<i>948-950</i> 761A	.2		.01		<i>¢</i> .35		0.02		" "
<i>953-961</i> 762A	.2		TRACE				0.02	8.80	SCHIST, GONGE
<i>971^S-972^S</i> 763A	.2		TRACE				0.015		BIOTITE SCHIST
<i>979-981</i> 764A	.2		NIL				0.015	3.00	SCHIST GONGE
<i>993-995</i> 765A	.4		TRACE				0.02		" "
<i>1003-1005</i> 766A	.3		TRACE				0.02	8.20	BIOTITE SCHIST
<i>1014-1016</i> 767A	.3		TRACE				0.03	8.00	BIOTITE SCHIST
<i>R-1</i>									

Charges \$ 60.50

Assayer.....

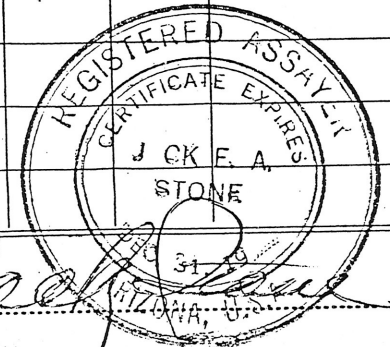

Shop No. **768**
File No. **1779 AR**

Date **27** **ch 1965** CHAS. A. DIEHL
(Registered)

*1 photo
See Attached
WINMA*

815 North First Street
Phoenix, Arizona
P. O. Box 1148

Arizona Assay Office

Phone Alpine 3-4001

VALUES
Latest Quotation

1 oz. Gold.....
1 oz. Silver.....
1 lb. Copper.....
1 lb. Lead.....
1 lb. Zinc.....

ARKLA EXPLORATION CO
P.O. BOX 1047
KINGMAN ARIZONA

P.O.# 014

	Fe %	
# 757	6.20	
# 758	10.00	
# 760	8.60	
# 762	8.80	Short Ton 2000 Lbs.
# 764	3.00	Short Ton Unit 20 Lbs.
# 766	8.20	Long Ton 2240 Lbs.
# 767	8.00	Long Ton Unit 22.4 Lbs.

THIS CERTIFIES
Samples submitted for assay
contain as follows:

R-1 MARKS	SILVER PER TON		VALUE PER TON	GOLD PER TON		VALUE PER TON	TOTAL VALUE PER TON of Gold & Silver	PERCENTAGE		REMARKS
	Ozs.	Tenths		Ozs.	100ths			COPPER		
1033-1035 768		.3			TRACE			0.03	9.00	PICATA SCI
1044-1046 769		.2			NIL			0.02		" "
1060-1062 770		.2			NIL			0.015	8.40	" "
1080-1082 771		.2			NIL			0.015		" "
1099-1101 772		.8		.01		\$.35		0.03	8.80	" "
1124-1126 773		.4			TRACE			0.02		" "
1144-1146 774		.4			NIL			0.025	9.60	" "
1156-1158 775		3.0			NIL			0.025		" "
1183-1185 776		.8			NIL			0.025	8.80	" "
1201-1203 777		.6			TRACE			0.015		" "

Charges \$ **55.00**

Assayer.....

ANDY CHUKA, PRINT

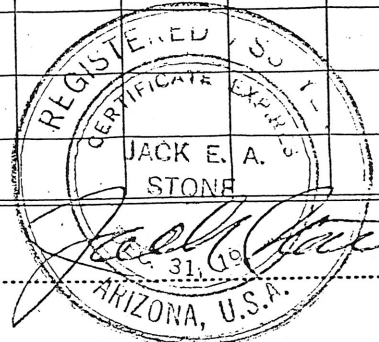

Shop No. 778-793
 File No. 1782 AR
VALUES
 Latest Quotation

Date 31 MCH 1965 CHAS. A. DIEHL
 (Registered)

Arizona Assay Office

*1 oz to
 Lee Branch
 w/NMA*

815 North First Street
 Phoenix, Arizona
 P. O. Box 1148

- 1 oz. Gold.....
- 1 oz. Silver.....
- 1 lb. Copper.....
- 1 lb. Lead.....
- 1 lb. Zinc.....

Phone ALpine 3-4001

ARKIA EXPLORATION CO
 P.O. BOX 1047
 KING KINGMAN ARIZONA

Short Ton 2000 Lbs.
 Short Ton Unit 20 Lbs.
 Long Ton 2240 Lbs.
 Long Ton Unit 22.4 Lbs.

THIS CERTIFIES
 Samples submitted for assay
 contain as follows:

RAY-#1

P.O. # 014

MARKS	SILVER PER TON		VALUE PER TON	GOLD PER TON		VALUE PER TON	TOTAL VALUE PER TON of Gold & Silver	PERCENTAGE				REMARKS	
	Ozs.	Tenths		Ozs.	100ths								
# 778 -----	0.03%	Cu.	1309	3-	1311 ³	SCHIST							
#779 -----	0.05%	Cu.	1312		1321	SCHIST							
#780 -----	0.03%	Cu.	1330		1332	SCHIST							
#781 -----	0.025%	Cu.	1332 ²		1341 ²	SCHIST							
#782 -----	0.025%	Cu.	1348		1350	SCHIST							
# 783 -----	0.015%	Cu.	1353 ²		1355 ²	QUARTZ & SCHIST WITH QUARTZ INCLUSIONS							
# 784 -----	0.04 %	Cu.	1364 ⁵		1366 ⁵	"	"	"	"	"	"		
#785 -----	0.055%	Cu.	1368 ⁵		1370 ⁵	HIGHLY ALTERED SILICIFIED GRANITE, SCHIST INCLUSIONS							
#786 -----	0.155%	Cu.	1376		1378	"	"	"	"	"	"		
#787 -----	0.035%	Cu.	1397		1399	SCHIST, BIOTITE, MAGNETITE							
#788 -----	0.035%	Cu.	1403		1405	SCHIST, BRECCIA & FAULT GOUGE							
#789 -----	0.035%	Cu.	1412 ²		1414 ²	"	"	"	"	"	"		
#790 ----	0.02 %	Cu.	1423		1425	SILICIFIED GRANITE & SCHIST							
#791 -----	0.015%	Cu.	1432 ⁵		1434 ⁵	SCHIST							
#792 -----	0.025%	Cu.	1448		1450	SCHIST							
#793 -----	0.05%	Cu.	1457 ⁵		1459 ⁵	SCHIST							

G. W.

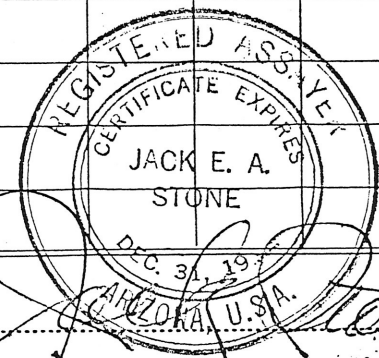

Charges \$ 40.00

Assayer.....

DATE May 5, 1965

M E M O

TO Mr. Lee Gorsuch

FROM R. L. Breedlove

Dear Lee:

Attached is Assay Reports for a test on the Santa Claus Prospect. Number Identification will follow.

R. L. Breedlove
R. L. Breedlove (sm)

Shop No. 794-799
 File No. 1734 AR

Date 4-19-58

Arizona Assay Office

815 NORTH FIRST STREET
 Phone: 253-4001

*1 spec to
Lee Heston
WINMA*

Phoenix, Arizona 85001
 P. O. BOX 1148

VALUES
 Latest Quotation

- 1 oz. Gold.....
- 1 oz. Silver.....
- 1 lb. Copper.....
- 1 lb. Lead.....
- 1 lb. Zinc.....

- Short Ton 2000 Lbs.
- Short Ton Unit 20 Lbs.
- Long Ton 2240 Lbs.
- Long Ton Unit 22.4 Lbs.

THIS CERTIFIES
 Samples submitted for assay
 contain as follows:

ARKLA EXPLORATION CO
 BOX 1047
 KINGMAN, ARIZONA

P.O. # 014

MARKS	SILVER PER TON		VALUE PER TON	GOLD PER TON		VALUE PER TON	TOTAL VALUE PER TON of Gold & Silver	PERCENTAGE			REMARKS
	Ozs.	Tenths		Ozs.	100ths			COPPER			
R-1											
1573 ⁵ -1581 794		.3			TRACE			0.04			BIOTITE SCHIST
1599-1601 795		.3			TRACE			0.02			"
1608-1610 796		.3			TRACE			0.025			"
1621-1623 797		.3			NIL			0.015			"
1626 ⁵ -1628 ⁵ 798		.3			NIL			0.04			QUARTZOSE (SILICIFIED) GRANITE
1632-1634 799		.3			NIL			0.095			"

Charges \$ 33.00

ANDY CHUKA, PRINT

Assayer.....

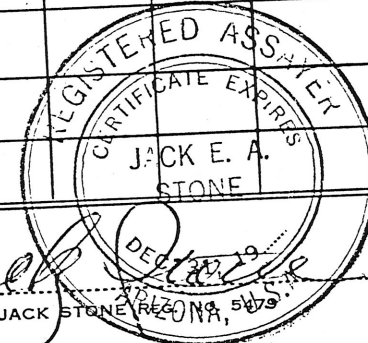



ARKLA EXPLORATION

C O M P A N Y

POST OFFICE BOX 1439, OKLAHOMA CITY, OKLAHOMA

May 10, 1965

Mr. E. L. Gorsuch, Vice President
NEW MEXICO AND ARIZONA LAND COMPANY
808 Bank of New Mexico Building
Albuquerque, New Mexico

Re: Budget - Santa Claus Project
and Holbrook Core Hole
Drilling Project

Dear Mr. Gorsuch:

This will confirm our telephone conversation of today, May 10, 1965, regarding the status of the above subject core hole budgets, whereby we agreed to continue the coring program under the terms of the core hole projects until further discussion can be held at our proposed meeting in San Francisco in the near future.

I also mentioned to you the name of the individual, George Mayfield, as furnished to me by a broker for Francis I. duPont & Company, responsible for the breach in security concerning information of our core hole projects. This man is supposed to have a relative working for Merrill, Lynch, Pierce, Fenner and Smith. The employee of the above mentioned brokerage firm is reportedly the one who told the brokers in the other brokerage houses of the potential possibilities of the New Mexico and Arizona Land Company stock. As I told you, I do not know how accurate this information is, but it was furnished to me in good faith by a reliable source. If this could possibly be the security leak, it would not hurt to attempt to eliminate it.

Yours very truly,

ARKLA EXPLORATION COMPANY

By W. C. Bradford
W. C. Bradford
Exploration Coordinator

WCB:cv
cc: W. H. Thomas



ARKLA EXPLORATION

C O M P A N Y

P. O. BOX 1734 SHREVEPORT, LOUISIANA 71102

May 7, 1965

Mr. E. L. Gorsuch
New Mexico Arizona Land Company
808 Bank of New Mexico Bldg.
Albuquerque, New Mexico

Dear Lee:

Attached are mineral assays from the Santa
Claus prospect.

Very truly yours,

ARKLA EXPLORATION COMPANY

A handwritten signature in cursive script, appearing to read "R. L. Breedlove". The signature is written in black ink and is positioned above a horizontal line.

R. L. Breedlove
Chief Geologist

RLB:aw

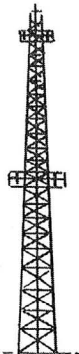

O I L • G A S • M I N E R A L S

ARKLA EXPLORATION COMPANY
 SHREVEPORT, LOUISIANA
 RECEIVED
 MAY 6 1965
 GEOLOGICAL
 DEPT.

ARKLA EXPLORATION
 COMPANY

INTERNAL CORRESPONDENCE

DATED AT KINGMAN 5-4-65

TO: R. L. BREEDLOVE

FROM: G. WEATHERS

SUBJECT: SAMPLES SUBMITTED FOR ASSAY

SAM No.	HOLE	DEPTH	SAM No.	HOLE	DEPTH
832	P-25	377-379	850	P-25	545-547
833	P-25	386-388	851	P-25	557-559
834	P-25	392-394	852	P-25	564-566
835	P-25	397-398	853	P-25	575-577
836	P-25	409-411	854	P-25	582-584
837	P-25	417-419	855	P-25	593 ⁵ -595 ⁵
838	P-25	428-430	856	P-25	601-603
839	P-25	438-440	857	P-25	609-611
840	P-25	447-449	858	P-25	622-624
841	P-25	457-459			
842	P-25	467-469			
843	P-25	477-479			
844	P-25	485-487			
845	P-25	495 ⁵ -497 ⁵			
846	P-25	505-507			
847	P-25	514 ⁵ -516 ⁵			
848	P-25	522-533			
849	P-25	530-532			

13X to
 Lee Gorsuch
 w/ NM-A.

Shop No. 851-858
 File No. 1793 A R

Date 4 MAY 1965

Phoenix, Arizona 85001
 P. O. BOX 1148

Arizona Assay Office

815 NORTH FIRST STREET
 Phone: 253-4001

ARKLA EXPLORATION CO
 P.O. BOX 1047
 KINGMAN ARIZONA

P.O.# 014

Short Ton 2000 Lbs.
 Short Ton Unit 20 Lbs.
 Long Ton 2240 Lbs.
 Long Ton Unit 22.4 Lbs.

VALUES
 Latest Quotation

1 oz. Gold.....
 1 oz. Silver.....
 1 lb. Copper.....
 1 lb. Lead.....
 1 lb. Zinc.....

THIS CERTIFIES
 Samples submitted for assay
 contain as follows:

MARKS	SILVER PER TON		VALUE PER TON	GOLD PER TON		VALUE PER TON	TOTAL VALUE PER TON of Gold & Silver	PERCENTAGE		REMARKS
	Ozs.	Tenths		Ozs.	100ths			COPPER		
851		.3			NIL			0.035		<i>Handwritten notes:</i> 851-858 GEORGE W/AM
852		.3			NIL			0.06		
853		.3			NIL			0.025		
854		.4			TRACE			0.065		
855		.2			NIL			0.06		
856		.4			TRACE			0.07		
857		.4			NIL			0.015		
858		.3			TRACE			0.015		

Charges \$ 44.00

ANDY CHUKA, PRINT

Assayer.....

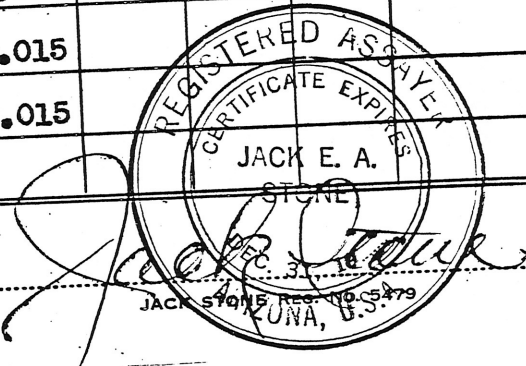

JACK STONE REG. NO. 5479
 ARIZONA, U.S.

*Pg. 1 was
a letter
of transmittal
only. RLB*

Field No.	Copper	Zinc	Molybdenum
562	250	95	2
563	60	60	3
564	40	25	3
565	40	70	2
566	40	155	1
567	40	130	2
568	20	5	1
569	30	5	2
570	375	340	3
571	310	260	3
572	290	270	2
573	135	300	1
574	180	95	3
575	10	-5	2

*13X. to
L. Garsach
W/NM-A*

E. A. Johnson
E. A. Johnson

ROCKY MOUNTAIN GEOCHEMICAL LABORATORIES

233 North Marina Street

Phone: 445-4393

PRESCOTT, ARIZONA

ANALYTICAL REPORT

Date April 28, 1965

Page 1 of 2

Client Mr. Gerald Weathers
ARKLA Exploration Co.
P.O. Box 1047
Kingman, Arizona

Report on 15 Pulp samples

Sample Data Sheet of (none)

Submitted by G. Weathers

Date App. 4-16-65

Analysis Copper, Zinc, Lead, Molybdenum, Silver

Remarks Colorimetric methods used. Pulps to be returned.

cc: encl.
file

1 3x. fo: L. Gorsuch by NMA 5-3-65

All values are reported in parts per million unless specified otherwise. A minus sign (-) is to be read "less than" and a plus sign (+) "greater than". Values in parenthesis are estimates. This analytical report is the confidential property of the above mentioned client and for the protection of this client and ourselves we reserve the right to forbid publication or reproduction of this report or any part thereof without written permission.

Sample No.	Copper	Zinc	Lead	Molybdenum	Silver
625	55	30	10	1	-1
626	75	40	15	1	-1
627	95	40	15	2	-1
628	60	50	30	1	-1
629	75	35	15	1	1
630	40	25	65	6	1
631	205	90	400	3	1
632	65	30	35	2	-1
633	55	45	35	5	-1
<i>R-14</i> 1570 ⁵ -1581	85	30	30	1	-1
1599-1601	75	60	15	1	-1
1608-1610	65	40	10	1	-1
1621-1623	80	45	35	2	-1
1626 ⁵ -1628 ⁵	35	20	20	2	-1
1632-1634	35	15	40	2	-1

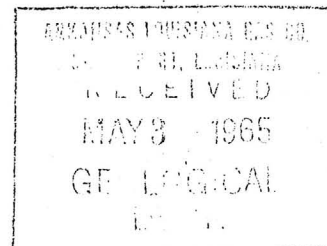

E. A. Johnson
 E. A. Johnson

13X. to: L. Gorsuch w/
 NM-A 5-3-65

Shop No. 113-128
 File No. 1790 AR

Date 28 APRIL 1965 CHAS. A. DIEHL
 (Registered)

815 North First Street
 Phoenix, Arizona
 P. O. Box 1148

Arizona Assay Office

VALUES
 Latest Quotation

1 oz. Gold.....
 1 oz. Silver.....
 1 lb. Copper.....
 1 lb. Lead.....
 1 lb. Zinc.....

Phone ALpine 3-4001
 ARKLA EXPLORATION CO
 P.O. BOX 1047
 KINGMAN ARIZONA

Short Ton 2000 Lbs.
 Short Ton Unit 20 Lbs.
 Long Ton 2240 Lbs.
 Long Ton Unit 22.4 Lbs.

THIS CERTIFIES
 Samples submitted for assay
 contain as follows:

P.O.# 014

MARKS	SILVER PER TON		VALUE PER TON	GOLD PER TON		VALUE PER TON	TOTAL VALUE PER TON of Gold & Silver	PERCENTAGE			REMARKS
	Ozs.	Tenths		Ozs.	100ths			COPPER			
# 113		.1			TRACE					0.04	
# 114		.2			TRACE					0.03	
# 115		.2			NIL					0.025	
# 116		.1			NIL					0.055	
# 117		.1			NIL					0.035	
# 118		.1			NIL					0.035	
# 119		TRACE			NIL					0.02	
# 120		.1			NIL					0.02	
# 121		.1			NIL					0.07	
# 122		TRACE			NIL					0.03	
# 123		TRACE			NIL					0.03	
# 124		.4			NIL					0.03	
# 125		TRACE			NIL					0.025	
# 126		TRACE			NIL					0.015	
# 127		TRACE			NIL					0.015	
# 128-----		TRACE			NIL					0.015	

Charges \$.....88.00.....

Assayer.....

13X. to L. Gorsuch WNM-A

ANDY CHUKA, PRINT

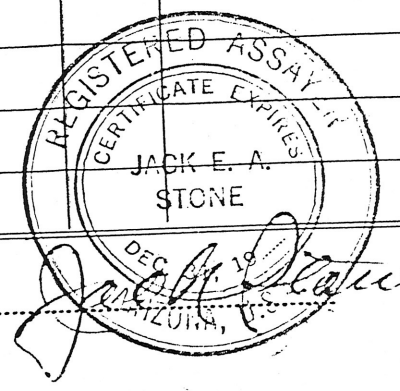

Shop No. **1791 AR**
 File No. **129-139**

Date **29 APRIL 1965**

CHAS. A. DIEHL
 (Registered)

815 North First Street
 Phoenix, Arizona
 P. O. Box 1148

Arizona Assay Office

Phone ALpine 3-4001

ARKLA EXPLORATION CO
 P.O. BOX 1047
 KINGMAN ARIZONA

Short Ton 2000 Lbs.
 Short Ton Unit 20 Lbs.
 Long Ton 2240 Lbs.
 Long Ton Unit 22.4 Lbs.

- VALUES**
 Latest Quotation
- 1 oz. Gold.....
 - 1 oz. Silver.....
 - 1 lb. Copper.....
 - 1 lb. Lead.....
 - 1 lb. Zinc.....

THIS CERTIFIES
 Samples submitted for assay
 contain as follows:

P.O. # 014

MARKS	SILVER PER TON		VALUE PER TON	GOLD PER TON		VALUE PER TON	TOTAL VALUE PER TON of Gold & Silver	PERCENTAGE			REMARKS
	Ozs.	Tenths		Ozs.	100ths			COPPER			
# 129		.2			NIL			0.02			
# 130		.2			NIL			0.02			
# 131		.2			NIL			0.02			
# 132		.4			NIL			0.02			
# 133		.4			NIL			0.045			
# 134		.3			NIL			0.015			
# 135		.3			NIL			0.02			
# 136		.4			NIL			0.02			
# 137		.6			NIL			0.015			
# 138		.5			NIL			0.015			
# 139		.2			NIL			0.02			

*13% to L. Gorsuch
 W/K M-A*

Charges \$ **60.50**

Assayer.....

Jack Stone
 REGISTERED ASSAYER
 CERTIFICATE EXPIRES
 JACK E. A. STONE
 ARIZONA, U.S.A.

Shop No. 113-128
 File No. 1790 AR

Date 28 APRIL 1965 CHAS. A. DIEHL
 (Registered)

815 North First Street
 Phoenix, Arizona
 P. O. Box 1148

Arizona Assay Office

Phone ALpine 3-4001

ARKLA EXPLORATION CO
 P.O. BOX 1047
 KINGMAN ARIZONA

VALUES
 Latest Quotation
 1 oz. Gold.....
 1 oz. Silver.....
 1 lb. Copper.....
 1 lb. Lead.....
 1 lb. Zinc.....

Short Ton 2000 Lbs.
 Short Ton Unit 20 Lbs.
 Long Ton 2240 Lbs.
 Long Ton Unit 22.4 Lbs.

THIS CERTIFIES
 Samples submitted for assay
 contain as follows:

P.O.# 014

MARKS	SILVER PER TON		VALUE PER TON	GOLD PER TON		VALUE PER TON	TOTAL VALUE PER TON of Gold & Silver	PERCENTAGE			REMARKS
	Ozs.	Tenths		Ozs.	100ths			COPPER			
# 113		.1			TRACE			0.04			
# 114		.2			TRACE			0.03			
# 115		.2			NIL			0.025			
# 116		.1			NIL			0.055			
# 117		.1			NIL			0.035			
# 118		.1			NIL			0.035			
# 119		TRACE			NIL			0.02			
# 120		.1			NIL			0.02			
# 121		.1			NIL			0.07			
# 122		TRACE			NIL			0.03			
# 123		TRACE			NIL			0.03			
# 124		.4			NIL			0.03			
# 125		TRACE			NIL			0.025			
# 126		TRACE			NIL			0.015			
# 127		TRACE			NIL			0.015			
# 128		TRACE			NIL			0.015			

Charges \$..... 88.00.....

Assayer.....

1 BK. to L. Gorsuch / NM-A

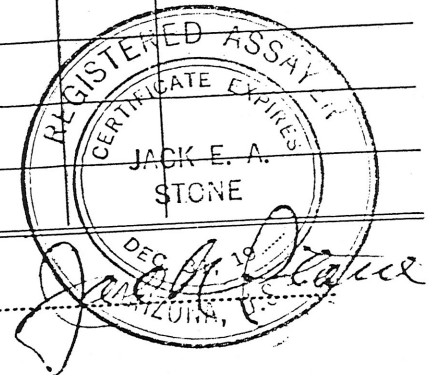

#1 Core Hole & Validation - Ray Claims

Location: Section 34, Twp. 23N, Rge. 18W

Remarks: Coring 595'

#3 Core Hole & Validation - Ray Claims

Location: Section 34, Twp. 23N, Rge, 18W

Remarks: Coring 315'

#4 Core Hole & Validation - Ray Claims

Location: Section 34, Twp. 23N, Rge. 18W

Remarks: Coring 360'

Rocky Mountain Geochemical Corporation

P. O. BOX 2217
SALT LAKE CITY, UTAH 84110

Phone 322-23
Area Code 80

CERTIFICATE OF ANALYSES

Date June 7, 1968

Page 1

Client Arkla Exploration Co.,
% Gerald Weathers
P.O. Box 971
Wikieup, Arizona

YB-13

Report on: 25 pulp samples

Submitted by: G. Weathers

Date Received: June 5, 1968

Analysis: Copper and Molybdenum.

Remarks: Analysis of Molybdenum determined colorimetrically. Copper determined by atomic absorption. 8 assays reported. Purchase Order No. L 58098. Job. No. 68-14-2 SL.

cc: Enc.
File (2)

LRR:dc

*Arkla
Exploration
#13 Yellow
Basin*

MM-A

All values are reported in parts per million unless specified otherwise. A minus sign (-) is to be read "less than" and a plus sign (+) "greater than." Values in parenthesis are estimates. This analytical report is the confidential property of the above mentioned client and for the protection of this client and ourselves we reserve the right to forbid publication or reproduction of this report or any part thereof without written permission.
ND = None Detected 1 ppm = 0.0001% 1 Troy oz./ton = 34.28 ppm % Mo x 1.6683 = %MoS₂

MM-A

Ark' Exploration #13 Yellow Basin

<u>DEPTH</u>	<u>Sample No.</u>	<u>ppm Copper</u>	<u>ppm Molybdenum</u>	<u>AG</u>
YB 13 20'-25'	4001	240	4	(P) END
45'-50'	4002	185	7	
55-60	4003	200	9	
70-75	4004	190	5	
95-100	4005	300	4	
120-125	4006	220	11	(P)
145-150	4007	230	6	
170-175	4008	230	1	
195-200	4009	155	3	
208-211	4010	120	-1	
220-225 →	4011	325	13	(P)
245-250	4012	400	18	
270-275	4013	+1000=0.15%	21	
295-300	4014	570	5	
300-305	4015	520	6	
315-320	4016	670	20	(P)
320-325	4017	370	20	
340-345	4018	710	17	
345-350	4019	360	3	
360-365	4020	+1000=0.12%	23	
365-370	4021	+1000=0.10%	2	(P)
375-380	4022	+1000=0.19%	9	:
380-385	4023	+1000=0.74%	+300=.252%	
385-390 -	4024	+1000=0.37%	+300=.34%	COPPER & VEIN
420-425 -	4025	390	18	

Rocky Mountain Geochemical Corporation
Salt Lake City, Utah June 7, 1968
By Lawrence R. Reid
Lawrence R. Reid

ARK' NMA-A

Property 5-23 1968
YB-3
Location _____
County Mohave
S _____ T _____ R _____
NX Core wea Granite
ARKLA No 4001 20-25
Sample Data: 1-Union
2-RKyMTH

Au, Ag¹, Pb, Zn, Fe, Mn, Cu, Mo²

240 ppm 4
Sampler _____

Property 5-23 1968
YB-13
Location _____
County Mohave
S _____ T _____ R _____
NX Core wea Granite
ARKLA No 4002 45-50
Sample Data: 2-RKyMTH

Au, Ag, Pb, Zn, Fe, Mn, Cu, Mo^{7.2}

185
Sampler _____

Property 5-23 1968
YB-13
Location _____
County Mohave
S _____ T _____ R _____
NX Core wea Granite
ARKLA No 4003 55-60
Sample Data: 2-RKyMTH

Au, Ag, Pb, Zn, Fe, Mn, Cu, Mo²

Sampler _____

Property 5-23 1968
YB-13
Location _____
County Mohave
S _____ T _____ R _____
NX Core wea Granite
ARKLA No 4004 70-75
Sample Data: 2-RKyMTH

Au, Ag, Pb, Zn, Fe, Mn, Cu, Mo²

Sampler _____

Property 5-23 1968
YB-13
Location _____
County Mohave
S _____ T _____ R _____

ARKLA No 4006 NX Core
wea Granite
Sample Data: 120-125

1-Union
2-RKy Mtn

Au, Ag, Pb, Zn, Fe, Mn, Cu, Mo

Sampler _____

Property 5-23 1968
YB-13
Location _____
County Mohave
S _____ T _____ R _____

ARKLA No 4005 NX Core
wea Granite
Sample Data: 95-100

2-RKy Mtn

Au, Ag, Pb, Zn, Fe, Mn, Cu, Mo

Sampler _____

Property 5-28 1968
YB-13
Location _____
County Mohave
S _____ T _____ R _____

ARKLA No 4008 NX Core wea Granite
170-175

Sample Data:

2-RKy Mtn

Au, Ag, Pb, Zn, Fe, Mn, Cu, Mo

Sampler _____

Property 5-28 1968
YB-13
Location _____
County Mohave
S _____ T _____ R _____

ARKLA No 4007 NX Core wea Granite
145-150

Sample Data:

2-RKy Mtn

Au, Ag, Pb, Zn, Fe, Mn, Cu, Mo

Sampler _____

Property 5-28 1968
YB-3
Location _____
County Mohave
S _____ T _____ R _____

ARKLA No 4010 NX Core
Wea Granite
Sample Data: 208-211
2-RKy Mth

Au, Ag, Pb, Zn, Fe, Mn, Cu, Mo²

Sampler _____

Property 5-28 1968
YB-13
Location _____
County Mohave
S _____ T _____ R _____

ARKLA No 4009 NX Core
Wea Granite
Sample Data: 195-200
2-RKy Mth

Au, Ag, Pb, Zn, Fe, Mn, Cu, Mo²

Sampler _____

Property 5-29 1968
YB-13
Location _____
County Mohave
S _____ T _____ R _____

ARKLA No 4012 NX Core
Wea Granite
Sample Data: 245-250
2-RKy Mth

Au, Ag, Pb, Zn, Fe, Mn, Cu, Mo²

Sampler _____

Property 5-29 1968
YB-13
Location _____
County Mohave
S _____ T _____ R _____

ARKLA No 4011 NX Core
Wea Granite
Sample Data: 220-225
1-Union
2-RKy Mth

Au, Ag¹, Pb, Zn, Fe, Mn, Cu, Mo²

Sampler _____

Property 5-29 1968
3-13
Location _____
County Mohave
S _____ T _____ R _____
NX Core wea Granite
ARKLA No 4013 270-275-
Sample Data: 2-RKy Mtn

Au, Ag, Pb, Zn, Fe, Mn, Cu, Mo

Sampler _____

Property 5-29 1968
YB-13
Location _____
County Mohave
S _____ T _____ R _____
NX Core wea Granite
ARKLA No 4014 295-300-
Sample Data: 2-RKy Mtn

Au, Ag, Pb, Zn, Fe, Mn, Cu, Mo

Sampler _____

Property 5-29 1968
YB-13
Location _____
County Mohave
S _____ T _____ R _____
NX Core wea Granite
ARKLA No 4015 ~~300-305~~
Sample Data: 2-RKy Mtn

Au, Ag, Pb, Zn, Fe, Mn, Cu, Mo²

Sampler _____

Property 5-29 1968
YB-13
Location _____
County Mohave
S _____ T _____ R _____
NX Core wea Granite
ARKLA No 4016 315-320
Sample Data: 1-Union
2-RKy Mtn

Au, Ag, Pb, Zn, Fe, Mn, Cu, Mo

Sampler _____

5-29 1968
Property _____
Location _____
County Mohave
S _____ T _____ R _____

NX Core
ARKLA No 4017 wea Granite
Sample Data: 320-325
2-RKY Mtn

Au, Ag, Pb, Zn, Fe, Mn, Cu, Mo

Sampler _____

5-29 1968
Property YB-13
Location _____
County Mohave
S _____ T _____ R _____

NX Core wea Granite
ARKLA No 4018 340-345
Sample Data: 2-RKY Mtn

Au, Ag, Pb, Zn, Fe, Mn, Cu, Mo

Sampler _____

5-29 1968
Property YB-13
Location _____
County Mohave
S _____ T _____ R _____

NX Core wea Granite
ARKLA No 4019 345-350
Sample Data: 2-RKY Mtn

Au, Ag, Pb, Zn, Fe, Mn, Cu, Mo

Sampler _____

5-29 1968
Property YB-13
Location _____
County Mohave
S _____ T _____ R _____

NX Core wea Granite
ARKLA No 4020 360-365
Sample Data: 2-RKY Mtn

Au, Ag, Pb, Zn, Fe, Mn, Cu, Mo

Sampler _____

5-29 1968
Property YB-1
Location _____
County Mohave
S _____ T _____ R _____

ARKLA No: 4021 NX Core
Wea Granite
Sample Data: 365-370
1-Union
2-RKy Mtn

Au, Ag¹, Pb, Zn, Fe, Mn, Cu, Mo²

Sampler _____

3-31
Property YB-13
Location _____
County Mohave
S _____ T _____ R _____

ARKLA No: 4022 NX Core
Wea Granite
Sample Data: 375-380
2-RKy Mtn

Au, Ag, Pb, Zn, Fe, Mn, Cu, Mo²

Sampler _____

5-31 1968
Property YB-13
Location _____
County Mohave
S _____ T _____ R _____

ARKLA No: 4023 NX Core
Wea Granite
Sample Data: 380-385
2-RKy Mtn

Au, Ag, Pb, Zn, Fe, Mn, Cu, Mo²

Sampler _____

5-31
Property YB-13
Location _____
County Mohave
S _____ T _____ R _____

ARKLA No: 4024 NX Core
Wea Granite
Sample Data: 385-390
2-RKy Mtn

Au, Ag, Pb, Zn, Fe, Mn, Cu, Mo²

Sampler _____

Property 5-31 1968
Location YB-13
County Mohave
S. _____ T. _____ R. _____

ARKLA No 4025 NX Core
Sample Data: wea Granite
420-425
2-RKY MTH

Au, Ag, Pb, Zn, Fe, Mn, Cu, Mo

Sampler _____

ARKLA EXPLORATION CO.

COMPANY

INTERNAL CORRESPONDENCE

DATED AT KINGMAN, ARIZONA
12/5/65

TO: Mr. R. L. Breedlove

FROM: D. P. McCarthy

SUBJECT: Your request for list of drill holes on Mohave Project and locations.

Following is the list of Drill Holes completed during 1964 on the Mohave Tract:

DRILL HOLE	CLAIM	TD	DATES		LOCATION			Sec.	Tsp	Rng.
			START	COMPL.	N/S Line	E/W Line				
1 Northside #1	Northside #3	351	7/15/64	7/30/64	30'	1670'	14	17N	19W	
2 Paycheck #1	Paycheck #3	230	7/30/64	8/4/64	3940'	5240'	22	17N	19W	
3 Badger #1	Badger #1	122	8/6/64	9/3/64	3550'	3280'	18	18N	18W	
4 Finger #1	Finger #8	185.5	8/4/64	8/10/64	1330'	4510'	9	17N	19W	
5 Chuck #1	Stan #5	119	8/7/64		2370'	4500'	1	18N	19W	
6 Don #1	Don #4	180	8/10/64	8/13/64	1000'	5180'	8	17N	19W	
7 4-Buttes #1	4-Buttes #1	77			5160'	2120'	1	18N	19W	
8 Stan #1	Stan #10	162	8/13/64	8/17/64	5240'	2350'	1	18N	19W	
9 Clint #1	Clint #3	135	8/13/64	8/15/64	3680'	5080'	17	17N	19W	
10 Badger #2	Badger #7	77	8/18/64	8/19/64	3650'	2680'	18	18N	18W	
11 Northside #2	Northside #3	684	8/17/64	9/11/64	200'	1440'	14	17N	19W	
12 Nosam #1	Nosam #4	111	8/18/64	8/21/64	4080'	4180'	15	19N	19W	
13 Lil #1	Lil #2	100	8/25/64	8/27/64	850'	1660'	10	17N	19W	
14 Matilda #1	Matilda #3	396	8/27/64	9/11/64	1270'	820'	9	17N	19W	
15 Ted #1	Ted #2	120	9/12/64	9/14/64	5160'	1820'	15	17N	19W	
16 Extension #1	Extension #2	102	9/14/64	9/15/64	3640'	770'	14	17N	19W	
17 West End #1	West End #4	130	9/14/64	9/16/64	1160'	1800'	35	17N	19W	
18 Matilda #2	Matilda #8	603	9/ /64	10/ /64	1420'	2100'	9	17N	19W	

ARKANSAS LOUISIANA GAS CO.
SHREVEPORT, LOUISIANA
RECEIVED
DEC 7 1965
GEOLOGICAL
DEPT.

D. P. McCarthy

#1 Core Hole & Validation - Ray Claims

Location: Section 34, Twp. 23N, Rge. 18W

Remarks: Coring 595'

#3 Core Hole & Validation - Ray Claims

Location: Section 34, Twp. 23N, Rge. 18W

Remarks: Coring 315'

#4 Core Hole & Validation - Ray Claims

Location: Section 34, Twp. 23N, Rge. 18W

Remarks: Coring 360'

May 26, 1967

Mr. H. B. Parker, Auditor
New Mexico and Arizona Land Company
3253 East Trafficway
Springfield, Missouri

Dear Mr. Parker:

Reference your letter of May 25, 1967, Santa Claus Project, referenced project is status quo as of this date.

The only activity is trying to defend claims that have been State on Government land which is adjoining that which was the old Santa Claus Project originally. It is questionable whether any additional expenditures will be made this year in this area.

Very truly yours,

E. L. Gorsuch

ELG:ko

cc: Mr. George Bailey, St. Louis
Mr. G. M. Rayburn, St. Louis

NEW MEXICO AND ARIZONA LAND COMPANY

~~XX~~
~~300 OLIVE STREET, ST. LOUIS, MISSOURI 63101~~

H. B. PARKER
AUDITOR

3253 East Trafficway
Springfield, Missouri 65802
May 25, 1967

AIR MAIL

Mr. E. L. Gorsuch, Vice President
New Mexico & Arizona Land Company
1130 Bank of New Mexico Building
222 4th Street, N.W.
Albuquerque, New Mexico 87101

Dear Mr. Gorsuch:

Please furnish, by return air mail,
status of Santa Claus project under Arkla contract.

Yours very truly,

H. B. Parker
HBP

cc: Messrs. G. M. Rayburn
G. E. Bailey

January 31, 1967

Mr. G. M. Rayburn, President
New Mexico and Arizona Land Company
906 Olive Street
St. Louis, Missouri

Re: Santa Clause Area
Sections 26 and 27
T. 23N, R. 18W

Dear Mr. Rayburn:

Pursuant to our discussion as of this date referencing Santa Clause Project, Mohave County, Arizona, herewith you will find executed copy of Agreement to validate claims to Santa Clause Project, Sections 26 and 27, Township 23 North, Range 18 West.

You will note that "which we are sure we will find" is underlined and that means we must find mineral of economic value to extend these claims within a period of time.

Very truly yours,

E. L. Gorsuch

ELG:ko
Enc.



ARKLA EXPLORATION COMPANY (a wholly owned subsidiary of)
ARKANSAS LOUISIANA GAS COMPANY
and the NEW MEXICO AND ARIZONA LAND COMPANY
OKLAHOMA CITY, OKLAHOMA

P. O. Box 1439

February 15, 1965

Request for Prospecting Permits

Mr. T. H. Rodgers
Land Commissioner
Santa Fe Pacific Railroad Company
4549 Produce Plaza
Los Angeles, California 90058

Dear Mr. Rodgers:

This letter is a request for prospecting permits covering Sections 27, 33 and 35, in Township 23 North, Range 18 West, Mohave County, Arizona, subject to the following terms and conditions:

The rental of \$2 per acre with the acreage being held equal to the amount of \$10 per acre spent at the end of the first year. Royalty terms will be negotiated similar to those of the State of Arizona when a commercial discovery has been made.

The Arkla Exploration Company and the New Mexico and Arizona Land Company are currently engaged in an extensive exploratory program for numerous minerals in the State of Arizona, and have been for the last two years. Currently, we have approximately 35 engineers and geologists, plus the following consulting firms working in our behalf:

Dames and Moore, Los Angeles; Research Institute of Colorado at Colorado School of Mines, Golden, Colorado; Walter and Heinerich of Tucson; Western Knapp of San Francisco; and A. I. Levenson, as advisors.

Should a commercial deposit of ore be found, we are prepared to handle all of the operations with the assistance of the above staffs.

Very truly yours,

W. C. Bradford, Exploration Coordinator
ARKLA EXPLORATION COMPANY

E. L. Gorsuch, Vice President
NEW MEXICO AND ARIZONA LAND COMPANY

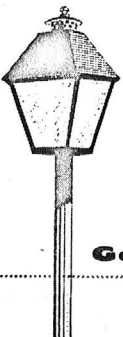

A. E. C. # 6 TOM

INDEX

25.5-83'

This index is spaced to that additional assay depths can be added.

To add additional assays to this folder, remove staples, insert new data at proper depths, and re-staple.

By: ARKLA EXPL. CO.

R. L. Breedlove

CHIEF GEOL.

By: Rocky Mt Geo Chem

AEC # 6 Tom

Page 2

Sample No.	Copper	Zinc	Lead	Molybdenum
1766	725	800	15	2
1767	375	390	20	3
1768	575	380	15	1
1769	425	450	20	1
1770	400	420	20	3
1771	290	380	15	-1

@
Santa
Claus
prospect

AEC # 6 Tom

@ Santa Claus
prospect

3x-to.
L.G. - A
W.N.M.

E. A. Johnson
E. A. Johnson

2-8 1967
 Property TOM 17-24
 Location T-6 = TOM #6
 County MOHAVE, ARIZ

 ARKLA No: 1767

 Sample Data: NX
36⁵ - 38⁵
FeOx STAINED
 Au, Ag, Pb, Zn, Fe, Mn, Cu, Mo
20 390
 Sampler G. WEATHERS

2-8 1967
 Property TOM 17-24
 Location D 11 T-6 = TOM #6
 County MOHAVE - ARIZ

 ARKLA No: 1766

 Sample Data: NX CORE
25⁵ - 27⁵
BIOTITE GRANITE GNEISS
FeOx STAINED
 Au, Ag, Pb, Zn, Fe, Mn, Cu, Mo
15 800 725 2
 Sampler S. W. WOODS Comp O.K.

2-8 1967
 Property TOM 17-24
 Location T-6 = TOM #6
 County MOHAVE, ARIZ

 ARKLA No: 1769

 Sample Data: NX CORE
53-55
 Au, Ag, Pb, Zn, Fe, Mn, Cu, Mo
20 450 425
 Sampler G. WEATHERS

2-8 1967
 Property TOM 17-24
 Location T-6 = TOM #6
 County MOHAVE - ARIZ

 ARKLA No: 1768

 Sample Data: NX CORE
46⁵ - 48⁵
WEA GR GNEISS
 Au, Ag, Pb, Zn, Fe, Mn, Cu, Mo
15 380 575
 Sampler G. WEATHERS

2-8 1967
 Property TOM 17-24
 Location T-6 = TOM #6
 County MOHAVE, ARIZ

 ARKLA No: 1771

 Sample Data: 75-83 NX CORE
1.9' CORE RECOVERY
ABUNDANT LIMONITE CLAY
 Au, Ag, Pb, Zn, Fe, Mn, Cu, Mo
15 380 290 -1
 Sampler G. WEATHERS

2-8 1967
 Property TOM 17-24
 Location T-6 = TOM #6
 County MOHAVE, ARIZ

 ARKLA No: 1770

 Sample Data: NX CORE
59-61
 Au, Ag, Pb, Zn, Fe, Mn, Cu, Mo
20 420 400 3
 Sampler G. WEATHERS

A.E.C. #2 RAY
SANTA CLAUS PROSPECT

INDEX

609'-609.5'

This index is spaced so that additional assay depths can be added.

To add additional assays to this folder, remove staples, insert new data at proper depths, and re-staple.

By: ARKLA EXPL. Co.

R.L. Breedlove

CHIEF GEOL.

NMA

Shop No. 560-561-744A 744A
File No. 1772 AR

8 MARCH 1965

Arizona Assay Office

815 NORTH FIRST STREET
Phone: 253-4001

ARKANSAS LOUISIANA GAS CO
P.O. BOX 1047
KINGMAN ARIZONA

A.E.C.
RAY
2

Phoenix, Arizona 85001

P. O. BOX 1148

AT Santa Claus

Short Ton 2000 Lbs.
Short Ton Unit 20 Lbs.
Long Ton 2240 Lbs.
Long Ton Unit 22.4 Lbs.

VALUES Latest Quotation

- 1 oz. Gold.....
- 1 oz. Silver.....
- 1 lb. Copper.....
- 1 lb. Lead.....
- 1 lb. Zinc.....

THIS CERTIFIES
Samples submitted for assay
contain as follows:

G. WEATHERS

MARKS	SILVER PER TON		VALUE PER TON	GOLD PER TON		VALUE PER TON	TOTAL VALUE PER TON of Gold & Silver	PERCENTAGE		REMARKS
	Ozs.	Tenths		Ozs.	100ths			COPPER		
Ray # 2 = 560-609-609.5-	09	5						0.015		

#560, #561 &
#744 AS to
#745 AS to G. W.
N.M.-A
Land Co.



Assayer.....

Charges \$ 22.00

A.E.C. #1 HAGEY

INDEX

31-96'

This index is spaced so that additional assays depths can be added.

To add additional assays to this folder, remove staples, insert new data at proper depths, and re-staple.

By: ARKLA EXPL. Co.

R. L. Breedlove
CHIEF GEOL.

ROCKY MOUNTAIN GEOCHEMICAL LABORATORIES

519 North Washington Ave.

Phone: 445-4393

PRESCOTT, ARIZONA 86301

ANALYTICAL REPORT

Date February 20, 1967

Page 1 of 1

Client Mr. Gerald Weathers
ARKLA Exploration Co.
P.O. Box 971
Wikieup, Arizona

A.E.C.

*#1 Hagey drill hole
@ Santa Claus prospect*

Report on 8 Drill Cor Samples

Sample Data Sheet of Verbal 2-15-67

Submitted by G. Weathers

Date 2-15-67

Analysis Copper, Zinc, Lead, Molybdenum

Remarks Copper, Zinc, done by Atomic Absorption methods.
Lead, Molybdenum, done by Colorimetric methods.
Sample pulps to be returned.

*2x to
L. Gorsuch
w/NA-A*

cc: encl.
file

DEPTH	Sample No.	Copper	Zinc	Lead	Molybdenum
74-76	1781	225	270	75	6
86-88	1782	410	380	125	1
94-96	1783	175	320	15	2
66-68	1784	185	220	45	2
54-56	1785	320	370	120	-1
47-49	1786	290	330	100	2
38-40	1787	450	350	140	2
31-32	1788	575	800	185	-1

E A Johnson

E. A. Johnson

All values are reported in parts per million unless specified otherwise. A minus sign (—) is to be read "less than" and a plus sign (+) "greater than." Values in parenthesis are estimates. This analytical report is the confidential property of the above mentioned client and for the protection of this client and ourselves we reserve the right to forbid publication or reproduction of this report or any part thereof without written permission

*NA-A
copy*

2-15 1967
Property: HAGLEY 1
Location: H-1 DN
County: MOHAVE, ARIZ

ARKLA No 1781

Sample Data: NX CORE
74-76' WEATHERED IRON
STAINED GRANITE GNEISS

75 270 225
Au, Ag, Pb, Zn, Fe, Mn, Cu, Mo

Sampler: G. WEATHERS

*1781-88
Comp.
o.k.

2-15 1967
Property: HAGLEY 1
Location: H-1 = Hagley #1
County: MOHAVE, ARIZ

ARKLA No 1782

Sample Data: NX CORE 86-88
IRON OXIDE STAINED WEATHERED
GRANITE GNEISS

125 380 410 1
Au, Ag, Pb, Zn, Fe, Mn, Cu, Mo

Sampler: G. WEATHERS

2-15 1967
Property: HAGLEY 1 #1
Location: H-1 = Hagley #1
County: MOHAVE, ARIZ

ARKLA No 1783

Sample Data: NX CORE 94-96
WEA GRANITE GNEISS

15 320 175 2
Au, Ag, Pb, Zn, Fe, Mn, Cu, Mo

Sampler: G. WEATHERS

2-15 1967
Property: HAGLEY 1
Location: H-1
County: MOHAVE, ARIZ

ARKLA No 1784

Sample Data: NX CORE 66-68

PPM 45 220 185 2
Au, Ag, Pb, Zn, Fe, Mn, Cu, Mo

Sampler: G. WEATHERS

2-15 1967
Property HAGLEY
Location H-1
County MOHAVE, ARIZ

ARKLA No 1785

Sample Data: NX CORE 54-56
GR GNEISS

PPM 120 370 320 -1
Au, Ag, Pb, Zn, Fe, Mn, Cu, Mo

Sampler G. WEATHERS

2-15 1967
Property HAGLEY
Location H-1 = Hagley #1
County MOHAVE, ARIZ

ARKLA No 1786

Sample Data: NX CORE 47-49

100 330 290 2
Au, Ag, Pb, Zn, Fe, Mn, Cu, Mo

Sampler G. WEATHERS

2-15 1967
Property HAGLEY
Location H-1
County MOHAVE, ARIZ

ARKLA No 1787

Sample Data: NX CORE 38-40
(SEE LOG)

PPM 140 350 450 2
Au, Ag, Pb, Zn, Fe, Mn, Cu, Mo

Sampler G. WEATHERS

2-15 1967
Property HAGLEY
Location H-1 = Hagley #1
County MOHAVE, ARIZ

ARKLA No 1788

Sample Data: NX CORE 31-32
(SEE LOG)

185 800 575 -1
Au, Ag, Pb, Zn, Fe, Mn, Cu, Mo

Sampler G. WEATHERS

A.E.C. #1 PETE
SANTA CLAUS PROSPECT

INDEX

85-739'

This index is spaced so that additional assays depths can be added.

To add additional assays to this folder, remove staples, insert new data at proper depths, and re-staple.

By: ARKLA EXPL. Co.

R. L. Breedlove

CHIEF GEOL.

ROCKY MOUNTAIN GEOCHEMICAL LABORATORIES

233 North Marina Street

Phone: 445-4393

PRESCOTT, ARIZONA

ANALYTICAL REPORT

Date March 4, 1965

Page 1 of 1

Client Mr. Gerald Weathers
Arkansas Louisiana Gas Co.
P.O. Box 1047
Kingman, Arizona

A. E. C.
#1 Pete
@ Santa Clara Prospect

Report on 9 rock samples

Sample Data Sheet of Inst. 3-1-65

Submitted by G. Weathers

Date 3-1-65

Analysis Copper, Zinc, Molybdenum, Silver

Remarks Colorimetric methods used. Pulps to be returned.

cc: encl.
file

Field No.	Copper	Zinc	Molybdenum	Silver	HOLE NO	DEPTH
521-522 735 CORE	10	15	1	-1	R1	521-522
505-515 736 CORE	15	35	-1	1	R1	505-515
P-3 35-36 737 CORE	10	40	2	-1	P3	35-36
P-1 680-682 738 CORE	25	30	1	-1	R2	680-682
P-1 85 TD 739 CUTTINGS	195	60	5	-1	P1	85 TD
R-1 474-482 490 CORE	40	20	1	-1	R1	474-482
R-1 486-488	60	30	2	-1	R1	486-488
R-1 490-492 491 CORE	60	30	2	-1	R1	490-492
494-496	40	260	3	1	P4	494-496
P-4 50-52 107 42 CORE	40	260	3	1	P4	50-52 107
R-1 496-498 493 CORE	60	30	1	-1	R1	496-498
500-501	60	30	1	-1	R1	500-501
503-505	60	30	1	-1	R1	503-505

*34 to wt
L.A. Johnson*

E. A. Johnson
E. A. Johnson

All values are reported in parts per million unless specified otherwise. A minus sign (-) is to be read "less than" and a plus sign (+) "greater than". Values in parenthesis are estimates. This analytical report is the confidential property of the above mentioned client and for the protection of this client and ourselves we reserve the right to forbid publication or reproduction of this report or any part thereof without written permission.

A.E.C. # 3 PETE
SANTA CLAUS PROSPECT

35-36'

This index is spaced so that additional assay depths can be added.

To add additional assays to this folder, remove staples, insert new data at proper depths, and re-staple.

By: ARKLA EXPL. Co.

R. L. Breedlove

CHIEF GEOL.

Shop No. 735A

File No. 1771-AR

VALUES
Latest Quotation

1 oz. Gold.....

1 oz. Silver.....

1 lb. Copper.....

1 lb. Lead.....

1 lb. Zinc.....

THIS CERTIFIES
Samples submitted for assay
contain as follows:

Date 2 MARCH 1965

ASSAYS DELIVERED TO
MAIL BOX ON RD BY MISTAKE

Arizona Assay Office

815 NORTH FIRST STREET

Phone: 253-4001

Phoenix, Arizona 85001

P. O. BOX 1148

ARKANSAS LOUISIANA GAS CO

@ Santa Claus Prospect

*A & C
#3 Refe*

Short Ton 2000 Lbs.
Short Ton Unit 20 Lbs.
Long Ton 2240 Lbs.
Long Ton Unit 22.4 Lbs.

MARKS	SILVER PER TON		VALUE PER TON	GOLD PER TON		VALUE PER TON	TOTAL VALUE PER TON of Gold & Silver	PERCENTAGE			REMARKS
	Ozs.	Tenths		Ozs.	100ths						
735 A	.3			.01		\$.35		P-1	35'-36'	36'	CORE
737 A	.4			.01		\$.35		P-3	35'-36'	36'	VALIDATION CORE
742A	.4			.01		\$.35		P-4	36'-37'	37'	VALIDATION CORE

*to wt
7/4/65*

Charges \$ 12.00

Assayer.....

ANDY CHUKA, PRINT

JACK STONE REG. No. 5479

WMA

ROCKY MOUNTAIN GEOCHEMICAL LABORATORIES

233 North Marina Street

Phone: 445-4393

PRESCOTT, ARIZONA

ANALYTICAL REPORT

Date March 4, 1965

A. E. C. Page 1 of 1

Client Mr. Gerald Weathers
Arkansas Louisiana Gas Co.
P.O. Box 1047
Kingman, Arizona

*# 3 Pete
@ Santa Clara Prospect.*

Report on 9 rock samples

Sample Data Sheet of Inst. 3-1-65

Submitted by G. Weathers

Date 3-1-65

Analysis Copper, Zinc, Molybdenum, Silver

Remarks Colorimetric methods used. Pulps to be returned.

cc: encl.
file

Field No.	Copper	Zinc	Molybdenum	Silver	HOLE NO	DEPTH
521-522 735 CORE	10	45	1	1	R1	521-522
505-508 736 CORE	15	35	1	1	R1	505-508
P-3 35-36 737 CORE	10	40	2	-1	P3	35-36'
681-686 682 738 CORE	(25)	30	1	-1	R2	680-686
85-10 739 CUTTINGS	195	60	5	-1	P1	85-10
474-486 740 CORE	40	20	1	-1	R1	474-486
486-488 420-427 741 CORE	60	30	2	-1	R1 comp	486-488 420-427
427-428 24 50-52 742 CORE	40	260	3	1	P4	427-428 50-52
426-428 500-501 503-505	60	30	1	-1	R1 comp	426-428 500-501 503-505

*to w a
H. L. M. a*

E. A. Johnson
E. A. Johnson

All values are reported in parts per million unless specified otherwise. A minus sign (-) is to be read "less than" and a plus sign (+) "greater than". Values in parenthesis are estimates. This analytical report is the confidential property of the above mentioned client and for the protection of this client and ourselves we reserve the right to forbid publication or reproduction of this report or any part thereof without written permission.

A.E.C. #2 TOM
(OLD PETE #2 DPND.)
SANTA CLAUS PROSPECT

INDEX

67-73'
87-88'
96-97'
102-103'
108-112'
154-155'
166.5-168.5'

This index is spaced so that additional assay depths can be added.

To add additional assays to this folder, remove staples, insert new data at proper depths, and re-staple.

By: ARKLA EXPL. CO.

R.L. Breedlove
CHIEF GEOL.

ROCKY MOUNTAIN GEOCHEMICAL LABORATORIES

519 North Washington Ave.

Phone: 445-4393

PRESCOTT, ARIZONA 86301

ANALYTICAL REPORT

Date February 8, 1967

Page 1 of 1

Client Mr. Gerald Weathers
ARLA Exploration Co.
P.O. Box 971
Wikieup, Arizona

*A.E.C. #2 Tom
(old Pete #2 d'nd.)
@ Santa Claus prospect*

Report on 10 Drill Core Samples

Sample Data Sheet of Inst. 2-6-67

Submitted by G. Weathers

Date 2-6-67

Analysis Copper, Zinc, Molybdenum

Remarks Copper, Zinc, done by Atomic Absorption methods.
Molybdenum done by Colorimetric method.
Sample pulps to be returned.

*See P6
on next pg.*

cc: encl.
file

Sample No.	Copper	Zinc	Molybdenum
1756	195	210	3
1757	230	200	4
1758	125	145	6
1759	70	55	2
1760	120	85	2
1761	10	100	-1
1762	5	95	-1
1763	10	65	-1
1764	10	135	-1
1765	15	60	-1

*X to
L.G.W.N.A*

E. A. Johnson

E. A. Johnson

All values are reported in parts per million unless specified otherwise. A minus sign (—) is to be read "less than" and a plus sign (+) "greater than." Values in parenthesis are estimates. This analytical report is the confidential property of the above mentioned client and for the protection of this client and ourselves we reserve the right to forbid publication or reproduction of this report or any part thereof without written permission

ROCKY MOUNTAIN GEOCHEMICAL LABORATORIES

519 North Washington Ave.

Phone: 445-4393

PRESCOTT, ARIZONA 86301

ANALYTICAL REPORT

Date February 15, 1967

Page 1 of 2

Client Mr. Gerald Weathers
ARKLA Exploration Co.
P.O. Box 971
Wikieup, Arizona

Jmc
AEC #2 Tom
(old Pete #2 dprnd.)
@ Santa Claus Prospect.

Report on 15 Core & 10 Pulp Samples

Sample Data Sheet of Verbal 2-10-67

Submitted by G. Weathers

Date 2-10-67

Analysis Copper, Zinc, Lead, Molybdenum; Lead only on the Pulp samples.

Remarks Copper, Zinc, done by Atomic Absorption methods.
Lead, Molybdenum done by Colorimetric methods.
Sample pulps to be returned.

cc: encl.
file

Sample No.	<u>Lead</u>
1756	25
1757	30
1758	25
1759	25
1760	20
1761	25
1762	35
1763	15
1764	25
1765	40

E.

All values are reported in parts per million unless specified otherwise. A minus sign (—) is to be read "less than" and a plus sign (+) "greater than." Values in parenthesis are estimates. This analytical report is the confidential property of the above mentioned client and for the protection of this client and ourselves we reserve the right to forbid publication or reproduction of this report or any part thereof without written permission

*3K to LG:
WJ NM-A*

1-4 19.67
Property TOM 5
Location DD T-2 = TOM #2
County MOHAVE, ARIZ
old Pete #2 dpnd.

ARKLA No 1762

Sample Data: NX 121-123
RUBBLE IRON OXIDE
STAINED

95 PPM 5 -1
Au, Ag, Pb, Zn, Fe, Mn, Cu, Mo

Sampler G. WEATHERS

1-4 19.67
Property TOM NO 5
Location DH T-2 = TOM #2
County MOHAVE, ARIZ
old Pete #2 dpnd.

ARKLA No 1763

Sample Data: NX CORE
OXIDIZED GRANITE GNEISS
Fe OX STAINED

65 PPM 10 -1
Au, Ag, Pb, Zn, Fe, Mn, Cu, Mo

Sampler G. Weathers

1-5 19.67
Property TOM NO 5
Location DH T-2 = TOM #2
County MOHAVE, ARIZ
old Pete #2 dpnd.

ARKLA No 1764

Sample Data: NX CORE
154-155 RUBBLED
BIOTITE GRANITE GNEISS

135 PPM 10 -1
Au, Ag, Pb, Zn, Fe, Mn, Cu, Mo

Sampler G. Weathers

1-5 19.67
Property TOM NO 5
Location DH T-2 = TOM #2
County MOHAVE, ARIZ
old Pete #2 dpnd.

ARKLA No 1765

Sample Data: NX CORE
166⁵ - 168⁵
OXIDIZED GRANITE GNEISS
FRACTURE PLANES STAINED w/FeOx
DK GR COATING 168 (PYRITE?)

60 PPM 15 -1
Au, Ag, Pb, Zn, Fe, Mn, Cu, Mo

Sampler G. Weathers

Property 2-4 1967
Property TOM NO 5
Location TOM NO 2 (COLLIER P-2)
County MOHAVE, ARIZ

ARKLA No 1756

Sample Data: NX CORE
OXIDIZED GRANITE GNEISS
67-68⁵

210 PPM
Au, ~~Ag~~ Pb, Zn, Fe, Mn, Cu, Mo

Sampler G. WEATHERS

1756-65
195
Comp. of

Property 2-4 1967
Property TOM 5
Location T-2 146 = TOM #2 (Dpn) (Pete #2)
County MOHAVE, ARIZ

ARKLA No 1757

Sample Data: NX CORE
WEATHERED GRANITE GNEISS
70-73

200 PPM 230 4
Au, ~~Ag~~ Pb, Zn, Fe, Mn, Cu, Mo

Sampler G. WEATHERS

Property 1-4 1967
Property TOM NO 5
Location HOLE T-2 = TOM #2 (old Pete #2) (dpnd)
County MOHAVE ARIZ

ARKLA No 1758

Sample Data: NX CORE
87-88 OXIDIZED
GRANITE GNEISS

148 125 6
Au, ~~Ag~~ Pb, Zn, Fe, Mn, Cu, Mo

Sampler G. WEATHERS

Property 1-4 1967
Property TOM NO 5
Location DH T-2 = TOM #2 (old Pete #2) (dpnd)
County MOHAVE, ARIZ

ARKLA No 1759

Sample Data: NX CORE
96-97

55 PPM 70 2
Au, ~~Ag~~ Pb, Zn, Fe, Mn, Cu, Mo

Sampler G. WEATHERS

Property 1-4 1967
Property TOM 5
Location DH T-2 = TOM #2 (old Pete #2) (dpnd)
County MOHAVE, ARIZ

ARKLA No 1760

Sample Data: NX 102-103

85 PPM 120 2
Au, ~~Ag~~ Pb, Zn, Fe, Mn, Cu, Mo

Sampler G. WEATHERS

Property 1-4 1967
Property TOM NO 5
Location DH T-2 = TOM #2 (old Pete #2) (dpnd)
County MOHAVE, ARIZ

ARKLA No 1761

Sample Data:
108⁵ - 112⁰

100 PPM 10 -1
Au, ~~Ag~~ Pb, Zn, Fe, Mn, Cu, Mo

Sampler G. WEATHERS

NM-A
COA

A.E.C. #12 TOM

INDEX

16-92'

This index is spaced so that additional assay depths can be added.

To add additional assays to this folder, remove staples, insert new data at proper depths, and re-staple.

By: ARKLA EXPL. Co.

R. L. Breddlove

CHIEF GEOL.

By: Rocky Mt Geo Chem

A.E.C. # 12 ^{Page 2} TOM

Sample No. Copper Zinc Lead Molybdenum @

1772	30	110	15	3
1773	25	<u>105</u>	<u>10</u>	3
<u>T-12</u> 1774	<u>15</u>	<u>120</u>	<u>35</u>	5
1775	15	100	20	6
1776	10	75	15	5
1777	5	75	20	3
1778	10	40	25	1
1779	15	60	45	3
1780	10	75	10	2

A.E.C. # 12 Tom

@ Santa Claus Prospect

3x-to.
L.G. - A
W.N.M. - A

E. A. Johnson
E. A. Johnson

N.M.A

2-9 1967
 Property TOM 20
 Location T-12 = Tom #12 (drill hole)
 County MOHAVE, ARIZ

ARKLA No 1773

 Sample Data: NX
WEA GR. GNEISS, FeOx & MnO₂ STAINED

 Au, Ag, Pb, Zn 105, Fe, Mn, Cu, Mo 3
 _____ 10 _____ 25
 Sampler G. WEATHERS

2-9 1967
 Property TOM No 20
 Location T-12 = Tom #12 (drill hole)
 County MOHAVE ARIZ

ARKLA No 1772

 Sample Data: NX CORE
16.0' - 18.0' FeOx STAINED CORE

 Au, Ag, Pb, Zn 15 110, Fe, Mn, Cu, Mo 30 3
 _____ _____
 Sampler G. WEATHERS

2-9 1967
 Property TOM 20
 Location DM T-12 = Tom #12 (drill hole)
 County MOHAVE, ARIZ

ARKLA No 1775

 Sample Data: NX 41-43

 Au, Ag, Pb, Zn 35 100, Fe, Mn, Cu, Mo 15
 _____ _____ 6
 Sampler G. WEATHERS

2-9 1967
 Property TOM - 20
 Location T-12 = Tom #12 (drill hole)
 County MOHAVE, ARIZ

ARKLA No 1774

 Sample Data: NX CORE
28-30 FeOx STAINED RUBBLE

 Au, Ag, Pb, Zn 35 120, Fe, Mn, Cu, Mo 5
 _____ 15
 Sampler G. Weather

2-9 1967
 Property TOM 20
 Location DM T-12 = Tom #12 (drill hole)
 County MOHAVE, ARIZ

ARKLA No 1777

 Sample Data: NX CORE 54-56
BIOTITE GR GNEISS

 Au, Ag, Pb, Zn 20 75, Fe, Mn, Cu, Mo 5 3
 _____ _____
 Sampler G. WEATHERS

2-9 1967
 Property TOM 20
 Location DM T-12 = Tom #12 (drill hole)
 County MOHAVE, ARIZ

ARKLA No 1776

 Sample Data: NX
45.0' - 47.0' FeOx STAINED GR. GNEISS

 Au, Ag, Pb, Zn 15 75, Fe, Mn, Cu, Mo
 _____ 10 5
 Sampler G. Weather

Property 2-10 1967
Location TOM 20
County MOHAVE ARIZ

ARKLA No 1779

Sample Data: NX CORE
GR GNEISS, SILICIFIED
BIOTITE LINED 80-90° 1170 CORE

86⁵ - 88⁵

Au, Ag, Pb, Zn, Fe, Mn, Cu, Mo
AS

Sampler G. WEATHERS

Drill hole

Property 2-10 1967
Location TOM No 20
County MOHAVE, ARIZ

ARKLA No 1778

Sample Data: NX CORE
79-81

GRAY BIOTITE GNEISS, SILICIFIED
HARD

Au, Ag, Pb, Zn, Fe, Mn, Cu, Mo

Sampler G. Weathers

hole

Property 2-10 1967
Location TOM No 20
County MOHAVE, ARIZ

ARKLA No 1780

Sample Data: NX CORE
HARD SILICIFIED LT GRAY
BIOTITE GRANITE

91-92

Au, Ag, Pb, Zn, Fe, Mn, Cu, Mo

Sampler G. Weathers

Drill hole