

R 13 E

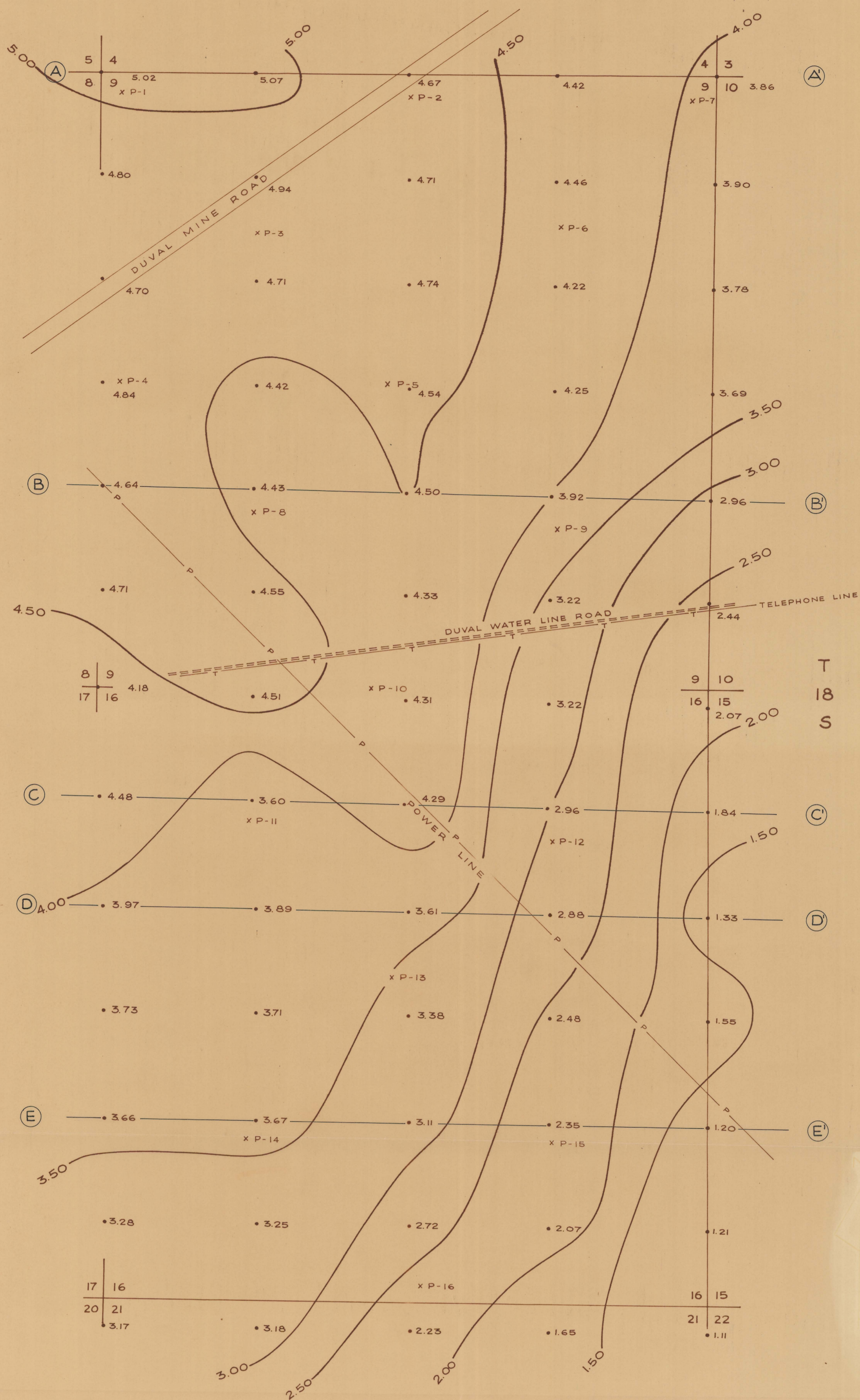

GRAVITY DEPTH ESTIMATION

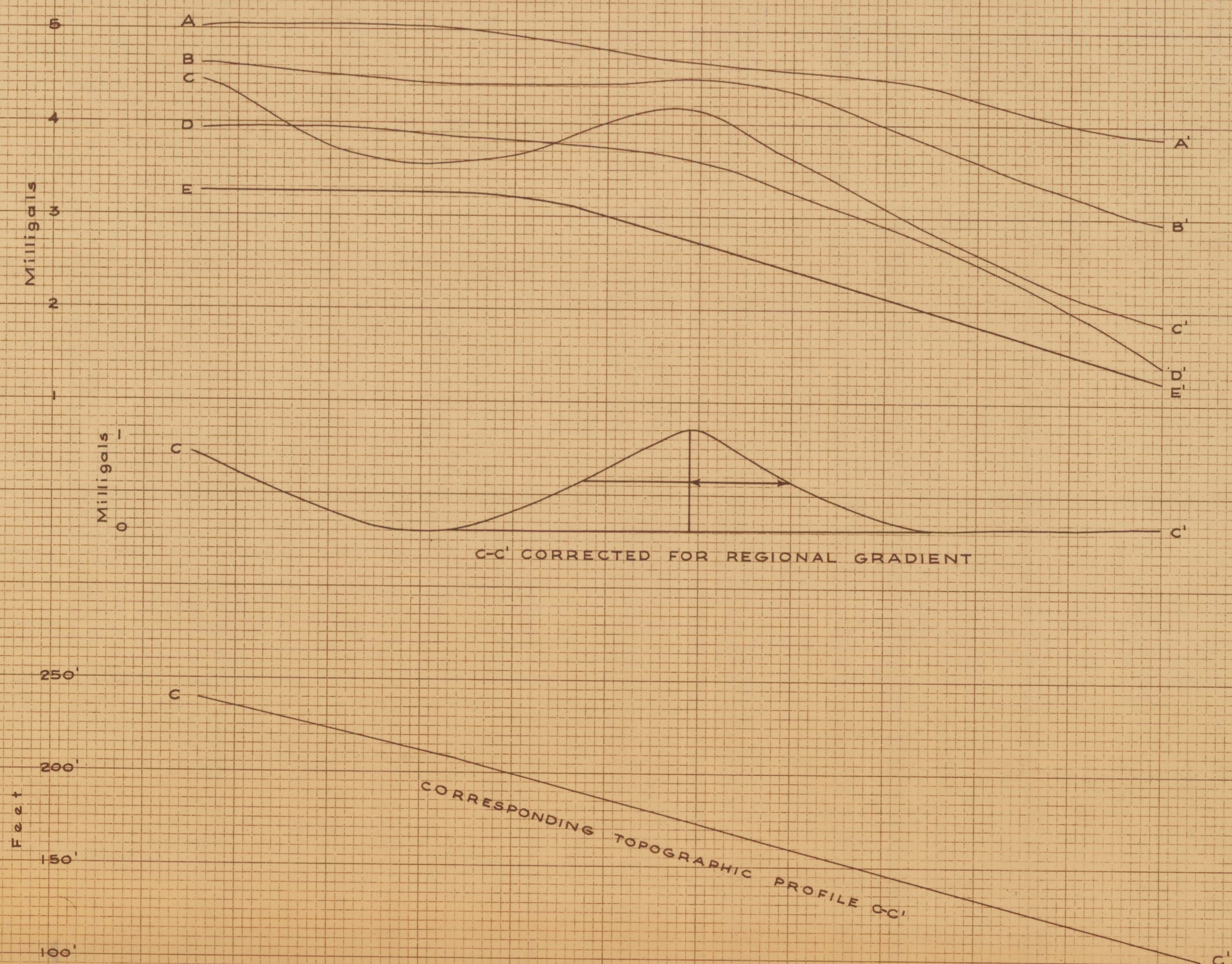

HEINRICH'S GEOEXPLORATION COMPANY P.O. Box 5671 Tucson, Arizona		
GRAVITY SURVEY FOR HECLA MINING COMPANY		
TWIN BUTTES AREA PIMA COUNTY, ARIZONA		
SCALE: 1" = 500'	CONTOUR INTERVAL:	REVISIONS
DATE: OCT. 1964	DATA BY: J. P. M. & J. W. L.	
DRAWN BY: i. b.	SHEET OF	FILE:
	DRAWING NO.:	

471-10-10 4/58