

205	a	WID.	OZ. AU	OZ. AG	% CU	% PB	% ZN
	b	1.25'	.03	1.1	.12	0.3	2.0
	c	1.5'	.19	2.7	.33	6.2	6.2

WID.	OZ. AU	OZ. AG	% CU	% PB	% ZN	
1.83'	.04	2.5	.36	0.5	1.0	a
2.0'	.11	1.2	.12	0.0	0.0	b
2.17'	.005	8.2	2.60	0.0	0.0	c
3.17'	.06	.45	.10	0.0	0.6	d
1.58'	.08	4.9	.43	12.3	5.8	e

200 FOOT LEVEL

38.5 FEET BELOW 160 FOOT LEVEL

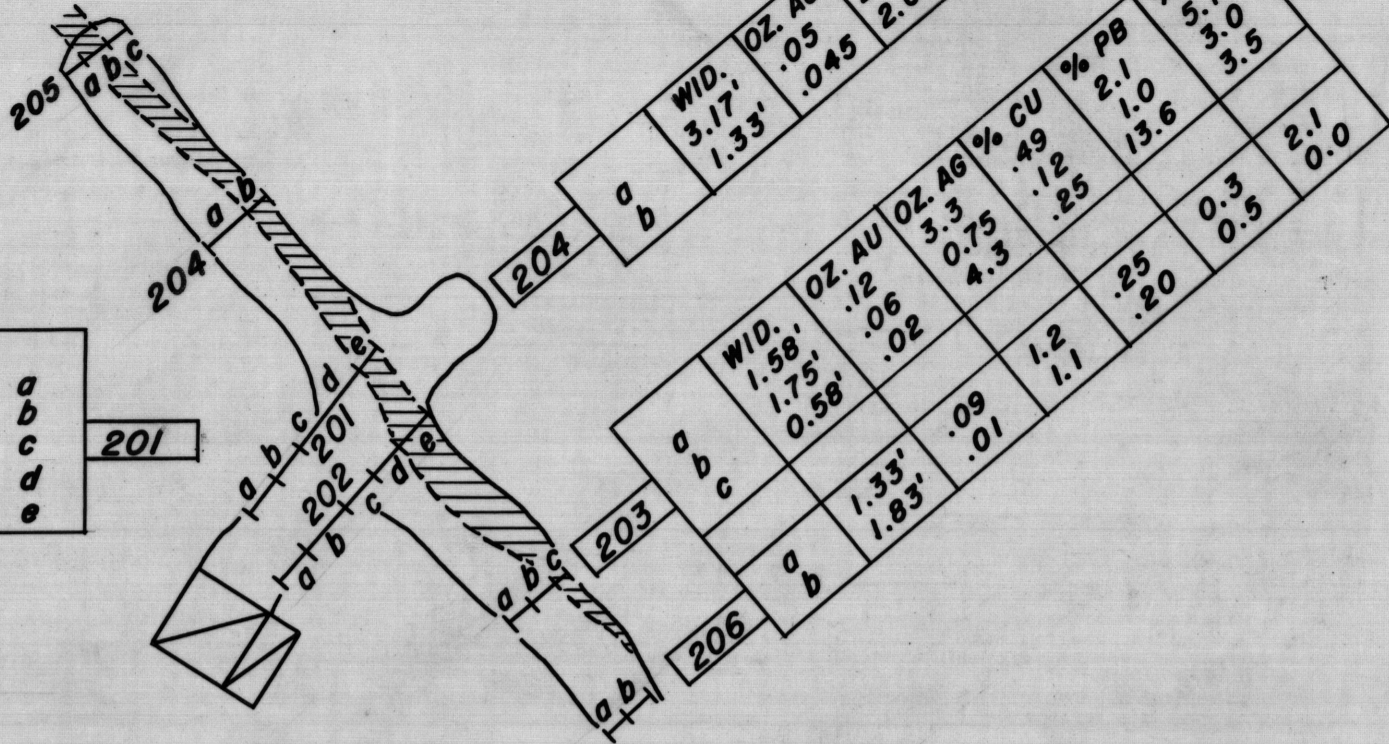

202	a	WID.	OZ. AU	OZ. AG	% CU	% PB	% ZN
	b	2.00'	.06	2.45	.38	0.7	4.6
	c	3.08'	.09	6.5	1.59	0.0	0.0
	d	2.50'	.03	6.8	1.62	0.0	0.0
	e	2.00'	.005	1.5	.36	0.0	0.0

NOTE: SAMPLING, EXCEPT WHERE OTHERWISE NOTED, BY U.S.S.R. & M. CO., APRIL, 1942.

OTHERWISE NOTED, APRIL 1942

COMPANY SAMPLING - APRIL, 1942

EXAMINATIONS BY U. S. BUREAU OF MINES IN AUGUST AND SEPTEMBER, 1943

WORKINGS ACCESSIBLE IN AUGUST, 1943; LOWER LEVELS FLOODED IN SEPTEMBER, 1943

303	a	WID.	OZ. AU	OZ. AG	% CU	% PB	% ZN
	b	1.67'	.02	0.7	.15	0.0	0.4
	c	1.33'	.07	1.6	.20	1.2	0.7

306	a	WID.	OZ. AU	OZ. AG	% CU	% PB	% ZN
	b	0.67'	.03	2.0	.46	0.7	1.0
	c	1.75'	.05	2.85	.41	1.2	1.5

2272 USBM	WID.	OZ. AU	OZ. AG	% CU	% PB	% ZN
	5.0'	.185	2.90	.17	1.8	10.8

2273 USBM	WID.	OZ. AU	OZ. AG	% CU	% PB	% ZN
	5.0'	.035	3.35	.16	0.1	0.5



302	a	WID.	OZ. AU	OZ. AG	% CU	% PB	% ZN
	b	1.00'	.02	1.3	.02	1.1	2.4
	c	1.42'	.12	4.3	.64	4.4	6.6

301	WID.	OZ. AU	OZ. AG	% CU	% PB	% ZN
	2.33'	.10	7.6	1.83	1.2	3.4

300 FOOT LEVEL

135.5 FEET BELOW 160 FOOT LEVEL

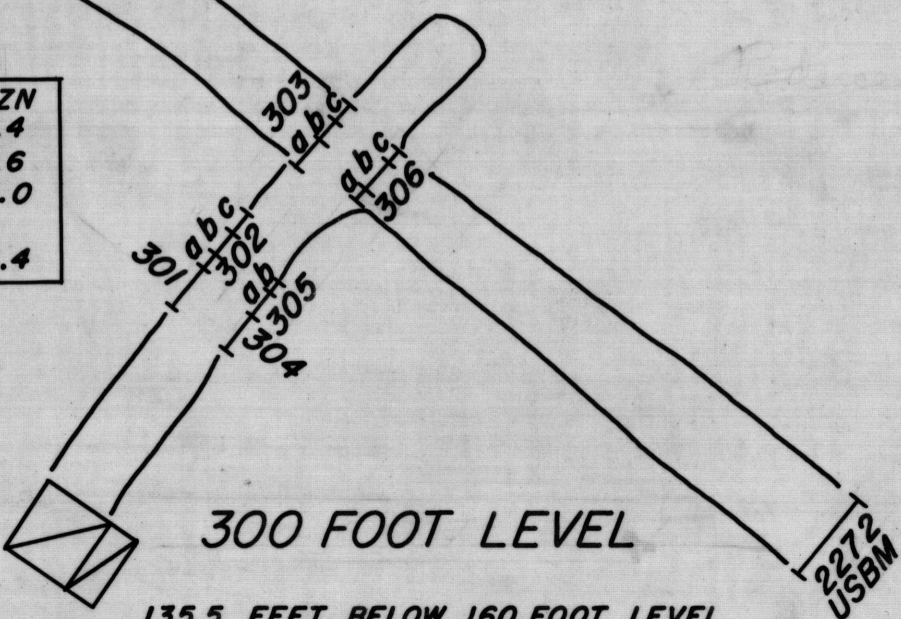

305	a	WID.	OZ. AU	OZ. AG	% CU	% PB	% ZN
	b	1.5'	.08	2.6	.39	1.4	2.3

304	WID.	OZ. AU	OZ. AG	% CU	% PB	% ZN
	2.42'	.07	1.7	.30	2.1	5.5

USBM 2272 SAMPLE BY BUREAU OF MINES

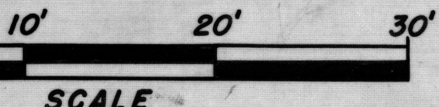

MAP TRACED FROM SAMPLE PLAT FURNISHED BY U.S.S.R. & M. CO.

FIG. 10-SAMPLE PLATS OF 200 FT. & 300 FT. LEVELS, SUMMIT MINE

FIG. 2 - SAMPLE MAPS OF LOWER LEVELS, SUMMIT MINE