

Sample No.	Sample Width	Percentages		
		Zn.	Pb.	Cu.
1	5.0'	5.8	6.96	1.17
2	4.5'	10.2	10.22	1.37
3	3.0'	9.8	17.10	2.64
4	3.5'	9.6	10.68	1.91
5	3.0'	12.6	9.56	0.88
6	2.5'	14.4	10.44	1.55
7	4.5'	7.0	15.02	0.50
8	3.0'	11.4	14.48	1.00

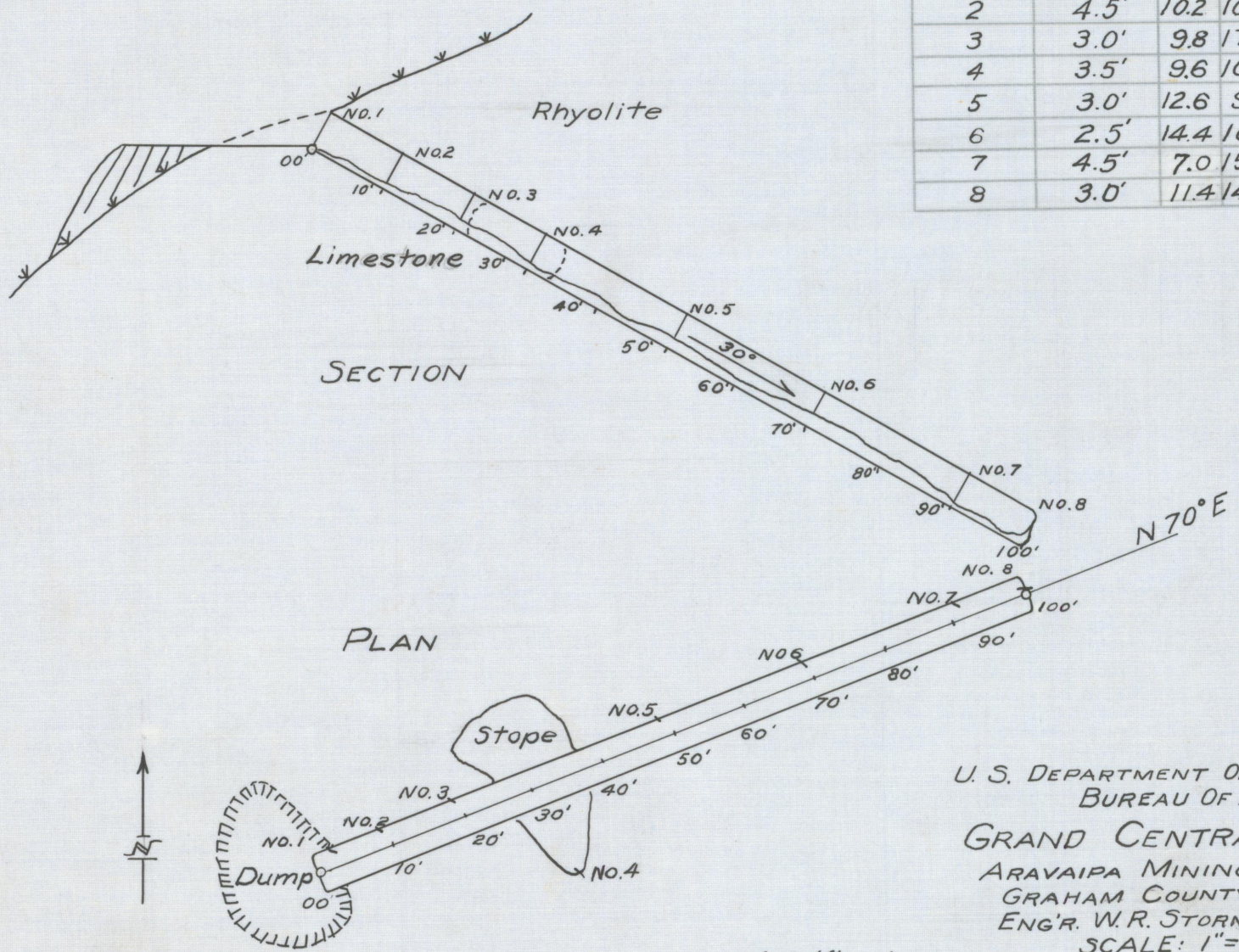

Traced from map by A. J. Klamt.

U. S. DEPARTMENT OF THE INTERIOR
 BUREAU OF MINES
GRAND CENTRAL MINE
 ARAVAIPA MINING DISTRICT
 GRAHAM COUNTY, ARIZ.
 ENG'R. W. R. STORMS - JUNE, 1942
 SCALE: 1" = 20'

Fig. 9.