

- EXPLANATION**
- Diabase
  - Probable area containing mineable asbestos
  - Intensely faulted area
  - Geologic contact
  - Thrust faults
  - Strike-slip faults
  - Strike and dip of beds
  - Horizontal beds
  - Mine workings
  - position *guessed approximate*
- Distribution of asbestos**
- ← Total thickness of asbestos veins } in inches
  - ← Thickness of asbestos-serpentine zone }

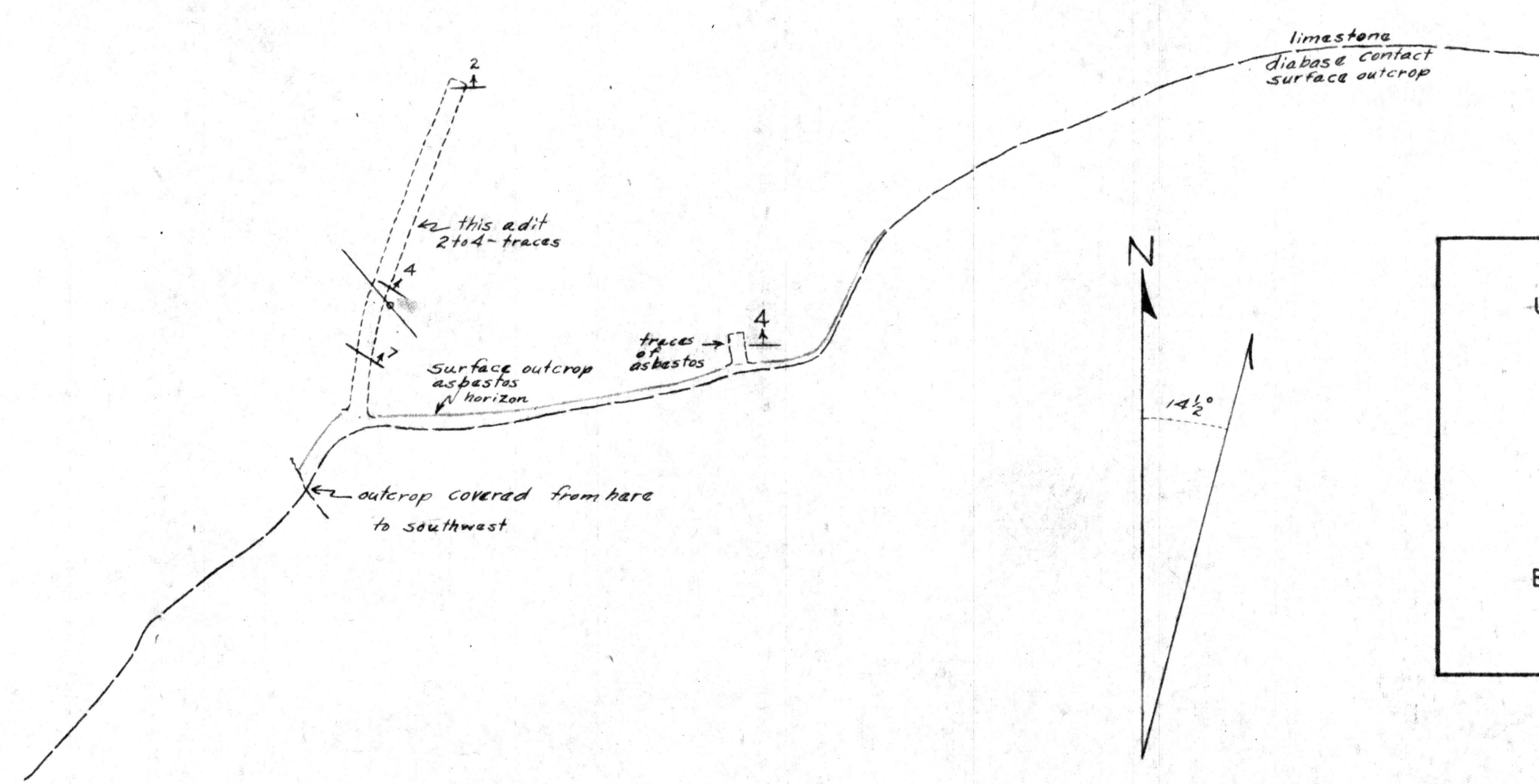

UNITED STATES DEPARTMENT OF THE INTERIOR  
 GEOLOGICAL SURVEY  
 MAP OF THE LADDER MINE  
 GILA COUNTY, ARIZONA

Scale  
 0 25 50 100 150 200 FEET

By  
 A.F. Shride-May 1944