

UNITED STATES  
DEPARTMENT OF THE INTERIOR  
BUREAU OF MINES  
ARIZONA DISTRICT

Map Showing  
ORE ESTIMATE DATA  
APACHE IRON DEPOSIT  
TO ACCOMPANY REPORT ON ARIZONA  
IRON DEPOSITS DATED MARCH 9,  
1943

SCALE: 1" = 500'  
CONTOUR INTERVAL: 250 feet

Elev. at Collar	Depth Ore	Elev. Ore	Hole
5840	415	5425	1(L)
5870	460	5410	2(K)
6230	270	5960	3(B)
6020	630	5390	4(A)
6210	145	6065	5(C)
6410	285	6125	6(D)

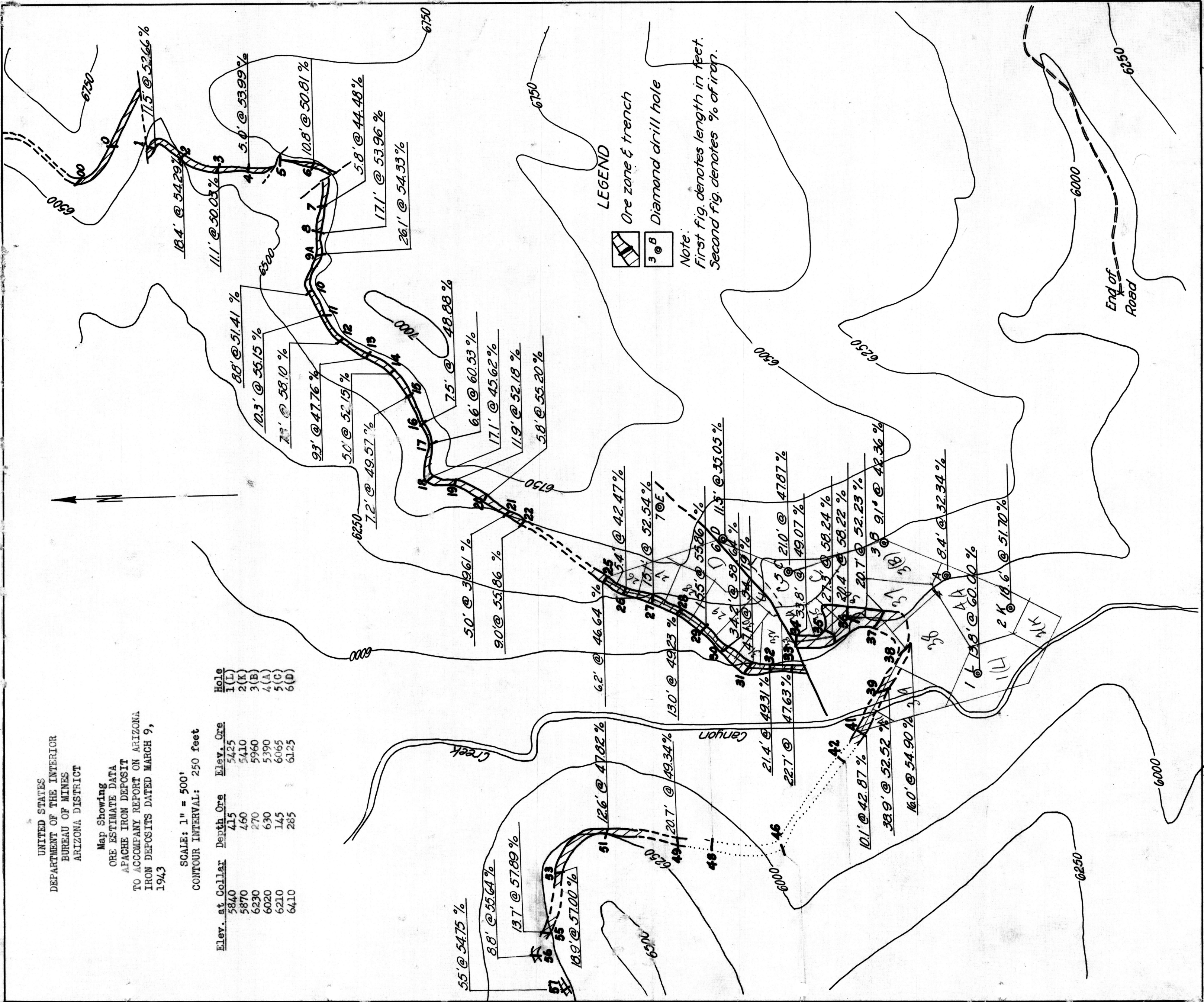

LEGEND

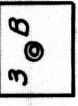
-  Ore zone & trench
-  Diamond drill hole

Note:  
First fig. denotes length in feet.  
Second fig. denotes % of iron.