

UNITED STATES  
DEPARTMENT OF THE INTERIOR  
**BUREAU OF MINES**

ARIZONA DISTRICT

**REWARD-ZINC**

PROJECT NO. 1587

**INDEX MAP**

SCALE 1"=500'

LEGEND

- |  |                               |                          |
|--|-------------------------------|--------------------------|
| 335 1/2  Slope Wash                                    | 350  Altered Limestone        | Quartz Porphyry Dike     |
| 325  Monzonite Porphyry                                | 354  Garnet Rock<br>Magnetite | Hornblende Porphyry Sill |
| 343  Quartzite, Quartz Conglomerate & Impure Sandstone | 349  Mineralized Zones        | Boulder Conglomerate     |
| 320  Limestone, Dolomite                               | Transit Station               |                          |

- 40° Dip & Strike of Bedding
- 70° Fault, Showing Dip & Down Thrown Side (D)  
Dashed Where Not Well Exposed.
- 70° Strike & Dip of Minor Shear.
- 70° Strike & Dip of Joint.

GEOLOGY BY  
J. B. HADLEY &  
H. S. SULLWOLD JR.  
U-S-G-S-

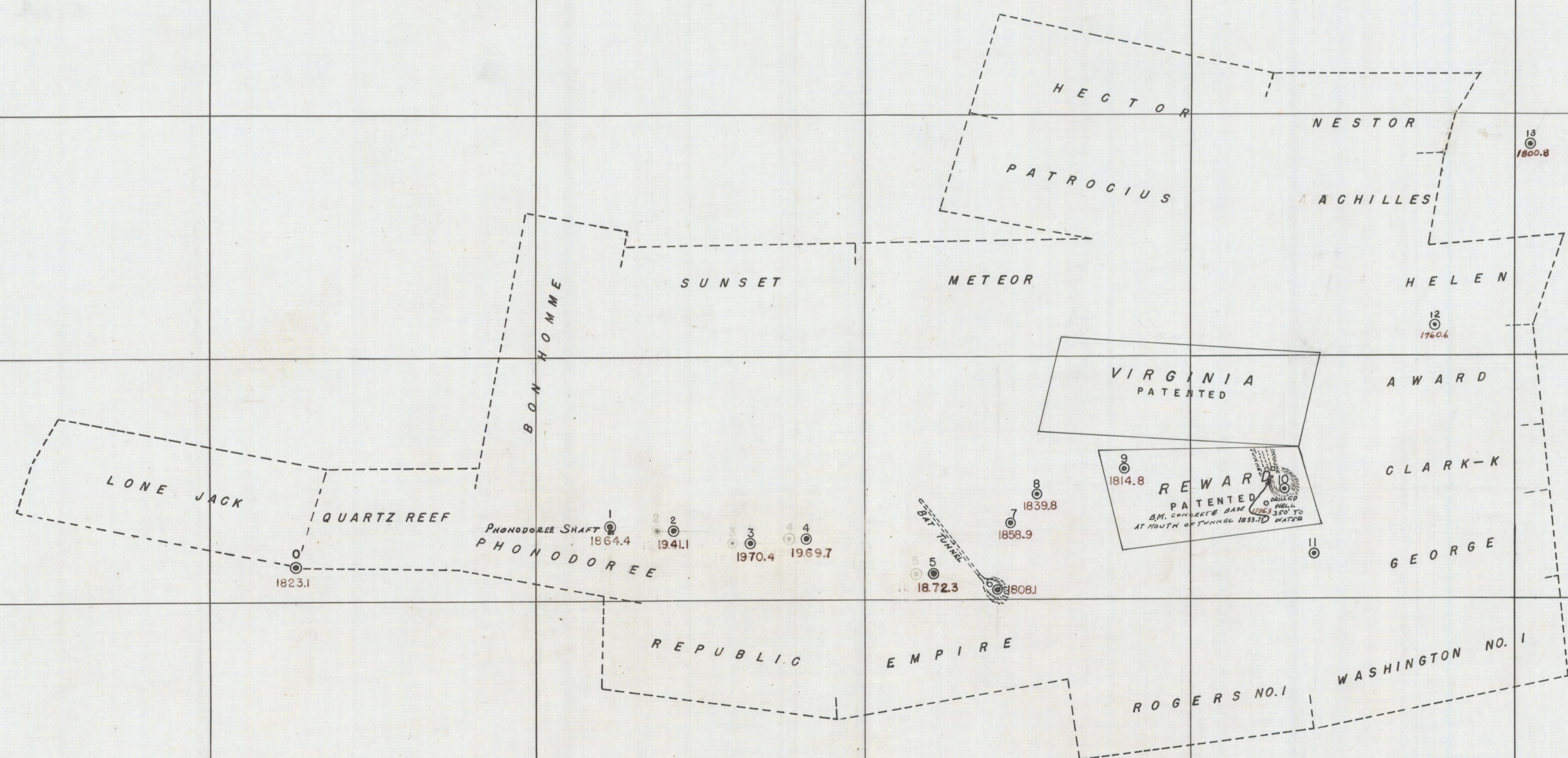

**NOTICE**  
The claim boundaries shown on this map are for INDEX use only, and should not be assumed to represent their exact position.

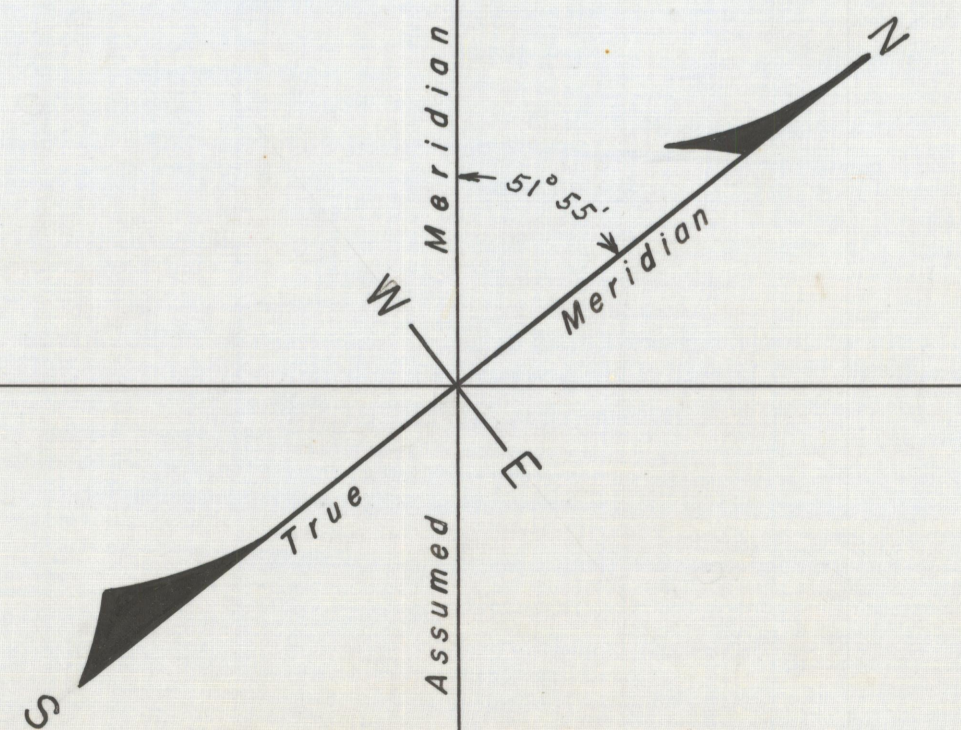

REVISED

BY	DATE	BY	DATE