

EXPLANATION

ROCKS

QUATERNARY	Qal	BOLSON DEPOSITS
TERTIARY (?)	f	FELSITE PORPHYRY
	qp	QUARTZ PORPHYRY
CRETACEOUS (?)	d	DIORITE PORPHYRY DIKES & SHEETS
	Kcg	CONGLOMERATE, SANDSTONE, SEDIMENTARY & VOLCANIC BRECCIA, LAVA.
	Ka	ARKOSE, FINE CONGLOMERATE, VOLCANIC BRECCIA.
	Ks	QUARTZ CONGLOMERATE, QUARTZITE, RED SANDSTONE.
MISSISSIPPIAN	Cme	LIMESTONE <i>Pentremites Zone</i>
DEVONIAN (?)	Dm	MAGNESIAN LIMESTONE
CAMBRIAN	€m	LIMESTONE, DOLOMITE, ARENACEOUS SHALE, CALCAREOUS SANDSTONE.
	€t	QUARTZITE

CONTACTS

observed ———
inferred - - - - -
gradational - - - - -

FAULTS

observed ———
inferred - - - - -
concealed - - - - -
arrow shows dip. D = downthrown side.

33 strike & dip of beds.
X Principal mine workings ———
Travelled roads ———

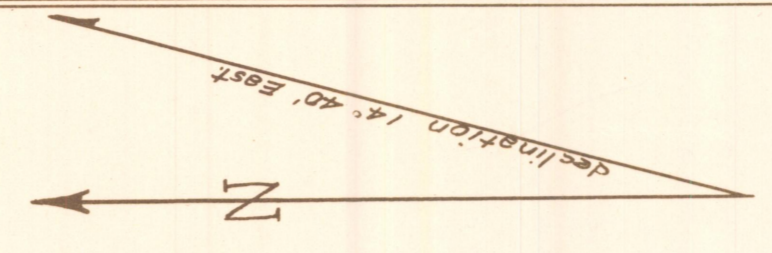

GEOLOGIC AND TOPOGRAPHIC MAP OF THE EASTERN PART OF THE VEKOL MOUNTAINS PINAL COUNTY, ARIZONA

SCALE :
0 500 1000 1500 2000 2500 FEET
CONTOUR INTERVAL 50 FEET
DATUM MEAN SEA LEVEL

UNITED STATES GEOLOGICAL SURVEY, CONFIDENTIAL
TOPOGRAPHY FROM U.S.G.S. VEKOL MTS. SHEET
GEOLOGY BY JARVIS B. HADLEY & HAROLD H. SULLWOLD, JR.
DECEMBER, 1942