

# LAKE SHORE GROUP

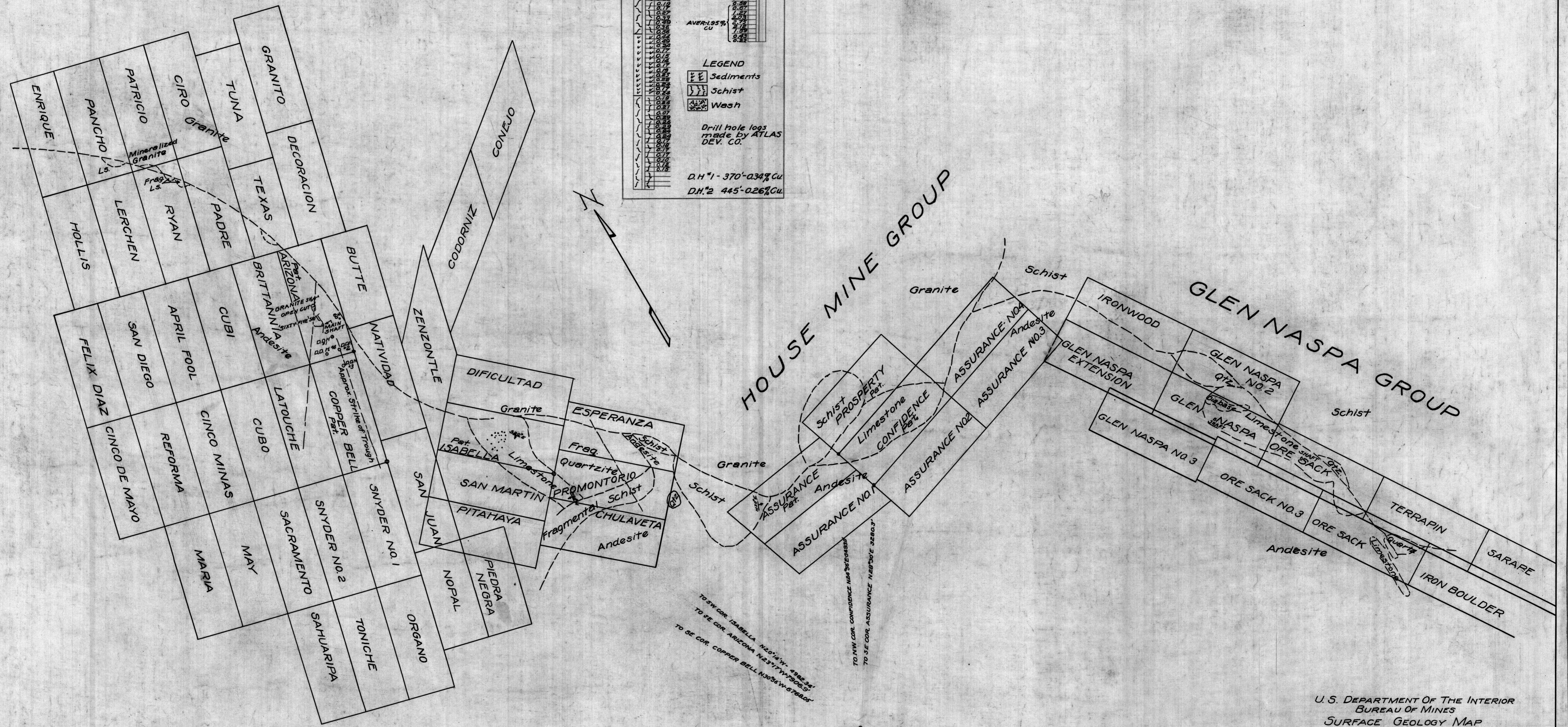
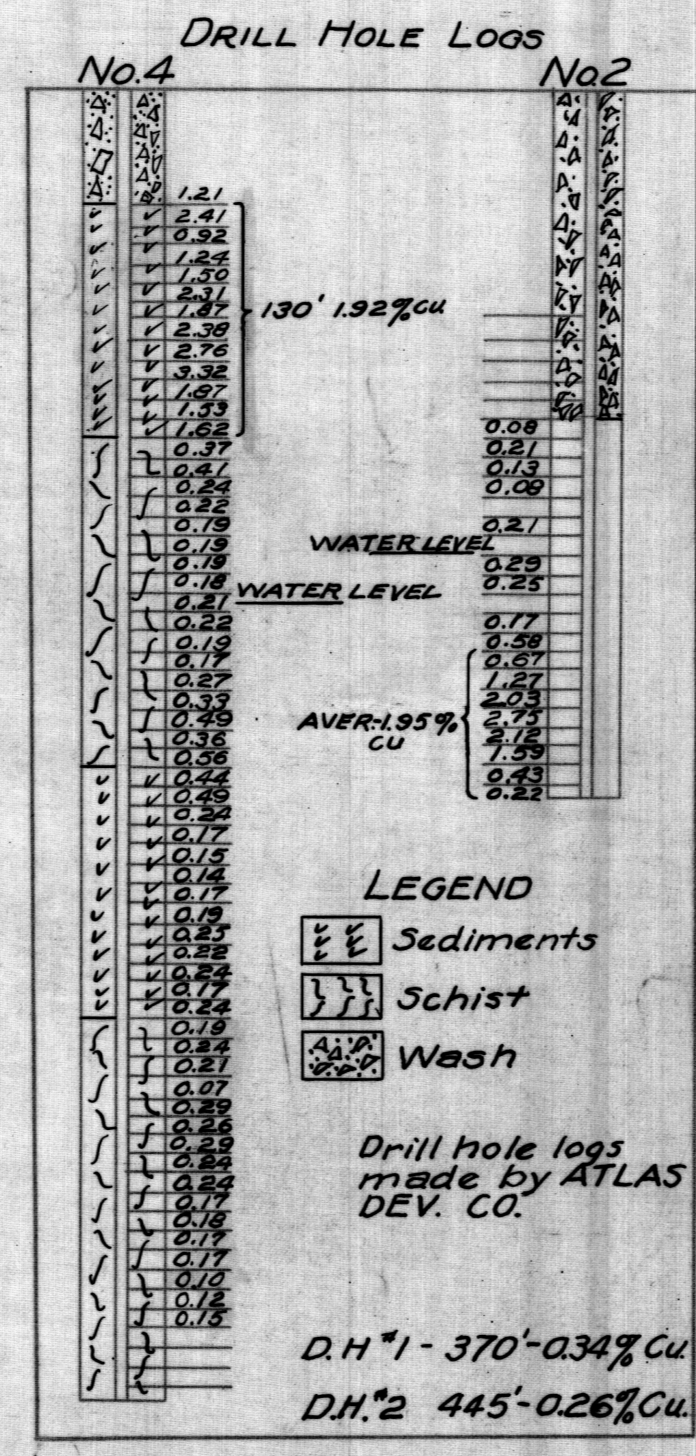

U.S. DEPARTMENT OF THE INTERIOR  
BUREAU OF MINES  
SURFACE GEOLOGY MAP  
**LAKE SHORE & ADJOINING PROPERTIES**  
CASA GRANDE MINING DIST.  
PINAL COUNTY, ARIZONA  
TRACED FROM MAP BY FRANK M. LEONARD, JR.  
ENGR. O. M. BISHOP  
JUNE, 1942  
SCALE: 1 in. = 600 FT. FIG. 1