

Samp. No.	Samp. Length	Per Cent Cu.
19	5'	0.93
20	5'	1.10
21	5'	0.38
22	5'	0.25
23	5'	0.49
24	5'	0.39
25	5'	2.31
26	5'	2.11
27	5'	4.15
28	5'	1.12
29	5'	1.06
30	5'	1.40
31	5'	1.78

Samp. No.	Samp. Length	Per Cent Cu.
32	5'	1.18
33	5'	1.93
34	5'	1.97
35	5'	2.52
36	5'	1.40
37	5'	1.37
38	5'	4.25
39	5'	2.47
40	5'	1.31
41	5'	0.52
42	5'	0.93
43	5'	1.92
44	5'	2.31
45	5'	1.90
46	5'	1.15
47	5'	0.63
48	5'	0.95
49	5'	0.38
50	5'	0.52
51	5'	0.65
52	5'	0.30

Samp. No.	Samp. Length	Per Cent Cu.
60	5'	2.35
61	5'	4.26
62	5'	4.65
63	5'	2.00
64	5'	1.16
65	5'	1.60
66	5'	1.70
67	5'	1.90
68	5'	1.05
69	5'	1.96
70	5'	1.58
71	5'	1.43
72	5'	1.12
73	5'	0.89
74	5'	0.58
75	5'	0.43
76	5'	0.62
77	5'	0.70
109	5'	3.29
110	5'	0.34
111	5'	0.54
112	5'	1.18
113	5'	1.95
114	5'	2.88
115	5'	4.97
116	5'	1.56
117	5'	0.85
118	5'	1.38
119	5'	1.75
120	5'	1.02
121	5'	1.52
122	5'	1.95
123	5'	0.83

Samp. No.	Samp. Length	Per Cent Cu.
53	5'	6.39
54	5'	2.28
55	5'	0.25
56	5'	2.39
57	5'	1.83
58	5'	1.81
59	5'	1.71

Samp. No.	Samp. Length	Per Cent Cu.
1	5'	3.50
2	5'	2.31
3	5'	2.40
4	5'	2.12
5	5'	1.75
6	5'	2.65
7	5'	1.47
8	5'	2.87
9	5'	3.29
10	5'	2.12
11	5'	1.41
12	5'	0.41
13	5'	0.50
14	5'	0.37
15	5'	0.40
16	5'	0.80
17	5'	0.92
18	5'	0.50
106	6'	0.74
107	6'	0.58
108	6'	0.36

DRILL HOLE LOGS

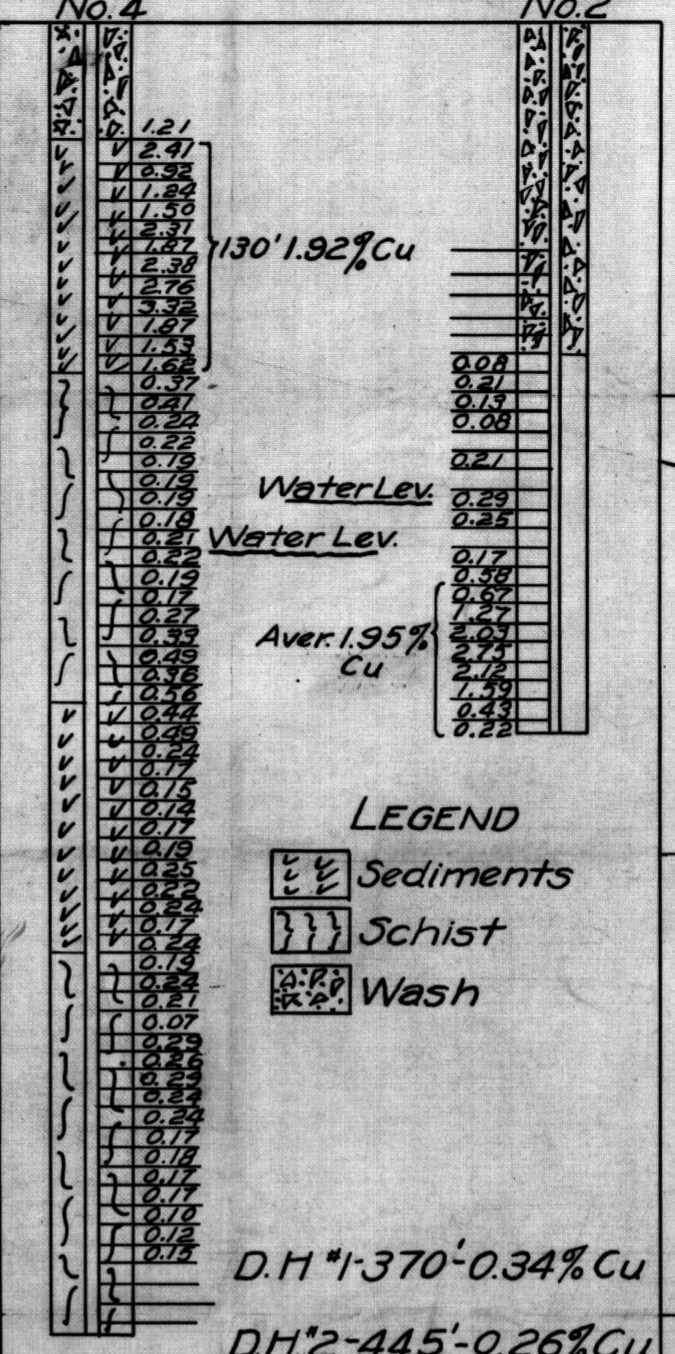

D.M. #1-370'-0.34% Cu
D.M. #2-445'-0.26% Cu

Samp. No.	Samp. Length	Per Cent Cu.
124	5'	0.78
125	5'	2.32
126	5'	3.40
127	5'	0.21
128	5'	1.78
129	5'	2.48
130	5'	1.49
131	5'	0.80
132	5'	2.05

Samp. No.	Samp. Length	Per Cent Cu.
78	5'	2.32
79	5'	1.50
80	5'	3.07
81	5'	2.35
82	5'	1.48
83	5'	1.82
84	5'	1.52
85	5'	1.83
86	5'	1.82
87	5'	2.32
88	5'	0.37
89	5'	0.28
90	5'	0.37
91	5'	1.87
92	5'	0.22
93	5'	0.22
94	5'	0.25
95	5'	0.17
96	5'	0.30
97	5'	0.26
98	5'	1.45
99	5'	2.80
100	5'	2.71
101	5'	2.30
102	5'	0.98
103	5'	1.21
104	5'	0.54
105	5'	0.34

LEGEND

- Sediments
- Schist
- Wash

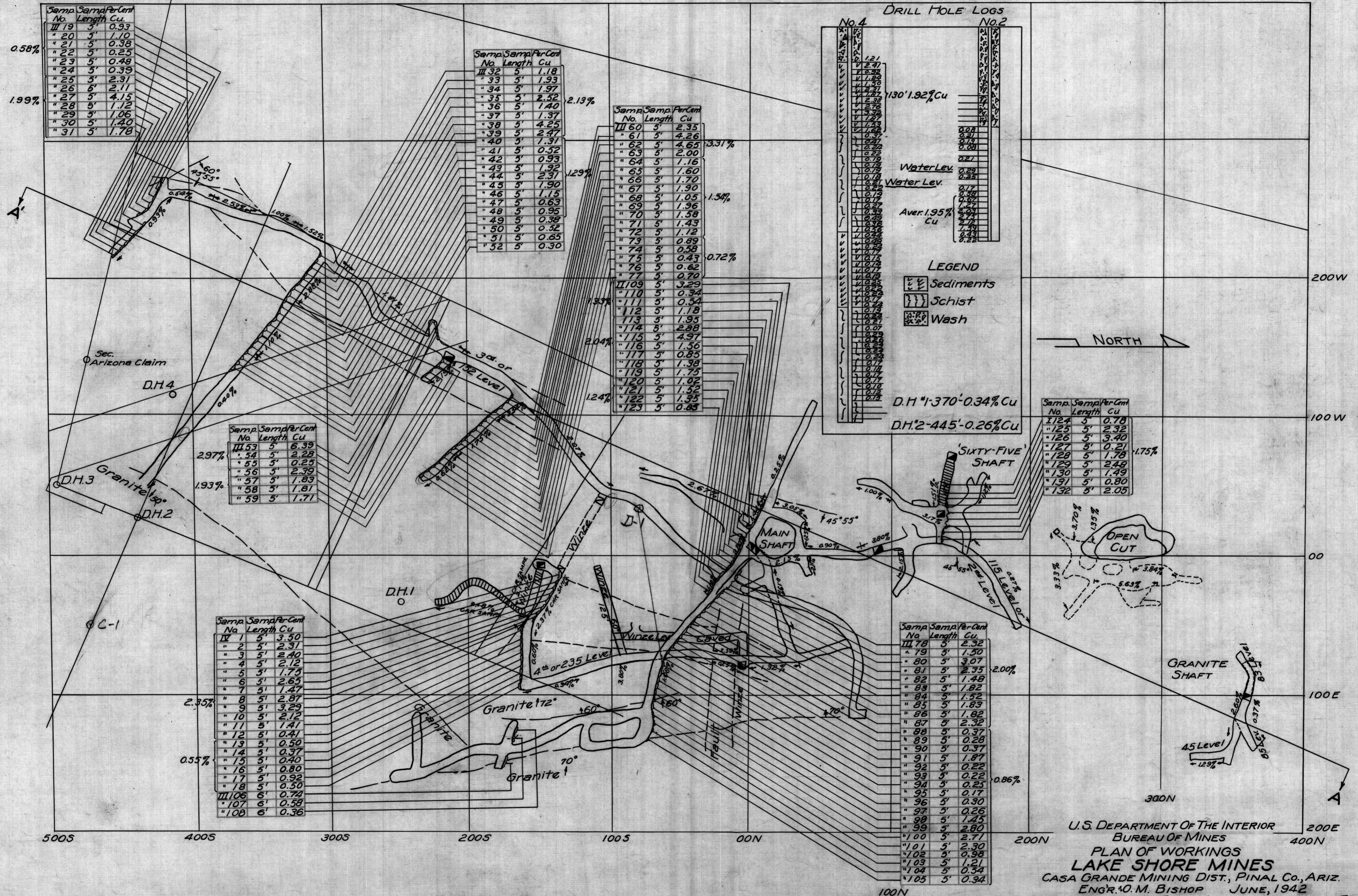
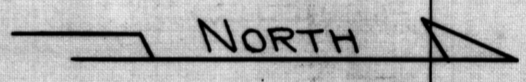

U.S. DEPARTMENT OF THE INTERIOR
BUREAU OF MINES
PLAN OF WORKINGS
LAKE SHORE MINES
CASA GRANDE MINING DIST., PINAL CO., ARIZ.
ENGR. O. M. BISHOP JUNE, 1942
SCALE: 1 IN. = 40 FT. APPROX.