

81#

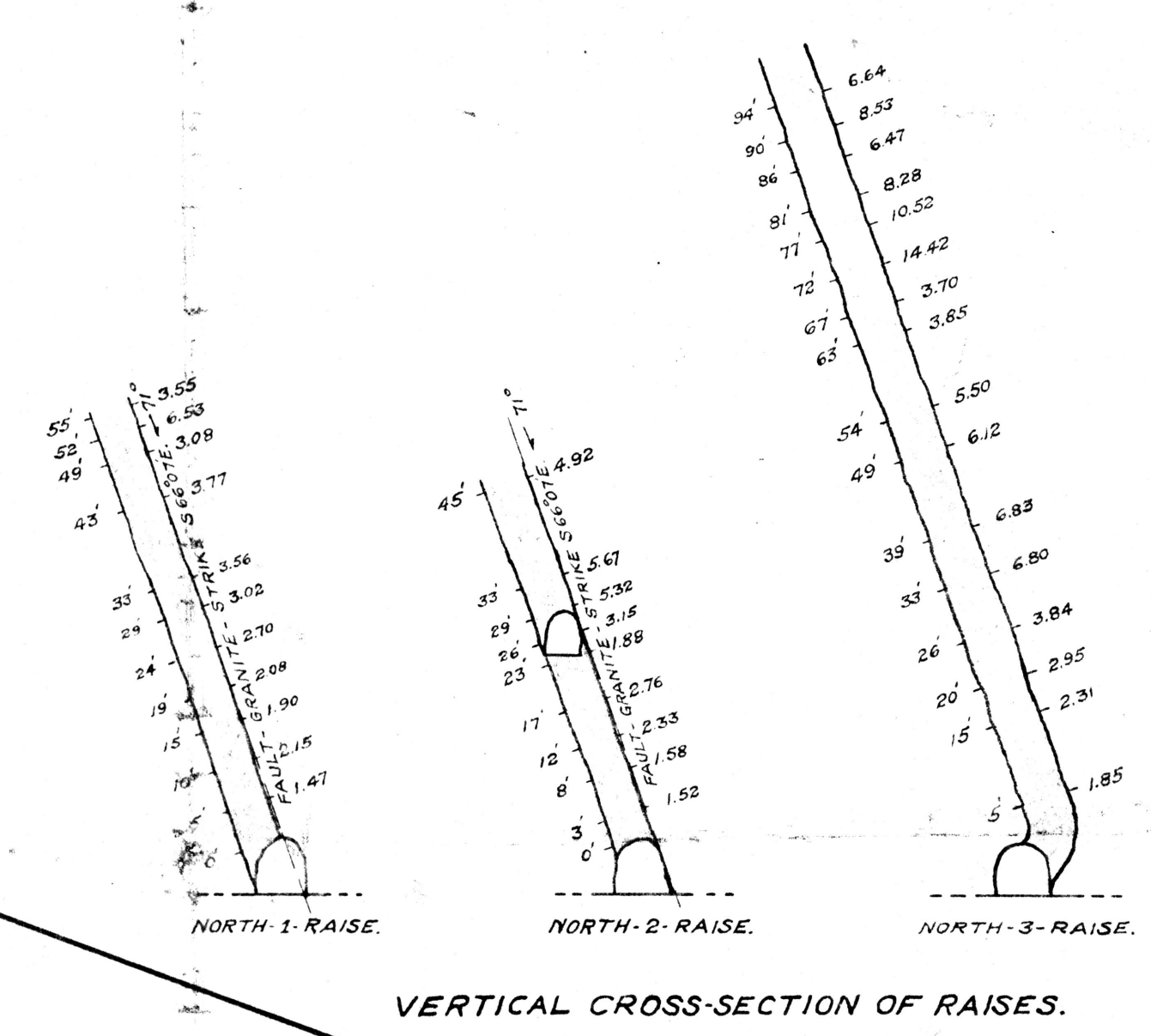
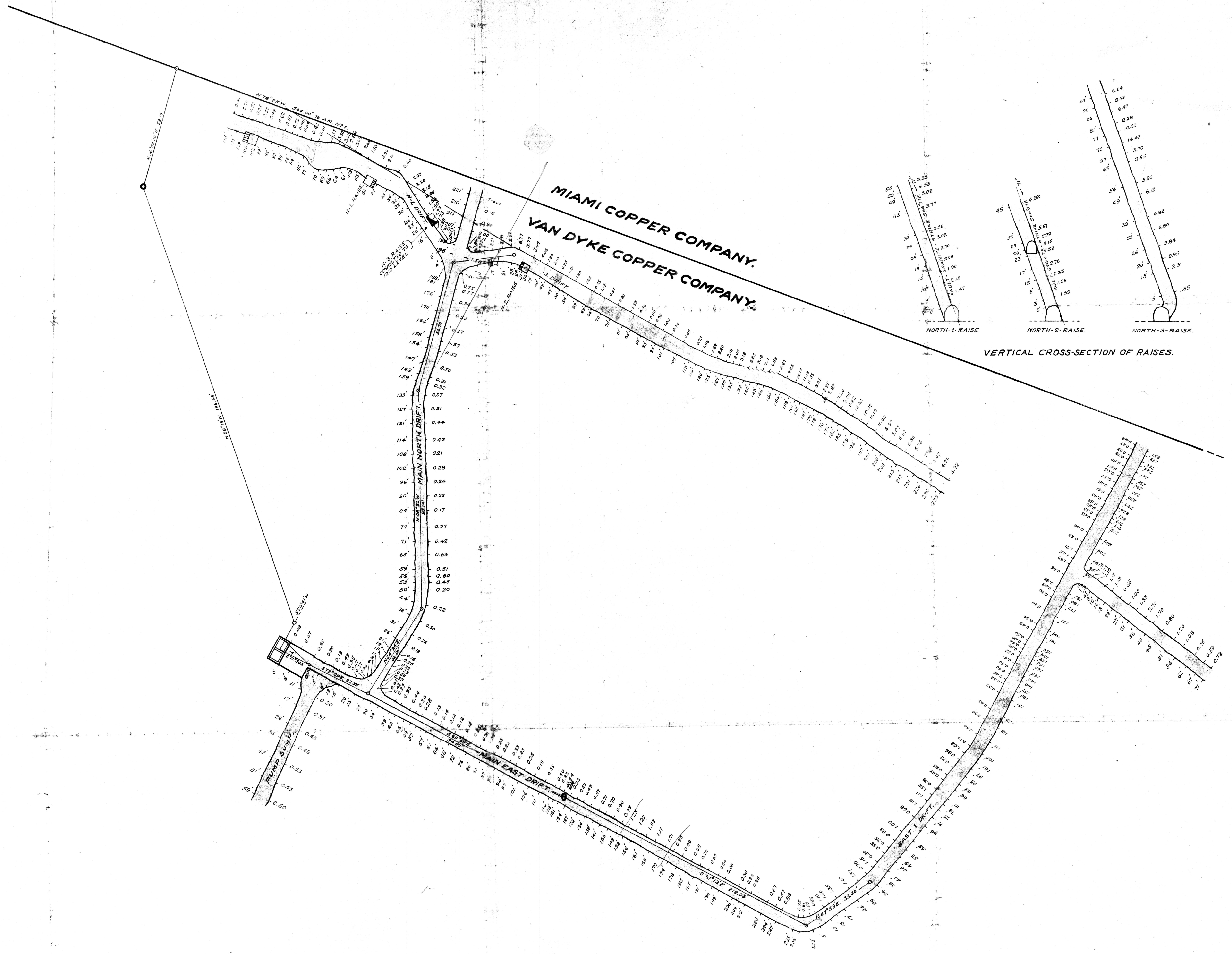

VERTICAL CROSS-SECTION OF RAISES.

ASSAY MAP
 OF
 1312' LEVEL
 UNDER-GROUND WORKINGS.
 VAN DYKE COPPER COMPANY.
 MIAMI, ARIZONA.
 SCALE 1" = 20' AUGUST 1, 1929.
 L.C. BRIGHT, E.M.

7/3