

**ASSAY MAP**  
— OF —  
**SAN MARCOS MINE**  
WENDEN - YUMA COUNTY - ARIZONA.

SKETCH - SHOWING HORIZONTAL PROJECTION OF SECTIONS NOT SURVEYED.  
SCALE: 20 FEET = 1 INCH. DATE: MAY 25<sup>th</sup> 1932. RECHECKED - March - 1933  
Assayed & Sampled by A.W. Worcester.

**ASSAYS**

No.	Width	Grade	Value	Remarks	No.	Width	Grade	Value	Remarks	No.	Width	Grade	Value	Remarks
1	6.0	20	400	no F.W.	51	2.0	12	240	H.W. no walls	92A	2.0	12	240	Breast 325' W. V. Vein
2	6.5	10	280	no walls	51	6.0	12	480	H.W. no walls	92A	7.0	12	420	"
3	1.0	24	480	Bottom Shallow vein - no walls	52	4.5	14	320	no walls	97	2.5	10	100	no F.W.
4	4.0	12	240	no walls	53	4.0	12	480	"	98	2.0	10	200	"
5	2.5	24	480	Flue at Tunnel	54	3.5	14	320	"	99	1.0	10	170	H.W.
6	5.5	17	340	no walls	55	4.0	10	160	"	100	4.5	10	450	Walls
7	6.0	07	180	"	56	3.0	14	280	"	101	3.0	18	360	"
8	6.5	18	360	"	57	1.0	10	100	"	102	3.0	12	240	"
9	3.0	14	280	H.W. no walls	58	4.5	12	450	"	103	3.0	12	240	"
10	3.0	40	800	F.W.	59	6.0	16	320	No Walls					
11	4.0	11	220	no walls	60	5.0	10	200	"					
12	1.5	68	1360	"	61	8.0	12	480	"					
13	4.0	14	320	"	62	8.0	22	440	"					
14	3.0	14	280	"	63	8.0	21	420	"					
15	4.0	10	200	"	64	2.0	16	320	"					
16	4.0	20	400	"	65A	5.0	15	300	H.W.					
17	2.0	18	360	H.W. no F.W.	65B	5.0	13	260	"					
18	4.0	18	360	no F.W.	66	8.0	17	340	"					
19	4.0	18	360	no F.W.	67	3.5	10	200	Walls					
20	3.0	18	360	no Walls	68	4.0	21	420	"					
21	4.0	14	280	H.W. no F.W.	69	4.0	17	340	"					
22	4.0	40	800	H.W. no walls	70	4.0	08	160	H.W.					
23	2.0	10	200	F.W.	71	3.0	10	200	"					
24	4.0	24	480	no Walls	72	2.0	09	180	"					
25	3.0	22	440	"	73	2.5	08	160	"					
26	3.0	24	480	Grade in F.W. - no F.W. cut	74	6.0	24	480	"					
27	3.0	24	480	Bottom of vein at Slope to Surface	75	7.0	12	280	"					
28	3.5	20	400	no Walls	76	10.0	12	260	"					
29	1.5	12	240	New walls in F.W. w/ exposed	77	10.0	40	800	"					
30	4.5	17	340	no Walls	78	2.0	60	1200	"					
31	4.0	15	300	"	79	3.0	18	360	Walls					
32	2.0	12	240	"	80		04	120	Under Track					
33	4.0	22	440	"	81	4.5	10	225	"					
34	1.5	30	450	Under Track - no F.W.	82		05	100	under Track					
35	4.0	07	140	Taken above H.W. in Air Shaft	83	2.0	07	140	H.W.					
36	3.0	24	480	Under Track - no F.W.	84	4.0	16	200	F.W.					
37	2.0	22	440	"	85	2.0	10	200	no F.W.					
38	6.0	20	400	no walls	86	2.0	09	180	H.W. no H.W.					
39	1.0	18	360	F.W.	87	4.0	07	140	F.W.					
40	8.0	07	140	Walls	88	2.0	04	120	"					
41	3.0	07	140	under track no F.W.	89	4.0	08	160	"					
42	4.0	18	360	no walls	90	4.5	05	100	"					
43	4.0	14	280	H.W. no walls	91	4.0	01	180	"					
44	4.0	07	140	F.W.	92	4.0	01	180	"					
45	4.5	18	360	H.W.	93	4.0	01	180	"					
46	4.5	10	200	F.W.	94	8.0	22	440	"					
47	4.0	11	220	no Walls	95		07	140	Face of vein - vertical vein					
48	4.5	18	360	"					"					
49	4.5	24	480	Under Track no F.W.					"					
50	4.0	22	440	"					"					

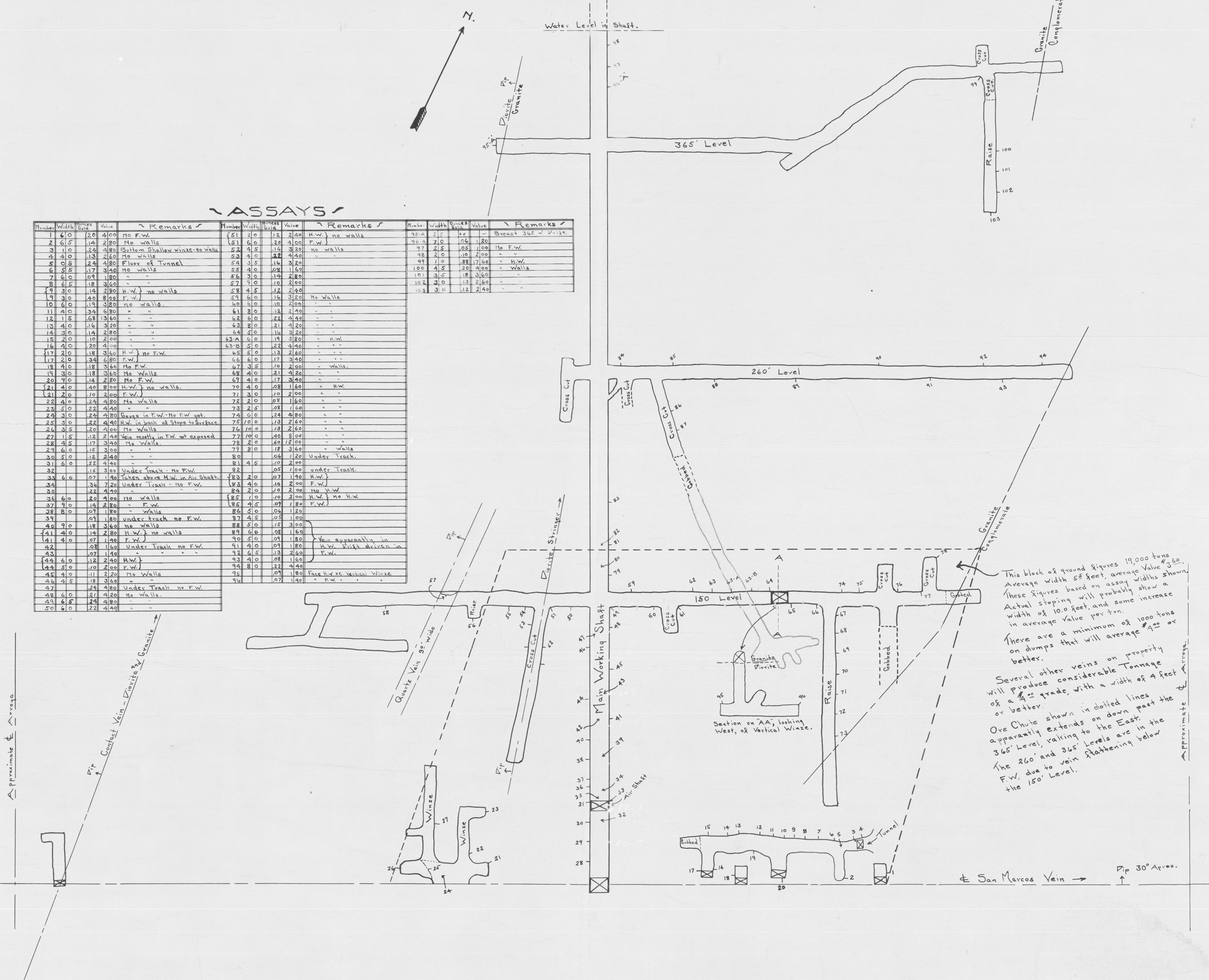

This block of ground gives 19,000 tons average width 65 feet, average value \$30. These figures based on assay widths shown. Actual stoping will probably show a width of 100 feet, and some increase in average value per ton. There are a minimum of 1000 tons on dumps that will average \$25 or better.

Several other veins on property will produce considerable tonnage of a 4% grade, with a width of 4 feet or better.

One chute extends in dotted lines apparently extending to the East. The 260' and 365' Levels are in the F.W. due to vein flattening below the 150' Level.

Approximate Average

Approximate Average