

5

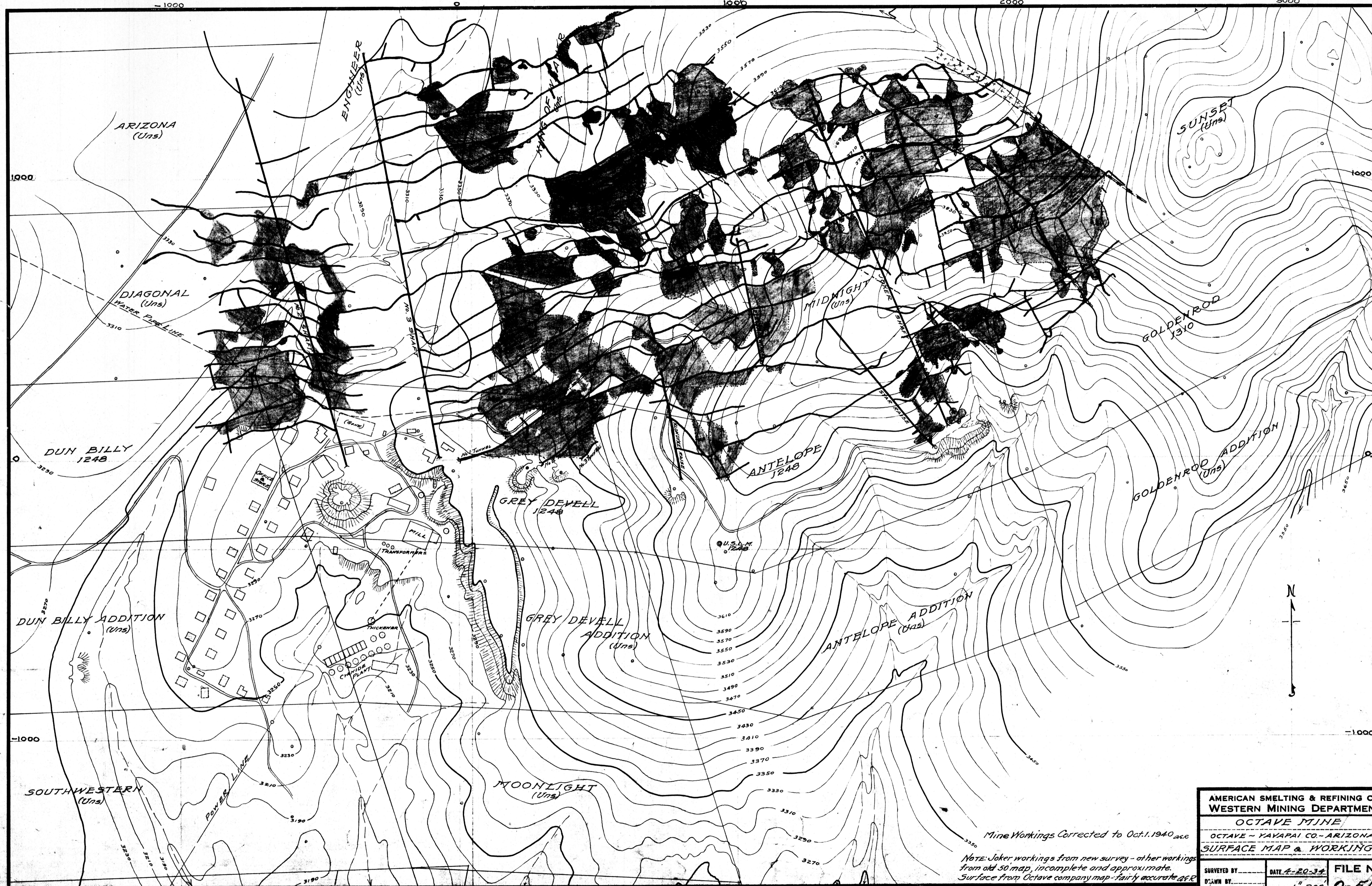

Mine Workings Corrected to Oct. 1, 1940  
 Note: Joker workings from new survey - other workings from old 50 map, incomplete and approximate. Surface from Octave company map - fairly accurate.

<b>AMERICAN SMELTING &amp; REFINING CO.</b> <b>WESTERN MINING DEPARTMENT</b> <b>OCTAVE MINE</b>		
OCTAVE - YAVAPAI CO. - ARIZONA <b>SURFACE MAP &amp; WORKINGS</b>		
SURVEYED BY _____ DRAWN BY _____ TRACED BY <i>ASL</i>	DATE <i>4-20-34</i> SCALE: <i>1" = 200'</i>	<b>FILE NO.</b> <i>0-515</i>

0-2-10