

FROM MAP FILES OF  
E. ROSS HOUSHOLDER, P. E.  
BOX 1107 (431 SPRING ST.) KINGMAN, ARIZ.  
T. 22N., R. 17W.

4 3  
9 10

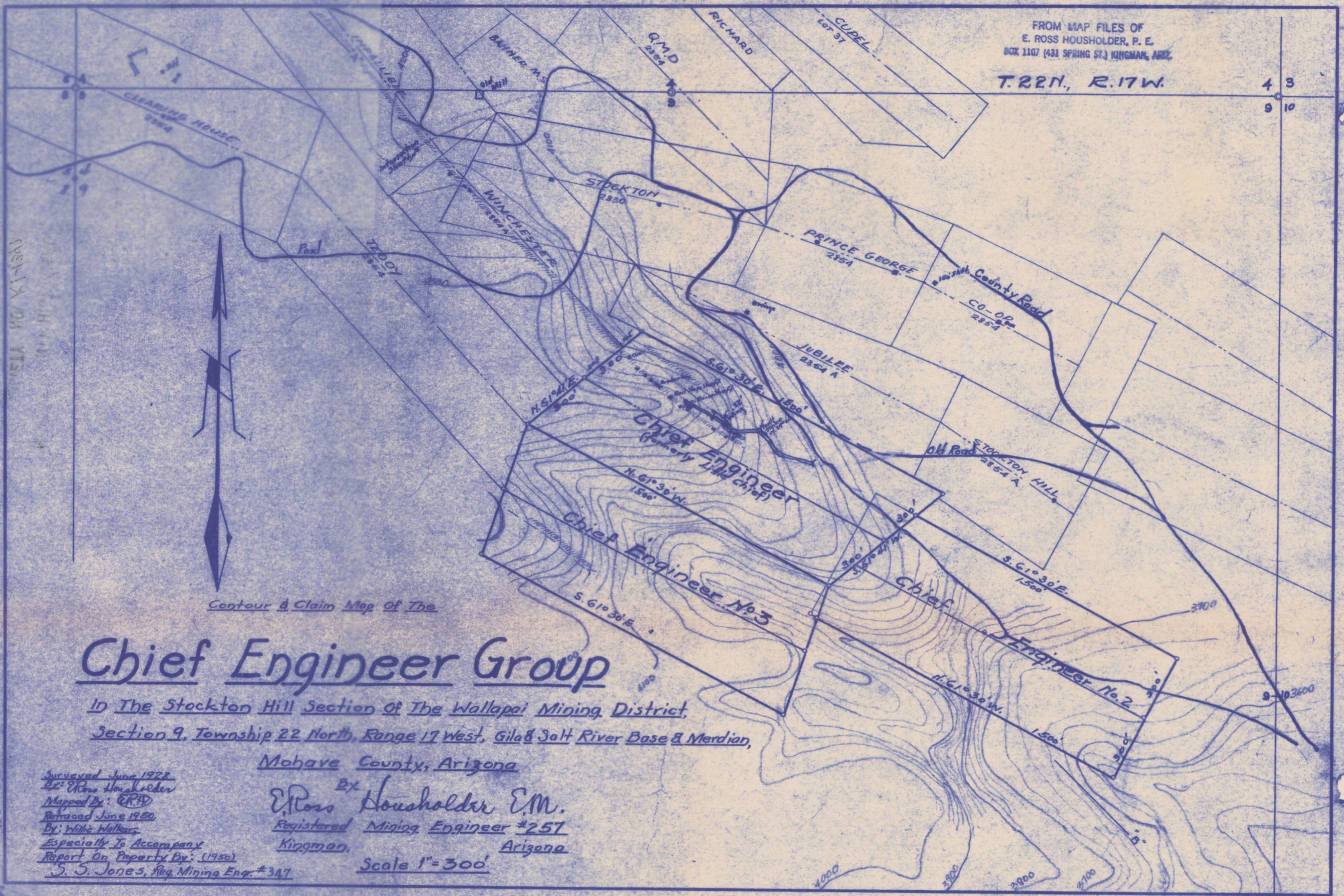

Contour & Claim Map of The

# Chief Engineer Group

In The Stockton Hill Section of The Wallapai Mining District,  
Section 9, Township 22 North, Range 17 West, Gila & Salt River Base & Meridian,  
Mohave County, Arizona

Surveyed June 1928  
By: E. Ross Housholder  
Mapped By: E.P.H.  
Retraced June 1950  
By: Willie Walkers  
Especially To Accompany  
Report On Property By: (1950)  
S. S. Jones, Reg. Mining Engr. #347

By  
E. Ross Housholder E.M.  
Registered Mining Engineer #257  
Kingman, Arizona

Scale 1" = 300'

Arizona State Department of Mines and Minerals  
Mohave County Office, 100 West Central Ave.  
Kingman, Arizona 86401

ADMMR 0283-006