

This Map Shows Part Of
Underground Workings
Chief Engineer Mine

Stockton Hill Section, Wallapai Mining Dist.,
Section 9, Township 22 North, Range 17 West,
Gila & Salt River Base & Meridian,

Mohave County, Arizona

Especially Prepared To Accompany Report On The Property For

S. S. Jones, Registered Mining Engineer #347

July 1950

Base Survey By
 L. H. FOSTER,
 U. S. MINERAL SURVEYOR
 Aug. 20, 1926

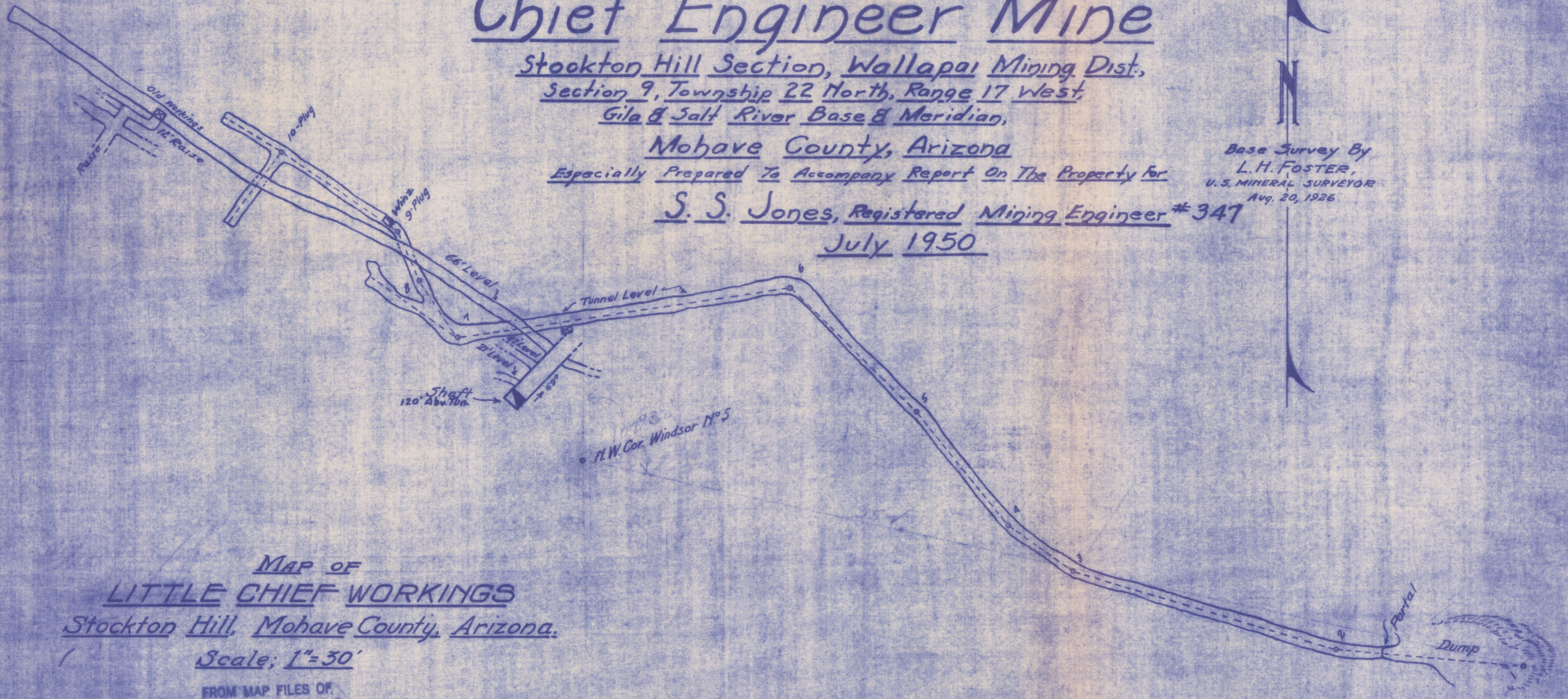

MAP OF
LITTLE CHIEF WORKINGS
Stockton Hill, Mohave County, Arizona.

Scale; 1"=30'

FROM MAP FILES OF
 E. ROSS HOUSHOLDER, P. E.
 BOX 1107 (431 SPRING ST.) KINGMAN, ARIZ.

File No. 9-22-17-26850

ADMUR 0283-001