

Mohave County, Arizona
E. Ross Houholder
Engineer & Land Surveyor
Flagstaff, Arizona 86001

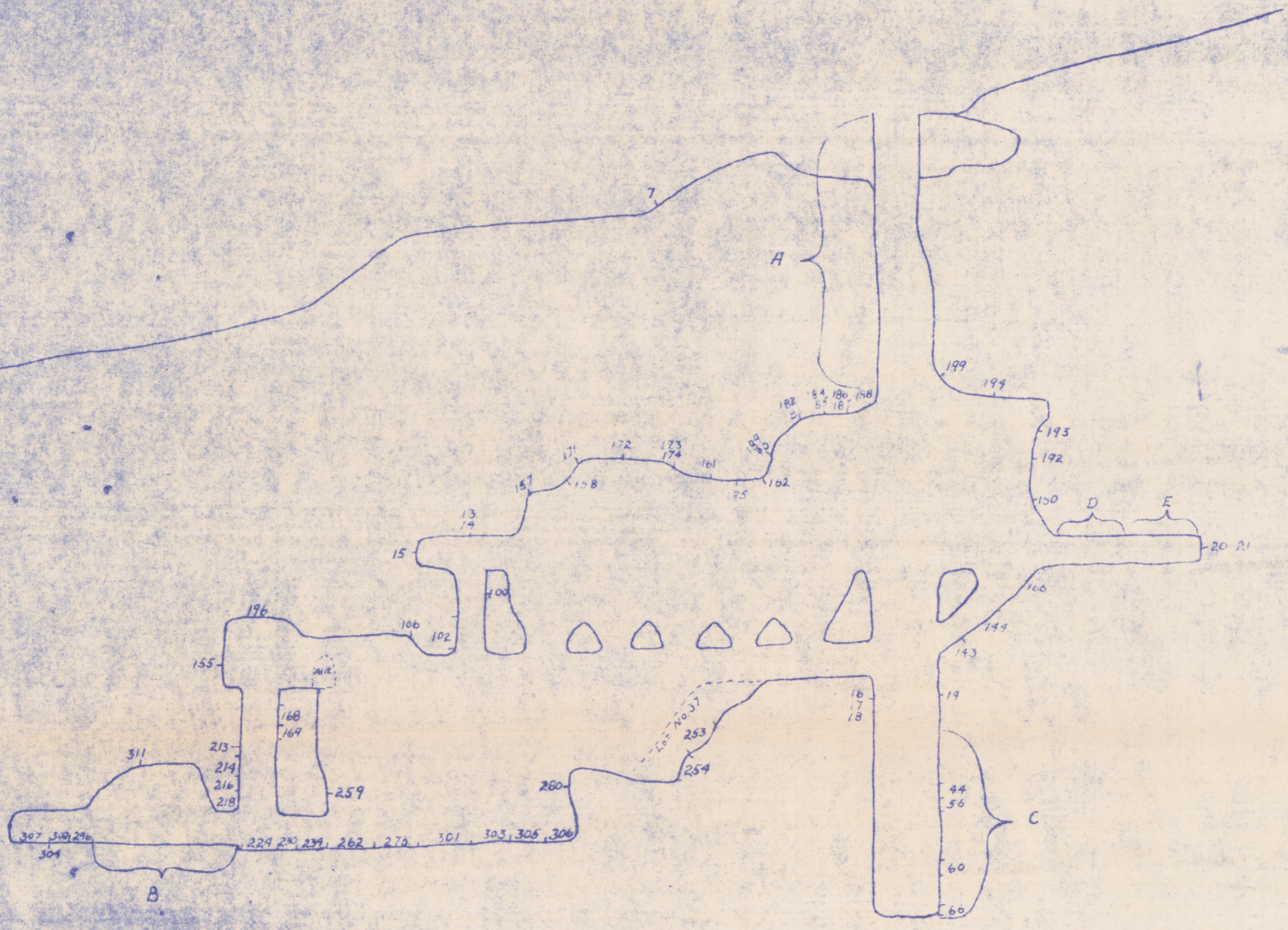

For assay results see the list attached

Assay Section
Looking Southwest through
Lee and Hill Shaft.
WHITE EAGLE PROPERTY
Mohave County, Arizona

Scale 1 in. = 20 ft.

MAPS FROM FILES OF
E. ROSS HOUSHOLDER
ENGINEER & LAND SURVEYOR

October 30, 1939 Dan Sheehan

ADMMR 0205-0033