

A044R 0828-017

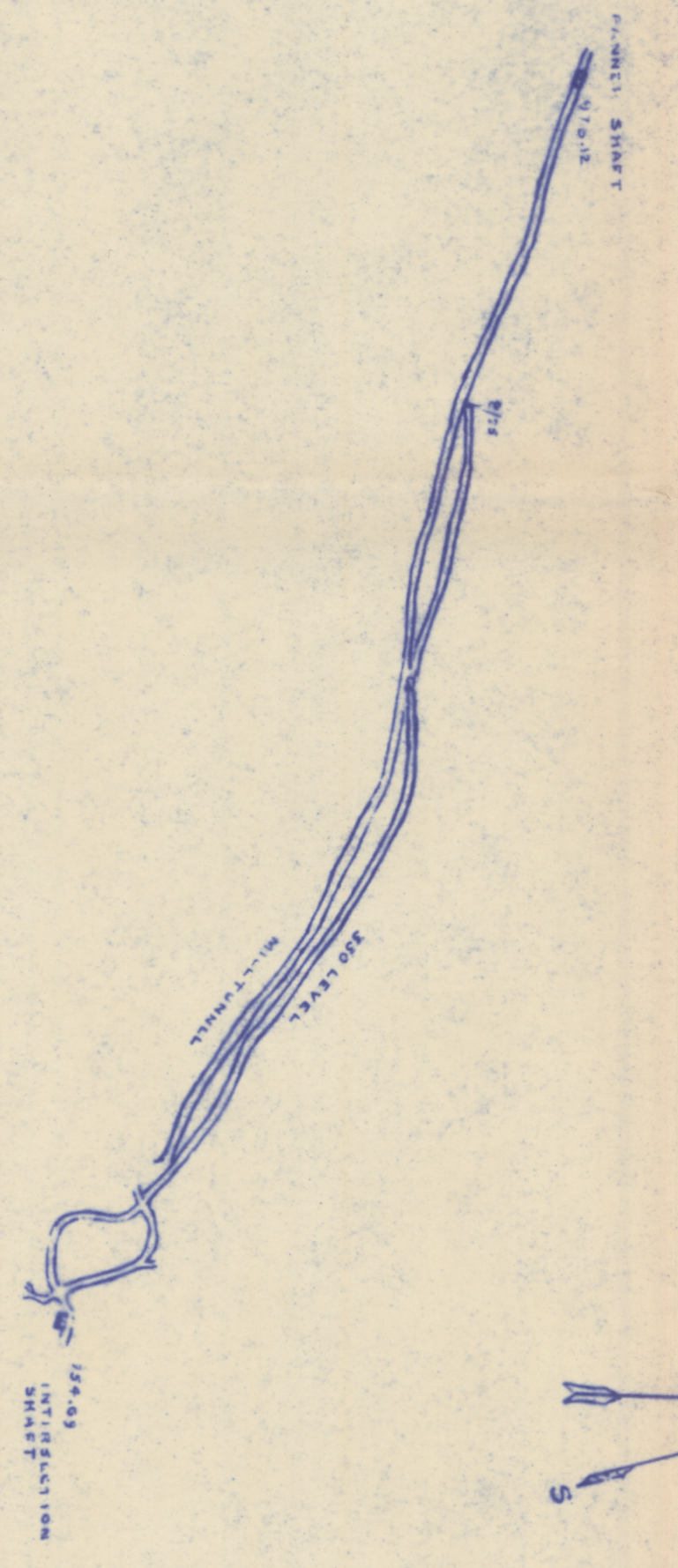

LONGITUDINAL SECTION
 NEW PUNNEL, PRINCE GEORGE & BANNEK WORKS

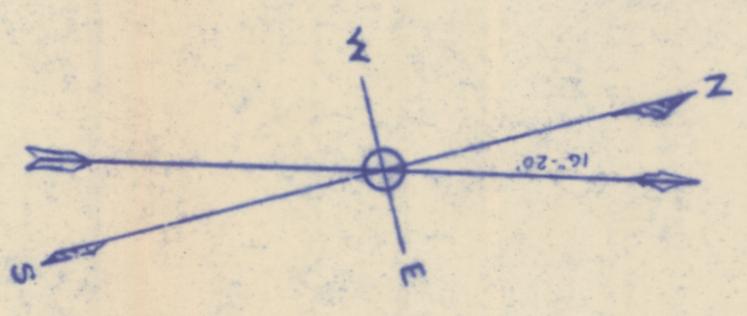
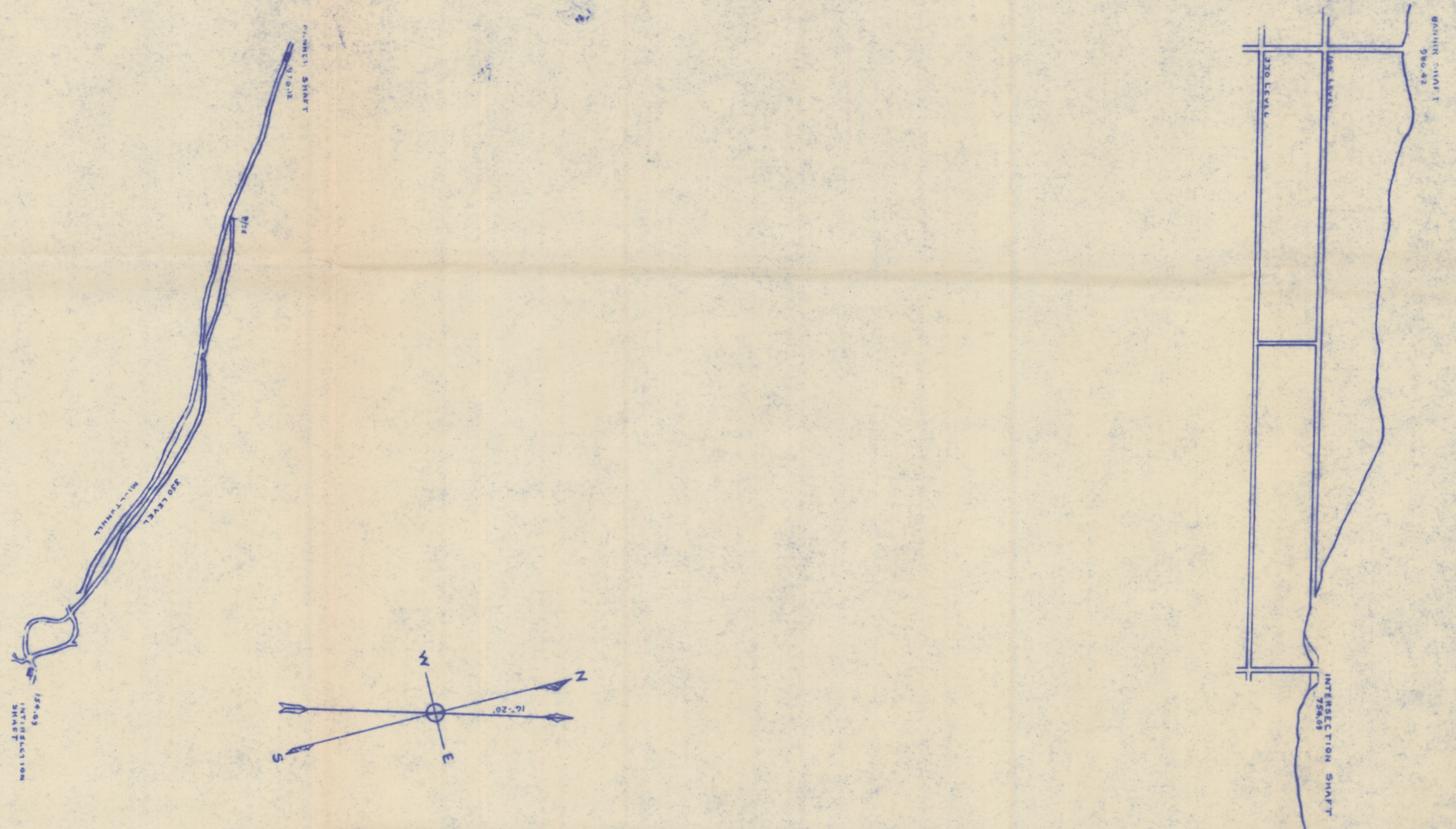
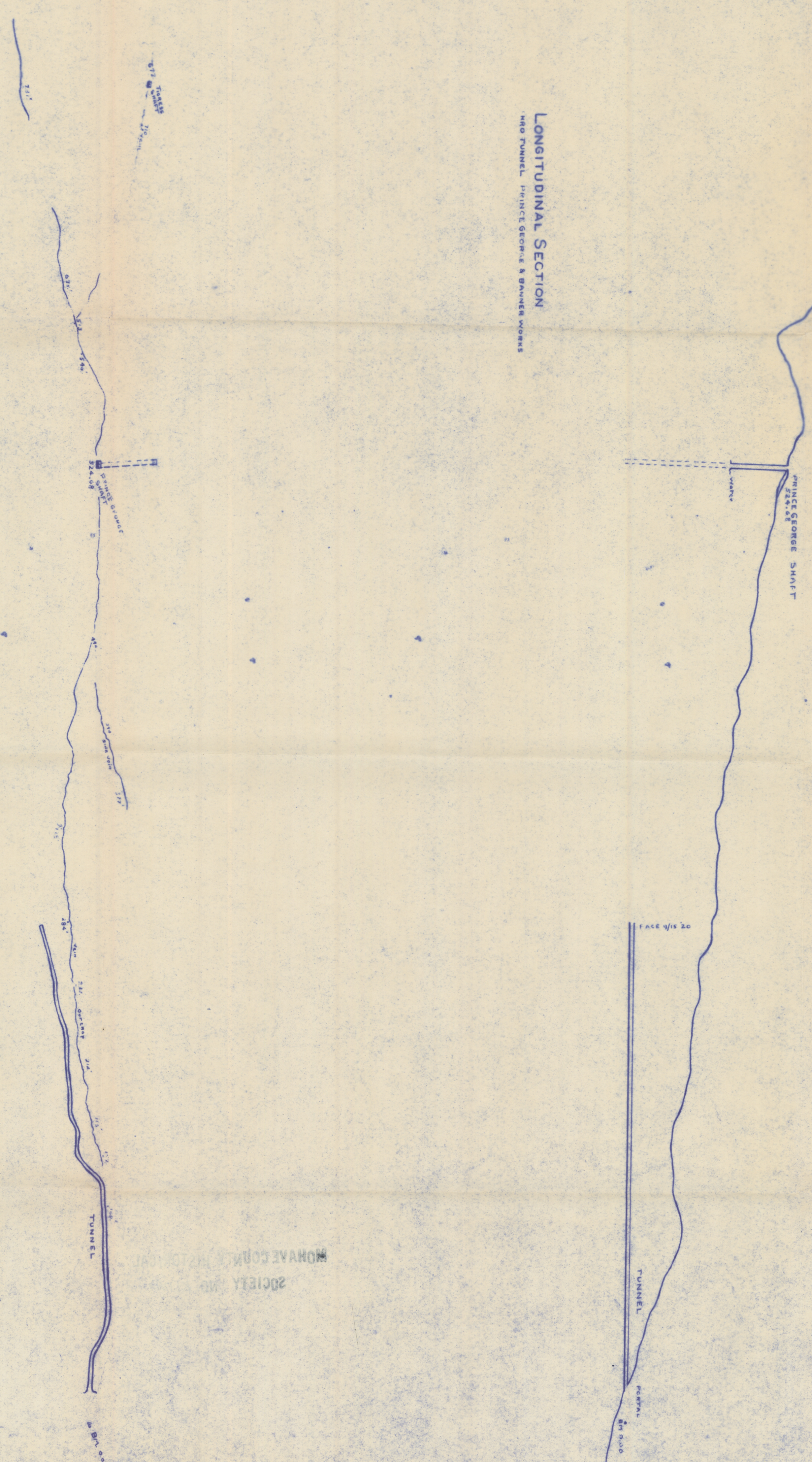

PLAN
 AND LONGITUDINAL
 SECTION
 OF THE
 UNDERGROUND WORKINGS
 OF THE
KINGMAN CONSOLIDATED MINES COMPANY
 PROPERTY
 MOHAVE COUNTY, ARIZ.
 1927

MORAVE CORP. ENGINEERS
 SOCIETY, INC.

Engineers
 1527
 Phoenix, Arizona