

Surveyed & Corners Located:
 Data Compiled From Government
 Patent Survey Maps
 By
 Erwin Hausholder, E.M.
 Registered Professional
 Mining Engineer #257
 431 E. Spring Street
 Kingman, Arizona
 Phone Green 87
 1956-1958

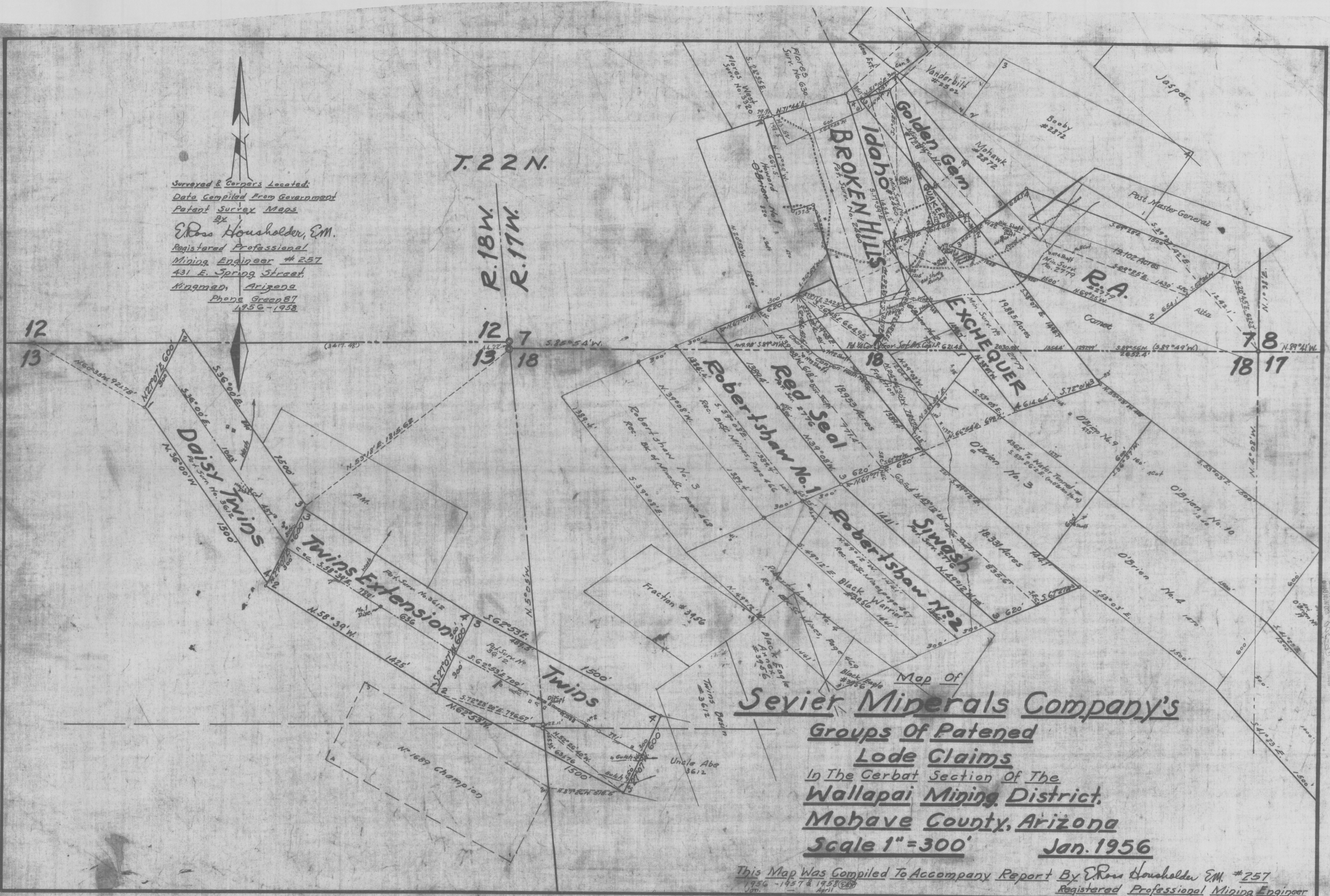

Map of
Sevier Minerals Company's
Groups of Patented
Lode Claims
 In The Gerbat Section Of The
Wallapai Mining District,
Mohave County, Arizona
 Scale 1" = 300' Jan. 1956

This Map Was Compiled To Accompany Report By Erwin Hausholder E.M. #257
 1956-1957 & 1958
 Registered Professional Mining Engineer