

PROPERTY GROUP MAP SHOWING ESTATE OF Kingman-Gold-Silver-Lead Merger Mines Company

COMPRISING THE O'BRIEN GROUP OF LOSE CLAIMS
WALLAPAI MINING DISTRICT
MOHAVE COUNTY, ARIZONA
T. 22 N.; R. 17 W., GILA & SALT RIVER MER.

COMPILED AND SURVEYED UNDER THE DIRECTION OF
G. WARREN SHUFFLET
INDUSTRIAL ENGINEER
335 SOUTH WOODS AVENUE
LOS ANGELES, CALIFORNIA
SURVEYED AND DELINEATED BY
E. ROSS HOUSHOLDER E.M.
REGISTERED PROFESSIONAL ENGINEER
KINGMAN, ARIZONA

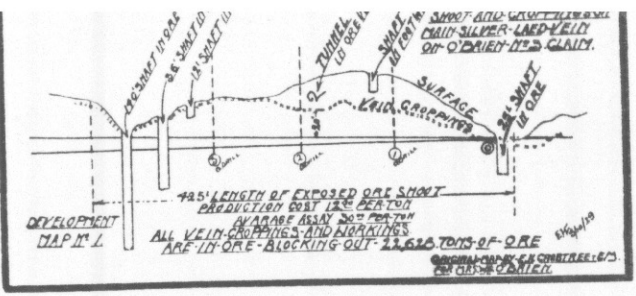

- ### LEGEND
- ⊠ MILL
 - ⊞ DOUBLE COMPARTMENT SHAFT
 - ⊠ SHIFTS
 - ⊠ BUILDINGS
 - ⊠ WASH
 - ⊠ OPEN CUT
 - ⊠ TUNNEL
 - ⊠ CANYON, GULCH
 - ⊠ SECTION LINES
 - ⊠ GROUP BOUNDARY
 - ⊠ ROADS
 - ⊠ VEINS, DYKES
 - ⊠ PIPE LINE
 - ⊠ SPRINGS
 - ⊠ CLAIM CORNERS
 - ⊠ 1/4 SECTION CORNER
 - ⊠ SECTION CORNER
 - ⊠ CEMETERY

1/4 S. GROUP - 13 O'BRIEN CLAIMS
EXCHEQUER; R.A. QUINCY
& BROOKLYN HILLS
LORE'S CLAIMS
GROUP - 3 SUMMIT CLAIMS

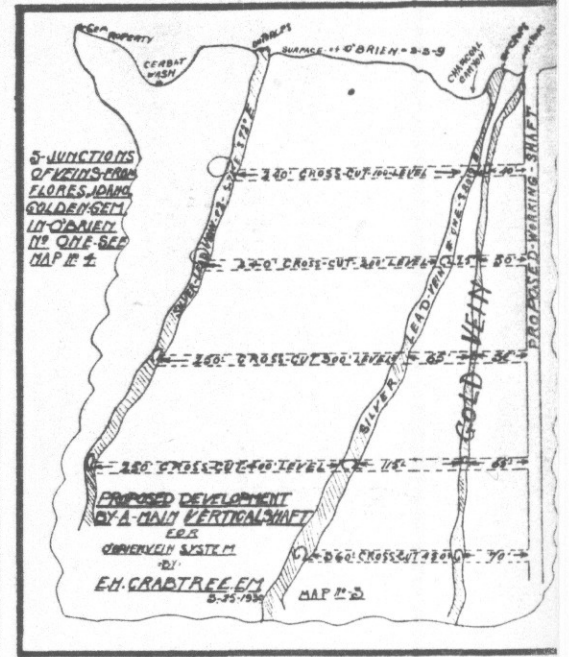
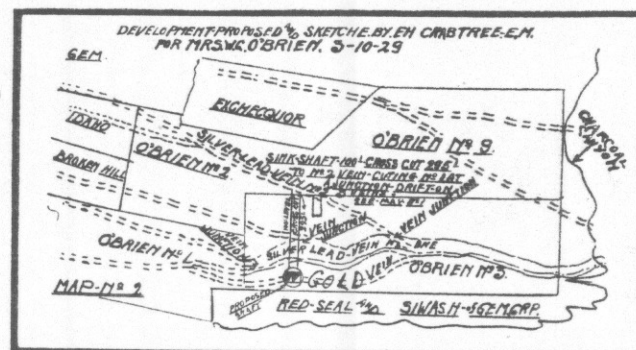
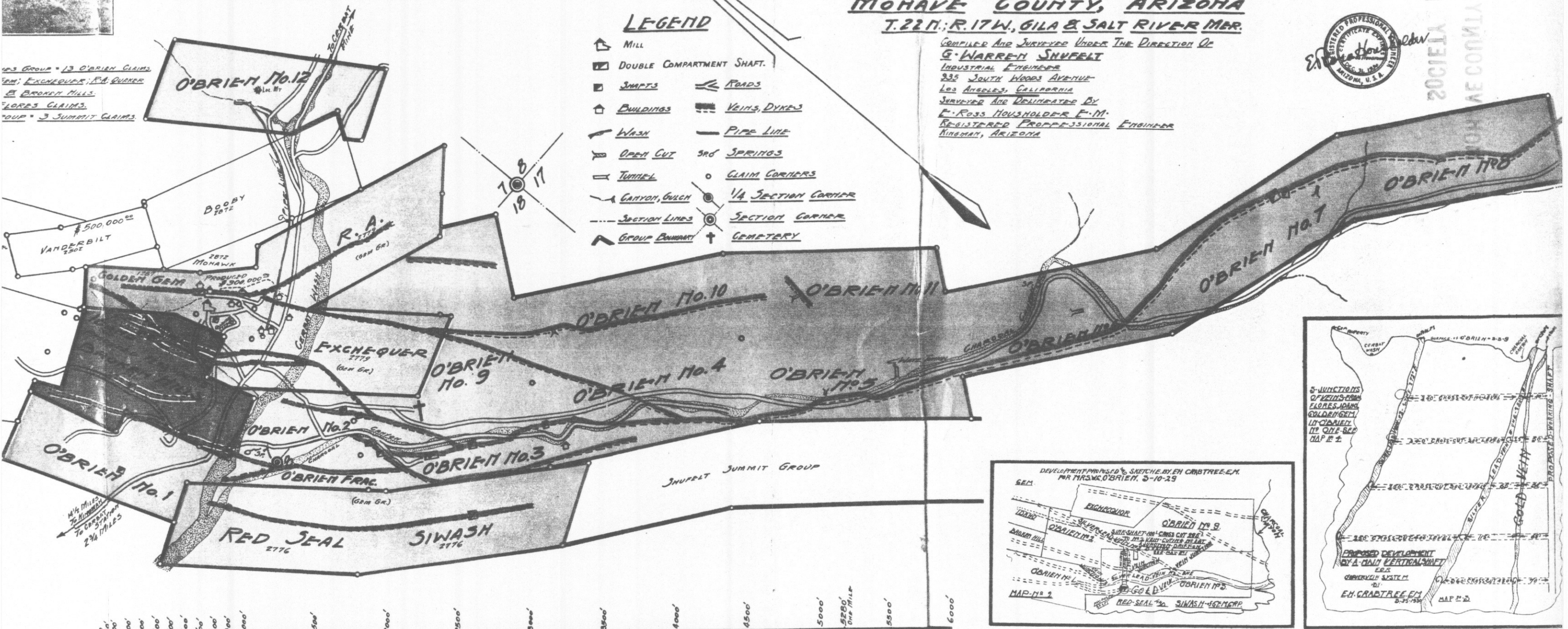

GRAPHIC SCALE IN FEET

COMPILED BY
E. ROSS HOUSHOLDER E.M.
REGISTERED PROFESSIONAL ENGINEER
KINGMAN, ARIZONA

ADMNR 0265-008