

MATERIAL

DESCRIPTION

PART NO. / DWG. NO.

ITEM REQ.

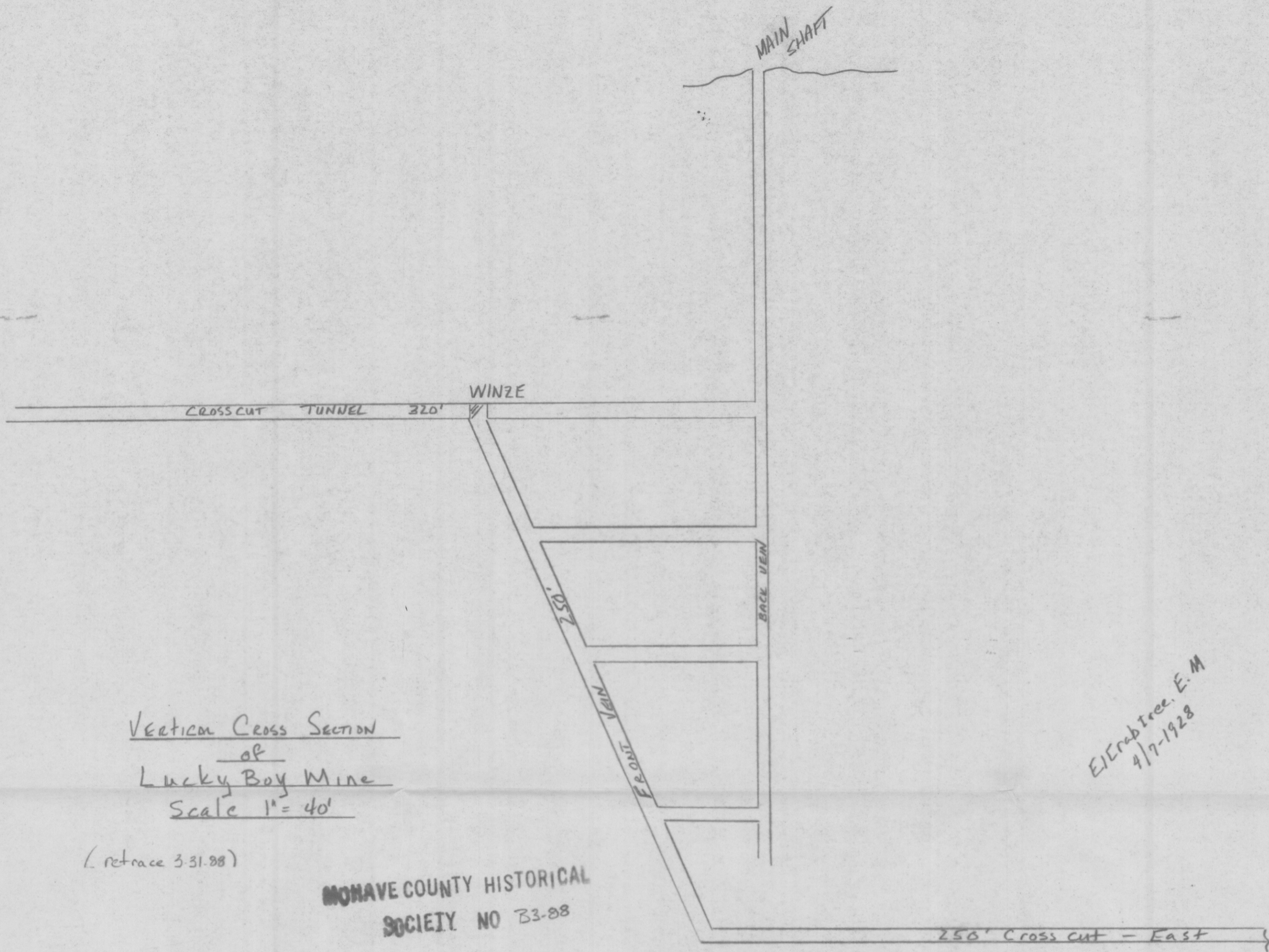

Vertical Cross Section  
of  
Lucky Boy Mine  
Scale 1" = 40'

(retrace 3-31-88)

MONHAVE COUNTY HISTORICAL  
 SOCIETY NO B3-88

Map No. 6

E. Crabtree, E. M.  
 4/7-1928

ADMUR 0254-001