

ADMR 0209-016

MOHAVE COUNTY HISTORICAL SOCIETY NO 89-110

(MILE) Mineral Park Road 1/2 mile To Kingman

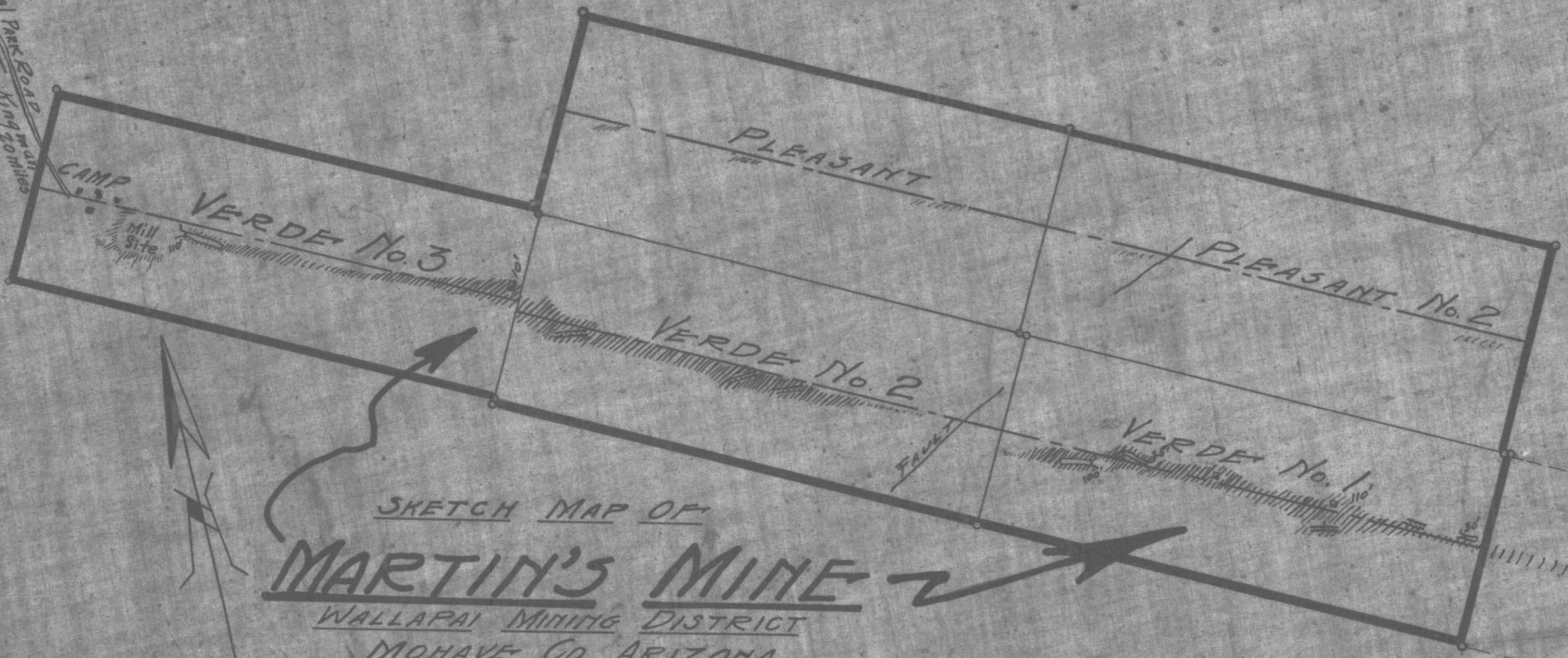

SKETCH MAP OF
MARTIN'S MINE
 WALLAPAI MINING DISTRICT
 MOHAVE CO., ARIZONA.

DRAWN AND OUTLINED BY
 SAM MARTIN, OWNER
 KINGMAN, ARIZONA
 TRACED & DELINEATED BY
 E. ROSS HOUSHOLDER E. M.
 KINGMAN, ARIZONA

MAY 1934

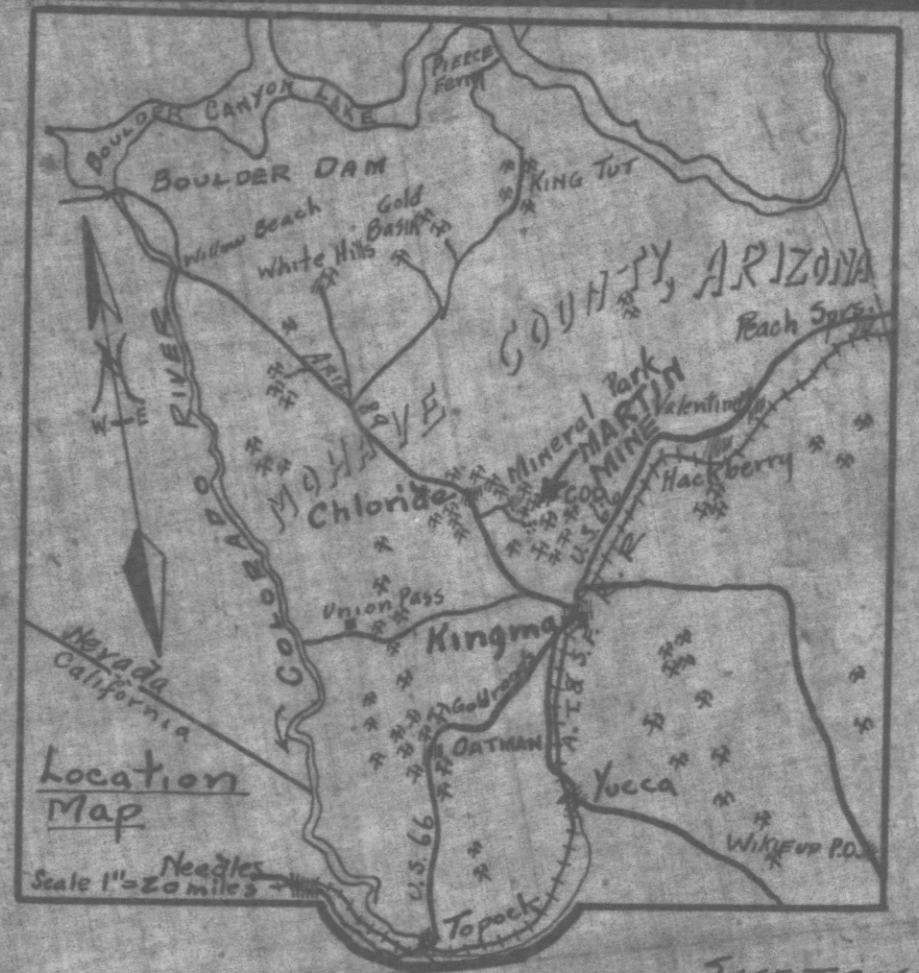

THE MINES ARE CENTRALLY LOCATED IN A
 WIDELY KNOWN MINING DISTRICT AND
 ARE SURROUNDED BY PRODUCTION MINES
 THAT PROVED REMUNERATIVE TO THEIR OWNERS.

SKETCH MAP SHOWS THE RELATIVE LOCATIONS OF

THE C.O.D. MINE GROUP
 TO THE
MARTIN MINE
 IN THE WALLAPAI MINING DISTRICT, MOHAVE CO., ARIZ.

