

Mohave County Historical Society, Inc.
408 West Deane
Kingman, Arizona 86401

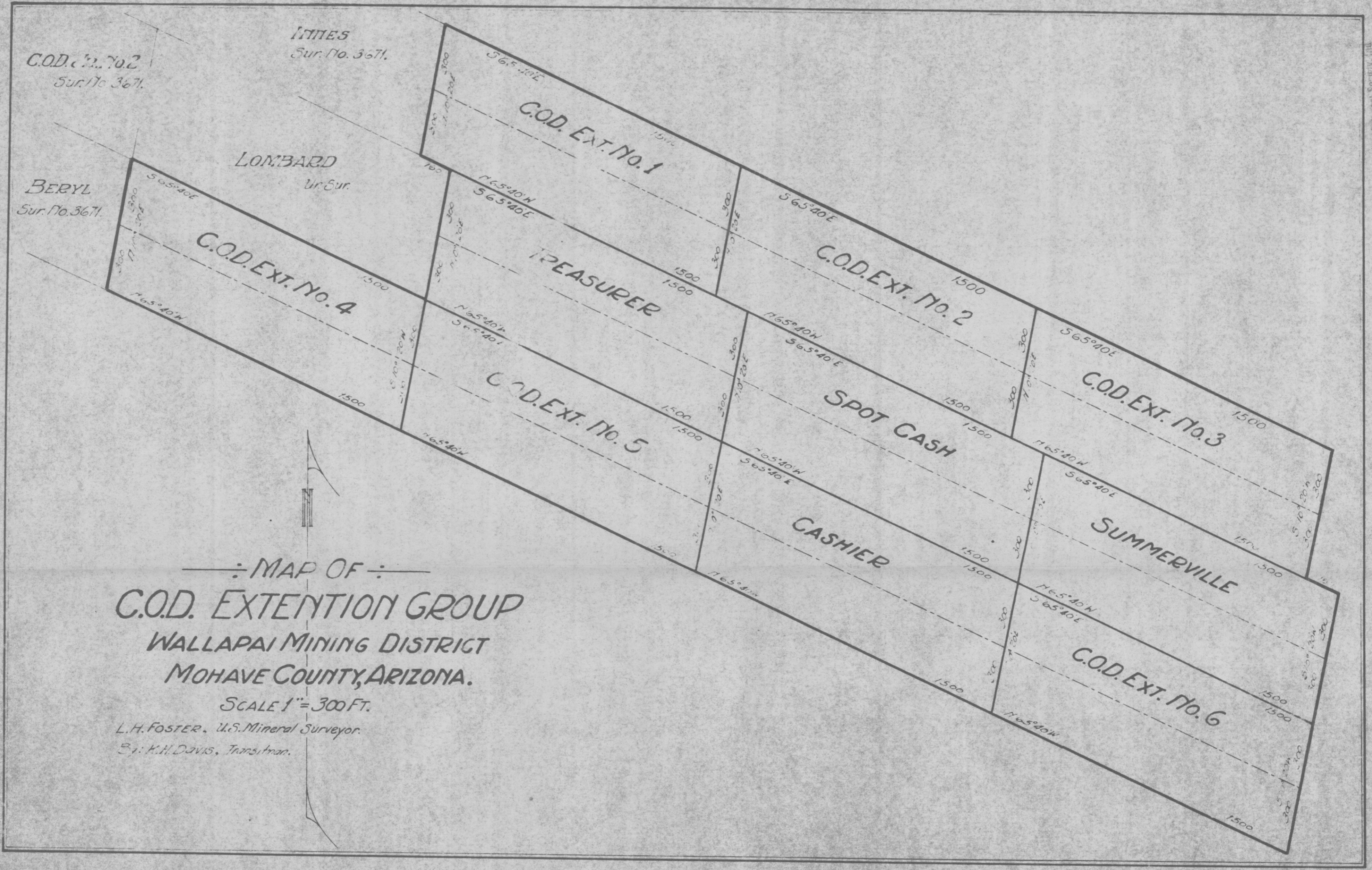

MAP OF
C.O.D. EXTENTION GROUP
WALLAPAI MINING DISTRICT
MOHAVE COUNTY, ARIZONA.

SCALE 1" = 300 FT.

L.H. FOSTER, U.S. Mineral Surveyor.
S.J. K.H. DAVIS, Transitman.

ADMMR 0269-013