

T. 17N, R. 15W
T. 17N, R. 14W

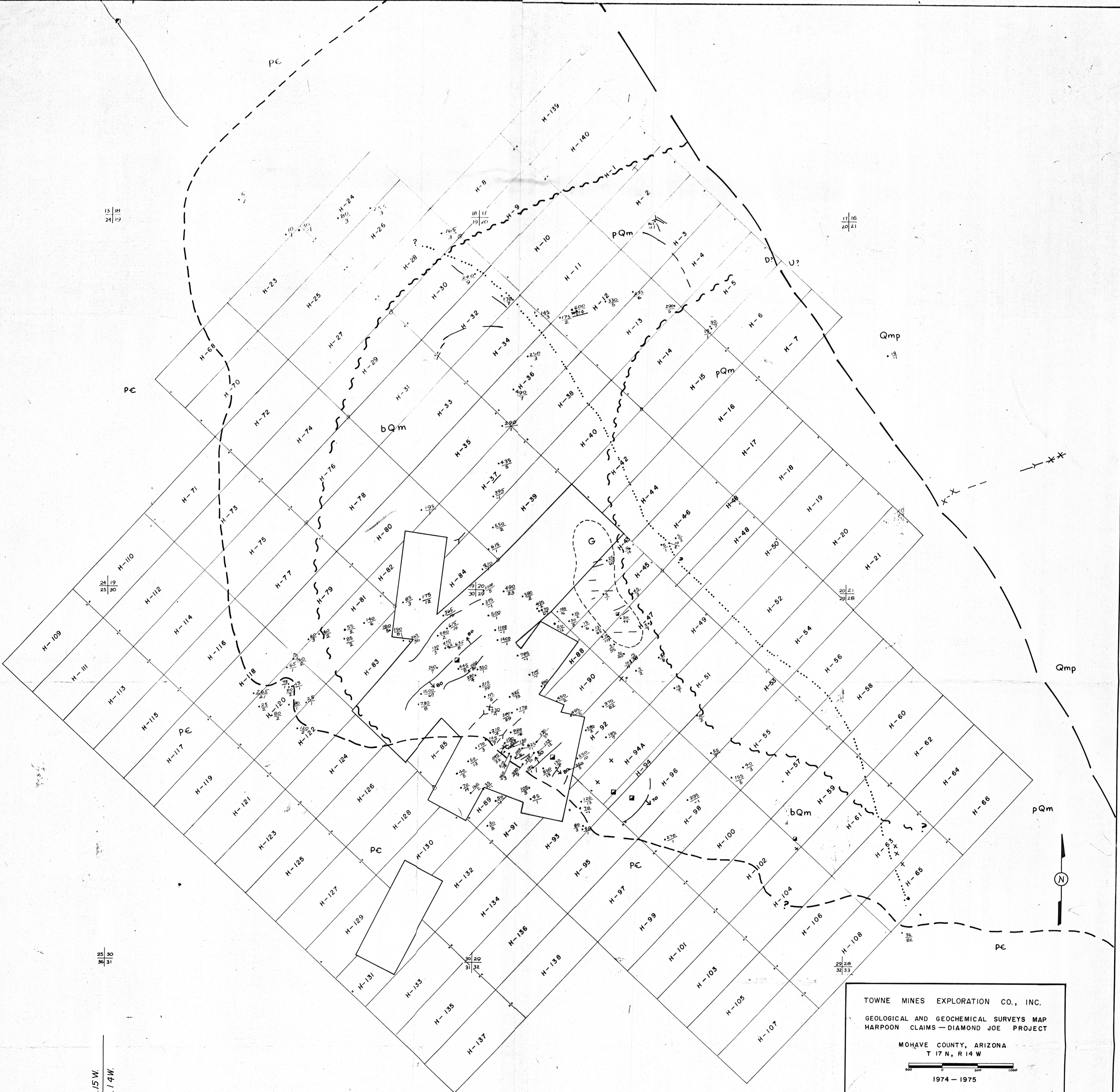

TOWNE MINES EXPLORATION CO., INC.
GEOLOGICAL AND GEOCHEMICAL SURVEYS MAP
HARPOON CLAIMS - DIAMOND JOE PROJECT
MOHAVE COUNTY, ARIZONA
T 17 N, R 14 W

1974 - 1975

EXPLANATION

Laramide (?)

- Qm Quartz Monzonite Porphyry
- pQm Porphyritic Quartz, Monzonite
- bQm Biotite Quartz Monzonite

Precambrian

- PC Granitic Gneisses, Amphibolite Schists

Fault

Quartz - Sulfide Vein

Approximate Contact Diamond Joe Stock

Approximate Stock Facies Contact

Rock Chip Samples

- 370 ppm Cu
- 82 ppm Mo

Arcuate Zone of Abundant Sulfide-bearing Fractures, Veins and Veinlets

"Greisen" Area of Quartz - Muscovite - K-spar Alteration

1/17