

9800N

9900N

10,000N

10,100N

SECTION SURFACE TRACE 10,050N

1600' EL

1500' EL

1400' EL

1300' EL

1200' EL

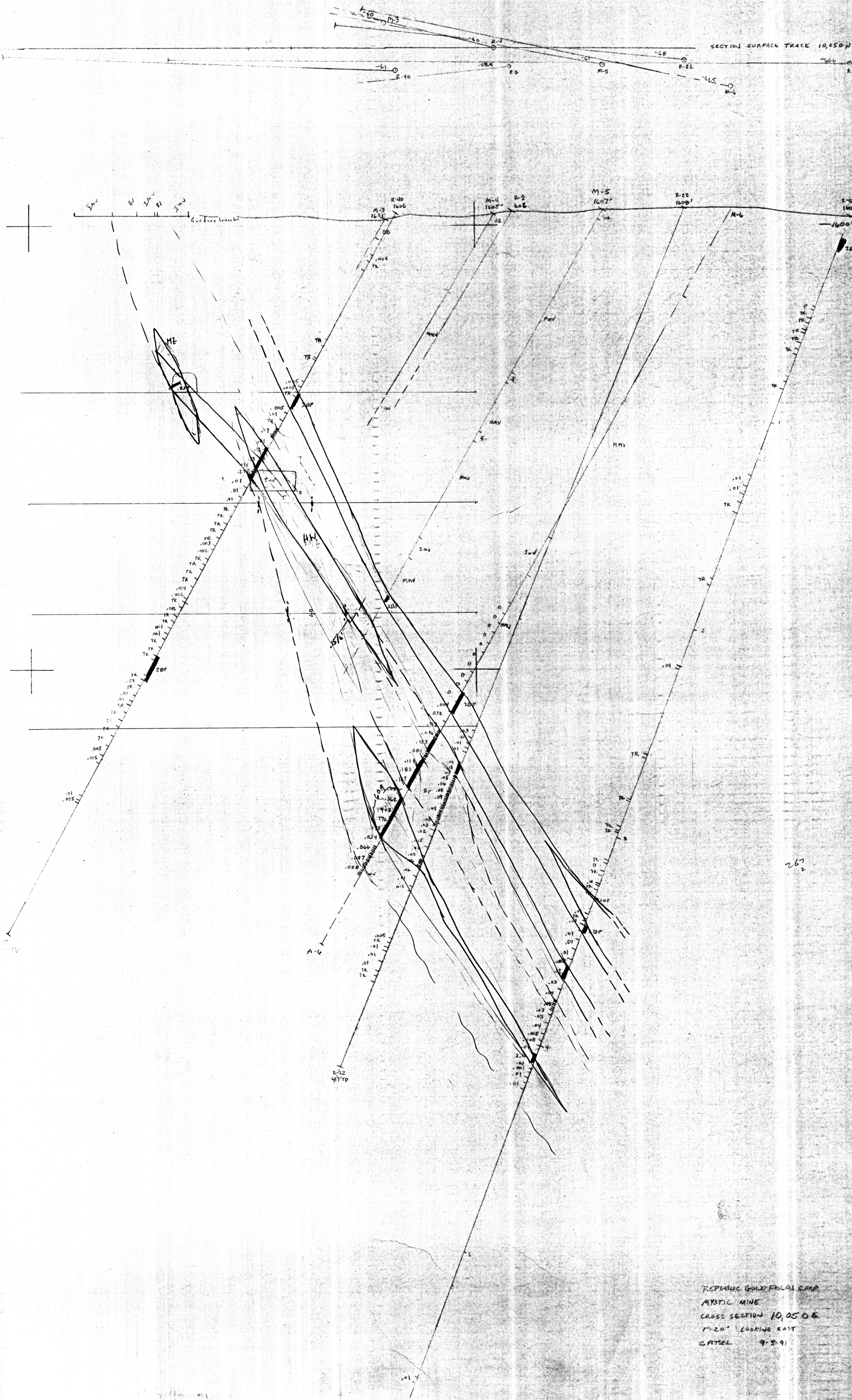

267

REPUBLIC GOLD FIELD CAMP
 MYSTIC MINE
 CROSS SECTION 10,050 N
 1"=20' LOOKING EAST
 S. MITCHELL 9-5-91