

- 7500 N

- 7500 N

- 7500 N

1" = 50' SURFACE TROUGH

R-12 102.3' R-11 102.2' R-20 102.2' R-11 102.4'

1400' EL

1500' EL

1400' EL

1300' EL

1200' EL

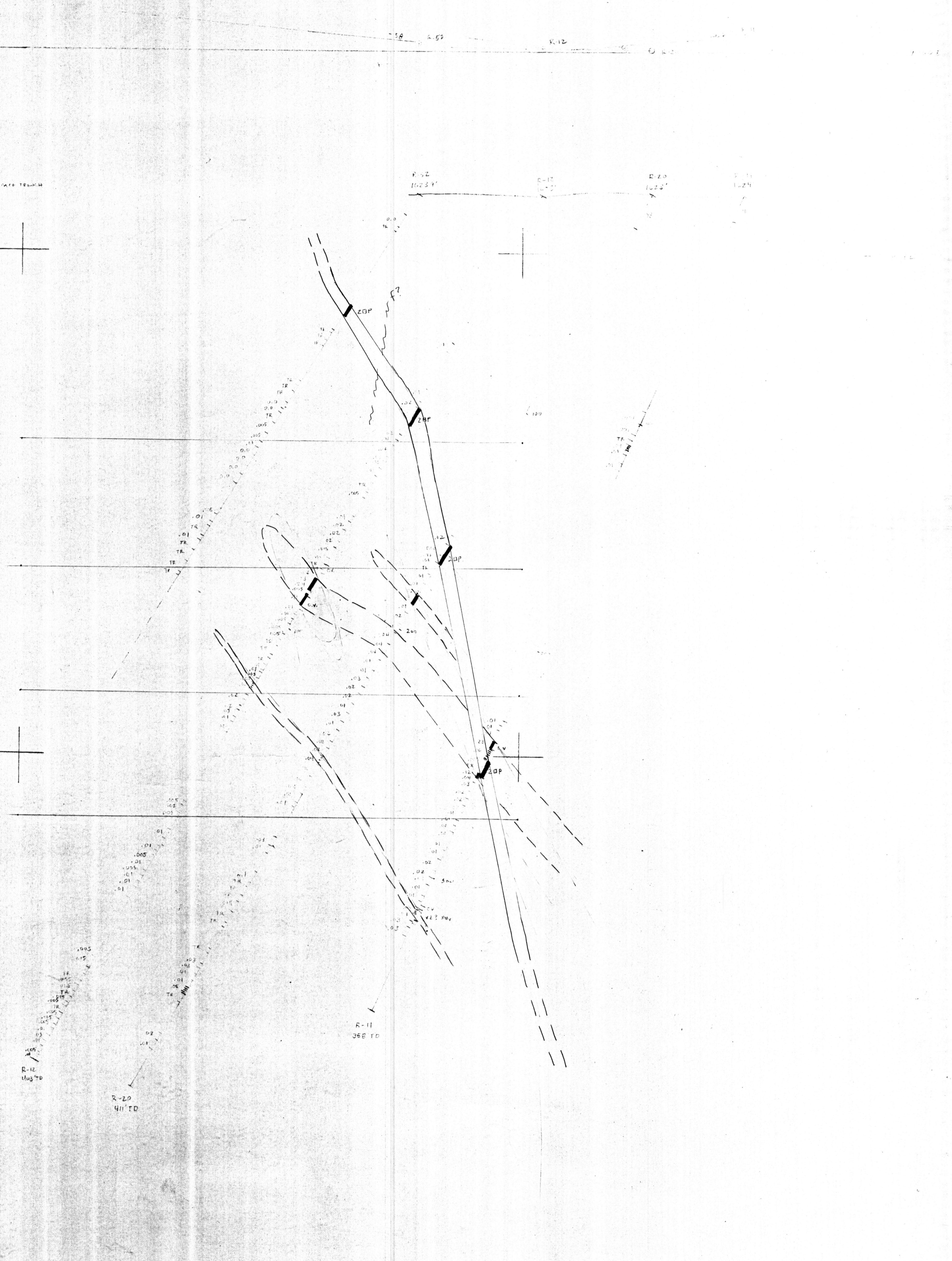
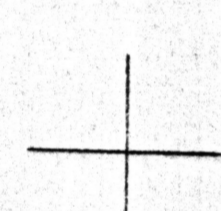
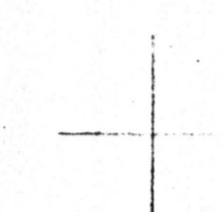
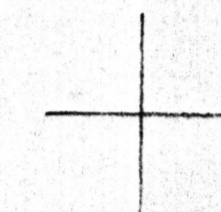

SECTION 2 OF FIELD LOG  
 ASTIC AREA  
 CROSS SECTION 125°E  
 1" = 20' LOOKING EAST  
 SURFACE 1950