

of underground ABM maps
 1 map - section
 6
 122N R17W S4E
 (GOLCONDA EXTENSION MINE - MILLS)
 MOHAVE COUNTY ARIZ

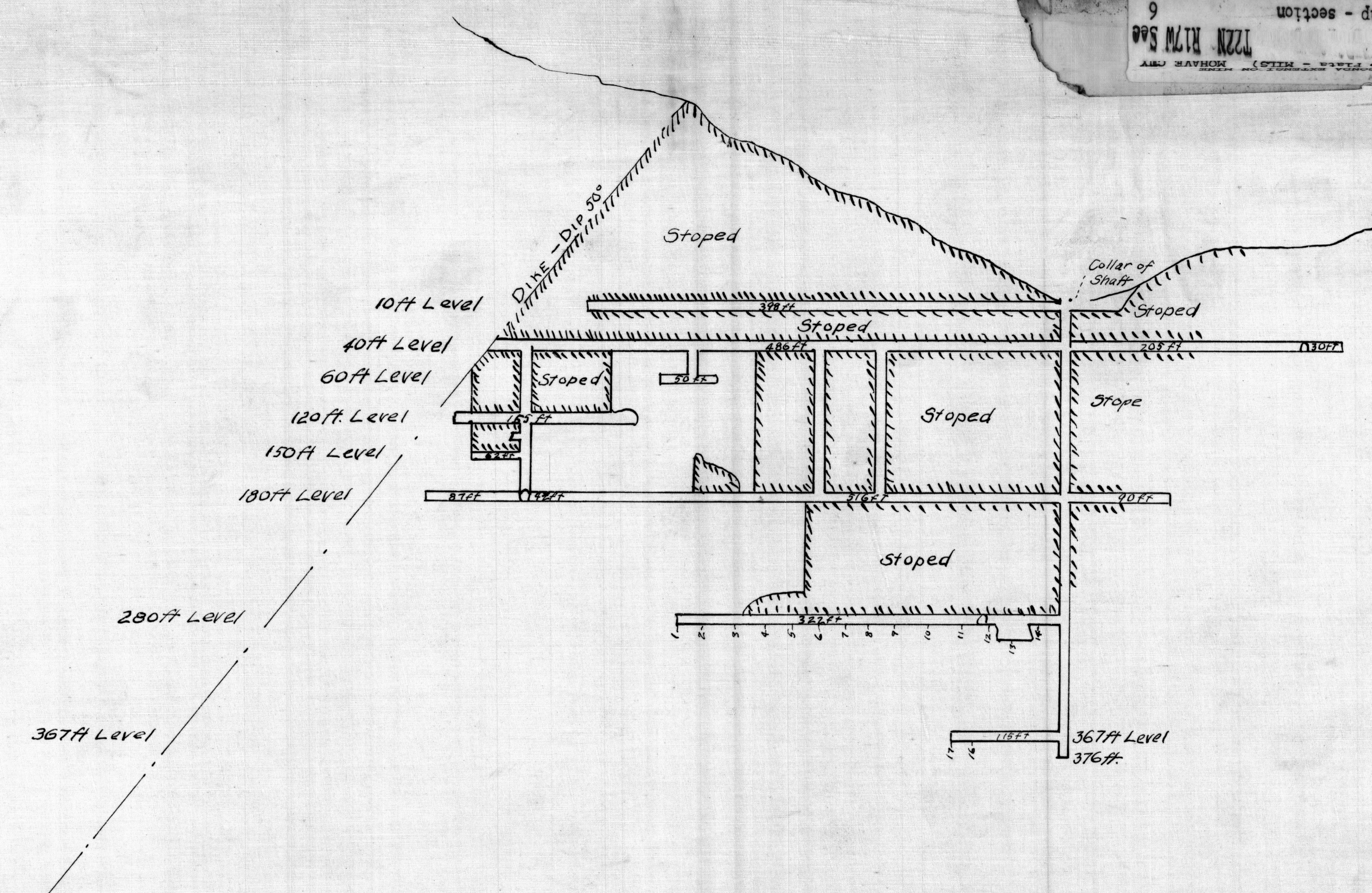

Section of the Underground Workings
 of the
GOLCONDA EXTENSION MINE
 MOHAVE COUNTY, ARIZONA.
 Traced by: M.G. Gullety

ADMMR 0217-001