

Sample No	Width	% Cu	% Zn	Description	Sample No	Width	% Cu	% Zn	Description
156	10"	2.80	15.81	Razor Jan. 19, 1944	48	65"	11.3	32.9	Torote, Aug 27, 1916
40	14"	-	35.9	Near Torote No 41	B-4	78"	5.2	31.3	Mills and Yates, Aug 18, 1942
157	36"	4.33	20.22	Torote, Aug 17, 1916	47	15"	10.14	-	near Torote No 48
158	36"	5.24	28.80	"	B-3	12"	16.01	1.1	Mills and Yates, Aug 18, 1942
41	12"	-	33.7	Torote, Aug 17, 1916	46	15"	2.65	5.4	near Torote No 47
159	20"	5.84	30.00	Razor, near Torote No 42	D-11	36"	7.6	3.0	Dye & Bathrick Dec, 1943
42	19"	-	30.8	Torote	D-12	76"	3.3	1.2	" "
160	48"	7.90	37.98	Razor, near Torote No 43	D	10"	4.2	27.6	" near Torote No 47
73	73"	5.84	27.4	Torote	79	10"	4.4	23.2	Torote
161	66"	5.01	25.11	Razor	169	51"	3.62	2.25	Razor
162	36"	6.73	24.09	"	D.B. 3	54"	8.28	2.4	Dye and Bathrick
44	17"	5.02	40.7	Torote	D.B. 4	54"	4.24	3.5	" "
163	18"	3.95	34.63	Razor, near Torote No 44	170	60"	4.71	13.64	Razor
164	48"	7.11	36.20	"	171	72"	9.88	16.24	"
165	67"	7.15	28.15	"	172	68"	8.20	4.95	"
166	60"	5.66	16.72	"	D.B. 5	30"	7.68	31.3	Dye and Bathrick
45	60"	4.31	40.2	Torote	D.B. 6	66"	9.30	20.5	" "
167	50"	3.97	11.01	Razor	D.B. 7	60"	9.42	23.7	" "
168	60"	5.90	16.84	"	D.B. 8	66"	12.94	17.8	" "
173	102"	2.33	20.77	"	D.B. 1	72"	5.50	14.1	" "
174	72"	7.91	18.88	"	176	66"	6.85	35.67	Razor
175	60"	6.60	26.83	"	177	48"	6.75	40.20	"

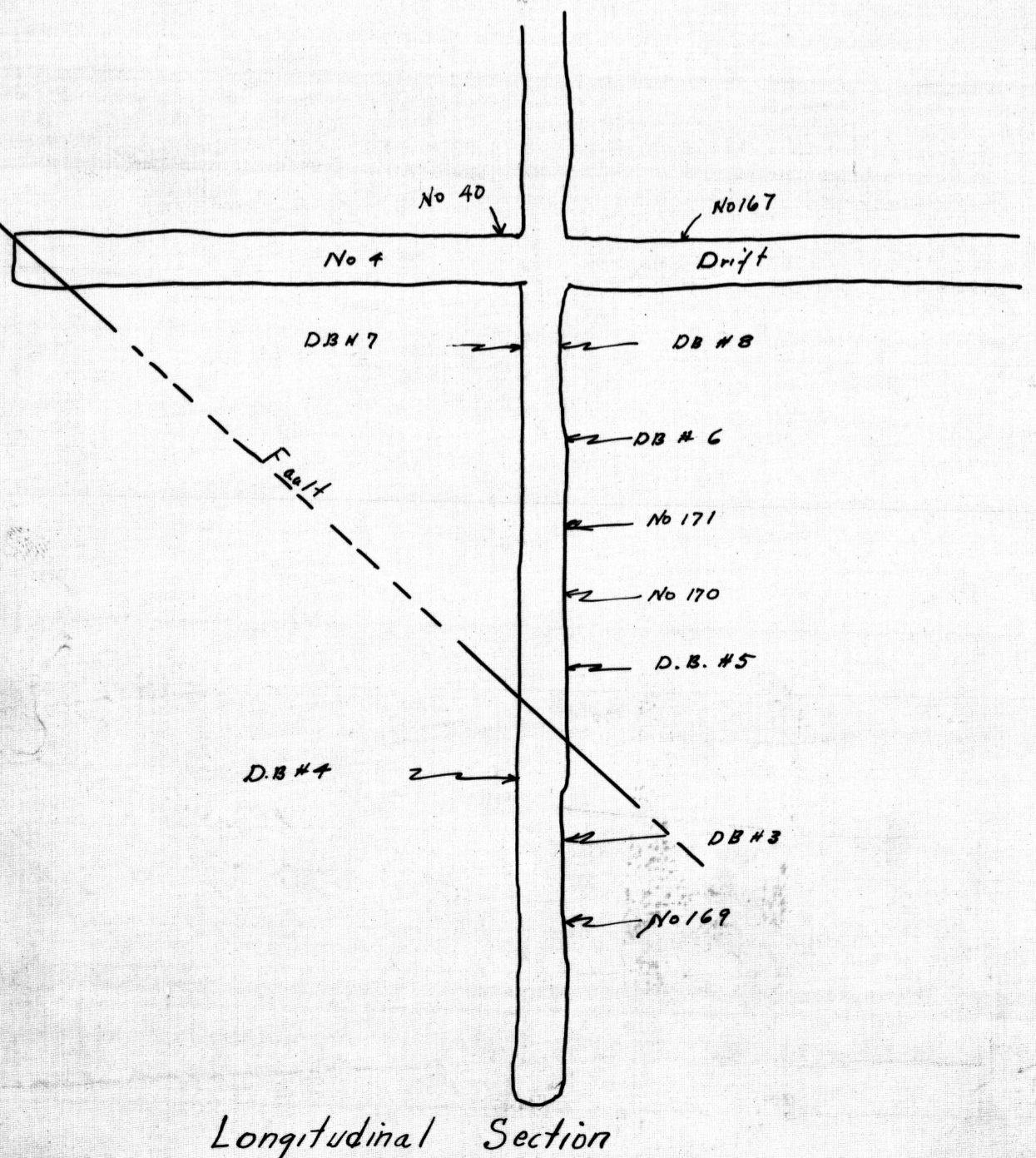
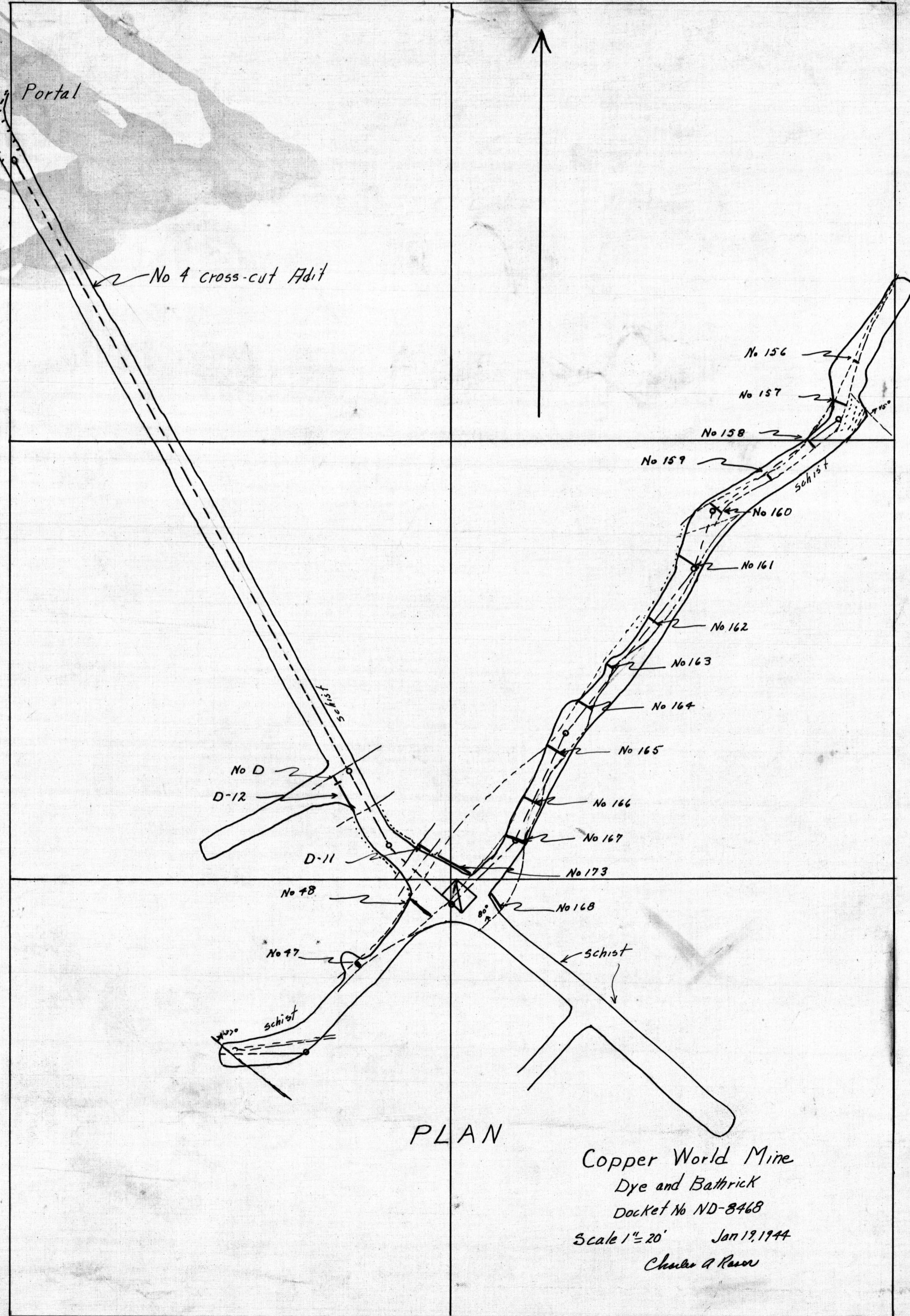
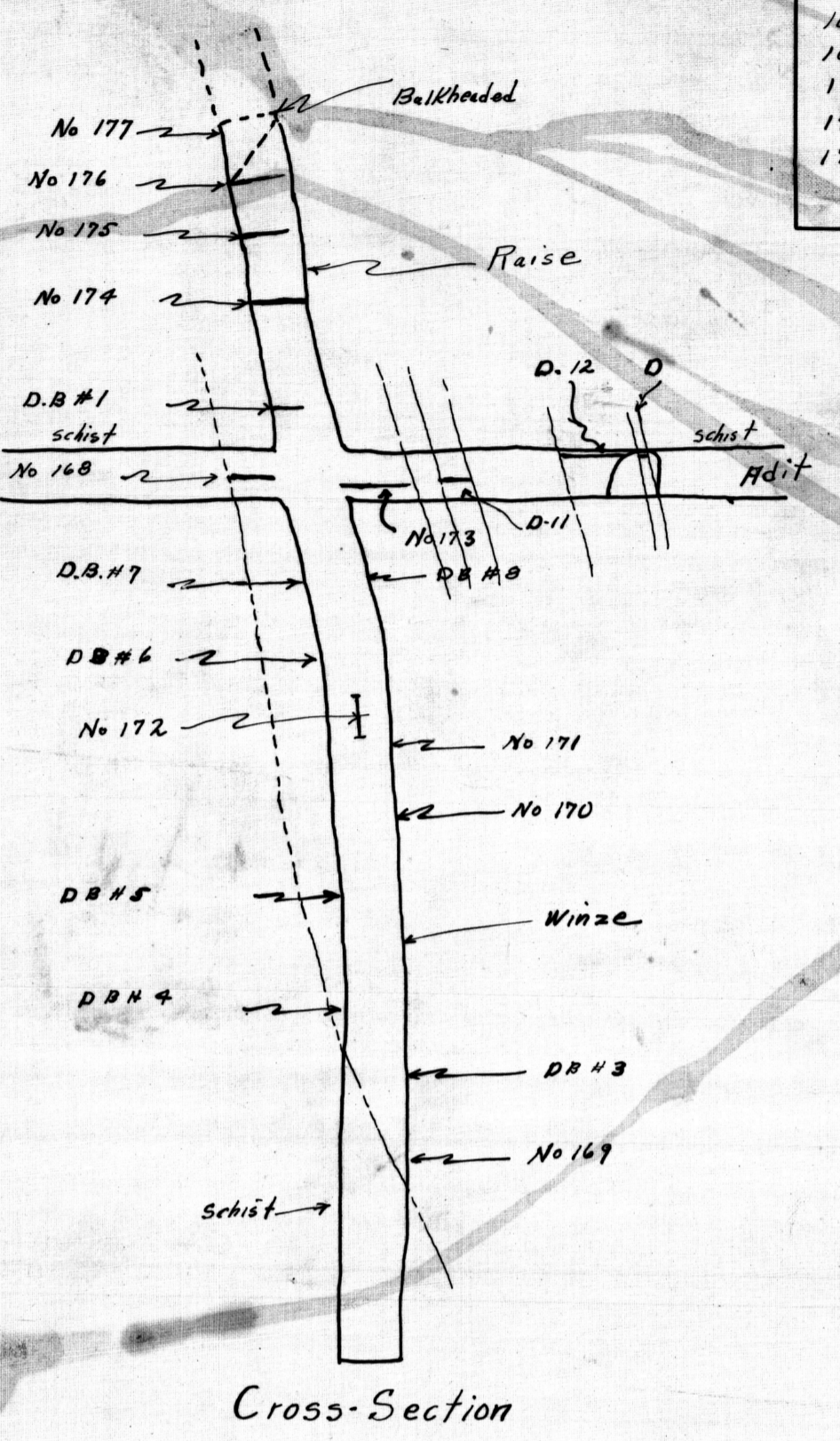

Copper World Mine
 Dye and Bathrick
 Docket No ND-8468
 Scale 1"=20' Jan 19, 1944
 Charles A. Rason

ADMMR0189-016