

BUTCH CLAIMS - SANTA RITA MNG. CO

RED STAR CLAIMS
9 INC. 16
HELVETIA MINING DISTRICT
NE 1/4 SECTION 14
T18S R15E
SANTA RITA MINING CO.

ALL CLAIMS POSTED 7/23/68
" " RECORDED 8/21/68
6/4/71
Revised 7/29/71
H.S. Dahlman

ELK CLAIMS - ANACONDA
Shown thusly

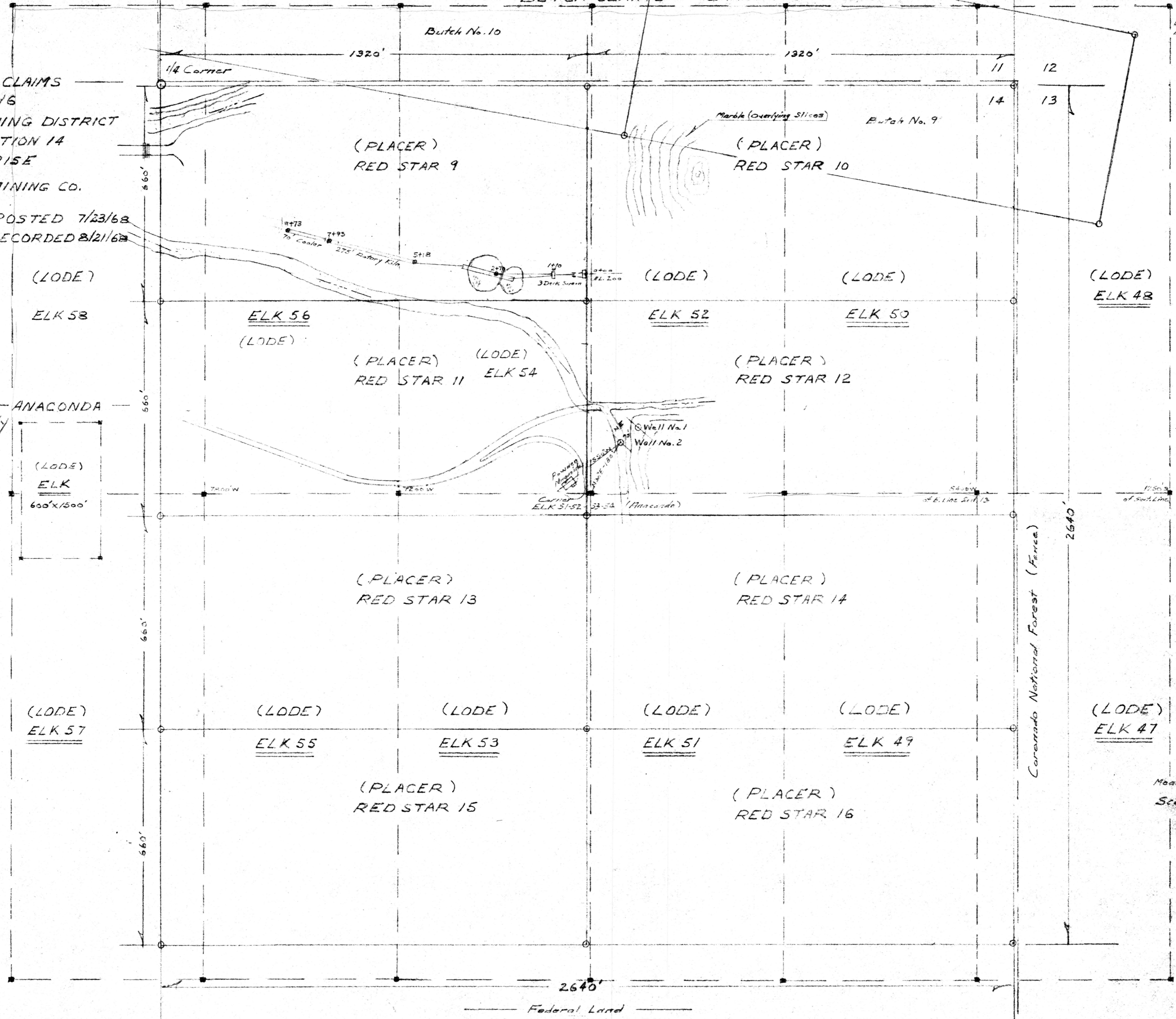

1800' W. of
E. Line Sect. 13

N



13° MN

Magn. Declination
Scale 1 Inch = 200 Ft.

ADMMR 0117-001

Revised 7/29/71
6/4/71
HSD