

②

JAQUAYS MINING CORP  
 1219 SOUTH 19<sup>TH</sup> AVE., PHOENIX, ARIZONA  
 CROSS-SECTIONS SHEET 2  
 ARTILLERY PEAK DISTRICT MOHAVE COUNTY, ARIZONA  
 SCALE: HOR.-1 IN.=20 FT., VERT.-1 IN.=10 FT.  
 SURVEYED & DRAWN: MAY 1957, BY: *John L. Steiner*  
 REGISTERED MINING ENGINEER  
 ARIZONA NO. 2506.

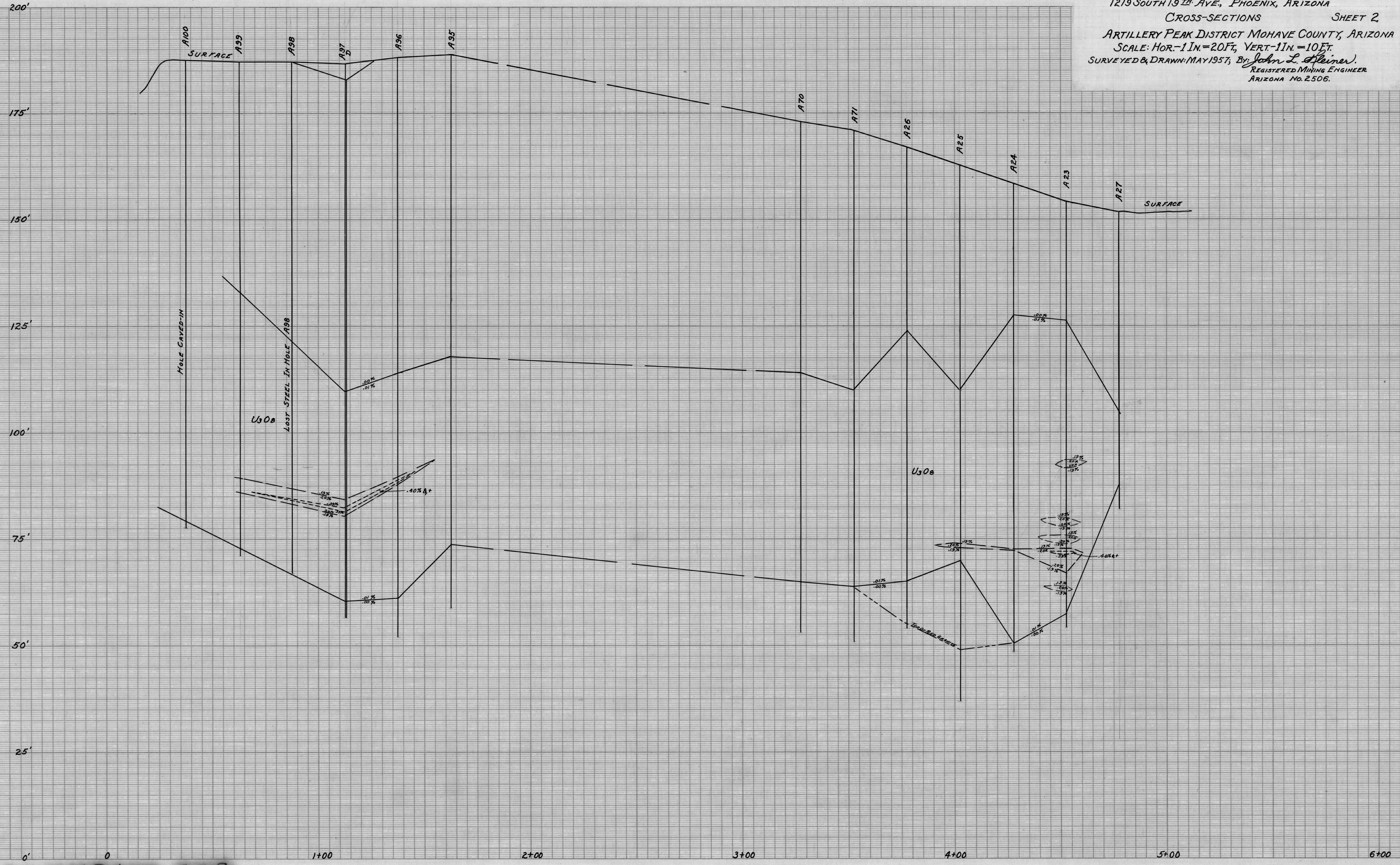

ADMMR103-008

PROFILE PLATE A  
 CHARLES BRUNING CO  
 MADE IN U.S.A.

PROFILE PLATE A  
 CHARLES BRUNING CO  
 MADE IN U.S.A.

Jaquays Mining Corp Plate 6  
 Scanned: 9/08