

COLUMBIA-SILVER BELL
BLOCKS A-B-C

BLOCK B
720 Tons
Ag. 8.5 oz.
Pb. 2.2%

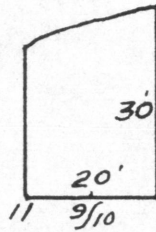

BLOCK A
1224 Tons
Ag. 13.0 oz.
Pb. 2.7%

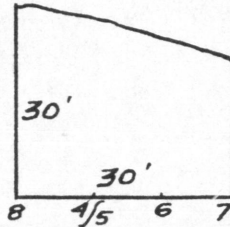

STOPE # 1

LATITUDE
19700

STOPE # 1

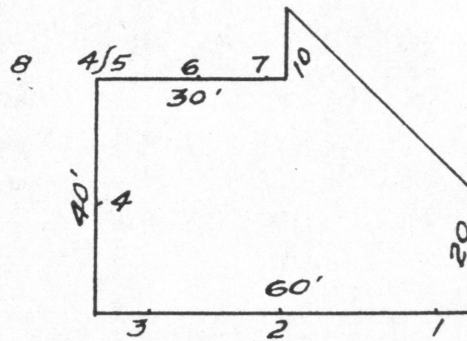

#1 ADIT

BLOCK C
3018 Tons
Ag. 13.1 oz.
Pb. 2.6%

ADMMR
0027-070