

Adjust

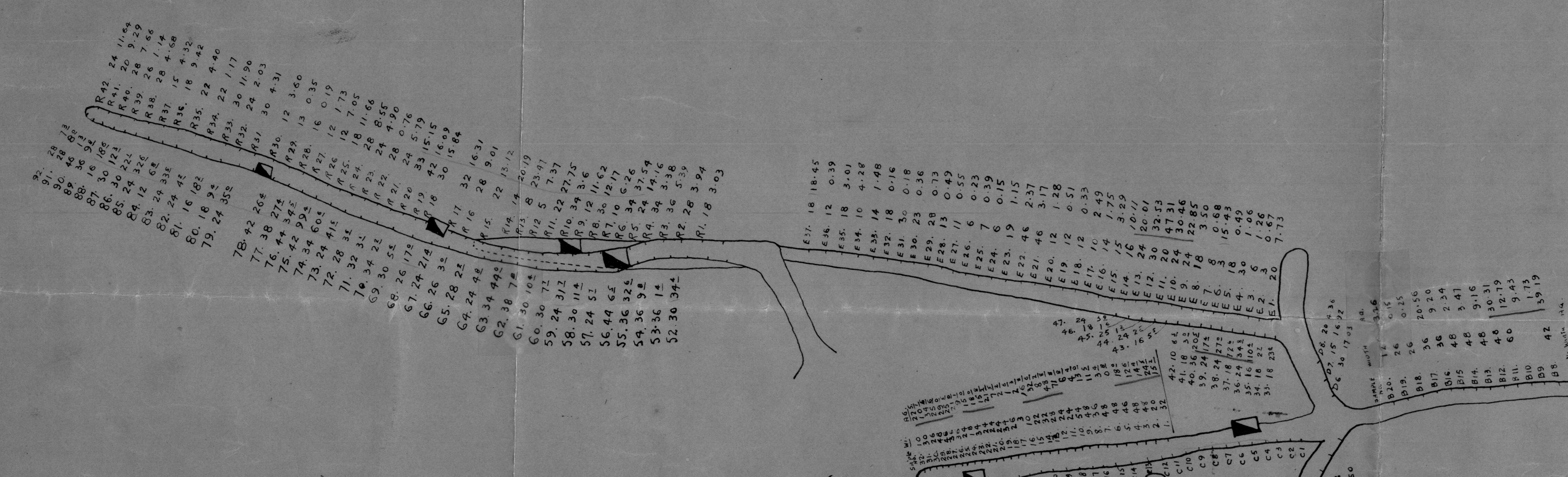

76	10.4
77	10.4
78	10.4
79	10.4
80	10.4
81	10.4
82	10.4
83	10.4
84	10.4
85	10.4
86	10.4
87	10.4
88	10.4
89	10.4
90	10.4
91	10.4
92	10.4
93	10.4
94	10.4
95	10.4
96	10.4
97	10.4
98	10.4
99	10.4
100	10.4
101	10.4
102	10.4
103	10.4
104	10.4
105	10.4
106	10.4
107	10.4
108	10.4
109	10.4
110	10.4
111	10.4
112	10.4
113	10.4
114	10.4
115	10.4
116	10.4
117	10.4
118	10.4
119	10.4
120	10.4
121	10.4
122	10.4
123	10.4
124	10.4
125	10.4
126	10.4
127	10.4
128	10.4
129	10.4
130	10.4
131	10.4
132	10.4
133	10.4
134	10.4
135	10.4
136	10.4
137	10.4
138	10.4
139	10.4
140	10.4
141	10.4
142	10.4
143	10.4
144	10.4
145	10.4
146	10.4
147	10.4
148	10.4
149	10.4
150	10.4
151	10.4
152	10.4
153	10.4
154	10.4
155	10.4
156	10.4
157	10.4
158	10.4
159	10.4
160	10.4
161	10.4
162	10.4
163	10.4
164	10.4
165	10.4
166	10.4
167	10.4
168	10.4
169	10.4
170	10.4
171	10.4
172	10.4
173	10.4
174	10.4
175	10.4
176	10.4
177	10.4
178	10.4
179	10.4
180	10.4
181	10.4
182	10.4
183	10.4
184	10.4
185	10.4
186	10.4
187	10.4
188	10.4
189	10.4
190	10.4
191	10.4
192	10.4
193	10.4
194	10.4
195	10.4
196	10.4
197	10.4
198	10.4
199	10.4
200	10.4

Sample	Width	Assay
C-1	3.0	0.78
C-2	1.2	2.13
C-3	1.4	4.09
C-4	1.2	21.67
C-5	1.6	13.76
C-6	2.0	9.68
C-7	2.8	15.98
C-8	2.0	2.09
C-9	2.8	51.68
C-10	1.6	11.27
C-11	3.0	5.30
C-12	3.6	5.78
C-13	4.2	9.68
C-14	4.8	6.49
C-15	3.8	6.49
C-16	4.2	5.65
C-17	4.2	7.35
C-18	1.2	5.65
C-19	2.2	9.60
C-20	1.8	7.66
C-21	3.6	2.68
C-22	1.8	1.88
C-23	1.0	1.75
C-24	1.8	5.04

ASSAY MAP
LEGEND

In the first column is the number of the samples in the second in the width in inches, and in the third column the silver in ounces.

Samples the number of which is preceded by a letter are check samples in 100% of the H.P.C. assays and engineers. All samples are cut in 5-ft intervals and for width of vein only.

LITTLE TREASURE MINE
SADDLE MOUNTAIN DISTRICT ARIZONA
Scale 2"=50'

Compiled by: M. HAYDEN July 21, 1937

ADMMR-0021-008

(In "Adjust" file)