

PROPERTY OF  
**UNITED VERDE CONSOLIDATED**  
**COPPER COMPANY**  
SQUAW PEAK MINING DISTRICT  
YAVAPAI COUNTY ARIZONA  
SCALE 1IN=300 FT

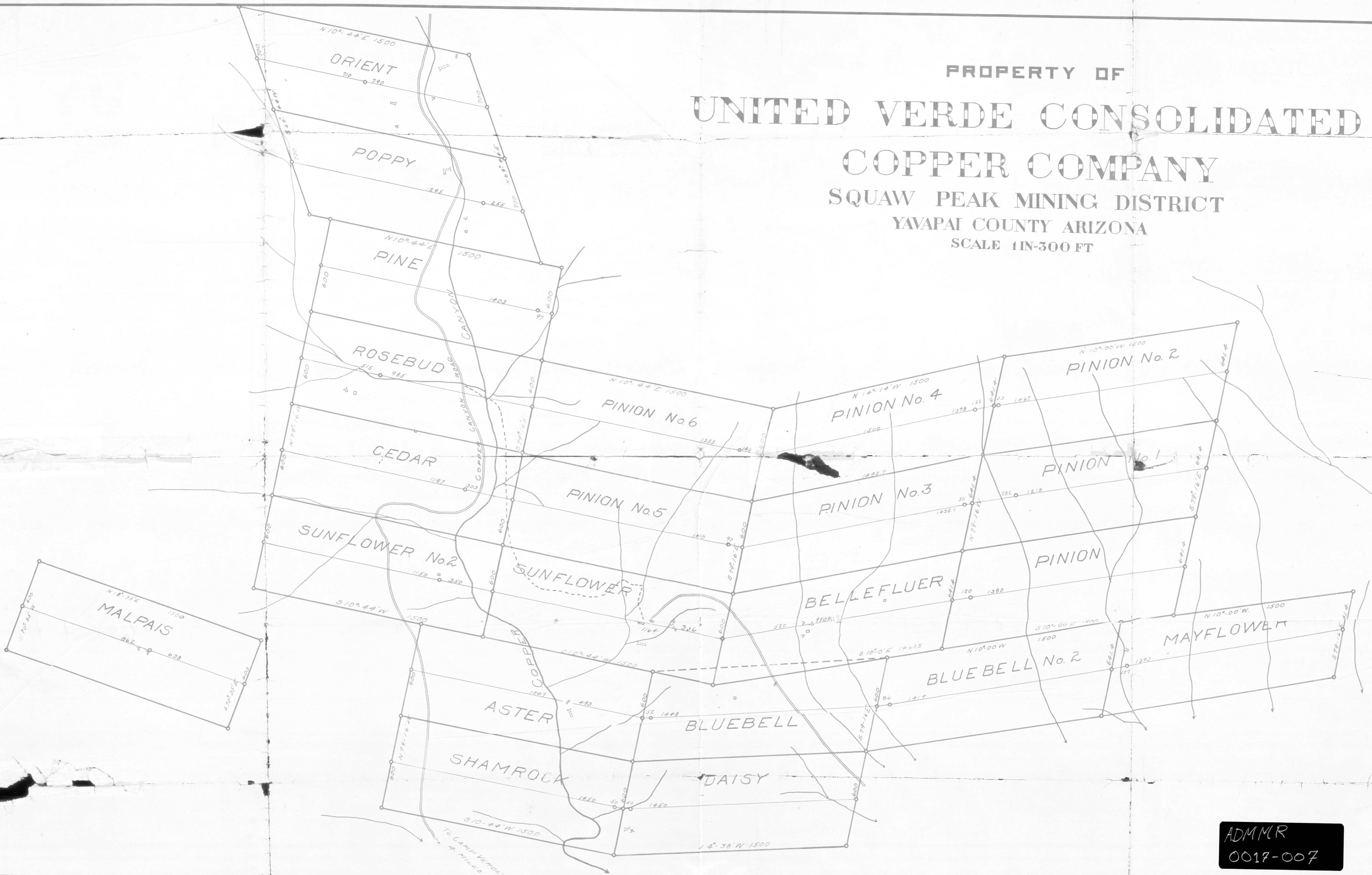

ADMIN  
0017-007

By J. WILLIAM WAARA  
U.S. MINERAL SURVEYOR  
PRESCOTT, ARIZONA  
SEPT. 1916