

SUPERVISOR: _____
 COMPILED BY: _____
 DRAWN BY: _____
 SCALE: 1" = 400'
 DATE: 03/17/90
 PROJECT: AMERICAN COPPER AND NICKEL CO., INC.
 LOCATION: MOHAVE COUNTY, NEVADA
 SHEET: _____
 GEOLOGY & DRILL PLAN

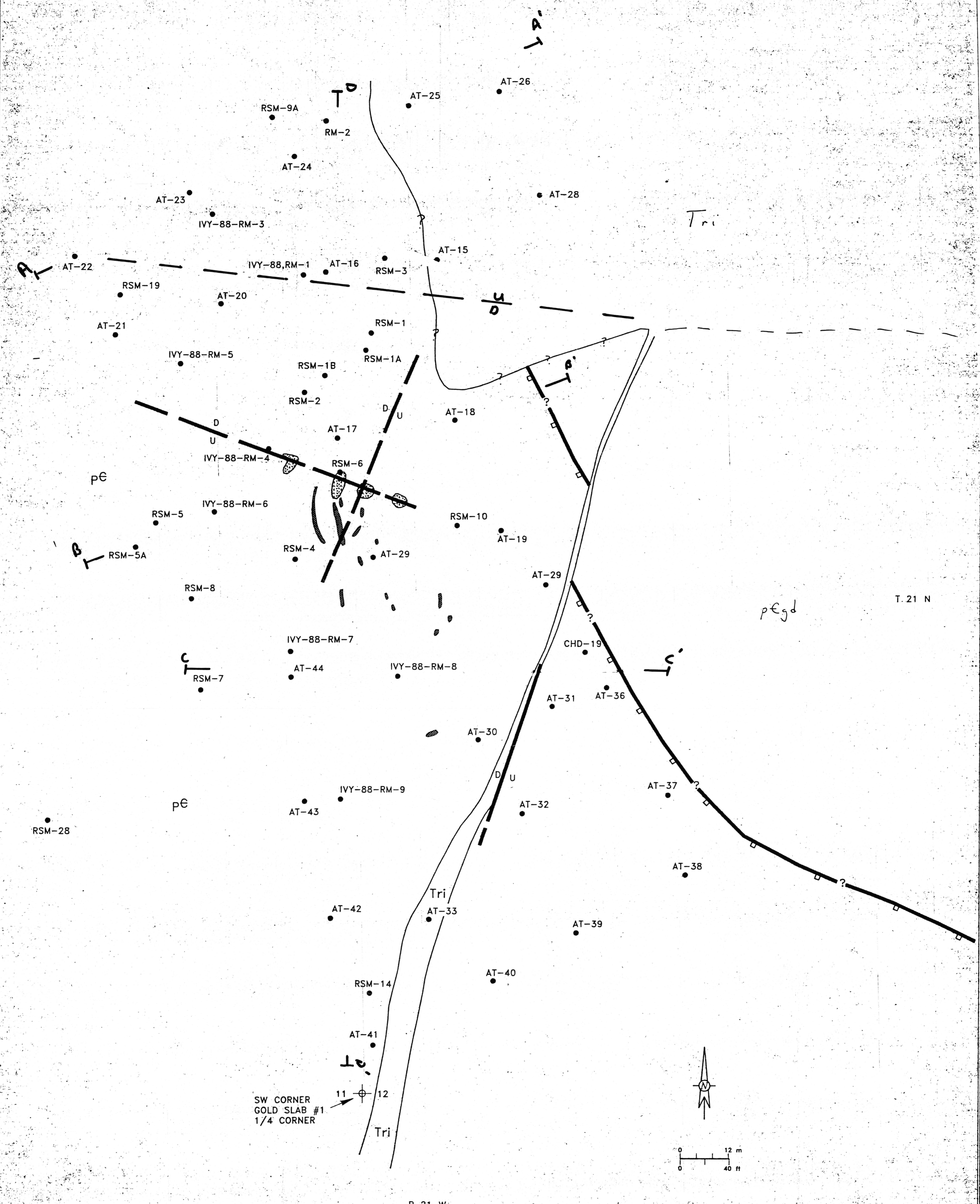

SW CORNER
 GOLD SLAB #1
 1/4 CORNER

EXPLANATION

- DRILL HOLE
- /— DETACHMENT FAULT
- /— FAULT
- ▨ OREGRADE (>0.03 OZ/TON Au) UNDERGROUND SAMPLES PROJECTED TO SURFACE
- ▤ TERTIARY BRECCIA
- Tri TERTIARY RHYOLITE INTRUSIVE
- Trv TERTIARY RHYOLITE VOLCANICS
- pE PRECAMBRIAN GRANITE

ADMNR 0007-090